

EE3 LLC.
MUTUAL #04-30H ON EXISTING #02-30H PAD
 LOCATED IN JACKSON COUNTY, COLORADO
 SECTION 30, T7N, R80W, 6th P.M.

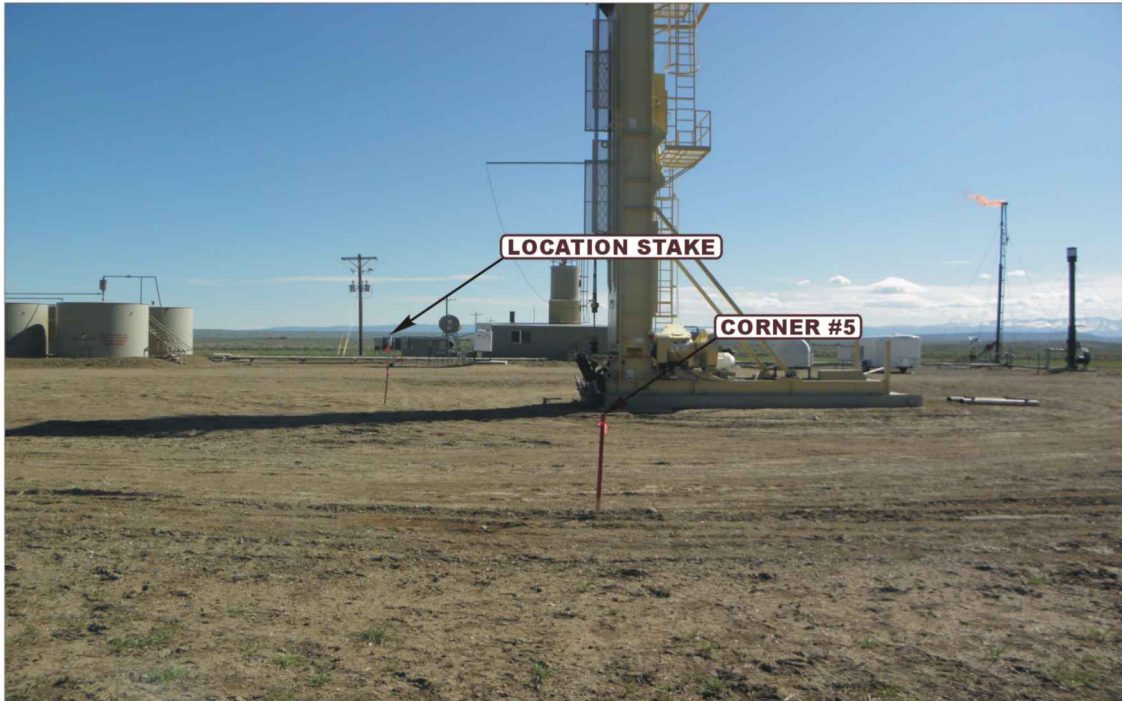

PHOTO: VIEW FROM CORNER #5 TO LOCATION STAKE

CAMERA ANGLE: NORTHEASTERLY



PHOTO: VIEW OF EXISTING ROAD

CAMERA ANGLE: SOUTHERLY



- Since 1964 -

U **E** **L** **S** Uintah Engineering & Land Surveying
 85 South 200 East Vernal, Utah 84078
 (435) 789-1017 * FAX (435) 789-1813

LOCATION PHOTOS	06	28	11	PHOTO P1
	MONTH	DAY	YEAR	
TAKEN BY: D.N.	DRAWN BY: C.L.	REV: 04-03-13 A.T.		

EE3 LLC.
MUTUAL #04-30H ON EXISTING #02-30H PAD
 LOCATED IN JACKSON COUNTY, COLORADO
 SECTION 30, T7N, R80W, 6th P.M.



PHOTO: VIEW OF LOCATION STAKE

CAMERA ANGLE: NORTHERLY



PHOTO: VIEW OF LOCATION STAKE

CAMERA ANGLE: EASTERLY



- Since 1964 -

U
E
L
S Uintah Engineering & Land Surveying
 85 South 200 East Vernal, Utah 84078
 (435) 789-1017 * FAX (435) 789-1813

LOCATION PHOTOS	06 MONTH	28 DAY	11 YEAR	PHOTO P2
TAKEN BY: D.N.	DRAWN BY: C.L.	REV: 04-03-13 A.T.		

EE3 LLC.
MUTUAL #04-30H ON EXISTING #02-30H PAD
 LOCATED IN JACKSON COUNTY, COLORADO
 SECTION 30, T7N, R80W, 6th P.M.



PHOTO: VIEW OF LOCATION STAKE

CAMERA ANGLE: SOUTHERLY

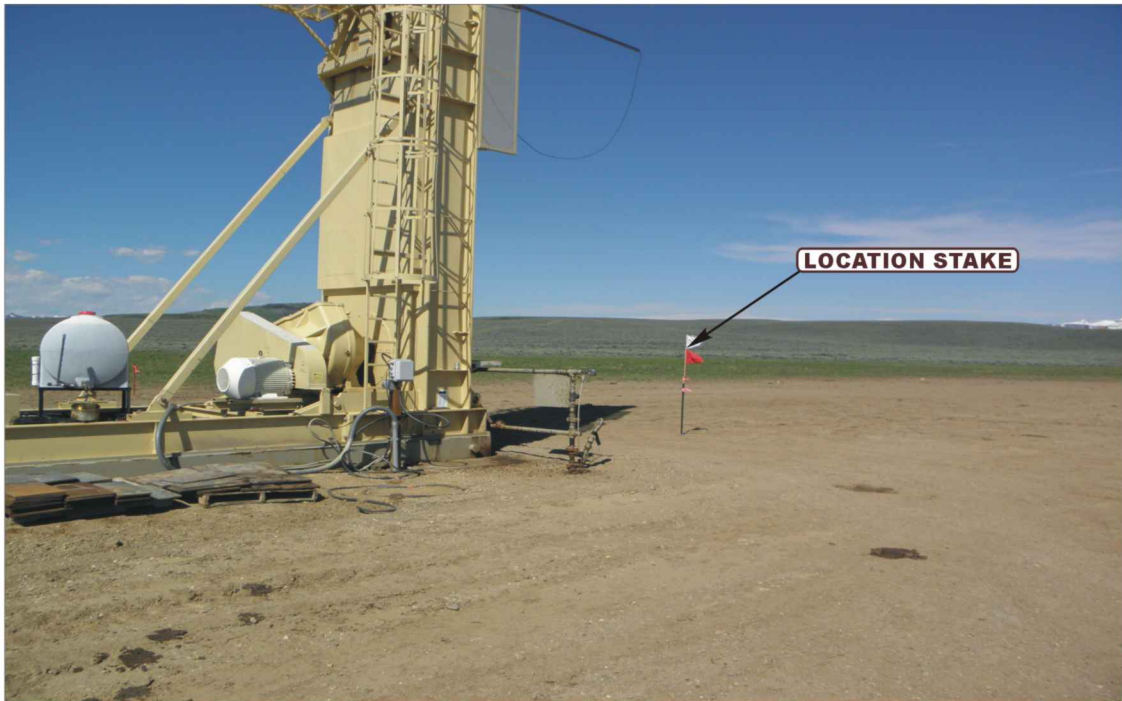

PHOTO: VIEW OF LOCATION STAKE

CAMERA ANGLE: WESTERLY



- Since 1964 -

UELS Uintah Engineering & Land Surveying
 85 South 200 East Vernal, Utah 84078
 (435) 789-1017 * FAX (435) 789-1813

LOCATION PHOTOS	06	28	11	PHOTO P3
	MONTH	DAY	YEAR	
TAKEN BY: D.N.	DRAWN BY: C.L.	REV: 04-03-13 A.T.		