

LOCATION DRAWING

ROHN STATE LD03-65-1HN PAD,
ROHN STATE LD04-65-1HN PAD

SECTION: 4
TOWNSHIP: 9N
RANGE: 58W

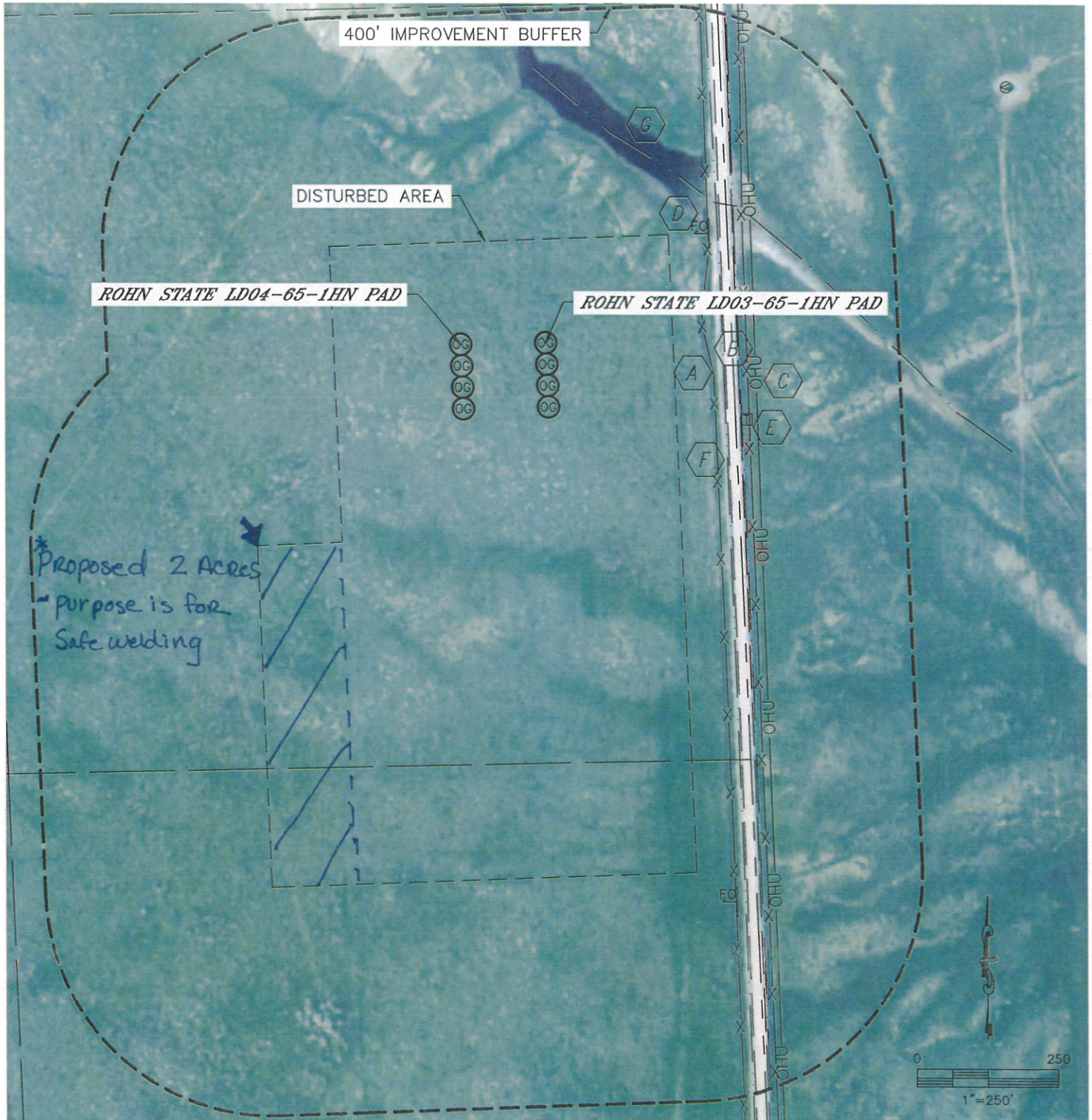

IMPROVEMENTS:

(MEASURED FROM THE PROPOSED ROHN STATE LD03-65-1HN WELL LOCATION)

- | | | |
|----------------------------------|--|--------------------------------|
| (A) FENCE 280' & 355' E | (D) FIBER OPTIC MARKER 335' NE, 1057' SE | (F) BARROW DITCH 313' & 341' E |
| (B) COUNTY ROAD 127 316' E | (E) TELEPHONE PEDESTAL 379' SE | (G) SWALE 375' NE |
| (C) OVERHEAD UTILITY LINE 370' E | | |

NEAREST: BUILDING 5280'+, PUBLIC ROAD 316' E, (CR 127),
ABOVE GROUND UTILITY 370' E, RAILROAD 5280'+, PROPERTY LINE 330' E

DATE: rev 6/26/2013
PROJECT#: 2012159