

Notes:

1. Topsoil and seed new cut and fill slopes and new disturbed areas for reclaimed pad according to notes on sheet 2F.
2. Cut slopes and fill slopes to be no steeper than 5:1, minimize disturbance on previously undisturbed ground.
3. Use original pad material to fill in cut slopes and layback fill slopes for the reclaimed surface.

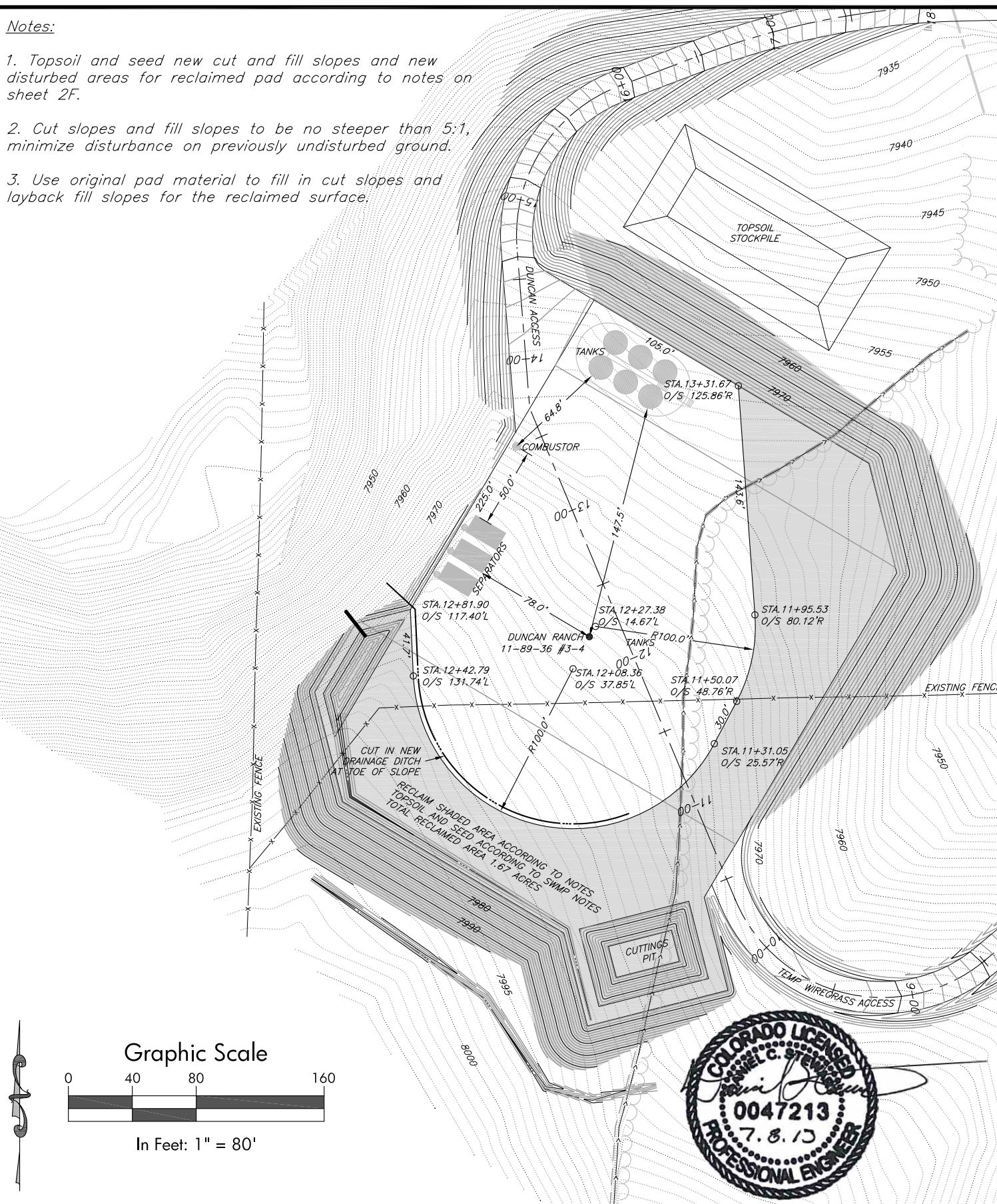

Graphic Scale

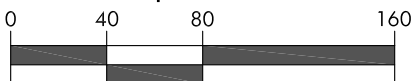

In Feet: 1" = 80'



**Petroleum
Resource
Management
Corp.**



118 West Sixth Street, Suite 200
Glenwood Springs, CO 81601
970.945.1004 www.sgm-inc.com

Scale: 1" = 80

Sheet 2G of 7

DR SE APD

Duncan Ranch SE Reclaim & Facilities

SW1/4 SE1/4, Section 36, T.11N, R.89W., 6TH P.M.

Job# 2013-379.001

Date: 7.8.13

By: DCS

File: DRAPD_BM