

SWEPI LP
WILLIAMS #1-30
LOCATED IN ROUTT COUNTY, COLORADO
SECTION 30, T6N, R87W, 6th P.M.

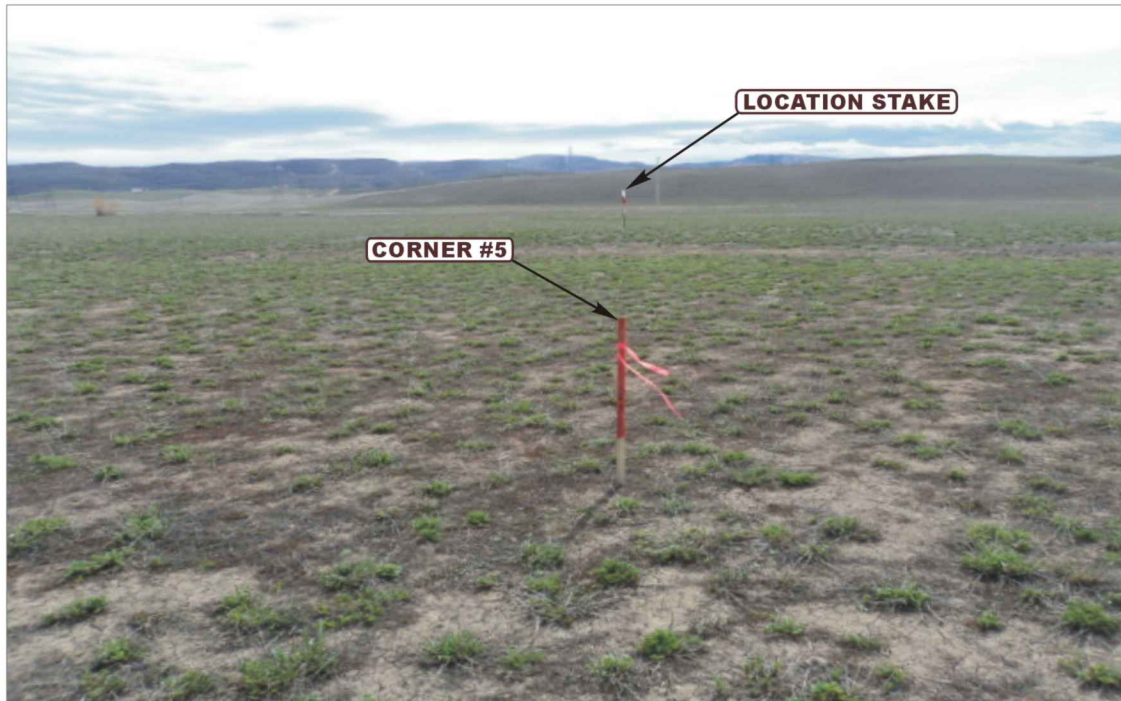

PHOTO: VIEW FROM CORNER #5 TO LOCATION STAKE

CAMERA ANGLE: EASTERLY



PHOTO: VIEW FROM BEGINNING OF PROPOSED ACCESS

CAMERA ANGLE: SOUTHERLY



- Since 1964 -



Uintah Engineering & Land Surveying
85 South 200 East Vernal, Utah 84078
(435) 789-1017 * FAX (435) 789-1813

LOCATION PHOTOS

05 **16** **13**
MONTH DAY YEAR

TAKEN BY: G.M.

DRAWN BY: A.T.

REVISED: 00-00-00

PHOTO
P1

SWEPI LP
WILLIAMS #1-30
LOCATED IN ROUTT COUNTY, COLORADO
SECTION 30, T6N, R87W, 6th P.M.

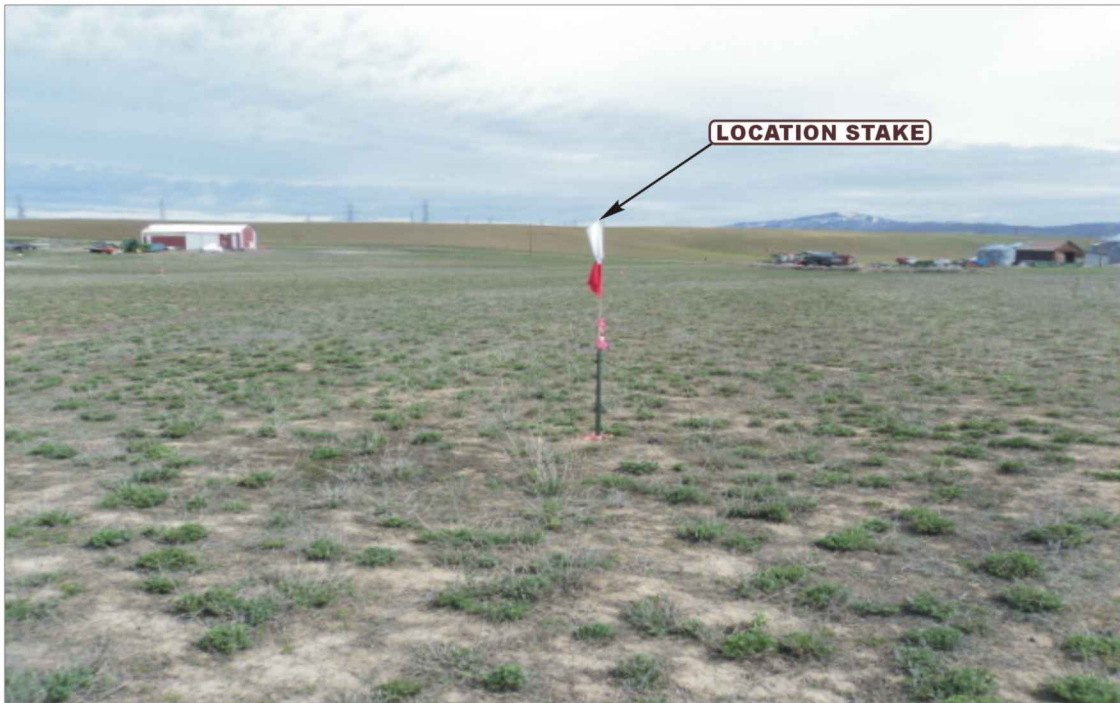

PHOTO: VIEW OF LOCATION STAKE

CAMERA ANGLE: NORTHERLY

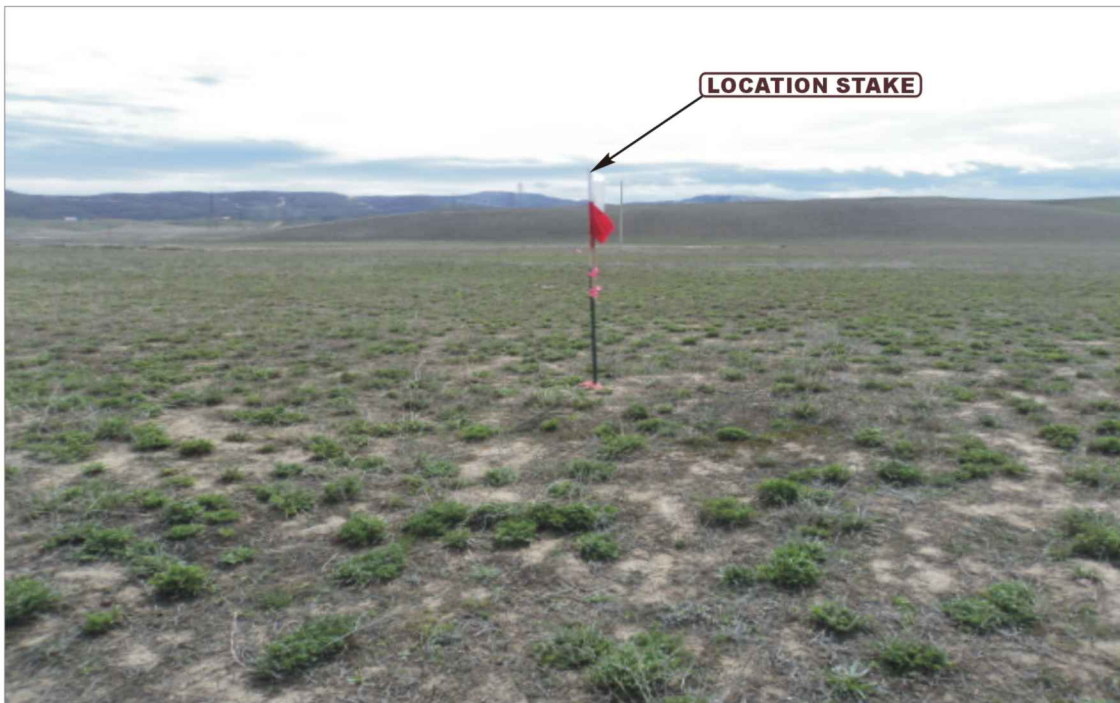

PHOTO: VIEW OF LOCATION STAKE

CAMERA ANGLE: EASTERLY



- Since 1964 -



Uintah Engineering & Land Surveying
85 South 200 East Vernal, Utah 84078
(435) 789-1017 * FAX (435) 789-1813

LOCATION PHOTOS

05 **16** **13**
MONTH DAY YEAR

TAKEN BY: G.M.

DRAWN BY: A.T.

REVISED: 00-00-00

PHOTO
P2

SWEPI LP
WILLIAMS #1-30
LOCATED IN ROUTT COUNTY, COLORADO
SECTION 30, T6N, R87W, 6th P.M.



PHOTO: VIEW OF LOCATION STAKE

CAMERA ANGLE: SOUTHERLY



PHOTO: VIEW OF LOCATION STAKE

CAMERA ANGLE: WESTERLY



- Since 1964 -



Uintah Engineering & Land Surveying
85 South 200 East Vernal, Utah 84078
(435) 789-1017 * FAX (435) 789-1813

LOCATION PHOTOS

05 **16** **13**
MONTH DAY YEAR

TAKEN BY: G.M.

DRAWN BY: A.T.

REVISED: 00-00-00

PHOTO
P3