

ENCANA OIL & GAS (USA) INC

LOCATION LAYOUT WELL PAD (K22W)

Section 22, T7S, R93W, 6th P.M.

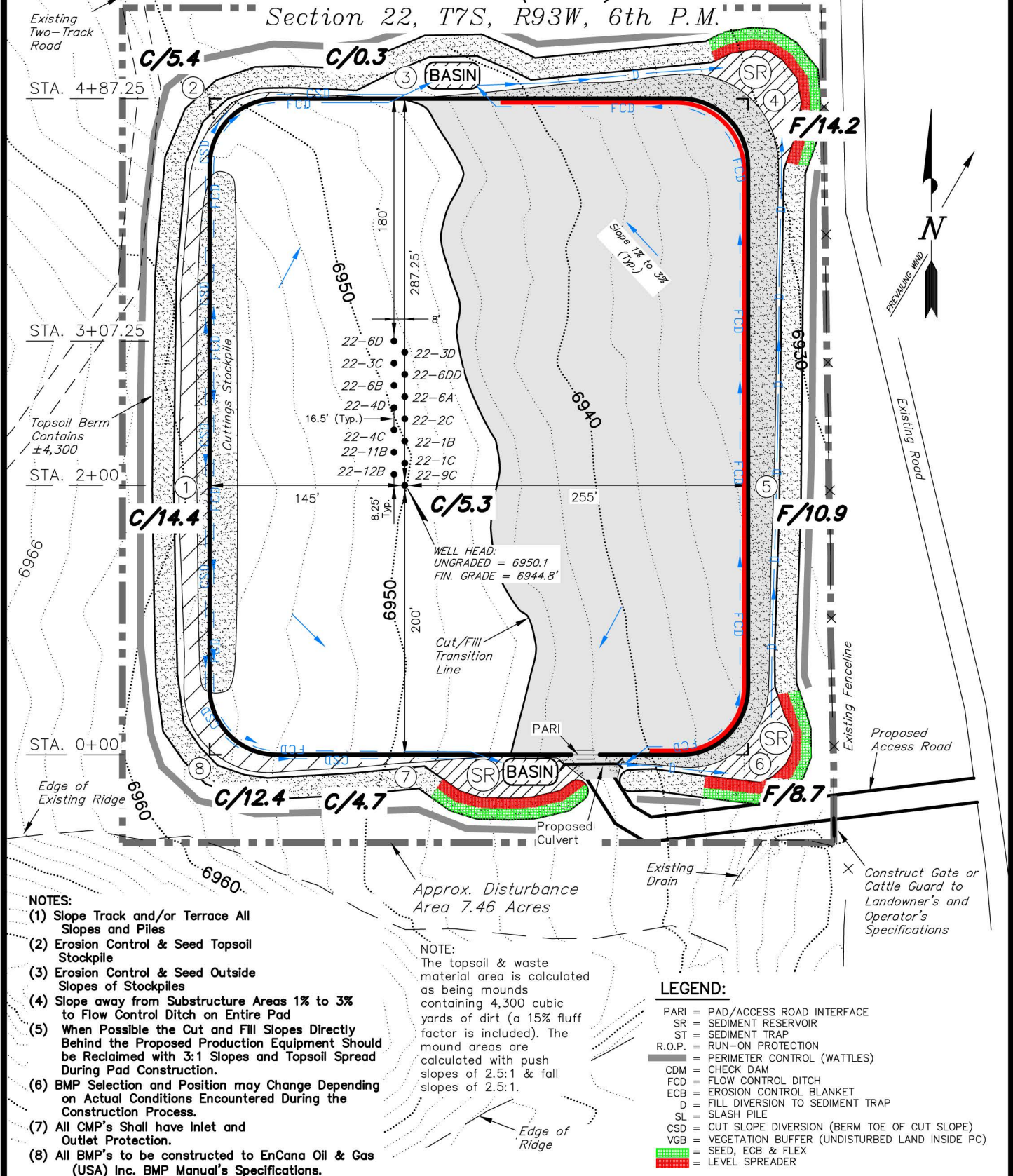

| | | | |
|--------------|-----------|----------------|---------------|
| SURVEYED BY: | C.D.S. | DATE SURVEYED: | 03-08-13 |
| DRAWN BY: | M.W. | DATE DRAWN: | 03-11-13 |
| SCALE: | 1" = 100' | REVISED: | M.W. 05-06-13 |

Tri State
Land Surveying, Inc.
180 NORTH VERNAL AVE. VERNAL, UTA

ENCANA OIL & GAS (USA) INC

TYPICAL RIG LAYOUT

WELL PAD (K22W)

Section 22, T7S, R93W, 6th P.M.

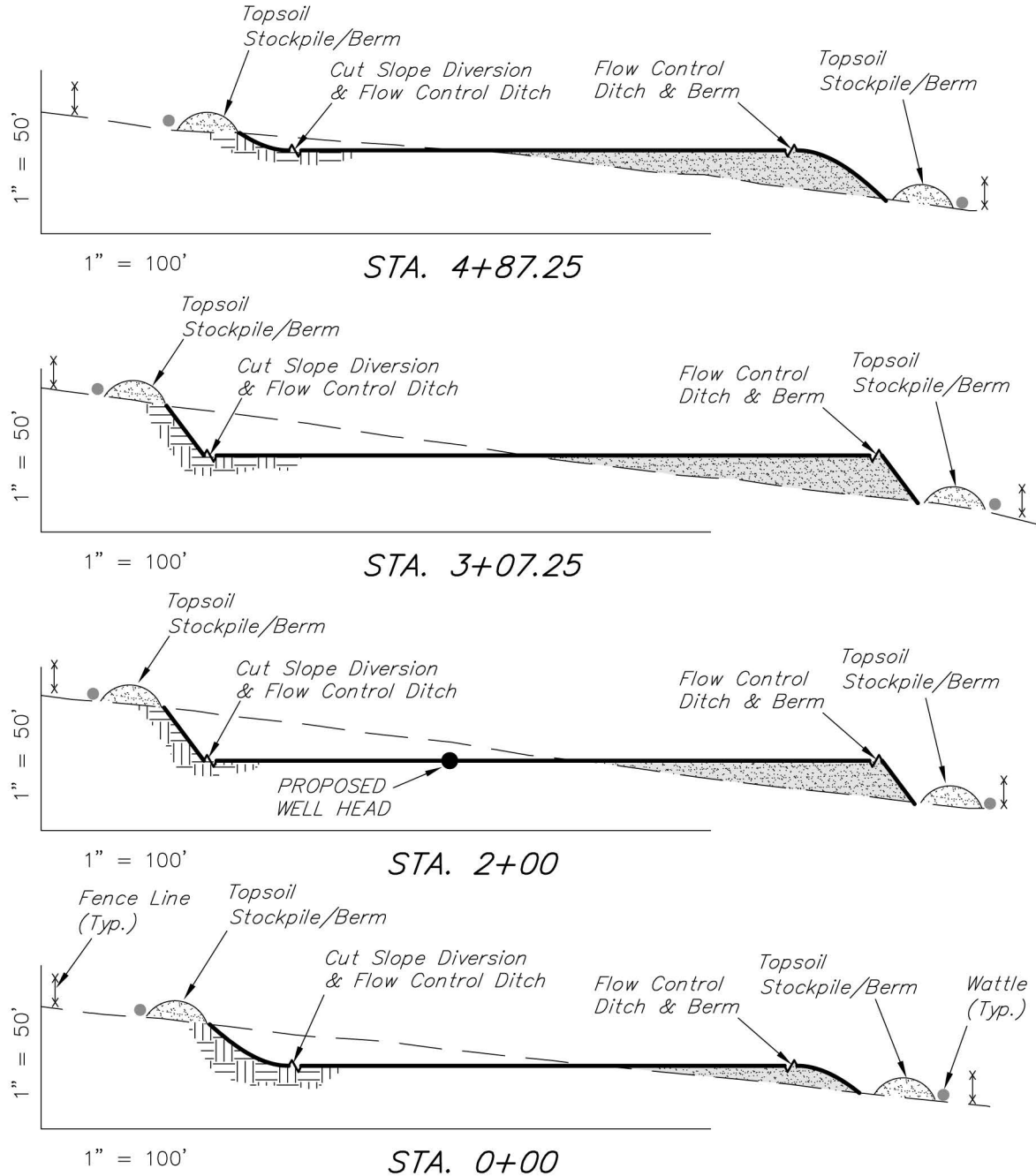

NOTE:
UNLESS OTHERWISE NOTED
CUT SLOPES ARE AT 1.5:1
FILL SLOPES ARE AT 1.5:1

| ESTIMATED EARTHWORK QUANTITIES (No Shrink or swell adjustments have been used) (Expressed in Cubic Yards) | | | | |
|---|--------|--------|------------------------------------|--------|
| ITEM | CUT | FILL | 6" TOPSOIL | EXCESS |
| PAD | 22,330 | 22,330 | Topsoil is not included in Pad Cut | 0 |
| PIT | N/A | N/A | | N/A |
| TOTALS | 22,330 | 22,330 | 3,730 | 0 |

| | |
|---------------------|-------------------------|
| SURVEYED BY: C.D.S. | DATE SURVEYED: 03-08-13 |
| DRAWN BY: M.W. | DATE DRAWN: 05-06-13 |
| SCALE: 1" = 100' | REVISED: |

| | | |
|--|-----------------------|--------------------|
| | Tri State | (435) 781-2501 |
| | Land Surveying, Inc. | |
| | 180 NORTH VERNAL AVE. | VERNAL, UTAH 84078 |

| |
|-------|
| SHEET |
| 5 |
| OF 8 |

ENCANA OIL & GAS (USA) INC

TYPICAL RIG LAYOUT

WELL PAD (K22W)

Section 22, T7S, R93W, 6th P.M.

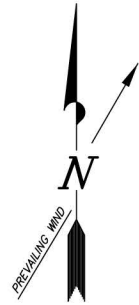

| | |
|---------------------|-------------------------|
| SURVEYED BY: C.D.S. | DATE SURVEYED: 03-08-13 |
| DRAWN BY: M.W. | DATE DRAWN: 05-06-13 |
| SCALE: 1" = 100' | REVISED: |

Tri State
Land Surveying, Inc.
180 NORTH VERNAL AVE. VERNAL, UTAH 84078
(435) 781-2501

SHEET
6
OF 8

ENCANA OIL & GAS (USA) INC

PRODUCTION SCHEMATIC

WELL PAD (K22W)

Section 22, T7S, R93W, 6th P.M.

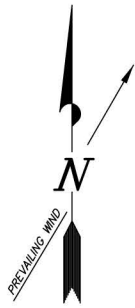

14 Combination Line Heater
& Production Packs
2 Mil. CF/DAY (2 5-Packs
& 1 4-Pack)

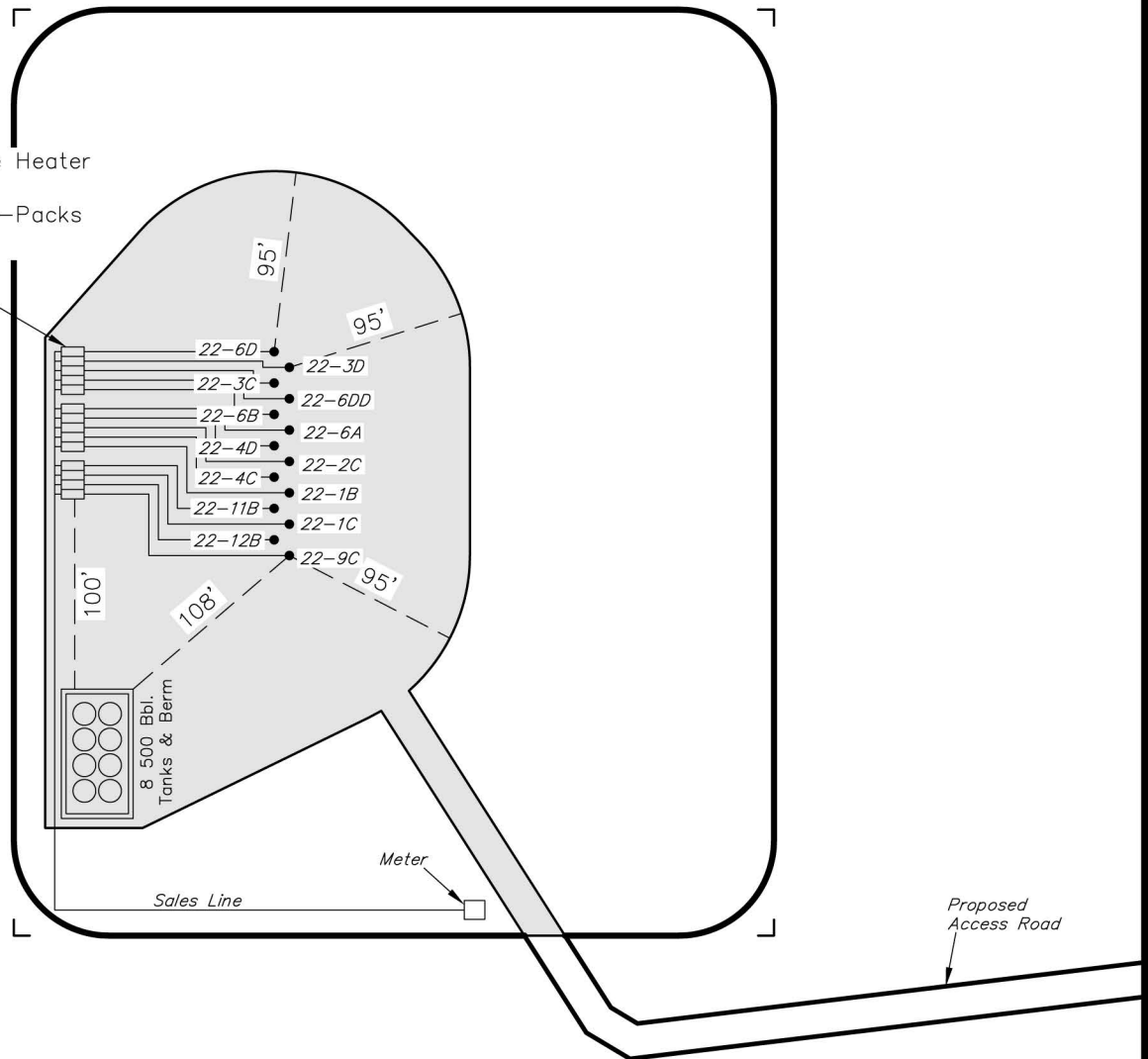

Notes:

1. Reclaimed area to include seeding of approved vegetation and sufficient storm water management system.
2. Reclaimed Pad to have storm water Management BMP's Per Encana Oil & Gas (USA) Inc. BMP Manual.
3. Actual Equipment Layout and Reclaimed Pad Surface Area May Change do to Production Requirements or Site Conditions.

DISTURBED AREA:

TOTAL DISTURBED AREA = ± 7.46 ACRES

TOTAL RECLAIMED AREA = ± 5.95 ACRES

UNRECLAIMED AREA = ± 1.51 ACRES

| | |
|---------------------|-------------------------|
| SURVEYED BY: C.D.S. | DATE SURVEYED: 03-08-13 |
| DRAWN BY: M.W. | DATE DRAWN: 05-06-13 |
| SCALE: 1" = 100' | REVISED: |

Tri State
Land Surveying, Inc.
180 NORTH VERNAL AVE. VERNAL, UTAH 84078
(435) 781-2501

SHEET
7
OF 8

ENCANA OIL & GAS (USA) INC

SURFACE DISTURBANCE AREA

WELL PAD (K22W)

Section 22, T7S, R93W, 6th P.M.

SE 1/4
NW 1/4

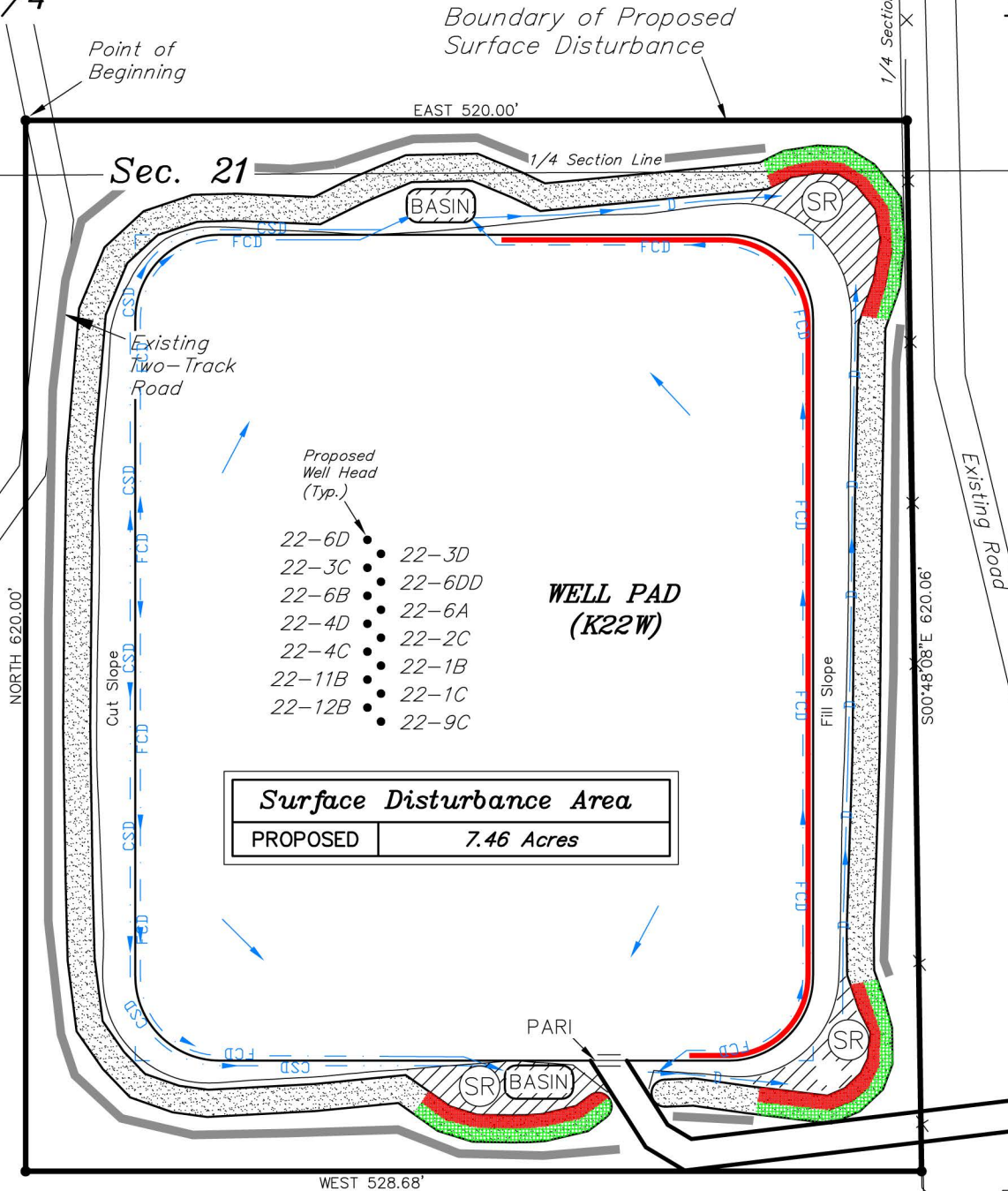

Surface Disturbance Area

| | |
|----------|------------|
| PROPOSED | 7.46 Acres |
|----------|------------|

NE 1/4
SW 1/4

BASIS OF BEARINGS NOTE:

Basis of Bearings is the West line of the NW 1/4 which is taken from Global Positioning Satellite observations to bear N00°13'32"W a measured distance of 2632.95'.

CORNER TIE NOTE:

The Northwest corner of the Disturbance Boundary (Point of Beginning) bears N88°49'10"E 2017.25' from the West 1/4 Corner of Section 22.

| | |
|---------------------|-------------------------|
| SURVEYED BY: C.D.S. | DATE SURVEYED: 03-08-13 |
| DRAWN BY: M.W. | DATE DRAWN: 05-06-13 |
| SCALE: 1" = 200' | |

Tri State
Land Surveying, Inc.
180 NORTH VERNAL AVE. VERNAL, UTAH 84078
(435) 781-2501

SHEET
8
OF 8