



CARRIZO OIL & GAS, INC.

Field: Niobrara CONZ'83
 Site: Bob White 2-36-8-62 Pad
 Well: 3-36-8-62
 Wellpath: Original Hole
 Plan: Plan #1



Precision
 Directional Services

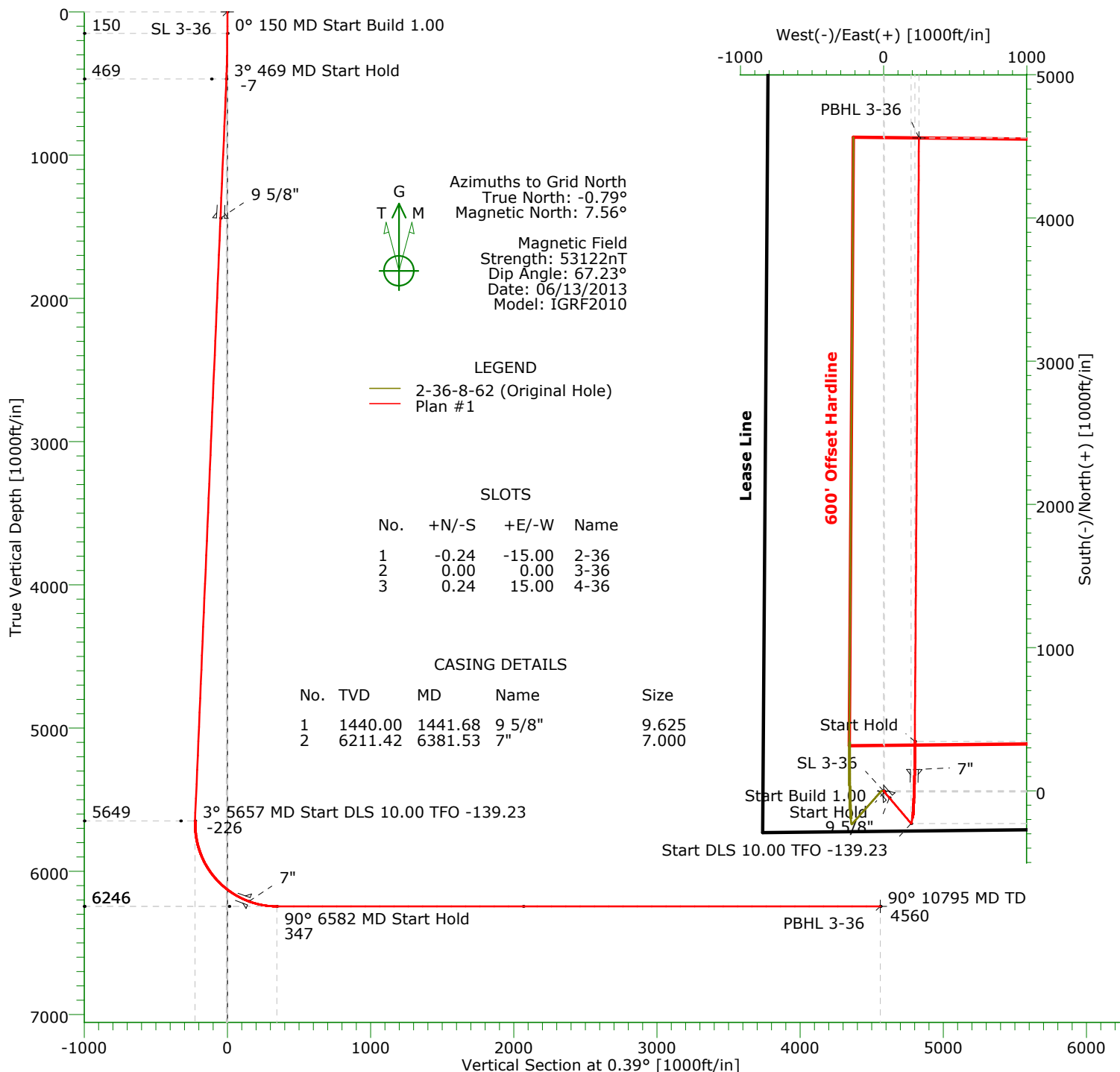

TARGET DETAILS

Name	TVD	+N/-S	+E/-W	Northing	Easting	Latitude	Longitude	Shape
SL 3-36	0.00	0.00	0.00	1467812.45	3340086.27	40°36'39.913N	104°16'30.291W	Point
PBHL 3-36	6246.00	4558.90	247.23	1472371.35	3340333.50	40°37'24.923N	104°16'26.268W	Point

SECTION DETAILS

Sec	MD	Inc	Azi	TVD	+N/-S	+E/-W	DLeg	TFace	VSec	Target
1	0.00	0.00	0.00	0.00	0.00	0.00	0.00	0.00	0.00	
2	150.00	0.00	0.00	150.00	0.00	0.00	0.00	0.00	0.00	
3	469.38	3.19	139.66	469.21	-6.78	5.76	1.00	0.00	-6.74	
4	5657.47	3.19	139.66	5649.25	-227.11	192.86	0.00	0.00	-225.79	
5	6581.67	90.00	0.39	6246.00	345.18	218.49	10.00	-139.23	346.66	
6	10795.49	90.00	0.39	6246.00	4558.90	247.23	0.00	0.00	4560.48	PBHL 3-36

Precision Directional Services, Inc.

Planning Report

Company: CARRIZO OIL & GAS, INC. Field: Niobrara CONZ'83 Site: Bob White 2-36-8-62 Pad Well: 3-36-8-62 Wellpath: Original Hole	Date: 06/17/2013 Co-ordinate(NE) Reference: Well: 3-36-8-62, Grid North Vertical (TVD) Reference: 4939'GL+17'KB 4956.0 Section (VS) Reference: Well (0.00N,0.00E,0.39Azi) Plan: Plan #1	Time: 12:54:28 Page: 1
---	--	---

Field: Niobrara CONZ'83 Map System: US State Plane Coordinate System 1983 Geo Datum: GRS 1980 Sys Datum: Mean Sea Level	Map Zone: Colorado, Northern Zone Coordinate System: Well Centre Geomagnetic Model: IGRF2010
--	---

Site: Bob White 2-36-8-62 Pad			
Weld County			
Site Position:	Northing: 1467812.21 ft	Latitude: 40 36 39.912 N	
From: Map	Easting: 3340071.27 ft	Longitude: 104 16 30.485 W	
Position Uncertainty: 0.00 ft		North Reference: Grid	
Ground Level: 4939.00 ft		Grid Convergence: 0.79 deg	

Well: 3-36-8-62 centered on 2-36	Slot Name: 3-36
Well Position: +N/-S 0.24 ft	Northing: 1467812.45 ft
+E/-W 15.00 ft	Latitude: 40 36 39.913 N
Position Uncertainty: 0.00 ft	Easting : 3340086.27 ft
	Longitude: 104 16 30.291 W

Wellpath: Original Hole	Drilled From: Surface
Current Datum: 4939'GL+17'KB	Tie-on Depth: 0.00 ft
Magnetic Data: 06/13/2013	Above System Datum: Mean Sea Level
Field Strength: 53122 nT	Declination: 8.35 deg
Vertical Section: Depth From (TVD)	Mag Dip Angle: 67.23 deg
ft	+N/-S
	+E/-W
	Direction
	deg
0.00	0.00
	0.00
	0.39

Plan: Plan #1	Date Composed: 06/13/2013
Principal: No	Version: 1
	Tied-to: From Surface

Plan Section Information										
MD ft	Incl deg	Azim deg	TVD ft	+N/-S ft	+E/-W ft	DLS deg/100ft	Build deg/100ft	Turn deg/100ft	TFO deg	Target
0.00	0.00	0.00	0.00	0.00	0.00	0.00	0.00	0.00	0.00	
150.00	0.00	0.00	150.00	0.00	0.00	0.00	0.00	0.00	0.00	
469.38	3.19	139.66	469.21	-6.78	5.76	1.00	1.00	0.00	0.00	
5657.47	3.19	139.66	5649.25	-227.11	192.86	0.00	0.00	0.00	0.00	
6581.67	90.00	0.39	6246.00	345.18	218.49	10.00	9.39	-15.07	-139.23	
10795.49	90.00	0.39	6246.00	4558.90	247.23	0.00	0.00	0.00	0.00	PBHL 3-36

Survey										
MD ft	Incl deg	Azim deg	TVD ft	+N/-S ft	+E/-W ft	VS ft	DLS deg/100ft	Build deg/100ft	Turn deg/100ft	Tool/Comment
0.00	0.00	0.00	0.00	0.00	0.00	0.00	0.00	0.00	0.00	
100.00	0.00	0.00	100.00	0.00	0.00	0.00	0.00	0.00	0.00	
150.00	0.00	0.00	150.00	0.00	0.00	0.00	0.00	0.00	0.00	
200.00	0.50	139.66	200.00	-0.17	0.14	-0.17	1.00	1.00	0.00	
300.00	1.50	139.66	299.98	-1.50	1.27	-1.49	1.00	1.00	0.00	
400.00	2.50	139.66	399.92	-4.16	3.53	-4.13	1.00	1.00	0.00	
469.38	3.19	139.66	469.21	-6.78	5.76	-6.74	1.00	1.00	0.00	
500.00	3.19	139.66	499.79	-8.08	6.86	-8.04	0.00	0.00	0.00	
600.00	3.19	139.66	599.63	-12.33	10.47	-12.26	0.00	0.00	0.00	
700.00	3.19	139.66	699.48	-16.58	14.08	-16.48	0.00	0.00	0.00	
800.00	3.19	139.66	799.32	-20.82	17.68	-20.70	0.00	0.00	0.00	
900.00	3.19	139.66	899.17	-25.07	21.29	-24.92	0.00	0.00	0.00	
1000.00	3.19	139.66	999.01	-29.32	24.90	-29.15	0.00	0.00	0.00	
1100.00	3.19	139.66	1098.86	-33.56	28.50	-33.37	0.00	0.00	0.00	
1200.00	3.19	139.66	1198.70	-37.81	32.11	-37.59	0.00	0.00	0.00	

Precision Directional Services, Inc.

Planning Report

Company: CARRIZO OIL & GAS, INC.
Field: Niobrara CONZ'83
Site: Bob White 2-36-8-62 Pad
Well: 3-36-8-62
Wellpath: Original Hole

Date: 06/17/2013
Co-ordinate(NE) Reference: Well: 3-36-8-62, Grid North
Vertical (TVD) Reference: 4939'GL+17'KB 4956.0
Section (VS) Reference: Well (0.00N,0.00E,0.39Azi)
Plan: Plan #1

Page: 2

Survey

MD ft	Incl deg	Azim deg	TVD ft	+N/-S ft	+E/-W ft	VS ft	DLS deg/100ft	Build deg/100ft	Turn deg/100ft	Tool/Comment
1300.00	3.19	139.66	1298.54	-42.06	35.72	-41.81	0.00	0.00	0.00	9 5/8"
1400.00	3.19	139.66	1398.39	-46.30	39.32	-46.04	0.00	0.00	0.00	
1441.68	3.19	139.66	1440.00	-48.07	40.82	-47.79	0.00	0.00	0.00	
1500.00	3.19	139.66	1498.23	-50.55	42.93	-50.26	0.00	0.00	0.00	
1600.00	3.19	139.66	1598.08	-54.80	46.53	-54.48	0.00	0.00	0.00	
1700.00	3.19	139.66	1697.92	-59.04	50.14	-58.70	0.00	0.00	0.00	
1800.00	3.19	139.66	1797.77	-63.29	53.75	-62.92	0.00	0.00	0.00	
1900.00	3.19	139.66	1897.61	-67.54	57.35	-67.15	0.00	0.00	0.00	
2000.00	3.19	139.66	1997.46	-71.78	60.96	-71.37	0.00	0.00	0.00	
2100.00	3.19	139.66	2097.30	-76.03	64.57	-75.59	0.00	0.00	0.00	
2200.00	3.19	139.66	2197.15	-80.28	68.17	-79.81	0.00	0.00	0.00	
2300.00	3.19	139.66	2296.99	-84.52	71.78	-84.03	0.00	0.00	0.00	
2400.00	3.19	139.66	2396.84	-88.77	75.38	-88.26	0.00	0.00	0.00	
2500.00	3.19	139.66	2496.68	-93.02	78.99	-92.48	0.00	0.00	0.00	
2600.00	3.19	139.66	2596.53	-97.26	82.60	-96.70	0.00	0.00	0.00	
2700.00	3.19	139.66	2696.37	-101.51	86.20	-100.92	0.00	0.00	0.00	
2800.00	3.19	139.66	2796.21	-105.76	89.81	-105.14	0.00	0.00	0.00	
2900.00	3.19	139.66	2896.06	-110.00	93.42	-109.37	0.00	0.00	0.00	
3000.00	3.19	139.66	2995.90	-114.25	97.02	-113.59	0.00	0.00	0.00	
3100.00	3.19	139.66	3095.75	-118.50	100.63	-117.81	0.00	0.00	0.00	
3200.00	3.19	139.66	3195.59	-122.74	104.24	-122.03	0.00	0.00	0.00	
3300.00	3.19	139.66	3295.44	-126.99	107.84	-126.25	0.00	0.00	0.00	
3400.00	3.19	139.66	3395.28	-131.24	111.45	-130.48	0.00	0.00	0.00	
3500.00	3.19	139.66	3495.13	-135.48	115.05	-134.70	0.00	0.00	0.00	
3600.00	3.19	139.66	3594.97	-139.73	118.66	-138.92	0.00	0.00	0.00	
3700.00	3.19	139.66	3694.82	-143.98	122.27	-143.14	0.00	0.00	0.00	
3800.00	3.19	139.66	3794.66	-148.22	125.87	-147.36	0.00	0.00	0.00	
3900.00	3.19	139.66	3894.51	-152.47	129.48	-151.59	0.00	0.00	0.00	
4000.00	3.19	139.66	3994.35	-156.72	133.09	-155.81	0.00	0.00	0.00	
4100.00	3.19	139.66	4094.20	-160.96	136.69	-160.03	0.00	0.00	0.00	
4200.00	3.19	139.66	4194.04	-165.21	140.30	-164.25	0.00	0.00	0.00	
4300.00	3.19	139.66	4293.88	-169.46	143.90	-168.47	0.00	0.00	0.00	
4400.00	3.19	139.66	4393.73	-173.70	147.51	-172.70	0.00	0.00	0.00	
4500.00	3.19	139.66	4493.57	-177.95	151.12	-176.92	0.00	0.00	0.00	
4600.00	3.19	139.66	4593.42	-182.20	154.72	-181.14	0.00	0.00	0.00	
4700.00	3.19	139.66	4693.26	-186.44	158.33	-185.36	0.00	0.00	0.00	
4800.00	3.19	139.66	4793.11	-190.69	161.94	-189.58	0.00	0.00	0.00	
4900.00	3.19	139.66	4892.95	-194.94	165.54	-193.81	0.00	0.00	0.00	
5000.00	3.19	139.66	4992.80	-199.18	169.15	-198.03	0.00	0.00	0.00	
5100.00	3.19	139.66	5092.64	-203.43	172.76	-202.25	0.00	0.00	0.00	
5200.00	3.19	139.66	5192.49	-207.68	176.36	-206.47	0.00	0.00	0.00	
5300.00	3.19	139.66	5292.33	-211.92	179.97	-210.69	0.00	0.00	0.00	
5400.00	3.19	139.66	5392.18	-216.17	183.57	-214.92	0.00	0.00	0.00	
5500.00	3.19	139.66	5492.02	-220.42	187.18	-219.14	0.00	0.00	0.00	
5600.00	3.19	139.66	5591.87	-224.66	190.79	-223.36	0.00	0.00	0.00	
5657.47	3.19	139.66	5649.25	-227.11	192.86	-225.79	0.00	0.00	0.00	
5700.00	2.78	49.05	5691.74	-227.33	194.40	-226.01	10.00	-0.98	-213.05	
5800.00	12.01	10.24	5790.84	-215.48	198.09	-214.12	10.00	9.24	-38.81	
5900.00	21.93	5.58	5886.37	-186.58	201.77	-185.20	10.00	9.91	-4.66	
6000.00	31.89	3.74	5975.43	-141.52	205.32	-140.12	10.00	9.97	-1.84	
6100.00	41.88	2.72	6055.31	-81.67	208.64	-80.25	10.00	9.98	-1.03	7"
6200.00	51.86	2.03	6123.59	-8.84	211.62	-7.40	10.00	9.99	-0.69	
6300.00	61.85	1.51	6178.19	74.74	214.18	76.20	10.00	9.99	-0.52	
6381.53	70.00	1.15	6211.42	149.10	215.89	150.57	10.00	9.99	-0.44	

Precision Directional Services, Inc.

Planning Report

Company: CARRIZO OIL & GAS, INC.
Field: Niobrara CONZ'83
Site: Bob White 2-36-8-62 Pad
Well: 3-36-8-62
Wellpath: Original Hole

Date: 06/17/2013
Co-ordinate(NE) Reference: Well: 3-36-8-62, Grid North
Vertical (TVD) Reference: 4939'GL+17'KB 4956.0
Section (VS) Reference: Well (0.00N,0.00E,0.39Azi)
Plan: Plan #1

Page: 3

Survey

MD ft	Incl deg	Azim deg	TVD ft	+N/-S ft	+E/-W ft	VS ft	DLS deg/100ft	Build deg/100ft	Turn deg/100ft	Tool/Comment
6400.00	71.85	1.07	6217.46	166.55	216.23	168.02	10.00	9.99	-0.41	
6500.00	81.84	0.69	6240.19	263.79	217.72	265.27	10.00	9.99	-0.38	
6581.67	90.00	0.39	6246.00	345.18	218.49	346.66	10.00	9.99	-0.37	
6600.00	90.00	0.39	6246.00	363.51	218.62	364.99	0.00	0.00	0.00	
6700.00	90.00	0.39	6246.00	463.51	219.30	464.99	0.00	0.00	0.00	
6800.00	90.00	0.39	6246.00	563.51	219.98	564.99	0.00	0.00	0.00	
6900.00	90.00	0.39	6246.00	663.50	220.66	664.99	0.00	0.00	0.00	
7000.00	90.00	0.39	6246.00	763.50	221.34	764.99	0.00	0.00	0.00	
7100.00	90.00	0.39	6246.00	863.50	222.03	864.99	0.00	0.00	0.00	
7200.00	90.00	0.39	6246.00	963.50	222.71	964.99	0.00	0.00	0.00	
7300.00	90.00	0.39	6246.00	1063.49	223.39	1064.99	0.00	0.00	0.00	
7400.00	90.00	0.39	6246.00	1163.49	224.07	1164.99	0.00	0.00	0.00	
7500.00	90.00	0.39	6246.00	1263.49	224.75	1264.99	0.00	0.00	0.00	
7600.00	90.00	0.39	6246.00	1363.49	225.44	1364.99	0.00	0.00	0.00	
7700.00	90.00	0.39	6246.00	1463.49	226.12	1464.99	0.00	0.00	0.00	
7800.00	90.00	0.39	6246.00	1563.48	226.80	1564.99	0.00	0.00	0.00	
7900.00	90.00	0.39	6246.00	1663.48	227.48	1664.99	0.00	0.00	0.00	
8000.00	90.00	0.39	6246.00	1763.48	228.16	1764.99	0.00	0.00	0.00	
8100.00	90.00	0.39	6246.00	1863.48	228.85	1864.99	0.00	0.00	0.00	
8200.00	90.00	0.39	6246.00	1963.47	229.53	1964.99	0.00	0.00	0.00	
8300.00	90.00	0.39	6246.00	2063.47	230.21	2064.99	0.00	0.00	0.00	
8400.00	90.00	0.39	6246.00	2163.47	230.89	2164.99	0.00	0.00	0.00	
8500.00	90.00	0.39	6246.00	2263.47	231.57	2264.99	0.00	0.00	0.00	
8600.00	90.00	0.39	6246.00	2363.46	232.26	2364.99	0.00	0.00	0.00	
8700.00	90.00	0.39	6246.00	2463.46	232.94	2464.99	0.00	0.00	0.00	
8800.00	90.00	0.39	6246.00	2563.46	233.62	2564.99	0.00	0.00	0.00	
8900.00	90.00	0.39	6246.00	2663.46	234.30	2664.99	0.00	0.00	0.00	
9000.00	90.00	0.39	6246.00	2763.46	234.98	2764.99	0.00	0.00	0.00	
9100.00	90.00	0.39	6246.00	2863.45	235.67	2864.99	0.00	0.00	0.00	
9200.00	90.00	0.39	6246.00	2963.45	236.35	2964.99	0.00	0.00	0.00	
9300.00	90.00	0.39	6246.00	3063.45	237.03	3064.99	0.00	0.00	0.00	
9400.00	90.00	0.39	6246.00	3163.45	237.71	3164.99	0.00	0.00	0.00	
9500.00	90.00	0.39	6246.00	3263.44	238.39	3264.99	0.00	0.00	0.00	
9600.00	90.00	0.39	6246.00	3363.44	239.08	3364.99	0.00	0.00	0.00	
9700.00	90.00	0.39	6246.00	3463.44	239.76	3464.99	0.00	0.00	0.00	
9800.00	90.00	0.39	6246.00	3563.44	240.44	3564.99	0.00	0.00	0.00	
9900.00	90.00	0.39	6246.00	3663.43	241.12	3664.99	0.00	0.00	0.00	
10000.00	90.00	0.39	6246.00	3763.43	241.80	3764.99	0.00	0.00	0.00	
10100.00	90.00	0.39	6246.00	3863.43	242.49	3864.99	0.00	0.00	0.00	
10200.00	90.00	0.39	6246.00	3963.43	243.17	3964.99	0.00	0.00	0.00	
10300.00	90.00	0.39	6246.00	4063.43	243.85	4064.99	0.00	0.00	0.00	
10400.00	90.00	0.39	6246.00	4163.42	244.53	4164.99	0.00	0.00	0.00	
10500.00	90.00	0.39	6246.00	4263.42	245.21	4264.99	0.00	0.00	0.00	
10600.00	90.00	0.39	6246.00	4363.42	245.90	4364.99	0.00	0.00	0.00	
10700.00	90.00	0.39	6246.00	4463.42	246.58	4464.99	0.00	0.00	0.00	
10795.49	90.00	0.39	6246.00	4558.90	247.23	4560.48	0.00	0.00	0.00	PBHL 3-36

Targets

Name	Description Dip.	Dir.	TVD ft	+N/-S ft	+E/-W ft	Map Northing ft	Map Easting ft	<--- Latitude ---> Deg Min Sec			<--- Longitude ---> Deg Min Sec		
SL 3-36			0.00	0.00	0.00	1467812.45	3340086.27	40	36	39.913 N	104	16	30.291 W
PBHL 3-36			6246.00	4558.90	247.23	1472371.35	3340333.50	40	37	24.923 N	104	16	26.268 W

Precision Directional Services, Inc.

Planning Report

Company: CARRIZO OIL & GAS, INC.
Field: Niobrara CONZ'83
Site: Bob White 2-36-8-62 Pad
Well: 3-36-8-62
Wellpath: Original Hole

Date: 06/17/2013
Co-ordinate(NE) Reference: Well: 3-36-8-62, Grid North
Vertical (TVD) Reference: 4939'GL+17'KB 4956.0
Section (VS) Reference: Well (0.00N,0.00E,0.39Azi)
Plan: Plan #1

Page: 4

Targets

Name	Description Dip.	Dir.	TVD ft	+N/-S ft	+E/-W ft	Map Northing ft	Map Easting ft	<---- Latitude ---->			<--- Longitude --->		
								Deg	Min	Sec	Deg	Min	Sec

Casing Points

MD ft	TVD ft	Diameter in	Hole Size in	Name
1441.68	1440.00	9.625	12.250	9 5/8"
6381.53	6211.42	7.000	8.500	7"