

# LEGEND:

PROPOSED LOCATION

## AXIA ENERGY

BULLDOG #10-24V-890, #10-34H-890, #10-24H-890,  
 #15-21H-890 & #15-11H-890  
 SECTION 15, T8N, R90W, 6th P.M.  
 LOT 2



Uintah Engineering & Land Surveying  
 85 South 200 East Vernal, Utah 84078  
 (435) 789-1017 \* FAX (435) 789-1813



ACCESS ROAD  
 M A P

02 12 13  
 MONTH DAY YEAR

SCALE: 1:100,000 DRAWN BY: C.L. REV: 03-29-13 J.L.H.





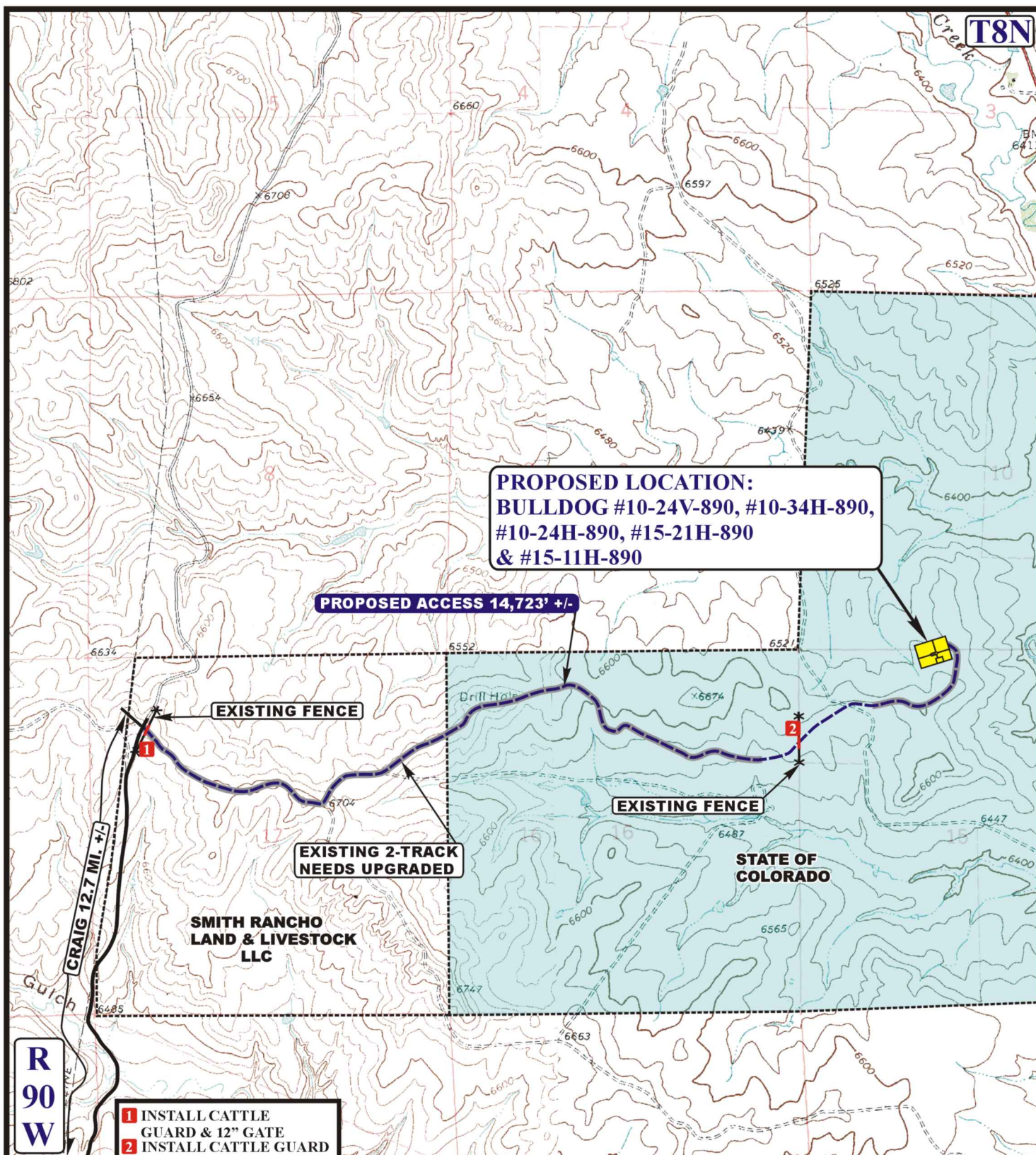

**R  
90  
W**

- 1** INSTALL CATTLE GUARD & 12" GATE  
**2** INSTALL CATTLE GUARD

## LEGEND:

- EXISTING ROAD  
- - - PROPOSED ACCESS ROAD  
- - - EXISTING 2-TRACK NEEDS UPGRADED  
\* \* \* \* \* EXISTING FENCE



## AXIA ENERGY

**BULLDOG #10-24V-890, #10-34H-890, #10-24H-890,  
#15-21H-890 & #15-11H-890  
SECTION 15, T8N, R90W, 6th P.M.  
LOT 2**



**Uintah Engineering & Land Surveying**  
85 South 200 East Vernal, Utah 84078  
(435) 789-1017 \* FAX (435) 789-1813

**ACCESS ROAD  
MAP**

**02 12 13**  
MONTH DAY YEAR

SCALE: 1" = 2000' DRAWN BY: C.L. REV: 03-29-13 J.L.H.

