

# ACCESS AND VICINITY MAP

## Speakman A Pad

### Section 24, Township 7 South, Range 96 West

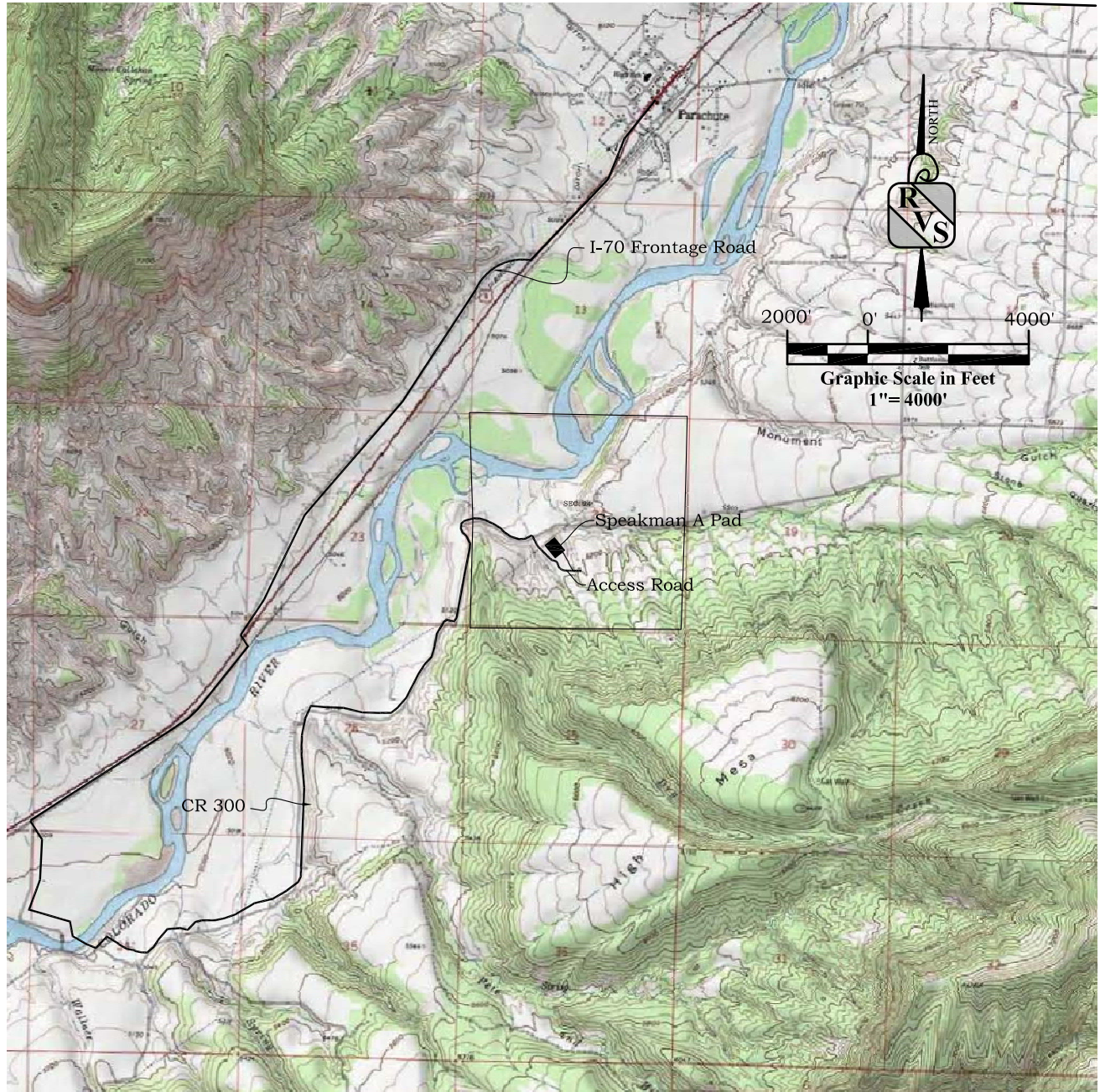

#### **ACCESS:**

WESTERLY FROM THE TOWN OF PARACHUTE ALONG THE I-70 FRONTAGE ROAD 4.5 MILES TO THE UNA BRIDGE TURNOFF (COUNTY ROAD 300). TURN LEFT ON COUNTY ROAD 300 AND PROCEED IN A SOUTHERLY DIRECTION ACROSS THE UNA BRIDGE THEN NORTH AND EAST 4.19 MILES ALONG COUNTY ROAD 300 TO PAD A ACCESS ROAD. TURN RIGHT ON FIELD ACCESS ROAD PROCEED 0.2 MILES TO THE SPEAKMAN A PAD ACCESS ROAD. TURN LEFT AND CONTINUE NORTH 0.1 MILES TO THE SPEAKMAN A PAD SITE.



**River Valley Survey, Inc.**  
110 East 3rd. Street, Suite 213  
Rifle, Colorado 81650  
Ph: 970-379-7846

**Project:** Speakman A Pad

**Field Date:** 08-05-10

**Date:** 09-17-10

**Scale:** 1"= 4000'

**Sheet:** 11 of 11

**Well Location Plat**  
**Prepared For Antero Resources**

**Situate In:**  
SW 1/4 Section 24, T7S., R. 96 W. of the  
6th P.M., Garfield County, Colorado

