

WHITING OIL & GAS CORP.

LOCATION DRAWING FOR

RAZOR #27L-3401B, #27L-3403B, #27L-3404B
ON EXISTING RAZOR #27-3414H
SECTION 27, T10N, R58W, 6th P.M.
NW 1/4 SW 1/4

SCALE: 1" = 200'

DATE: 03-29-13

DRAWN BY: B.D.H.

REVISED: 04-08-13 J.S.



LINE TABLE			LINE TABLE		
LINE	DIRECTION	LENGTH	LINE	DIRECTION	LENGTH
L1	S15°E	129'	L7	S89°W	597'
L2	S10°E	133'	L8	N84°W	119'
L3	S02°E	351'	L9	N39°W	112'
L4	S14°W	242'	L10	N30°E	52'
L5	S53°W	178'	L11	S77°E	151'
L6	S89°W	624'			

PROPOSED #27L-3401B

(NAD 83)
Lat: 40.808881°
Long: 103.858489°

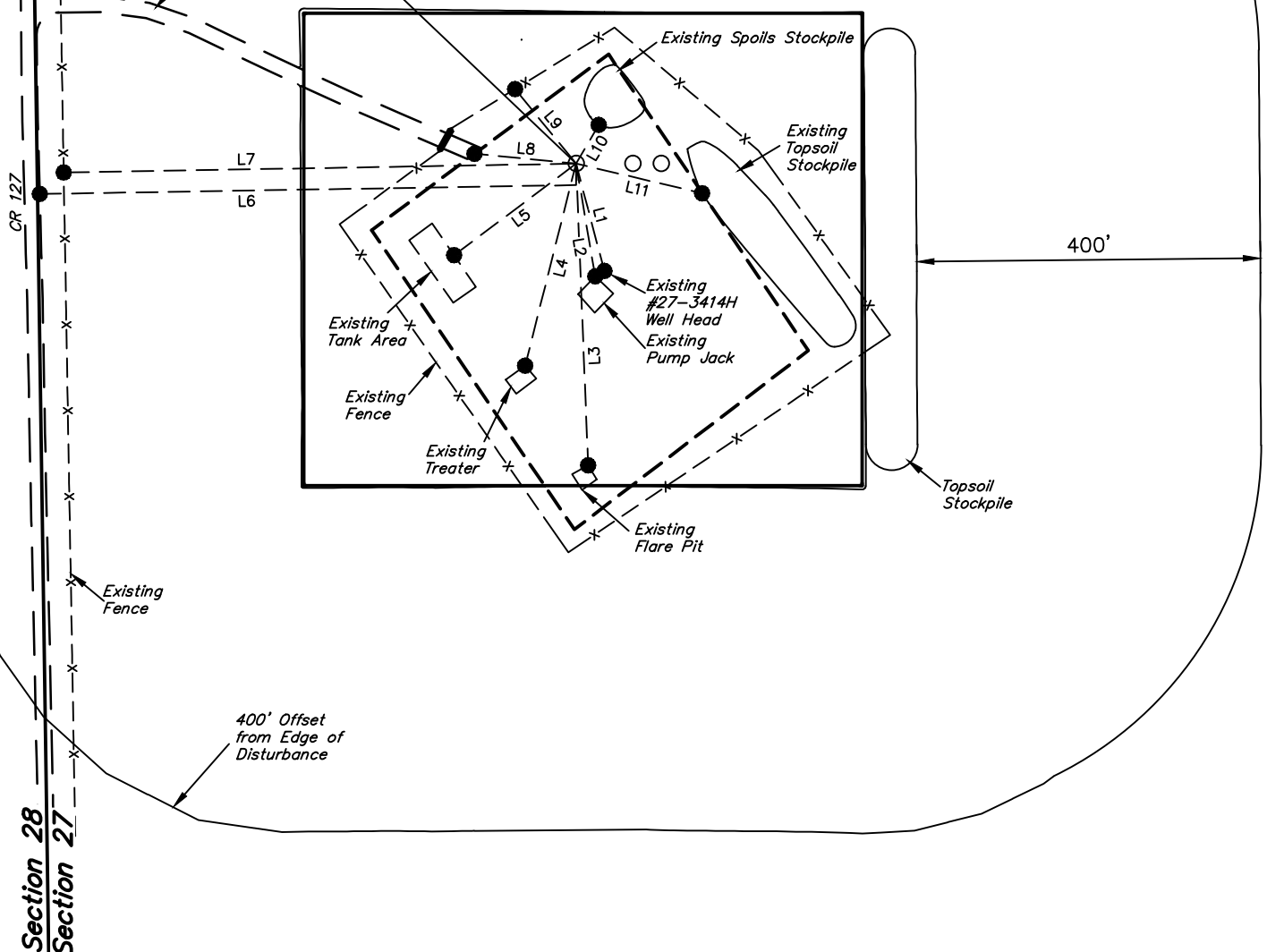

UINTAH ENGINEERING & LAND SURVEYING

85 So. 200 East * Vernal, Utah 84078 * (435) 789-1017