



Physical Address: 345 Comanche St.
Mail to: Box 384, Kiowa, CO 80117
Ph. 303-621-8672 - Fax 303-621-7749
www.highprairiesurvey.com

Job # 13099 Mull UPRC-Hanavan #1 (Re-Entry)

Inv # 2419

High Prairie Surveying of Kiowa, Colorado, in accordance with a request from **Pronghorn Operating LLC**, has determined the location of **Mull UPRC-Hanavan #1 (Re-Entry)** to be **667 feet FSL**, and **1982 feet FWL**, (90° off Section lines) of **SECTION 21**, Township **13s**, Range **44w** of the 6th Principal Meridian, **Cheyenne County**, Colorado.

Date: Staked on 5/14/13 drawn on 6/05/13.

Re:

Staked by Elijah Frane

Drawn:

Drawn by Dustin Cotter

Access Road Map

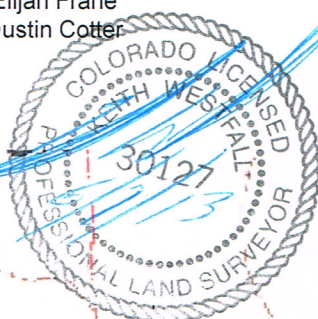

Pronghorn Operating LLC
SW ¼ Sec. 21-13s-44w
Mull UPRC-Hanavan #1 (Re-Entry)
Cheyenne County, Colorado

