



WEXPRO COMPANY

**COLORADO (MOFFAT COUNTY)
SEC. 8 TWP. 11N RGE. 97W 6th P.M.
B.W. MUSSER #43**

ORIGINAL WELLBORE

13 December, 2011

Plan: PROPOSAL #2



Project: COLORADO (MOFFAT COUNTY)
Site: SEC. 8 TWP. 11N RGE. 97W 6th P.M.
Well: B.W. MUSSER #43
Wellbore: ORIGINAL WELLBORE
Design: PROPOSAL #2

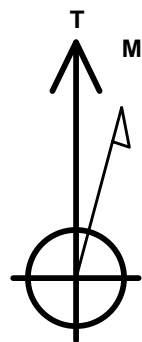
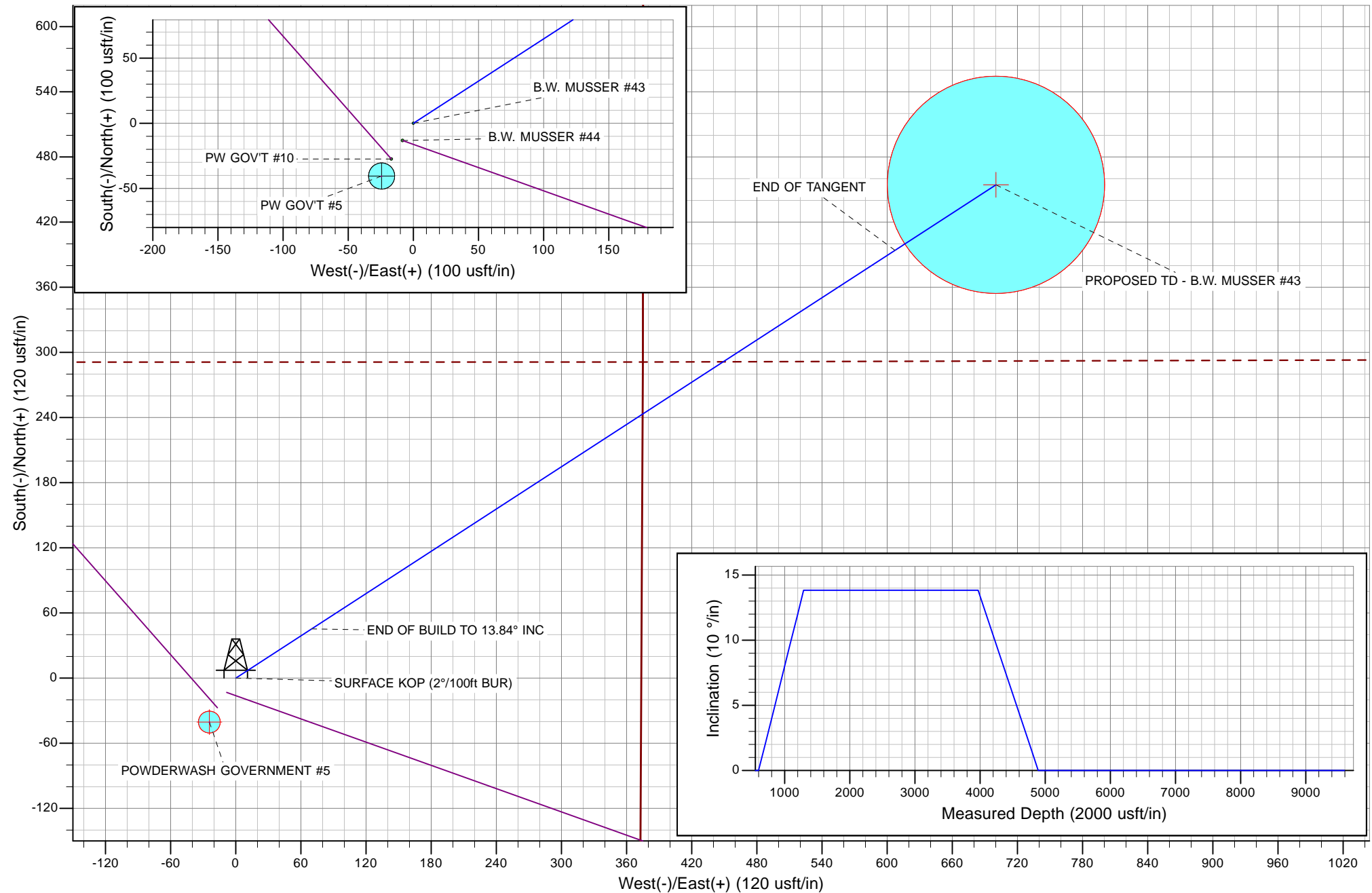
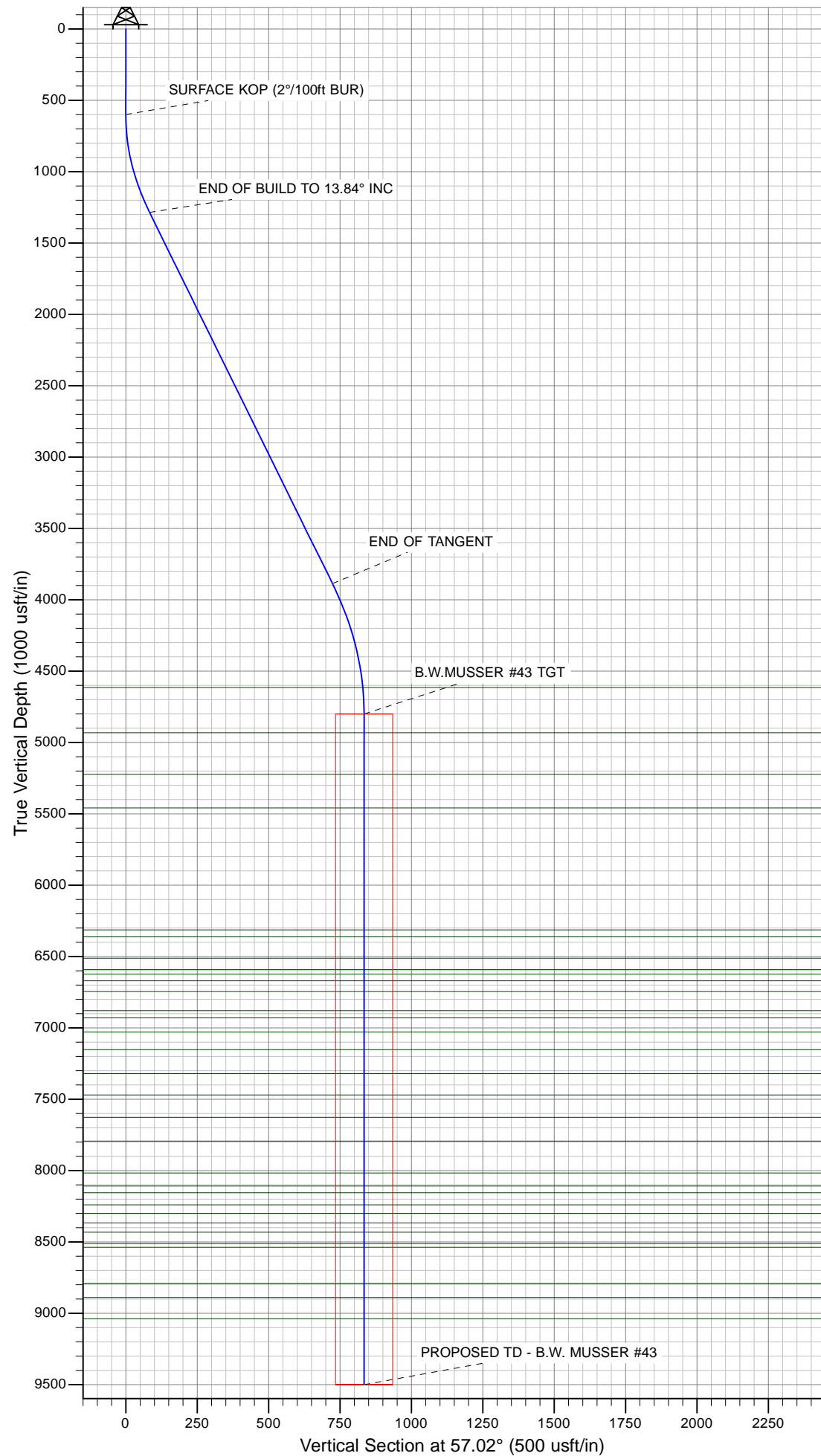

Azimuths to True North
Magnetic North: 10.75°

Magnetic Field
Strength: 53023.2snT
Dip Angle: 66.87°
Date: 09/12/2010
Model: IGRF2010

ANNOTATIONS

TVD	MD	Inc	Azi	+N/-S	+E/-W	VSect	Annotation
600.0	600.0	0.00	0.00	0.0	0.0	0.0	SURFACE KOP (2°/100ft BUR)
1285.2	1291.9	13.84	57.02	45.3	69.8	83.1	END OF BUILD TO 13.84° INC
3886.4	3970.9	13.84	57.02	394.0	607.2	723.9	END OF TANGENT
4800.0	4893.4	0.00	0.00	454.4	700.2	834.7	B.W.MUSSER #43 TGT
9500.0	9593.4	0.00	0.00	454.4	700.2	834.7	PROPOSED TD - B.W. MUSSER #43

Planning Report

Database:	EDM_5000_1_7	Local Co-ordinate Reference:	Well B.W. MUSSER #43
Company:	WEXPRO COMPANY	TVD Reference:	KB-EST @ 6785.0usft (Original Well Elev)
Project:	COLORADO (MOFFAT COUNTY)	MD Reference:	KB-EST @ 6785.0usft (Original Well Elev)
Site:	SEC. 8 TWP. 11N RGE. 97W 6th P.M.	North Reference:	True
Well:	B.W. MUSSER #43	Survey Calculation Method:	Minimum Curvature
Wellbore:	ORIGINAL WELLBORE		
Design:	PROPOSAL #2		

Project	COLORADO (MOFFAT COUNTY)		
Map System:	US State Plane 1983	System Datum:	Mean Sea Level
Geo Datum:	North American Datum 1983		
Map Zone:	Colorado Northern Zone		Using geodetic scale factor

Site	SEC. 8 TWP. 11N RGE. 97W 6th P.M.		
Site Position:		Northing:	1,592,772.28 usft
From:	Lat/Long	Easting:	2,224,268.54 usft
Position Uncertainty:	0.0 usft	Slot Radius:	13-3/16"
		Latitude:	40° 55' 36.530 N
		Longitude:	108° 18' 27.259 W
		Grid Convergence:	-1.81 °

Well	B.W. MUSSER #43		
Well Position	+N-S	67.8 usft	Northing:
	+E-W	11.3 usft	Easting:
Position Uncertainty	0.0 usft		Wellhead Elevation:
			Latitude:
			Longitude:
			Ground Level:

Wellbore	ORIGINAL WELLBORE				
Magnetics	Model Name	Sample Date	Declination (°)	Dip Angle (°)	Field Strength (nT)
	IGRF2010	09/12/2010	10.75	66.87	53,023

Design	PROPOSAL #2				
---------------	-------------	--	--	--	--

Audit Notes:					
Version:	Phase:	PROTOTYPE		Tie On Depth:	0.0
Vertical Section:	Depth From (TVD) (usft)	+N-S (usft)	+E-W (usft)	Direction (°)	
	0.0	0.0	0.0	57.02	

Plan Sections											
MD (usft)	Inc (°)	Azi (°)	Vertical Depth	SS (usft)	+N-S (usft)	+E-W (usft)	Dogleg Rate (°/100usft)	Build Rate (°/100usft)	Turn Rate (°/100usft)	TFO (°)	Target
0.0	0.00	0.00	0.0	-6,785.0	0.0	0.0	0.00	0.00	0.00	0.00	
600.0	0.00	0.00	600.0	-6,185.0	0.0	0.0	0.00	0.00	0.00	0.00	
1,291.9	13.84	57.02	1,285.2	-5,499.8	45.3	69.7	2.00	2.00	0.00	57.02	
3,970.9	13.84	57.02	3,886.5	-2,898.5	394.0	607.2	0.00	0.00	0.00	0.00	
4,893.4	0.00	0.00	4,800.0	-1,985.0	454.4	700.2	1.50	-1.50	0.00	180.00	B.W. MUSSER #43
9,593.4	0.00	0.00	9,500.0	2,715.0	454.4	700.2	0.00	0.00	0.00	0.00	

Planning Report

Database:	EDM_5000_1_7	Local Co-ordinate Reference:	Well B.W. MUSSER #43
Company:	WEXPRO COMPANY	TVD Reference:	KB-EST @ 6785.0usft (Original Well Elev)
Project:	COLORADO (MOFFAT COUNTY)	MD Reference:	KB-EST @ 6785.0usft (Original Well Elev)
Site:	SEC. 8 TWP. 11N RGE. 97W 6th P.M.	North Reference:	True
Well:	B.W. MUSSER #43	Survey Calculation Method:	Minimum Curvature
Wellbore:	ORIGINAL WELLBORE		
Design:	PROPOSAL #2		

Planned Survey										
MD (usft)	Inc (°)	Azi (°)	TVD (usft)	SS (usft)	+N/-S (usft)	+E/-W (usft)	Vertical Section (usft)	Dogleg Rate (°/100usft)	Build Rate (°/100usft)	Turn Rate (°/100usft)
0.0	0.00	0.00	0.0	6,785.00	0.0	0.0	0.0	0.00	0.00	0.00
100.0	0.00	0.00	100.0	6,685.00	0.0	0.0	0.0	0.00	0.00	0.00
200.0	0.00	0.00	200.0	6,585.00	0.0	0.0	0.0	0.00	0.00	0.00
300.0	0.00	0.00	300.0	6,485.00	0.0	0.0	0.0	0.00	0.00	0.00
400.0	0.00	0.00	400.0	6,385.00	0.0	0.0	0.0	0.00	0.00	0.00
500.0	0.00	0.00	500.0	6,285.00	0.0	0.0	0.0	0.00	0.00	0.00
SURFACE KOP (2°/100ft BUR)										
600.0	0.00	0.00	600.0	6,185.00	0.0	0.0	0.0	0.00	0.00	0.00
700.0	2.00	57.02	700.0	6,085.02	0.9	1.5	1.7	2.00	2.00	0.00
800.0	4.00	57.02	799.8	5,985.16	3.8	5.9	7.0	2.00	2.00	0.00
900.0	6.00	57.02	899.5	5,885.55	8.5	13.2	15.7	2.00	2.00	0.00
1,000.0	8.00	57.02	998.7	5,786.30	15.2	23.4	27.9	2.00	2.00	0.00
1,100.0	10.00	57.02	1,097.5	5,687.53	23.7	36.5	43.5	2.00	2.00	0.00
1,200.0	12.00	57.02	1,195.6	5,589.38	34.1	52.5	62.6	2.00	2.00	0.00
END OF BUILD TO 13.84° INC										
1,291.9	13.84	57.02	1,285.2	5,499.81	45.3	69.8	83.1	2.00	2.00	0.00
1,300.0	13.84	57.02	1,293.1	5,491.94	46.3	71.4	85.1	0.00	0.00	0.00
1,400.0	13.84	57.02	1,390.2	5,394.84	59.3	91.4	109.0	0.00	0.00	0.00
1,500.0	13.84	57.02	1,487.3	5,297.75	72.3	111.5	132.9	0.00	0.00	0.00
1,600.0	13.84	57.02	1,584.4	5,200.65	85.4	131.6	156.8	0.00	0.00	0.00
1,700.0	13.84	57.02	1,681.4	5,103.55	98.4	151.6	180.8	0.00	0.00	0.00
1,800.0	13.84	57.02	1,778.5	5,006.45	111.4	171.7	204.7	0.00	0.00	0.00
1,900.0	13.84	57.02	1,875.6	4,909.35	124.4	191.8	228.6	0.00	0.00	0.00
2,000.0	13.84	57.02	1,972.7	4,812.26	137.4	211.8	252.5	0.00	0.00	0.00
2,100.0	13.84	57.02	2,069.8	4,715.16	150.5	231.9	276.4	0.00	0.00	0.00
2,200.0	13.84	57.02	2,166.9	4,618.06	163.5	251.9	300.3	0.00	0.00	0.00
2,300.0	13.84	57.02	2,264.0	4,520.96	176.5	272.0	324.2	0.00	0.00	0.00
2,400.0	13.84	57.02	2,361.1	4,423.86	189.5	292.1	348.2	0.00	0.00	0.00
2,500.0	13.84	57.02	2,458.2	4,326.77	202.5	312.1	372.1	0.00	0.00	0.00
2,600.0	13.84	57.02	2,555.3	4,229.67	215.5	332.2	396.0	0.00	0.00	0.00
2,700.0	13.84	57.02	2,652.4	4,132.57	228.6	352.3	419.9	0.00	0.00	0.00
2,800.0	13.84	57.02	2,749.5	4,035.47	241.6	372.3	443.8	0.00	0.00	0.00
2,900.0	13.84	57.02	2,846.6	3,938.37	254.6	392.4	467.7	0.00	0.00	0.00
3,000.0	13.84	57.02	2,943.7	3,841.28	267.6	412.4	491.7	0.00	0.00	0.00
3,100.0	13.84	57.02	3,040.8	3,744.18	280.6	432.5	515.6	0.00	0.00	0.00
3,200.0	13.84	57.02	3,137.9	3,647.08	293.7	452.6	539.5	0.00	0.00	0.00
3,300.0	13.84	57.02	3,235.0	3,549.98	306.7	472.6	563.4	0.00	0.00	0.00
3,400.0	13.84	57.02	3,332.1	3,452.89	319.7	492.7	587.3	0.00	0.00	0.00
3,500.0	13.84	57.02	3,429.2	3,355.79	332.7	512.8	611.2	0.00	0.00	0.00
3,600.0	13.84	57.02	3,526.3	3,258.69	345.7	532.8	635.2	0.00	0.00	0.00
3,700.0	13.84	57.02	3,623.4	3,161.59	358.7	552.9	659.1	0.00	0.00	0.00
3,800.0	13.84	57.02	3,720.5	3,064.49	371.8	572.9	683.0	0.00	0.00	0.00
3,900.0	13.84	57.02	3,817.6	2,967.40	384.8	593.0	706.9	0.00	0.00	0.00
END OF TANGENT										
3,970.9	13.84	57.02	3,886.4	2,898.55	394.0	607.2	723.9	0.00	0.00	0.00
4,000.0	13.40	57.02	3,914.7	2,870.27	397.7	613.0	730.7	1.50	-1.50	0.00
4,100.0	11.90	57.02	4,012.3	2,772.70	409.7	631.4	752.6	1.50	-1.50	0.00
4,200.0	10.40	57.02	4,110.4	2,674.59	420.2	647.6	772.0	1.50	-1.50	0.00
4,300.0	8.90	57.02	4,209.0	2,576.01	429.3	661.6	788.7	1.50	-1.50	0.00
4,400.0	7.40	57.02	4,308.0	2,477.02	437.0	673.5	802.9	1.50	-1.50	0.00
4,500.0	5.90	57.02	4,407.3	2,377.70	443.3	683.2	814.5	1.50	-1.50	0.00
4,600.0	4.40	57.02	4,506.9	2,278.11	448.2	690.8	823.5	1.50	-1.50	0.00
4,700.0	2.90	57.02	4,606.7	2,178.31	451.7	696.1	829.8	1.50	-1.50	0.00

Planning Report

Database:	EDM_5000_1_7	Local Co-ordinate Reference:	Well B.W. MUSSER #43
Company:	WEXPRO COMPANY	TVD Reference:	KB-EST @ 6785.0usft (Original Well Elev)
Project:	COLORADO (MOFFAT COUNTY)	MD Reference:	KB-EST @ 6785.0usft (Original Well Elev)
Site:	SEC. 8 TWP. 11N RGE. 97W 6th P.M.	North Reference:	True
Well:	B.W. MUSSER #43	Survey Calculation Method:	Minimum Curvature
Wellbore:	ORIGINAL WELLBORE		
Design:	PROPOSAL #2		

Planned Survey

MD (usft)	Inc (°)	Azi (°)	TVD (usft)	SS (usft)	+N/-S (usft)	+E/-W (usft)	Vertical Section (usft)	Dogleg Rate (°/100usft)	Build Rate (°/100usft)	Turn Rate (°/100usft)
A-4-G SD										
4,708.3	2.78	57.02	4,615.0	2,170.00	451.9	696.5	830.2	1.50	-1.50	0.00
4,800.0	1.40	57.02	4,706.6	2,078.39	453.7	699.3	833.6	1.50	-1.50	0.00
B.W.MUSSER #43 TGT										
4,893.4	0.00	0.00	4,800.0	1,984.99	454.4	700.2	834.7	1.50	-1.50	0.00
4,900.0	0.00	0.00	4,806.6	1,978.39	454.4	700.2	834.7	0.00	0.00	0.00
5,000.0	0.00	0.00	4,906.6	1,878.39	454.4	700.2	834.7	0.00	0.00	0.00
(BIG WATER SD)										
5,024.4	0.00	0.00	4,931.0	1,854.00	454.4	700.2	834.7	0.00	0.00	0.00
5,100.0	0.00	0.00	5,006.6	1,778.39	454.4	700.2	834.7	0.00	0.00	0.00
5,200.0	0.00	0.00	5,106.6	1,678.39	454.4	700.2	834.7	0.00	0.00	0.00
5,300.0	0.00	0.00	5,206.6	1,578.39	454.4	700.2	834.7	0.00	0.00	0.00
A-4-H SD										
5,316.4	0.00	0.00	5,223.0	1,562.00	454.4	700.2	834.7	0.00	0.00	0.00
5,400.0	0.00	0.00	5,306.6	1,478.39	454.4	700.2	834.7	0.00	0.00	0.00
5,500.0	0.00	0.00	5,406.6	1,378.39	454.4	700.2	834.7	0.00	0.00	0.00
FORT UNION FORMATION										
5,551.4	0.00	0.00	5,458.0	1,327.00	454.4	700.2	834.7	0.00	0.00	0.00
5,600.0	0.00	0.00	5,506.6	1,278.39	454.4	700.2	834.7	0.00	0.00	0.00
5,700.0	0.00	0.00	5,606.6	1,178.39	454.4	700.2	834.7	0.00	0.00	0.00
5,800.0	0.00	0.00	5,706.6	1,078.39	454.4	700.2	834.7	0.00	0.00	0.00
5,900.0	0.00	0.00	5,806.6	978.39	454.4	700.2	834.7	0.00	0.00	0.00
6,000.0	0.00	0.00	5,906.6	878.39	454.4	700.2	834.7	0.00	0.00	0.00
6,100.0	0.00	0.00	6,006.6	778.39	454.4	700.2	834.7	0.00	0.00	0.00
6,200.0	0.00	0.00	6,106.6	678.39	454.4	700.2	834.7	0.00	0.00	0.00
6,300.0	0.00	0.00	6,206.6	578.39	454.4	700.2	834.7	0.00	0.00	0.00
6,400.0	0.00	0.00	6,306.6	478.39	454.4	700.2	834.7	0.00	0.00	0.00
L.F.U. ALLEN 8A										
6,406.4	0.00	0.00	6,313.0	472.00	454.4	700.2	834.7	0.00	0.00	0.00
L.F.U. ALLEN 8B										
6,454.4	0.00	0.00	6,361.0	424.00	454.4	700.2	834.7	0.00	0.00	0.00
6,500.0	0.00	0.00	6,406.6	378.39	454.4	700.2	834.7	0.00	0.00	0.00
6,600.0	0.00	0.00	6,506.6	278.39	454.4	700.2	834.7	0.00	0.00	0.00
L.F.U. ALLEN 8E										
6,604.4	0.00	0.00	6,511.0	274.00	454.4	700.2	834.7	0.00	0.00	0.00
L.F.U. ALLEN 8E1										
6,684.4	0.00	0.00	6,591.0	194.00	454.4	700.2	834.7	0.00	0.00	0.00
6,700.0	0.00	0.00	6,606.6	178.39	454.4	700.2	834.7	0.00	0.00	0.00
L.F.U. ALLEN 8F										
6,716.4	0.00	0.00	6,623.0	162.00	454.4	700.2	834.7	0.00	0.00	0.00
L.F.U. ALLEN 8G										
6,763.4	0.00	0.00	6,670.0	115.00	454.4	700.2	834.7	0.00	0.00	0.00
6,800.0	0.00	0.00	6,706.6	78.39	454.4	700.2	834.7	0.00	0.00	0.00
L.F.U. ALLEN 8H										
6,838.4	0.00	0.00	6,745.0	40.00	454.4	700.2	834.7	0.00	0.00	0.00
6,900.0	0.00	0.00	6,806.6	-21.61	454.4	700.2	834.7	0.00	0.00	0.00
L.F.U. ALLEN 9A										
6,972.4	0.00	0.00	6,879.0	-94.00	454.4	700.2	834.7	0.00	0.00	0.00
7,000.0	0.00	0.00	6,906.6	-121.61	454.4	700.2	834.7	0.00	0.00	0.00
L.F.U. ALLEN 9B										
7,023.4	0.00	0.00	6,930.0	-145.00	454.4	700.2	834.7	0.00	0.00	0.00
7,100.0	0.00	0.00	7,006.6	-221.61	454.4	700.2	834.7	0.00	0.00	0.00

Planning Report

Database:	EDM_5000_1_7	Local Co-ordinate Reference:	Well B.W. MUSSER #43
Company:	WEXPRO COMPANY	TVD Reference:	KB-EST @ 6785.0usft (Original Well Elev)
Project:	COLORADO (MOFFAT COUNTY)	MD Reference:	KB-EST @ 6785.0usft (Original Well Elev)
Site:	SEC. 8 TWP. 11N RGE. 97W 6th P.M.	North Reference:	True
Well:	B.W. MUSSER #43	Survey Calculation Method:	Minimum Curvature
Wellbore:	ORIGINAL WELLBORE		
Design:	PROPOSAL #2		

Planned Survey

MD (usft)	Inc (°)	Azi (°)	TVD (usft)	SS (usft)	+N/-S (usft)	+E/-W (usft)	Vertical Section (usft)	Dogleg Rate (°/100usft)	Build Rate (°/100usft)	Turn Rate (°/100usft)
L.F.U. ALLEN 9C										
7,122.4	0.00	0.00	7,029.0	-244.00	454.4	700.2	834.7	0.00	0.00	0.00
7,200.0	0.00	0.00	7,106.6	-321.61	454.4	700.2	834.7	0.00	0.00	0.00
L.F.U. ALLEN 11										
7,245.4	0.00	0.00	7,152.0	-367.00	454.4	700.2	834.7	0.00	0.00	0.00
7,300.0	0.00	0.00	7,206.6	-421.61	454.4	700.2	834.7	0.00	0.00	0.00
7,400.0	0.00	0.00	7,306.6	-521.61	454.4	700.2	834.7	0.00	0.00	0.00
L.F.U. ALLEN 11A										
7,413.4	0.00	0.00	7,320.0	-535.00	454.4	700.2	834.7	0.00	0.00	0.00
7,500.0	0.00	0.00	7,406.6	-621.61	454.4	700.2	834.7	0.00	0.00	0.00
L.F.U. ALLEN 11B										
7,563.4	0.00	0.00	7,470.0	-685.00	454.4	700.2	834.7	0.00	0.00	0.00
7,600.0	0.00	0.00	7,506.6	-721.61	454.4	700.2	834.7	0.00	0.00	0.00
7,700.0	0.00	0.00	7,606.6	-821.61	454.4	700.2	834.7	0.00	0.00	0.00
L.F.U. ALLEN 11C										
7,719.4	0.00	0.00	7,626.0	-841.00	454.4	700.2	834.7	0.00	0.00	0.00
7,800.0	0.00	0.00	7,706.6	-921.61	454.4	700.2	834.7	0.00	0.00	0.00
L.F.U. 4600										
7,863.4	0.00	0.00	7,793.0	-1,008.00	454.4	700.2	834.7	0.00	0.00	0.00
7,900.0	0.00	0.00	7,806.6	-1,021.61	454.4	700.2	834.7	0.00	0.00	0.00
8,000.0	0.00	0.00	7,906.6	-1,121.61	454.4	700.2	834.7	0.00	0.00	0.00
8,100.0	0.00	0.00	8,006.6	-1,221.61	454.4	700.2	834.7	0.00	0.00	0.00
L.F.U. ALLEN 10A										
8,109.4	0.00	0.00	8,016.0	-1,231.00	454.4	700.2	834.7	0.00	0.00	0.00
8,200.0	0.00	0.00	8,106.6	-1,321.61	454.4	700.2	834.7	0.00	0.00	0.00
L.F.U. ALLEN 10B										
8,201.4	0.00	0.00	8,108.0	-1,323.00	454.4	700.2	834.7	0.00	0.00	0.00
L.F.U. ALLEN 10C										
8,248.4	0.00	0.00	8,155.0	-1,370.00	454.4	700.2	834.7	0.00	0.00	0.00
8,300.0	0.00	0.00	8,206.6	-1,421.61	454.4	700.2	834.7	0.00	0.00	0.00
L.F.U. ALLEN 6										
8,333.4	0.00	0.00	8,240.0	-1,455.00	454.4	700.2	834.7	0.00	0.00	0.00
L.F.U. ALLEN 6A										
8,393.4	0.00	0.00	8,300.0	-1,515.00	454.4	700.2	834.7	0.00	0.00	0.00
8,400.0	0.00	0.00	8,306.6	-1,521.61	454.4	700.2	834.7	0.00	0.00	0.00
L.F.U. ALLEN 6B										
8,459.4	0.00	0.00	8,366.0	-1,581.00	454.4	700.2	834.7	0.00	0.00	0.00
8,500.0	0.00	0.00	8,406.6	-1,621.61	454.4	700.2	834.7	0.00	0.00	0.00
L.F.U. ALLEN 6C										
8,524.4	0.00	0.00	8,431.0	-1,646.00	454.4	700.2	834.7	0.00	0.00	0.00
8,600.0	0.00	0.00	8,506.6	-1,721.61	454.4	700.2	834.7	0.00	0.00	0.00
L.F.U. ALLEN 6D										
8,604.4	0.00	0.00	8,511.0	-1,726.00	454.4	700.2	834.7	0.00	0.00	0.00
L.F.U. ALLEN 6E										
8,630.4	0.00	0.00	8,537.0	-1,752.00	454.4	700.2	834.7	0.00	0.00	0.00
8,700.0	0.00	0.00	8,606.6	-1,821.61	454.4	700.2	834.7	0.00	0.00	0.00
8,800.0	0.00	0.00	8,706.6	-1,921.61	454.4	700.2	834.7	0.00	0.00	0.00
L.F.U. ALLEN 6G										
8,882.4	0.00	0.00	8,789.0	-2,004.00	454.4	700.2	834.7	0.00	0.00	0.00
8,900.0	0.00	0.00	8,806.6	-2,021.61	454.4	700.2	834.7	0.00	0.00	0.00
L.F.U. ALLEN 6H										
8,982.4	0.00	0.00	8,889.0	-2,104.00	454.4	700.2	834.7	0.00	0.00	0.00

Planning Report

Database:	EDM_5000_1_7	Local Co-ordinate Reference:	Well B.W. MUSSER #43
Company:	WEXPRO COMPANY	TVD Reference:	KB-EST @ 6785.0usft (Original Well Elev)
Project:	COLORADO (MOFFAT COUNTY)	MD Reference:	KB-EST @ 6785.0usft (Original Well Elev)
Site:	SEC. 8 TWP. 11N RGE. 97W 6th P.M.	North Reference:	True
Well:	B.W. MUSSER #43	Survey Calculation Method:	Minimum Curvature
Wellbore:	ORIGINAL WELLBORE		
Design:	PROPOSAL #2		

Planned Survey										
MD (usft)	Inc (°)	Azi (°)	TVD (usft)	SS (usft)	+N/-S (usft)	+E/-W (usft)	Vertical Section (usft)	Dogleg Rate (°/100usft)	Build Rate (°/100usft)	Turn Rate (°/100usft)
9,000.0	0.00	0.00	8,906.6	-2,121.61	454.4	700.2	834.7	0.00	0.00	0.00
9,100.0	0.00	0.00	9,006.6	-2,221.61	454.4	700.2	834.7	0.00	0.00	0.00
L.F.U. ALLEN 6K										
9,131.4	0.00	0.00	9,038.0	-2,253.00	454.4	700.2	834.7	0.00	0.00	0.00
9,200.0	0.00	0.00	9,106.6	-2,321.61	454.4	700.2	834.7	0.00	0.00	0.00
9,300.0	0.00	0.00	9,206.6	-2,421.61	454.4	700.2	834.7	0.00	0.00	0.00
9,400.0	0.00	0.00	9,306.6	-2,521.61	454.4	700.2	834.7	0.00	0.00	0.00
9,500.0	0.00	0.00	9,406.6	-2,621.61	454.4	700.2	834.7	0.00	0.00	0.00
9,593.4	0.00	0.00	9,500.0	-2,715.00	454.4	700.2	834.7	0.00	0.00	0.00

Formations						
MD (usft)	TVD (usft)	Name	Lithology	Dip (°)	Dip Direction (°)	
4,708.3	4,615.0	A-4-G SD				
5,024.4	4,931.0	(BIG WATER SD)				
5,316.4	5,223.0	A-4-H SD				
5,551.4	5,458.0	FORT UNION FORMATION				
6,406.4	6,313.0	L.F.U. ALLEN 8A				
6,454.4	6,361.0	L.F.U. ALLEN 8B				
6,604.4	6,511.0	L.F.U. ALLEN 8E				
6,684.4	6,591.0	L.F.U. ALLEN 8E1				
6,716.4	6,623.0	L.F.U. ALLEN 8F				
6,763.4	6,670.0	L.F.U. ALLEN 8G				
6,838.4	6,745.0	L.F.U. ALLEN 8H				
6,972.4	6,879.0	L.F.U. ALLEN 9A				
7,023.4	6,930.0	L.F.U. ALLEN 9B				
7,122.4	7,029.0	L.F.U. ALLEN 9C				
7,245.4	7,152.0	L.F.U. ALLEN 11				
7,413.4	7,320.0	L.F.U. ALLEN 11A				
7,563.4	7,470.0	L.F.U. ALLEN 11B				
7,719.4	7,626.0	L.F.U. ALLEN 11C				
7,886.4	7,793.0	L.F.U 4600				
8,109.4	8,016.0	L.F.U. ALLEN 10A				
8,201.4	8,108.0	L.F.U. ALLEN 10B				
8,248.4	8,155.0	L.F.U. ALLEN 10C				
8,333.4	8,240.0	L.F.U. ALLEN 6				
8,393.4	8,300.0	L.F.U. ALLEN 6A				
8,459.4	8,366.0	L.F.U. ALLEN 6B				
8,524.4	8,431.0	L.F.U. ALLEN 6C				
8,604.4	8,511.0	L.F.U. ALLEN 6D				
8,630.4	8,537.0	L.F.U. ALLEN 6E				
8,882.4	8,789.0	L.F.U. ALLEN 6G				
8,982.4	8,889.0	L.F.U. ALLEN 6H				
9,131.4	9,038.0	L.F.U. ALLEN 6K				

Planning Report

Database:	EDM_5000_1_7	Local Co-ordinate Reference:	Well B.W. MUSSER #43
Company:	WEXPRO COMPANY	TVD Reference:	KB-EST @ 6785.0usft (Original Well Elev)
Project:	COLORADO (MOFFAT COUNTY)	MD Reference:	KB-EST @ 6785.0usft (Original Well Elev)
Site:	SEC. 8 TWP. 11N RGE. 97W 6th P.M.	North Reference:	True
Well:	B.W. MUSSER #43	Survey Calculation Method:	Minimum Curvature
Wellbore:	ORIGINAL WELLBORE		
Design:	PROPOSAL #2		

Plan Annotations				
Local Coordinates				
MD (usft)	TVD (usft)	+N/-S (usft)	+E/-W (usft)	Comment
600.0	600.0	0.0	0.0	SURFACE KOP (2°/100ft BUR)
1,291.9	1,285.2	45.3	69.8	END OF BUILD TO 13.84° INC
3,970.9	3,886.4	394.0	607.2	END OF TANGENT
4,893.4	4,800.0	454.4	700.2	B.W.MUSSER #43 TGT
9,593.4	9,500.0	454.4	700.2	PROPOSED TD - B.W. MUSSER #43