

Physical Address: 345 Comanche St.
Mail to: Box 384, Kiowa, CO 80117
Ph. 303-621-8672 - Fax 303-621-7749
www.highprairiesurvey.com

Job # 13118-APC-BAUGHMAN UNIT #1-35

Inv # 2440

High Prairie Surveying of Kiowa, Colorado has in accordance with a request from **MULL DRILLING COMPANY** has determined the location of **APC-BAUGHMAN UNIT #1-35** to be **660 feet FSL**, and **330 feet FWL**, (90° off Section lines) of **SECTION 35**, Township **16s**, Range **45w** of the 6th Principal Meridian, **Cheyenne County**, Colorado.

Date: Staked on 05/15/13 Drawn on 05/28/13.

Re: Staked by Elijah Frane
Drawn: Drawn by Dustin Cotter

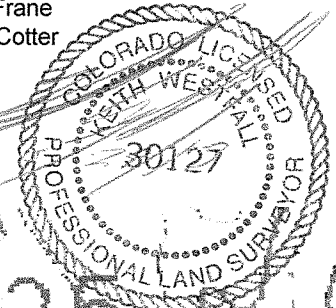

Reference Area

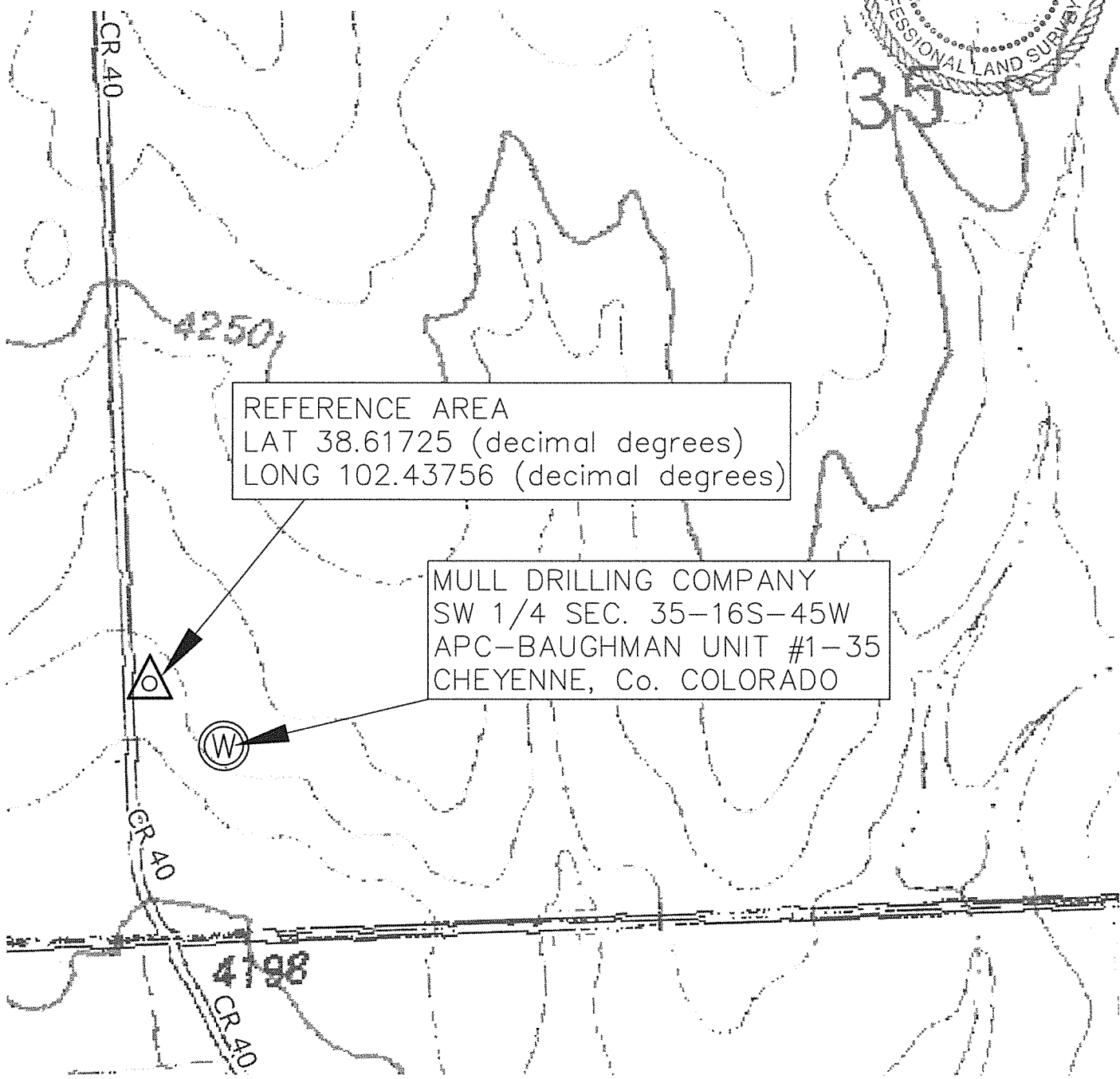

REFERENCE AREA
LAT 38.61725 (decimal degrees)
LONG 102.43756 (decimal degrees)

MULL DRILLING COMPANY
SW 1/4 SEC. 35-16S-45W
APC-BAUGHMAN UNIT #1-35
CHEYENNE, Co. COLORADO