

Location	Weld County, CO, USA(Imported)	Slot	Slot #4
Field	Wattenberg	Well	SRC PHELPS #13-32CHZ
Installation	SRC PHELPS	Wellbore	SRC PHELPS #13-32CHZ (PWB)

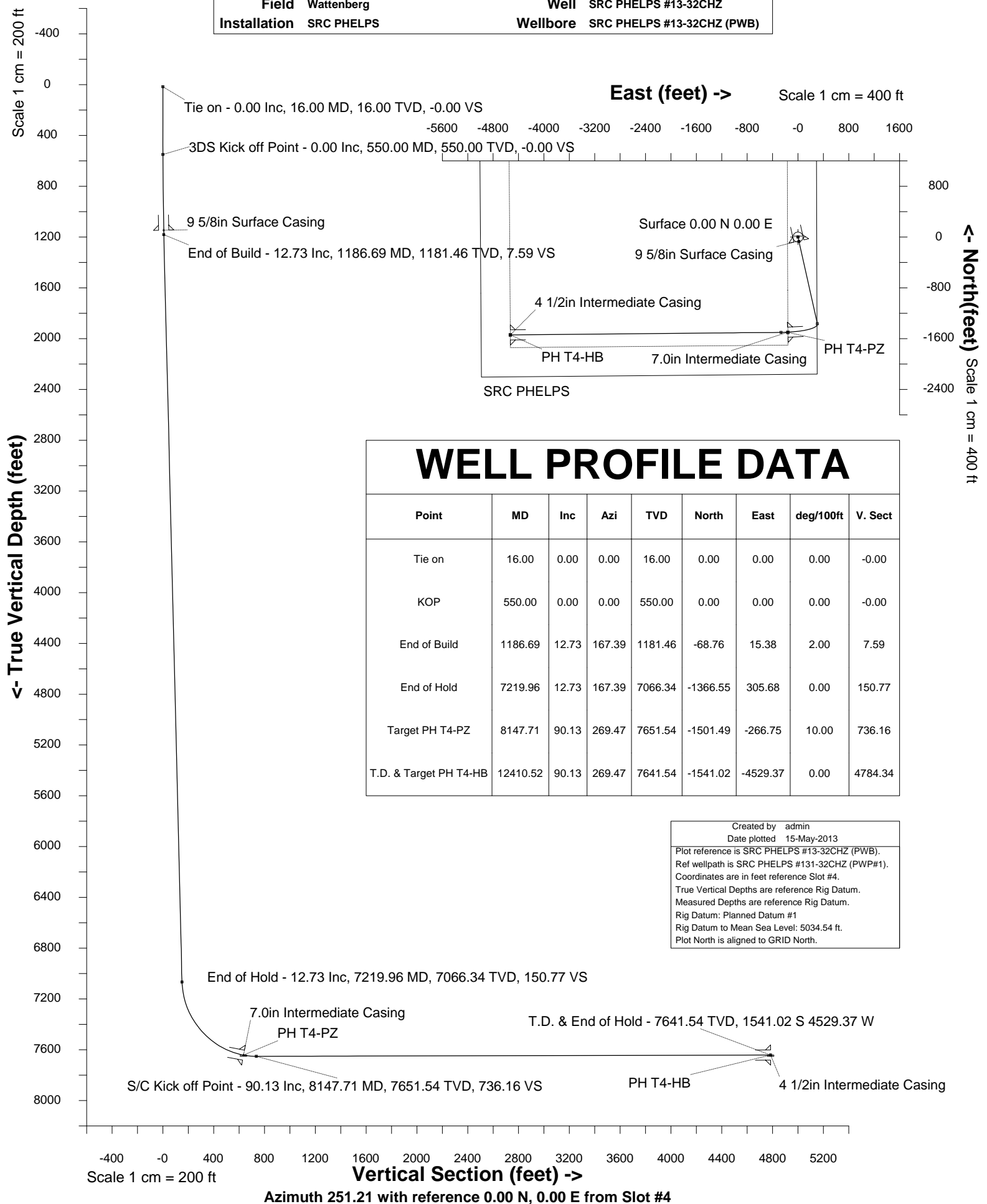



INTEGRATED PETROLEUM TECHNOLOGIES, INC
SYSDRILL
Well Design Combined Report
Wellbore: SRC PHELPS #13-32CHZ (PWB)

Wellhead Details							
Name	Northing	Easting	Latitude	Longitude	North	East	Elevation Above Inst.
Slot #4	1247278.2520	3198168.4880	N40 0 35.9818	W104 47 33.1160	17.52S	21.95E	0.60

Declination			
Date	Source	Time	
18-Apr-2013	IGRF Model [1900.0-2015.0]		16:06

Site Details				
Name	Northing	Easting	Coord System Name	North Alignment
SRC PHELPS	1247295.7700	3198146.5430	CO83-NF on NORTH AMERICAN DATUM 1983 datum	Grid

Summary Wellpath									
MD[ft]	Inc[deg]	Azi[deg]	TVD[ft]	North[ft]	East[ft]	Dogleg [deg/100ft]	Vertical Section[ft]	Northing	Easting
16.00	0.00	0.000	16.00	0.00N	0.00E		0.00	1247278.25	3198168.49
550.00	0.00	0.000	550.00	0.00N	0.00E	==>	0.00	1247278.25	3198168.49
1186.69	12.73	167.390	1181.46	68.76S	15.38E	2.00	7.59	1247209.49	3198183.87
7219.96	12.73	167.390	7066.34	1366.55S	305.68E	==>	150.77	1245911.75	3198474.16
8147.71	90.13	269.470	7651.54	1501.49S	266.75W	10.00	736.16	1245776.82	3197901.75
12410.52	90.13	269.470	7641.54	1541.02S	4529.37W	==>	4784.34	1245737.29	3193639.29

Interpolated Wellpath									
MD[ft]	Inc[deg]	Azi[deg]	TVD[ft]	North[ft]	East[ft]	Dogleg [deg/100ft]	Vertical Section[ft]	Northing	Easting
0.00	0.00	0.000	0.00	0.00N	0.00E		0.00	1247278.25	3198168.49
16.00	0.00	0.000	16.00	0.00N	0.00E	==>	0.00	1247278.25	3198168.49
100.00	0.00	0.000	100.00	0.00N	0.00E	==>	0.00	1247278.25	3198168.49
200.00	0.00	0.000	200.00	0.00N	0.00E	==>	0.00	1247278.25	3198168.49
300.00	0.00	0.000	300.00	0.00N	0.00E	==>	0.00	1247278.25	3198168.49
400.00	0.00	0.000	400.00	0.00N	0.00E	==>	0.00	1247278.25	3198168.49
500.00	0.00	0.000	500.00	0.00N	0.00E	==>	0.00	1247278.25	3198168.49
534.00	0.00	0.000	534.00	0.00N	0.00E	==>	0.00	1247278.25	3198168.49
550.00	0.00	0.000	550.00	0.00N	0.00E	==>	0.00	1247278.25	3198168.49
634.00	1.68	167.390	633.99	1.20S	0.27E	2.00	0.13	1247277.05	3198168.76
734.00	3.68	167.390	733.87	5.76S	1.29E	2.00	0.64	1247272.49	3198169.78
834.00	5.68	167.390	833.54	13.73S	3.07E	2.00	1.51	1247264.53	3198171.56
934.00	7.68	167.390	932.85	25.08S	5.61E	2.00	2.77	1247253.18	3198174.10
1034.00	9.68	167.390	1031.70	39.80S	8.90E	2.00	4.39	1247238.45	3198177.39
1134.00	11.68	167.390	1129.96	57.89S	12.95E	2.00	6.39	1247220.37	3198181.44
1186.69	12.73	167.390	1181.46	68.76S	15.38E	2.00	7.59	1247209.49	3198183.87
1200.00	12.73	167.390	1194.44	71.62S	16.02E	==>	7.90	1247206.63	3198184.51
1300.00	12.73	167.390	1291.98	93.13S	20.83E	==>	10.28	1247185.12	3198189.32
1400.00	12.73	167.390	1389.53	114.65S	25.64E	==>	12.65	1247163.61	3198194.13
1500.00	12.73	167.390	1487.07	136.16S	30.46E	==>	15.02	1247142.10	3198198.94
1600.00	12.73	167.390	1584.61	157.67S	35.27E	==>	17.40	1247120.59	3198203.75
1700.00	12.73	167.390	1682.15	179.18S	40.08E	==>	19.77	1247099.08	3198208.57
1800.00	12.73	167.390	1779.69	200.69S	44.89E	==>	22.14	1247077.57	3198213.38
1900.00	12.73	167.390	1877.23	222.20S	49.70E	==>	24.51	1247056.06	3198218.19
2000.00	12.73	167.390	1974.77	243.71S	54.51E	==>	26.89	1247034.55	3198223.00
2100.00	12.73	167.390	2072.31	265.22S	59.33E	==>	29.26	1247013.04	3198227.81
2200.00	12.73	167.390	2169.85	286.73S	64.14E	==>	31.63	1246991.53	3198232.62
2300.00	12.73	167.390	2267.39	308.24S	68.95E	==>	34.01	1246970.02	3198237.44
2400.00	12.73	167.390	2364.93	329.75S	73.76E	==>	36.38	1246948.51	3198242.25
2500.00	12.73	167.390	2462.47	351.26S	78.57E	==>	38.75	1246927.00	3198247.06
2600.00	12.73	167.390	2560.01	372.77S	83.38E	==>	41.13	1246905.49	3198251.87
2700.00	12.73	167.390	2657.55	394.28S	88.20E	==>	43.50	1246883.98	3198256.68
2800.00	12.73	167.390	2755.09	415.79S	93.01E	==>	45.87	1246862.48	3198261.49
2900.00	12.73	167.390	2852.63	437.30S	97.82E	==>	48.25	1246840.97	3198266.30
3000.00	12.73	167.390	2950.17	458.81S	102.63E	==>	50.62	1246819.46	3198271.12
3100.00	12.73	167.390	3047.71	480.32S	107.44E	==>	52.99	1246797.95	3198275.93
3200.00	12.73	167.390	3145.25	501.83S	112.25E	==>	55.37	1246776.44	3198280.74

All data is in Feet unless otherwise stated
Coordinates are from Slot MD's are from Rig and TVD's are from Rig (Planned Datum #1 5034.5ft above Mean Sea Level)
Vertical Section is from 0.00N 0.00E on azimuth 251.210 degrees
Bottom hole distance is 4784.34 Feet on azimuth 251.21 degrees from Wellhead
Calculation method uses Minimum Curvature method
Prepared by Peterson Energy
Date Printed: 15-May-2013



INTEGRATED PETROLEUM TECHNOLOGIES, INC
SYSDRILL
Well Design Combined Report
Wellbore: SRC PHELPS #13-32CHZ (PWB)

Interpolated Wellpath									
MD[ft]	Inc[deg]	Azi[deg]	TVD[ft]	North[ft]	East[ft]	Dogleg [deg/100ft]	Vertical Section[ft]	Northing	Easting
3300.00	12.73	167.390	3242.79	523.34S	117.07E	==>	57.74	1246754.93	3198285.55
3400.00	12.73	167.390	3340.33	544.85S	121.88E	==>	60.11	1246733.42	3198290.36
3500.00	12.73	167.390	3437.88	566.37S	126.69E	==>	62.49	1246711.91	3198295.17
3600.00	12.73	167.390	3535.42	587.88S	131.50E	==>	64.86	1246690.40	3198299.98
3700.00	12.73	167.390	3632.96	609.39S	136.31E	==>	67.23	1246668.89	3198304.80
3800.00	12.73	167.390	3730.50	630.90S	141.12E	==>	69.61	1246647.38	3198309.61
3900.00	12.73	167.390	3828.04	652.41S	145.94E	==>	71.98	1246625.87	3198314.42
4000.00	12.73	167.390	3925.58	673.92S	150.75E	==>	74.35	1246604.36	3198319.23
4100.00	12.73	167.390	4023.12	695.43S	155.56E	==>	76.73	1246582.85	3198324.04
4200.00	12.73	167.390	4120.66	716.94S	160.37E	==>	79.10	1246561.34	3198328.85
4300.00	12.73	167.390	4218.20	738.45S	165.18E	==>	81.47	1246539.83	3198333.66
4400.00	12.73	167.390	4315.74	759.96S	169.99E	==>	83.85	1246518.32	3198338.48
4500.00	12.73	167.390	4413.28	781.47S	174.81E	==>	86.22	1246496.81	3198343.29
4600.00	12.73	167.390	4510.82	802.98S	179.62E	==>	88.59	1246475.30	3198348.10
4700.00	12.73	167.390	4608.36	824.49S	184.43E	==>	90.97	1246453.79	3198352.91
4800.00	12.73	167.390	4705.90	846.00S	189.24E	==>	93.34	1246432.28	3198357.72
4900.00	12.73	167.390	4803.44	867.51S	194.05E	==>	95.71	1246410.77	3198362.53
5000.00	12.73	167.390	4900.98	889.02S	198.86E	==>	98.09	1246389.26	3198367.35
5100.00	12.73	167.390	4998.52	910.53S	203.68E	==>	100.46	1246367.75	3198372.16
5200.00	12.73	167.390	5096.06	932.04S	208.49E	==>	102.83	1246346.24	3198376.97
5300.00	12.73	167.390	5193.60	953.55S	213.30E	==>	105.20	1246324.73	3198381.78
5400.00	12.73	167.390	5291.14	975.06S	218.11E	==>	107.58	1246303.22	3198386.59
5500.00	12.73	167.390	5388.69	996.58S	222.92E	==>	109.95	1246281.71	3198391.40
5600.00	12.73	167.390	5486.23	1018.09S	227.73E	==>	112.32	1246260.20	3198396.21
5700.00	12.73	167.390	5583.77	1039.60S	232.55E	==>	114.70	1246238.69	3198401.03
5800.00	12.73	167.390	5681.31	1061.11S	237.36E	==>	117.07	1246217.18	3198405.84
5900.00	12.73	167.390	5778.85	1082.62S	242.17E	==>	119.44	1246195.67	3198410.65
6000.00	12.73	167.390	5876.39	1104.13S	246.98E	==>	121.82	1246174.16	3198415.46
6100.00	12.73	167.390	5973.93	1125.64S	251.79E	==>	124.19	1246152.65	3198420.27
6200.00	12.73	167.390	6071.47	1147.15S	256.60E	==>	126.56	1246131.15	3198425.08
6300.00	12.73	167.390	6169.01	1168.66S	261.42E	==>	128.94	1246109.64	3198429.89
6400.00	12.73	167.390	6266.55	1190.17S	266.23E	==>	131.31	1246088.13	3198434.71
6500.00	12.73	167.390	6364.09	1211.68S	271.04E	==>	133.68	1246066.62	3198439.52
6600.00	12.73	167.390	6461.63	1233.19S	275.85E	==>	136.06	1246045.11	3198444.33
6700.00	12.73	167.390	6559.17	1254.70S	280.66E	==>	138.43	1246023.60	3198449.14
6800.00	12.73	167.390	6656.71	1276.21S	285.47E	==>	140.80	1246002.09	3198453.95
6900.00	12.73	167.390	6754.25	1297.72S	290.29E	==>	143.18	1245980.58	3198458.76
7000.00	12.73	167.390	6851.79	1319.23S	295.10E	==>	145.55	1245959.07	3198463.57
7100.00	12.73	167.390	6949.33	1340.74S	299.91E	==>	147.92	1245937.56	3198468.39
7200.00	12.73	167.390	7046.87	1362.25S	304.72E	==>	150.30	1245916.05	3198473.20
7219.96	12.73	167.390	7066.34	1366.55S	305.68E	==>	150.77	1245911.75	3198474.16
7300.00	13.55	202.960	7144.41	1383.82S	303.95E	10.00	157.98	1245894.48	3198472.42
7400.00	19.69	231.300	7240.34	1405.19S	286.18E	10.00	181.68	1245873.11	3198454.66
7500.00	28.08	244.970	7331.76	1425.74S	251.62E	10.00	221.01	1245852.57	3198420.10
7600.00	37.23	252.530	7415.90	1444.83S	201.32E	10.00	274.79	1245833.48	3198369.80
7700.00	46.68	257.410	7490.21	1461.88S	136.80E	10.00	341.36	1245816.43	3198305.28
7800.00	56.29	260.960	7552.41	1476.38S	60.02E	10.00	418.72	1245801.93	3198228.50
7900.00	65.98	263.790	7600.63	1487.89S	26.68W	10.00	504.51	1245790.42	3198141.80
8000.00	75.72	266.210	7633.39	1496.05S	120.68W	10.00	596.12	1245782.26	3198047.82
8100.00	85.48	268.440	7649.71	1500.62S	219.10W	10.00	690.77	1245777.69	3197949.39
8147.71	90.13	269.470	7651.54	1501.49S	266.75W	10.00	736.16	1245776.82	3197901.75
8200.00	90.13	269.470	7651.42	1501.97S	319.04W	==>	785.82	1245776.33	3197849.46
8300.00	90.13	269.470	7651.18	1502.90S	419.04W	==>	880.79	1245775.41	3197749.47
8400.00	90.13	269.470	7650.95	1503.83S	519.03W	==>	975.75	1245774.48	3197649.47
8500.00	90.13	269.470	7650.71	1504.76S	619.03W	==>	1070.72	1245773.55	3197549.48
8600.00	90.13	269.470	7650.48	1505.68S	719.02W	==>	1165.68	1245772.62	3197449.49
8700.00	90.13	269.470	7650.24	1506.61S	819.02W	==>	1260.65	1245771.70	3197349.50
8800.00	90.13	269.470	7650.01	1507.54S	919.01W	==>	1355.61	1245770.77	3197249.51
8900.00	90.13	269.470	7649.78	1508.46S	1019.01W	==>	1450.58	1245769.84	3197149.52
9000.00	90.13	269.470	7649.54	1509.39S	1119.01W	==>	1545.54	1245768.91	3197049.52
9100.00	90.13	269.470	7649.31	1510.32S	1219.00W	==>	1640.51	1245767.99	3196949.53

All data is in Feet unless otherwise stated
Coordinates are from Slot MD's are from Rig (Planned Datum #1 5034.5ft above Mean Sea Level)
Vertical Section is from 0.00N 0.00E on azimuth 251.210 degrees
Bottom hole distance is 4784.34 Feet on azimuth 251.21 degrees from Wellhead
Calculation method uses Minimum Curvature method
Prepared by Peterson Energy
Date Printed: 15-May-2013



INTEGRATED PETROLEUM TECHNOLOGIES, INC
SYSDRILL
Well Design Combined Report
Wellbore: SRC PHELPS #13-32CHZ (PWB)

Interpolated Wellpath									
MD[ft]	Inc[deg]	Azi[deg]	TVD[ft]	North[ft]	East[ft]	Dogleg [deg/100ft]	Vertical Section[ft]	Northing	Easting
9200.00	90.13	269.470	7649.07	1511.25S	1319.00W	==>	1735.47	1245767.06	3196849.54
9300.00	90.13	269.470	7648.84	1512.17S	1418.99W	==>	1830.44	1245766.13	3196749.55
9400.00	90.13	269.470	7648.60	1513.10S	1518.99W	==>	1925.40	1245765.21	3196649.56
9500.00	90.13	269.470	7648.37	1514.03S	1618.98W	==>	2020.37	1245764.28	3196549.56
9600.00	90.13	269.470	7648.13	1514.96S	1718.98W	==>	2115.33	1245763.35	3196449.57
9700.00	90.13	269.470	7647.90	1515.88S	1818.97W	==>	2210.30	1245762.42	3196349.58
9800.00	90.13	269.470	7647.66	1516.81S	1918.97W	==>	2305.26	1245761.50	3196249.59
9900.00	90.13	269.470	7647.43	1517.74S	2018.96W	==>	2400.23	1245760.57	3196149.60
10000.00	90.13	269.470	7647.19	1518.67S	2118.96W	==>	2495.19	1245759.64	3196049.61
10100.00	90.13	269.470	7646.96	1519.59S	2218.96W	==>	2590.16	1245758.71	3195949.61
10200.00	90.13	269.470	7646.73	1520.52S	2318.95W	==>	2685.12	1245757.79	3195849.62
10300.00	90.13	269.470	7646.49	1521.45S	2418.95W	==>	2780.09	1245756.86	3195749.63
10400.00	90.13	269.470	7646.26	1522.38S	2518.94W	==>	2875.05	1245755.93	3195649.64
10500.00	90.13	269.470	7646.02	1523.30S	2618.94W	==>	2970.02	1245755.00	3195549.65
10600.00	90.13	269.470	7645.79	1524.23S	2718.93W	==>	3064.98	1245754.08	3195449.65
10700.00	90.13	269.470	7645.55	1525.16S	2818.93W	==>	3159.95	1245753.15	3195349.66
10800.00	90.13	269.470	7645.32	1526.09S	2918.92W	==>	3254.91	1245752.22	3195249.67
10900.00	90.13	269.470	7645.08	1527.01S	3018.92W	==>	3349.88	1245751.29	3195149.68
11000.00	90.13	269.470	7644.85	1527.94S	3118.91W	==>	3444.84	1245750.37	3195049.69
11100.00	90.13	269.470	7644.61	1528.87S	3218.91W	==>	3539.81	1245749.44	3194949.70
11200.00	90.13	269.470	7644.38	1529.79S	3318.90W	==>	3634.77	1245748.51	3194849.70
11300.00	90.13	269.470	7644.15	1530.72S	3418.90W	==>	3729.74	1245747.59	3194749.71
11400.00	90.13	269.470	7643.91	1531.65S	3518.90W	==>	3824.70	1245746.66	3194649.72
11500.00	90.13	269.470	7643.68	1532.58S	3618.89W	==>	3919.67	1245745.73	3194549.73
11600.00	90.13	269.470	7643.44	1533.50S	3718.89W	==>	4014.63	1245744.80	3194449.74
11700.00	90.13	269.470	7643.21	1534.43S	3818.88W	==>	4109.60	1245743.88	3194349.75
11800.00	90.13	269.470	7642.97	1535.36S	3918.88W	==>	4204.56	1245742.95	3194249.75
11900.00	90.13	269.470	7642.74	1536.29S	4018.87W	==>	4299.53	1245742.02	3194149.76
12000.00	90.13	269.470	7642.50	1537.21S	4118.87W	==>	4394.49	1245741.09	3194049.77
12100.00	90.13	269.470	7642.27	1538.14S	4218.86W	==>	4489.46	1245740.17	3193949.78
12200.00	90.13	269.470	7642.03	1539.07S	4318.86W	==>	4584.42	1245739.24	3193849.79
12300.00	90.13	269.470	7641.80	1540.00S	4418.85W	==>	4679.39	1245738.31	3193749.79
12400.00	90.13	269.470	7641.56	1540.92S	4518.85W	==>	4774.35	1245737.38	3193649.80
12410.52	90.13	269.470	7641.54	1541.02S	4529.37W	==>	4784.34	1245737.29	3193639.29

All data is in Feet unless otherwise stated
Coordinates are from Slot MD's are from Rig (Planned Datum #1 5034.5ft above Mean Sea Level)
Vertical Section is from 0.00N 0.00E on azimuth 251.210 degrees
Bottom hole distance is 4784.34 Feet on azimuth 251.21 degrees from Wellhead
Calculation method uses Minimum Curvature method
Prepared by Peterson Energy
Date Printed: 15-May-2013



INTEGRATED PETROLEUM TECHNOLOGIES, INC
SYSDRILL
Well Design Combined Report
Wellbore: SRC PHELPS #13-32CHZ (PWB)

Hole Sections								
Diameter	Start	Start	Start	Start	End	End	End	End
[in]	MD[ft]	TVD[ft]	North[ft]	East[ft]	MD[ft]	TVD[ft]	North[ft]	East[ft]
13 1/2	16.00	16.00	0.00N	0.00E	1150.00	1145.62	61.09S	13.67E
8 5/8	1150.00	1145.62	61.09S	13.67E	8041.00	7642.11	1498.37S	160.66W
6 1/8	8041.00	7642.11	1498.37S	160.66W	12410.52	7641.54	1541.02S	4529.37W

Casings								
Name	Top	Top	Top	Top	Shoe	Shoe	Shoe	Shoe
	MD[ft]	TVD[ft]	North[ft]	East[ft]	MD[ft]	TVD[ft]	North[ft]	East[ft]
9 5/8in Surface Casing	16.00	16.00	0.00N	0.00E	1150.00	1145.62	61.09S	13.67E
7.0in Intermediate Casing	16.00	16.00	0.00N	0.00E	8041.00	7642.11	1498.37S	160.66W
4 1/2in Intermediate Casing	7220.00	7066.38	1366.56S	305.68E	12410.52	7641.54	1541.02S	4529.37W

Targets								
Name	North[ft]	East[ft]	TVD[ft]	Latitude	Longitude	Northing	Easting	Last Revised
PH T4-HB	1541.02S	4529.37W	7641.54	N40 0 21.1065	W104 48 31.4778	1245737.29	3193639.29	14-May-2013
PH T4-PZ	1501.56S	159.75W	7641.54	N40 0 21.1560	W104 47 35.3228	1245776.75	3198008.74	14-May-2013

Survey Tool Program					
Reference	Survey Name	MD[ft]	TVD[ft]	Survey Tool	Error Model
36683	Planned	12410.52	7641.54	WdW Rate Gyro	Standard

Notes

All data is in Feet unless otherwise stated
Coordinates are from Slot MD's are from Rig and TVD's are from Rig (Planned Datum #1 5034.5ft above Mean Sea Level)
Vertical Section is from 0.00N 0.00E on azimuth 251.210 degrees
Bottom hole distance is 4784.34 Feet on azimuth 251.21 degrees from Wellhead
Calculation method uses Minimum Curvature method
Prepared by Peterson Energy
Date Printed: 15-May-2013



SYSDRILL
Closest Approach + Clearance Factor Summary Report
Wellbore: SRC PHELPS #13-32CHZ (PWB)

Ellipse separations are reported ONLY if BOTH wells have uncertainty data
Only Depth and Magnetic Reference Field error terms are correlated across tie points
Cutoff is calculated on CENTRE to CENTRE distance

Summary data uses Closest Approach clearance calculation for all minima
Hole size/Casings ARE included
Hole size/Casings are NOT subtracted from Centre-Centre distance
Confidence limit of 95.00% / 2.80 SD.

Wellbore		
Name	Created	Last Revised
SRC PHELPS #13-32CHZ (PWB)	14-May-2013	15-May-2013

Well		
Name	Government ID	Last Revised
SRC PHELPS #13-32CHZ		15-May-2013

Slot						
Name	Grid Northing	Grid Easting	Latitude	Longitude	North	East
Slot #4	1247278.2520	3198168.4880	N40 0 35.9818	W104 47 33.1160	17.52S	21.95E

Installation					
Name	Easting	Northing	Coord System Name	North Alignment	
SRC PHELPS	3198146.5430	1247295.7700	CO83-NF on NORTH AMERICAN DATUM 1983 datum	Grid	

Field					
Name	Easting	Northing	Coord System Name	North Alignment	
Wattenberg	3212690.1960	1438741.7551	CO83-NF on NORTH AMERICAN DATUM 1983 datum	Grid	

Clearance Summary										
Offset WellName	Offset Wellbore	Offset Slot	Offset Structure	Separation [ft]	MD[ft]	Diverging From[ft]	Ellipse Separation [ft]	Ellipse MD[ft]	Clearance Factor	Clearance MD[ft]
SRC PHELPS #11-32NHZ	SRC PHELPS #11-32NHZ (PWB)	Slot #3	SRC PHELPS	22.49	550.00	12404.18	20.67	550.00	12.19	573.74
SRC PHELPS #B-32CHZ	SRC PHELPS #B-32CHZ (PWB)	Slot #2	SRC PHELPS	22.50	458.91	12410.52	20.78	516.00	7.04	12410.52
SRC PHELPLS #13-32NHZ	SRC PHELPLS #13-32NHZ (PWB)	Slot #6	SRC PHELPS	22.59	590.15	12410.52	20.67	639.36	4.57	12410.52
SRC PHELPS #J-32CHZ	SRC PHELPS #J-32CHZ (PWB)	Slot #1	SRC PHELPS	28.08	442.51	442.51	26.42	458.91	15.81	573.74
SRC PHELPS #11-32CHZ	SRC PHELPS #11-32CHZ (PWB)	Slot #5	SRC PHELPS	35.15	550.00	550.00	33.31	557.34	18.27	655.76
SRC PHELPS #K-32CHZ	SRC PHELPS #K-32CHZ (PWB)	Slot #8	SRC PHELPS	44.96	606.55	12410.52	43.01	655.76	7.92	12410.52
SRC PHELPS #A-32NHZ	SRC PHELPS #A-32NHZ (PWB)	Slot #7	SRC PHELPS	54.46	550.00	550.00	52.63	557.34	26.03	12410.52
SRC PHELPS #K-32NHZ	SRC PHELPS #K-32NHZ (PWB)	Slot #10	SRC PHELPS	75.48	606.55	12410.52	73.50	672.17	10.47	12410.52
SRC PHELPS #A-32CHZ	SRC PHELPS #A-32CHZ (PWB)	Slot #9	SRC PHELPS	83.31	557.34	557.34	81.47	573.74	23.75	12410.52

All data is in Feet unless otherwise stated
Coordinates are from Slot MD's are from Rig and TVD's are from Rig (Planned Datum #1 5034.5ft above Mean Sea Level)
Vertical Section is from 0.00N 0.00E on azimuth 251.210 degrees
Prepared by Peterson Energy
Date Printed: 15-May-2013



SYSDRILL
Closest Approach + Clearance Factor Summary Report
Wellbore: SRC PHELPS #13-32CHZ (PWB)

Clearance Summary										
Offset WellName	Offset Wellbore	Offset Slot	Offset Structure	Separation [ft]	MD[ft]	Diverging From[ft]	Ellipse Separation [ft]	Ellipse MD[ft]	Clearance Factor	Clearance MD[ft]
SRC PHELPS #12-32CHZ	SRC PHELPS #12-32CHZ (PWB)	Slot #12	SRC PHELPS	97.99	622.96	622.96	96.00	688.57	15.80	12410.52
SRC PHELPS #12-32NHZ	SRC PHELPS #12-32NHZ (PWB)	Slot #11	SRC PHELPS	105.02	557.34	12410.52	103.17	573.74	18.38	12410.52
EMMA DELVENT HAL GAS UNIT #1	EMMA DELVENTHAL GAS UNIT #1 (AWB)	EMMA DELVENT HAL GAS UNIT #1	SRC PHELPS OFFSETS	804.36	557.34	8670.15	796.07	672.17	40.60	8677.42