

# SYNERGY RESOURCES

<b>Location</b>	Weld County, CO, USA(Imported)	<b>Slot</b>	Slot #3
<b>Field</b>	Wattenberg	<b>Well</b>	SRC PHELPS #11-32NHZ
<b>Installation</b>	SRC PHELPS	<b>Wellbore</b>	SRC PHELPS #11-32NHZ (PWB)

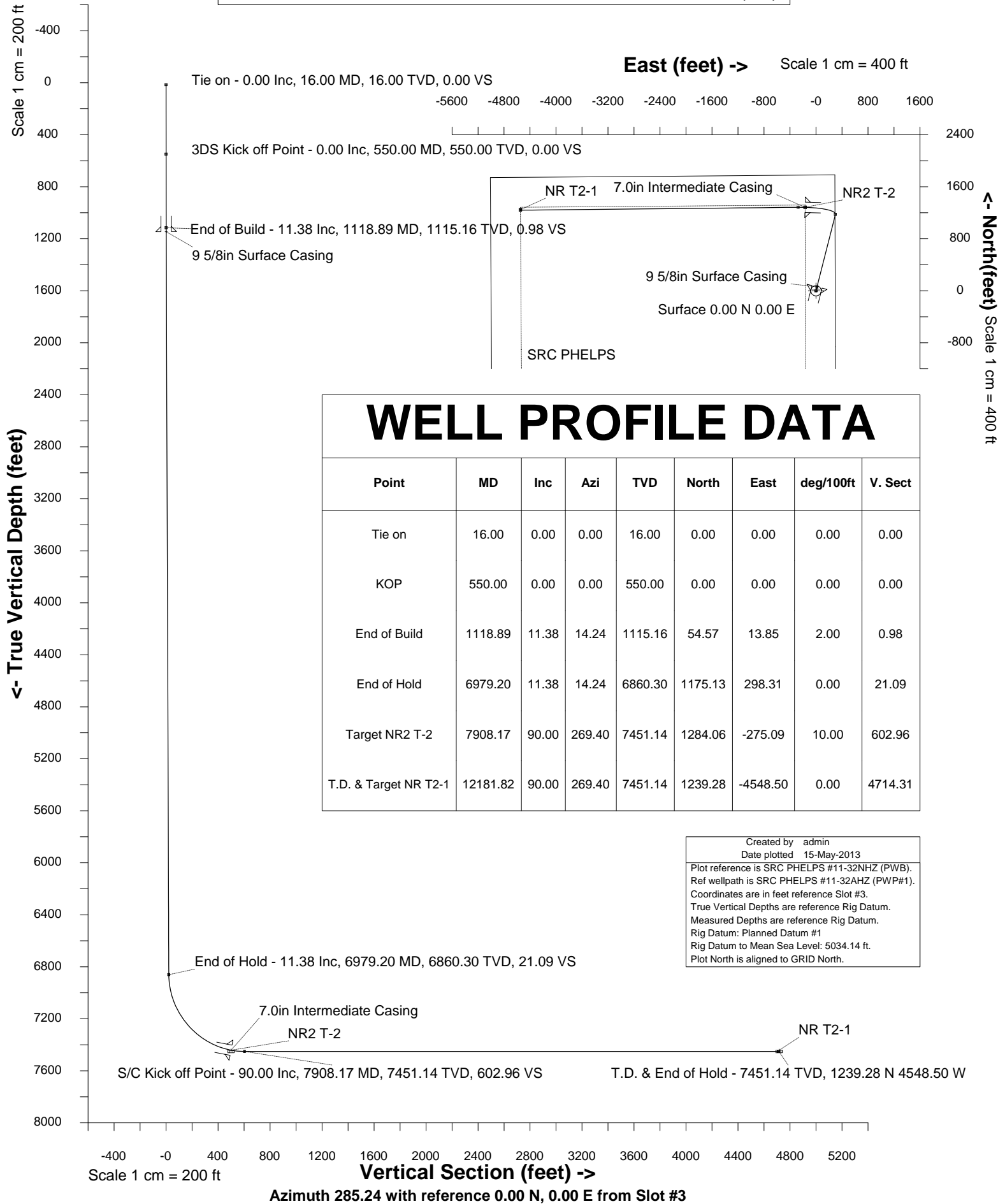



INTEGRATED PETROLEUM TECHNOLOGIES, INC  
SYSDRILL  
Well Design Combined Report  
Wellbore: SRC PHELPS #11-32NHZ (PWB)

Wellhead Details							
Name	Northing	Easting	Latitude	Longitude	North	East	Elevation Above Inst.
Slot #3	1247300.7450	3198168.4150	N40 0 36.2041	W104 47 33.1146	4.98N	21.87E	0.20

Declination			
Date	Source	Time	
18-Apr-2013	IGRF Model [1900.0-2015.0]		16:06

Site Details				
Name	Northing	Easting	Coord System Name	North Alignment
SRC PHELPS	1247295.7700	3198146.5430	CO83-NF on NORTH AMERICAN DATUM 1983 datum	Grid

Summary Wellpath									
MD[ft]	Inc[deg]	Azi[deg]	TVD[ft]	North[ft]	East[ft]	Dogleg [deg/100ft]	Vertical Section[ft]	Northing	Easting
16.00	0.00	0.000	16.00	0.00N	0.00E		0.00	1247300.75	3198168.41
550.00	0.00	0.000	550.00	0.00N	0.00E	==>	0.00	1247300.75	3198168.41
1118.89	11.38	14.240	1115.16	54.57N	13.85E	2.00	0.98	1247355.31	3198182.27
6979.20	11.38	14.240	6860.30	1175.13N	298.31E	==>	21.09	1248475.83	3198466.72
7908.17	90.00	269.400	7451.14	1284.06N	275.09W	10.00	602.96	1248584.75	3197893.34
12181.82	90.00	269.400	7451.14	1239.28N	4548.50W	==>	4714.31	1248539.98	3193620.08

Interpolated Wellpath									
MD[ft]	Inc[deg]	Azi[deg]	TVD[ft]	North[ft]	East[ft]	Dogleg [deg/100ft]	Vertical Section[ft]	Northing	Easting
0.00	0.00	0.000	0.00	0.00N	0.00E		0.00	1247300.75	3198168.41
16.00	0.00	0.000	16.00	0.00N	0.00E	==>	0.00	1247300.75	3198168.41
100.00	0.00	0.000	100.00	0.00N	0.00E	==>	0.00	1247300.75	3198168.41
200.00	0.00	0.000	200.00	0.00N	0.00E	==>	0.00	1247300.75	3198168.41
300.00	0.00	0.000	300.00	0.00N	0.00E	==>	0.00	1247300.75	3198168.41
400.00	0.00	0.000	400.00	0.00N	0.00E	==>	0.00	1247300.75	3198168.41
500.00	0.00	0.000	500.00	0.00N	0.00E	==>	0.00	1247300.75	3198168.41
534.00	0.00	0.000	534.00	0.00N	0.00E	==>	0.00	1247300.75	3198168.41
550.00	0.00	0.000	550.00	0.00N	0.00E	==>	0.00	1247300.75	3198168.41
634.00	1.68	14.240	633.99	1.19N	0.30E	2.00	0.02	1247301.94	3198168.72
734.00	3.68	14.240	733.87	5.73N	1.45E	2.00	0.10	1247306.47	3198169.87
834.00	5.68	14.240	833.54	13.63N	3.46E	2.00	0.24	1247314.38	3198171.88
934.00	7.68	14.240	932.85	24.91N	6.32E	2.00	0.45	1247325.65	3198174.74
1034.00	9.68	14.240	1031.70	39.53N	10.04E	2.00	0.71	1247340.28	3198178.45
1118.89	11.38	14.240	1115.16	54.57N	13.85E	2.00	0.98	1247355.31	3198182.27
1200.00	11.38	14.240	1194.67	70.08N	17.79E	==>	1.26	1247370.82	3198186.20
1300.00	11.38	14.240	1292.71	89.20N	22.64E	==>	1.60	1247389.94	3198191.06
1400.00	11.38	14.240	1390.74	108.32N	27.50E	==>	1.94	1247409.06	3198195.91
1500.00	11.38	14.240	1488.78	127.44N	32.35E	==>	2.29	1247428.18	3198200.77
1600.00	11.38	14.240	1586.81	146.56N	37.21E	==>	2.63	1247447.30	3198205.62
1700.00	11.38	14.240	1684.85	165.68N	42.06E	==>	2.97	1247466.42	3198210.47
1800.00	11.38	14.240	1782.88	184.81N	46.91E	==>	3.32	1247485.54	3198215.33
1900.00	11.38	14.240	1880.92	203.93N	51.77E	==>	3.66	1247504.66	3198220.18
2000.00	11.38	14.240	1978.95	223.05N	56.62E	==>	4.00	1247523.78	3198225.03
2100.00	11.38	14.240	2076.99	242.17N	61.48E	==>	4.35	1247542.90	3198229.89
2200.00	11.38	14.240	2175.02	261.29N	66.33E	==>	4.69	1247562.03	3198234.74
2300.00	11.38	14.240	2273.06	280.41N	71.18E	==>	5.03	1247581.15	3198239.60
2400.00	11.38	14.240	2371.09	299.53N	76.04E	==>	5.38	1247600.27	3198244.45
2500.00	11.38	14.240	2469.13	318.65N	80.89E	==>	5.72	1247619.39	3198249.30
2600.00	11.38	14.240	2567.16	337.77N	85.75E	==>	6.06	1247638.51	3198254.16
2700.00	11.38	14.240	2665.20	356.90N	90.60E	==>	6.41	1247657.63	3198259.01
2800.00	11.38	14.240	2763.23	376.02N	95.45E	==>	6.75	1247676.75	3198263.87
2900.00	11.38	14.240	2861.27	395.14N	100.31E	==>	7.09	1247695.87	3198268.72
3000.00	11.38	14.240	2959.30	414.26N	105.16E	==>	7.44	1247714.99	3198273.57
3100.00	11.38	14.240	3057.34	433.38N	110.02E	==>	7.78	1247734.11	3198278.43
3200.00	11.38	14.240	3155.37	452.50N	114.87E	==>	8.12	1247753.23	3198283.28
3300.00	11.38	14.240	3253.40	471.62N	119.72E	==>	8.47	1247772.35	3198288.13

All data is in Feet unless otherwise stated  
Coordinates are from Slot MD's are from Rig and TVD's are from Rig ( Planned Datum #1 5034.1ft above Mean Sea Level )  
Vertical Section is from 0.00N 0.00E on azimuth 285.240 degrees  
Bottom hole distance is 4714.31 Feet on azimuth 285.24 degrees from Wellhead  
Calculation method uses Minimum Curvature method  
Prepared by Peterson Energy  
Date Printed: 15-May-2013



INTEGRATED PETROLEUM TECHNOLOGIES, INC  
SYSDRILL  
Well Design Combined Report  
Wellbore: SRC PHELPS #11-32NHZ (PWB)

Interpolated Wellpath									
MD[ft]	Inc[deg]	Azi[deg]	TVD[ft]	North[ft]	East[ft]	Dogleg [deg/100ft]	Vertical Section[ft]	Northing	Easting
3400.00	11.38	14.240	3351.44	490.74N	124.58E	==>	8.81	1247791.47	3198292.99
3500.00	11.38	14.240	3449.47	509.87N	129.43E	==>	9.15	1247810.59	3198297.84
3600.00	11.38	14.240	3547.51	528.99N	134.29E	==>	9.50	1247829.71	3198302.70
3700.00	11.38	14.240	3645.54	548.11N	139.14E	==>	9.84	1247848.83	3198307.55
3800.00	11.38	14.240	3743.58	567.23N	143.99E	==>	10.18	1247867.95	3198312.40
3900.00	11.38	14.240	3841.61	586.35N	148.85E	==>	10.52	1247887.07	3198317.26
4000.00	11.38	14.240	3939.65	605.47N	153.70E	==>	10.87	1247906.19	3198322.11
4100.00	11.38	14.240	4037.68	624.59N	158.56E	==>	11.21	1247925.31	3198326.97
4200.00	11.38	14.240	4135.72	643.71N	163.41E	==>	11.55	1247944.43	3198331.82
4300.00	11.38	14.240	4233.75	662.83N	168.26E	==>	11.90	1247963.56	3198336.67
4400.00	11.38	14.240	4331.79	681.96N	173.12E	==>	12.24	1247982.68	3198341.53
4500.00	11.38	14.240	4429.82	701.08N	177.97E	==>	12.58	1248001.80	3198346.38
4600.00	11.38	14.240	4527.86	720.20N	182.83E	==>	12.93	1248020.92	3198351.23
4700.00	11.38	14.240	4625.89	739.32N	187.68E	==>	13.27	1248040.04	3198356.09
4800.00	11.38	14.240	4723.93	758.44N	192.53E	==>	13.61	1248059.16	3198360.94
4900.00	11.38	14.240	4821.96	777.56N	197.39E	==>	13.96	1248078.28	3198365.80
5000.00	11.38	14.240	4920.00	796.68N	202.24E	==>	14.30	1248097.40	3198370.65
5100.00	11.38	14.240	5018.03	815.80N	207.10E	==>	14.64	1248116.52	3198375.50
5200.00	11.38	14.240	5116.07	834.92N	211.95E	==>	14.99	1248135.64	3198380.36
5300.00	11.38	14.240	5214.10	854.05N	216.80E	==>	15.33	1248154.76	3198385.21
5400.00	11.38	14.240	5312.14	873.17N	221.66E	==>	15.67	1248173.88	3198390.07
5500.00	11.38	14.240	5410.17	892.29N	226.51E	==>	16.02	1248193.00	3198394.92
5600.00	11.38	14.240	5508.21	911.41N	231.37E	==>	16.36	1248212.12	3198399.77
5700.00	11.38	14.240	5606.24	930.53N	236.22E	==>	16.70	1248231.24	3198404.63
5800.00	11.38	14.240	5704.27	949.65N	241.07E	==>	17.05	1248250.36	3198409.48
5900.00	11.38	14.240	5802.31	968.77N	245.93E	==>	17.39	1248269.48	3198414.33
6000.00	11.38	14.240	5900.34	987.89N	250.78E	==>	17.73	1248288.60	3198419.19
6100.00	11.38	14.240	5998.38	1007.02N	255.64E	==>	18.08	1248307.72	3198424.04
6200.00	11.38	14.240	6096.41	1026.14N	260.49E	==>	18.42	1248326.84	3198428.90
6300.00	11.38	14.240	6194.45	1045.26N	265.34E	==>	18.76	1248345.96	3198433.75
6400.00	11.38	14.240	6292.48	1064.38N	270.20E	==>	19.11	1248365.09	3198438.60
6500.00	11.38	14.240	6390.52	1083.50N	275.05E	==>	19.45	1248384.21	3198443.46
6600.00	11.38	14.240	6488.55	1102.62N	279.91E	==>	19.79	1248403.33	3198448.31
6700.00	11.38	14.240	6586.59	1121.74N	284.76E	==>	20.14	1248422.45	3198453.17
6800.00	11.38	14.240	6684.62	1140.86N	289.61E	==>	20.48	1248441.57	3198458.02
6900.00	11.38	14.240	6782.66	1159.98N	294.47E	==>	20.82	1248460.69	3198462.87
6979.20	11.38	14.240	6860.30	1175.13N	298.31E	==>	21.09	1248475.83	3198466.72
7000.00	11.04	3.670	6880.71	1179.10N	298.95E	10.00	21.53	1248479.81	3198467.35
7100.00	14.30	319.150	6978.48	1198.05N	291.46E	10.00	33.73	1248498.75	3198459.87
7200.00	22.01	298.160	7073.53	1216.28N	266.80E	10.00	62.32	1248516.98	3198435.20
7300.00	31.02	288.270	7162.96	1233.24N	225.70E	10.00	106.43	1248533.94	3198394.11
7400.00	40.46	282.580	7244.06	1248.43N	169.43E	10.00	164.71	1248549.13	3198337.84
7500.00	50.09	278.760	7314.36	1261.37N	99.68E	10.00	235.41	1248562.07	3198268.09
7600.00	59.81	275.900	7371.73	1271.68N	18.58E	10.00	316.37	1248572.38	3198187.00
7700.00	69.58	273.550	7414.43	1279.05N	71.40W	10.00	405.12	1248579.75	3198097.01
7800.00	79.38	271.490	7441.15	1283.24N	167.54W	10.00	498.99	1248583.94	3198000.88
7900.00	89.20	269.560	7451.08	1284.13N	266.92W	10.00	595.10	1248584.83	3197901.51
7908.17	90.00	269.400	7451.14	1284.06N	275.09W	10.00	602.96	1248584.75	3197893.34
8000.00	90.00	269.400	7451.14	1283.09N	366.91W	==>	691.30	1248583.79	3197801.52
8100.00	90.00	269.400	7451.14	1282.05N	466.91W	==>	787.51	1248582.74	3197701.52
8200.00	90.00	269.400	7451.14	1281.00N	566.90W	==>	883.71	1248581.70	3197601.53
8300.00	90.00	269.400	7451.14	1279.95N	666.90W	==>	979.91	1248580.65	3197501.54
8400.00	90.00	269.400	7451.14	1278.90N	766.89W	==>	1076.11	1248579.60	3197401.55
8500.00	90.00	269.400	7451.14	1277.85N	866.89W	==>	1172.32	1248578.55	3197301.56
8600.00	90.00	269.400	7451.14	1276.81N	966.88W	==>	1268.52	1248577.51	3197201.57
8700.00	90.00	269.400	7451.14	1275.76N	1066.87W	==>	1364.72	1248576.46	3197101.58
8800.00	90.00	269.400	7451.14	1274.71N	1166.87W	==>	1460.92	1248575.41	3197001.59
8900.00	90.00	269.400	7451.14	1273.66N	1266.86W	==>	1557.12	1248574.36	3196901.60
9000.00	90.00	269.400	7451.14	1272.62N	1366.86W	==>	1653.33	1248573.32	3196801.61
9100.00	90.00	269.400	7451.14	1271.57N	1466.85W	==>	1749.53	1248572.27	3196701.62
9200.00	90.00	269.400	7451.14	1270.52N	1566.85W	==>	1845.73	1248571.22	3196601.62

All data is in Feet unless otherwise stated  
Coordinates are from Slot MD's are from Rig ( Planned Datum #1 5034.1ft above Mean Sea Level )  
Vertical Section is from 0.00N 0.00E on azimuth 285.240 degrees  
Bottom hole distance is 4714.31 Feet on azimuth 285.24 degrees from Wellhead  
Calculation method uses Minimum Curvature method  
Prepared by Peterson Energy  
Date Printed: 15-May-2013



INTEGRATED PETROLEUM TECHNOLOGIES, INC  
SYSDRILL  
Well Design Combined Report  
Wellbore: SRC PHELPS #11-32NHZ (PWB)

Interpolated Wellpath									
MD[ft]	Inc[deg]	Azi[deg]	TVD[ft]	North[ft]	East[ft]	Dogleg [deg/100ft]	Vertical Section[ft]	Northing	Easting
9300.00	90.00	269.400	7451.14	1269.47N	1666.84W	==>	1941.93	1248570.17	3196501.63
9400.00	90.00	269.400	7451.14	1268.43N	1766.84W	==>	2038.14	1248569.13	3196401.64
9500.00	90.00	269.400	7451.14	1267.38N	1866.83W	==>	2134.34	1248568.08	3196301.65
9600.00	90.00	269.400	7451.14	1266.33N	1966.83W	==>	2230.54	1248567.03	3196201.66
9700.00	90.00	269.400	7451.14	1265.28N	2066.82W	==>	2326.74	1248565.98	3196101.67
9800.00	90.00	269.400	7451.14	1264.24N	2166.81W	==>	2422.94	1248564.93	3196001.68
9900.00	90.00	269.400	7451.14	1263.19N	2266.81W	==>	2519.15	1248563.89	3195901.69
10000.00	90.00	269.400	7451.14	1262.14N	2366.80W	==>	2615.35	1248562.84	3195801.70
10100.00	90.00	269.400	7451.14	1261.09N	2466.80W	==>	2711.55	1248561.79	3195701.71
10200.00	90.00	269.400	7451.14	1260.05N	2566.79W	==>	2807.75	1248560.74	3195601.72
10300.00	90.00	269.400	7451.14	1259.00N	2666.79W	==>	2903.96	1248559.70	3195501.73
10400.00	90.00	269.400	7451.14	1257.95N	2766.78W	==>	3000.16	1248558.65	3195401.73
10500.00	90.00	269.400	7451.14	1256.90N	2866.78W	==>	3096.36	1248557.60	3195301.74
10600.00	90.00	269.400	7451.14	1255.85N	2966.77W	==>	3192.56	1248556.55	3195201.75
10700.00	90.00	269.400	7451.14	1254.81N	3066.76W	==>	3288.76	1248555.51	3195101.76
10800.00	90.00	269.400	7451.14	1253.76N	3166.76W	==>	3384.97	1248554.46	3195001.77
10900.00	90.00	269.400	7451.14	1252.71N	3266.75W	==>	3481.17	1248553.41	3194901.78
11000.00	90.00	269.400	7451.14	1251.66N	3366.75W	==>	3577.37	1248552.36	3194801.79
11100.00	90.00	269.400	7451.14	1250.62N	3466.74W	==>	3673.57	1248551.32	3194701.80
11200.00	90.00	269.400	7451.14	1249.57N	3566.74W	==>	3769.78	1248550.27	3194601.81
11300.00	90.00	269.400	7451.14	1248.52N	3666.73W	==>	3865.98	1248549.22	3194501.82
11400.00	90.00	269.400	7451.14	1247.47N	3766.73W	==>	3962.18	1248548.17	3194401.83
11500.00	90.00	269.400	7451.14	1246.43N	3866.72W	==>	4058.38	1248547.13	3194301.83
11600.00	90.00	269.400	7451.14	1245.38N	3966.72W	==>	4154.58	1248546.08	3194201.84
11700.00	90.00	269.400	7451.14	1244.33N	4066.71W	==>	4250.79	1248545.03	3194101.85
11800.00	90.00	269.400	7451.14	1243.28N	4166.70W	==>	4346.99	1248543.98	3194001.86
11900.00	90.00	269.400	7451.14	1242.24N	4266.70W	==>	4443.19	1248542.94	3193901.87
12000.00	90.00	269.400	7451.14	1241.19N	4366.69W	==>	4539.39	1248541.89	3193801.88
12100.00	90.00	269.400	7451.14	1240.14N	4466.69W	==>	4635.60	1248540.84	3193701.89
12181.82	90.00	269.400	7451.14	1239.28N	4548.50W	==>	4714.31	1248539.98	3193620.08

All data is in Feet unless otherwise stated  
Coordinates are from Slot MD's are from Rig and TVD's are from Rig ( Planned Datum #1 5034.1ft above Mean Sea Level )  
Vertical Section is from 0.00N 0.00E on azimuth 285.240 degrees  
Bottom hole distance is 4714.31 Feet on azimuth 285.24 degrees from Wellhead  
Calculation method uses Minimum Curvature method  
Prepared by Peterson Energy  
Date Printed: 15-May-2013



INTEGRATED PETROLEUM TECHNOLOGIES, INC  
SYSDRILL  
Well Design Combined Report  
Wellbore: SRC PHELPS #11-32NHZ (PWB)

Hole Sections								
Diameter	Start	Start	Start	Start	End	End	End	End
[in]	MD[ft]	TVD[ft]	North[ft]	East[ft]	MD[ft]	TVD[ft]	North[ft]	East[ft]
13 1/2	16.00	16.00	0.00N	0.00E	1150.00	1145.66	60.52N	15.36E
8 5/8	1150.00	1145.66	60.52N	15.36E	7801.00	7441.33	1283.26N	168.53W
6 1/8	7801.00	7441.33	1283.26N	168.53W	12374.51	7451.14	1237.26N	4741.18W

Casings								
Name	Top	Top	Top	Top	Shoe	Shoe	Shoe	Shoe
	MD[ft]	TVD[ft]	North[ft]	East[ft]	MD[ft]	TVD[ft]	North[ft]	East[ft]
9 5/8in Surface Casing	16.00	16.00	0.00N	0.00E	1150.00	1145.66	60.52N	15.36E
7.0in Intermediate Casing	16.00	16.00	0.00N	0.00E	7801.00	7441.33	1283.26N	168.53W
4 1/2in Production Liner	6990.00	6870.89	1177.19N	298.74E	12374.51		1237.26N	4741.18W

Targets								
Name	North[ft]	East[ft]	TVD[ft]	Latitude	Longitude	Northing	Easting	Last Revised
NR T2-1	1247.28N	4548.49W	7441.14	N40 0 48.8843	W104 48 31.4430	1248547.98	3193620.09	14-May-2013
NR2 T-2	1283.98N	168.09W	7441.14	N40 0 48.9057	W104 47 35.1432	1248584.68	3198000.34	14-May-2013

Survey Tool Program					
Reference	Survey Name	MD[ft]	TVD[ft]	Survey Tool	Error Model
24363	Planned	12181.82	7451.14	WdW Rate Gyro	Standard

Notes

All data is in Feet unless otherwise stated  
Coordinates are from Slot MD's are from Rig and TVD's are from Rig ( Planned Datum #1 5034.1ft above Mean Sea Level )  
Vertical Section is from 0.00N 0.00E on azimuth 285.240 degrees  
Bottom hole distance is 4714.31 Feet on azimuth 285.24 degrees from Wellhead  
Calculation method uses Minimum Curvature method  
Prepared by Peterson Energy  
Date Printed: 15-May-2013



SYSDRILL  
Closest Approach + Clearance Factor Summary Report  
Wellbore: SRC PHELPS #11-32NHZ (PWB)

Ellipse separations are reported ONLY if BOTH wells have uncertainty data  
Only Depth and Magnetic Reference Field error terms are correlated across tie points  
Cutoff is calculated on CENTRE to CENTRE distance

Summary data uses Closest Approach clearance calculation for all minima  
Hole size/Casings ARE included  
Hole size/Casings are NOT subtracted from Centre-Centre distance  
Confidence limit of 95.00% / 2.80 SD.

Wellbore		
Name	Created	Last Revised
SRC PHELPS #11-32NHZ (PWB)	22-Apr-2013	15-May-2013

Well		
Name	Government ID	Last Revised
SRC PHELPS #11-32NHZ		15-May-2013

Slot						
Name	Grid Northing	Grid Easting	Latitude	Longitude	North	East
Slot #3	1247300.7450	3198168.4150	N40 0 36.2041	W104 47 33.1146	4.98N	21.87E

Installation					
Name	Easting	Northing	Coord System Name	North Alignment	
SRC PHELPS	3198146.5430	1247295.7700	CO83-NF on NORTH AMERICAN DATUM 1983 datum	Grid	

Field					
Name	Easting	Northing	Coord System Name	North Alignment	
Wattenberg	3212690.1960	1438741.7551	CO83-NF on NORTH AMERICAN DATUM 1983 datum	Grid	

Clearance Summary										
Offset WellName	Offset Wellbore	Offset Slot	Offset Structure	Separation [ft]	MD[ft]	Diverging From[ft]	Ellipse Separation [ft]	Ellipse MD[ft]	Clearance Factor	Clearance MD[ft]
SRC PHELPS #11-32CHZ	SRC PHELPS #11-32CHZ (PWB)	Slot #5	SRC PHELPS	20.29	874.24	12181.82	17.89	901.83	4.16	12181.82
SRC PHELPS #J-32CHZ	SRC PHELPS #J-32CHZ (PWB)	Slot #1	SRC PHELPS	20.73	721.38	721.38	18.60	737.78	6.19	12181.82
SRC PHELPS #13-32CHZ	SRC PHELPS #13-32CHZ (PWB)	Slot #4	SRC PHELPS	22.50	550.00	12181.82	20.67	550.00	12.19	573.74
SRC PHELPLS #13-32NHZ	SRC PHELPLS #13-32NHZ (PWB)	Slot #6	SRC PHELPS	28.24	550.00	12181.82	26.40	557.34	14.59	672.17
SRC PHELPS #B-32CHZ	SRC PHELPS #B-32CHZ (PWB)	Slot #2	SRC PHELPS	35.11	442.51	12181.82	33.45	442.51	19.88	573.74
SRC PHELPS #A-32NHZ	SRC PHELPS #A-32NHZ (PWB)	Slot #7	SRC PHELPS	40.87	883.89	12181.82	38.49	885.42	7.87	12181.82
SRC PHELPS #K-32CHZ	SRC PHELPS #K-32CHZ (PWB)	Slot #8	SRC PHELPS	45.74	573.74	12181.82	43.83	639.36	21.33	803.40
SRC PHELPS #A-32CHZ	SRC PHELPS #A-32CHZ (PWB)	Slot #9	SRC PHELPS	68.19	960.79	12181.82	65.65	983.85	10.29	12181.82
SRC PHELPS #K-32NHZ	SRC PHELPS #K-32NHZ (PWB)	Slot #10	SRC PHELPS	72.88	819.81	12181.82	70.60	836.21	23.74	12181.82

All data is in Feet unless otherwise stated  
Coordinates are from Slot MD's are from Rig and TVD's are from Rig ( Planned Datum #1 5034.1ft above Mean Sea Level )  
Vertical Section is from 0.00N 0.00E on azimuth 285.240 degrees  
Prepared by Peterson Energy  
Date Printed: 15-May-2013



SYSDRILL  
Closest Approach + Clearance Factor Summary Report  
Wellbore: SRC PHELPS #11-32NHZ (PWB)

Clearance Summary										
Offset WellName	Offset Wellbore	Offset Slot	Offset Structure	Separation [ft]	MD[ft]	Diverging From[ft]	Ellipse Separation [ft]	Ellipse MD[ft]	Clearance Factor	Clearance MD[ft]
SRC PHELPS #12-32NHZ	SRC PHELPS #12-32NHZ (PWB)	Slot #11	SRC PHELPS	90.40	926.35	12181.82	87.93	951.04	15.46	12181.82
SRC PHELPS #12-32CHZ	SRC PHELPS #12-32CHZ (PWB)	Slot #12	SRC PHELPS	93.21	874.48	12181.82	90.84	874.48	17.98	12181.82
EMMA DELVENT HAL GAS UNIT #1	EMMA DELVENTHAL GAS UNIT #1 (AWB)	EMMA DELVENT HAL GAS UNIT #1	SRC PHELPS OFFSETS	806.06	557.34	8449.87	797.99	606.55	38.40	8480.57