

# SYNERGY RESOURCES

Location	Weld County, CO, USA(Imported)	Slot	Slot #7
Field	Wattenberg	Well	SRC PHELPS #A-32NHZ
Installation	SRC PHELPS	Wellbore	SRC PHELPS #A-32NHZ (PWB)

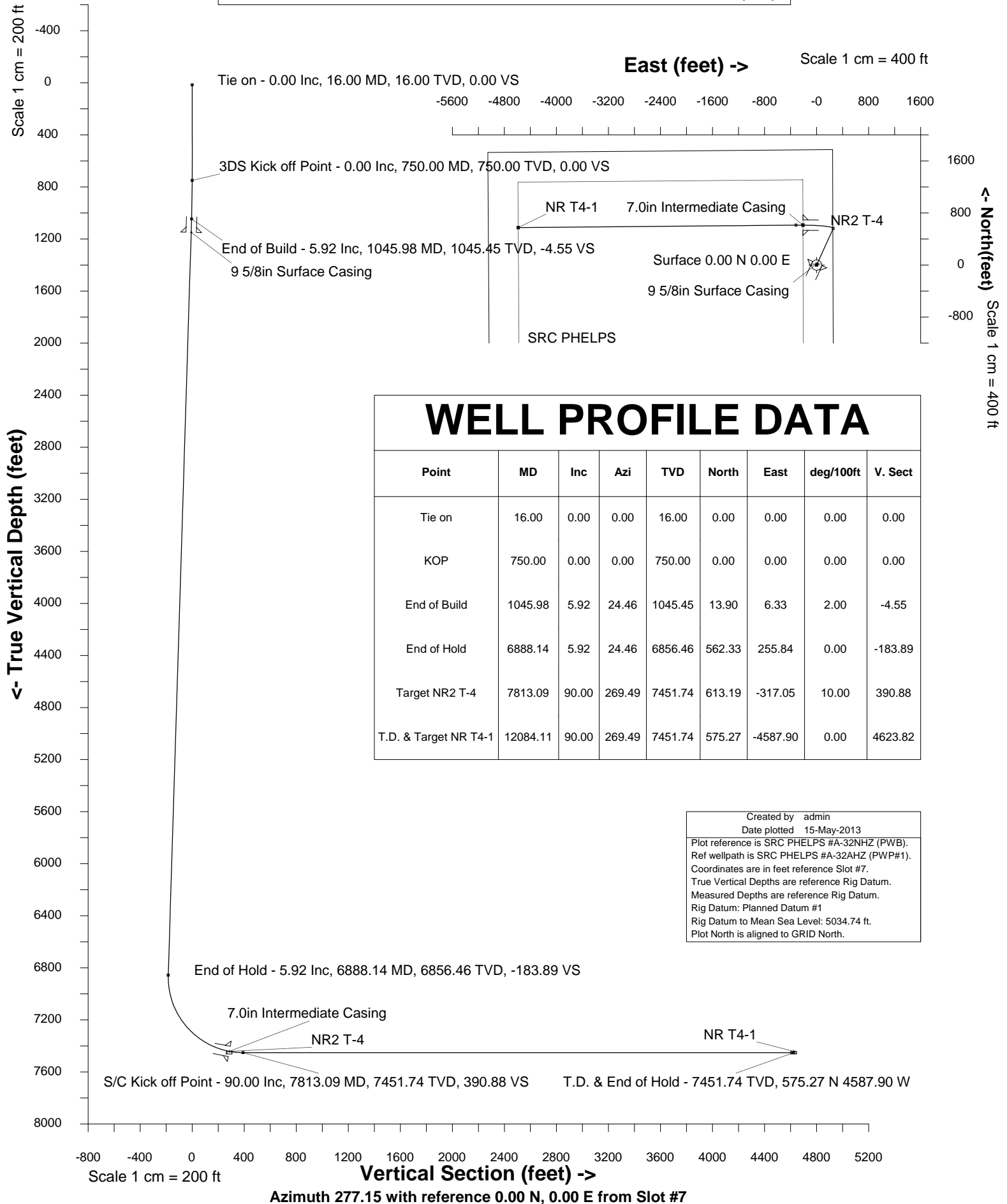



INTEGRATED PETROLEUM TECHNOLOGIES, INC  
SYSDRILL  
Well Design Combined Report  
Wellbore: SRC PHELPS #A-32NHZ (PWB)

Wellhead Details							
Name	Northing	Easting	Latitude	Longitude	North	East	Elevation Above Inst.
Slot #7	1247310.5810	3198212.3120	N40 0 36.2979	W104 47 32.5495	14.81N	65.77E	0.80

Declination			
Date	Source	Time	
18-Apr-2013	IGRF Model [1900.0-2015.0]		16:06

Site Details				
Name	Northing	Easting	Coord System Name	North Alignment
SRC PHELPS	1247295.7700	3198146.5430	CO83-NF on NORTH AMERICAN DATUM 1983 datum	Grid

Summary Wellpath									
MD[ft]	Inc[deg]	Azi[deg]	TVD[ft]	North[ft]	East[ft]	Dogleg [deg/100ft]	Vertical Section[ft]	Northing	Easting
16.00	0.00	0.000	16.00	0.00N	0.00E		0.00	1247310.58	3198212.31
750.00	0.00	0.000	750.00	0.00N	0.00E	==>	0.00	1247310.58	3198212.31
1045.98	5.92	24.460	1045.45	13.90N	6.33E	2.00	-4.55	1247324.49	3198218.64
6888.14	5.92	24.460	6856.46	562.33N	255.84E	==>	-183.89	1247872.89	3198468.14
7813.09	90.00	269.490	7451.74	613.19N	317.05W	10.00	390.88	1247923.75	3197895.28
12084.11	90.00	269.490	7451.74	575.27N	4587.90W	==>	4623.82	1247885.84	3193624.58

Interpolated Wellpath									
MD[ft]	Inc[deg]	Azi[deg]	TVD[ft]	North[ft]	East[ft]	Dogleg [deg/100ft]	Vertical Section[ft]	Northing	Easting
0.00	0.00	0.000	0.00	0.00N	0.00E		0.00	1247310.58	3198212.31
16.00	0.00	0.000	16.00	0.00N	0.00E	==>	0.00	1247310.58	3198212.31
100.00	0.00	0.000	100.00	0.00N	0.00E	==>	0.00	1247310.58	3198212.31
200.00	0.00	0.000	200.00	0.00N	0.00E	==>	0.00	1247310.58	3198212.31
300.00	0.00	0.000	300.00	0.00N	0.00E	==>	0.00	1247310.58	3198212.31
400.00	0.00	0.000	400.00	0.00N	0.00E	==>	0.00	1247310.58	3198212.31
500.00	0.00	0.000	500.00	0.00N	0.00E	==>	0.00	1247310.58	3198212.31
600.00	0.00	0.000	600.00	0.00N	0.00E	==>	0.00	1247310.58	3198212.31
700.00	0.00	0.000	700.00	0.00N	0.00E	==>	0.00	1247310.58	3198212.31
734.00	0.00	0.000	734.00	0.00N	0.00E	==>	0.00	1247310.58	3198212.31
750.00	0.00	0.000	750.00	0.00N	0.00E	==>	0.00	1247310.58	3198212.31
834.00	1.68	24.460	833.99	1.12N	0.51E	2.00	-0.37	1247311.70	3198212.82
934.00	3.68	24.460	933.87	5.38N	2.45E	2.00	-1.76	1247315.96	3198214.76
1034.00	5.68	24.460	1033.54	12.80N	5.82E	2.00	-4.19	1247323.38	3198218.14
1045.98	5.92	24.460	1045.45	13.90N	6.33E	2.00	-4.55	1247324.49	3198218.64
1100.00	5.92	24.460	1099.19	18.98N	8.63E	==>	-6.21	1247329.56	3198220.95
1200.00	5.92	24.460	1198.65	28.36N	12.90E	==>	-9.28	1247338.94	3198225.22
1300.00	5.92	24.460	1298.12	37.75N	17.18E	==>	-12.35	1247348.33	3198229.49
1400.00	5.92	24.460	1397.59	47.14N	21.45E	==>	-15.41	1247357.72	3198233.76
1500.00	5.92	24.460	1497.05	56.53N	25.72E	==>	-18.48	1247367.10	3198238.03
1600.00	5.92	24.460	1596.52	65.91N	29.99E	==>	-21.55	1247376.49	3198242.30
1700.00	5.92	24.460	1695.99	75.30N	34.26E	==>	-24.62	1247385.88	3198246.57
1800.00	5.92	24.460	1795.45	84.69N	38.53E	==>	-27.69	1247395.26	3198250.84
1900.00	5.92	24.460	1894.92	94.07N	42.80E	==>	-30.76	1247404.65	3198255.11
2000.00	5.92	24.460	1994.39	103.46N	47.07E	==>	-33.83	1247414.04	3198259.38
2100.00	5.92	24.460	2093.85	112.85N	51.34E	==>	-36.90	1247423.43	3198263.65
2200.00	5.92	24.460	2193.32	122.24N	55.61E	==>	-39.97	1247432.81	3198267.92
2300.00	5.92	24.460	2292.79	131.62N	59.88E	==>	-43.04	1247442.20	3198272.19
2400.00	5.92	24.460	2392.25	141.01N	64.16E	==>	-46.11	1247451.59	3198276.47
2500.00	5.92	24.460	2491.72	150.40N	68.43E	==>	-49.18	1247460.97	3198280.74
2600.00	5.92	24.460	2591.19	159.79N	72.70E	==>	-52.25	1247470.36	3198285.01
2700.00	5.92	24.460	2690.65	169.17N	76.97E	==>	-55.32	1247479.75	3198289.28
2800.00	5.92	24.460	2790.12	178.56N	81.24E	==>	-58.39	1247489.13	3198293.55
2900.00	5.92	24.460	2889.59	187.95N	85.51E	==>	-61.46	1247498.52	3198297.82
3000.00	5.92	24.460	2989.05	197.33N	89.78E	==>	-64.53	1247507.91	3198302.09
3100.00	5.92	24.460	3088.52	206.72N	94.05E	==>	-67.60	1247517.30	3198306.36
3200.00	5.92	24.460	3187.99	216.11N	98.32E	==>	-70.67	1247526.68	3198310.63

All data is in Feet unless otherwise stated  
Coordinates are from Slot MD's are from Rig and TVD's are from Rig ( Planned Datum #1 5034.7ft above Mean Sea Level )  
Vertical Section is from 0.00N 0.00E on azimuth 277.150 degrees  
Bottom hole distance is 4623.82 Feet on azimuth 277.15 degrees from Wellhead  
Calculation method uses Minimum Curvature method  
Prepared by Peterson Energy  
Date Printed: 15-May-2013



INTEGRATED PETROLEUM TECHNOLOGIES, INC  
SYSDRILL

Well Design Combined Report  
Wellbore: SRC PHELPS #A-32NHZ (PWB)

Interpolated Wellpath									
MD[ft]	Inc[deg]	Azi[deg]	TVD[ft]	North[ft]	East[ft]	Dogleg [deg/100ft]	Vertical Section[ft]	Northing	Easting
3300.00	5.92	24.460	3287.45	225.50N	102.59E	==>	-73.74	1247536.07	3198314.90
3400.00	5.92	24.460	3386.92	234.88N	106.86E	==>	-76.81	1247545.46	3198319.17
3500.00	5.92	24.460	3486.39	244.27N	111.14E	==>	-79.88	1247554.84	3198323.44
3600.00	5.92	24.460	3585.85	253.66N	115.41E	==>	-82.95	1247564.23	3198327.71
3700.00	5.92	24.460	3685.32	263.05N	119.68E	==>	-86.02	1247573.62	3198331.99
3800.00	5.92	24.460	3784.79	272.43N	123.95E	==>	-89.09	1247583.00	3198336.26
3900.00	5.92	24.460	3884.26	281.82N	128.22E	==>	-92.16	1247592.39	3198340.53
4000.00	5.92	24.460	3983.72	291.21N	132.49E	==>	-95.23	1247601.78	3198344.80
4100.00	5.92	24.460	4083.19	300.60N	136.76E	==>	-98.30	1247611.17	3198349.07
4200.00	5.92	24.460	4182.66	309.98N	141.03E	==>	-101.37	1247620.55	3198353.34
4300.00	5.92	24.460	4282.12	319.37N	145.30E	==>	-104.44	1247629.94	3198357.61
4400.00	5.92	24.460	4381.59	328.76N	149.57E	==>	-107.51	1247639.33	3198361.88
4500.00	5.92	24.460	4481.06	338.14N	153.84E	==>	-110.58	1247648.71	3198366.15
4600.00	5.92	24.460	4580.52	347.53N	158.12E	==>	-113.65	1247658.10	3198370.42
4700.00	5.92	24.460	4679.99	356.92N	162.39E	==>	-116.72	1247667.49	3198374.69
4800.00	5.92	24.460	4779.46	366.31N	166.66E	==>	-119.79	1247676.87	3198378.96
4900.00	5.92	24.460	4878.92	375.69N	170.93E	==>	-122.86	1247686.26	3198383.23
5000.00	5.92	24.460	4978.39	385.08N	175.20E	==>	-125.93	1247695.65	3198387.51
5100.00	5.92	24.460	5077.86	394.47N	179.47E	==>	-129.00	1247705.04	3198391.78
5200.00	5.92	24.460	5177.32	403.86N	183.74E	==>	-132.07	1247714.42	3198396.05
5300.00	5.92	24.460	5276.79	413.24N	188.01E	==>	-135.14	1247723.81	3198400.32
5400.00	5.92	24.460	5376.26	422.63N	192.28E	==>	-138.21	1247733.20	3198404.59
5500.00	5.92	24.460	5475.72	432.02N	196.55E	==>	-141.28	1247742.58	3198408.86
5600.00	5.92	24.460	5575.19	441.40N	200.83E	==>	-144.35	1247751.97	3198413.13
5700.00	5.92	24.460	5674.66	450.79N	205.10E	==>	-147.42	1247761.36	3198417.40
5800.00	5.92	24.460	5774.12	460.18N	209.37E	==>	-150.49	1247770.74	3198421.67
5900.00	5.92	24.460	5873.59	469.57N	213.64E	==>	-153.56	1247780.13	3198425.94
6000.00	5.92	24.460	5973.06	478.95N	217.91E	==>	-156.63	1247789.52	3198430.21
6100.00	5.92	24.460	6072.52	488.34N	222.18E	==>	-159.70	1247798.90	3198434.48
6200.00	5.92	24.460	6171.99	497.73N	226.45E	==>	-162.77	1247808.29	3198438.75
6300.00	5.92	24.460	6271.46	507.12N	230.72E	==>	-165.84	1247817.68	3198443.03
6400.00	5.92	24.460	6370.92	516.50N	234.99E	==>	-168.91	1247827.07	3198447.30
6500.00	5.92	24.460	6470.39	525.89N	239.26E	==>	-171.98	1247836.45	3198451.57
6600.00	5.92	24.460	6569.86	535.28N	243.53E	==>	-175.05	1247845.84	3198455.84
6700.00	5.92	24.460	6669.32	544.67N	247.81E	==>	-178.12	1247855.23	3198460.11
6800.00	5.92	24.460	6768.79	554.05N	252.08E	==>	-181.19	1247864.61	3198464.38
6888.14	5.92	24.460	6856.46	562.33N	255.84E	==>	-183.89	1247872.89	3198468.14
6900.00	5.53	13.220	6868.26	563.44N	256.22E	10.00	-184.13	1247874.00	3198468.53
7000.00	10.20	300.970	6967.49	572.71N	249.71E	10.00	-176.52	1247883.27	3198462.02
7100.00	19.42	284.950	7064.10	581.58N	226.00E	10.00	-151.88	1247892.14	3198438.30
7200.00	29.15	279.190	7155.16	589.78N	185.79E	10.00	-110.97	1247900.34	3198398.10
7300.00	39.00	276.160	7237.89	597.06N	130.32E	10.00	-55.03	1247907.62	3198342.63
7400.00	48.91	274.190	7309.79	603.21N	61.28E	10.00	14.25	1247913.77	3198273.59
7500.00	58.84	272.750	7368.67	608.03N	19.25W	10.00	94.75	1247918.59	3198193.06
7600.00	68.79	271.580	7412.74	611.38N	108.81W	10.00	184.03	1247921.94	3198103.51
7700.00	78.74	270.560	7440.66	613.15N	204.68W	10.00	279.38	1247923.71	3198007.64
7800.00	88.70	269.610	7451.59	613.30N	303.96W	10.00	377.90	1247923.85	3197908.37
7813.09	90.00	269.490	7451.74	613.19N	317.05W	10.00	390.88	1247923.75	3197895.28
7900.00	90.00	269.490	7451.74	612.42N	403.95W	==>	477.01	1247922.98	3197808.37
8000.00	90.00	269.490	7451.74	611.53N	503.95W	==>	576.12	1247922.09	3197708.38
8100.00	90.00	269.490	7451.74	610.65N	603.94W	==>	675.23	1247921.21	3197608.39
8200.00	90.00	269.490	7451.74	609.76N	703.94W	==>	774.33	1247920.32	3197508.40
8300.00	90.00	269.490	7451.74	608.87N	803.94W	==>	873.44	1247919.43	3197408.40
8400.00	90.00	269.490	7451.74	607.98N	903.93W	==>	972.55	1247918.54	3197308.41
8500.00	90.00	269.490	7451.74	607.10N	1003.93W	==>	1071.66	1247917.65	3197208.42
8600.00	90.00	269.490	7451.74	606.21N	1103.92W	==>	1170.77	1247916.77	3197108.43
8700.00	90.00	269.490	7451.74	605.32N	1203.92W	==>	1269.88	1247915.88	3197008.44
8800.00	90.00	269.490	7451.74	604.43N	1303.92W	==>	1368.99	1247914.99	3196908.44
8900.00	90.00	269.490	7451.74	603.54N	1403.91W	==>	1468.09	1247914.10	3196808.45
9000.00	90.00	269.490	7451.74	602.66N	1503.91W	==>	1567.20	1247913.22	3196708.46
9100.00	90.00	269.490	7451.74	601.77N	1603.90W	==>	1666.31	1247912.33	3196608.47

All data is in Feet unless otherwise stated  
Coordinates are from Slot MD's are from Rig ( Planned Datum #1 5034.7ft above Mean Sea Level )  
Vertical Section is from 0.00N 0.00E on azimuth 277.150 degrees  
Bottom hole distance is 4623.82 Feet on azimuth 277.15 degrees from Wellhead  
Calculation method uses Minimum Curvature method  
Prepared by Peterson Energy  
Date Printed: 15-May-2013



INTEGRATED PETROLEUM TECHNOLOGIES, INC  
SYSDRILL  
Well Design Combined Report  
Wellbore: SRC PHELPS #A-32NHZ (PWB)

Interpolated Wellpath									
MD[ft]	Inc[deg]	Azi[deg]	TVD[ft]	North[ft]	East[ft]	Dogleg [deg/100ft]	Vertical Section[ft]	Northing	Easting
9200.00	90.00	269.490	7451.74	600.88N	1703.90W	==>	1765.42	1247911.44	3196508.47
9300.00	90.00	269.490	7451.74	599.99N	1803.90W	==>	1864.53	1247910.55	3196408.48
9400.00	90.00	269.490	7451.74	599.10N	1903.89W	==>	1963.64	1247909.66	3196308.49
9500.00	90.00	269.490	7451.74	598.22N	2003.89W	==>	2062.75	1247908.78	3196208.50
9600.00	90.00	269.490	7451.74	597.33N	2103.89W	==>	2161.86	1247907.89	3196108.50
9700.00	90.00	269.490	7451.74	596.44N	2203.88W	==>	2260.96	1247907.00	3196008.51
9800.00	90.00	269.490	7451.74	595.55N	2303.88W	==>	2360.07	1247906.11	3195908.52
9900.00	90.00	269.490	7451.74	594.67N	2403.87W	==>	2459.18	1247905.23	3195808.53
10000.00	90.00	269.490	7451.74	593.78N	2503.87W	==>	2558.29	1247904.34	3195708.53
10100.00	90.00	269.490	7451.74	592.89N	2603.87W	==>	2657.40	1247903.45	3195608.54
10200.00	90.00	269.490	7451.74	592.00N	2703.86W	==>	2756.51	1247902.56	3195508.55
10300.00	90.00	269.490	7451.74	591.11N	2803.86W	==>	2855.62	1247901.67	3195408.56
10400.00	90.00	269.490	7451.74	590.23N	2903.85W	==>	2954.72	1247900.79	3195308.56
10500.00	90.00	269.490	7451.74	589.34N	3003.85W	==>	3053.83	1247899.90	3195208.57
10600.00	90.00	269.490	7451.74	588.45N	3103.85W	==>	3152.94	1247899.01	3195108.58
10700.00	90.00	269.490	7451.74	587.56N	3203.84W	==>	3252.05	1247898.12	3195008.59
10800.00	90.00	269.490	7451.74	586.68N	3303.84W	==>	3351.16	1247897.24	3194908.59
10900.00	90.00	269.490	7451.74	585.79N	3403.83W	==>	3450.27	1247896.35	3194808.60
11000.00	90.00	269.490	7451.74	584.90N	3503.83W	==>	3549.38	1247895.46	3194708.61
11100.00	90.00	269.490	7451.74	584.01N	3603.83W	==>	3648.49	1247894.57	3194608.62
11200.00	90.00	269.490	7451.74	583.12N	3703.82W	==>	3747.59	1247893.68	3194508.62
11300.00	90.00	269.490	7451.74	582.24N	3803.82W	==>	3846.70	1247892.80	3194408.63
11400.00	90.00	269.490	7451.74	581.35N	3903.81W	==>	3945.81	1247891.91	3194308.64
11500.00	90.00	269.490	7451.74	580.46N	4003.81W	==>	4044.92	1247891.02	3194208.65
11600.00	90.00	269.490	7451.74	579.57N	4103.81W	==>	4144.03	1247890.13	3194108.66
11700.00	90.00	269.490	7451.74	578.69N	4203.80W	==>	4243.14	1247889.25	3194008.66
11800.00	90.00	269.490	7451.74	577.80N	4303.80W	==>	4342.25	1247888.36	3193908.67
11900.00	90.00	269.490	7451.74	576.91N	4403.79W	==>	4441.35	1247887.47	3193808.68
12000.00	90.00	269.490	7451.74	576.02N	4503.79W	==>	4540.46	1247886.58	3193708.69
12084.11	90.00	269.490	7451.74	575.27N	4587.90W	==>	4623.82	1247885.84	3193624.58

All data is in Feet unless otherwise stated  
Coordinates are from Slot MD's are from Rig and TVD's are from Rig ( Planned Datum #1 5034.7ft above Mean Sea Level )  
Vertical Section is from 0.00N 0.00E on azimuth 277.150 degrees  
Bottom hole distance is 4623.82 Feet on azimuth 277.15 degrees from Wellhead  
Calculation method uses Minimum Curvature method  
Prepared by Peterson Energy  
Date Printed: 15-May-2013



INTEGRATED PETROLEUM TECHNOLOGIES, INC  
SYSDRILL  
Well Design Combined Report  
Wellbore: SRC PHELPS #A-32NHZ (PWB)

Hole Sections								
Diameter	Start	Start	Start	Start	End	End	End	End
[in]	MD[ft]	TVD[ft]	North[ft]	East[ft]	MD[ft]	TVD[ft]	North[ft]	East[ft]
13 1/2	16.00	16.00	0.00N	0.00E	1150.00	1148.92	23.67N	10.77E
8 5/8	1150.00	1148.92	23.67N	10.77E	7706.00	7441.80	613.21N	210.57W
6 1/8	7706.00	7441.80	613.21N	210.57W	12084.11	7451.74	575.27N	4587.90W

Casings								
Name	Top	Top	Top	Top	Shoe	Shoe	Shoe	Shoe
	MD[ft]	TVD[ft]	North[ft]	East[ft]	MD[ft]	TVD[ft]	North[ft]	East[ft]
9 5/8in Surface Casing	16.00	16.00	0.00N	0.00E	1150.00	1148.92	23.67N	10.77E
7.0in Intermediate Casing	16.00	16.00	0.00N	0.00E	7706.00	7441.80	613.21N	210.57W
4 1/2in Production Liner	6900.00	6868.26	563.44N	256.22E	12084.11	7451.74	575.27N	4587.90W

Targets								
Name	North[ft]	East[ft]	TVD[ft]	Latitude	Longitude	Northing	Easting	Last Revised
NR T4-1	575.27N	4587.90W	7441.74	N40 0 42.3403	W104 48 31.4515	1247885.84	3193624.58	14-May-2013
NR2 T-4	613.12N	210.05W	7441.74	N40 0 42.3733	W104 47 35.1860	1247923.68	3198002.27	14-May-2013

Survey Tool Program					
Reference	Survey Name	MD[ft]	TVD[ft]	Survey Tool	Error Model
24434	Planned	12084.11	7451.74	WdW Rate Gyro	Standard

Notes

All data is in Feet unless otherwise stated  
Coordinates are from Slot MD's are from Rig and TVD's are from Rig ( Planned Datum #1 5034.7ft above Mean Sea Level )  
Vertical Section is from 0.00N 0.00E on azimuth 277.150 degrees  
Bottom hole distance is 4623.82 Feet on azimuth 277.15 degrees from Wellhead  
Calculation method uses Minimum Curvature method  
Prepared by Peterson Energy  
Date Printed: 15-May-2013



SYSDRILL  
Closest Approach + Clearance Factor Summary Report  
Wellbore: SRC PHELPS #A-32NHZ (PWB)

Ellipse separations are reported ONLY if BOTH wells have uncertainty data  
Only Depth and Magnetic Reference Field error terms are correlated across tie points  
Cutoff is calculated on CENTRE to CENTRE distance

Summary data uses Closest Approach clearance calculation for all minima  
Hole size/Casings ARE included  
Hole size/Casings are NOT subtracted from Centre-Centre distance  
Confidence limit of 95.00% / 2.80 SD.

Wellbore		
Name	Created	Last Revised
SRC PHELPS #A-32NHZ (PWB)	22-Apr-2013	15-May-2013

Well		
Name	Government ID	Last Revised
SRC PHELPS #A-32NHZ		15-May-2013

Slot						
Name	Grid Northing	Grid Easting	Latitude	Longitude	North	East
Slot #7	1247310.5810	3198212.3120	N40 0 36.2979	W104 47 32.5495	14.81N	65.77E

Installation					
Name	Easting	Northing	Coord System Name	North Alignment	
SRC PHELPS	3198146.5430	1247295.7700	CO83-NF on NORTH AMERICAN DATUM 1983 datum	Grid	

Field					
Name	Easting	Northing	Coord System Name	North Alignment	
Wattenberg	3212690.1960	1438741.7551	CO83-NF on NORTH AMERICAN DATUM 1983 datum	Grid	

Clearance Summary										
Offset WellName	Offset Wellbore	Offset Slot	Offset Structure	Separation [ft]	MD[ft]	Diverging From[ft]	Ellipse Separation [ft]	Ellipse MD[ft]	Clearance Factor	Clearance MD[ft]
SRC PHELPS #11-32CHZ	SRC PHELPS #11-32CHZ (PWB)	Slot #5	SRC PHELPS	20.71	869.02	12084.11	18.34	901.83	6.81	12084.11
SRC PHELPS #K-32CHZ	SRC PHELPS #K-32CHZ (PWB)	Slot #8	SRC PHELPS	22.50	750.00	750.00	20.36	750.00	10.40	770.59
SRC PHELPS #A-32CHZ	SRC PHELPS #A-32CHZ (PWB)	Slot #9	SRC PHELPS	26.38	1197.10	12084.11	23.58	1147.89	4.19	12084.11
SRC PHELPS #K-32NHZ	SRC PHELPS #K-32NHZ (PWB)	Slot #10	SRC PHELPS	33.69	754.19	754.19	31.49	819.81	14.45	901.83
SRC PHELPLS #13-32NHZ	SRC PHELPLS #13-32NHZ (PWB)	Slot #6	SRC PHELPS	34.99	639.36	639.36	33.02	655.76	16.83	754.19
SRC PHELPS #11-32NHZ	SRC PHELPS #11-32NHZ (PWB)	Slot #3	SRC PHELPS	40.87	871.35	12084.11	38.48	885.42	7.87	12084.11
SRC PHELPS #12-32NHZ	SRC PHELPS #12-32NHZ (PWB)	Slot #11	SRC PHELPS	50.29	1065.87	1065.87	47.62	1065.87	7.60	12084.11
SRC PHELPS #12-32CHZ	SRC PHELPS #12-32CHZ (PWB)	Slot #12	SRC PHELPS	52.49	883.05	12084.11	50.13	883.05	10.34	12084.11
SRC PHELPS #13-32CHZ	SRC PHELPS #13-32CHZ (PWB)	Slot #4	SRC PHELPS	54.46	540.93	540.93	52.64	557.34	26.03	12084.11

All data is in Feet unless otherwise stated  
Coordinates are from Slot MD's are from Rig and TVD's are from Rig ( Planned Datum #1 5034.7ft above Mean Sea Level )  
Vertical Section is from 0.00N 0.00E on azimuth 277.150 degrees  
Prepared by Peterson Energy  
Date Printed: 15-May-2013



SYSDRILL  
Closest Approach + Clearance Factor Summary Report  
Wellbore: SRC PHELPS #A-32NHZ (PWB)

Clearance Summary										
Offset WellName	Offset Wellbore	Offset Slot	Offset Structure	Separation [ft]	MD[ft]	Diverging From[ft]	Ellipse Separation [ft]	Ellipse MD[ft]	Clearance Factor	Clearance MD[ft]
SRC PHELPS #J-32CHZ	SRC PHELPS #J-32CHZ (PWB)	Slot #1	SRC PHELPS	61.83	829.81	829.81	59.51	836.21	13.47	12084.11
SRC PHELPS #B-32CHZ	SRC PHELPS #B-32CHZ (PWB)	Slot #2	SRC PHELPS	75.61	442.51	442.51	73.94	458.91	33.05	12084.11
EMMA DELVENT HAL GAS UNIT #1	EMMA DELVENTHAL GAS UNIT #1 (AWB)	EMMA DELVENT HAL GAS UNIT #1	SRC PHELPS OFFSETS	693.07	8349.33	8349.33	657.96	8349.33	19.73	8365.74