

SYNERGY RESOURCES

Location	Weld County, CO, USA(Imported)	Slot	Slot #9
Field	Wattenberg	Well	SRC PHELPS #A-32CHZ
Installation	SRC PHELPS	Wellbore	SRC PHELPS #A-32CHZ (PWB)

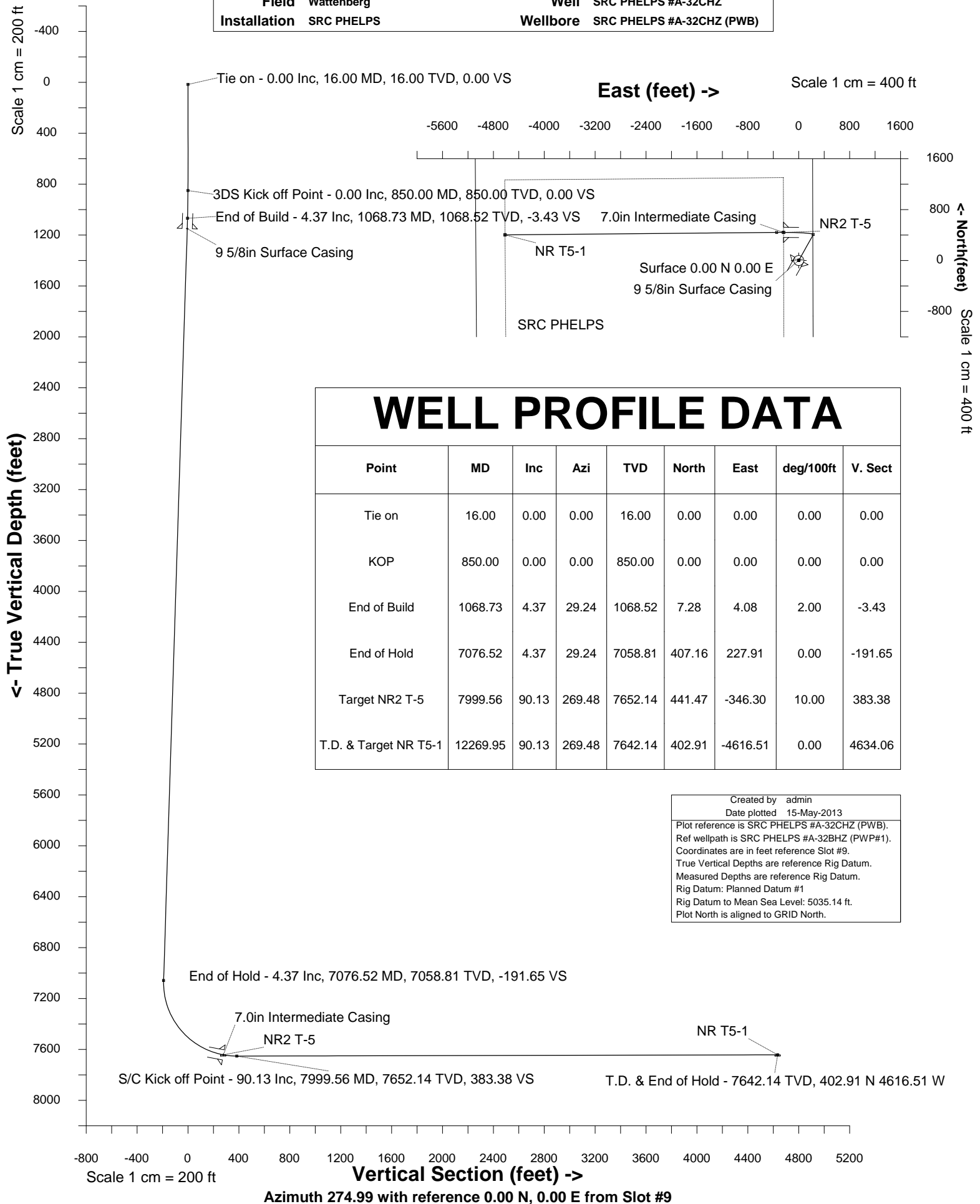



INTEGRATED PETROLEUM TECHNOLOGIES, INC
SYSDRILL
Well Design Combined Report
Wellbore: SRC PHELPS #A-32CHZ (PWB)

Wellhead Details							
Name	Northing	Easting	Latitude	Longitude	North	East	Elevation Above Inst.
Slot #9	1247317.3390	3198242.0500	N40 0 36.3623	W104 47 32.1666	21.57N	95.51E	1.20

Declination			
Date	Source	Time	
18-Apr-2013	IGRF Model [1900.0-2015.0]		16:06

Site Details				
Name	Northing	Easting	Coord System Name	North Alignment
SRC PHELPS	1247295.7700	3198146.5430	CO83-NF on NORTH AMERICAN DATUM 1983 datum	Grid

Summary Wellpath									
MD[ft]	Inc[deg]	Azi[deg]	TVD[ft]	North[ft]	East[ft]	Dogleg [deg/100ft]	Vertical Section[ft]	Northing	Easting
16.00	0.00	0.000	16.00	0.00N	0.00E		0.00	1247317.34	3198242.05
850.00	0.00	0.000	850.00	0.00N	0.00E	==>	0.00	1247317.34	3198242.05
1068.73	4.37	29.240	1068.52	7.28N	4.08E	2.00	-3.43	1247324.62	3198246.13
7076.52	4.37	29.240	7058.81	407.16N	227.91E	==>	-191.65	1247724.48	3198469.96
7999.56	90.13	269.480	7652.14	441.47N	346.30W	10.00	383.38	1247758.79	3197895.76
12269.95	90.13	269.480	7642.14	402.91N	4616.51W	==>	4634.06	1247720.24	3193625.71

Interpolated Wellpath									
MD[ft]	Inc[deg]	Azi[deg]	TVD[ft]	North[ft]	East[ft]	Dogleg [deg/100ft]	Vertical Section[ft]	Northing	Easting
0.00	0.00	0.000	0.00	0.00N	0.00E		0.00	1247317.34	3198242.05
16.00	0.00	0.000	16.00	0.00N	0.00E	==>	0.00	1247317.34	3198242.05
100.00	0.00	0.000	100.00	0.00N	0.00E	==>	0.00	1247317.34	3198242.05
200.00	0.00	0.000	200.00	0.00N	0.00E	==>	0.00	1247317.34	3198242.05
300.00	0.00	0.000	300.00	0.00N	0.00E	==>	0.00	1247317.34	3198242.05
400.00	0.00	0.000	400.00	0.00N	0.00E	==>	0.00	1247317.34	3198242.05
500.00	0.00	0.000	500.00	0.00N	0.00E	==>	0.00	1247317.34	3198242.05
600.00	0.00	0.000	600.00	0.00N	0.00E	==>	0.00	1247317.34	3198242.05
700.00	0.00	0.000	700.00	0.00N	0.00E	==>	0.00	1247317.34	3198242.05
800.00	0.00	0.000	800.00	0.00N	0.00E	==>	0.00	1247317.34	3198242.05
834.00	0.00	0.000	834.00	0.00N	0.00E	==>	0.00	1247317.34	3198242.05
850.00	0.00	0.000	850.00	0.00N	0.00E	==>	0.00	1247317.34	3198242.05
934.00	1.68	29.240	933.99	1.07N	0.60E	2.00	-0.51	1247318.41	3198242.65
1034.00	3.68	29.240	1033.87	5.15N	2.89E	2.00	-2.43	1247322.49	3198244.94
1068.73	4.37	29.240	1068.52	7.28N	4.08E	2.00	-3.43	1247324.62	3198246.13
1100.00	4.37	29.240	1099.70	9.36N	5.24E	==>	-4.41	1247326.70	3198247.29
1200.00	4.37	29.240	1199.41	16.02N	8.97E	==>	-7.54	1247333.36	3198251.02
1300.00	4.37	29.240	1299.11	22.68N	12.69E	==>	-10.67	1247340.01	3198254.74
1400.00	4.37	29.240	1398.82	29.33N	16.42E	==>	-13.81	1247346.67	3198258.47
1500.00	4.37	29.240	1498.53	35.99N	20.14E	==>	-16.94	1247353.33	3198262.19
1600.00	4.37	29.240	1598.24	42.64N	23.87E	==>	-20.07	1247359.98	3198265.92
1700.00	4.37	29.240	1697.95	49.30N	27.60E	==>	-23.21	1247366.64	3198269.65
1800.00	4.37	29.240	1797.66	55.96N	31.32E	==>	-26.34	1247373.29	3198273.37
1900.00	4.37	29.240	1897.37	62.61N	35.05E	==>	-29.47	1247379.95	3198277.10
2000.00	4.37	29.240	1997.07	69.27N	38.77E	==>	-32.60	1247386.60	3198280.82
2100.00	4.37	29.240	2096.78	75.92N	42.50E	==>	-35.74	1247393.26	3198284.55
2200.00	4.37	29.240	2196.49	82.58N	46.23E	==>	-38.87	1247399.92	3198288.27
2300.00	4.37	29.240	2296.20	89.23N	49.95E	==>	-42.00	1247406.57	3198292.00
2400.00	4.37	29.240	2395.91	95.89N	53.68E	==>	-45.14	1247413.23	3198295.73
2500.00	4.37	29.240	2495.62	102.55N	57.40E	==>	-48.27	1247419.88	3198299.45
2600.00	4.37	29.240	2595.33	109.20N	61.13E	==>	-51.40	1247426.54	3198303.18
2700.00	4.37	29.240	2695.04	115.86N	64.85E	==>	-54.54	1247433.19	3198306.90
2800.00	4.37	29.240	2794.74	122.51N	68.58E	==>	-57.67	1247439.85	3198310.63
2900.00	4.37	29.240	2894.45	129.17N	72.31E	==>	-60.80	1247446.50	3198314.35
3000.00	4.37	29.240	2994.16	135.83N	76.03E	==>	-63.93	1247453.16	3198318.08
3100.00	4.37	29.240	3093.87	142.48N	79.76E	==>	-67.07	1247459.82	3198321.80
3200.00	4.37	29.240	3193.58	149.14N	83.48E	==>	-70.20	1247466.47	3198325.53

All data is in Feet unless otherwise stated
Coordinates are from Slot MD's are from Rig and TVD's are from Rig (Planned Datum #1 5035.1ft above Mean Sea Level)
Vertical Section is from 0.00N 0.00E on azimuth 274.990 degrees
Bottom hole distance is 4634.06 Feet on azimuth 274.99 degrees from Wellhead
Calculation method uses Minimum Curvature method
Prepared by Peterson Energy
Date Printed: 15-May-2013



INTEGRATED PETROLEUM TECHNOLOGIES, INC
SYSDRILL
Well Design Combined Report
Wellbore: SRC PHELPS #A-32CHZ (PWB)

Interpolated Wellpath									
MD[ft]	Inc[deg]	Azi[deg]	TVD[ft]	North[ft]	East[ft]	Dogleg [deg/100ft]	Vertical Section[ft]	Northing	Easting
3300.00	4.37	29.240	3293.29	155.79N	87.21E	==>	-73.33	1247473.13	3198329.26
3400.00	4.37	29.240	3393.00	162.45N	90.94E	==>	-76.47	1247479.78	3198332.98
3500.00	4.37	29.240	3492.70	169.11N	94.66E	==>	-79.60	1247486.44	3198336.71
3600.00	4.37	29.240	3592.41	175.76N	98.39E	==>	-82.73	1247493.09	3198340.43
3700.00	4.37	29.240	3692.12	182.42N	102.11E	==>	-85.87	1247499.75	3198344.16
3800.00	4.37	29.240	3791.83	189.07N	105.84E	==>	-89.00	1247506.41	3198347.88
3900.00	4.37	29.240	3891.54	195.73N	109.56E	==>	-92.13	1247513.06	3198351.61
4000.00	4.37	29.240	3991.25	202.39N	113.29E	==>	-95.26	1247519.72	3198355.34
4100.00	4.37	29.240	4090.96	209.04N	117.02E	==>	-98.40	1247526.37	3198359.06
4200.00	4.37	29.240	4190.66	215.70N	120.74E	==>	-101.53	1247533.03	3198362.79
4300.00	4.37	29.240	4290.37	222.35N	124.47E	==>	-104.66	1247539.68	3198366.51
4400.00	4.37	29.240	4390.08	229.01N	128.19E	==>	-107.80	1247546.34	3198370.24
4500.00	4.37	29.240	4489.79	235.66N	131.92E	==>	-110.93	1247553.00	3198373.96
4600.00	4.37	29.240	4589.50	242.32N	135.64E	==>	-114.06	1247559.65	3198377.69
4700.00	4.37	29.240	4689.21	248.98N	139.37E	==>	-117.20	1247566.31	3198381.42
4800.00	4.37	29.240	4788.92	255.63N	143.10E	==>	-120.33	1247572.96	3198385.14
4900.00	4.37	29.240	4888.63	262.29N	146.82E	==>	-123.46	1247579.62	3198388.87
5000.00	4.37	29.240	4988.33	268.94N	150.55E	==>	-126.59	1247586.27	3198392.59
5100.00	4.37	29.240	5088.04	275.60N	154.27E	==>	-129.73	1247592.93	3198396.32
5200.00	4.37	29.240	5187.75	282.26N	158.00E	==>	-132.86	1247599.58	3198400.04
5300.00	4.37	29.240	5287.46	288.91N	161.73E	==>	-135.99	1247606.24	3198403.77
5400.00	4.37	29.240	5387.17	295.57N	165.45E	==>	-139.13	1247612.90	3198407.50
5500.00	4.37	29.240	5486.88	302.22N	169.18E	==>	-142.26	1247619.55	3198411.22
5600.00	4.37	29.240	5586.59	308.88N	172.90E	==>	-145.39	1247626.21	3198414.95
5700.00	4.37	29.240	5686.29	315.54N	176.63E	==>	-148.53	1247632.86	3198418.67
5800.00	4.37	29.240	5786.00	322.19N	180.35E	==>	-151.66	1247639.52	3198422.40
5900.00	4.37	29.240	5885.71	328.85N	184.08E	==>	-154.79	1247646.17	3198426.12
6000.00	4.37	29.240	5985.42	335.50N	187.81E	==>	-157.92	1247652.83	3198429.85
6100.00	4.37	29.240	6085.13	342.16N	191.53E	==>	-161.06	1247659.49	3198433.57
6200.00	4.37	29.240	6184.84	348.82N	195.26E	==>	-164.19	1247666.14	3198437.30
6300.00	4.37	29.240	6284.55	355.47N	198.98E	==>	-167.32	1247672.80	3198441.03
6400.00	4.37	29.240	6384.26	362.13N	202.71E	==>	-170.46	1247679.45	3198444.75
6500.00	4.37	29.240	6483.96	368.78N	206.43E	==>	-173.59	1247686.11	3198448.48
6600.00	4.37	29.240	6583.67	375.44N	210.16E	==>	-176.72	1247692.76	3198452.20
6700.00	4.37	29.240	6683.38	382.09N	213.89E	==>	-179.86	1247699.42	3198455.93
6800.00	4.37	29.240	6783.09	388.75N	217.61E	==>	-182.99	1247706.08	3198459.65
6900.00	4.37	29.240	6882.80	395.41N	221.34E	==>	-186.12	1247712.73	3198463.38
7000.00	4.37	29.240	6982.51	402.06N	225.06E	==>	-189.25	1247719.39	3198467.11
7076.52	4.37	29.240	7058.81	407.16N	227.91E	==>	-191.65	1247724.48	3198469.96
7100.00	3.80	356.800	7082.23	408.71N	228.31E	10.00	-191.91	1247726.04	3198470.35
7200.00	10.86	289.750	7181.47	415.23N	219.24E	10.00	-182.30	1247732.55	3198461.28
7300.00	20.52	279.710	7277.65	421.38N	193.03E	10.00	-155.66	1247738.71	3198435.07
7400.00	30.39	275.990	7367.84	427.00N	150.49E	10.00	-112.79	1247744.32	3198392.53
7500.00	40.33	273.980	7449.29	431.89N	92.90E	10.00	-55.00	1247749.22	3198334.95
7600.00	50.28	272.650	7519.53	435.93N	22.02E	10.00	15.96	1247753.25	3198264.07
7700.00	60.25	271.670	7576.44	438.98N	60.00W	10.00	97.94	1247756.31	3198182.05
7800.00	70.22	270.860	7618.27	440.96N	150.67W	10.00	188.43	1247758.28	3198091.39
7900.00	80.20	270.150	7643.76	441.79N	247.23W	10.00	284.70	1247759.12	3197994.83
7999.56	90.13	269.480	7652.14	441.47N	346.30W	10.00	383.38	1247758.79	3197895.76
8000.00	90.13	269.480	7652.14	441.47N	346.75W	==>	383.82	1247758.79	3197895.31
8100.00	90.13	269.480	7651.90	440.56N	446.74W	==>	483.36	1247757.89	3197795.32
8200.00	90.13	269.480	7651.67	439.66N	546.74W	==>	582.90	1247756.98	3197695.33
8300.00	90.13	269.480	7651.44	438.76N	646.73W	==>	682.43	1247756.08	3197595.34
8400.00	90.13	269.480	7651.20	437.85N	746.73W	==>	781.97	1247755.18	3197495.35
8500.00	90.13	269.480	7650.97	436.95N	846.73W	==>	881.51	1247754.27	3197395.35
8600.00	90.13	269.480	7650.73	436.05N	946.72W	==>	981.05	1247753.37	3197295.36
8700.00	90.13	269.480	7650.50	435.15N	1046.72W	==>	1080.59	1247752.47	3197195.37
8800.00	90.13	269.480	7650.27	434.24N	1146.71W	==>	1180.13	1247751.57	3197095.38
8900.00	90.13	269.480	7650.03	433.34N	1246.71W	==>	1279.66	1247750.66	3196995.39
9000.00	90.13	269.480	7649.80	432.44N	1346.70W	==>	1379.20	1247749.76	3196895.39
9100.00	90.13	269.480	7649.56	431.53N	1446.70W	==>	1478.74	1247748.86	3196795.40

All data is in Feet unless otherwise stated
Coordinates are from Slot MD's are from Rig and TVD's are from Rig (Planned Datum #1 5035.1ft above Mean Sea Level)
Vertical Section is from 0.00N 0.00E on azimuth 274.990 degrees
Bottom hole distance is 4634.06 Feet on azimuth 274.99 degrees from Wellhead
Calculation method uses Minimum Curvature method
Prepared by Peterson Energy
Date Printed: 15-May-2013



INTEGRATED PETROLEUM TECHNOLOGIES, INC
SYSDRILL

Well Design Combined Report
Wellbore: SRC PHELPS #A-32CHZ (PWB)

Interpolated Wellpath									
MD[ft]	Inc[deg]	Azi[deg]	TVD[ft]	North[ft]	East[ft]	Dogleg [deg/100ft]	Vertical Section[ft]	Northing	Easting
9200.00	90.13	269.480	7649.33	430.63N	1546.70W	==>	1578.28	1247747.95	3196695.41
9300.00	90.13	269.480	7649.09	429.73N	1646.69W	==>	1677.82	1247747.05	3196595.42
9400.00	90.13	269.480	7648.86	428.83N	1746.69W	==>	1777.36	1247746.15	3196495.43
9500.00	90.13	269.480	7648.63	427.92N	1846.68W	==>	1876.90	1247745.25	3196395.43
9600.00	90.13	269.480	7648.39	427.02N	1946.68W	==>	1976.43	1247744.34	3196295.44
9700.00	90.13	269.480	7648.16	426.12N	2046.67W	==>	2075.97	1247743.44	3196195.45
9800.00	90.13	269.480	7647.92	425.21N	2146.67W	==>	2175.51	1247742.54	3196095.46
9900.00	90.13	269.480	7647.69	424.31N	2246.67W	==>	2275.05	1247741.63	3195995.47
10000.00	90.13	269.480	7647.46	423.41N	2346.66W	==>	2374.59	1247740.73	3195895.47
10100.00	90.13	269.480	7647.22	422.50N	2446.66W	==>	2474.13	1247739.83	3195795.48
10200.00	90.13	269.480	7646.99	421.60N	2546.65W	==>	2573.66	1247738.93	3195695.49
10300.00	90.13	269.480	7646.75	420.70N	2646.65W	==>	2673.20	1247738.02	3195595.50
10400.00	90.13	269.480	7646.52	419.80N	2746.64W	==>	2772.74	1247737.12	3195495.51
10500.00	90.13	269.480	7646.28	418.89N	2846.64W	==>	2872.28	1247736.22	3195395.51
10600.00	90.13	269.480	7646.05	417.99N	2946.63W	==>	2971.82	1247735.31	3195295.52
10700.00	90.13	269.480	7645.82	417.09N	3046.63W	==>	3071.36	1247734.41	3195195.53
10800.00	90.13	269.480	7645.58	416.18N	3146.63W	==>	3170.90	1247733.51	3195095.54
10900.00	90.13	269.480	7645.35	415.28N	3246.62W	==>	3270.43	1247732.61	3194995.55
11000.00	90.13	269.480	7645.11	414.38N	3346.62W	==>	3369.97	1247731.70	3194895.55
11100.00	90.13	269.480	7644.88	413.48N	3446.61W	==>	3469.51	1247730.80	3194795.56
11200.00	90.13	269.480	7644.65	412.57N	3546.61W	==>	3569.05	1247729.90	3194695.57
11300.00	90.13	269.480	7644.41	411.67N	3646.60W	==>	3668.59	1247728.99	3194595.58
11400.00	90.13	269.480	7644.18	410.77N	3746.60W	==>	3768.13	1247728.09	3194495.59
11500.00	90.13	269.480	7643.94	409.86N	3846.60W	==>	3867.66	1247727.19	3194395.59
11600.00	90.13	269.480	7643.71	408.96N	3946.59W	==>	3967.20	1247726.28	3194295.60
11700.00	90.13	269.480	7643.47	408.06N	4046.59W	==>	4066.74	1247725.38	3194195.61
11800.00	90.13	269.480	7643.24	407.15N	4146.58W	==>	4166.28	1247724.48	3194095.62
11900.00	90.13	269.480	7643.01	406.25N	4246.58W	==>	4265.82	1247723.58	3193995.63
12000.00	90.13	269.480	7642.77	405.35N	4346.57W	==>	4365.36	1247722.67	3193895.63
12100.00	90.13	269.480	7642.54	404.45N	4446.57W	==>	4464.90	1247721.77	3193795.64
12200.00	90.13	269.480	7642.30	403.54N	4546.56W	==>	4564.43	1247720.87	3193695.65
12269.95	90.13	269.480	7642.14	402.91N	4616.51W	==>	4634.06	1247720.24	3193625.71

All data is in Feet unless otherwise stated
Coordinates are from Slot MD's are from Rig and TVD's are from Rig (Planned Datum #1 5035.1ft above Mean Sea Level)
Vertical Section is from 0.00N 0.00E on azimuth 274.990 degrees
Bottom hole distance is 4634.06 Feet on azimuth 274.99 degrees from Wellhead
Calculation method uses Minimum Curvature method
Prepared by Peterson Energy
Date Printed: 15-May-2013



INTEGRATED PETROLEUM TECHNOLOGIES, INC
SYSDRILL
Well Design Combined Report
Wellbore: SRC PHELPS #A-32CHZ (PWB)

Hole Sections								
Diameter	Start	Start	Start	Start	End	End	End	End
[in]	MD[ft]	TVD[ft]	North[ft]	East[ft]	MD[ft]	TVD[ft]	North[ft]	East[ft]
13 1/2	16.00	16.00	0.00N	0.00E	1150.00	1149.55	12.69N	7.10E
8 5/8	1150.00	1149.55	12.69N	7.10E	7893.00	7642.53	441.77N	240.34W
6 1/8	7893.00	7642.53	441.77N	240.34W	12269.95	7642.14	402.91N	4616.51W

Casings								
Name	Top	Top	Top	Top	Shoe	Shoe	Shoe	Shoe
	MD[ft]	TVD[ft]	North[ft]	East[ft]	MD[ft]	TVD[ft]	North[ft]	East[ft]
9 5/8in Surface Casing	16.00	16.00	0.00N	0.00E	1150.00	1149.55	12.69N	7.10E
7.0in Intermediate Casing	16.00	16.00	0.00N	0.00E	7893.00	7642.53	441.77N	240.34W
4 1/2in Production Liner	7075.00	7057.29	407.05N	227.86E	12269.95	7642.14	402.91N	4616.51W

Targets								
Name	North[ft]	East[ft]	TVD[ft]	Latitude	Longitude	Northing	Easting	Last Revised
NR T5-1	402.91N	4616.51W	7642.14	N40 0 40.7037	W104 48 31.4537	1247720.24	3193625.71	14-May-2013
NR2 T-5	441.40N	239.30W	7642.14	N40 0 40.7431	W104 47 35.1967	1247758.72	3198002.75	14-May-2013

Survey Tool Program					
Reference	Survey Name	MD[ft]	TVD[ft]	Survey Tool	Error Model
24504	Planned	12269.95	7642.14	WdW Rate Gyro	Standard

Notes

All data is in Feet unless otherwise stated
Coordinates are from Slot MD's are from Rig and TVD's are from Rig (Planned Datum #1 5035.1ft above Mean Sea Level)
Vertical Section is from 0.00N 0.00E on azimuth 274.990 degrees
Bottom hole distance is 4634.06 Feet on azimuth 274.99 degrees from Wellhead
Calculation method uses Minimum Curvature method
Prepared by Peterson Energy
Date Printed: 15-May-2013



SYSDRILL
Closest Approach + Clearance Factor Summary Report
Wellbore: SRC PHELPS #A-32CHZ (PWB)

Ellipse separations are reported ONLY if BOTH wells have uncertainty data
Only Depth and Magnetic Reference Field error terms are correlated across tie points
Cutoff is calculated on CENTRE to CENTRE distance

Summary data uses Closest Approach clearance calculation for all minima
Hole size/Casings ARE included
Hole size/Casings are NOT subtracted from Centre-Centre distance
Confidence limit of 95.00% / 2.80 SD.

Wellbore		
Name	Created	Last Revised
SRC PHELPS #A-32CHZ (PWB)	22-Apr-2013	15-May-2013

Well		
Name	Government ID	Last Revised
SRC PHELPS #A-32CHZ		15-May-2013

Slot						
Name	Grid Northing	Grid Easting	Latitude	Longitude	North	East
Slot #9	1247317.3390	3198242.0500	N40 0 36.3623	W104 47 32.1666	21.57N	95.51E

Installation					
Name	Easting	Northing	Coord System Name	North Alignment	
SRC PHELPS	3198146.5430	1247295.7700	CO83-NF on NORTH AMERICAN DATUM 1983 datum	Grid	

Field					
Name	Easting	Northing	Coord System Name	North Alignment	
Wattenberg	3212690.1960	1438741.7551	CO83-NF on NORTH AMERICAN DATUM 1983 datum	Grid	

Clearance Summary										
Offset WellName	Offset Wellbore	Offset Slot	Offset Structure	Separation [ft]	MD[ft]	Diverging From[ft]	Ellipse Separation [ft]	Ellipse MD[ft]	Clearance Factor	Clearance MD[ft]
SRC PHELPS #12-32NHZ	SRC PHELPS #12-32NHZ (PWB)	Slot #11	SRC PHELPS	22.33	850.00	12269.95	20.02	883.19	6.46	12269.95
SRC PHELPS #K-32NHZ	SRC PHELPS #K-32NHZ (PWB)	Slot #10	SRC PHELPS	22.48	850.00	8001.63	20.17	850.00	9.68	885.42
SRC PHELPS #A-32NHZ	SRC PHELPS #A-32NHZ (PWB)	Slot #7	SRC PHELPS	26.38	1197.10	12269.95	23.58	1147.89	4.19	12269.95
SRC PHELPS #12-32CHZ	SRC PHELPS #12-32CHZ (PWB)	Slot #12	SRC PHELPS	28.21	850.00	850.00	25.90	850.00	7.86	12269.95
SRC PHELPS #K-32CHZ	SRC PHELPS #K-32CHZ (PWB)	Slot #8	SRC PHELPS	41.69	737.78	737.78	39.54	754.19	15.80	12269.95
SRC PHELPS #11-32CHZ	SRC PHELPS #11-32CHZ (PWB)	Slot #5	SRC PHELPS	48.23	991.90	991.90	45.65	1000.25	7.93	12269.95
SRC PHELPS #13-32NHZ	SRC PHELPS #13-32NHZ (PWB)	Slot #6	SRC PHELPS	61.81	639.36	639.36	59.83	655.76	21.98	12269.95
SRC PHELPS #11-32NHZ	SRC PHELPS #11-32NHZ (PWB)	Slot #3	SRC PHELPS	68.18	967.44	12269.95	65.63	967.44	10.28	12269.95
SRC PHELPS #13-32CHZ	SRC PHELPS #13-32CHZ (PWB)	Slot #4	SRC PHELPS	83.30	540.93	540.93	81.48	573.74	23.76	12269.95

All data is in Feet unless otherwise stated
Coordinates are from Slot MD's are from Rig and TVD's are from Rig (Planned Datum #1 5035.1ft above Mean Sea Level)
Vertical Section is from 0.00N 0.00E on azimuth 274.990 degrees
Prepared by Peterson Energy
Date Printed: 15-May-2013



SYSDRILL
Closest Approach + Clearance Factor Summary Report
Wellbore: SRC PHELPS #A-32CHZ (PWB)

Clearance Summary										
Offset WellName	Offset Wellbore	Offset Slot	Offset Structure	Separation [ft]	MD[ft]	Diverging From[ft]	Ellipse Separation [ft]	Ellipse MD[ft]	Clearance Factor	Clearance MD[ft]
SRC PHELPS #J-32CHZ	SRC PHELPS #J-32CHZ (PWB)	Slot #1	SRC PHELPS	89.54	907.35	907.35	87.05	918.23	14.99	12269.95
SRC PHELPS #B-32CHZ	SRC PHELPS #B-32CHZ (PWB)	Slot #2	SRC PHELPS	105.18	442.51	442.51	103.51	475.32	30.78	12269.95
EMMA DELVENT HAL GAS UNIT #1	EMMA DELVENTHAL GAS UNIT #1 (AWB)	EMMA DELVENT HAL GAS UNIT #1	SRC PHELPS OFFSETS	528.03	8534.27	8534.27	492.35	8534.27	14.80	8546.18