

SYNERGY RESOURCES			
Location	Weld County, CO, USA(Imported)	Slot	Slot #7
Field	Wattenberg	Well	SRC LEFFLER #24-26NHZ
Installation	SRC LEFFLER	Wellbore	SRC LEFFLER #24-26NHZ (PWB)

Slot	Slot #7
------	---------

Well SRC LEFFLER #24-26NHZ

Wellbore SRC LEFFLER #24-26NHZ (PWB)

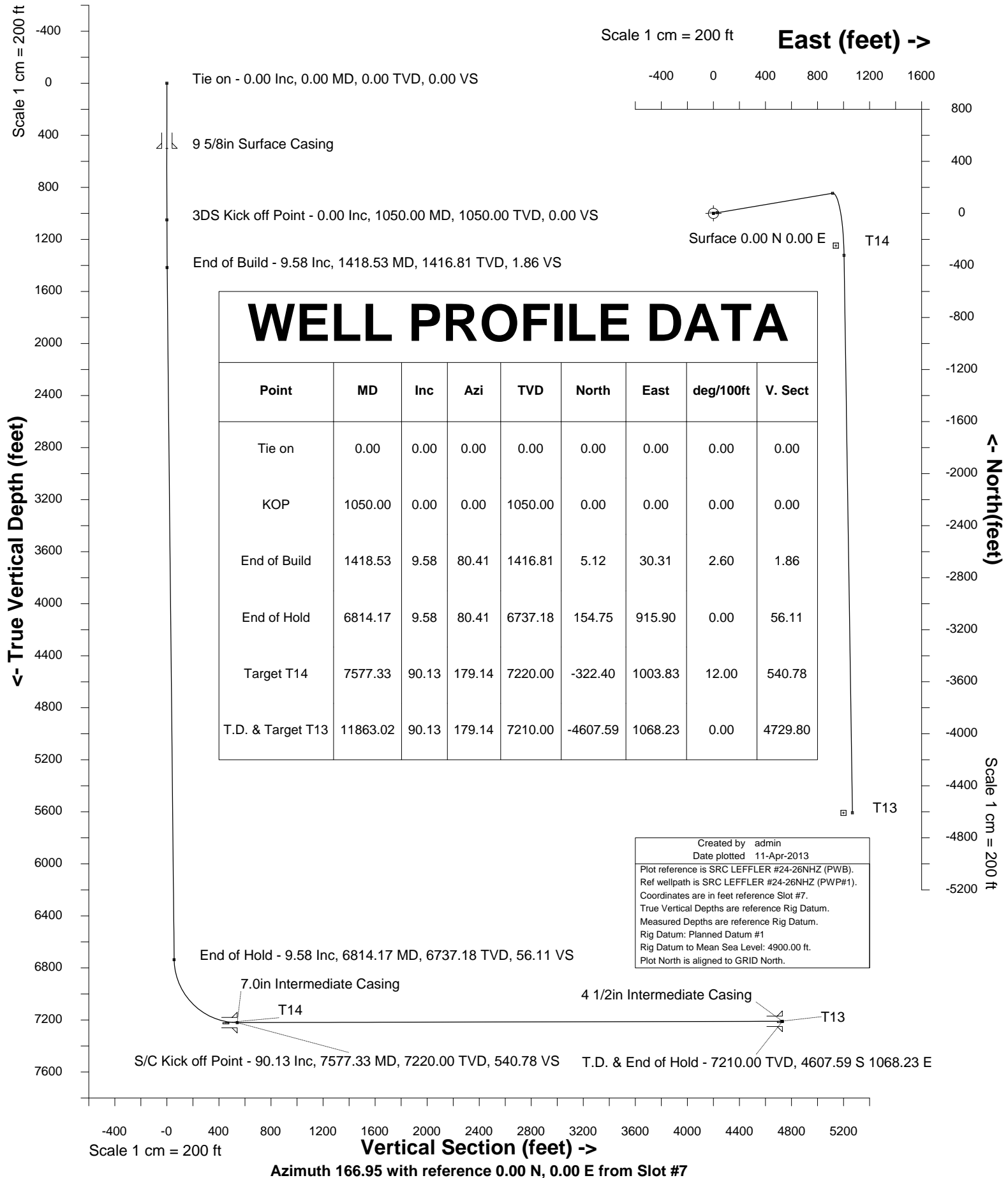



SYSDRILL
Well Design Combined Report
Wellbore: SRC LEFFLER #24-26NHZ (PWB)
Wellpath: SRC LEFFLER #24-26NHZ (PWP#1)

Wellhead Details

Name	Northing	Easting	Latitude	Longitude	North	East
Slot #7	1445136.7950	3208276.0910	N40 33 10.3825	W104 45 1.7247	3.20N	134.93E

Site Details

Name	Northing	Easting	Coord System Name	North Alignment
SRC LEFFLER	1445133.5911	3208141.1650	CO83-NF on NORTH AMERICAN DATUM 1983 datum	Grid

Summary Wellpath

MD[ft]	Inc[deg]	Azi[deg]	TVD[ft]	North[ft]	East[ft]	Dogleg [deg/100ft]	Vertical Section[ft]	Northing	Easting
0.00	0.00	0.000	0.00	0.00N	0.00E		0.00	1445136.80	3208276.09
1050.00	0.00	0.000	1050.00	0.00N	0.00E	==>	0.00	1445136.80	3208276.09
1418.53	9.58	80.410	1416.81	5.12N	30.31E	2.60	1.86	1445141.92	3208306.40
6814.17	9.58	80.410	6737.18	154.75N	915.90E	==>	56.11	1445291.54	3209191.96
7577.33	90.13	179.140	7220.00	322.40S	1003.83E	12.00	540.78	1444814.41	3209279.89
11863.02	90.13	179.140	7210.00	4607.59S	1068.23E	==>	4729.80	1440529.35	3209344.29

Interpolated Wellpath

MD[ft]	Inc[deg]	Azi[deg]	TVD[ft]	North[ft]	East[ft]	Dogleg [deg/100ft]	Vertical Section[ft]	Northing	Easting
0.00	0.00	0.000	0.00	0.00N	0.00E		0.00	1445136.80	3208276.09
100.00	0.00	0.000	100.00	0.00N	0.00E	==>	0.00	1445136.80	3208276.09
200.00	0.00	0.000	200.00	0.00N	0.00E	==>	0.00	1445136.80	3208276.09
300.00	0.00	0.000	300.00	0.00N	0.00E	==>	0.00	1445136.80	3208276.09
400.00	0.00	0.000	400.00	0.00N	0.00E	==>	0.00	1445136.80	3208276.09
500.00	0.00	0.000	500.00	0.00N	0.00E	==>	0.00	1445136.80	3208276.09
600.00	0.00	0.000	600.00	0.00N	0.00E	==>	0.00	1445136.80	3208276.09
700.00	0.00	0.000	700.00	0.00N	0.00E	==>	0.00	1445136.80	3208276.09
800.00	0.00	0.000	800.00	0.00N	0.00E	==>	0.00	1445136.80	3208276.09
900.00	0.00	0.000	900.00	0.00N	0.00E	==>	0.00	1445136.80	3208276.09
1000.00	0.00	0.000	1000.00	0.00N	0.00E	==>	0.00	1445136.80	3208276.09
1050.00	0.00	0.000	1050.00	0.00N	0.00E	==>	0.00	1445136.80	3208276.09
1150.00	2.60	80.410	1149.97	0.38N	2.24E	2.60	0.14	1445137.17	3208278.33
1250.00	5.20	80.410	1249.73	1.51N	8.94E	2.60	0.55	1445138.31	3208285.03
1350.00	7.80	80.410	1349.07	3.40N	20.10E	2.60	1.23	1445140.19	3208296.19
1418.53	9.58	80.410	1416.81	5.12N	30.31E	2.60	1.86	1445141.92	3208306.40
1500.00	9.58	80.410	1497.15	7.38N	43.69E	==>	2.68	1445144.18	3208319.78
1600.00	9.58	80.410	1595.75	10.15N	60.10E	==>	3.68	1445146.95	3208336.19
1700.00	9.58	80.410	1694.36	12.93N	76.51E	==>	4.69	1445149.72	3208352.60
1800.00	9.58	80.410	1792.96	15.70N	92.92E	==>	5.69	1445152.49	3208369.01
1900.00	9.58	80.410	1891.57	18.47N	109.34E	==>	6.70	1445155.27	3208385.42
2000.00	9.58	80.410	1990.17	21.25N	125.75E	==>	7.70	1445158.04	3208401.84
2100.00	9.58	80.410	2088.78	24.02N	142.16E	==>	8.71	1445160.81	3208418.25
2200.00	9.58	80.410	2187.38	26.79N	158.58E	==>	9.71	1445163.59	3208434.66
2300.00	9.58	80.410	2285.99	29.57N	174.99E	==>	10.72	1445166.36	3208451.07
2400.00	9.58	80.410	2384.59	32.34N	191.40E	==>	11.73	1445169.13	3208467.49
2500.00	9.58	80.410	2483.20	35.11N	207.81E	==>	12.73	1445171.91	3208483.90
2600.00	9.58	80.410	2581.80	37.88N	224.23E	==>	13.74	1445174.68	3208500.31
2700.00	9.58	80.410	2680.41	40.66N	240.64E	==>	14.74	1445177.45	3208516.72
2800.00	9.58	80.410	2779.01	43.43N	257.05E	==>	15.75	1445180.22	3208533.14
2900.00	9.58	80.410	2877.62	46.20N	273.47E	==>	16.75	1445183.00	3208549.55
3000.00	9.58	80.410	2976.22	48.98N	289.88E	==>	17.76	1445185.77	3208565.96
3100.00	9.58	80.410	3074.83	51.75N	306.29E	==>	18.76	1445188.54	3208582.37
3200.00	9.58	80.410	3173.43	54.52N	322.71E	==>	19.77	1445191.32	3208598.79
3300.00	9.58	80.410	3272.04	57.30N	339.12E	==>	20.77	1445194.09	3208615.20
3400.00	9.58	80.410	3370.64	60.07N	355.53E	==>	21.78	1445196.86	3208631.61
3500.00	9.58	80.410	3469.25	62.84N	371.94E	==>	22.79	1445199.64	3208648.02
3600.00	9.58	80.410	3567.85	65.62N	388.36E	==>	23.79	1445202.41	3208664.44
3700.00	9.58	80.410	3666.46	68.39N	404.77E	==>	24.80	1445205.18	3208680.85
3800.00	9.58	80.410	3765.06	71.16N	421.18E	==>	25.80	1445207.95	3208697.26
3900.00	9.58	80.410	3863.67	73.93N	437.60E	==>	26.81	1445210.73	3208713.67
4000.00	9.58	80.410	3962.27	76.71N	454.01E	==>	27.81	1445213.50	3208730.09
4100.00	9.58	80.410	4060.88	79.48N	470.42E	==>	28.82	1445216.27	3208746.50
4200.00	9.58	80.410	4159.48	82.25N	486.83E	==>	29.82	1445219.05	3208762.91
4300.00	9.58	80.410	4258.09	85.03N	503.25E	==>	30.83	1445221.82	3208779.32
4400.00	9.58	80.410	4356.69	87.80N	519.66E	==>	31.83	1445224.59	3208795.74
4500.00	9.58	80.410	4455.29	90.57N	536.07E	==>	32.84	1445227.36	3208812.15
4600.00	9.58	80.410	4553.90	93.35N	552.49E	==>	33.85	1445230.14	3208828.56
4700.00	9.58	80.410	4652.50	96.12N	568.90E	==>	34.85	1445232.91	3208844.97
4800.00	9.58	80.410	4751.11	98.89N	585.31E	==>	35.86	1445235.68	3208861.38
4900.00	9.58	80.410	4849.71	101.66N	601.72E	==>	36.86	1445238.46	3208877.80
5000.00	9.58	80.410	4948.32	104.44N	618.14E	==>	37.87	1445241.23	3208894.21
5100.00	9.58	80.410	5046.92	107.21N	634.55E	==>	38.87	1445244.00	3208910.62

All data is in Feet unless otherwise stated
Coordinates are from Slot MD's are from Rig and TVD's are from Rig (Planned Datum #1 4900.0ft above Mean Sea Level)
Vertical Section is from 0.00N 0.00E on azimuth 166.950 degrees
Bottom hole distance is 4729.80 Feet on azimuth 166.95 degrees from Wellhead
Calculation method uses Minimum Curvature method
Prepared by Peterson Energy
Date Printed: 11-Apr-2013



SYSDRILL
Well Design Combined Report
Wellbore: SRC LEFFLER #24-26NHZ (PWB)
Wellpath: SRC LEFFLER #24-26NHZ (PWP#1)

Interpolated Wellpath

MD[ft]	Inc[deg]	Azi[deg]	TVD[ft]	North[ft]	East[ft]	Dogleg [deg/100ft]	Vertical Section[ft]	Northing	Easting
5200.00	9.58	80.410	5145.53	109.98N	650.96E	==>	39.88	1445246.78	3208927.03
5300.00	9.58	80.410	5244.13	112.76N	667.38E	==>	40.88	1445249.55	3208943.45
5400.00	9.58	80.410	5342.74	115.53N	683.79E	==>	41.89	1445252.32	3208959.86
5500.00	9.58	80.410	5441.34	118.30N	700.20E	==>	42.90	1445255.09	3208976.27
5600.00	9.58	80.410	5539.95	121.08N	716.62E	==>	43.90	1445257.87	3208992.68
5700.00	9.58	80.410	5638.55	123.85N	733.03E	==>	44.91	1445260.64	3209009.10
5800.00	9.58	80.410	5737.16	126.62N	749.44E	==>	45.91	1445263.41	3209025.51
5900.00	9.58	80.410	5835.76	129.40N	765.85E	==>	46.92	1445266.19	3209041.92
6000.00	9.58	80.410	5934.37	132.17N	782.27E	==>	47.92	1445268.96	3209058.33
6100.00	9.58	80.410	6032.97	134.94N	798.68E	==>	48.93	1445271.73	3209074.75
6200.00	9.58	80.410	6131.58	137.71N	815.09E	==>	49.93	1445274.51	3209091.16
6300.00	9.58	80.410	6230.18	140.49N	831.51E	==>	50.94	1445277.28	3209107.57
6400.00	9.58	80.410	6328.79	143.26N	847.92E	==>	51.94	1445280.05	3209123.98
6500.00	9.58	80.410	6427.39	146.03N	864.33E	==>	52.95	1445282.82	3209140.40
6600.00	9.58	80.410	6526.00	148.81N	880.74E	==>	53.96	1445285.60	3209156.81
6700.00	9.58	80.410	6624.60	151.58N	897.16E	==>	54.96	1445288.37	3209173.22
6800.00	9.58	80.410	6723.21	154.35N	913.57E	==>	55.97	1445291.14	3209189.63
6814.17	9.58	80.410	6737.18	154.75N	915.90E	==>	56.11	1445291.54	3209191.96
6900.00	12.94	132.550	6821.55	149.42N	930.06E	12.00	64.49	1445286.21	3209206.12
7000.00	22.82	155.750	6916.71	124.08N	946.33E	12.00	92.86	1445260.87	3209222.39
7100.00	34.05	164.820	7004.55	79.22N	961.68E	12.00	140.02	1445216.01	3209237.74
7200.00	45.64	169.720	7081.22	16.80N	975.44E	12.00	203.94	1445153.60	3209251.50
7300.00	57.36	172.980	7143.37	60.44S	987.00E	12.00	281.80	1445076.35	3209263.06
7400.00	69.16	175.470	7188.29	149.14S	995.87E	12.00	370.20	1444987.66	3209271.93
7500.00	80.98	177.600	7214.02	245.41S	1001.64E	12.00	465.29	1444891.39	3209277.70
7577.33	90.13	179.140	7220.00	322.40S	1003.83E	12.00	540.78	1444814.41	3209279.89
7600.00	90.13	179.140	7219.95	345.06S	1004.17E	==>	562.94	1444791.74	3209280.23
7700.00	90.13	179.140	7219.71	445.05S	1005.67E	==>	660.68	1444691.76	3209281.73
7800.00	90.13	179.140	7219.48	545.04S	1007.17E	==>	758.43	1444591.77	3209283.23
7900.00	90.13	179.140	7219.25	645.03S	1008.68E	==>	856.17	1444491.79	3209284.74
8000.00	90.13	179.140	7219.01	745.02S	1010.18E	==>	953.92	1444391.80	3209286.24
8100.00	90.13	179.140	7218.78	845.00S	1011.68E	==>	1051.66	1444291.82	3209287.74
8200.00	90.13	179.140	7218.55	944.99S	1013.19E	==>	1149.41	1444191.83	3209289.24
8300.00	90.13	179.140	7218.31	1044.98S	1014.69E	==>	1247.15	1444091.85	3209290.75
8400.00	90.13	179.140	7218.08	1144.97S	1016.19E	==>	1344.89	1443991.86	3209292.25
8500.00	90.13	179.140	7217.85	1244.96S	1017.69E	==>	1442.64	1443891.88	3209293.75
8600.00	90.13	179.140	7217.61	1344.95S	1019.20E	==>	1540.38	1443791.89	3209295.26
8700.00	90.13	179.140	7217.38	1444.94S	1020.70E	==>	1638.13	1443691.91	3209296.76
8800.00	90.13	179.140	7217.15	1544.92S	1022.20E	==>	1735.87	1443591.92	3209298.26
8900.00	90.13	179.140	7216.91	1644.91S	1023.70E	==>	1833.62	1443491.93	3209299.76
9000.00	90.13	179.140	7216.68	1744.90S	1025.21E	==>	1931.36	1443391.95	3209301.27
9100.00	90.13	179.140	7216.45	1844.89S	1026.71E	==>	2029.10	1443291.96	3209302.77
9200.00	90.13	179.140	7216.21	1944.88S	1028.21E	==>	2126.85	1443191.98	3209304.27
9300.00	90.13	179.140	7215.98	2044.87S	1029.72E	==>	2224.59	1443091.99	3209305.77
9400.00	90.13	179.140	7215.75	2144.85S	1031.22E	==>	2322.34	1442992.01	3209307.28
9500.00	90.13	179.140	7215.51	2244.84S	1032.72E	==>	2420.08	1442892.02	3209308.78
9600.00	90.13	179.140	7215.28	2344.83S	1034.22E	==>	2517.83	1442792.04	3209310.28
9700.00	90.13	179.140	7215.05	2444.82S	1035.73E	==>	2615.57	1442692.05	3209311.78
9800.00	90.13	179.140	7214.81	2544.81S	1037.23E	==>	2713.31	1442592.07	3209313.29
9900.00	90.13	179.140	7214.58	2644.80S	1038.73E	==>	2811.06	1442492.08	3209314.79
10000.00	90.13	179.140	7214.35	2744.78S	1040.23E	==>	2908.80	1442392.10	3209316.29
10100.00	90.13	179.140	7214.11	2844.77S	1041.74E	==>	3006.55	1442292.11	3209317.80
10200.00	90.13	179.140	7213.88	2944.76S	1043.24E	==>	3104.29	1442192.13	3209319.30
10300.00	90.13	179.140	7213.65	3044.75S	1044.74E	==>	3202.04	1442092.14	3209320.80
10400.00	90.13	179.140	7213.41	3144.74S	1046.25E	==>	3299.78	1441992.15	3209322.30
10500.00	90.13	179.140	7213.18	3244.73S	1047.75E	==>	3397.52	1441892.17	3209323.81
10600.00	90.13	179.140	7212.95	3344.72S	1049.25E	==>	3495.27	1441792.18	3209325.31
10700.00	90.13	179.140	7212.71	3444.70S	1050.75E	==>	3593.01	1441692.20	3209326.81
10800.00	90.13	179.140	7212.48	3544.69S	1052.26E	==>	3690.76	1441592.21	3209328.31
10900.00	90.13	179.140	7212.25	3644.68S	1053.76E	==>	3788.50	1441492.23	3209329.82
11000.00	90.13	179.140	7212.01	3744.67S	1055.26E	==>	3886.25	1441392.24	3209331.32
11100.00	90.13	179.140	7211.78	3844.66S	1056.76E	==>	3983.99	1441292.26	3209332.82
11200.00	90.13	179.140	7211.55	3944.65S	1058.27E	==>	4081.73	1441192.27	3209334.32
11300.00	90.13	179.140	7211.31	4044.63S	1059.77E	==>	4179.48	1441092.29	3209335.83
11400.00	90.13	179.140	7211.08	4144.62S	1061.27E	==>	4277.22	1440992.30	3209337.33
11500.00	90.13	179.140	7210.85	4244.61S	1062.78E	==>	4374.97	1440892.32	3209338.83
11600.00	90.13	179.140	7210.61	4344.60S	1064.28E	==>	4472.71	1440792.33	3209340.34
11700.00	90.13	179.140	7210.38	4444.59S	1065.78E	==>	4570.46	1440692.35	3209341.84
11800.00	90.13	179.140	7210.15	4544.58S	1067.28E	==>	4668.20	1440592.36	3209343.34
11863.02	90.13	179.140	7210.00	4607.59S	1068.23E	==>	4729.80	1440529.35	3209344.29

All data is in Feet unless otherwise stated
Coordinates are from Slot MD's are from Rig and TVD's are from Rig (Planned Datum #1 4900.0ft above Mean Sea Level)
Vertical Section is from 0.00N 0.00E on azimuth 166.950 degrees
Bottom hole distance is 4729.80 Feet on azimuth 166.95 degrees from Wellhead
Calculation method uses Minimum Curvature method
Prepared by Peterson Energy
Date Printed: 11-Apr-2013



SYSDRILL
Well Design Combined Report
Wellbore: SRC LEFFLER #24-26NHZ (PWB)
Wellpath: SRC LEFFLER #24-26NHZ (PWP#1)

Hole Sections

Diameter [in]	Start MD[ft]	Start TVD[ft]	Start North[ft]	Start East[ft]	End MD[ft]	End TVD[ft]	End North[ft]	End East[ft]	Wellbore
12 1/4	0.00	0.00	0.00N	0.00E	500.00	500.00	0.00N	0.00E	SRC LEFFLER #24-26NHZ (PWB) SRC LEFFLER #24-26NHZ (PWB) SRC LEFFLER #24-26NHZ (PWB)
8 5/8	500.00	500.00	0.00N	0.00E	7577.00	7220.00	322.06S	1003.82E	
6 1/8	7577.00	7220.00	322.06S	1003.82E	11863.02	7210.00	4607.59S	1068.23E	

Casings

Name	Top MD[ft]	Top TVD[ft]	Top North[ft]	Top East[ft]	Shoe MD[ft]	Shoe TVD[ft]	Shoe North[ft]	Shoe East[ft]	Wellbore
9 5/8in Surface Casing	0.00	0.00	0.00N	0.00E	500.00	500.00	0.00N	0.00E	SRC LEFFLER #24-26NHZ (PWB) SRC LEFFLER #24-26NHZ (PWB) SRC LEFFLER #24-26NHZ (PWB)
7.0in Intermediate Casing	0.00	0.00	0.00N	0.00E	7577.00	7220.00	322.06S	1003.82E	
4 1/2in Intermediate Casing	6814.00	6737.01	154.74N	915.87E	11863.02	7210.00	4607.59S	1068.23E	

Targets

Name	North[ft]	East[ft]	TVD[ft]	Latitude	Longitude	Northing	Easting	Last Revised
T13	4608.05S	999.35E	7210.00	N40 32 24.7666	W104 44 49.2857	1440528.89	3209275.41	8-Apr-2013
T14	247.67S	940.71E	7220.00	N40 33 7.8565	W104 44 49.5657	1444889.13	3209216.77	8-Apr-2013

Survey Tool Program

Reference	Survey Name	MD[ft]	TVD[ft]	Survey Tool	Error Model
17402	Planned	11863.02	7210.00	WdW Rate Gyro	Standard

Notes



SYSDRILL
Closest Approach + Clearance Factor Summary Report
Wellbore: SRC LEFFLER #24-26NHZ (PWB)
Wellpath: SRC LEFFLER #24-26NHZ (PWP#1)

Ellipse separations are reported ONLY if BOTH wells have uncertainty data
Only Depth and Magnetic Reference Field error terms are correlated across tie points
Cutoff is calculated on CENTRE to CENTRE distance

Summary data uses Closest Approach clearance calculation for all minima
Hole size/Casings ARE included
Hole size/Casings are NOT subtracted from Centre-Centre distance
Confidence limit of 95.00% / 2.80 SD.

Wellbore

Name	Created	Last Revised
SRC LEFFLER #24-26NHZ (PWB)	1-Apr-2013	10-Apr-2013

Well

Name	Government ID	Last Revised
SRC LEFFLER #24-26NHZ		1-Apr-2013

Slot

Name	Grid Northing	Grid Easting	Latitude	Longitude	North	East
Slot #7	1445136.7950	3208276.0910	N40 33 10.3825	W104 45 1.7247	3.20N	134.93E

Installation

Name	Easting	Northing	Coord System Name	North Alignment
SRC LEFFLER	3208141.1650	1445133.5911	CO83-NF on NORTH AMERICAN DATUM 1983 datum	Grid

Field

Name	Easting	Northing	Coord System Name	North Alignment
Wattenberg	41136929.7567	12284170.6461	CO83-NF on NORTH AMERICAN DATUM 1983 datum	Grid

Clearance Summary

Offset WellName	Offset Wellbore	Offset Slot	Offset Structure	Separation [ft]	MD[ft]	Diverging From[ft]	Ellipse Separation [ft]	Ellipse MD[ft]	Clearance Factor	Clearance MD[ft]
SRC LEFFLER #B-26NBH Z	SRC LEFFLER #B-26NBH Z (PWB)	Slot #6	SRC LEFFLER	22.49	1050.00	1050.00	20.15	1050.00	4.71	11863.02
SRC LEFFLER #P-26NHZ	SRC LEFFLER #P-26NHZ (PWB)	Slot #8	SRC LEFFLER	22.50	935.04	11860.24	20.34	935.04	4.19	11863.02
SRC LEFFLER #B-26CHZ	SRC LEFFLER #B-26CHZ (PWB)	Slot #5	SRC LEFFLER	44.99	1050.00	7577.33	42.65	1050.00	7.29	11863.02
SRC LEFFLER P-26CHZ	SRC LEFFLER P-26CHZ (PWB)	Slot #9	SRC LEFFLER	44.99	836.61	11856.76	42.99	836.61	6.86	11863.02
SRC LEFFLER #B-26NAH Z	SRC LEFFLER #B-26NAH Z (PWB)	Slot #4	SRC LEFFLER	67.48	1050.00	1050.00	65.14	1050.00	12.70	11863.02
MAGNUSO N #23L-421	MAGNUSO N #23L-421 (AWB)	MAGNUSO N #23L-421	SRC LEFFLER OFFSETS	85.11	6768.60	6768.60	38.10	6774.93	1.81	6774.93
SRC LEFFLER #23-26D	SRC LEFFLER #23-26D (AWB)	SRC LEFFLER #23-26D	SRC LEFFLER OFFSETS	87.38	10391.94	10391.94	31.43	10391.94	1.56	10391.94
SRC LEFFLER #14-26NHZ	SRC LEFFLER #14-26NHZ (PWB)	Slot #3	SRC LEFFLER	89.98	1017.06	1017.06	87.69	1017.06	17.87	11863.02
SRC LEFFLER #H-26CHZ	SRC LEFFLER #H-26CHZ (PWB)	Slot #2	SRC LEFFLER	112.47	951.44	951.44	110.29	951.44	21.75	11863.02
SRC LEFFLER #24-26D	SRC LEFFLER #24-26D (AWB)	SRC LEFFLER #24-26D	SRC LEFFLER OFFSETS	125.62	11665.27	11665.27	54.67	11646.98	1.76	11646.98
SRC	SRC	Slot #1	SRC	134.97	836.61	836.61	132.97	836.61	23.58	11863.02

All data is in Feet unless otherwise stated
Coordinates are from Slot MD's are from Rig and TVD's are from Rig (Planned Datum #1 4900.0ft above Mean Sea Level)
Vertical Section is from 0.00N 0.00E on azimuth 166.950 degrees
Prepared by Peterson Energy
Date Printed: 11-Apr-2013



SYSDRILL
Closest Approach + Clearance Factor Summary Report
Wellbore: SRC LEFFLER #24-26NHZ (PWB)
Wellpath: SRC LEFFLER #24-26NHZ (PWP#1)

Clearance Summary

Offset WellName	Offset Wellbore	Offset Slot	Offset Structure	Separation [ft]	MD[ft]	Diverging From[ft]	Ellipse Separation [ft]	Ellipse MD[ft]	Clearance Factor	Clearance MD[ft]
LEFFLER #H-26NHZ	LEFFLER #H-26NHZ (PWB)		LEFFLER							
MAGNUSO N #23L-201	MAGNUSO N #23L-201 (AWB)	MAGNUSO N #23L-201	SRC LEFFLER OFFSETS	511.73	1050.00	1050.00	505.87	1066.27	29.39	5544.62
MAGNUSO N #23I-421	MAGNUSO N #23I-421 (AWB)	MAGNUSO N #23I-421	SRC LEFFLER OFFSETS	530.43	869.42	869.42	526.13	1000.66	52.47	5741.47
MAGNUSO N #23I-221	MAGNUSO N #23I-221 (AWB)	MAGNUSO N #23I-221	SRC LEFFLER OFFSETS	550.47	984.25	984.25	545.88	1017.06	66.71	6774.93
MAGNUSS ON #1-23	MAGNUSS ON #1-23 (AWB)	MAGNUSS ON #1-23	SRC LEFFLER OFFSETS	883.52	1050.00	1050.00	872.85	1082.68	47.13	6020.34
TRACY #23M-203	TRACY #23M-203 (AWB)	TRACY #23M-203	SRC LEFFLER OFFSETS	914.75	7064.90	7064.90	838.36	7053.81	11.77	6971.78
LEFFLER #26Q-421	LEFFLER #26Q-421 (AWB)	LEFFLER #26Q-421	SRC LEFFLER OFFSETS	1157.85	11586.38	11586.38	1059.38	7544.36	9.21	7544.36
SRC LEFFLER #13-26D	SRC LEFFLER #13-26D (AWB)	SRC LEFFLER #13-26D	SRC LEFFLER OFFSETS	1367.40	10427.70	10427.70	1313.33	10427.70	25.29	10416.67
SRC LEFFLER #14-26D	SRC LEFFLER #14-26D (AWB)	SRC LEFFLER #14-26D	SRC LEFFLER OFFSETS	1381.87	11658.41	11658.41	1313.50	11663.39	20.10	11778.22
TRACY #31-23H	TRACY #31-23H (AWB)	TRACY #31-23H	SRC LEFFLER OFFSETS	2041.19	7135.83	7135.83	1922.36	7135.83	17.17	7103.02
SRC LEFFLER #23-26DX	SRC LEFFLER #23-26DX (AWB)	SRC LEFFLER #23-26DX	SRC LEFFLER OFFSETS	3679.87	508.53	10941.60	3677.06	500.00	364.18	11863.02