

Section 33  
T. 6 S., R 90 W.

Alkali Creek, LLC

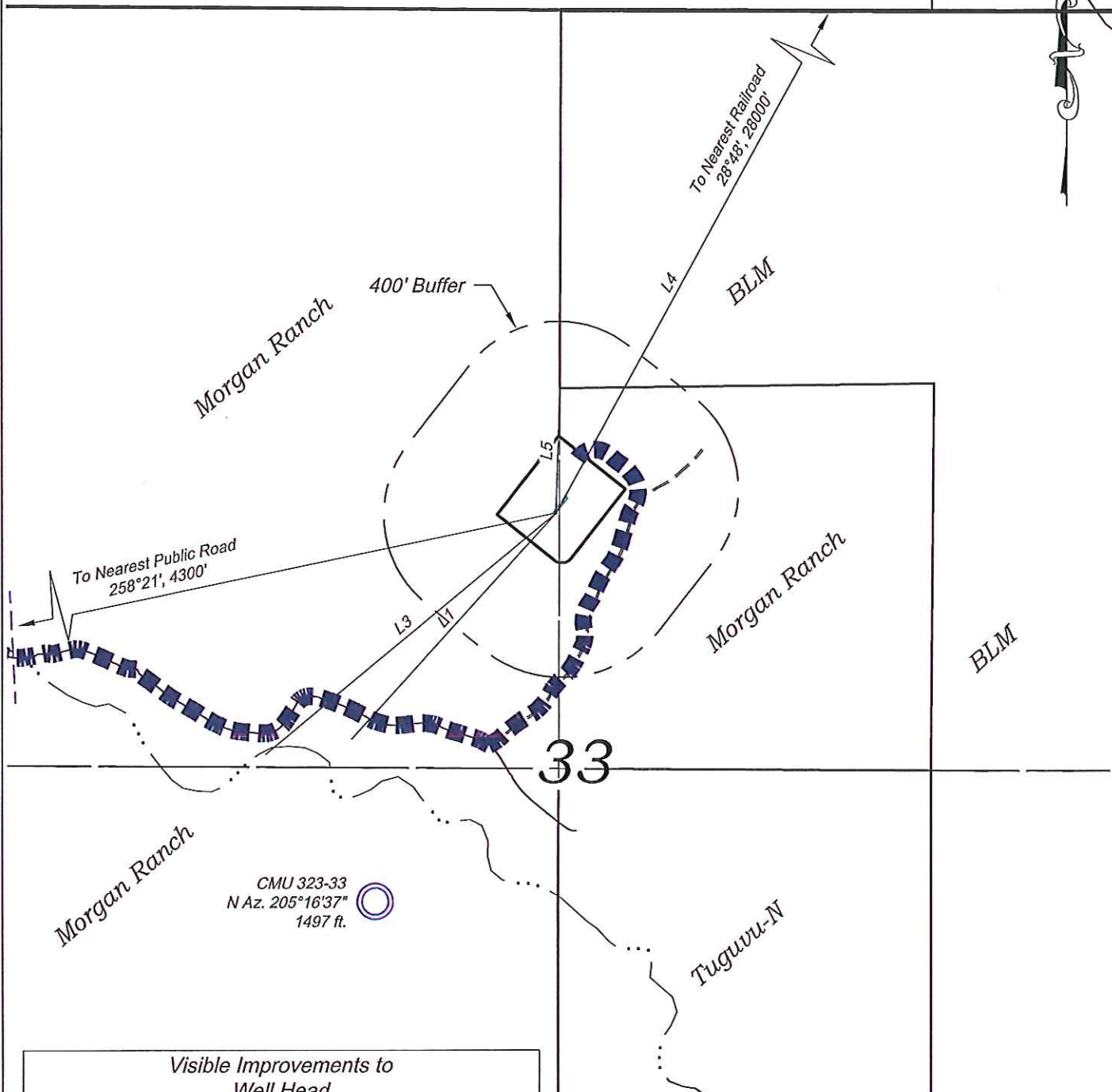
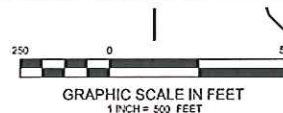

Visible Improvements to  
Well Head

| Desc.               | Bearing | Distance (ft) | Well       |
|---------------------|---------|---------------|------------|
| L1 Building         | 222°31' | 1067          | CMU 323-33 |
| Public Road         | 258°21' | 4300          | CMU 323-33 |
| L3 Above Grnd Util. | 230°43' | 1326          | CMU 323-33 |
| Railroad            | 28°48'  | 28000         | CMU 323-33 |
| L5 Property Line    | 01°50'  | 436           | CMU 323-33 |

| CURRENT LAND USE                          |   |                                      |
|---|---|--------------------------------------|
| <input type="checkbox"/> CROP LAND        | <input checked="" type="checkbox"/> NON-CROP LAND | <input type="checkbox"/> SUBDIVIDED  |
| <input type="checkbox"/> IRRIGATED        | <input checked="" type="checkbox"/> RANGELAND     | <input type="checkbox"/> INDUSTRIAL  |
| <input type="checkbox"/> DRY LAND         | <input type="checkbox"/> TIMBER                   | <input type="checkbox"/> COMMERCIAL  |
| <input type="checkbox"/> IMPROVED PASTURE | <input type="checkbox"/> RECREATIONAL             | <input type="checkbox"/> RESIDENTIAL |
| <input type="checkbox"/> HAY MEADOW       | <input type="checkbox"/> OTHER (describe):        |                                      |
| <input type="checkbox"/> CRP              |   |                                      |

REVISED: 3/7/13

Construction Plan Prepared for:

**WPXENERGY**

WPX Energy Rocky Mountain, LLC

CMU 22-33 Drill Pad - Plat 6  
LOCATION

136 East Third Street  
Rifle, Colorado 81650  
Ph. (970) 625-2720  
Fax (970) 625-2773



**BOOKCLIFF**  
Survey Services, Inc.

SCALE: 1" = 500'  
DATE: 2/29/13  
PLAT: 6 of 7  
PROJECT: Kokopelli  
DFT: cws