

Location	Weld County, CO, USA(Imported)	Slot	Slot #6
Field	Wattenberg	Well	SRC LEFFLER #B-26NBHZ
Installation	SRC LEFFLER	Wellbore	SRC LEFFLER #B-26NBHZ (PWB)

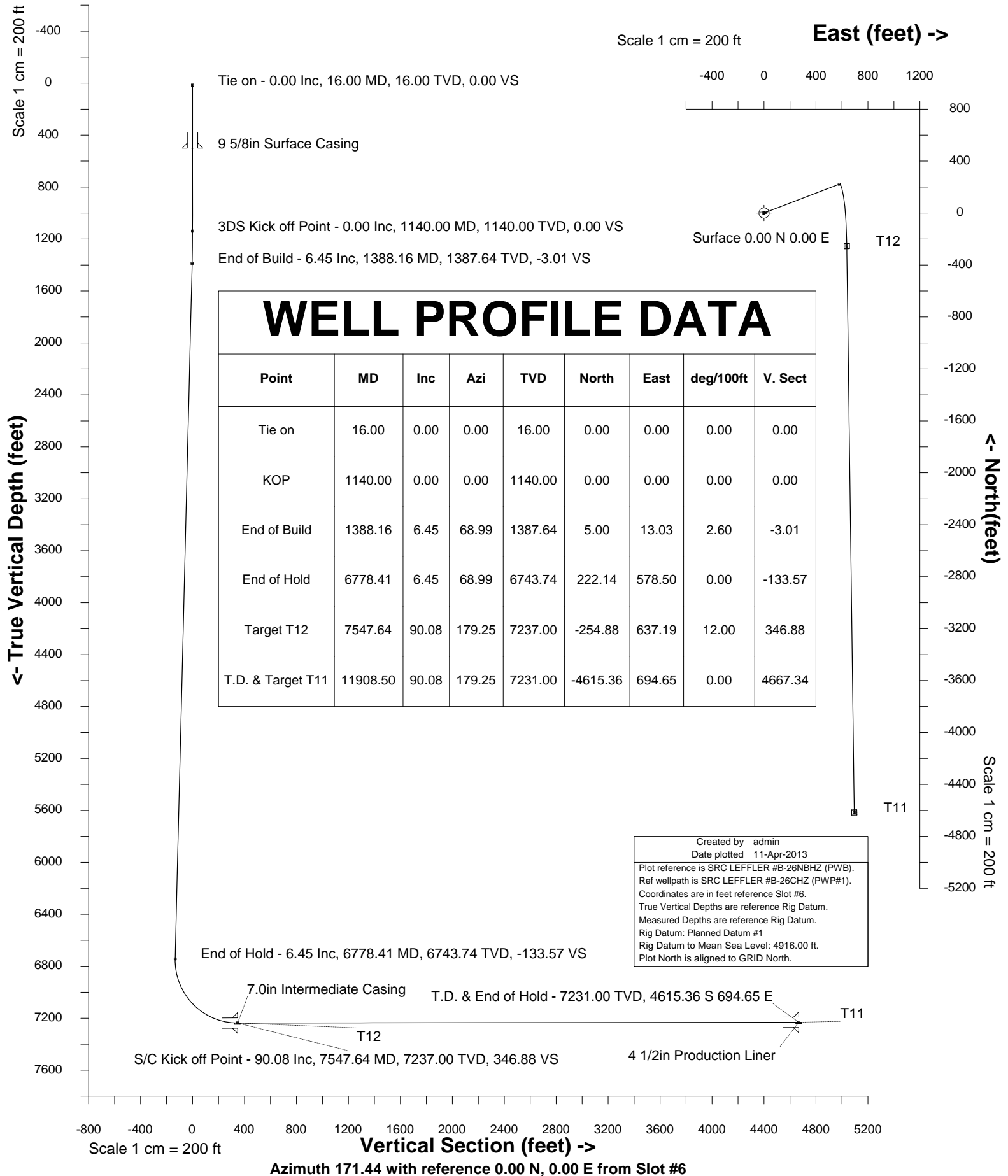



SYSDRILL
Well Design Combined Report
Wellbore: SRC LEFFLER #B-26NBHZ (PWB)
Wellpath: SRC LEFFLER #B-26CHZ (PWP#1)

Wellhead Details

Name	Northing	Easting	Latitude	Longitude	North	East
Slot #6	1445136.2610	3208253.6040	N40 33 10.3791	W104 45 2.0160	2.67N	112.44E

Site Details

Name	Northing	Easting	Coord System Name	North Alignment
SRC LEFFLER	1445133.5911	3208141.1650	CO83-NF on NORTH AMERICAN DATUM 1983 datum	Grid

Summary Wellpath

MD[ft]	Inc[deg]	Azi[deg]	TVD[ft]	North[ft]	East[ft]	Dogleg [deg/100ft]	Vertical Section[ft]	Northing	Easting
16.00	0.00	0.000	16.00	0.00N	0.00E		0.00	1445136.26	3208253.60
1140.00	0.00	0.000	1140.00	0.00N	0.00E	==>	0.00	1445136.26	3208253.60
1388.16	6.45	68.990	1387.64	5.00N	13.03E	2.60	-3.01	1445141.26	3208266.63
6778.41	6.45	68.990	6743.74	222.14N	578.50E	==>	-133.57	1445358.40	3208832.08
7547.64	90.08	179.250	7237.00	254.88S	637.19E	12.00	346.88	1444881.39	3208890.78
11908.50	90.08	179.250	7231.00	4615.36S	694.65E	==>	4667.34	1440521.05	3208948.23

Interpolated Wellpath

MD[ft]	Inc[deg]	Azi[deg]	TVD[ft]	North[ft]	East[ft]	Dogleg [deg/100ft]	Vertical Section[ft]	Northing	Easting
0.00	0.00	0.000	0.00	0.00N	0.00E		0.00	1445136.26	3208253.60
16.00	0.00	0.000	16.00	0.00N	0.00E	==>	0.00	1445136.26	3208253.60
100.00	0.00	0.000	100.00	0.00N	0.00E	==>	0.00	1445136.26	3208253.60
200.00	0.00	0.000	200.00	0.00N	0.00E	==>	0.00	1445136.26	3208253.60
300.00	0.00	0.000	300.00	0.00N	0.00E	==>	0.00	1445136.26	3208253.60
400.00	0.00	0.000	400.00	0.00N	0.00E	==>	0.00	1445136.26	3208253.60
500.00	0.00	0.000	500.00	0.00N	0.00E	==>	0.00	1445136.26	3208253.60
600.00	0.00	0.000	600.00	0.00N	0.00E	==>	0.00	1445136.26	3208253.60
700.00	0.00	0.000	700.00	0.00N	0.00E	==>	0.00	1445136.26	3208253.60
800.00	0.00	0.000	800.00	0.00N	0.00E	==>	0.00	1445136.26	3208253.60
900.00	0.00	0.000	900.00	0.00N	0.00E	==>	0.00	1445136.26	3208253.60
1000.00	0.00	0.000	1000.00	0.00N	0.00E	==>	0.00	1445136.26	3208253.60
1100.00	0.00	0.000	1100.00	0.00N	0.00E	==>	0.00	1445136.26	3208253.60
1124.00	0.00	0.000	1124.00	0.00N	0.00E	==>	0.00	1445136.26	3208253.60
1140.00	0.00	0.000	1140.00	0.00N	0.00E	==>	0.00	1445136.26	3208253.60
1224.00	2.18	68.990	1223.98	0.57N	1.49E	2.60	-0.35	1445136.83	3208255.10
1324.00	4.78	68.990	1323.79	2.75N	7.17E	2.60	-1.65	1445139.01	3208260.77
1388.16	6.45	68.990	1387.64	5.00N	13.03E	2.60	-3.01	1445141.26	3208266.63
1400.00	6.45	68.990	1399.40	5.48N	14.27E	==>	-3.30	1445141.74	3208267.88
1500.00	6.45	68.990	1498.77	9.51N	24.76E	==>	-5.72	1445145.77	3208278.37
1600.00	6.45	68.990	1598.13	13.54N	35.25E	==>	-8.14	1445149.80	3208288.86
1700.00	6.45	68.990	1697.50	17.57N	45.74E	==>	-10.56	1445153.83	3208299.35
1800.00	6.45	68.990	1796.87	21.59N	56.23E	==>	-12.98	1445157.85	3208309.84
1900.00	6.45	68.990	1896.23	25.62N	66.73E	==>	-15.41	1445161.88	3208320.33
2000.00	6.45	68.990	1995.60	29.65N	77.22E	==>	-17.83	1445165.91	3208330.82
2100.00	6.45	68.990	2094.97	33.68N	87.71E	==>	-20.25	1445169.94	3208341.31
2200.00	6.45	68.990	2194.33	37.71N	98.20E	==>	-22.67	1445173.97	3208351.80
2300.00	6.45	68.990	2293.70	41.74N	108.69E	==>	-25.09	1445178.00	3208362.29
2400.00	6.45	68.990	2393.07	45.76N	119.18E	==>	-27.52	1445182.02	3208372.78
2500.00	6.45	68.990	2492.43	49.79N	129.67E	==>	-29.94	1445186.05	3208383.27
2600.00	6.45	68.990	2591.80	53.82N	140.16E	==>	-32.36	1445190.08	3208393.76
2700.00	6.45	68.990	2691.17	57.85N	150.65E	==>	-34.78	1445194.11	3208404.25
2800.00	6.45	68.990	2790.53	61.88N	161.14E	==>	-37.21	1445198.14	3208414.74
2900.00	6.45	68.990	2889.90	65.91N	171.63E	==>	-39.63	1445202.16	3208425.23
3000.00	6.45	68.990	2989.27	69.93N	182.12E	==>	-42.05	1445206.19	3208435.72
3100.00	6.45	68.990	3088.63	73.96N	192.61E	==>	-44.47	1445210.22	3208446.21
3200.00	6.45	68.990	3188.00	77.99N	203.10E	==>	-46.89	1445214.25	3208456.70
3300.00	6.45	68.990	3287.37	82.02N	213.59E	==>	-49.32	1445218.28	3208467.19
3400.00	6.45	68.990	3386.73	86.05N	224.08E	==>	-51.74	1445222.31	3208477.68
3500.00	6.45	68.990	3486.10	90.08N	234.57E	==>	-54.16	1445226.33	3208488.17
3600.00	6.45	68.990	3585.47	94.10N	245.06E	==>	-56.58	1445230.36	3208498.66
3700.00	6.45	68.990	3684.83	98.13N	255.56E	==>	-59.00	1445234.39	3208509.15
3800.00	6.45	68.990	3784.20	102.16N	266.05E	==>	-61.43	1445238.42	3208519.64
3900.00	6.45	68.990	3883.57	106.19N	276.54E	==>	-63.85	1445242.45	3208530.13
4000.00	6.45	68.990	3982.93	110.22N	287.03E	==>	-66.27	1445246.48	3208540.62
4100.00	6.45	68.990	4082.30	114.25N	297.52E	==>	-68.69	1445250.50	3208551.11
4200.00	6.45	68.990	4181.67	118.27N	308.01E	==>	-71.12	1445254.53	3208561.60
4300.00	6.45	68.990	4281.03	122.30N	318.50E	==>	-73.54	1445258.56	3208572.09
4400.00	6.45	68.990	4380.40	126.33N	328.99E	==>	-75.96	1445262.59	3208582.58
4500.00	6.45	68.990	4479.77	130.36N	339.48E	==>	-78.38	1445266.62	3208593.07
4600.00	6.45	68.990	4579.13	134.39N	349.97E	==>	-80.80	1445270.64	3208603.56
4700.00	6.45	68.990	4678.50	138.42N	360.46E	==>	-83.23	1445274.67	3208614.05
4800.00	6.45	68.990	4777.87	142.44N	370.95E	==>	-85.65	1445278.70	3208624.54

All data is in Feet unless otherwise stated
Coordinates are from Slot MD's are from Rig and TVD's are from Rig (Planned Datum #1 4916.0ft above Mean Sea Level)
Vertical Section is from 0.00N 0.00E on azimuth 171.440 degrees
Bottom hole distance is 4667.34 Feet on azimuth 171.44 degrees from Wellhead
Calculation method uses Minimum Curvature method
Prepared by Peterson Energy
Date Printed: 11-Apr-2013



SYSDRILL
Well Design Combined Report
Wellbore: SRC LEFFLER #B-26NBHZ (PWB)
Wellpath: SRC LEFFLER #B-26CHZ (PWP#1)

Interpolated Wellpath

MD[ft]	Inc[deg]	Azi[deg]	TVD[ft]	North[ft]	East[ft]	Dogleg [deg/100ft]	Vertical Section[ft]	Northing	Easting
4900.00	6.45	68.990	4877.23	146.47N	381.44E	==>	-88.07	1445282.73	3208635.03
5000.00	6.45	68.990	4976.60	150.50N	391.93E	==>	-90.49	1445286.76	3208645.52
5100.00	6.45	68.990	5075.96	154.53N	402.42E	==>	-92.92	1445290.79	3208656.01
5200.00	6.45	68.990	5175.33	158.56N	412.91E	==>	-95.34	1445294.81	3208666.51
5300.00	6.45	68.990	5274.70	162.59N	423.40E	==>	-97.76	1445298.84	3208677.00
5400.00	6.45	68.990	5374.06	166.61N	433.90E	==>	-100.18	1445302.87	3208687.49
5500.00	6.45	68.990	5473.43	170.64N	444.39E	==>	-102.60	1445306.90	3208697.98
5600.00	6.45	68.990	5572.80	174.67N	454.88E	==>	-105.03	1445310.93	3208708.47
5700.00	6.45	68.990	5672.16	178.70N	465.37E	==>	-107.45	1445314.96	3208718.96
5800.00	6.45	68.990	5771.53	182.73N	475.86E	==>	-109.87	1445318.98	3208729.45
5900.00	6.45	68.990	5870.90	186.76N	486.35E	==>	-112.29	1445323.01	3208739.94
6000.00	6.45	68.990	5970.26	190.78N	496.84E	==>	-114.71	1445327.04	3208750.43
6100.00	6.45	68.990	6069.63	194.81N	507.33E	==>	-117.14	1445331.07	3208760.92
6200.00	6.45	68.990	6169.00	198.84N	517.82E	==>	-119.56	1445335.10	3208771.41
6300.00	6.45	68.990	6268.36	202.87N	528.31E	==>	-121.98	1445339.12	3208781.90
6400.00	6.45	68.990	6367.73	206.90N	538.80E	==>	-124.40	1445343.15	3208792.39
6500.00	6.45	68.990	6467.10	210.93N	549.29E	==>	-126.83	1445347.18	3208802.88
6600.00	6.45	68.990	6566.46	214.96N	559.78E	==>	-129.25	1445351.21	3208813.37
6700.00	6.45	68.990	6665.83	218.98N	570.27E	==>	-131.67	1445355.24	3208823.86
6778.41	6.45	68.990	6743.74	222.14N	578.50E	==>	-133.57	1445358.40	3208832.08
6800.00	6.07	92.670	6765.21	222.52N	580.77E	12.00	-133.61	1445358.78	3208834.36
6900.00	13.75	153.530	6863.86	211.60N	591.38E	12.00	-121.23	1445347.86	3208844.97
7000.00	25.06	166.120	6958.06	180.29N	601.80E	12.00	-88.72	1445316.55	3208855.38
7100.00	36.80	171.080	7043.71	129.96N	611.56E	12.00	-37.50	1445266.22	3208865.14
7200.00	48.65	173.880	7117.05	62.81N	620.23E	12.00	30.20	1445199.07	3208873.82
7300.00	60.54	175.800	7174.88	18.22S	627.45E	12.00	111.40	1445118.04	3208881.04
7400.00	72.46	177.320	7214.68	109.60S	632.89E	12.00	202.58	1445026.66	3208886.48
7500.00	84.39	178.640	7234.70	207.33S	636.32E	12.00	299.73	1444928.94	3208889.90
7547.64	90.08	179.250	7237.00	254.88S	637.19E	12.00	346.88	1444881.39	3208890.78
7600.00	90.08	179.250	7236.93	307.24S	637.88E	==>	398.76	1444829.03	3208891.47
7700.00	90.08	179.250	7236.79	407.23S	639.20E	==>	497.83	1444729.04	3208892.79
7800.00	90.08	179.250	7236.65	507.22S	640.52E	==>	596.91	1444629.55	3208894.10
7900.00	90.08	179.250	7236.52	607.22S	641.84E	==>	695.98	1444529.06	3208895.42
8000.00	90.08	179.250	7236.38	707.21S	643.15E	==>	795.05	1444429.08	3208896.74
8100.00	90.08	179.250	7236.24	807.20S	644.47E	==>	894.13	1444329.09	3208898.06
8200.00	90.08	179.250	7236.10	907.19S	645.79E	==>	993.20	1444229.10	3208899.37
8300.00	90.08	179.250	7235.96	1007.18S	647.11E	==>	1092.27	1444129.11	3208900.69
8400.00	90.08	179.250	7235.83	1107.17S	648.43E	==>	1191.35	1444029.12	3208902.01
8500.00	90.08	179.250	7235.69	1207.16S	649.74E	==>	1290.42	1443929.14	3208903.33
8600.00	90.08	179.250	7235.55	1307.15S	651.06E	==>	1389.49	1443829.15	3208904.64
8700.00	90.08	179.250	7235.41	1407.15S	652.38E	==>	1488.57	1443729.16	3208905.96
8800.00	90.08	179.250	7235.28	1507.14S	653.70E	==>	1587.64	1443629.17	3208907.28
8900.00	90.08	179.250	7235.14	1607.13S	655.01E	==>	1686.72	1443529.18	3208908.60
9000.00	90.08	179.250	7235.00	1707.12S	656.33E	==>	1785.79	1443429.19	3208909.91
9100.00	90.08	179.250	7234.86	1807.11S	657.65E	==>	1884.86	1443329.21	3208911.23
9200.00	90.08	179.250	7234.73	1907.10S	658.97E	==>	1983.94	1443229.22	3208912.55
9300.00	90.08	179.250	7234.59	2007.09S	660.28E	==>	2083.01	1443129.23	3208913.87
9400.00	90.08	179.250	7234.45	2107.08S	661.60E	==>	2182.08	1443029.24	3208915.18
9500.00	90.08	179.250	7234.31	2207.08S	662.92E	==>	2281.16	1442929.25	3208916.50
9600.00	90.08	179.250	7234.18	2307.07S	664.24E	==>	2380.23	1442829.27	3208917.82
9700.00	90.08	179.250	7234.04	2407.06S	665.55E	==>	2479.31	1442729.28	3208919.14
9800.00	90.08	179.250	7233.90	2507.05S	666.87E	==>	2578.38	1442629.29	3208920.45
9900.00	90.08	179.250	7233.76	2607.04S	668.19E	==>	2677.45	1442529.30	3208921.77
10000.00	90.08	179.250	7233.63	2707.03S	669.51E	==>	2776.53	1442429.31	3208923.09
10100.00	90.08	179.250	7233.49	2807.02S	670.82E	==>	2875.60	1442329.33	3208924.41
10200.00	90.08	179.250	7233.35	2907.01S	672.14E	==>	2974.67	1442229.34	3208925.72
10300.00	90.08	179.250	7233.21	3007.01S	673.46E	==>	3073.75	1442129.35	3208927.04
10400.00	90.08	179.250	7233.08	3107.00S	674.78E	==>	3172.82	1442029.36	3208928.36
10500.00	90.08	179.250	7232.94	3206.99S	676.09E	==>	3271.89	1441929.37	3208929.68
10600.00	90.08	179.250	7232.80	3306.98S	677.41E	==>	3370.97	1441829.39	3208930.99
10700.00	90.08	179.250	7232.66	3406.97S	678.73E	==>	3470.04	1441729.40	3208932.31
10800.00	90.08	179.250	7232.53	3506.96S	680.05E	==>	3569.12	1441629.41	3208933.63
10900.00	90.08	179.250	7232.39	3606.95S	681.36E	==>	3668.19	1441529.42	3208934.95
11000.00	90.08	179.250	7232.25	3706.94S	682.68E	==>	3767.26	1441429.43	3208936.26
11100.00	90.08	179.250	7232.11	3806.94S	684.00E	==>	3866.34	1441329.44	3208937.58
11200.00	90.08	179.250	7231.97	3906.93S	685.32E	==>	3965.41	1441229.46	3208938.90
11300.00	90.08	179.250	7231.84	4006.92S	686.63E	==>	4064.48	1441129.47	3208940.22
11400.00	90.08	179.250	7231.70	4106.91S	687.95E	==>	4163.56	1441029.48	3208941.53
11500.00	90.08	179.250	7231.56	4206.90S	689.27E	==>	4262.63	1440929.49	3208942.85
11600.00	90.08	179.250	7231.42	4306.89S	690.59E	==>	4361.70	1440829.50	3208944.17
11700.00	90.08	179.250	7231.29	4406.88S	691.90E	==>	4460.78	1440729.52	3208945.49
11800.00	90.08	179.250	7231.15	4506.87S	693.22E	==>	4559.85	1440629.53	3208946.80
11900.00	90.08	179.250	7231.01	4606.87S	694.54E	==>	4658.93	1440529.54	3208948.12
11908.50	90.08	179.250	7231.00	4615.36S	694.65E	==>	4667.34	1440521.05	3208948.23

All data is in Feet unless otherwise stated
Coordinates are from Slot MD's are from Rig and TVD's are from Rig (Planned Datum #1 4916.0ft above Mean Sea Level)
Vertical Section is from 0.00N 0.00E on azimuth 171.440 degrees
Bottom hole distance is 4667.34 Feet on azimuth 171.44 degrees from Wellhead
Calculation method uses Minimum Curvature method
Prepared by Peterson Energy
Date Printed: 11-Apr-2013



SYSDRILL
Well Design Combined Report
Wellbore: SRC LEFFLER #B-26NBHZ (PWB)
Wellpath: SRC LEFFLER #B-26CHZ (PWP#1)

Hole Sections

Diameter [in]	Start MD[ft]	Start TVD[ft]	Start North[ft]	Start East[ft]	End MD[ft]	End TVD[ft]	End North[ft]	End East[ft]	Wellbore
12 1/4	16.00	16.00	0.00N	0.00E	500.00	500.00	0.00N	0.00E	SRC LEFFLER #B-26NBHZ (PWB)
8 5/8	500.00	500.00	0.00N	0.00E	7548.00	7237.00	255.25S	637.20E	SRC LEFFLER #B-26NBHZ (PWB)
6 1/8	7548.00	7237.00	255.25S	637.20E	11908.50	7231.00	4615.36S	694.65E	SRC LEFFLER #B-26NBHZ (PWB)

Casings

Name	Top MD[ft]	Top TVD[ft]	Top North[ft]	Top East[ft]	Shoe MD[ft]	Shoe TVD[ft]	Shoe North[ft]	Shoe East[ft]	Wellbore
9 5/8in Surface Casing	16.00	16.00	0.00N	0.00E	500.00	500.00	0.00N	0.00E	SRC LEFFLER #B-26NBHZ (PWB)
7.0in Intermediate Casing	16.00	16.00	0.00N	0.00E	7548.00	7237.00	255.25S	637.20E	SRC LEFFLER #B-26NBHZ (PWB)
4 1/2in Production Liner	6800.00	6765.21	222.52N	580.77E	11908.50	7231.00	4615.36S	694.65E	SRC LEFFLER #B-26NBHZ (PWB)

Targets

Name	North[ft]	East[ft]	TVD[ft]	Latitude	Longitude	Northing	Easting	Last Revised
T11	4615.36S	694.65E	7231.00	N40 32 24.7165	W104 44 53.5243	1440521.05	3208948.23	8-Apr-2013
T12	254.88S	637.19E	7237.00	N40 33 7.8073	W104 44 53.7896	1444881.39	3208890.78	8-Apr-2013

Survey Tool Program

Reference	Survey Name	MD[ft]	TVD[ft]	Survey Tool	Error Model
17365	Planned	11908.50	7231.00	WdW Rate Gyro	Standard

Notes

All data is in Feet unless otherwise stated
Coordinates are from Slot MD's are from Rig and TVD's are from Rig (Planned Datum #1 4916.0ft above Mean Sea Level)
Vertical Section is from 0.00N 0.00E on azimuth 171.440 degrees
Bottom hole distance is 4667.34 Feet on azimuth 171.44 degrees from Wellhead
Calculation method uses Minimum Curvature method
Prepared by Peterson Energy
Date Printed: 11-Apr-2013



SYSDRILL
Closest Approach + Clearance Factor Summary Report
Wellbore: SRC LEFFLER #B-26NBHZ (PWB)
Wellpath: SRC LEFFLER #B-26CHZ (PWP#1)

Ellipse separations are reported ONLY if BOTH wells have uncertainty data
Only Depth and Magnetic Reference Field error terms are correlated across tie points
Cutoff is calculated on CENTRE to CENTRE distance

Summary data uses Closest Approach clearance calculation for all minima
Hole size/Casings ARE included
Hole size/Casings are NOT subtracted from Centre-Centre distance
Confidence limit of 95.00% / 2.80 SD.

Wellbore

Name	Created	Last Revised
SRC LEFFLER #B-26NBHZ (PWB)	1-Apr-2013	10-Apr-2013

Well

Name	Government ID	Last Revised
SRC LEFFLER #B-26NBHZ		1-Apr-2013

Slot

Name	Grid Northing	Grid Easting	Latitude	Longitude	North	East
Slot #6	1445136.2610	3208253.6040	N40 33 10.3791	W104 45 2.0160	2.67N	112.44E

Installation

Name	Easting	Northing	Coord System Name	North Alignment
SRC LEFFLER	3208141.1650	1445133.5911	CO83-NF on NORTH AMERICAN DATUM 1983 datum	Grid

Field

Name	Easting	Northing	Coord System Name	North Alignment
Wattenberg	41136929.7567	12284170.6461	CO83-NF on NORTH AMERICAN DATUM 1983 datum	Grid

Clearance Summary

Offset WellName	Offset Wellbore	Offset Slot	Offset Structure	Separation [ft]	MD[ft]	Diverging From[ft]	Ellipse Separation [ft]	Ellipse MD[ft]	Clearance Factor	Clearance MD[ft]
SRC LEFFLER #24-26NHZ	SRC LEFFLER #24-26NHZ (PWB)	Slot #7	SRC LEFFLER	22.49	1065.87	1065.87	20.15	1065.87	4.71	11908.50
SRC LEFFLER #B-26CHZ	SRC LEFFLER #B-26CHZ (PWB)	Slot #5	SRC LEFFLER	22.50	1140.00	11908.50	20.03	1147.89	3.72	11908.50
SRC LEFFLER #P-26NHZ	SRC LEFFLER #P-26NHZ (PWB)	Slot #8	SRC LEFFLER	44.99	951.04	11897.21	42.83	951.04	8.90	11908.50
SRC LEFFLER #B-26NAHZ	SRC LEFFLER #B-26NAHZ (PWB)	Slot #4	SRC LEFFLER	44.99	1140.00	11908.50	42.53	1147.89	7.98	11908.50
SRC LEFFLER P-26CHZ	SRC LEFFLER P-26CHZ (PWB)	Slot #9	SRC LEFFLER	67.48	852.61	852.61	65.48	852.61	11.25	11908.50
SRC LEFFLER #14-26NHZ	SRC LEFFLER #14-26NHZ (PWB)	Slot #3	SRC LEFFLER	67.49	1033.06	1033.06	65.20	1033.06	13.11	11908.50
SRC LEFFLER #H-26CHZ	SRC LEFFLER #H-26CHZ (PWB)	Slot #2	SRC LEFFLER	89.98	967.44	11908.50	87.80	967.44	17.07	11908.50
SRC LEFFLER #H-26NHZ	SRC LEFFLER #H-26NHZ (PWB)	Slot #1	SRC LEFFLER	112.47	852.61	11908.50	110.47	852.61	18.86	11908.50
SRC LEFFLER #24-26D	SRC LEFFLER #24-26D (AWB)	SRC LEFFLER #24-26D	SRC LEFFLER OFFSETS	270.18	11707.94	11707.94	199.72	11728.60	3.78	11745.00
SRC LEFFLER #23-26D	SRC LEFFLER #23-26D (AWB)	SRC LEFFLER #23-26D	SRC LEFFLER OFFSETS	306.03	10434.58	10434.58	250.13	10434.58	5.47	10432.67

All data is in Feet unless otherwise stated
Coordinates are from Slot MD's are from Rig and TVD's are from Rig (Planned Datum #1 4916.0ft above Mean Sea Level)
Vertical Section is from 0.00N 0.00E on azimuth 171.440 degrees
Prepared by Peterson Energy
Date Printed: 11-Apr-2013



SYSDRILL
Closest Approach + Clearance Factor Summary Report
Wellbore: SRC LEFFLER #B-26NBHZ (PWB)
Wellpath: SRC LEFFLER #B-26CHZ (PWP#1)

Clearance Summary

Offset WellName	Offset Wellbore	Offset Slot	Offset Structure	Separation [ft]	MD[ft]	Diverging From[ft]	Ellipse Separation [ft]	Ellipse MD[ft]	Clearance Factor	Clearance MD[ft]
MAGNUSO N #23L-421	MAGNUSON #23L-421 (AWB)	MAGNUSO N #23L-421	SRC LEFFLER OFFSETS	309.03	2624.27	6930.78	290.47	2689.88	11.14	7069.81
MAGNUSO N #23L-201	MAGNUSON #23L-201 (AWB)	MAGNUSO N #23L-201	SRC LEFFLER OFFSETS	384.54	5454.73	5454.73	362.16	5454.73	16.99	5626.24
MAGNUSO N #23I-421	MAGNUSON #23I-421 (AWB)	MAGNUSO N #23I-421	SRC LEFFLER OFFSETS	516.02	1016.66	1016.66	511.22	1098.68	39.90	6816.00
MAGNUSO N #23I-221	MAGNUSON #23I-221 (AWB)	MAGNUSO N #23I-221	SRC LEFFLER OFFSETS	536.00	1000.25	1000.25	531.40	1033.06	53.92	6823.74
MAGNUSS ON #1-23	MAGNUSSO N #1-23 (AWB)	MAGNUSS ON #1-23	SRC LEFFLER OFFSETS	873.58	1147.89	1147.89	862.37	1246.31	36.60	6807.34
SRC LEFFLER #13-26D	SRC LEFFLER #13-26D (AWB)	SRC LEFFLER #13-26D	SRC LEFFLER OFFSETS	974.91	10471.20	10471.20	920.79	10471.20	18.01	10465.48
SRC LEFFLER #14-26D	SRC LEFFLER #14-26D (AWB)	SRC LEFFLER #14-26D	SRC LEFFLER OFFSETS	986.82	11705.25	11705.25	918.37	11716.00	14.35	11777.81
TRACY #23M-203	TRACY #23M-203 (AWB)	TRACY #23M-203	SRC LEFFLER OFFSETS	1162.07	7053.40	7053.40	1064.69	7037.00	11.84	6971.38
LEFFLER #26Q-421	LEFFLER #26Q-421 (AWB)	LEFFLER #26Q-421	SRC LEFFLER OFFSETS	1553.48	11622.23	11622.23	1447.72	7569.47	12.26	7547.64
TRACY #31-23H	TRACY #31-23H (AWB)	TRACY #31-23H	SRC LEFFLER OFFSETS	2379.30	7102.61	7102.61	2258.43	7102.61	19.68	7069.81
SRC LEFLER #23-26DX	SRC LEFLER #23-26DX (AWB)	SRC LEFLER #23-26DX	SRC LEFFLER OFFSETS	3679.84	524.53	10974.01	3677.09	491.72	366.42	11908.50