

LEGEND:

 PROPOSED LOCATION



EE3 LLC.

DAMFINO #02-06H ON EXISTING
SURPRISE #04-06H PAD
SECTION 6, T6N, R80W, 6th P.M.
SW 1/4 SE 1/4



Uintah Engineering & Land Surveying
85 South 200 East Vernal, Utah 84078
(435) 789-1017 * FAX (435) 789-1813

**ACCESS ROAD
MAP**

11 13 07
MONTH DAY YEAR



SCALE: 1:100,000 DRAWN BY: Z.L. REV: 04-16-13 B.D.H.

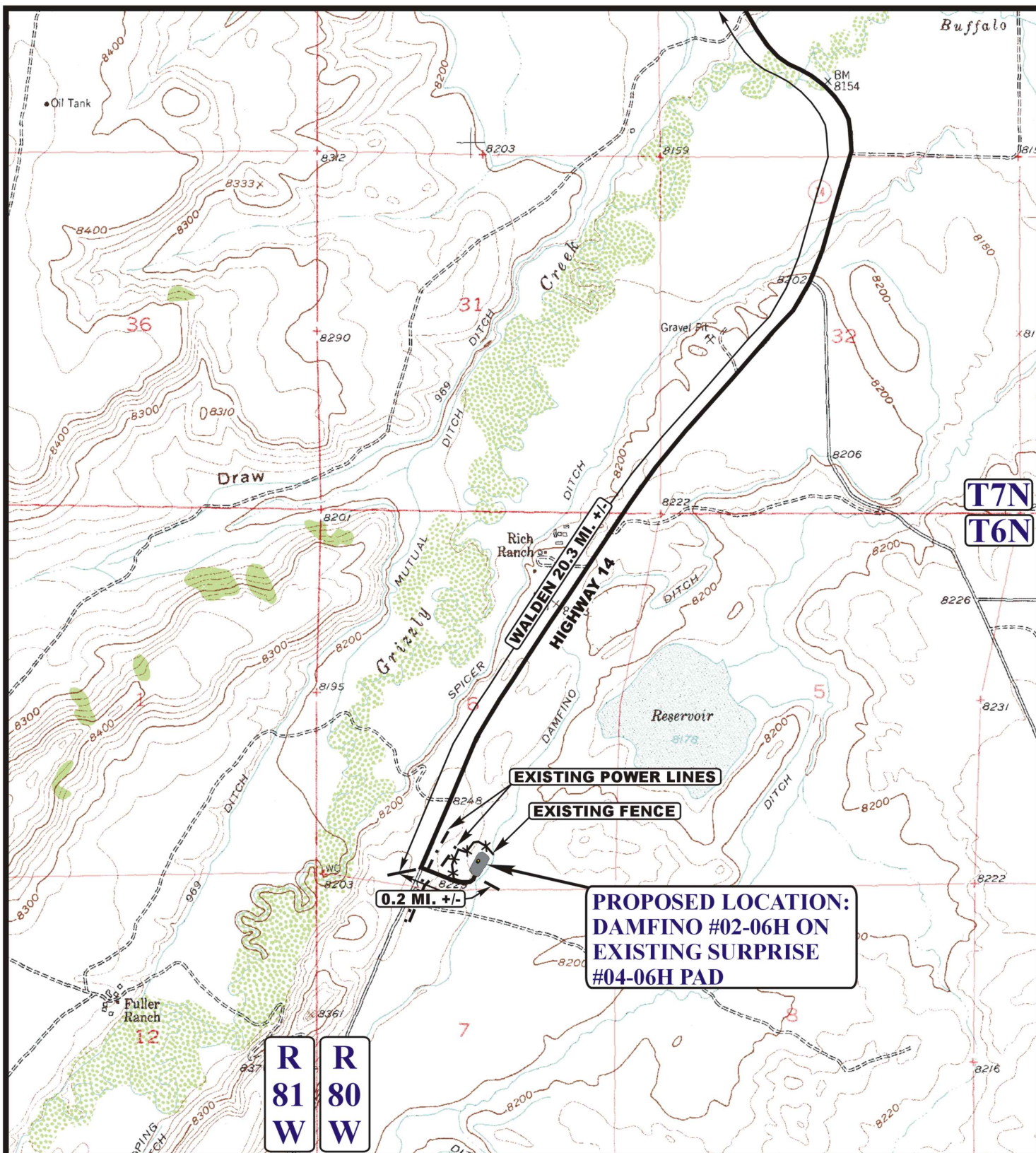

LEGEND:

EXISTING ROAD
 EXISTING FENCE
 EXISTING POWER LINE



EE3 LLC.

DAMFINO #02-06H ON EXISTING
SURPRISE #04-06H PAD
SECTION 6, T6N, R80W, 6th P.M.
SW 1/4 SE 1/4



Uintah Engineering & Land Surveying
85 South 200 East Vernal, Utah 84078
(435) 789-1017 * FAX (435) 789-1813

ACCESS ROAD
MAP

11 **13** **07**
MONTH DAY YEAR

SCALE: 1" = 2000' DRAWN BY: Z.L. REV: 04-16-13 B.D.H.

