

WELL LOCATION CERTIFICATE: DOVE 5N-13HZ

SECTION 12, TOWNSHIP 2 NORTH, RANGE 66 WEST, 6TH P.M.

NW SEC. 12
3/4" ALUM. CAP
PLS 13155

NE SEC. 12
2" ALUM. CAP
PLS 23027

N 1/4 SEC. 12
3/4" ALUM. CAP
PLS 13155

NOTES:
BH LOCATION PROVIDED BY CLIENT.
LAND SURFACE USE-RANGELAND
SEE ATTACHED MAP FOR ADDITIONAL
IMPROVEMENTS WITHIN 400'.

PDOP= 2.3
GPS OPERATOR: OWEN MCKEE

12

W 1/4 SEC. 12
2" ALUM. CAP
PLS 25937

N 88°53'23" E 2653.10'

N 88°54'12" E 2651.06'

E 1/4 SEC. 12
2 1/2" ALUM. CAP
PLS 32828

C 1/4 SEC. 12
2" ALUM. CAP
PLS 12330

SURFACE LOCATION
GROUND ELEVATION= 5000'
NAD83
LATITUDE= 40.158768°
LONGITUDE= 104.732747°

LATITUDE= 40°09'31.566"
LONGITUDE= 104°43'57.891"

BOTTOM HOLE LOCATION
NAD83
LATITUDE= 40.139624°
LONGITUDE= 104.731087°

LATITUDE= 40°08'22.648"
LONGITUDE= 104°43'51.912"

S 1/4 SEC. 12
2" ALUM. CAP
PLS 25937

S 88°26'08" W 2646.68'

SE SEC. 12
3/4" ALUM. CAP
PLS 12330

SW SEC. 12
2 1/2" ALUM. CAP
PLS 19585

S 88°25'55" W 2646.95'
BH- 2208' FNL
1054' FWL

(BASIS OF BEARINGS) SEE NOTE 3

LEGEND

- ⊕ = EXISTING MONUMENT ⊕ = BOTTOM HOLE
● = PROPOSED WELL ◆ = EXISTING WELL
BH = BOTTOM HOLE

WELL DOVE 5N-13HZ TO BE LOCATED 500' FNL AND 590' FWL

0 500 1000

SCALE: 1"=1000'

NOTES:

- THIS FIELD SURVEY CONFORMS TO THE MINIMUM STANDARDS SET BY THE C.O.G.C.C., RULE NO. 215
- HORIZONTAL POSITIONS AND ORTHOMETRIC ELEVATIONS SHOWN AT THE WELL HEAD, ARE BASED ON GPS-RTK POSITIONS DERIVED FROM MINIMUM 2-HOUR STATIC OBSERVATIONS CORRECTED BY THE NATIONAL GEODETIC SURVEY ONLINE POSITIONING USER SERVICE, O.P.U.S. DATUM: HORIZONTAL = NAD83/2007, VERTICAL = NAVD88
- THE BASIS OF BEARINGS ARE STATE PLANE COORDINATE SYSTEM GRID BEARINGS SHOWN HEREON BETWEEN THE DESCRIBED MONUMENTS SHOWN HEREON.
- GRID DISTANCES ARE SHOWN, AS MEASURED IN THE FIELD, WITH TIES TO WELLS MEASURED PERPENDICULAR TO SECTION LINES.

I, MARK A. HALL, A LICENSED PROFESSIONAL LAND SURVEYOR IN THE STATE OF COLORADO DO HEREBY CERTIFY TO **KERR-MCGEE OIL & GAS ONSHORE LP**, THAT THE SURVEY AND WELL LOCATION CERTIFICATE SHOWN HEREON WERE DONE BY ME OR UNDER MY DIRECT SUPERVISION AND THAT THE DRAWING SHOWN HEREON ACCURATELY DEPICTS THE PROPOSED LOCATION OF THE WELL. THIS CERTIFICATE DOES NOT REPRESENT A LAND SURVEY PLAT OR IMPROVEMENT SURVEY PLAT AS DEFINED BY C.R.S. 38-51-102 AND CANNOT BE RELIED UPON TO DETERMINE OWNERSHIP.

MARK A. HALL, PLS 36073
COLORADO LICENSED PROFESSIONAL LAND SURVEYOR
FOR AND ON BEHALF OF P.F.S., LLC

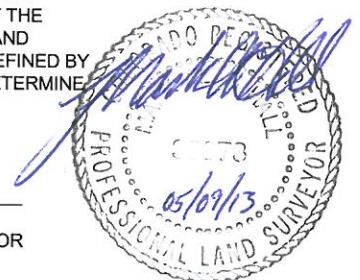

SHEET 1 OF 2

PREPARED BY:



FIELD DATE:

04-13-12

DRAWING DATE:

05-07-13

BY:

CLM

REV:

TJN

SURFACE LOCATION:

NW 1/4 NW 1/4,

SEC. 12, T2N, R66W, 6TH P.M.

WELD COUNTY, COLORADO

NOTICE: ACCORDING TO COLORADO LAW YOU MUST COMMENCE ANY LEGAL ACTION BASED UPON ANY DEFECT IN THIS SURVEY WITHIN THREE YEARS AFTER YOU FIRST DISCOVER SUCH DEFECT. IN NO EVENT MAY ANY ACTION BASED UPON ANY DEFECT IN THIS SURVEY BE COMMENCED MORE THAN TEN YEARS FROM THIS SAID DATE OF THIS CERTIFICATION SHOWN HEREON.

SECTION 13, TOWNSHIP 2 NORTH, RANGE 66 WEST, 6TH P.M.

