

Petrox Resources, Inc.
Fosset Gulch Unit 9U #3
1310' FSL, 1755' FWL
Section 9U, T34N, R5W, S.U.L., N.M.P.M.,
Archuleta County, Co.
Ground Level Elevation: 7445'

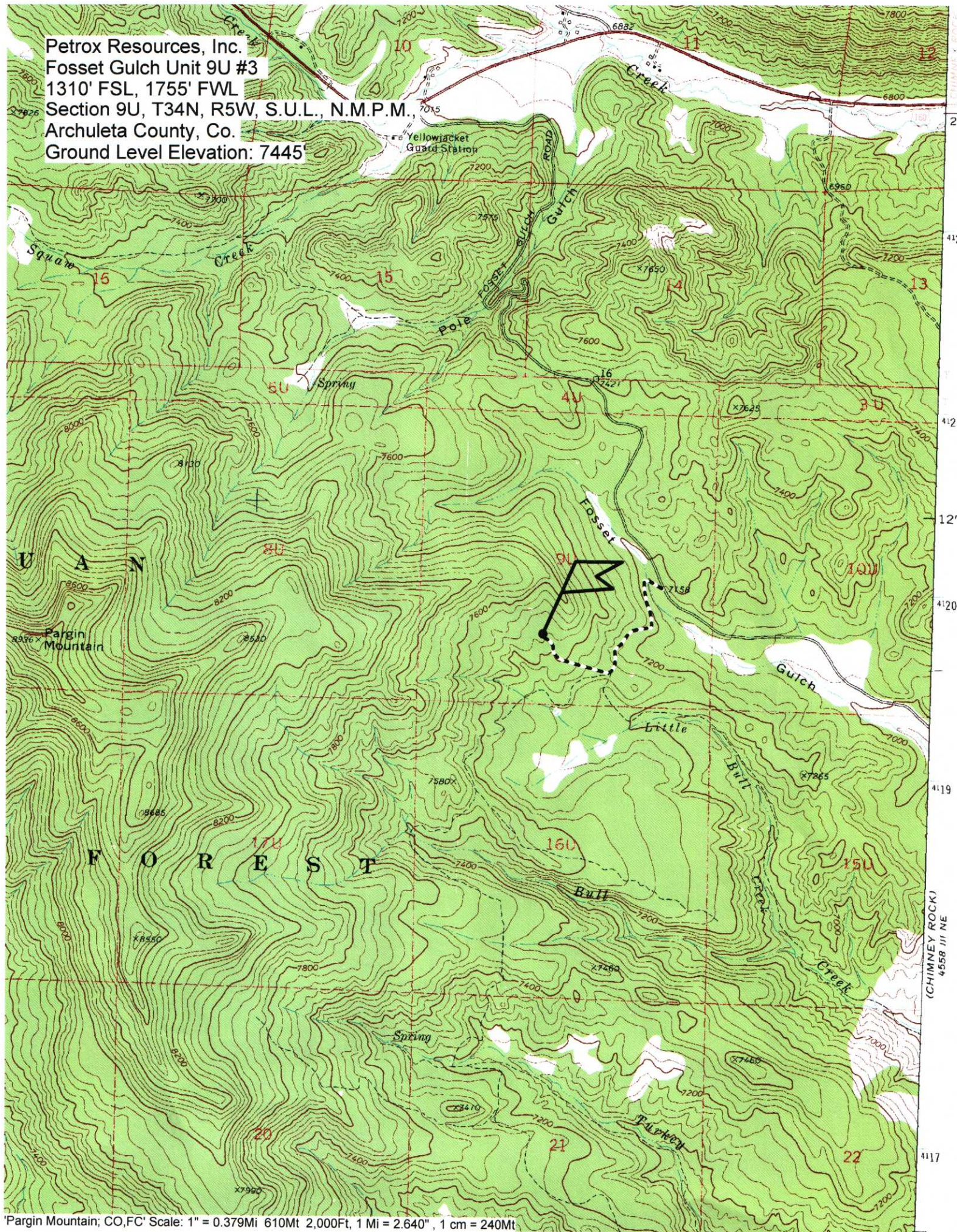

TEE CONNECTION
SEE PLANS BY
PEREGRINE GROUP
DATED 5/28/99

APPROX. LOCATION
OF EXISTING VALVE
BOX

EXISTING 18" CMP

15' WIDE
ACCESS ROAD

DIRECT DRAINAGE DITCH TO DRAIN
TO EXISTING 18" CMP TO THE NORTH
1' DEPTH, 2:1 SIDE SLOPES

CURVE
WIDENING 17.5'

V-DITCH
SEE TYPICAL ACCESS
ROAD SECTION DETAIL,
SHEET 5

INSTALL 18 inch CMP, 45° SKEW
WITH RIPRAP OUTLET
SEE SHEET 6 FOR CULVERT & RIPRAP
INSTALLATION DETAILS

CULVERT INLET
PROTECTION (TYP.)
SEE SHEET 6 FOR
INSTALLATION DETAILS

STRAW WATTLE (TYP.)
SEE SHEET 6 FOR
INSTALLATION DETAILS

PROPOSED GAS AND
WATERLINE

INSTALL 2 ROCK CHECK DAMS
UPSTREAM OF CULVERT INLETS
WHERE FLOWLINE IS STEEPENED TO
PROVIDE MINIMUM COVER OVER
CULVERT (TYP.)
SEE SHEET 6 FOR INSTALLATION
DETAILS

STRAW WATTLES (TYP.)

CURVE
WIDENING 17.3'

IF NECESSARY, DIG DITCH TO
PROVIDE POSITIVE DRAINAGE FROM
FLAT AREA

EDGE OF PROPOSED GRAVEL ROAD,
14' WIDE (TYP) EXCEPT WHERE
NOTED OTHERWISE

TOPO BOUNDARY (TYP.)

CURVE
WIDENING 12.1'

STRAW WATTLE (TYP.)
SEE SHEET 6 FOR
INSTALLATION DETAILS

C.W. STA 5+19

C.W. STA 6+35

AREA OF INTERPOLATED
TOPO FOR FINAL
PROPOSED SURFACE
CREATION

CURVE
WIDENING 9.5'

DISTURBANCE LIMIT IS
DEFINED AS 40' WIDE (TYP.)
UNLESS WIDENED FOR
ULTIMATE GRADING
SLOPES

DIRECT DRAINAGE TO
EXISTING FLAT AREA

CULVERT INLET
PROTECTION (TYP.)
SEE SHEET 6 FOR
INSTALLATION DETAILS

INSTALL 18 inch CMP
WITH RIPRAP OUTLET
SEE SHEET 6 FOR CULVERT & RIPRAP
INSTALLATION DETAILS

NOTES:

1. CONTRACTOR SHALL WALK ALL AREAS WITH FOREST SERVICE AND ENGINEER PRIOR TO CONSTRUCTION ACTIVITIES.
2. CONTRACTOR SHALL MAKE EFFORTS TO MINIMIZE IMPACTS TO SURROUNDING VEGETATION.
3. CONTRACTOR SHALL ADJUST CULVERTS TO MATCH VARIED FIELD CONDITIONS.



CALL UNCE
TWO WORKING DAYS
BEFORE YOU DIG
1-800-922-1987
UTILITY NOTIFICATION
CENTER OF COLORADO

PLAN
SCALE: 1" = 80' (11x17)
SCALE: 1" = 40' (24x36)
80' 40' 20' 0' 40'



SHEET
2
OF
9

Russell Planning &
Engineering, Inc.
Civil Engineering Services
934 Main Avenue, Unit C
Durango, Colorado 81301
Phone: (970) 366-4546
Fax: (970) 366-4502

PETRO RESOURCES INC.
9103 ACCESS ROAD
PLAN AND PROFILE SHEET

Drawn/Checked:
Dated by:
DATE: 2/23/2011

ACAD FILE: RUSSELL_9103.dwg
REVISIONS: Δ xx

PROFILE
SCALE: 1" = 40' H 1" = 5' V (24x36)
SCALE: 1" = 80' H 1" = 10' V (11x17)

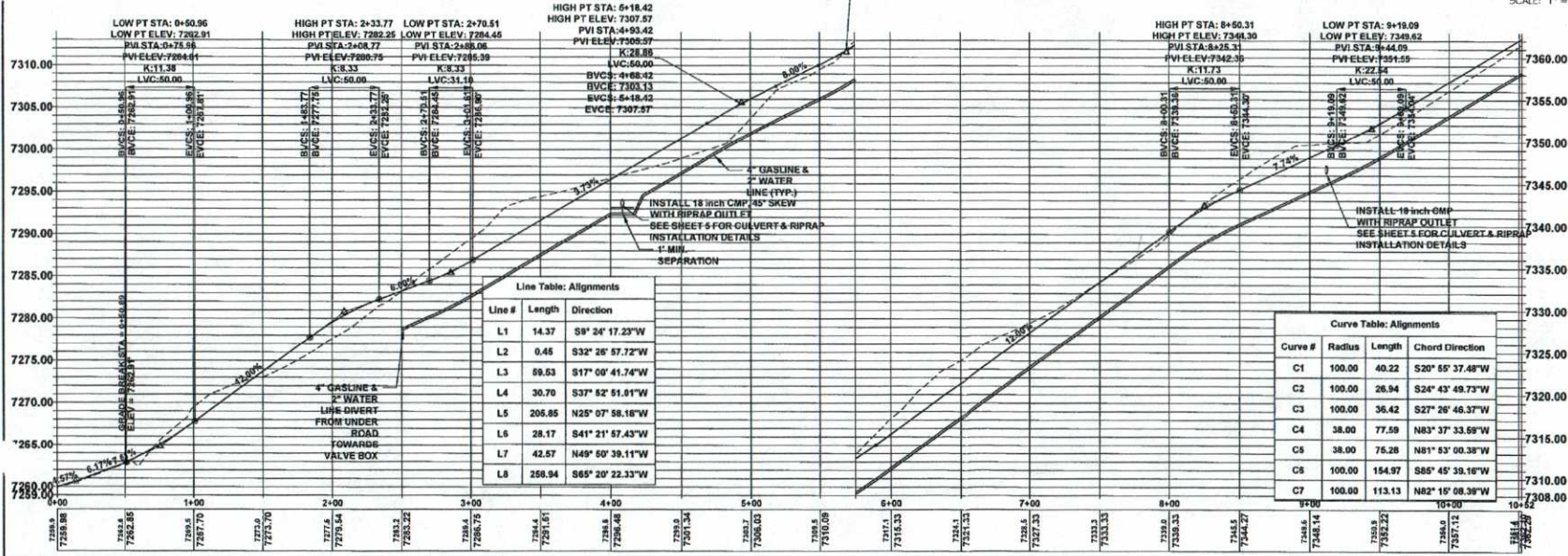

ACCEPTED

NOTES:

1. CONTRACTOR SHALL WALK ALL AREAS WITH FOREST SERVICE AND ENGINEER PRIOR TO CONSTRUCTION ACTIVITIES.
2. CONTRACTOR SHALL MAKE EFFORTS TO MINIMIZE IMPACTS TO SURROUNDING VEGETATION.
3. CONTRACTOR SHALL ADJUST CULVERTS TO MATCH VARIED FIELD CONDITIONS.

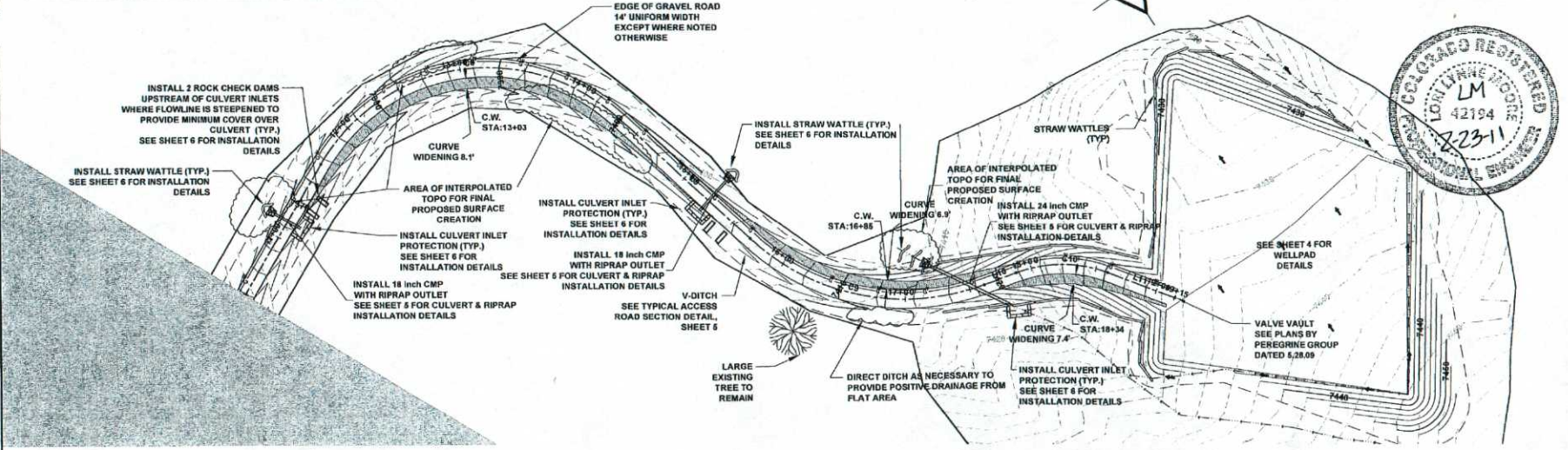

CALL UNCC
TWO WORKING DAYS
BEFORE YOU DIG
1-800-922-1987
UTILITY NOTIFICATION
CENTER OF COLORADO



Russell Planning & Engineering, Inc.
Civil Engineering Services
904 Main Avenue, Unit C
Durango, Colorado 81301
Phone: (970) 385-4546
Fax: (970) 385-4506

PETRO RESOURCES INC.
9043 ACCESS ROAD
PLAN AND PROFILE SHEET

Drawn/Checked:
Date: 2/23/2011

ACAD FILE: RUSSELL_9043.dwg
REVISIONS: Δ xx

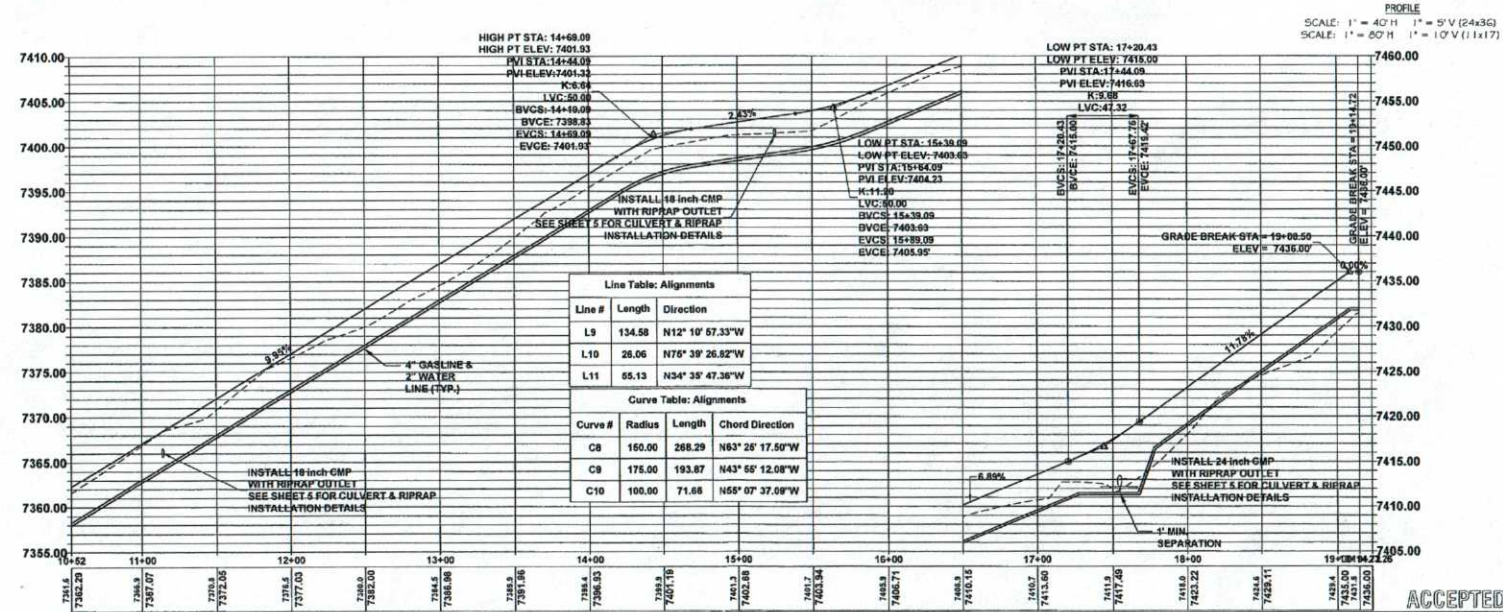

ACCEPTED



CALL UNCE
TWO WORKING DAYS
BEFORE YOU DIG
1-800-922-1987
UTILITY NOTIFICATION
CENTER OF COLORADO

SHEET
5
OF
9

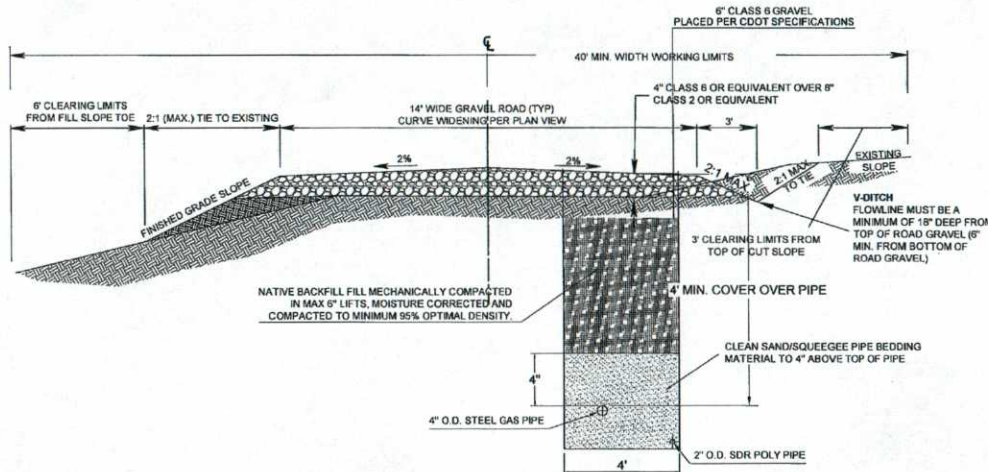

TYPICAL ACCESS ROAD SECTION

NTS

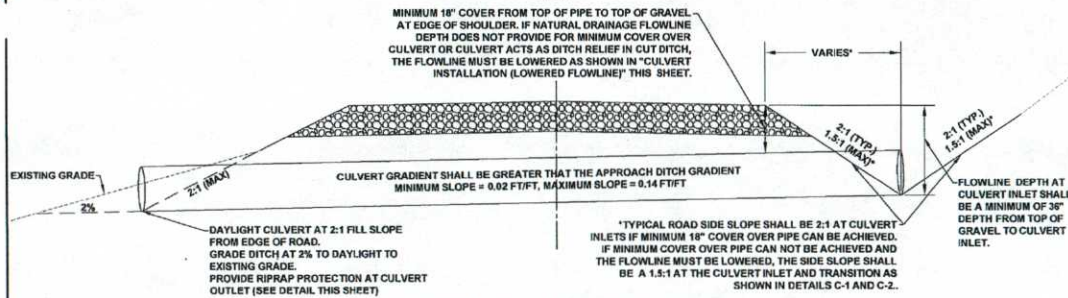

CULVERT INSTALLATION (LOWERED FLOWLINE)

NTS

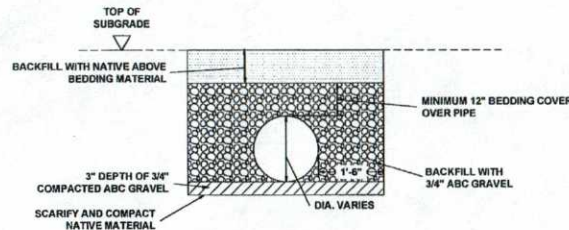

CULVERT BEDDING DETAIL

NTS

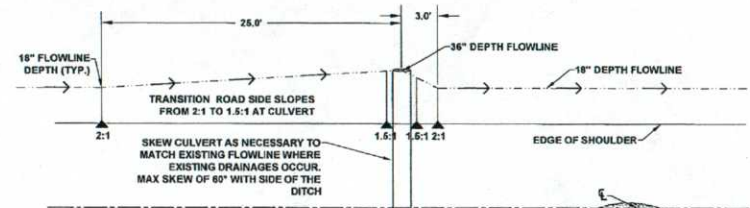

CULVERT INSTALLATION (LOWERED FLOWLINE)

PLAN VIEW

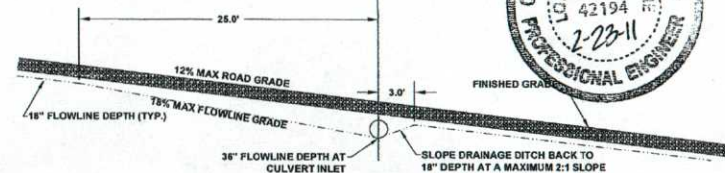

CULVERT INSTALLATION (LOWERED FLOWLINE)

CROSS SECTION VIEW

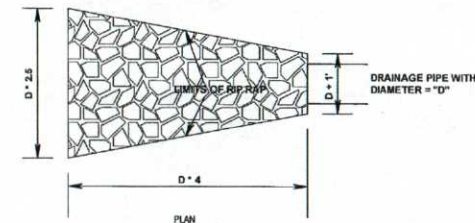

RIPRAP OUTLET DETAIL

NTS

Russell Planning & Engineering, Inc.
Civil Engineering Services
934 Main Avenue, Unit C
Durango, Colorado 81301
Phone: (970) 388-4546
Fax: (970) 388-4502

PETRO RESOURCES INC.
9043 DETAILS

Drawn/Checked:
Drafted by:
DATE: 2/23/2011

ACAD FILE: RUSSELL_9043_details.dwg

REVISIONS: XX

ACCEPTED

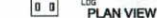

NTS

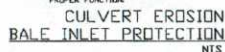

75% OF VEGETATION WAS RETURNED ON ALL SLOPES. ALL SLOPES NO STEEPER THAN 2:1 WILL BE PLATED WITH 4 INCH OF TOPSOIL AND RESEED. STRAWBALES SHALL BE PLACED AT ALL

NTS



* POINTS A SHALL BE HIGHER
THAN POINT B AND BELOW POINT C

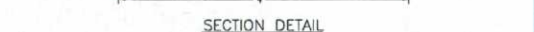
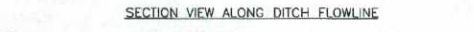

CHECK DAM FOR EROSION CONTROL

- NOTES:
1. RIPRAP SIZE D550 = 6 IN. OR AS SHOWN ON THE PLANS.
 2. THE ENDS OF RIPRAP CHECK DAM SHALL BE A MINIMUM OF 6 IN. HIGHER THAN CENTER OF CHECK DAM.
 3. SEDIMENT SHALL BE REMOVED WHEN THE DEPTH UPSTREAM FROM CHECK DAM IS $1\frac{1}{2}$ THE CREST HEIGHT.
 4. CHECK DAMS MAY BE TEMPORARY OR PERMANENT AS SHOWN ON THE PLANS.

**CALL UNCC
TWO WORKING DAYS
BEFORE YOU DIG
1-800-922-1987
UTILITY NOTIFICATION
CENTER OF COLORADO**



9U#3 DETAILS

ACAD FILE: RUSSELL_9U#3_details.dwg

[illegible]

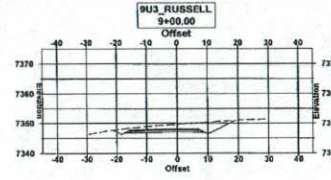
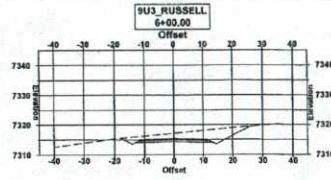
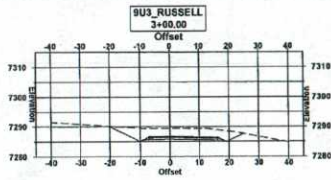
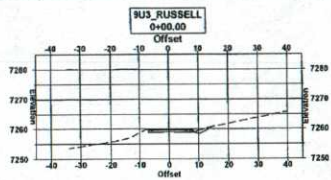

CALL UNCC
TWO WORKING DAYS
BEFORE YOU DIG
1-800-922-1987
UTILITY NOTIFICATION
CENTER OF COLORADO
PLAN
SCALE: 1" = 40' (11x17)
SCALE: 1" = 20' (24x36)
40' 20' 10' 0' 20'

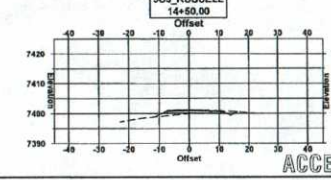
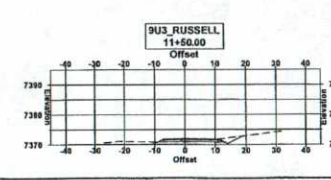
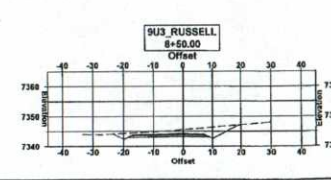
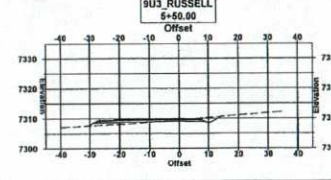
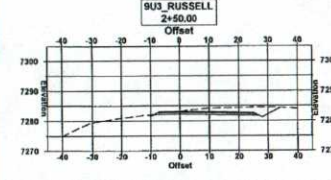
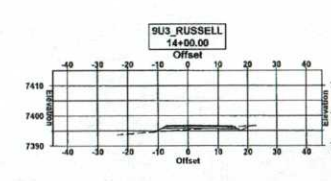
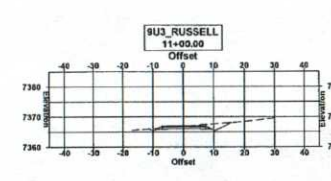
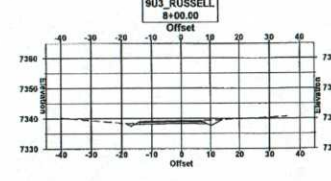
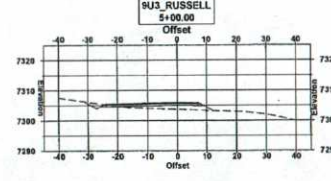
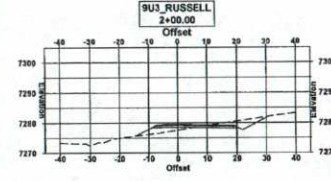
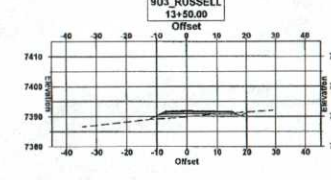
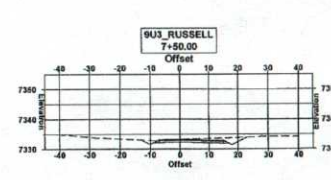
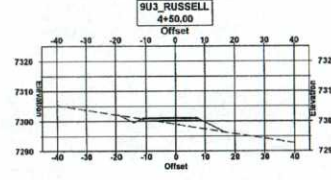
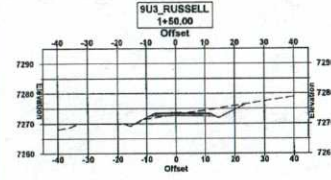
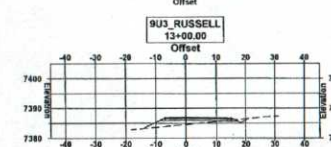
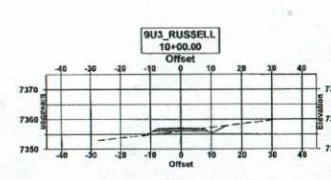
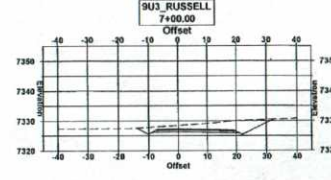
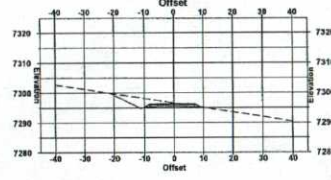
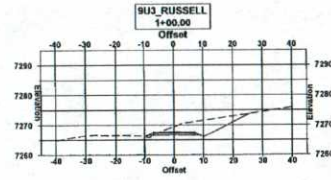
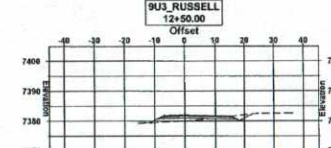
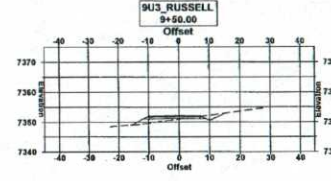
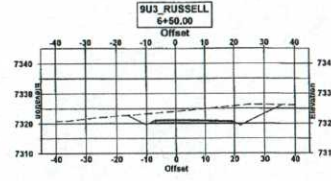
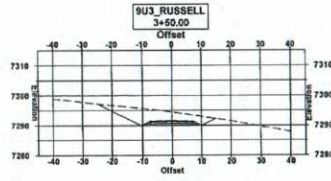
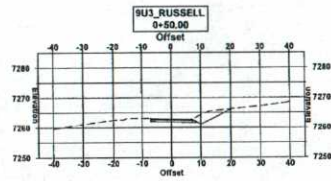
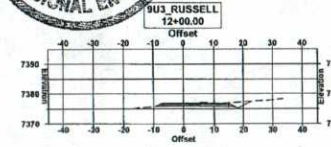

ACCEPTED

Russell Planning & Engineering, Inc.
Civil Engineers
934 Main Avenue, Unit C
Durango, Colorado 81301
Phone: (970) 386-4546
Fax: (970) 386-4502

PETROX RESOURCES INC.
9U#3 ROAD CROSS SECTIONS

Drawn/Checked:
Drafted by:
DATE: 2/23/2011

ACAD FILE: RUSSELL_9U#3.dwg
REVISIONS: Δ xx

