

ENCANA OIL & GAS (USA) INC

CONSTRUCTION LAYOUT DRAWING
WELL PAD (NGG30NE) EXPANSION
Section 30, T8S, R91W, 6th P.M.

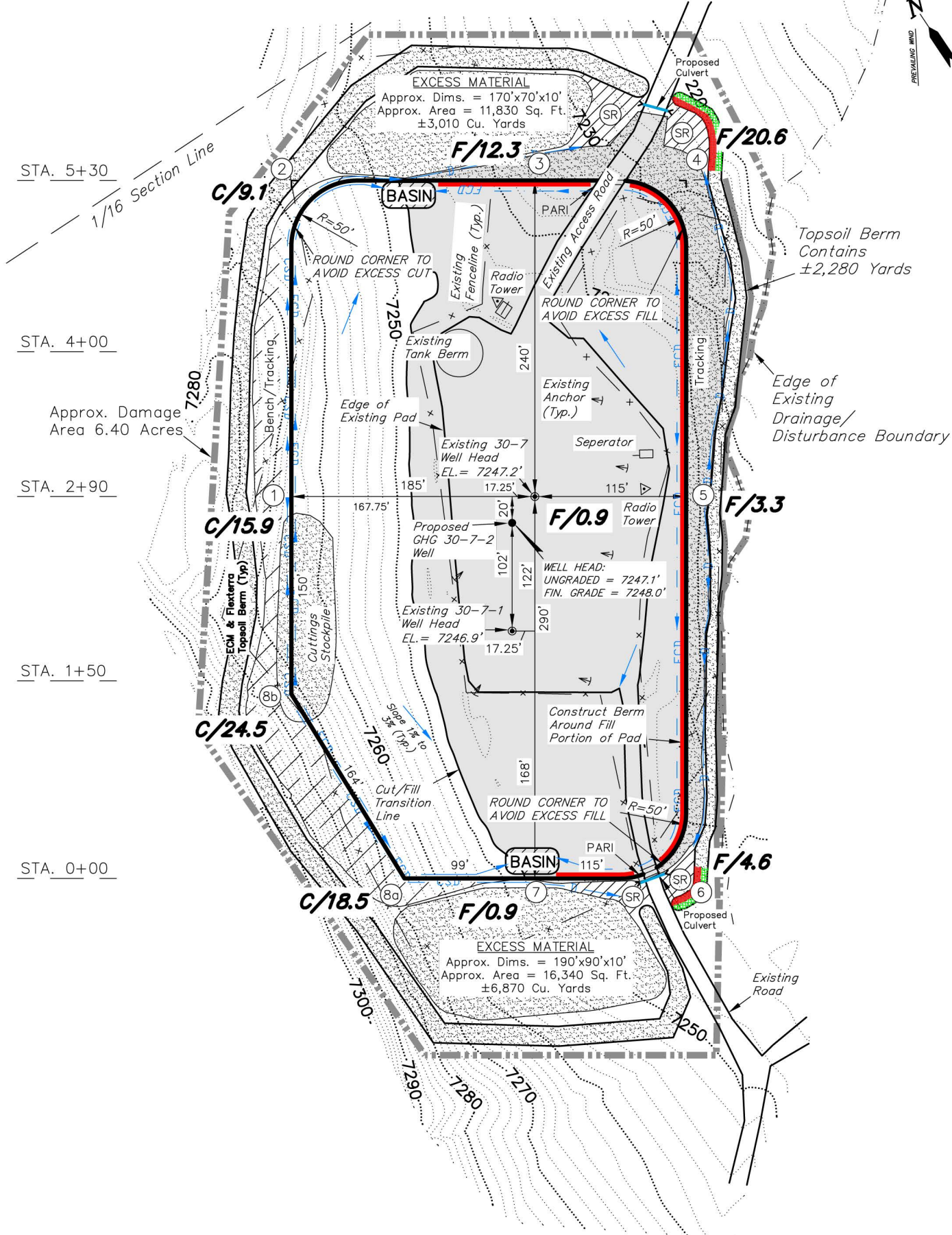
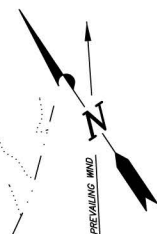

NOTES:

- (1) Slope Track and/or Terrace All Slopes and Piles
- (2) Erosion Control & Seed Topsoil Stockpile
- (3) Erosion Control & Seed Outside Slopes of Stockpiles
- (4) Slope away from Substructure Areas 1% to 3% to Flow Control Ditch on Entire Pad
- (5) When Possible the Cut and Fill Slopes Directly Behind the Proposed Production Equipment Should be Reclaimed with 3:1 Slopes and Topsoil Spread During Pad Construction.
- (6) BMP Selection and Position may Change Depending on Actual Conditions Encountered During the Construction Process.
- (7) All CMP's Shall have Inlet and Outlet Protection.
- (8) All BMP's to be constructed to EnCana Oil & Gas (USA) Inc. BMP Manual's Specifications.

LEGEND:

- PARI = PAD/ACCESS ROAD INTERFACE
- SR = SEDIMENT RESERVOIR
- ST = SEDIMENT TRAP
- R.O.P. = RUN-ON PROTECTION
- = PERIMETER CONTROL (WATTLES)
- CDM = CHECK DAM
- FCD = FLOW CONTROL DITCH
- ECB = EROSION CONTROL BLANKET
- D = FILL DIVERSION TO SEDIMENT TRAP
- CSD = CUT SLOPE DIVERSION (BERM TOE OF CUT SLOPE)
- VGB = VEGETATION BUFFER (UNDISTURBED LAND INSIDE PC)
- SEED, ECB & FLEX
- = LEVEL SPREADER

NOTE:

The topsoil & waste material area is calculated as being mounds containing 12,160 cubic yards of dirt (a 15% fluff factor is included). The mound areas are calculated with push slopes of 2.5:1 & fall slopes of 2.5:1.

ENCANA OIL & GAS (USA) INC

CROSS SECTIONS
WELL PAD (NGG30NE) EXPANSION
Section 30, T8S, R91W, 6th P.M.

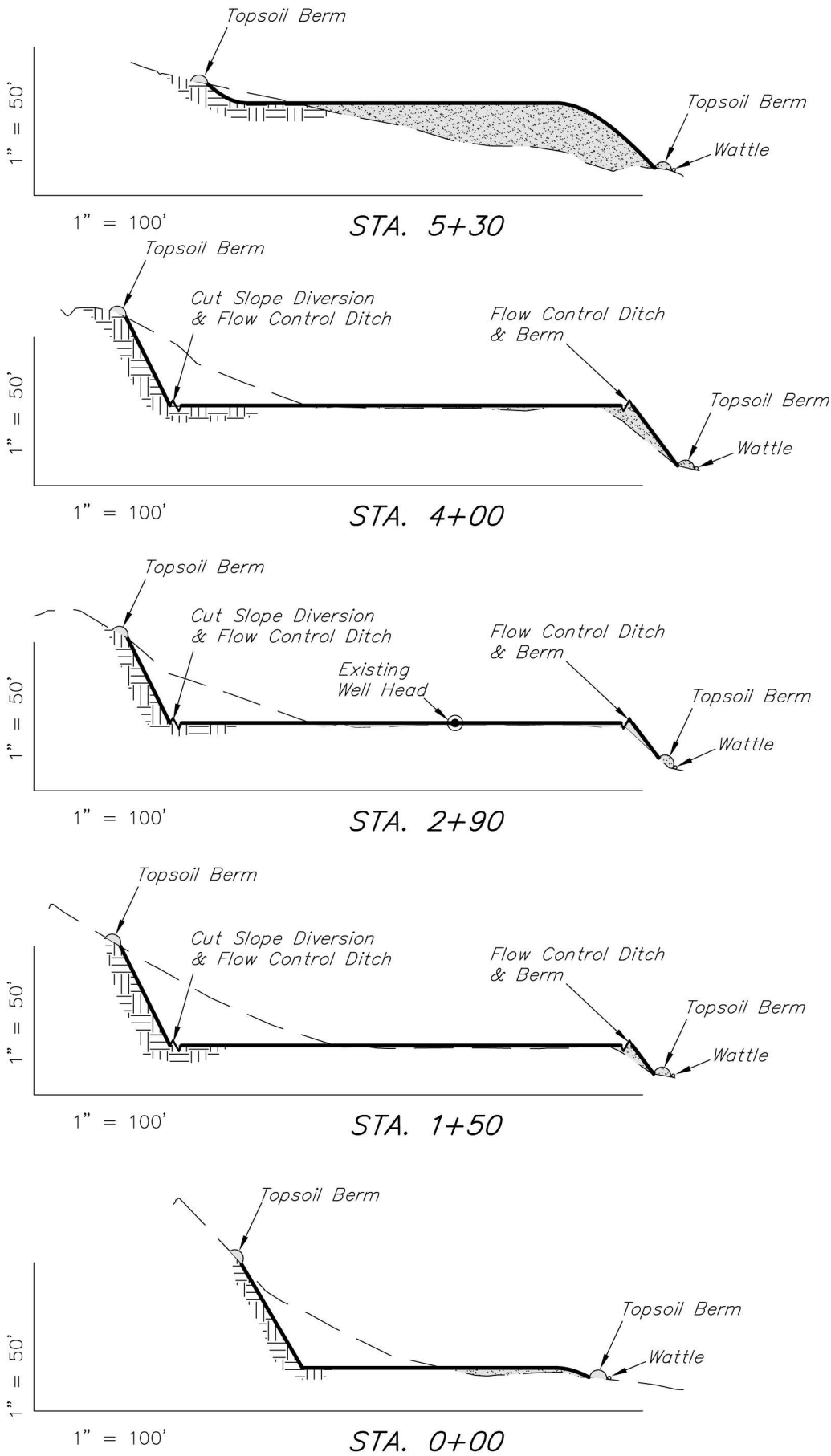

ESTIMATED EARTHWORK QUANTITIES (No Shrink or swell adjustments have been used) (Expressed in Cubic Yards)				
ITEM	CUT	FILL	6" TOPSOIL	EXCESS
PAD	21,180	12,590	Topsoil is not included in Pad Cut	8,590
PIT	N/A	N/A		N/A
TOTALS	21,180	12,590	1,980	8,590

NOTE:
UNLESS OTHERWISE NOTED
CUT SLOPES ARE AT 1.0:1
FILL SLOPES ARE AT 1.5:1

SURVEYED BY:	C.D.S.	DATE SURVEYED:	10-06-11
DRAWN BY:	M.W.	DATE DRAWN:	03-07-13
SCALE:	1" = 100'	REVISED:	M.W. 04-26-13

Tri State Land Surveying, Inc.	(435) 781-2501
	180 NORTH VERNAL AVE. VERNAL, UTAH 84078

ENCANA OIL & GAS (USA) INC

TYPICAL RIG LAYOUT

WELL PAD (NGG30NE) EXPANSION

Section 30, T8S, R91W, 6th P.M.

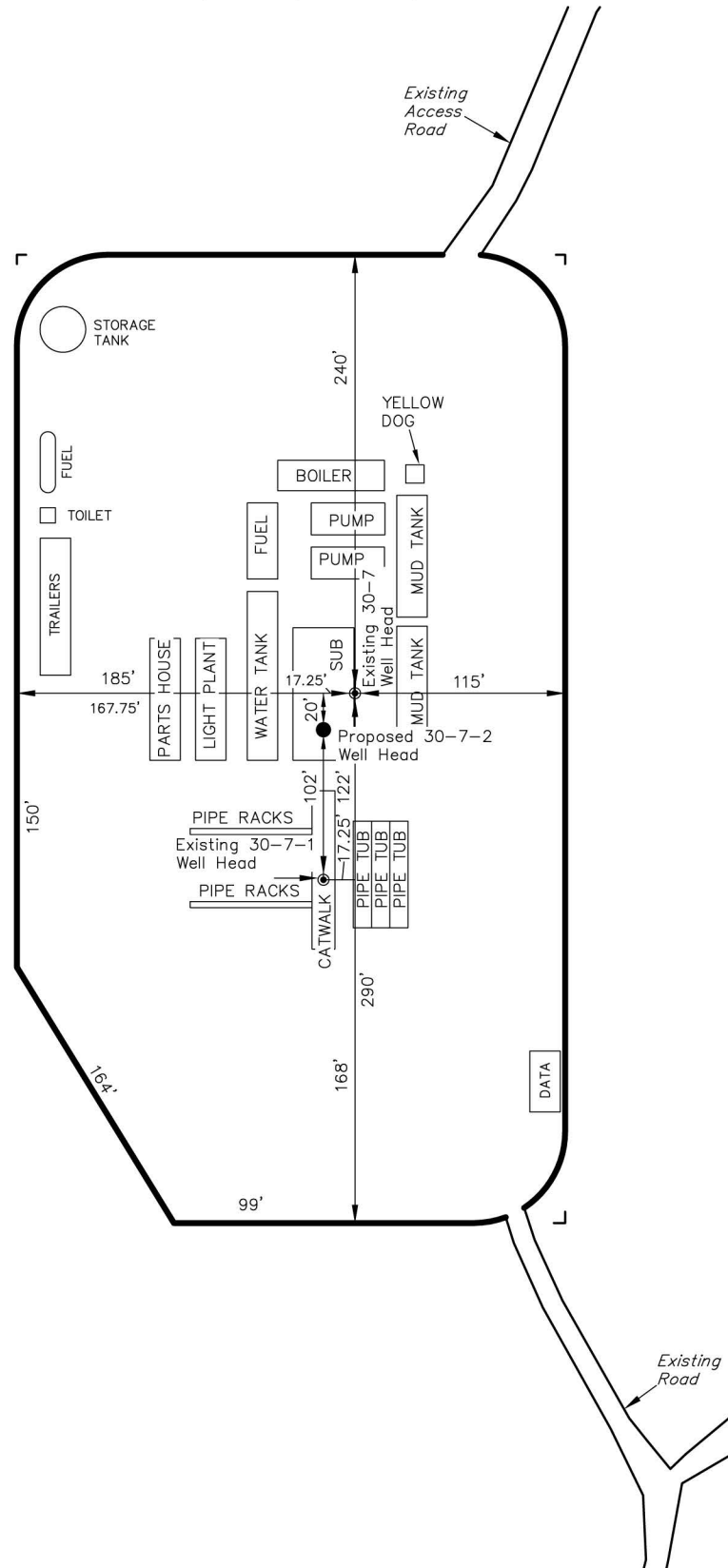
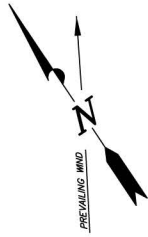

SURVEYED BY: C.D.S.	DATE SURVEYED: 10-06-11
DRAWN BY: M.W.	DATE DRAWN: 03-07-13
SCALE: 1" = 100'	REVISED: M.W. 04-26-13

Tri State
Land Surveying, Inc.
180 NORTH VERNAL AVE. VERNAL, UTAH 84078
(435) 781-2501

SHEET
6
OF 8

ENCANA OIL & GAS (USA) INC

PRODUCTION SCHEMATIC

WELL PAD (NGG30NE) EXPANSION

Section 30, T8S, R91W, 6th P.M.

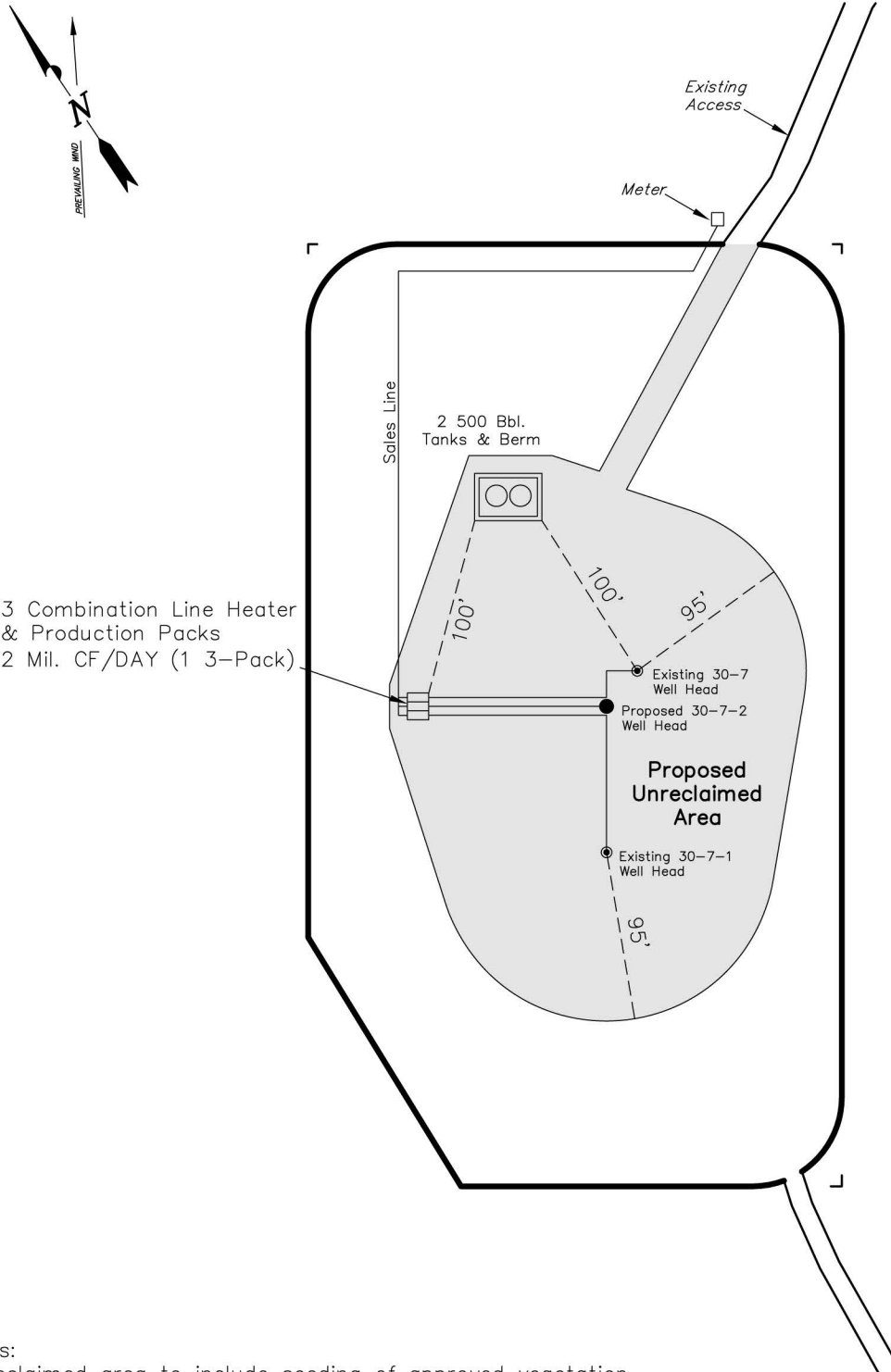

Notes:

1. Reclaimed area to include seeding of approved vegetation and sufficient storm water management system.
2. Reclaimed Pad to have storm water Management BMP's Per Encana Oil & Gas (USA) Inc. BMP Manual.
3. Actual Equipment Layout and Reclaimed Pad Surface Area May Change do to Production Requirements or Site Conditions.

DISTURBED AREA:

TOTAL DISTURBED AREA = 6.40 ACRES
TOTAL RECLAIMED AREA = 5.02 ACRES
UNRECLAIMED AREA = 1.38 ACRES

SURVEYED BY: C.D.S.	DATE SURVEYED: 10-06-11
DRAWN BY: M.W.	DATE DRAWN: 03-07-13
SCALE: 1" = 100'	REVISED: M.W. 04-26-13

Tri State
Land Surveying, Inc.
180 NORTH VERNAL AVE. VERNAL, UTAH 84078
(435) 781-2501

SHEET
7
OF 8

SURFACE DISTURBANCE AREA
WELL PAD (NGG30NE) EXPANSION
Section 30, T8S, R91W, 6th P.M.

557°19'22"W 2426.62'
(From the Northeast
Corner of Section 30,
Being a 1911 Brass Cap)



Surface Disturbance Area		
PROPOSED	EXISTING	TOTAL
5.30 Acres	1.10 Acres	6.40 Acres