

# BONANZA CREEK ENERGY OPERATING

Well Name: **State Pronghorn F-J-16HNB**

Surface Location: Pronghorn F-16 Pad Sec.16-T5N-R61W  
North American Datum 1983 , US State Plane 1983 , Colorado Northern Zone

Ground Elevation: 4638.0

| +N/-S   | +E/-W | Northing   | Easting    | Latitude  | Longitude   | Slot |
|---|-------|------------|------------|-----------|-------------|------|
| 0.0   | 0.0   | 1393828.58 | 3356678.70 | 40.407390 | -104.219150 |      |
| Ensign 128 - RKB 15' WELL @ 4653.0ft (Ensign 128 - RKB 15') |       |            |            |           |             |      |

## FINAL SURVEY

Projected Bottom Hole Location  
10734' MD 6114' TVD 4484' S & 81' E of  
SHL  
90 degree Incl @ 181 degree AZM

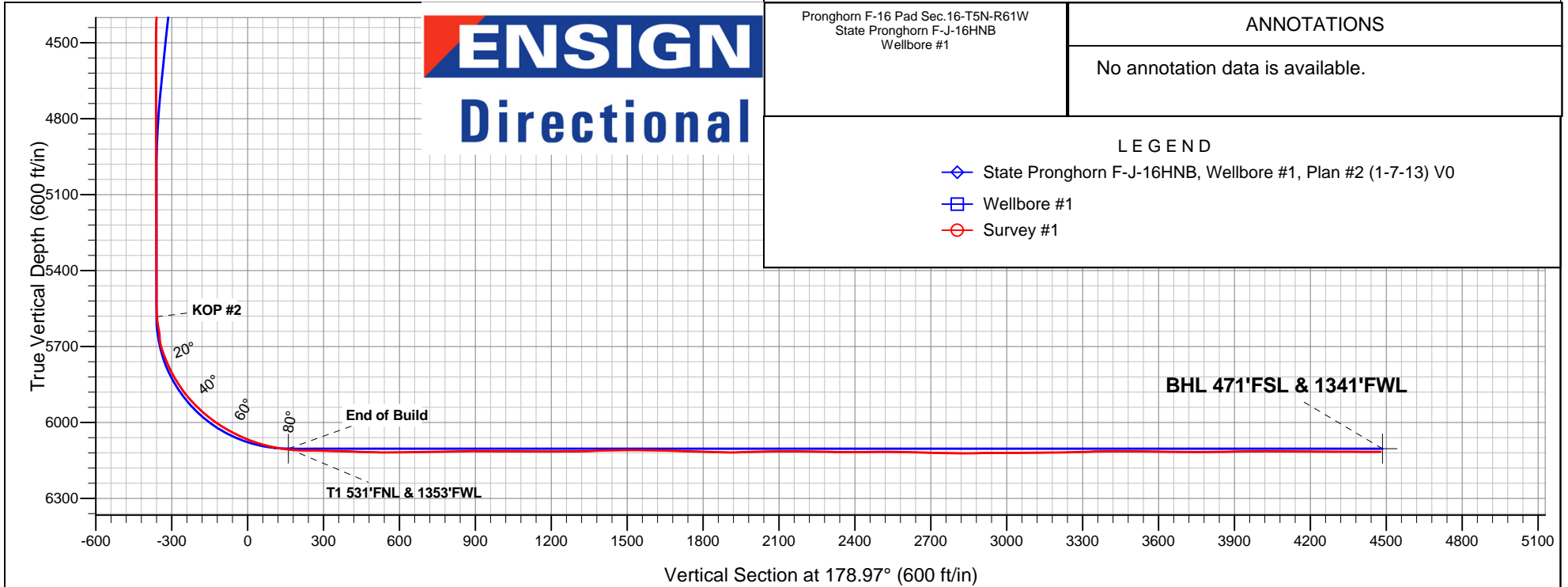
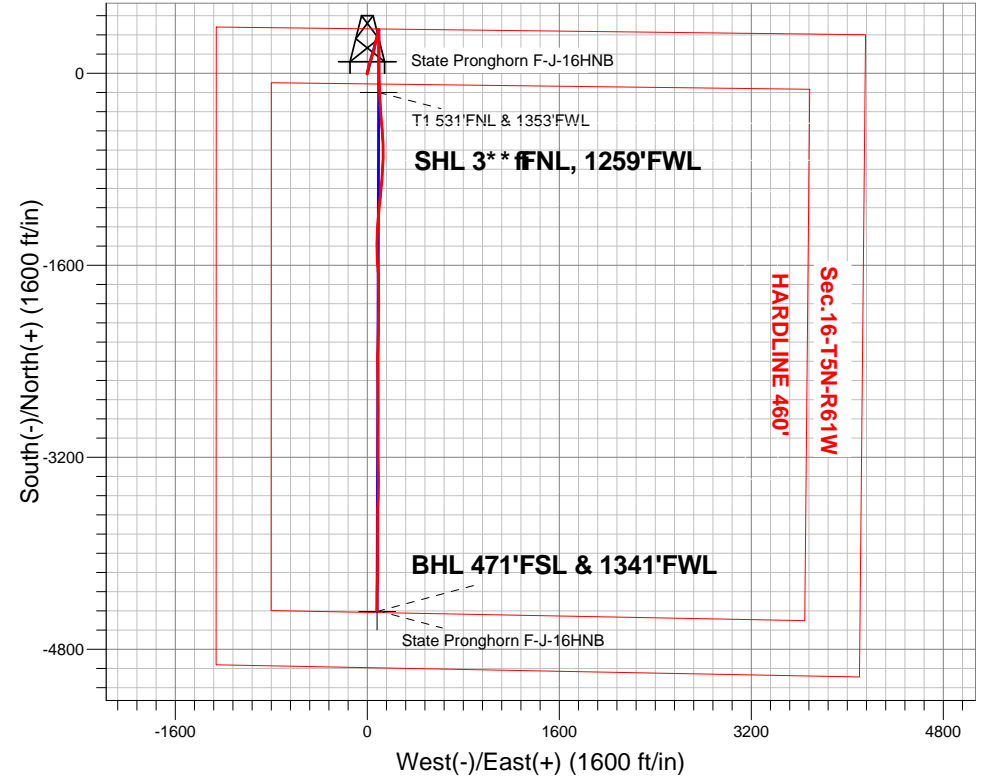



# **BONANZA CREEK ENERGY OPERATING**

**SEC.16-T5N-R61W**

**Pronghorn F-16 Pad Sec.16-T5N-R61W**

**State Pronghorn F-J-16HNB**

**Wellbore #1**

**Survey: Survey #1**

## **Standard Survey Report**

**29 April, 2013**

|                  |                                    |                                     |  |
|------------------|------------------------------------|-------------------------------------|--|
| <b>Company:</b>  | BONANZA CREEK ENERGY OPERATING     | <b>Local Co-ordinate Reference:</b> | Well State Pronghorn F-J-16HNB         |
| <b>Project:</b>  | SEC.16-T5N-R61W                    | <b>TVD Reference:</b>               | WELL @ 4653.0ft (Ensign 128 - RKB 15') |
| <b>Site:</b>     | Pronghorn F-16 Pad Sec.16-T5N-R61W | <b>MD Reference:</b>                | WELL @ 4653.0ft (Ensign 128 - RKB 15') |
| <b>Well:</b>     | State Pronghorn F-J-16HNB          | <b>North Reference:</b>             | True                                   |
| <b>Wellbore:</b> | Wellbore #1                        | <b>Survey Calculation Method:</b>   | Minimum Curvature                      |
| <b>Design:</b>   | Wellbore #1                        | <b>Database:</b>                    | Landmark                               |

|                    |                           |                      |                             |
|--------------------|---------------------------|----------------------|-----------------------------|
| <b>Project</b>     | SEC.16-T5N-R61W           |                      |                             |
| <b>Map System:</b> | US State Plane 1983       | <b>System Datum:</b> | Mean Sea Level              |
| <b>Geo Datum:</b>  | North American Datum 1983 |                      | Using Well Reference Point  |
| <b>Map Zone:</b>   | Colorado Northern Zone    |                      | Using geodetic scale factor |

| Site                  | Pronghorn F-16 Pad Sec.16-T5N-R61W |              |                |                   |             |
|-----------------------|------------------------------------|--------------|----------------|-------------------|-------------|
| Site Position:        |                                    | Northing:    | 1,393,828.59ft | Latitude:         | 40.407390   |
| From:                 | Lat/Long                           | Easting:     | 3,356,678.70ft | Longitude:        | -104.219150 |
| Position Uncertainty: | 0.0 ft                             | Slot Radius: | "              | Grid Convergence: | 0.83 °      |

| Well                 | State Pronghorn F-J-16HNB |        |                     |                 |               |             |
|----------------------|---------------------------|--------|---------------------|-----------------|---------------|-------------|
| Well Position        | +N/-S                     | 0.0 ft | Northing:           | 1,393,828.58 ft | Latitude:     | 40.407390   |
|                      | +E/-W                     | 0.0 ft | Easting:            | 3,356,678.70 ft | Longitude:    | -104.219150 |
| Position Uncertainty |                           | 0.0 ft | Wellhead Elevation: | ft              | Ground Level: | 4,638.0 ft  |

|                  |                   |                    |                        |                      |                            |
|------------------|-------------------|--------------------|------------------------|----------------------|----------------------------|
| <b>Wellbore</b>  | Wellbore #1       |                    |                        |                      |                            |
| <b>Magnetics</b> | <b>Model Name</b> | <b>Sample Date</b> | <b>Declination (°)</b> | <b>Dip Angle (°)</b> | <b>Field Strength (nT)</b> |
|                  | IGRF2010          | 1/7/2013           | 8.36                   | 67.09                | 53,029                     |

|                          |                              |                   |                   |                      |     |
|--------------------------|------------------------------|-------------------|-------------------|----------------------|-----|
| <b>Design</b>            | Wellbore #1                  |                   |                   |                      |     |
| <b>Audit Notes:</b>      |                              |                   |                   |                      |     |
| <b>Version:</b>          | 1.0                          | <b>Phase:</b>     | ACTUAL            | <b>Tie On Depth:</b> | 0.0 |
| <b>Vertical Section:</b> | <b>Depth From (TVD) (ft)</b> | <b>+N/-S (ft)</b> | <b>+E/-W (ft)</b> | <b>Direction (°)</b> |     |
|                          | 0.0                          | 0.0               | 0.0               | 178.97               |     |

|                       |                |                          |                  |                    |  |
|-----------------------|----------------|--------------------------|------------------|--------------------|--|
| <b>Survey Program</b> | <b>Date</b>    | 4/29/2013                |                  |                    |  |
| <b>From (ft)</b>      | <b>To (ft)</b> | <b>Survey (Wellbore)</b> | <b>Tool Name</b> | <b>Description</b> |  |
| 488.0                 | 10,734.0       | Survey #1 (Wellbore #1)  | MWD              | MWD - Standard     |  |

|                            |                        |                    |                            |                   |                   |                              |                              |                             |                            |  |
|----------------------------|------------------------|--------------------|----------------------------|-------------------|-------------------|------------------------------|------------------------------|-----------------------------|----------------------------|--|
| <b>Survey</b>              |                        |                    |                            |                   |                   |                              |                              |                             |                            |  |
| <b>Measured Depth (ft)</b> | <b>Inclination (°)</b> | <b>Azimuth (°)</b> | <b>Vertical Depth (ft)</b> | <b>+N/-S (ft)</b> | <b>+E/-W (ft)</b> | <b>Vertical Section (ft)</b> | <b>Dogleg Rate (°/100ft)</b> | <b>Build Rate (°/100ft)</b> | <b>Turn Rate (°/100ft)</b> |  |
| 0.0                        | 0.00                   | 0.00               | 0.0                        | 0.0               | 0.0               | 0.0                          | 0.00                         | 0.00                        | 0.00                       |  |
| 488.0                      | 1.10                   | 211.20             | 488.0                      | -4.0              | -2.4              | 4.0                          | 0.23                         | 0.23                        | 0.00                       |  |
| 611.0                      | 0.30                   | 186.80             | 611.0                      | -5.3              | -3.1              | 5.3                          | 0.68                         | -0.65                       | -19.84                     |  |
| 737.0                      | 0.50                   | 68.80              | 737.0                      | -5.5              | -2.6              | 5.4                          | 0.55                         | 0.16                        | -93.65                     |  |
| 860.0                      | 0.40                   | 348.70             | 860.0                      | -4.9              | -2.2              | 4.8                          | 0.47                         | -0.08                       | -65.12                     |  |
| 983.0                      | 0.70                   | 10.30              | 982.9                      | -3.7              | -2.1              | 3.7                          | 0.29                         | 0.24                        | 17.56                      |  |
| 1,107.0                    | 1.40                   | 26.10              | 1,106.9                    | -1.6              | -1.3              | 1.6                          | 0.61                         | 0.56                        | 12.74                      |  |
| 1,232.0                    | 2.90                   | 14.20              | 1,231.8                    | 2.9               | 0.1               | -2.9                         | 1.25                         | 1.20                        | -9.52                      |  |
| 1,354.0                    | 4.80                   | 9.60               | 1,353.6                    | 10.9              | 1.7               | -10.8                        | 1.58                         | 1.56                        | -3.77                      |  |
| 1,477.0                    | 6.60                   | 12.40              | 1,475.9                    | 22.9              | 4.1               | -22.8                        | 1.48                         | 1.46                        | 2.28                       |  |
| 1,600.0                    | 5.50                   | 10.10              | 1,598.3                    | 35.6              | 6.6               | -35.4                        | 0.92                         | -0.89                       | -1.87                      |  |
| 1,722.0                    | 5.30                   | 11.50              | 1,719.7                    | 46.8              | 8.8               | -46.7                        | 0.20                         | -0.16                       | 1.15                       |  |
| 1,845.0                    | 5.30                   | 13.10              | 1,842.2                    | 57.9              | 11.2              | -57.7                        | 0.12                         | 0.00                        | 1.30                       |  |

|                  |                                    |                                     |  |
|------------------|------------------------------------|-------------------------------------|--|
| <b>Company:</b>  | BONANZA CREEK ENERGY OPERATING     | <b>Local Co-ordinate Reference:</b> | Well State Pronghorn F-J-16HNB         |
| <b>Project:</b>  | SEC.16-T5N-R61W                    | <b>TVD Reference:</b>               | WELL @ 4653.0ft (Ensign 128 - RKB 15') |
| <b>Site:</b>     | Pronghorn F-16 Pad Sec.16-T5N-R61W | <b>MD Reference:</b>                | WELL @ 4653.0ft (Ensign 128 - RKB 15') |
| <b>Well:</b>     | State Pronghorn F-J-16HNB          | <b>North Reference:</b>             | True                                   |
| <b>Wellbore:</b> | Wellbore #1                        | <b>Survey Calculation Method:</b>   | Minimum Curvature                      |
| <b>Design:</b>   | Wellbore #1                        | <b>Database:</b>                    | Landmark                               |

| Survey              |                 |             |                     |            |            |                       |                       |                      |                     |  |
|---------------------|-----------------|-------------|---------------------|------------|------------|-----------------------|-----------------------|----------------------|---------------------|--|
| Measured Depth (ft) | Inclination (°) | Azimuth (°) | Vertical Depth (ft) | +N/-S (ft) | +E/-W (ft) | Vertical Section (ft) | Dogleg Rate (°/100ft) | Build Rate (°/100ft) | Turn Rate (°/100ft) |  |
| 1,969.0             | 6.60            | 15.20       | 1,965.5             | 70.4       | 14.4       | -70.1                 | 1.06                  | 1.05                 | 1.69                |  |
| 2,092.0             | 6.70            | 17.50       | 2,087.7             | 84.1       | 18.4       | -83.7                 | 0.23                  | 0.08                 | 1.87                |  |
| 2,216.0             | 5.90            | 11.30       | 2,210.9             | 97.2       | 21.8       | -96.8                 | 0.85                  | -0.65                | -5.00               |  |
| 2,340.0             | 6.60            | 13.60       | 2,334.2             | 110.4      | 24.7       | -109.9                | 0.60                  | 0.56                 | 1.85                |  |
| 2,463.0             | 6.90            | 19.80       | 2,456.4             | 124.2      | 28.9       | -123.7                | 0.64                  | 0.24                 | 5.04                |  |
| 2,587.0             | 6.60            | 25.80       | 2,579.5             | 137.6      | 34.5       | -137.0                | 0.62                  | -0.24                | 4.84                |  |
| 2,711.0             | 7.20            | 21.90       | 2,702.6             | 151.3      | 40.5       | -150.5                | 0.61                  | 0.48                 | -3.15               |  |
| 2,839.0             | 5.90            | 20.10       | 2,829.8             | 164.9      | 45.8       | -164.0                | 1.03                  | -1.02                | -1.41               |  |
| 2,965.0             | 4.30            | 19.60       | 2,955.3             | 175.4      | 49.6       | -174.5                | 1.27                  | -1.27                | -0.40               |  |
| 3,092.0             | 4.00            | 13.30       | 3,081.9             | 184.2      | 52.2       | -183.2                | 0.43                  | -0.24                | -4.96               |  |
| 3,156.0             | 5.20            | 14.90       | 3,145.7             | 189.2      | 53.5       | -188.2                | 1.89                  | 1.88                 | 2.50                |  |
| 3,219.0             | 6.40            | 14.50       | 3,208.4             | 195.3      | 55.1       | -194.3                | 1.91                  | 1.90                 | -0.63               |  |
| 3,346.0             | 9.40            | 12.60       | 3,334.2             | 212.3      | 59.1       | -211.2                | 2.37                  | 2.36                 | -1.50               |  |
| 3,473.0             | 12.40           | 9.60        | 3,458.9             | 235.9      | 63.7       | -234.7                | 2.40                  | 2.36                 | -2.36               |  |
| 3,599.0             | 12.00           | 14.20       | 3,582.0             | 261.9      | 69.1       | -260.6                | 0.83                  | -0.32                | 3.65                |  |
| 3,726.0             | 11.50           | 15.60       | 3,706.4             | 286.9      | 75.8       | -285.5                | 0.45                  | -0.39                | 1.10                |  |
| 3,853.0             | 9.30            | 12.40       | 3,831.3             | 309.1      | 81.4       | -307.6                | 1.79                  | -1.73                | -2.52               |  |
| 3,980.0             | 6.20            | 6.60        | 3,957.1             | 326.0      | 84.4       | -324.4                | 2.51                  | -2.44                | -4.57               |  |
| 4,107.0             | 5.90            | 9.20        | 4,083.4             | 339.2      | 86.2       | -337.6                | 0.32                  | -0.24                | 2.05                |  |
| 4,234.0             | 4.70            | 14.00       | 4,209.8             | 350.7      | 88.5       | -349.1                | 1.01                  | -0.94                | 3.78                |  |
| 4,361.0             | 3.30            | 23.30       | 4,336.5             | 359.1      | 91.2       | -357.4                | 1.21                  | -1.10                | 7.32                |  |
| 4,487.0             | 0.60            | 349.60      | 4,462.5             | 363.1      | 92.5       | -361.4                | 2.24                  | -2.14                | -26.75              |  |
| 4,614.0             | 0.30            | 131.10      | 4,589.5             | 363.6      | 92.7       | -361.8                | 0.67                  | -0.24                | 111.42              |  |
| 4,741.0             | 0.20            | 223.20      | 4,716.5             | 363.2      | 92.8       | -361.4                | 0.29                  | -0.08                | 72.52               |  |
| 4,868.0             | 0.50            | 272.40      | 4,843.4             | 363.0      | 92.1       | -361.3                | 0.31                  | 0.24                 | 38.74               |  |
| 4,995.0             | 0.40            | 295.40      | 4,970.4             | 363.2      | 91.1       | -361.5                | 0.16                  | -0.08                | 18.11               |  |
| 5,122.0             | 0.20            | 182.60      | 5,097.4             | 363.2      | 90.7       | -361.5                | 0.40                  | -0.16                | -88.82              |  |
| 5,249.0             | 0.40            | 250.10      | 5,224.4             | 362.8      | 90.3       | -361.2                | 0.29                  | 0.16                 | 53.15               |  |
| 5,376.0             | 0.40            | 137.70      | 5,351.4             | 362.4      | 90.1       | -360.7                | 0.52                  | 0.00                 | -88.50              |  |
| 5,496.0             | 0.10            | 292.10      | 5,471.4             | 362.1      | 90.3       | -360.4                | 0.41                  | -0.25                | 128.67              |  |
| 5,504.0             | 0.30            | 261.70      | 5,479.4             | 362.1      | 90.3       | -360.4                | 2.75                  | 2.50                 | -380.00             |  |
| 5,536.0             | 0.40            | 254.10      | 5,511.4             | 362.0      | 90.1       | -360.4                | 0.34                  | 0.31                 | -23.75              |  |
| 5,568.0             | 1.20            | 168.50      | 5,543.4             | 361.7      | 90.1       | -360.0                | 3.86                  | 2.50                 | -267.50             |  |
| 5,599.0             | 4.00            | 166.90      | 5,574.4             | 360.3      | 90.4       | -358.6                | 9.03                  | 9.03                 | -5.16               |  |
| 5,631.0             | 7.60            | 168.70      | 5,606.2             | 357.2      | 91.0       | -355.5                | 11.26                 | 11.25                | 5.63                |  |
| 5,663.0             | 11.10           | 169.40      | 5,637.8             | 352.1      | 92.0       | -350.3                | 10.94                 | 10.94                | 2.19                |  |
| 5,694.0             | 14.50           | 171.30      | 5,668.0             | 345.3      | 93.2       | -343.5                | 11.05                 | 10.97                | 6.13                |  |
| 5,726.0             | 17.50           | 174.60      | 5,698.8             | 336.5      | 94.2       | -334.8                | 9.79                  | 9.38                 | 10.31               |  |
| 5,758.0             | 20.10           | 176.60      | 5,729.1             | 326.2      | 95.0       | -324.5                | 8.37                  | 8.13                 | 6.25                |  |
| 5,790.0             | 23.00           | 176.60      | 5,758.8             | 314.5      | 95.7       | -312.7                | 9.06                  | 9.06                 | 0.00                |  |
| 5,821.0             | 26.00           | 176.90      | 5,787.0             | 301.7      | 96.4       | -299.9                | 9.69                  | 9.68                 | 0.97                |  |
| 5,853.0             | 29.40           | 177.30      | 5,815.4             | 286.8      | 97.2       | -285.0                | 10.64                 | 10.63                | 1.25                |  |
| 5,885.0             | 32.40           | 178.70      | 5,842.8             | 270.4      | 97.7       | -268.6                | 9.64                  | 9.38                 | 4.38                |  |
| 5,917.0             | 35.30           | 179.40      | 5,869.4             | 252.6      | 98.0       | -250.8                | 9.14                  | 9.06                 | 2.19                |  |
| 5,948.0             | 39.10           | 179.00      | 5,894.1             | 233.9      | 98.3       | -232.0                | 12.28                 | 12.26                | -1.29               |  |
| 5,980.0             | 43.40           | 179.70      | 5,918.1             | 212.8      | 98.5       | -210.9                | 13.51                 | 13.44                | 2.19                |  |
| 6,012.0             | 46.40           | 181.00      | 5,940.8             | 190.2      | 98.4       | -188.4                | 9.80                  | 9.38                 | 4.06                |  |
| 6,044.0             | 49.20           | 181.30      | 5,962.3             | 166.5      | 97.9       | -164.7                | 8.78                  | 8.75                 | 0.94                |  |
| 6,076.0             | 52.30           | 181.20      | 5,982.5             | 141.7      | 97.4       | -139.9                | 9.69                  | 9.69                 | -0.31               |  |
| 6,107.0             | 55.50           | 180.60      | 6,000.8             | 116.7      | 97.0       | -114.9                | 10.44                 | 10.32                | -1.94               |  |
| 6,139.0             | 58.70           | 180.10      | 6,018.2             | 89.8       | 96.8       | -88.0                 | 10.09                 | 10.00                | -1.56               |  |
| 6,171.0             | 62.10           | 179.70      | 6,034.0             | 62.0       | 96.9       | -60.2                 | 10.68                 | 10.63                | -1.25               |  |
| 6,203.0             | 64.70           | 179.00      | 6,048.3             | 33.4       | 97.2       | -31.6                 | 8.36                  | 8.13                 | -2.19               |  |
| 6,234.0             | 66.90           | 178.00      | 6,061.0             | 5.1        | 97.9       | -3.3                  | 7.68                  | 7.10                 | -3.23               |  |

|                  |                                    |                                     |  |
|------------------|------------------------------------|-------------------------------------|--|
| <b>Company:</b>  | BONANZA CREEK ENERGY OPERATING     | <b>Local Co-ordinate Reference:</b> | Well State Pronghorn F-J-16HNB         |
| <b>Project:</b>  | SEC.16-T5N-R61W                    | <b>TVD Reference:</b>               | WELL @ 4653.0ft (Ensign 128 - RKB 15') |
| <b>Site:</b>     | Pronghorn F-16 Pad Sec.16-T5N-R61W | <b>MD Reference:</b>                | WELL @ 4653.0ft (Ensign 128 - RKB 15') |
| <b>Well:</b>     | State Pronghorn F-J-16HNB          | <b>North Reference:</b>             | True                                   |
| <b>Wellbore:</b> | Wellbore #1                        | <b>Survey Calculation Method:</b>   | Minimum Curvature                      |
| <b>Design:</b>   | Wellbore #1                        | <b>Database:</b>                    | Landmark                               |

## Survey

| Measured Depth (ft)              | Inclination (°) | Azimuth (°) | Vertical Depth (ft) | +N/-S (ft) | +E/-W (ft) | Vertical Section (ft) | Dogleg Rate (°/100ft) | Build Rate (°/100ft) | Turn Rate (°/100ft) |
|----------------------------------|-----------------|-------------|---------------------|------------|------------|-----------------------|-----------------------|----------------------|---------------------|
| 6,266.0                          | 69.60           | 178.20      | 6,072.9             | -24.6      | 98.9       | 26.4                  | 8.46                  | 8.44                 | 0.63                |
| 6,298.0                          | 73.00           | 178.00      | 6,083.1             | -54.9      | 99.9       | 56.7                  | 10.64                 | 10.63                | -0.63               |
| 6,330.0                          | 76.90           | 178.70      | 6,091.4             | -85.8      | 100.8      | 87.6                  | 12.37                 | 12.19                | 2.19                |
| 6,361.0                          | 79.80           | 179.00      | 6,097.7             | -116.1     | 101.4      | 117.9                 | 9.40                  | 9.35                 | 0.97                |
| 6,393.0                          | 81.60           | 178.30      | 6,102.9             | -147.7     | 102.2      | 149.5                 | 6.02                  | 5.63                 | -2.19               |
| 6,404.4                          | 82.60           | 178.19      | 6,104.4             | -159.0     | 102.5      | 160.8                 | 8.80                  | 8.75                 | -0.94               |
| <b>T1 531'FNL &amp; 1353'FWL</b> |                 |             |                     |            |            |                       |                       |                      |                     |
| 6,425.0                          | 84.40           | 178.00      | 6,106.8             | -179.4     | 103.2      | 181.3                 | 8.80                  | 8.75                 | -0.94               |
| 6,457.0                          | 88.30           | 177.50      | 6,108.8             | -211.3     | 104.4      | 213.2                 | 12.29                 | 12.19                | -1.56               |
| 6,489.0                          | 90.30           | 175.70      | 6,109.2             | -243.3     | 106.3      | 245.1                 | 8.41                  | 6.25                 | -5.63               |
| 6,511.0                          | 89.10           | 176.20      | 6,109.3             | -265.2     | 107.9      | 267.1                 | 5.91                  | -5.45                | 2.27                |
| 6,596.0                          | 88.40           | 176.20      | 6,111.2             | -350.0     | 113.5      | 352.0                 | 0.82                  | -0.82                | 0.00                |
| 6,627.0                          | 88.50           | 175.20      | 6,112.0             | -380.9     | 115.9      | 382.9                 | 3.24                  | 0.32                 | -3.23               |
| 6,658.0                          | 87.80           | 175.00      | 6,113.0             | -411.8     | 118.5      | 413.8                 | 2.35                  | -2.26                | -0.65               |
| 6,689.0                          | 87.50           | 175.00      | 6,114.3             | -442.6     | 121.2      | 444.7                 | 0.97                  | -0.97                | 0.00                |
| 6,720.0                          | 87.90           | 176.20      | 6,115.5             | -473.5     | 123.6      | 475.7                 | 4.08                  | 1.29                 | 3.87                |
| 6,751.0                          | 88.80           | 176.10      | 6,116.4             | -504.4     | 125.7      | 506.6                 | 2.92                  | 2.90                 | -0.32               |
| 6,782.0                          | 89.20           | 176.60      | 6,117.0             | -535.4     | 127.6      | 537.6                 | 2.07                  | 1.29                 | 1.61                |
| 6,813.0                          | 90.30           | 176.60      | 6,117.1             | -566.3     | 129.5      | 568.6                 | 3.55                  | 3.55                 | 0.00                |
| 6,843.0                          | 91.00           | 178.50      | 6,116.8             | -596.3     | 130.7      | 598.5                 | 6.75                  | 2.33                 | 6.33                |
| 6,875.0                          | 91.10           | 178.90      | 6,116.2             | -628.3     | 131.5      | 630.5                 | 1.29                  | 0.31                 | 1.25                |
| 6,907.0                          | 91.00           | 178.90      | 6,115.6             | -660.3     | 132.1      | 662.5                 | 0.31                  | -0.31                | 0.00                |
| 6,939.0                          | 91.30           | 179.90      | 6,114.9             | -692.3     | 132.4      | 694.5                 | 3.26                  | 0.94                 | 3.13                |
| 6,970.0                          | 90.60           | 181.50      | 6,114.4             | -723.2     | 132.0      | 725.5                 | 5.63                  | -2.26                | 5.16                |
| 7,002.0                          | 90.30           | 182.70      | 6,114.2             | -755.2     | 130.9      | 757.5                 | 3.87                  | -0.94                | 3.75                |
| 7,034.0                          | 90.80           | 183.30      | 6,113.9             | -787.2     | 129.2      | 789.4                 | 2.44                  | 1.56                 | 1.88                |
| 7,066.0                          | 91.60           | 183.60      | 6,113.2             | -819.1     | 127.3      | 821.3                 | 2.67                  | 2.50                 | 0.94                |
| 7,097.0                          | 91.30           | 184.70      | 6,112.4             | -850.0     | 125.0      | 852.1                 | 3.68                  | -0.97                | 3.55                |
| 7,129.0                          | 90.70           | 184.80      | 6,111.9             | -881.9     | 122.4      | 884.0                 | 1.90                  | -1.88                | 0.31                |
| 7,161.0                          | 89.60           | 184.80      | 6,111.8             | -913.8     | 119.7      | 915.8                 | 3.44                  | -3.44                | 0.00                |
| 7,193.0                          | 89.40           | 184.80      | 6,112.0             | -945.7     | 117.0      | 947.6                 | 0.63                  | -0.63                | 0.00                |
| 7,224.0                          | 89.80           | 185.20      | 6,112.3             | -976.6     | 114.3      | 978.5                 | 1.82                  | 1.29                 | 1.29                |
| 7,256.0                          | 89.60           | 185.00      | 6,112.4             | -1,008.4   | 111.5      | 1,010.3               | 0.88                  | -0.63                | -0.63               |
| 7,288.0                          | 90.00           | 185.70      | 6,112.5             | -1,040.3   | 108.5      | 1,042.1               | 2.52                  | 1.25                 | 2.19                |
| 7,319.0                          | 90.00           | 185.70      | 6,112.5             | -1,071.1   | 105.4      | 1,072.9               | 0.00                  | 0.00                 | 0.00                |
| 7,351.0                          | 90.00           | 186.30      | 6,112.5             | -1,103.0   | 102.1      | 1,104.6               | 1.88                  | 0.00                 | 1.88                |
| 7,383.0                          | 89.20           | 185.90      | 6,112.8             | -1,134.8   | 98.7       | 1,136.4               | 2.80                  | -2.50                | -1.25               |
| 7,415.0                          | 88.90           | 185.50      | 6,113.3             | -1,166.6   | 95.5       | 1,168.1               | 1.56                  | -0.94                | -1.25               |
| 7,446.0                          | 90.20           | 185.20      | 6,113.5             | -1,197.5   | 92.6       | 1,199.0               | 4.30                  | 4.19                 | -0.97               |
| 7,478.0                          | 90.40           | 183.40      | 6,113.4             | -1,229.4   | 90.2       | 1,230.8               | 5.66                  | 0.63                 | -5.63               |
| 7,510.0                          | 90.70           | 183.80      | 6,113.1             | -1,261.3   | 88.2       | 1,262.7               | 1.56                  | 0.94                 | 1.25                |
| 7,541.0                          | 90.70           | 183.60      | 6,112.7             | -1,292.3   | 86.2       | 1,293.6               | 0.65                  | 0.00                 | -0.65               |
| 7,573.0                          | 91.40           | 182.90      | 6,112.1             | -1,324.2   | 84.4       | 1,325.5               | 3.09                  | 2.19                 | -2.19               |
| 7,605.0                          | 92.00           | 182.00      | 6,111.2             | -1,356.2   | 83.0       | 1,357.4               | 3.38                  | 1.88                 | -2.81               |
| 7,637.0                          | 91.50           | 181.50      | 6,110.2             | -1,388.1   | 82.0       | 1,389.4               | 2.21                  | -1.56                | -1.56               |
| 7,669.0                          | 91.60           | 180.80      | 6,109.3             | -1,420.1   | 81.4       | 1,421.3               | 2.21                  | 0.31                 | -2.19               |
| 7,700.0                          | 91.10           | 179.90      | 6,108.6             | -1,451.1   | 81.2       | 1,452.3               | 3.32                  | -1.61                | -2.90               |
| 7,732.0                          | 90.70           | 178.90      | 6,108.1             | -1,483.1   | 81.5       | 1,484.3               | 3.37                  | -1.25                | -3.13               |
| 7,764.0                          | 90.30           | 177.80      | 6,107.8             | -1,515.1   | 82.5       | 1,516.3               | 3.66                  | -1.25                | -3.44               |
| 7,796.0                          | 90.10           | 176.80      | 6,107.7             | -1,547.0   | 84.0       | 1,548.3               | 3.19                  | -0.63                | -3.13               |
| 7,828.0                          | 89.30           | 176.80      | 6,107.9             | -1,579.0   | 85.8       | 1,580.3               | 2.50                  | -2.50                | 0.00                |
| 7,860.0                          | 89.00           | 176.10      | 6,108.3             | -1,610.9   | 87.7       | 1,612.2               | 2.38                  | -0.94                | -2.19               |
| 7,892.0                          | 88.50           | 176.60      | 6,109.0             | -1,642.9   | 89.8       | 1,644.2               | 2.21                  | -1.56                | 1.56                |
| 7,923.0                          | 88.50           | 178.00      | 6,109.8             | -1,673.8   | 91.2       | 1,675.2               | 4.51                  | 0.00                 | 4.52                |

|                  |                                    |                                     |  |
|------------------|------------------------------------|-------------------------------------|--|
| <b>Company:</b>  | BONANZA CREEK ENERGY OPERATING     | <b>Local Co-ordinate Reference:</b> | Well State Pronghorn F-J-16HNB         |
| <b>Project:</b>  | SEC.16-T5N-R61W                    | <b>TVD Reference:</b>               | WELL @ 4653.0ft (Ensign 128 - RKB 15') |
| <b>Site:</b>     | Pronghorn F-16 Pad Sec.16-T5N-R61W | <b>MD Reference:</b>                | WELL @ 4653.0ft (Ensign 128 - RKB 15') |
| <b>Well:</b>     | State Pronghorn F-J-16HNB          | <b>North Reference:</b>             | True                                   |
| <b>Wellbore:</b> | Wellbore #1                        | <b>Survey Calculation Method:</b>   | Minimum Curvature                      |
| <b>Design:</b>   | Wellbore #1                        | <b>Database:</b>                    | Landmark                               |

| Survey              |                 |             |                     |            |            |                       |                       |                      |                     |
|---------------------|-----------------|-------------|---------------------|------------|------------|-----------------------|-----------------------|----------------------|---------------------|
| Measured Depth (ft) | Inclination (°) | Azimuth (°) | Vertical Depth (ft) | +N/-S (ft) | +E/-W (ft) | Vertical Section (ft) | Dogleg Rate (°/100ft) | Build Rate (°/100ft) | Turn Rate (°/100ft) |
| 7,955.0             | 87.80           | 178.70      | 6,110.9             | -1,705.8   | 92.2       | 1,707.2               | 3.09                  | -2.19                | 2.19                |
| 7,987.0             | 88.00           | 178.30      | 6,112.0             | -1,737.7   | 93.0       | 1,739.1               | 1.40                  | 0.63                 | -1.25               |
| 8,019.0             | 88.30           | 178.90      | 6,113.1             | -1,769.7   | 93.8       | 1,771.1               | 2.10                  | 0.94                 | 1.88                |
| 8,050.0             | 88.10           | 179.00      | 6,114.1             | -1,800.7   | 94.3       | 1,802.1               | 0.72                  | -0.65                | 0.32                |
| 8,082.0             | 88.80           | 178.50      | 6,114.9             | -1,832.7   | 95.0       | 1,834.1               | 2.69                  | 2.19                 | -1.56               |
| 8,114.0             | 88.50           | 180.60      | 6,115.7             | -1,864.7   | 95.3       | 1,866.1               | 6.63                  | -0.94                | 6.56                |
| 8,146.0             | 88.90           | 180.30      | 6,116.4             | -1,896.7   | 95.0       | 1,898.1               | 1.56                  | 1.25                 | -0.94               |
| 8,178.0             | 90.00           | 182.00      | 6,116.7             | -1,928.6   | 94.4       | 1,930.0               | 6.33                  | 3.44                 | 5.31                |
| 8,209.0             | 91.20           | 181.20      | 6,116.4             | -1,959.6   | 93.5       | 1,961.0               | 4.65                  | 3.87                 | -2.58               |
| 8,241.0             | 91.90           | 180.30      | 6,115.5             | -1,991.6   | 93.1       | 1,993.0               | 3.56                  | 2.19                 | -2.81               |
| 8,273.0             | 92.20           | 179.90      | 6,114.4             | -2,023.6   | 93.1       | 2,024.9               | 1.56                  | 0.94                 | -1.25               |
| 8,305.0             | 91.40           | 179.90      | 6,113.4             | -2,055.6   | 93.1       | 2,056.9               | 2.50                  | -2.50                | 0.00                |
| 8,336.0             | 91.30           | 181.50      | 6,112.6             | -2,086.6   | 92.7       | 2,087.9               | 5.17                  | -0.32                | 5.16                |
| 8,368.0             | 90.40           | 180.60      | 6,112.2             | -2,118.6   | 92.1       | 2,119.9               | 3.98                  | -2.81                | -2.81               |
| 8,400.0             | 89.60           | 179.90      | 6,112.2             | -2,150.6   | 92.0       | 2,151.9               | 3.32                  | -2.50                | -2.19               |
| 8,432.0             | 89.20           | 180.40      | 6,112.5             | -2,182.6   | 91.9       | 2,183.9               | 2.00                  | -1.25                | 1.56                |
| 8,463.0             | 88.50           | 181.00      | 6,113.1             | -2,213.5   | 91.5       | 2,214.8               | 2.97                  | -2.26                | 1.94                |
| 8,495.0             | 88.30           | 181.50      | 6,114.0             | -2,245.5   | 90.8       | 2,246.8               | 1.68                  | -0.63                | 1.56                |
| 8,527.0             | 89.10           | 181.50      | 6,114.7             | -2,277.5   | 90.0       | 2,278.8               | 2.50                  | 2.50                 | 0.00                |
| 8,559.0             | 89.40           | 182.40      | 6,115.2             | -2,309.5   | 88.9       | 2,310.7               | 2.96                  | 0.94                 | 2.81                |
| 8,590.0             | 89.70           | 182.60      | 6,115.4             | -2,340.5   | 87.6       | 2,341.7               | 1.16                  | 0.97                 | 0.65                |
| 8,622.0             | 89.90           | 181.90      | 6,115.5             | -2,372.4   | 86.3       | 2,373.6               | 2.28                  | 0.63                 | -2.19               |
| 8,654.0             | 89.40           | 180.10      | 6,115.7             | -2,404.4   | 85.8       | 2,405.6               | 5.84                  | -1.56                | -5.63               |
| 8,685.0             | 90.30           | 179.70      | 6,115.8             | -2,435.4   | 85.8       | 2,436.6               | 3.18                  | 2.90                 | -1.29               |
| 8,717.0             | 91.40           | 178.90      | 6,115.3             | -2,467.4   | 86.2       | 2,468.6               | 4.25                  | 3.44                 | -2.50               |
| 8,749.0             | 90.90           | 178.30      | 6,114.7             | -2,499.4   | 87.0       | 2,500.6               | 2.44                  | -1.56                | -1.88               |
| 8,781.0             | 89.40           | 177.10      | 6,114.6             | -2,531.4   | 88.3       | 2,532.6               | 6.00                  | -4.69                | -3.75               |
| 8,812.0             | 89.20           | 178.50      | 6,115.0             | -2,562.3   | 89.5       | 2,563.5               | 4.56                  | -0.65                | 4.52                |
| 8,844.0             | 88.90           | 178.70      | 6,115.5             | -2,594.3   | 90.2       | 2,595.5               | 1.13                  | -0.94                | 0.63                |
| 8,876.0             | 88.70           | 179.20      | 6,116.2             | -2,626.3   | 90.8       | 2,627.5               | 1.68                  | -0.63                | 1.56                |
| 8,908.0             | 88.80           | 180.40      | 6,116.9             | -2,658.3   | 90.9       | 2,659.5               | 3.76                  | 0.31                 | 3.75                |
| 8,939.0             | 88.90           | 181.00      | 6,117.5             | -2,689.3   | 90.6       | 2,690.5               | 1.96                  | 0.32                 | 1.94                |
| 8,971.0             | 88.30           | 180.30      | 6,118.3             | -2,721.3   | 90.2       | 2,722.5               | 2.88                  | -1.88                | -2.19               |
| 9,003.0             | 88.40           | 179.60      | 6,119.2             | -2,753.3   | 90.2       | 2,754.5               | 2.21                  | 0.31                 | -2.19               |
| 9,035.0             | 88.70           | 179.60      | 6,120.0             | -2,785.3   | 90.4       | 2,786.4               | 0.94                  | 0.94                 | 0.00                |
| 9,066.0             | 89.30           | 179.90      | 6,120.5             | -2,816.3   | 90.6       | 2,817.4               | 2.16                  | 1.94                 | 0.97                |
| 9,098.0             | 90.70           | 179.70      | 6,120.5             | -2,848.3   | 90.7       | 2,849.4               | 4.42                  | 4.38                 | -0.63               |
| 9,130.0             | 91.50           | 180.40      | 6,119.9             | -2,880.3   | 90.7       | 2,881.4               | 3.32                  | 2.50                 | 2.19                |
| 9,162.0             | 90.60           | 180.10      | 6,119.3             | -2,912.2   | 90.5       | 2,913.4               | 2.96                  | -2.81                | -0.94               |
| 9,193.0             | 89.90           | 180.10      | 6,119.2             | -2,943.2   | 90.5       | 2,944.4               | 2.26                  | -2.26                | 0.00                |
| 9,225.0             | 90.00           | 180.10      | 6,119.2             | -2,975.2   | 90.4       | 2,976.4               | 0.31                  | 0.31                 | 0.00                |
| 9,257.0             | 90.00           | 179.60      | 6,119.2             | -3,007.2   | 90.5       | 3,008.4               | 1.56                  | 0.00                 | -1.56               |
| 9,288.0             | 90.70           | 180.40      | 6,119.0             | -3,038.2   | 90.5       | 3,039.4               | 3.43                  | 2.26                 | 2.58                |
| 9,320.0             | 91.30           | 181.00      | 6,118.5             | -3,070.2   | 90.1       | 3,071.4               | 2.65                  | 1.88                 | 1.88                |
| 9,352.0             | 91.10           | 180.60      | 6,117.8             | -3,102.2   | 89.7       | 3,103.3               | 1.40                  | -0.63                | -1.25               |
| 9,384.0             | 90.00           | 179.20      | 6,117.5             | -3,134.2   | 89.7       | 3,135.3               | 5.56                  | -3.44                | -4.38               |
| 9,416.0             | 90.00           | 179.40      | 6,117.5             | -3,166.2   | 90.1       | 3,167.3               | 0.63                  | 0.00                 | 0.63                |
| 9,447.0             | 90.40           | 179.90      | 6,117.4             | -3,197.2   | 90.3       | 3,198.3               | 2.07                  | 1.29                 | 1.61                |
| 9,479.0             | 91.40           | 178.70      | 6,116.9             | -3,229.2   | 90.7       | 3,230.3               | 4.88                  | 3.13                 | -3.75               |
| 9,511.0             | 91.50           | 178.90      | 6,116.1             | -3,261.2   | 91.4       | 3,262.3               | 0.70                  | 0.31                 | 0.63                |
| 9,543.0             | 91.60           | 179.00      | 6,115.2             | -3,293.2   | 91.9       | 3,294.3               | 0.44                  | 0.31                 | 0.31                |
| 9,575.0             | 91.80           | 180.30      | 6,114.3             | -3,325.2   | 92.1       | 3,326.3               | 4.11                  | 0.63                 | 4.06                |
| 9,607.0             | 91.60           | 180.40      | 6,113.3             | -3,357.1   | 91.9       | 3,358.3               | 0.70                  | -0.63                | 0.31                |
| 9,638.0             | 90.40           | 179.20      | 6,112.8             | -3,388.1   | 92.1       | 3,389.3               | 5.47                  | -3.87                | -3.87               |

|                  |                                    |                                     |  |
|------------------|------------------------------------|-------------------------------------|--|
| <b>Company:</b>  | BONANZA CREEK ENERGY OPERATING     | <b>Local Co-ordinate Reference:</b> | Well State Pronghorn F-J-16HNB         |
| <b>Project:</b>  | SEC.16-T5N-R61W                    | <b>TVD Reference:</b>               | WELL @ 4653.0ft (Ensign 128 - RKB 15') |
| <b>Site:</b>     | Pronghorn F-16 Pad Sec.16-T5N-R61W | <b>MD Reference:</b>                | WELL @ 4653.0ft (Ensign 128 - RKB 15') |
| <b>Well:</b>     | State Pronghorn F-J-16HNB          | <b>North Reference:</b>             | True                                   |
| <b>Wellbore:</b> | Wellbore #1                        | <b>Survey Calculation Method:</b>   | Minimum Curvature                      |
| <b>Design:</b>   | Wellbore #1                        | <b>Database:</b>                    | Landmark                               |

| Survey                 |                 |             |                     |            |            |                       |                       |                      |                     |
|------------------------|-----------------|-------------|---------------------|------------|------------|-----------------------|-----------------------|----------------------|---------------------|
| Measured Depth (ft)    | Inclination (°) | Azimuth (°) | Vertical Depth (ft) | +N/-S (ft) | +E/-W (ft) | Vertical Section (ft) | Dogleg Rate (°/100ft) | Build Rate (°/100ft) | Turn Rate (°/100ft) |
| 9,670.0                | 89.30           | 180.10      | 6,112.9             | -3,420.1   | 92.2       | 3,421.2               | 4.44                  | -3.44                | 2.81                |
| 9,702.0                | 90.00           | 180.30      | 6,113.1             | -3,452.1   | 92.1       | 3,453.2               | 2.28                  | 2.19                 | 0.63                |
| 9,734.0                | 90.70           | 180.40      | 6,112.9             | -3,484.1   | 91.9       | 3,485.2               | 2.21                  | 2.19                 | 0.31                |
| 9,765.0                | 89.80           | 181.30      | 6,112.7             | -3,515.1   | 91.5       | 3,516.2               | 4.11                  | -2.90                | 2.90                |
| 9,797.0                | 89.50           | 181.90      | 6,112.9             | -3,547.1   | 90.6       | 3,548.2               | 2.10                  | -0.94                | 1.88                |
| 9,829.0                | 89.30           | 182.20      | 6,113.3             | -3,579.1   | 89.4       | 3,580.1               | 1.13                  | -0.63                | 0.94                |
| 9,860.0                | 89.10           | 182.20      | 6,113.7             | -3,610.1   | 88.3       | 3,611.1               | 0.65                  | -0.65                | 0.00                |
| 9,892.0                | 89.30           | 180.40      | 6,114.1             | -3,642.1   | 87.5       | 3,643.0               | 5.66                  | 0.63                 | -5.63               |
| 9,924.0                | 89.30           | 181.00      | 6,114.5             | -3,674.1   | 87.1       | 3,675.0               | 1.87                  | 0.00                 | 1.88                |
| 9,956.0                | 89.00           | 180.60      | 6,115.0             | -3,706.0   | 86.7       | 3,707.0               | 1.56                  | -0.94                | -1.25               |
| 9,988.0                | 89.30           | 180.40      | 6,115.5             | -3,738.0   | 86.4       | 3,739.0               | 1.13                  | 0.94                 | -0.63               |
| 10,020.0               | 90.10           | 180.40      | 6,115.6             | -3,770.0   | 86.2       | 3,771.0               | 2.50                  | 2.50                 | 0.00                |
| 10,052.0               | 91.10           | 179.70      | 6,115.3             | -3,802.0   | 86.2       | 3,803.0               | 3.81                  | 3.13                 | -2.19               |
| 10,084.0               | 91.00           | 179.00      | 6,114.7             | -3,834.0   | 86.5       | 3,835.0               | 2.21                  | -0.31                | -2.19               |
| 10,115.0               | 91.00           | 179.20      | 6,114.2             | -3,865.0   | 87.0       | 3,866.0               | 0.65                  | 0.00                 | 0.65                |
| 10,147.0               | 90.70           | 179.70      | 6,113.7             | -3,897.0   | 87.3       | 3,898.0               | 1.82                  | -0.94                | 1.56                |
| 10,179.0               | 90.50           | 180.10      | 6,113.4             | -3,929.0   | 87.4       | 3,930.0               | 1.40                  | -0.63                | 1.25                |
| 10,211.0               | 90.80           | 179.70      | 6,113.0             | -3,961.0   | 87.4       | 3,961.9               | 1.56                  | 0.94                 | -1.25               |
| 10,242.0               | 90.90           | 179.70      | 6,112.6             | -3,992.0   | 87.6       | 3,992.9               | 0.32                  | 0.32                 | 0.00                |
| 10,274.0               | 90.40           | 180.30      | 6,112.2             | -4,024.0   | 87.6       | 4,024.9               | 2.44                  | -1.56                | 1.88                |
| 10,306.0               | 90.00           | 180.80      | 6,112.1             | -4,056.0   | 87.3       | 4,056.9               | 2.00                  | -1.25                | 1.56                |
| 10,338.0               | 90.00           | 180.80      | 6,112.1             | -4,088.0   | 86.8       | 4,088.9               | 0.00                  | 0.00                 | 0.00                |
| 10,369.0               | 89.60           | 181.00      | 6,112.2             | -4,119.0   | 86.3       | 4,119.9               | 1.44                  | -1.29                | 0.65                |
| 10,401.0               | 89.20           | 181.30      | 6,112.5             | -4,151.0   | 85.7       | 4,151.9               | 1.56                  | -1.25                | 0.94                |
| 10,433.0               | 88.60           | 181.70      | 6,113.1             | -4,183.0   | 84.9       | 4,183.8               | 2.25                  | -1.88                | 1.25                |
| 10,465.0               | 89.40           | 181.00      | 6,113.7             | -4,215.0   | 84.1       | 4,215.8               | 3.32                  | 2.50                 | -2.19               |
| 10,496.0               | 89.90           | 180.40      | 6,113.9             | -4,246.0   | 83.7       | 4,246.8               | 2.52                  | 1.61                 | -1.94               |
| 10,528.0               | 90.00           | 180.80      | 6,113.9             | -4,278.0   | 83.4       | 4,278.8               | 1.29                  | 0.31                 | 1.25                |
| 10,560.0               | 90.00           | 180.80      | 6,113.9             | -4,310.0   | 83.0       | 4,310.7               | 0.00                  | 0.00                 | 0.00                |
| 10,592.0               | 90.00           | 180.40      | 6,113.9             | -4,342.0   | 82.6       | 4,342.7               | 1.25                  | 0.00                 | -1.25               |
| 10,623.0               | 89.50           | 180.10      | 6,114.0             | -4,372.9   | 82.5       | 4,373.7               | 1.88                  | -1.61                | -0.97               |
| 10,655.0               | 89.60           | 180.80      | 6,114.3             | -4,404.9   | 82.2       | 4,405.7               | 2.21                  | 0.31                 | 2.19                |
| 10,682.0               | 90.00           | 181.00      | 6,114.4             | -4,431.9   | 81.8       | 4,432.7               | 1.66                  | 1.48                 | 0.74                |
| 10,734.0               | 90.00           | 181.00      | 6,114.4             | -4,483.9   | 80.9       | 4,484.7               | 0.00                  | 0.00                 | 0.00                |
| BHL 470'FSL & 1341'FWL |                 |             |                     |            |            |                       |                       |                      |                     |

| Design Targets  |               |              |          |            |            |               |              |           |             |
|---|---------------|--------------|----------|------------|------------|---------------|--------------|-----------|-------------|
| Target Name   | Dip Angle (°) | Dip Dir. (°) | TVD (ft) | +N/-S (ft) | +E/-W (ft) | Northing (ft) | Easting (ft) | Latitude  | Longitude   |
| T1 531'FNL & 1353'FV<br>- hit/miss target<br>- Shape<br>- Point   | 0.00          | 0.00         | 6,103.0  | -159.4     | 94.7       | 1,393,670.57  | 3,356,775.68 | 40.406952 | -104.218810 |
| - survey misses target center by 8.0ft at 6404.4ft MD (6104.4 TVD, -159.0 N, 102.5 E)                                       |               |              |          |            |            |               |              |           |             |
| BHL 470'FSL & 1341'FV<br>- survey misses target center by 11.4ft at 10734.0ft MD (6114.4 TVD, -4483.9 N, 80.9 E)<br>- Point | 0.00          | 0.00         | 6,103.0  | -4,484.7   | 80.8       | 1,389,345.73  | 3,356,824.24 | 40.395080 | -104.218860 |

|                   |                    |             |
|-------------------|--------------------|-------------|
| Checked By: _____ | Approved By: _____ | Date: _____ |
|-------------------|--------------------|-------------|