

KERR-MCGEE OIL & GAS ONSHORE LP

Location: COLORADO Slot: SLOT#23 JELTS 37N-19HZ (275°FNL & 1828°FEL, SEC.19)
Field: WELD COUNTY (KERR MCGEE) Well: JELTS 37N-19HZ
Facility: SEC.19-T1N-R67W Wellbore: JELTS 37N-19HZ PWB

Plot reference wellpath is JELTS 37N-19HZ (PERMIT REV-1) PWP

True vertical depths are referenced to ENSIGN 145 (RKB)	Grid System: NAD83 / Lambert Colorado SP, Northern Zone (501), US feet
Measured depths are referenced to ENSIGN 145 (RKB)	North Reference: True north
ENSIGN 145 (RKB) to Mean Sea Level: 5160 feet	Scale: True distance
Mean Sea Level to Mud line (At Slot: SLOT#23 JELTS 37N-19HZ (275°FNL & 1828°FEL, SEC.19)): 0 feet	Depths are in feet
Coordinates are in feet referenced to Slot	Created by: wlsjef02 on 5/3/2013

Location Information

Facility Name			Grid East (US ft)	Grid North (US ft)	Latitude	Longitude
SEC.19-T1N-R67W			3157293.749	1259018.130	40°02'34.891"N	104°56'17.471"W
Slot	Local N (ft)	Local E (ft)	Grid East (US ft)	Grid North (US ft)	Latitude	Longitude
SLOT#23 JELTS 37N-19HZ (275°FNL & 1828°FEL, SEC.19)	37.83	2112.35	3159405.734	1259069.344	40°02'35.264"N	104°55'50.311"W
ENSIGN 145 (RKB) to Mud line (At Slot: SLOT#23 JELTS 37N-19HZ (275°FNL & 1828°FEL, SEC.19))					5160ft	
Mean Sea Level to Mud line (At Slot: SLOT#23 JELTS 37N-19HZ (275°FNL & 1828°FEL, SEC.19))					0ft	
ENSIGN 145 (RKB) to Mean Sea Level					5160ft	

Survey Program

Start MD (ft)	End MD (ft)	Tool	Model	Log Name/Comment	Wellbore
13.00	7956.39	NaviTrak	NaviTrak (Standard)		JELTS 37N-19HZ PWB
7956.39	12157.04	OnTrak	OnTrak (Standard)		JELTS 37N-19HZ PWB

Well Profile Data

Design Comment	MD (ft)	Inc (°)	Az (°)	TVD (ft)	Local N (ft)	Local E (ft)	DLS (°/100ft)	VS (ft)
TIE-ON	13.00	0.000	48.300	13.00	0.00	0.00	0.00	0.00
BEGIN NUDGE	1100.00	0.000	48.300	1100.00	0.00	0.00	0.00	0.00
END NUDGE	1600.00	10.000	48.300	1597.47	28.95	32.50	2.00	-26.60
BEGIN DROP	2941.92	10.000	48.300	2919.00	183.97	206.48	0.00	-169.03
END DROP	3441.92	0.000	179.025	3416.47	212.92	238.97	2.00	-195.64
KOP, BUILD @ 10°/100'	7062.53	0.000	179.025	7037.08	212.92	238.97	0.00	-195.64
LANDING POINT	7956.39	89.386	179.025	7610.00	-353.82	248.62	10.00	370.38
TOTAL DEPTH	12157.04	89.386	179.025	7655.00	-4553.61	320.10	0.00	4564.85

Targets

Name	MD (ft)	TVD (ft)	Local N (ft)	Local E (ft)	Grid East (US ft)	Grid North (US ft)	Latitude	Longitude
SECTION 19 LINES		27.00	-37.76	-2112.27	3157293.83	1259018.03	40°02'34.890"N	104°56'17.470"W
JELTS 37N-19HZ BHL ON PLAT REV-1 (460°FSL & 1590°FEL, SEC.19)	12157.04	7655.00	-4553.61	320.10	3159755.05	1254518.05	40°01'50.264"N	104°55'46.196"W
SEC. 19 HARDLINES (460' SETBACKS)		8027.00	-37.76	-2112.27	3157293.83	1259018.03	40°02'34.890"N	104°56'17.470"W

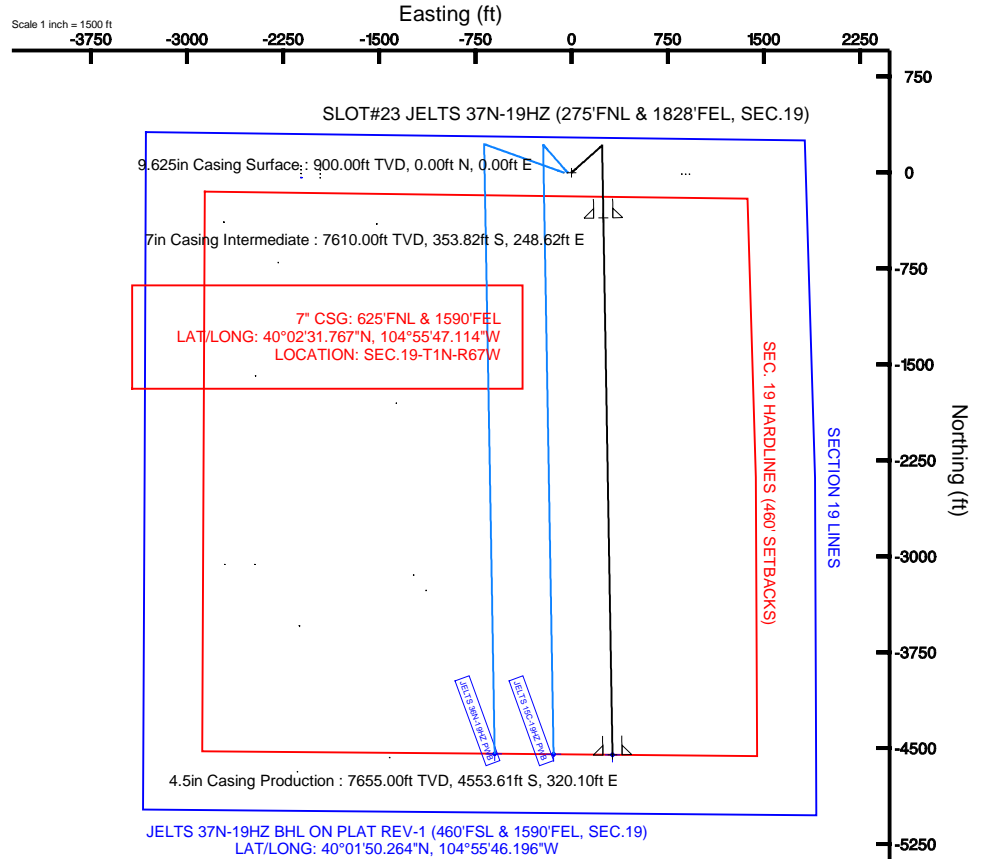
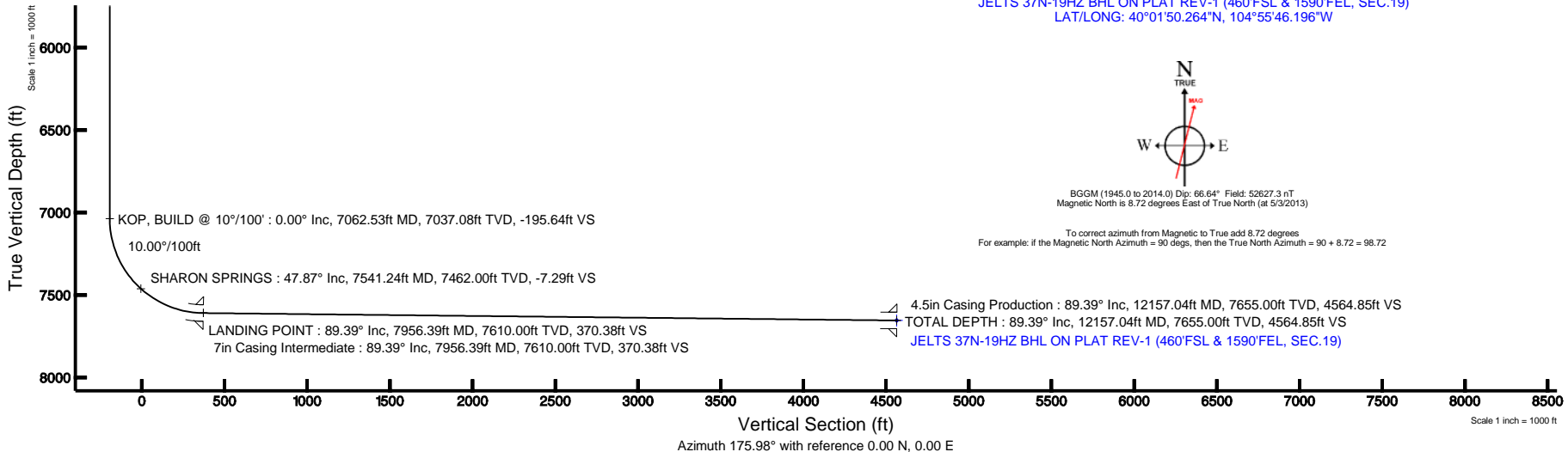

BGGM (1945.0 to 2014.0) Dip: 66.64° Field: 52627.3 nT
Magnetic North is 8.72 degrees East of True North (at 5/3/2013)

To correct azimuth from Magnetic to True add 8.72 degrees
For example: if the Magnetic North Azimuth = 90 degrees, then the True North Azimuth = 90 + 8.72 = 98.72



Planned Wellpath Report

JELTS 37N-19HZ (PERMIT REV-1) PWP

Page 1 of 6



REFERENCE WELLPATH IDENTIFICATION			
Operator	KERR-MCGEE OIL & GAS ONSHORE LP	Slot	SLOT#23 JELTS 37N-19HZ (275'FNL & 1828'FEL, SEC.19)
Area	COLORADO	Well	JELTS 37N-19HZ
Field	WELD COUNTY (KERR MCGEE)	Wellbore	JELTS 37N-19HZ PWB
Facility	SEC.19-T1N-R67W		

REPORT SETUP INFORMATION			
Projection System	NAD83 / Lambert Colorado SP, Northern Zone (501), US feet	Software System	WellArchitect® 3.0.2
North Reference	True	User	Wilsjef02
Scale	0.999963	Report Generated	5/3/2013 at 12:50:47
Convergence at slot	0.37° East	Database/Source file	WellArchitectDB/JELTS_37N-19HZ_PWB.xml

WELLPATH LOCATION						
	Local coordinates		Grid coordinates		Geographic coordinates	
	North[ft]	East[ft]	Easting[US ft]	Northing[US ft]	Latitude	Longitude
Slot Location	37.83	2112.35	3159405.73	1259069.34	40°02'35.264"N	104°55'50.311"W
Facility Reference Pt			3157293.75	1259018.13	40°02'34.891"N	104°56'17.471"W
Field Reference Pt			3197771.84	1268891.29	40°04'09.600"N	104°47'36.000"W

WELLPATH DATUM			
Calculation method	Minimum curvature	ENSIGN 145 (RKB) to Facility Vertical Datum	5160.00ft
Horizontal Reference Pt	Slot	ENSIGN 145 (RKB) to Mean Sea Level	5160.00ft
Vertical Reference Pt	ENSIGN 145 (RKB)	ENSIGN 145 (RKB) to Mud Line at Slot (SLOT#23 JELTS 37N-19HZ (275'FNL & 1828'FEL, SEC.19))	5160.00ft
MD Reference Pt	ENSIGN 145 (RKB)	Section Origin	N 0.00, E 0.00 ft
Field Vertical Reference	Mean Sea Level	Section Azimuth	175.98°



Planned Wellpath Report

JELTS 37N-19HZ (PERMIT REV-1) PWP
Page 2 of 6



REFERENCE WELLPATH IDENTIFICATION

Operator	KERR-MCGEE OIL & GAS ONSHORE LP	Slot	SLOT#23 JELTS 37N-19HZ (275'FNL & 1828'FEL, SEC.19)
Area	COLORADO	Well	JELTS 37N-19HZ
Field	WELD COUNTY (KERR MCGEE)	Wellbore	JELTS 37N-19HZ PWB
Facility	SEC.19-T1N-R67W		

WELLPATH DATA (132 stations) † = interpolated/extrapolated station

MD [ft]	Inclination [°]	Azimuth [°]	TVD [ft]	Vert Sect [ft]	North [ft]	East [ft]	Latitude	Longitude	DLS [°/100ft]	Comments
0.00†	0.000	48.300	0.00	0.00	0.00	0.00	40°02'35.264"N	104°55'50.311"W	0.00	
13.00	0.000	48.300	13.00	0.00	0.00	0.00	40°02'35.264"N	104°55'50.311"W	0.00	TIE-ON
113.00†	0.000	48.300	113.00	0.00	0.00	0.00	40°02'35.264"N	104°55'50.311"W	0.00	
213.00†	0.000	48.300	213.00	0.00	0.00	0.00	40°02'35.264"N	104°55'50.311"W	0.00	
313.00†	0.000	48.300	313.00	0.00	0.00	0.00	40°02'35.264"N	104°55'50.311"W	0.00	
413.00†	0.000	48.300	413.00	0.00	0.00	0.00	40°02'35.264"N	104°55'50.311"W	0.00	
513.00†	0.000	48.300	513.00	0.00	0.00	0.00	40°02'35.264"N	104°55'50.311"W	0.00	
613.00†	0.000	48.300	613.00	0.00	0.00	0.00	40°02'35.264"N	104°55'50.311"W	0.00	
713.00†	0.000	48.300	713.00	0.00	0.00	0.00	40°02'35.264"N	104°55'50.311"W	0.00	
813.00†	0.000	48.300	813.00	0.00	0.00	0.00	40°02'35.264"N	104°55'50.311"W	0.00	
913.00†	0.000	48.300	913.00	0.00	0.00	0.00	40°02'35.264"N	104°55'50.311"W	0.00	
1013.00†	0.000	48.300	1013.00	0.00	0.00	0.00	40°02'35.264"N	104°55'50.311"W	0.00	
1100.00	0.000	48.300	1100.00	0.00	0.00	0.00	40°02'35.264"N	104°55'50.311"W	0.00	BEGIN NUDGE
1113.00†	0.260	48.300	1113.00	-0.02	0.02	0.02	40°02'35.264"N	104°55'50.311"W	2.00	
1213.00†	2.260	48.300	1212.97	-1.36	1.48	1.66	40°02'35.279"N	104°55'50.290"W	2.00	
1313.00†	4.260	48.300	1312.80	-4.84	5.27	5.91	40°02'35.316"N	104°55'50.235"W	2.00	
1413.00†	6.260	48.300	1412.38	-10.44	11.36	12.75	40°02'35.376"N	104°55'50.147"W	2.00	
1513.00†	8.260	48.300	1511.57	-18.16	19.77	22.19	40°02'35.459"N	104°55'50.026"W	2.00	
1600.00	10.000	48.300	1597.47	-26.60	28.95	32.50	40°02'35.550"N	104°55'49.893"W	2.00	END NUDGE
1613.00†	10.000	48.300	1610.27	-27.98	30.45	34.18	40°02'35.565"N	104°55'49.872"W	0.00	
1713.00†	10.000	48.300	1708.75	-38.60	42.01	47.15	40°02'35.679"N	104°55'49.705"W	0.00	
1813.00†	10.000	48.300	1807.23	-49.21	53.56	60.11	40°02'35.793"N	104°55'49.538"W	0.00	
1913.00†	10.000	48.300	1905.71	-59.82	65.11	73.08	40°02'35.907"N	104°55'49.371"W	0.00	
2013.00†	10.000	48.300	2004.19	-70.44	76.66	86.04	40°02'36.022"N	104°55'49.205"W	0.00	
2113.00†	10.000	48.300	2102.67	-81.05	88.21	99.01	40°02'36.136"N	104°55'49.038"W	0.00	
2213.00†	10.000	48.300	2201.15	-91.67	99.76	111.97	40°02'36.250"N	104°55'48.871"W	0.00	
2313.00†	10.000	48.300	2299.63	-102.28	111.32	124.94	40°02'36.364"N	104°55'48.705"W	0.00	
2413.00†	10.000	48.300	2398.11	-112.89	122.87	137.90	40°02'36.478"N	104°55'48.538"W	0.00	
2513.00†	10.000	48.300	2496.59	-123.51	134.42	150.87	40°02'36.592"N	104°55'48.371"W	0.00	
2613.00†	10.000	48.300	2595.08	-134.12	145.97	163.83	40°02'36.707"N	104°55'48.204"W	0.00	
2713.00†	10.000	48.300	2693.56	-144.74	157.52	176.80	40°02'36.821"N	104°55'48.038"W	0.00	
2813.00†	10.000	48.300	2792.04	-155.35	169.07	189.76	40°02'36.935"N	104°55'47.871"W	0.00	
2913.00†	10.000	48.300	2890.52	-165.96	180.63	202.73	40°02'37.049"N	104°55'47.704"W	0.00	
2941.92	10.000	48.300	2919.00	-169.03	183.97	206.48	40°02'37.082"N	104°55'47.656"W	0.00	BEGIN DROP
3013.00†	8.578	48.300	2989.14	-176.05	191.60	215.05	40°02'37.157"N	104°55'47.546"W	2.00	
3113.00†	6.578	48.300	3088.27	-184.11	200.37	224.89	40°02'37.244"N	104°55'47.419"W	2.00	
3213.00†	4.578	48.300	3187.79	-190.05	206.84	232.15	40°02'37.308"N	104°55'47.326"W	2.00	
3313.00†	2.578	48.300	3287.59	-193.86	210.99	236.81	40°02'37.349"N	104°55'47.266"W	2.00	
3413.00†	0.578	48.300	3387.54	-195.55	212.82	238.87	40°02'37.367"N	104°55'47.240"W	2.00	
3441.92	0.000	179.025	3416.47	-195.64	212.92	238.97	40°02'37.368"N	104°55'47.238"W	2.00	END DROP
3513.00†	0.000	179.025	3487.54	-195.64	212.92	238.97	40°02'37.368"N	104°55'47.238"W	0.00	
3613.00†	0.000	179.025	3587.54	-195.64	212.92	238.97	40°02'37.368"N	104°55'47.238"W	0.00	
3713.00†	0.000	179.025	3687.54	-195.64	212.92	238.97	40°02'37.368"N	104°55'47.238"W	0.00	
3813.00†	0.000	179.025	3787.54	-195.64	212.92	238.97	40°02'37.368"N	104°55'47.238"W	0.00	
3913.00†	0.000	179.025	3887.54	-195.64	212.92	238.97	40°02'37.368"N	104°55'47.238"W	0.00	



Planned Wellpath Report

JELTS 37N-19HZ (PERMIT REV-1) PWP
Page 3 of 6



REFERENCE WELLPATH IDENTIFICATION

Operator	KERR-MCGEE OIL & GAS ONSHORE LP	Slot	SLOT#23 JELTS 37N-19HZ (275'FNL & 1828'FEL, SEC.19)
Area	COLORADO	Well	JELTS 37N-19HZ
Field	WELD COUNTY (KERR MCGEE)	Wellbore	JELTS 37N-19HZ PWB
Facility	SEC.19-T1N-R67W		

WELLPATH DATA (132 stations) † = interpolated/extrapolated station

MD [ft]	Inclination [°]	Azimuth [°]	TVD [ft]	Vert Sect [ft]	North [ft]	East [ft]	Latitude	Longitude	DLS [°/100ft]	Comments
4013.00†	0.000	179.025	3987.54	-195.64	212.92	238.97	40°02'37.368"N	104°55'47.238"W	0.00	
4113.00†	0.000	179.025	4087.54	-195.64	212.92	238.97	40°02'37.368"N	104°55'47.238"W	0.00	
4213.00†	0.000	179.025	4187.54	-195.64	212.92	238.97	40°02'37.368"N	104°55'47.238"W	0.00	
4313.00†	0.000	179.025	4287.54	-195.64	212.92	238.97	40°02'37.368"N	104°55'47.238"W	0.00	
4413.00†	0.000	179.025	4387.54	-195.64	212.92	238.97	40°02'37.368"N	104°55'47.238"W	0.00	
4513.00†	0.000	179.025	4487.54	-195.64	212.92	238.97	40°02'37.368"N	104°55'47.238"W	0.00	
4613.00†	0.000	179.025	4587.54	-195.64	212.92	238.97	40°02'37.368"N	104°55'47.238"W	0.00	
4713.00†	0.000	179.025	4687.54	-195.64	212.92	238.97	40°02'37.368"N	104°55'47.238"W	0.00	
4813.00†	0.000	179.025	4787.54	-195.64	212.92	238.97	40°02'37.368"N	104°55'47.238"W	0.00	
4913.00†	0.000	179.025	4887.54	-195.64	212.92	238.97	40°02'37.368"N	104°55'47.238"W	0.00	
4935.46†	0.000	179.025	4910.00	-195.64	212.92	238.97	40°02'37.368"N	104°55'47.238"W	0.00	SUSSEX
5013.00†	0.000	179.025	4987.54	-195.64	212.92	238.97	40°02'37.368"N	104°55'47.238"W	0.00	
5113.00†	0.000	179.025	5087.54	-195.64	212.92	238.97	40°02'37.368"N	104°55'47.238"W	0.00	
5213.00†	0.000	179.025	5187.54	-195.64	212.92	238.97	40°02'37.368"N	104°55'47.238"W	0.00	
5313.00†	0.000	179.025	5287.54	-195.64	212.92	238.97	40°02'37.368"N	104°55'47.238"W	0.00	
5413.00†	0.000	179.025	5387.54	-195.64	212.92	238.97	40°02'37.368"N	104°55'47.238"W	0.00	
5513.00†	0.000	179.025	5487.54	-195.64	212.92	238.97	40°02'37.368"N	104°55'47.238"W	0.00	
5613.00†	0.000	179.025	5587.54	-195.64	212.92	238.97	40°02'37.368"N	104°55'47.238"W	0.00	
5713.00†	0.000	179.025	5687.54	-195.64	212.92	238.97	40°02'37.368"N	104°55'47.238"W	0.00	
5813.00†	0.000	179.025	5787.54	-195.64	212.92	238.97	40°02'37.368"N	104°55'47.238"W	0.00	
5913.00†	0.000	179.025	5887.54	-195.64	212.92	238.97	40°02'37.368"N	104°55'47.238"W	0.00	
6013.00†	0.000	179.025	5987.54	-195.64	212.92	238.97	40°02'37.368"N	104°55'47.238"W	0.00	
6113.00†	0.000	179.025	6087.54	-195.64	212.92	238.97	40°02'37.368"N	104°55'47.238"W	0.00	
6213.00†	0.000	179.025	6187.54	-195.64	212.92	238.97	40°02'37.368"N	104°55'47.238"W	0.00	
6313.00†	0.000	179.025	6287.54	-195.64	212.92	238.97	40°02'37.368"N	104°55'47.238"W	0.00	
6413.00†	0.000	179.025	6387.54	-195.64	212.92	238.97	40°02'37.368"N	104°55'47.238"W	0.00	
6513.00†	0.000	179.025	6487.54	-195.64	212.92	238.97	40°02'37.368"N	104°55'47.238"W	0.00	
6613.00†	0.000	179.025	6587.54	-195.64	212.92	238.97	40°02'37.368"N	104°55'47.238"W	0.00	
6713.00†	0.000	179.025	6687.54	-195.64	212.92	238.97	40°02'37.368"N	104°55'47.238"W	0.00	
6813.00†	0.000	179.025	6787.54	-195.64	212.92	238.97	40°02'37.368"N	104°55'47.238"W	0.00	
6913.00†	0.000	179.025	6887.54	-195.64	212.92	238.97	40°02'37.368"N	104°55'47.238"W	0.00	
7013.00†	0.000	179.025	6987.54	-195.64	212.92	238.97	40°02'37.368"N	104°55'47.238"W	0.00	
7062.53	0.000	179.025	7037.08	-195.64	212.92	238.97	40°02'37.368"N	104°55'47.238"W	0.00	KOP, BUILD @ 10°/100'
7113.00†	5.047	179.025	7087.48	-193.42	210.70	239.01	40°02'37.346"N	104°55'47.238"W	10.00	
7213.00†	15.047	179.025	7185.82	-176.02	193.28	239.31	40°02'37.174"N	104°55'47.234"W	10.00	
7313.00†	25.047	179.025	7279.64	-141.83	159.05	239.89	40°02'36.836"N	104°55'47.227"W	10.00	
7413.00†	35.047	179.025	7366.09	-91.90	109.05	240.74	40°02'36.342"N	104°55'47.216"W	10.00	
7513.00†	45.047	179.025	7442.55	-27.73	44.80	241.84	40°02'35.707"N	104°55'47.202"W	10.00	
7541.24†	47.871	179.025	7462.00	-7.29	24.33	242.18	40°02'35.504"N	104°55'47.197"W	10.00	SHARON SPRINGS
7613.00†	55.047	179.025	7506.68	48.72	-31.75	243.14	40°02'34.950"N	104°55'47.185"W	10.00	
7713.00†	65.047	179.025	7556.55	135.14	-118.27	244.61	40°02'34.095"N	104°55'47.166"W	10.00	
7813.00†	75.047	179.025	7590.63	228.88	-212.14	246.21	40°02'33.168"N	104°55'47.145"W	10.00	
7913.00†	85.047	179.025	7607.89	327.11	-310.49	247.88	40°02'32.196"N	104°55'47.124"W	10.00	
7956.39	89.386	179.025	7610.00	370.38	-353.82	248.62	40°02'31.767"N	104°55'47.114"W	10.00	LANDING POINT
8013.00†	89.386	179.025	7610.61	426.91	-410.41	249.58	40°02'31.208"N	104°55'47.102"W	0.00	



Planned Wellpath Report

JELTS 37N-19HZ (PERMIT REV-1) PWP
Page 4 of 6



REFERENCE WELLPATH IDENTIFICATION			
Operator	KERR-MCGEE OIL & GAS ONSHORE LP	Slot	SLOT#23 JELTS 37N-19HZ (275'FNL & 1828'FEL, SEC.19)
Area	COLORADO	Well	JELTS 37N-19HZ
Field	WELD COUNTY (KERR MCGEE)	Wellbore	JELTS 37N-19HZ PWB
Facility	SEC.19-T1N-R67W		

WELLPATH DATA (132 stations) † = interpolated/extrapolated station										
MD [ft]	Inclination [°]	Azimuth [°]	TVD [ft]	Vert Sect [ft]	North [ft]	East [ft]	Latitude	Longitude	DLS [°/100ft]	Comments
8113.00†	89.386	179.025	7611.68	526.76	-510.39	251.29	40°02'30.220"N	104°55'47.080"W	0.00	
8213.00†	89.386	179.025	7612.75	626.61	-610.37	252.99	40°02'29.232"N	104°55'47.058"W	0.00	
8313.00†	89.386	179.025	7613.82	726.46	-710.35	254.69	40°02'28.244"N	104°55'47.036"W	0.00	
8413.00†	89.386	179.025	7614.89	826.32	-810.33	256.39	40°02'27.256"N	104°55'47.015"W	0.00	
8513.00†	89.386	179.025	7615.96	926.17	-910.31	258.09	40°02'26.268"N	104°55'46.993"W	0.00	
8613.00†	89.386	179.025	7617.03	1026.02	-1010.29	259.79	40°02'25.280"N	104°55'46.971"W	0.00	
8713.00†	89.386	179.025	7618.11	1125.88	-1110.27	261.49	40°02'24.292"N	104°55'46.949"W	0.00	
8813.00†	89.386	179.025	7619.18	1225.73	-1210.25	263.20	40°02'23.304"N	104°55'46.927"W	0.00	
8913.00†	89.386	179.025	7620.25	1325.58	-1310.23	264.90	40°02'22.316"N	104°55'46.905"W	0.00	
9013.00†	89.386	179.025	7621.32	1425.44	-1410.21	266.60	40°02'21.328"N	104°55'46.883"W	0.00	
9113.00†	89.386	179.025	7622.39	1525.29	-1510.19	268.30	40°02'20.340"N	104°55'46.861"W	0.00	
9213.00†	89.386	179.025	7623.46	1625.14	-1610.17	270.00	40°02'19.352"N	104°55'46.840"W	0.00	
9313.00†	89.386	179.025	7624.53	1724.99	-1710.15	271.70	40°02'18.364"N	104°55'46.818"W	0.00	
9413.00†	89.386	179.025	7625.60	1824.85	-1810.13	273.41	40°02'17.376"N	104°55'46.796"W	0.00	
9513.00†	89.386	179.025	7626.68	1924.70	-1910.11	275.11	40°02'16.388"N	104°55'46.774"W	0.00	
9613.00†	89.386	179.025	7627.75	2024.55	-2010.09	276.81	40°02'15.400"N	104°55'46.752"W	0.00	
9713.00†	89.386	179.025	7628.82	2124.41	-2110.07	278.51	40°02'14.412"N	104°55'46.730"W	0.00	
9813.00†	89.386	179.025	7629.89	2224.26	-2210.05	280.21	40°02'13.424"N	104°55'46.708"W	0.00	
9913.00†	89.386	179.025	7630.96	2324.11	-2310.03	281.91	40°02'12.436"N	104°55'46.687"W	0.00	
10013.00†	89.386	179.025	7632.03	2423.97	-2410.01	283.62	40°02'11.448"N	104°55'46.665"W	0.00	
10113.00†	89.386	179.025	7633.10	2523.82	-2509.99	285.32	40°02'10.460"N	104°55'46.643"W	0.00	
10213.00†	89.386	179.025	7634.17	2623.67	-2609.97	287.02	40°02'09.472"N	104°55'46.621"W	0.00	
10313.00†	89.386	179.025	7635.25	2723.52	-2709.95	288.72	40°02'08.484"N	104°55'46.599"W	0.00	
10413.00†	89.386	179.025	7636.32	2823.38	-2809.93	290.42	40°02'07.496"N	104°55'46.577"W	0.00	
10513.00†	89.386	179.025	7637.39	2923.23	-2909.91	292.12	40°02'06.508"N	104°55'46.555"W	0.00	
10613.00†	89.386	179.025	7638.46	3023.08	-3009.89	293.83	40°02'05.520"N	104°55'46.534"W	0.00	
10713.00†	89.386	179.025	7639.53	3122.94	-3109.87	295.53	40°02'04.531"N	104°55'46.512"W	0.00	
10813.00†	89.386	179.025	7640.60	3222.79	-3209.85	297.23	40°02'03.543"N	104°55'46.490"W	0.00	
10913.00†	89.386	179.025	7641.67	3322.64	-3309.83	298.93	40°02'02.555"N	104°55'46.468"W	0.00	
11013.00†	89.386	179.025	7642.74	3422.50	-3409.81	300.63	40°02'01.567"N	104°55'46.446"W	0.00	
11113.00†	89.386	179.025	7643.82	3522.35	-3509.79	302.33	40°02'00.579"N	104°55'46.424"W	0.00	
11213.00†	89.386	179.025	7644.89	3622.20	-3609.77	304.04	40°01'59.591"N	104°55'46.402"W	0.00	
11313.00†	89.386	179.025	7645.96	3722.05	-3709.75	305.74	40°01'58.603"N	104°55'46.381"W	0.00	
11413.00†	89.386	179.025	7647.03	3821.91	-3809.73	307.44	40°01'57.615"N	104°55'46.359"W	0.00	
11513.00†	89.386	179.025	7648.10	3921.76	-3909.71	309.14	40°01'56.627"N	104°55'46.337"W	0.00	
11613.00†	89.386	179.025	7649.17	4021.61	-4009.69	310.84	40°01'55.639"N	104°55'46.315"W	0.00	
11713.00†	89.386	179.025	7650.24	4121.47	-4109.67	312.54	40°01'54.651"N	104°55'46.293"W	0.00	
11813.00†	89.386	179.025	7651.31	4221.32	-4209.65	314.25	40°01'53.663"N	104°55'46.271"W	0.00	
11913.00†	89.386	179.025	7652.39	4321.17	-4309.63	315.95	40°01'52.675"N	104°55'46.249"W	0.00	
12013.00†	89.386	179.025	7653.46	4421.03	-4409.61	317.65	40°01'51.687"N	104°55'46.227"W	0.00	
12113.00†	89.386	179.025	7654.53	4520.88	-4509.59	319.35	40°01'50.699"N	104°55'46.206"W	0.00	
12157.04	89.386	179.025	7655.00 ¹	4564.85	-4553.61	320.10	40°01'50.264"N	104°55'46.196"W	0.00	TOTAL DEPTH



Planned Wellpath Report

JELTS 37N-19HZ (PERMIT REV-1) PWP

Page 5 of 6



REFERENCE WELLPATH IDENTIFICATION			
Operator	KERR-MCGEE OIL & GAS ONSHORE LP	Slot	SLOT#23 JELTS 37N-19HZ (275'FNL & 1828'FEL, SEC.19)
Area	COLORADO	Well	JELTS 37N-19HZ
Field	WELD COUNTY (KERR MCGEE)	Wellbore	JELTS 37N-19HZ PWB
Facility	SEC.19-T1N-R67W		

HOLE & CASING SECTIONS - Ref Wellbore: JELTS 37N-19HZ PWB Ref Wellpath: JELTS 37N-19HZ (PERMIT REV-1) PWP									
String/Diameter	Start MD [ft]	End MD [ft]	Interval [ft]	Start TVD [ft]	End TVD [ft]	Start N/S [ft]	Start E/W [ft]	End N/S [ft]	End E/W [ft]
13.5in Open Hole	13.00	900.00	887.00	13.00	900.00	0.00	0.00	0.00	0.00
9.625in Casing Surface	13.00	900.00	887.00	13.00	900.00	0.00	0.00	0.00	0.00
8.75in Open Hole	900.00	7956.39	7056.39	900.00	7610.00	0.00	0.00	-353.82	248.62
7in Casing Intermediate	13.00	7956.39	7943.39	13.00	7610.00	0.00	0.00	-353.82	248.62
6.125in Open Hole	7956.39	12157.04	4200.65	7610.00	7655.00	-353.82	248.62	-4553.61	320.10
4.5in Casing Production	13.00	12157.04	12144.04	13.00	7655.00	0.00	0.00	-4553.61	320.10

TARGETS									
Name	MD [ft]	TVD [ft]	North [ft]	East [ft]	Grid East [US ft]	Grid North [US ft]	Latitude	Longitude	Shape
SECTION 19 LINES		27.00	-37.76	-2112.27	3157293.83	1259018.03	40°02'34.890"N	104°56'17.470"W	polygon
1) JELTS 37N-19HZ BHL ON PLAT REV-1 (460'FSL & 1590'FEL, SEC.19)	12157.04	7655.00	-4553.61	320.10	3159755.05	1254518.05	40°01'50.264"N	104°55'46.196"W	point
SEC. 19 HARDLINES (460' SETBACKS)		8027.00	-37.76	-2112.27	3157293.83	1259018.03	40°02'34.890"N	104°56'17.470"W	polygon

SURVEY PROGRAM - Ref Wellbore: JELTS 37N-19HZ PWB Ref Wellpath: JELTS 37N-19HZ (PERMIT REV-1) PWP				
Start MD [ft]	End MD [ft]	Positional Uncertainty Model	Log Name/Comment	Wellbore
13.00	7956.39	NaviTrak (Standard)		JELTS 37N-19HZ PWB
7956.39	12157.04	OnTrak (Standard)		JELTS 37N-19HZ PWB



Planned Wellpath Report

JELTS 37N-19HZ (PERMIT REV-1) PWP

Page 6 of 6



REFERENCE WELLPATH IDENTIFICATION			
Operator	KERR-MCGEE OIL & GAS ONSHORE LP	Slot	SLOT#23 JELTS 37N-19HZ (275'FNL & 1828'FEL, SEC.19)
Area	COLORADO	Well	JELTS 37N-19HZ
Field	WELD COUNTY (KERR MCGEE)	Wellbore	JELTS 37N-19HZ PWB
Facility	SEC.19-T1N-R67W		

WELLPATH COMMENTS				
MD [ft]	Inclination [°]	Azimuth [°]	TVD [ft]	Comment
4935.46	0.000	179.025	4910.00	SUSSEX
7541.24	47.871	179.025	7462.00	SHARON SPRINGS