

FRAM OPERATING, LLC

CUT SHEET - HAMILTON 33-3-A

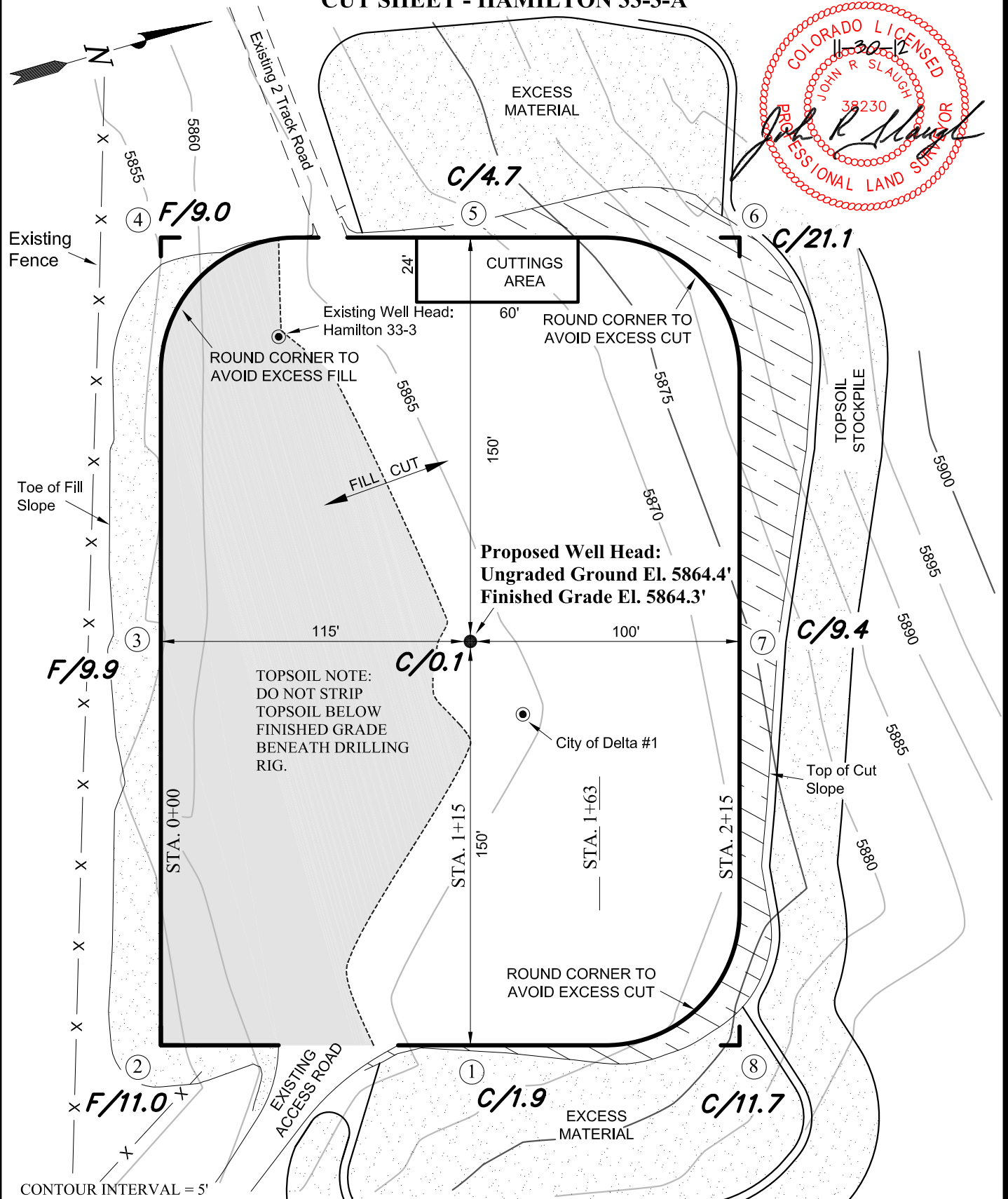

Section 33, T13S, R95W, 6th P.M.		Qtr/Qtr Location: LOT 4 (Surface)		Footage Location: 382' FNL & 484' FWL (Surface)	
Date Surveyed: 10-24-12	Date Drawn: 11-14-12	Date Last Revision:	TIMBERLINE ENGINEERING & LAND SURVEYING, INC. 209 NORTH 300 WEST - VERNAL, UTAH 84078 (435) 789-1365	SHEET 7 OF 18	
Surveyed By: A.F.	Drawn By: M.W.W.	Scale: 1" = 50'			

FRAM OPERATING, LLC

CROSS SECTION - HAMILTON 33-3-A

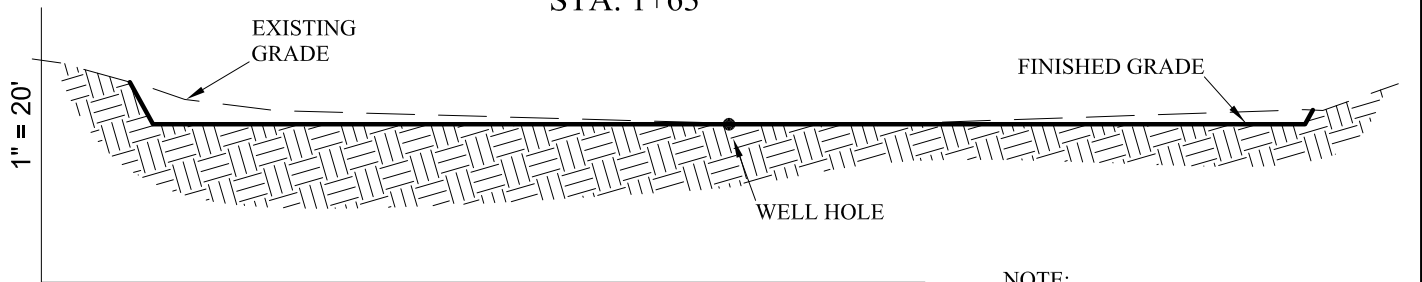
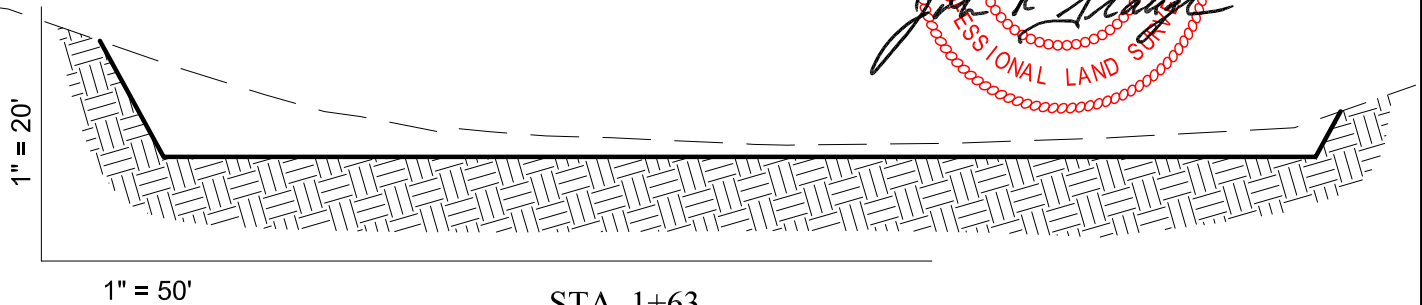
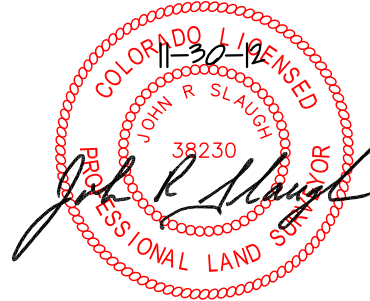
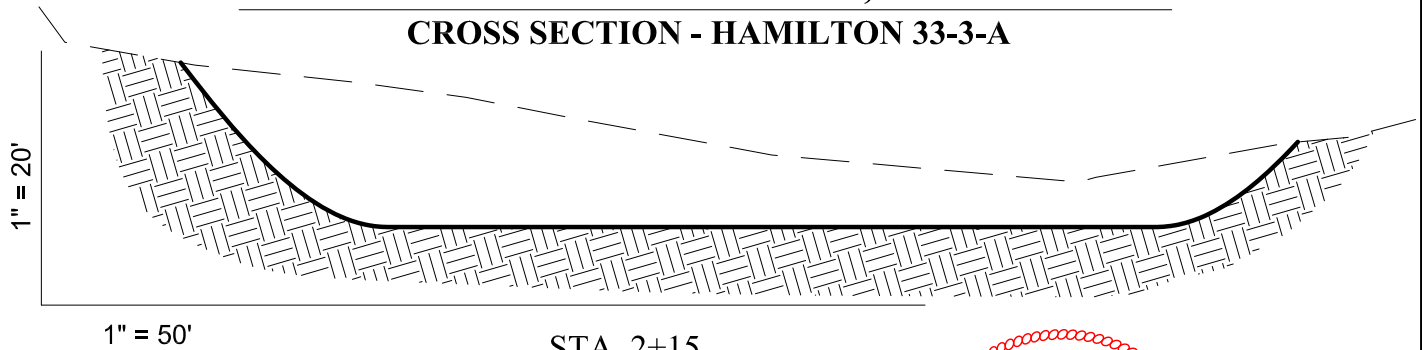

NOTE:
UNLESS OTHERWISE NOTED
CUT SLOPES ARE AT 1:1 FILL
SLOPES ARE AT 1.5:1

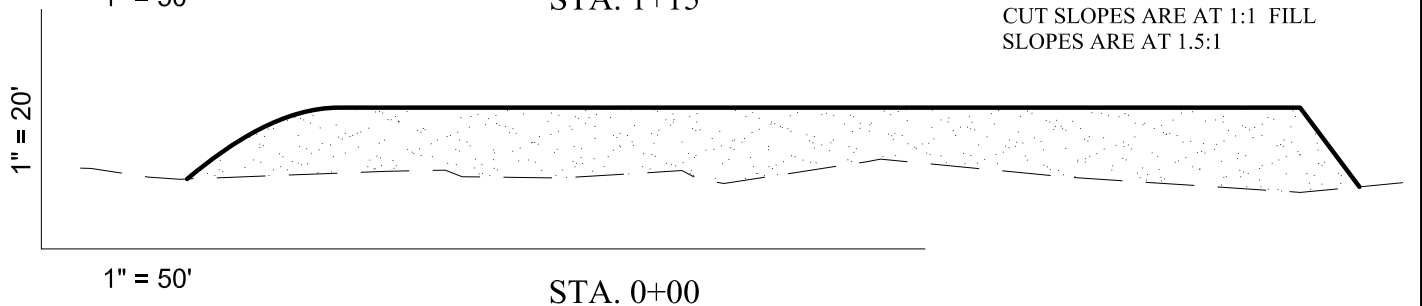

REFERENCE POINTS

150' NORTHERLY = 5886.2'
200' NORTHERLY = 5899.4'
200' WESTERLY = 5874.2'
250' WESTERLY = 5878.9'

ESTIMATED EARTHWORK QUANTITIES

(No shrink or swell adjustments have been used)
(Expressed in Cubic Yards)

CUT: 6" Topsoil Stripping = 1,420	Excess Material = 3,800
Remaining Location = 5,860	Topsoil = 1,420
TOTAL CUT = 7,280	Excess Unbalance = 2,380
FILL = 3,480	(Without Topsoil)

Section 33, T13S, R95W, 6th P.M.		Qtr/Qtr Location: LOT 4 (Surface)	Footage Location: 382' FNL & 484' FWL (Surface)
Date Surveyed: 10-24-12	Date Drawn: 11-14-12	Date Last Revision:	TIMBERLINE (435) 789-1365
Surveyed By: A.F.	Drawn By: M.W.W.	Scale: 1" = 50'	ENGINEERING & LAND SURVEYING, INC. 209 NORTH 300 WEST - VERNAL, UTAH 84078
			SHEET 8 OF 18