

Legend

- South Middle Fork WTF Phase 1

Encana Oil & Gas (USA) Inc.

South Middle Fork WTF Phase 1 - Access Route
 LOT 3 of SECTION 34, T6S, R96W, 6th, P.M.
 GARFIELD COUNTY, COLORADO

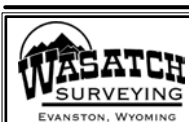

Wasatch Surveying Associates
 906 Main Street Evanston, Wyoming 82930
 Phone No. (307) 789-4545 Fax (307) 789-5722



TOPO A

PROJECT No. 11-04-116

DATE: 4/18/2013

SCALE: 1:100,000

REV.

0

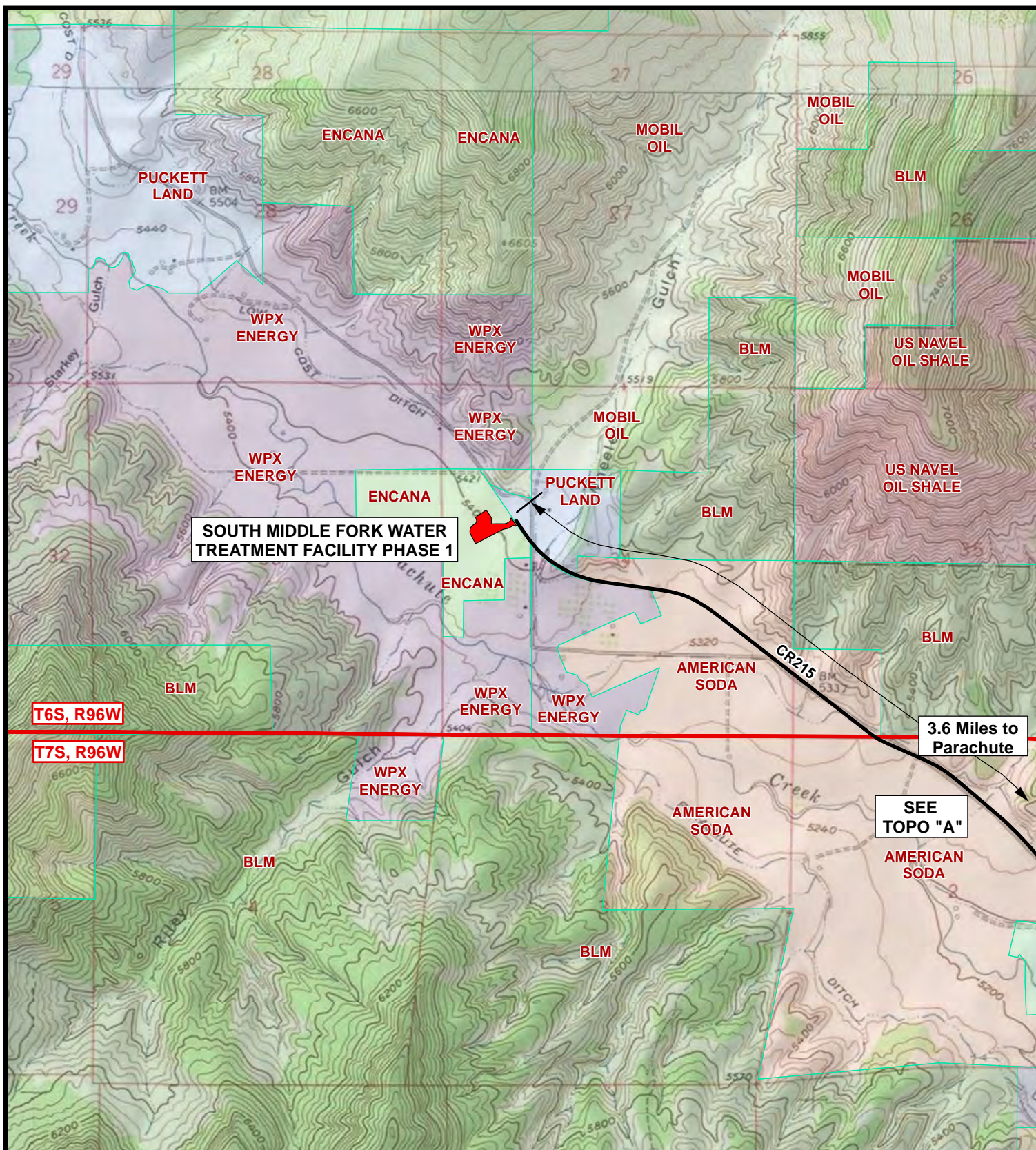

Legend

- EXISTING ROAD
- South Middle Fork WTF Phase 1

Encana Oil & Gas (USA) Inc.

South Middle Fork WTF Phase 1 - Access Route
LOT 3 of SECTION 34, T6S, R96W, 6th, P.M.
GARFIELD COUNTY, COLORADO

TOPO B

PROJECT No. 11-04-116

DATE: 4/18/2013

SCALE: 1 inch = 2,000 feet

REV.

0



Wasatch Surveying Associates

906 Main Street Evanston, Wyoming 82930
 Phone No. (307) 789-4545 Fax (307) 789-5722

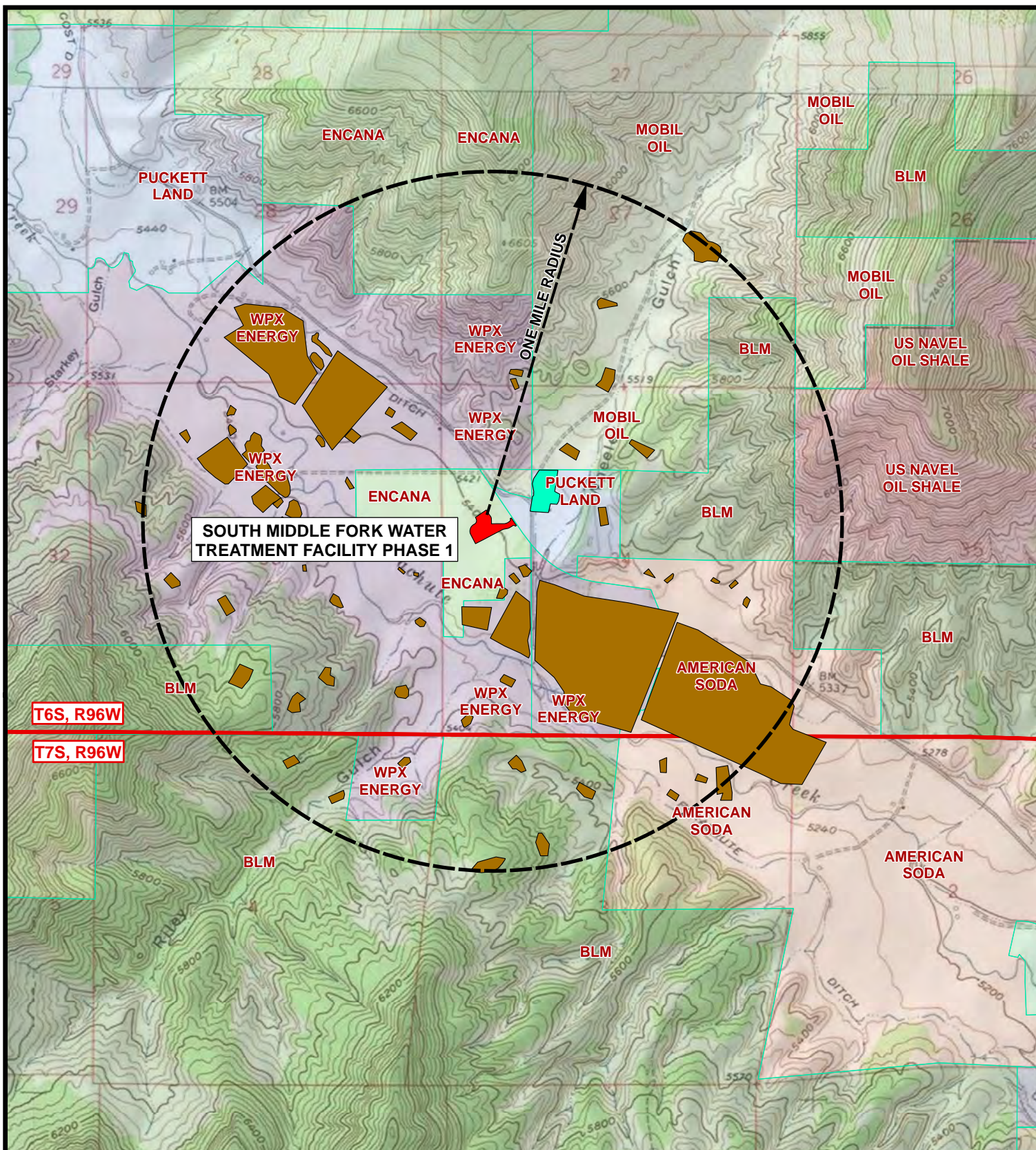

Legend

- South Middle Fork WTF Phase 1
- Existing Homestead
- Existing Locations & Well Pads

Encana Oil & Gas (USA) Inc.

South Middle Fork WTF Phase 1
 LOT 3 of SECTION 34, T6S, R96W, 6th, P.M.
 GARFIELD COUNTY, COLORADO

TOPO C

PROJECT No. 11-04-116

DATE: 4/18/2013

SCALE: 1 inch = 2,000 feet

REV.

0



Wasatch Surveying Associates
 906 Main Street Evanston, Wyoming 82930
 Phone No. (307) 789-4545 Fax (307) 789-5722

