



Physical Address: 345 Comanche St.
Mail to: Box 384, Kiowa, CO 80117
Ph. 303-621-8672 - Fax 303-621-7749
www.highprairiesurvey.com

Reference Area Map Enchanted Forest 12-53-19-6

High Prairie Surveying of Kiowa, Colorado in accordance with a request from **Pine Ridge Oil & Gas, LLC** has determined the location of **Enchanted Forest 12-53-19-6** to be **1911 feet FNL**, and **2484 feet FWL**, (90° off Section lines) of SECTION **19**, Township **12s**, Range **53w** of the 6th Principal Meridian, **Lincoln County**, Colorado.

Date: Staked on 04/04/13 drawn on 04/15/13.

Re: Staked by Elijah Frane
Drawn: Drawn by Dustin Cotter

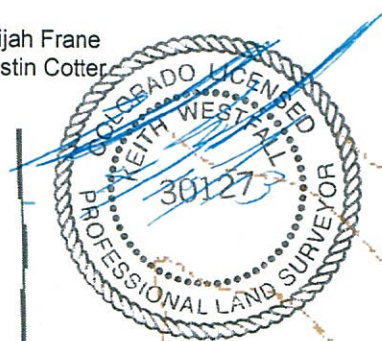

Pine Ridge Oil & Gas, LLC
NW 1/4 SEC. 19-12S-53W
Enchanted Forest 12-53-19-6
LINCOLN, Co. COLORADO

REFERENCE AREA
LAT 38.98946 (decimal degrees)
LONG 103.37515 (decimal degrees)

19 19

