

DALEY LAND SURVEYING, INC.

PARKER, CO. 80134

303 953 9841

## EXISTING CONTOURS LL JOHNSTON 1

SECTION 29, TOWNSHIP 17 SOUTH, RANGE 54 WEST OF THE 6TH PRINCIPAL MERIDIAN

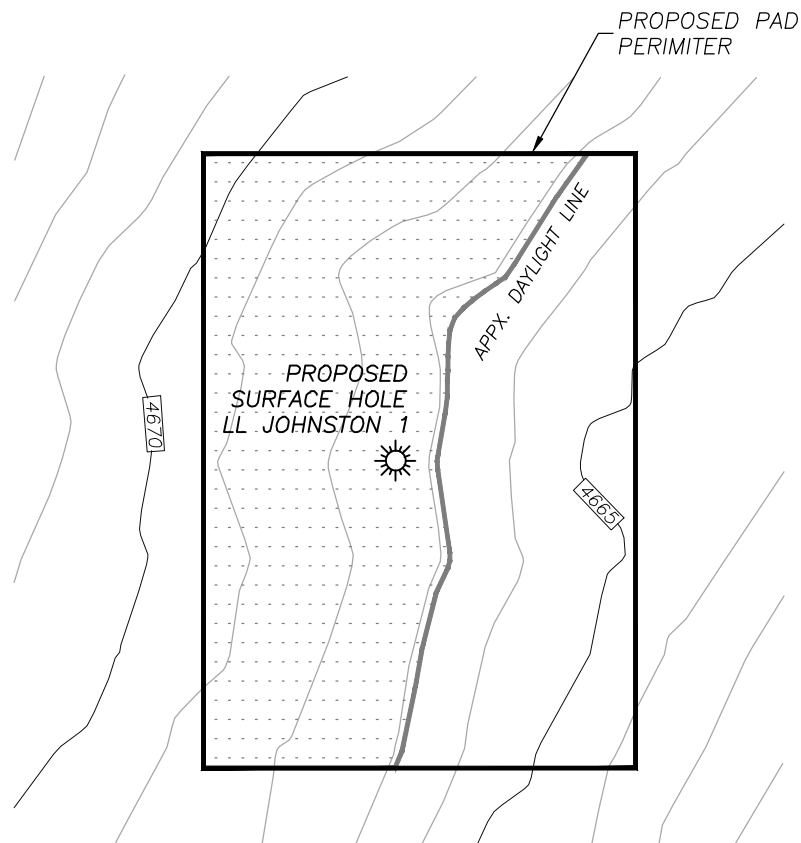

CONTOUR INTERVAL = 1'

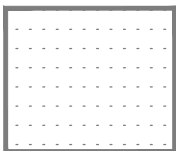

AREA OF  
PROPOSED CUT

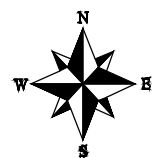

0 100  
SCALE: 1" = 100'

## PROPOSED PAD CONTOURS

### LL JOHNSTON 1

SECTION 29, TOWNSHIP 17 SOUTH, RANGE 54 WEST OF THE 6TH PRINCIPAL MERIDIAN

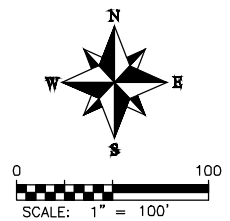
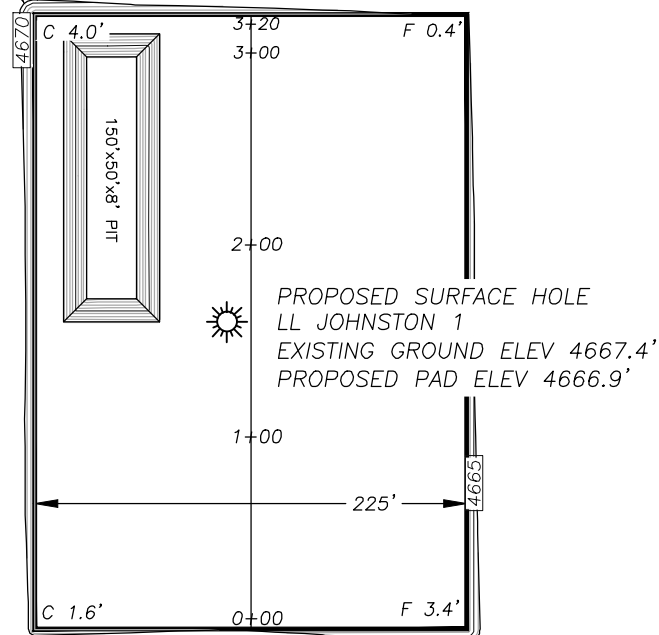
PROPOSED  
GRADING LIMITS

CONTOUR INTERVAL = 1'

LL JOHNSTON 1

Top of pad elevation: 4666.9'  
 Cut slope ratio: 2.0  
 Fill slope ratio: 2.0  
 Cut Swell Factor: 1.00  
 Fill Shrink Factor: 1.00

Pad Earthwork Volumes

Total cut: 2190 C.Y.  
 Total fill: 1310 C.Y.  
 Balance Export: 880 C.Y. (4" Topsoil)  
 Area: 1.8 Acres

Estimated Pit Volume

Assumed side slopes of 1.5:1  
 Volume: 1571 C.Y. including  
 Topsoil

## PROPOSED PAD CROSS SECTIONS LL JOHNSTON 1

SECTION 29, TOWNSHIP 17 SOUTH, RANGE 54 WEST OF THE 6TH PRINCIPAL MERIDIAN

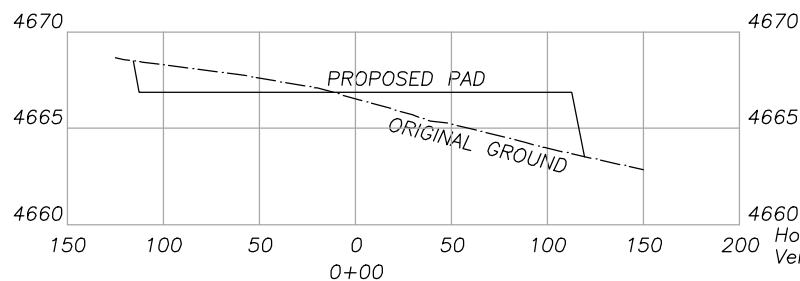
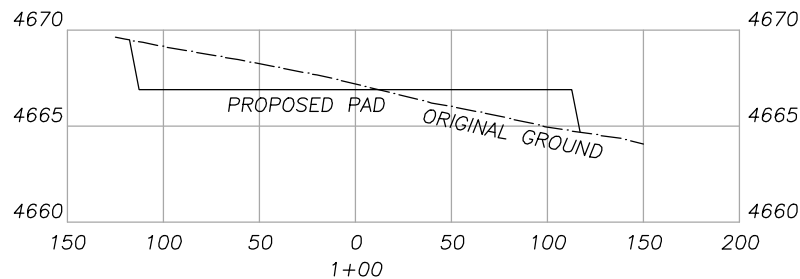
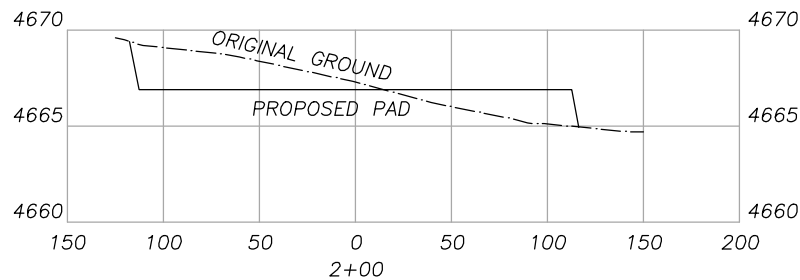
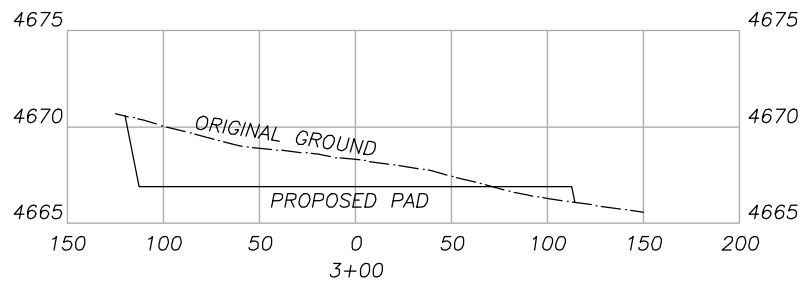
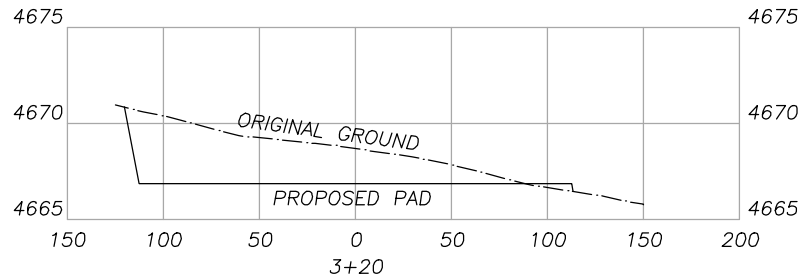

Horizontal Scale 50  
Vertical Scale 5

## PROPOSED RIG LAYOUT LL JOHNSTON 1

SECTION 29, TOWNSHIP 17 SOUTH, RANGE 54 WEST OF THE 6TH PRINCIPAL MERIDIAN

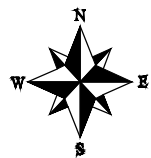
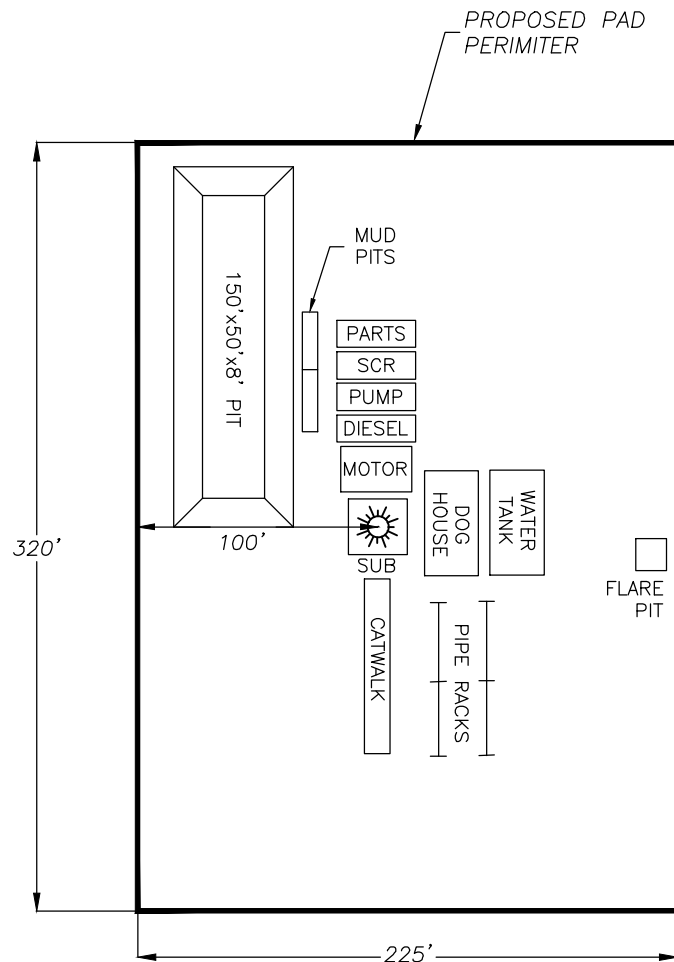

0 80  
SCALE: 1" = 80'

# PROPOSED PRODUCTION FACILITY LL JOHNSTON 1

SECTION 29, TOWNSHIP 17 SOUTH, RANGE 54 WEST OF THE 6TH PRINCIPAL MERIDIAN

