

DALEY LAND SURVEYING, INC.

PARKER, CO. 80134

303 953 9841



## ACCESS ROAD MAP CC KARVAL 1

SECTION 23, TOWNSHIP 17 SOUTH, RANGE 53 WEST OF THE 6TH PRINCIPAL MERIDIAN

Map to Accompany  
OIL AND GAS LOCATION ASSESSMENT  
Access Road Map

Aurora Power Resources, Inc.  
**CC Karval 1**  
1,980' FNL 1,980' FEL (SW/4 NE/4)  
Sec. 23 T17S R53W  
Lincoln County, Colorado  
Surface: Fee  
Mineral Lease: Fee

### LEGEND

-  New Construction (Fee) – On Lease
-  New Construction (Fee) – Off Lease
-  County Roads

Revised by Upstream Petroleum Management, Inc.

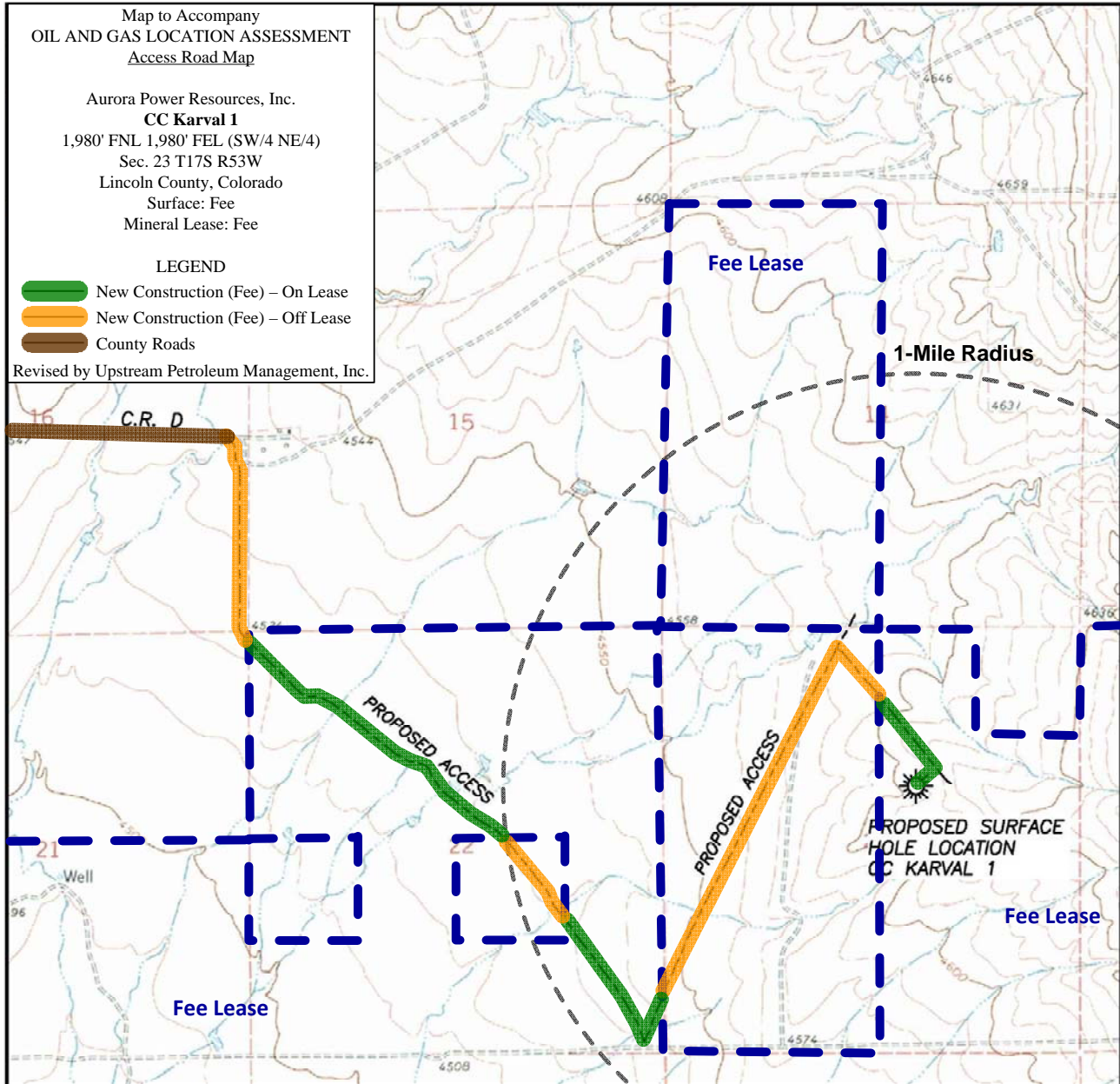

0 2000  
SCALE: 1" = 2000'

DALEY LAND SURVEYING, INC. PARKER, CO. 80134 303 953 9841

## ACCESS ROAD MAP CC KARVAL 1

SECTION 23, TOWNSHIP 17 SOUTH, RANGE 53 WEST OF THE 6TH PRINCIPAL MERIDIAN

