

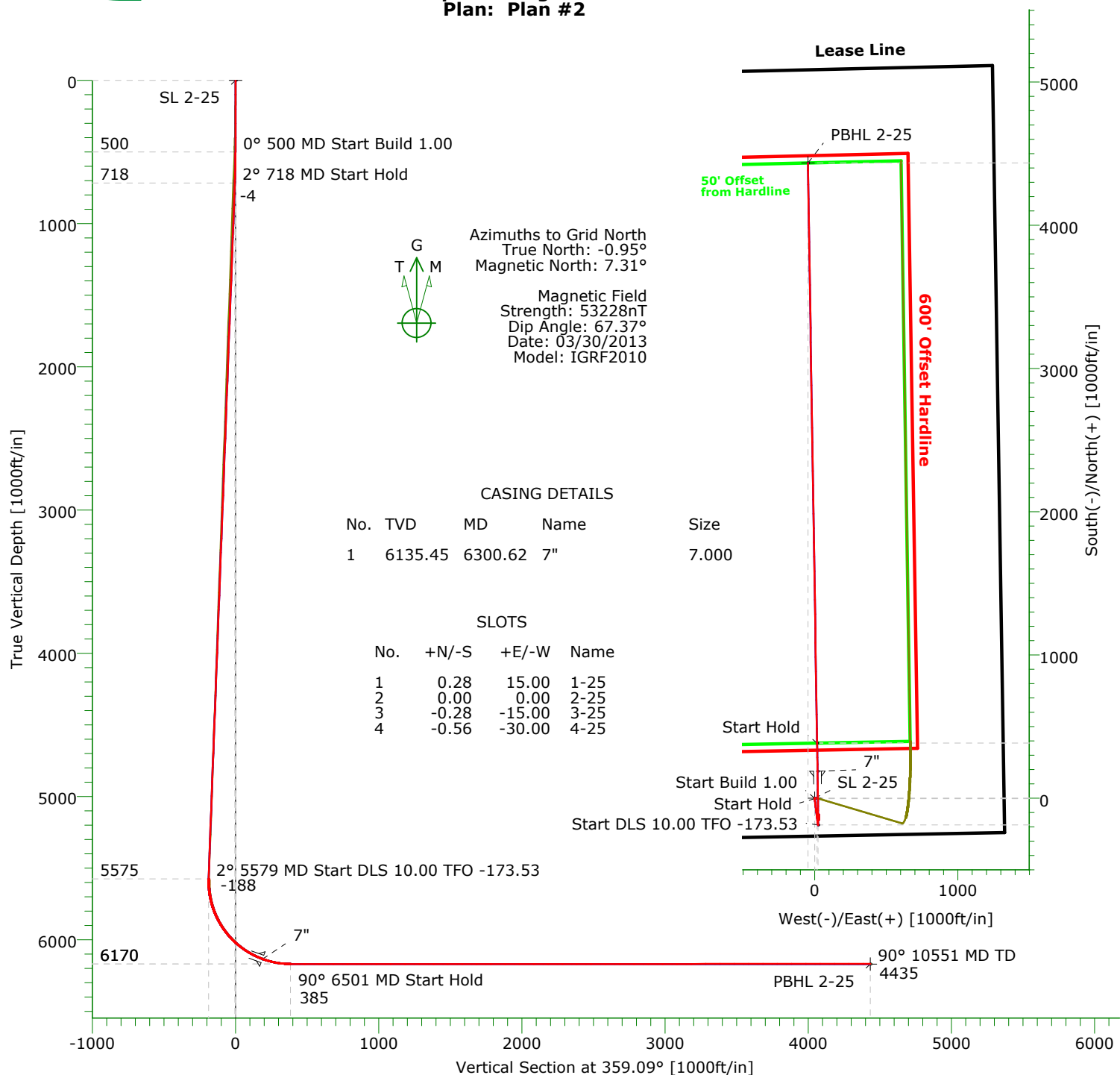

CARRIZO OIL & GAS, INC.

Field: Niobrara CONZ'83
Site: Shull 1-25-9-60 Pad
Well: 2-25-9-60
Wellpath: Original Hole
Plan: Plan #2



CASING DETAILS

No.	TVD	MD	Name	Size
1	6135.45	6300.62	7"	7.000

SLOTS

No.	+N/-S	+E/-W	Name
1	0.28	15.00	1-25
2	0.00	0.00	2-25
3	-0.28	-15.00	3-25
4	-0.56	-30.00	4-25

TARGET DETAILS

Name	TVD	+N/-S	+E/-W	Northing	Easting	Latitude	Longitude	Shape
SL 2-25	0.00	0.00	0.00	1506559.42	3406074.43	40°42'52.852N	104°02'06.488W	Point
PBHL 2-25	6170.00	4434.77	-46.29	1510994.19	3406028.14	40°43'36.675N	104°02'06.138W	Point

SECTION DETAILS

Sec	MD	Inc	Azi	TVD	+N/-S	+E/-W	DLeg	TFace	VSec	Target
1	0.00	0.00	0.00	0.00	0.00	0.00	0.00	0.00	0.00	
2	500.00	0.00	0.00	500.00	0.00	0.00	0.00	0.00	0.00	
3	717.93	2.18	172.62	717.87	-4.11	0.53	1.00	0.00	-4.12	
4	5578.97	2.18	172.62	5575.40	-187.43	24.27	0.00	0.00	-187.79	
5	6500.62	90.00	359.09	6170.00	385.09	17.72	10.00	-173.53	384.76	
6	10550.81	90.00	359.09	6170.00	4434.77	-46.60	0.00	0.00	4434.95	PBHL 2-25

Precision Directional Services, Inc.

Planning Report

Company: CARRIZO OIL & GAS, INC. Field: Niobrara CONZ'83 Site: Shull 1-25-9-60 Pad Well: 2-25-9-60 Wellpath: Original Hole	Date: 02/13/2013 Co-ordinate(NE) Reference: Well: 2-25-9-60, Grid North Vertical (TVD) Reference: 4943'GL+17'KB 4960.0 Section (VS) Reference: Well (0.00N,0.00E,359.09Azi) Plan: Plan #2	Time: 11:00:11 Page: 1
---	--	---

Field: Niobrara CONZ'83 Map System: US State Plane Coordinate System 1983 Geo Datum: GRS 1980 Sys Datum: Mean Sea Level	Map Zone: Colorado, Northern Zone Coordinate System: Well Centre Geomagnetic Model: IGRF2010
--	---

Site: Shull 1-25-9-60 Pad Weld County, CO Site Position: From: Map Position Uncertainty: 0.00 ft Ground Level: 4943.00 ft	Northing: 1511404.05 ft Easting: 3406027.06 ft Latitude: 40 43 40.724 N Longitude: 104 2 6.064 W North Reference: Grid Grid Convergence: 0.95 deg
---	--

Well: 2-25-9-60 centered on 1-25 265FSL 1324FEL Well Position: +N/-S -4844.63 ft +E/-W 47.37 ft Position Uncertainty: 0.00 ft	Slot Name: 2-25 Latitude: 40 42 52.852 N Longitude: 104 2 6.488 W
--	--

Wellpath: Original Hole Current Datum: 4943'GL+17'KB Magnetic Data: 03/30/2013 Field Strength: 53228 nT Vertical Section: Depth From (TVD) ft	Height 4960.00 ft	Drilled From: Surface Tie-on Depth: 0.00 ft Above System Datum: Mean Sea Level Declination: 8.25 deg Mag Dip Angle: 67.37 deg +E/-W ft Direction deg
0.00	0.00	0.00 359.09

Plan: Plan #2 updated SL Principal: Yes	Date Composed: 02/13/2013 Version: 1 Tied-to: From Surface
---	---

Plan Section Information										
MD ft	Incl deg	Azim deg	TVD ft	+N/-S ft	+E/-W ft	DLS deg/100ft	Build deg/100ft	Turn deg/100ft	TFO deg	Target
0.00	0.00	0.00	0.00	0.00	0.00	0.00	0.00	0.00	0.00	
500.00	0.00	0.00	500.00	0.00	0.00	0.00	0.00	0.00	0.00	
717.93	2.18	172.62	717.87	-4.11	0.53	1.00	1.00	0.00	0.00	
5578.97	2.18	172.62	5575.40	-187.43	24.27	0.00	0.00	0.00	0.00	
6500.62	90.00	359.09	6170.00	385.09	17.72	10.00	9.53	-18.83	-173.53	
10550.81	90.00	359.09	6170.00	4434.77	-46.60	0.00	0.00	0.00	0.00	PBHL 2-25

Survey										
MD ft	Incl deg	Azim deg	TVD ft	+N/-S ft	+E/-W ft	VS ft	DLS deg/100ft	Build deg/100ft	Turn deg/100ft	Tool/Comment
0.00	0.00	0.00	0.00	0.00	0.00	0.00	0.00	0.00	0.00	
100.00	0.00	0.00	100.00	0.00	0.00	0.00	0.00	0.00	0.00	MWD
200.00	0.00	0.00	200.00	0.00	0.00	0.00	0.00	0.00	0.00	MWD
300.00	0.00	0.00	300.00	0.00	0.00	0.00	0.00	0.00	0.00	MWD
400.00	0.00	0.00	400.00	0.00	0.00	0.00	0.00	0.00	0.00	MWD
500.00	0.00	0.00	500.00	0.00	0.00	0.00	0.00	0.00	0.00	MWD
600.00	1.00	172.62	599.99	-0.87	0.11	-0.87	1.00	1.00	0.00	MWD
700.00	2.00	172.62	699.96	-3.46	0.45	-3.47	1.00	1.00	0.00	MWD
717.93	2.18	172.62	717.87	-4.11	0.53	-4.12	1.00	1.00	0.00	MWD
800.00	2.18	172.62	799.89	-7.20	0.93	-7.22	0.00	0.00	0.00	MWD
900.00	2.18	172.62	899.82	-10.98	1.42	-11.00	0.00	0.00	0.00	MWD
1000.00	2.18	172.62	999.74	-14.75	1.91	-14.78	0.00	0.00	0.00	MWD
1100.00	2.18	172.62	1099.67	-18.52	2.40	-18.55	0.00	0.00	0.00	MWD
1200.00	2.18	172.62	1199.60	-22.29	2.89	-22.33	0.00	0.00	0.00	MWD
1300.00	2.18	172.62	1299.53	-26.06	3.37	-26.11	0.00	0.00	0.00	MWD

Precision Directional Services, Inc.

Planning Report

Company: CARRIZO OIL & GAS, INC.
Field: Niobrara CONZ'83
Site: Shull 1-25-9-60 Pad
Well: 2-25-9-60
Wellpath: Original Hole

Date: 02/13/2013
Co-ordinate(NE) Reference: Well: 2-25-9-60, Grid North
Vertical (TVD) Reference: 4943'GL+17'KB 4960.0
Section (VS) Reference: Well (0.00N,0.00E,359.09Azi)
Plan: Plan #2

Page: 2

Survey

MD ft	Incl deg	Azim deg	TVD ft	+N/-S ft	+E/-W ft	VS ft	DLS deg/100ft	Build deg/100ft	Turn deg/100ft	Tool/Comment
1400.00	2.18	172.62	1399.45	-29.83	3.86	-29.89	0.00	0.00	0.00	MWD
1500.00	2.18	172.62	1499.38	-33.60	4.35	-33.67	0.00	0.00	0.00	MWD
1600.00	2.18	172.62	1599.31	-37.37	4.84	-37.45	0.00	0.00	0.00	MWD
1700.00	2.18	172.62	1699.24	-41.15	5.33	-41.22	0.00	0.00	0.00	MWD
1800.00	2.18	172.62	1799.16	-44.92	5.82	-45.00	0.00	0.00	0.00	MWD
1900.00	2.18	172.62	1899.09	-48.69	6.30	-48.78	0.00	0.00	0.00	MWD
2000.00	2.18	172.62	1999.02	-52.46	6.79	-52.56	0.00	0.00	0.00	MWD
2100.00	2.18	172.62	2098.95	-56.23	7.28	-56.34	0.00	0.00	0.00	MWD
2200.00	2.18	172.62	2198.88	-60.00	7.77	-60.12	0.00	0.00	0.00	MWD
2300.00	2.18	172.62	2298.80	-63.77	8.26	-63.90	0.00	0.00	0.00	MWD
2400.00	2.18	172.62	2398.73	-67.54	8.74	-67.67	0.00	0.00	0.00	MWD
2500.00	2.18	172.62	2498.66	-71.31	9.23	-71.45	0.00	0.00	0.00	MWD
2600.00	2.18	172.62	2598.59	-75.09	9.72	-75.23	0.00	0.00	0.00	MWD
2700.00	2.18	172.62	2698.51	-78.86	10.21	-79.01	0.00	0.00	0.00	MWD
2800.00	2.18	172.62	2798.44	-82.63	10.70	-82.79	0.00	0.00	0.00	MWD
2900.00	2.18	172.62	2898.37	-86.40	11.19	-86.57	0.00	0.00	0.00	MWD
3000.00	2.18	172.62	2998.30	-90.17	11.67	-90.34	0.00	0.00	0.00	MWD
3100.00	2.18	172.62	3098.22	-93.94	12.16	-94.12	0.00	0.00	0.00	MWD
3200.00	2.18	172.62	3198.15	-97.71	12.65	-97.90	0.00	0.00	0.00	MWD
3300.00	2.18	172.62	3298.08	-101.48	13.14	-101.68	0.00	0.00	0.00	MWD
3400.00	2.18	172.62	3398.01	-105.25	13.63	-105.46	0.00	0.00	0.00	MWD
3500.00	2.18	172.62	3497.94	-109.03	14.11	-109.24	0.00	0.00	0.00	MWD
3600.00	2.18	172.62	3597.86	-112.80	14.60	-113.01	0.00	0.00	0.00	MWD
3700.00	2.18	172.62	3697.79	-116.57	15.09	-116.79	0.00	0.00	0.00	MWD
3800.00	2.18	172.62	3797.72	-120.34	15.58	-120.57	0.00	0.00	0.00	MWD
3900.00	2.18	172.62	3897.65	-124.11	16.07	-124.35	0.00	0.00	0.00	MWD
4000.00	2.18	172.62	3997.57	-127.88	16.56	-128.13	0.00	0.00	0.00	MWD
4100.00	2.18	172.62	4097.50	-131.65	17.04	-131.91	0.00	0.00	0.00	MWD
4200.00	2.18	172.62	4197.43	-135.42	17.53	-135.69	0.00	0.00	0.00	MWD
4300.00	2.18	172.62	4297.36	-139.20	18.02	-139.46	0.00	0.00	0.00	MWD
4400.00	2.18	172.62	4397.28	-142.97	18.51	-143.24	0.00	0.00	0.00	MWD
4500.00	2.18	172.62	4497.21	-146.74	19.00	-147.02	0.00	0.00	0.00	MWD
4600.00	2.18	172.62	4597.14	-150.51	19.49	-150.80	0.00	0.00	0.00	MWD
4700.00	2.18	172.62	4697.07	-154.28	19.97	-154.58	0.00	0.00	0.00	MWD
4800.00	2.18	172.62	4797.00	-158.05	20.46	-158.36	0.00	0.00	0.00	MWD
4900.00	2.18	172.62	4896.92	-161.82	20.95	-162.13	0.00	0.00	0.00	MWD
5000.00	2.18	172.62	4996.85	-165.59	21.44	-165.91	0.00	0.00	0.00	MWD
5100.00	2.18	172.62	5096.78	-169.36	21.93	-169.69	0.00	0.00	0.00	MWD
5200.00	2.18	172.62	5196.71	-173.14	22.41	-173.47	0.00	0.00	0.00	MWD
5300.00	2.18	172.62	5296.63	-176.91	22.90	-177.25	0.00	0.00	0.00	MWD
5400.00	2.18	172.62	5396.56	-180.68	23.39	-181.03	0.00	0.00	0.00	MWD
5500.00	2.18	172.62	5496.49	-184.45	23.88	-184.80	0.00	0.00	0.00	MWD
5578.97	2.18	172.62	5575.40	-187.43	24.27	-187.79	0.00	0.00	0.00	MWD
5600.00	0.25	103.29	5596.43	-187.83	24.36	-188.20	10.00	-9.16	-329.66	MWD
5700.00	9.94	0.49	5695.93	-179.23	24.65	-179.60	10.00	9.69	-102.79	MWD
5800.00	19.94	359.77	5792.42	-153.48	24.66	-153.86	10.00	10.00	-0.72	MWD
5900.00	29.94	359.52	5882.99	-111.37	24.38	-111.75	10.00	10.00	-0.25	MWD
6000.00	39.94	359.38	5964.86	-54.18	23.82	-54.55	10.00	10.00	-0.13	MWD
6100.00	49.94	359.30	6035.56	16.36	23.00	15.99	10.00	10.00	-0.09	MWD
6200.00	59.94	359.23	6092.93	98.10	21.95	97.74	10.00	10.00	-0.06	MWD
6300.00	69.94	359.18	6135.23	188.57	20.69	188.21	10.00	10.00	-0.05	MWD
6300.62	70.00	359.18	6135.45	189.15	20.68	188.80	10.00	10.00	-0.05	7"
6400.00	79.94	359.13	6161.19	285.00	19.27	284.66	10.00	10.00	-0.05	MWD
6500.00	89.94	359.09	6170.00	384.47	17.73	384.14	10.00	10.00	-0.04	MWD

Precision Directional Services, Inc.

Planning Report

Company: CARRIZO OIL & GAS, INC.
Field: Niobrara CONZ'83
Site: Shull 1-25-9-60 Pad
Well: 2-25-9-60
Wellpath: Original Hole

Date: 02/13/2013
Co-ordinate(NE) Reference: Well: 2-25-9-60, Grid North
Vertical (TVD) Reference: 4943'GL+17'KB 4960.0
Section (VS) Reference: Well (0.00N,0.00E,359.09Azi)
Plan: Plan #2

Page: 3

Survey

MD ft	Incl deg	Azim deg	TVD ft	+N/-S ft	+E/-W ft	VS ft	DLS deg/100ft	Build deg/100ft	Turn deg/100ft	Tool/Comment
6600.00	90.00	359.09	6170.00	484.46	16.14	484.14	0.06	0.06	0.00	MWD
6700.00	90.00	359.09	6170.00	584.44	14.55	584.14	0.00	0.00	0.00	MWD
6800.00	90.00	359.09	6170.00	684.43	12.97	684.14	0.00	0.00	0.00	MWD
6900.00	90.00	359.09	6170.00	784.42	11.38	784.14	0.00	0.00	0.00	MWD
7000.00	90.00	359.09	6170.00	884.41	9.79	884.14	0.00	0.00	0.00	MWD
7100.00	90.00	359.09	6170.00	984.39	8.20	984.14	0.00	0.00	0.00	MWD
7200.00	90.00	359.09	6170.00	1084.38	6.61	1084.14	0.00	0.00	0.00	MWD
7300.00	90.00	359.09	6170.00	1184.37	5.02	1184.14	0.00	0.00	0.00	MWD
7400.00	90.00	359.09	6170.00	1284.36	3.44	1284.14	0.00	0.00	0.00	MWD
7500.00	90.00	359.09	6170.00	1384.34	1.85	1384.14	0.00	0.00	0.00	MWD
7600.00	90.00	359.09	6170.00	1484.33	0.26	1484.14	0.00	0.00	0.00	MWD
7700.00	90.00	359.09	6170.00	1584.32	-1.33	1584.14	0.00	0.00	0.00	MWD
7800.00	90.00	359.09	6170.00	1684.30	-2.92	1684.14	0.00	0.00	0.00	MWD
7900.00	90.00	359.09	6170.00	1784.29	-4.50	1784.14	0.00	0.00	0.00	MWD
8000.00	90.00	359.09	6170.00	1884.28	-6.09	1884.14	0.00	0.00	0.00	MWD
8100.00	90.00	359.09	6170.00	1984.27	-7.68	1984.14	0.00	0.00	0.00	MWD
8200.00	90.00	359.09	6170.00	2084.25	-9.27	2084.14	0.00	0.00	0.00	MWD
8300.00	90.00	359.09	6170.00	2184.24	-10.86	2184.14	0.00	0.00	0.00	MWD
8400.00	90.00	359.09	6170.00	2284.23	-12.45	2284.14	0.00	0.00	0.00	MWD
8500.00	90.00	359.09	6170.00	2384.22	-14.03	2384.14	0.00	0.00	0.00	MWD
8600.00	90.00	359.09	6170.00	2484.20	-15.62	2484.14	0.00	0.00	0.00	MWD
8700.00	90.00	359.09	6170.00	2584.19	-17.21	2584.14	0.00	0.00	0.00	MWD
8800.00	90.00	359.09	6170.00	2684.18	-18.80	2684.14	0.00	0.00	0.00	MWD
8900.00	90.00	359.09	6170.00	2784.17	-20.39	2784.14	0.00	0.00	0.00	MWD
9000.00	90.00	359.09	6170.00	2884.15	-21.97	2884.14	0.00	0.00	0.00	MWD
9100.00	90.00	359.09	6170.00	2984.14	-23.56	2984.14	0.00	0.00	0.00	MWD
9200.00	90.00	359.09	6170.00	3084.13	-25.15	3084.14	0.00	0.00	0.00	MWD
9300.00	90.00	359.09	6170.00	3184.12	-26.74	3184.14	0.00	0.00	0.00	MWD
9400.00	90.00	359.09	6170.00	3284.10	-28.33	3284.14	0.00	0.00	0.00	MWD
9500.00	90.00	359.09	6170.00	3384.09	-29.92	3384.14	0.00	0.00	0.00	MWD
9600.00	90.00	359.09	6170.00	3484.08	-31.50	3484.14	0.00	0.00	0.00	MWD
9700.00	90.00	359.09	6170.00	3584.07	-33.09	3584.14	0.00	0.00	0.00	MWD
9800.00	90.00	359.09	6170.00	3684.05	-34.68	3684.14	0.00	0.00	0.00	MWD
9900.00	90.00	359.09	6170.00	3784.04	-36.27	3784.14	0.00	0.00	0.00	MWD
10000.00	90.00	359.09	6170.00	3884.03	-37.86	3884.14	0.00	0.00	0.00	MWD
10100.00	90.00	359.09	6170.00	3984.01	-39.44	3984.14	0.00	0.00	0.00	MWD
10200.00	90.00	359.09	6170.00	4084.00	-41.03	4084.14	0.00	0.00	0.00	MWD
10300.00	90.00	359.09	6170.00	4183.99	-42.62	4184.14	0.00	0.00	0.00	MWD
10400.00	90.00	359.09	6170.00	4283.98	-44.21	4284.14	0.00	0.00	0.00	MWD
10500.00	90.00	359.09	6170.00	4383.96	-45.80	4384.14	0.00	0.00	0.00	MWD
10550.81	90.00	359.09	6170.00	4434.77	-46.60	4434.95	0.00	0.00	0.00	PBHL 2-25

Targets

Name	Description Dip.	Dir.	TVD ft	+N/-S ft	+E/-W ft	Map Northing ft	Map Easting ft	<--- Latitude ---> Deg Min Sec			<--- Longitude ---> Deg Min Sec		
SL 2-25			0.00	0.00	0.00	1506559.42	3406074.43	40	42	52.852 N	104	2	6.488 W
PBHL 2-25			6170.00	4434.77	-46.29	1510994.19	3406028.14	40	43	36.675 N	104	2	6.138 W

Precision Directional Services, Inc.

Planning Report

Company: CARRIZO OIL & GAS, INC.

Field: Niobrara CONZ'83

Site: Shull 1-25-9-60 Pad

Well: 2-25-9-60

Wellpath: Original Hole

Date: 02/13/2013

Time: 11:00:11

Page: 4

Co-ordinate(NE) Reference: Well: 2-25-9-60, Grid North

Vertical (TVD) Reference: 4943'GL+17'KB 4960.0

Section (VS) Reference: Well (0.00N,0.00E,359.09Azi)

Plan: Plan #2

Casing Points

MD ft	TVD ft	Diameter in	Hole Size in	Name
6300.62	6135.45	7.000	8.750	7"