

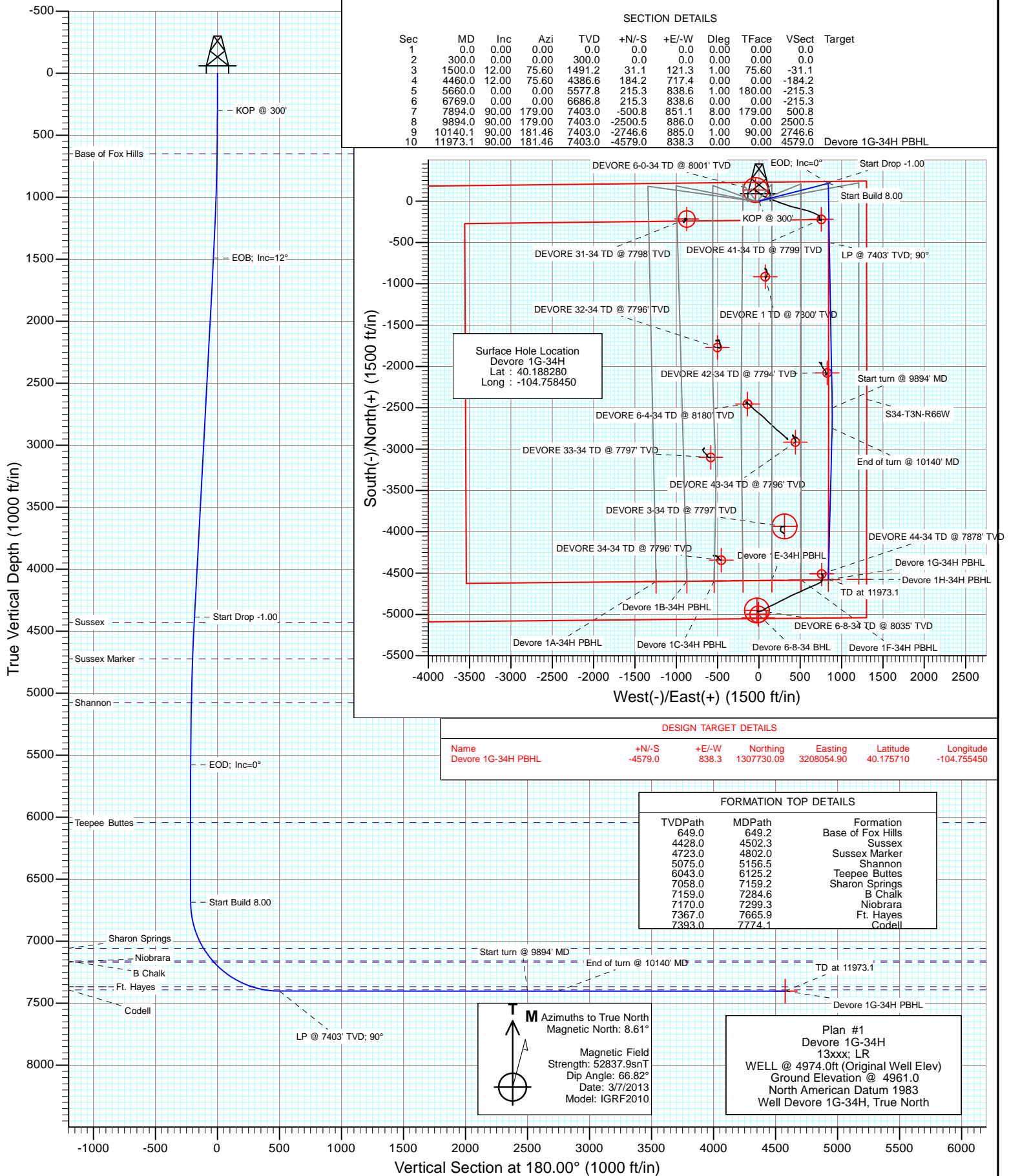

Project: DJ Wattenberg
Site: S34-T3N-R66W (Devore)
Well: Devore 1G-34H
Wellbore: Hz
Design: Plan #1



Planning Report

Database:	USA EDM 5000 Multi Users DB	Local Co-ordinate Reference:	Well Devore 1G-34H
Company:	EnCana Oil & Gas (USA) Inc	TVD Reference:	WELL @ 4974.0ft (Original Well Elev)
Project:	DJ Wattenberg	MD Reference:	WELL @ 4974.0ft (Original Well Elev)
Site:	S34-T3N-R66W (Devore)	North Reference:	True
Well:	Devore 1G-34H	Survey Calculation Method:	Minimum Curvature
Wellbore:	Hz		
Design:	Plan #1		

Project	DJ Wattenberg		
Map System:	US State Plane 1983	System Datum:	Mean Sea Level
Geo Datum:	North American Datum 1983		
Map Zone:	Colorado Northern Zone		

Site	S34-T3N-R66W (Devore)				
Site Position:		Northing:	1,307,711.17 ft	Latitude:	40.175660
From:	Lat/Long	Easting:	3,207,971.22 ft	Longitude:	-104.755750
Position Uncertainty:	0.0 ft	Slot Radius:	13.200 in	Grid Convergence:	0.48 °

Well	Devore 1G-34H					
Well Position	+N/-S	0.0 ft	Northing:	1,312,301.88 ft	Latitude:	40.188280
	+E/-W	0.0 ft	Easting:	3,207,178.34 ft	Longitude:	-104.758450
Position Uncertainty		0.0 ft	Wellhead Elevation:	ft	Ground Level:	4,961.0 ft

Wellbore	Hz				
Magnetics	Model Name	Sample Date	Declination (°)	Dip Angle (°)	Field Strength (nT)
	IGRF2010	3/7/2013	8.61	66.82	52,838

Design	Plan #1			
Audit Notes:				
Version:	Phase:	PLAN	Tie On Depth:	0.0
Vertical Section:	Depth From (TVD) (ft)	+N/-S (ft)	+E/-W (ft)	Direction (°)
	0.0	0.0	0.0	180.00

Plan Sections										
Measured Depth (ft)	Inclination (°)	Azimuth (°)	Vertical Depth (ft)	+N/-S (ft)	+E/-W (ft)	Dogleg Rate (°/100ft)	Build Rate (°/100ft)	Turn Rate (°/100ft)	TFO (°)	Target
0.0	0.00	0.00	0.0	0.0	0.0	0.00	0.00	0.00	0.00	
300.0	0.00	0.00	300.0	0.0	0.0	0.00	0.00	0.00	0.00	
1,500.0	12.00	75.60	1,491.2	31.1	121.3	1.00	1.00	0.00	75.60	
4,460.0	12.00	75.60	4,386.6	184.2	717.4	0.00	0.00	0.00	0.00	
5,660.0	0.00	0.00	5,577.8	215.3	838.6	1.00	-1.00	0.00	180.00	
6,769.0	0.00	0.00	6,686.8	215.3	838.6	0.00	0.00	0.00	0.00	
7,894.0	90.00	179.00	7,403.0	-500.8	851.1	8.00	8.00	0.00	179.00	
9,894.0	90.00	179.00	7,403.0	-2,500.5	886.0	0.00	0.00	0.00	0.00	
10,140.1	90.00	181.46	7,403.0	-2,746.6	885.0	1.00	0.00	1.00	90.00	
11,973.1	90.00	181.46	7,403.0	-4,579.0	838.3	0.00	0.00	0.00	0.00	Devore 1G-34H PBHL

Planning Report

Database:	USA EDM 5000 Multi Users DB	Local Co-ordinate Reference:	Well Devore 1G-34H
Company:	EnCana Oil & Gas (USA) Inc	TVD Reference:	WELL @ 4974.0ft (Original Well Elev)
Project:	DJ Wattenberg	MD Reference:	WELL @ 4974.0ft (Original Well Elev)
Site:	S34-T3N-R66W (Devore)	North Reference:	True
Well:	Devore 1G-34H	Survey Calculation Method:	Minimum Curvature
Wellbore:	Hz		
Design:	Plan #1		

Planned Survey

Measured Depth (ft)	Inclination (°)	Azimuth (°)	Vertical Depth (ft)	+N/-S (ft)	+E/-W (ft)	Vertical Section (ft)	Dogleg Rate (°/100ft)	Build Rate (°/100ft)	Comments / Formations
0.0	0.00	0.00	0.0	0.0	0.0	0.0	0.00	0.00	
100.0	0.00	0.00	100.0	0.0	0.0	0.0	0.00	0.00	
200.0	0.00	0.00	200.0	0.0	0.0	0.0	0.00	0.00	
300.0	0.00	0.00	300.0	0.0	0.0	0.0	0.00	0.00	KOP @ 300'
400.0	1.00	75.60	400.0	0.2	0.8	-0.2	1.00	1.00	
500.0	2.00	75.60	500.0	0.9	3.4	-0.9	1.00	1.00	
600.0	3.00	75.60	599.9	2.0	7.6	-2.0	1.00	1.00	
649.2	3.49	75.60	649.0	2.6	10.3	-2.6	1.00	1.00	Base of Fox Hills
700.0	4.00	75.60	699.7	3.5	13.5	-3.5	1.00	1.00	
800.0	5.00	75.60	799.4	5.4	21.1	-5.4	1.00	1.00	
900.0	6.00	75.60	898.9	7.8	30.4	-7.8	1.00	1.00	
1,000.0	7.00	75.60	998.3	10.6	41.4	-10.6	1.00	1.00	
1,100.0	8.00	75.60	1,097.4	13.9	54.0	-13.9	1.00	1.00	
1,200.0	9.00	75.60	1,196.3	17.5	68.3	-17.5	1.00	1.00	
1,300.0	10.00	75.60	1,294.9	21.6	84.3	-21.6	1.00	1.00	
1,400.0	11.00	75.60	1,393.3	26.2	102.0	-26.2	1.00	1.00	
1,500.0	12.00	75.60	1,491.2	31.1	121.3	-31.1	1.00	1.00	EOB; Inc=12°
1,600.0	12.00	75.60	1,589.1	36.3	141.4	-36.3	0.00	0.00	
1,700.0	12.00	75.60	1,686.9	41.5	161.5	-41.5	0.00	0.00	
1,800.0	12.00	75.60	1,784.7	46.6	181.7	-46.6	0.00	0.00	
1,900.0	12.00	75.60	1,882.5	51.8	201.8	-51.8	0.00	0.00	
2,000.0	12.00	75.60	1,980.3	57.0	222.0	-57.0	0.00	0.00	
2,100.0	12.00	75.60	2,078.1	62.2	242.1	-62.2	0.00	0.00	
2,200.0	12.00	75.60	2,175.9	67.3	262.2	-67.3	0.00	0.00	
2,300.0	12.00	75.60	2,273.8	72.5	282.4	-72.5	0.00	0.00	
2,400.0	12.00	75.60	2,371.6	77.7	302.5	-77.7	0.00	0.00	
2,500.0	12.00	75.60	2,469.4	82.8	322.7	-82.8	0.00	0.00	
2,600.0	12.00	75.60	2,567.2	88.0	342.8	-88.0	0.00	0.00	
2,700.0	12.00	75.60	2,665.0	93.2	362.9	-93.2	0.00	0.00	
2,800.0	12.00	75.60	2,762.8	98.4	383.1	-98.4	0.00	0.00	
2,900.0	12.00	75.60	2,860.7	103.5	403.2	-103.5	0.00	0.00	
3,000.0	12.00	75.60	2,958.5	108.7	423.3	-108.7	0.00	0.00	
3,100.0	12.00	75.60	3,056.3	113.9	443.5	-113.9	0.00	0.00	
3,200.0	12.00	75.60	3,154.1	119.0	463.6	-119.0	0.00	0.00	
3,300.0	12.00	75.60	3,251.9	124.2	483.8	-124.2	0.00	0.00	
3,400.0	12.00	75.60	3,349.7	129.4	503.9	-129.4	0.00	0.00	
3,500.0	12.00	75.60	3,447.5	134.5	524.0	-134.5	0.00	0.00	
3,600.0	12.00	75.60	3,545.4	139.7	544.2	-139.7	0.00	0.00	
3,700.0	12.00	75.60	3,643.2	144.9	564.3	-144.9	0.00	0.00	
3,800.0	12.00	75.60	3,741.0	150.1	584.4	-150.1	0.00	0.00	
3,900.0	12.00	75.60	3,838.8	155.2	604.6	-155.2	0.00	0.00	
4,000.0	12.00	75.60	3,936.6	160.4	624.7	-160.4	0.00	0.00	
4,100.0	12.00	75.60	4,034.4	165.6	644.9	-165.6	0.00	0.00	
4,200.0	12.00	75.60	4,132.2	170.7	665.0	-170.7	0.00	0.00	
4,300.0	12.00	75.60	4,230.1	175.9	685.1	-175.9	0.00	0.00	
4,400.0	12.00	75.60	4,327.9	181.1	705.3	-181.1	0.00	0.00	
4,460.0	12.00	75.60	4,386.6	184.2	717.4	-184.2	0.00	0.00	Start Drop -1.00
4,500.0	11.60	75.60	4,425.7	186.2	725.3	-186.2	1.00	-1.00	
4,502.3	11.58	75.60	4,428.0	186.3	725.7	-186.3	1.00	-1.00	Sussex
4,600.0	10.60	75.60	4,523.8	191.0	743.9	-191.0	1.00	-1.00	
4,700.0	9.60	75.60	4,622.3	195.4	760.9	-195.4	1.00	-1.00	
4,800.0	8.60	75.60	4,721.0	199.3	776.2	-199.3	1.00	-1.00	

Planning Report

Database:	USA EDM 5000 Multi Users DB	Local Co-ordinate Reference:	Well Devore 1G-34H
Company:	EnCana Oil & Gas (USA) Inc	TVD Reference:	WELL @ 4974.0ft (Original Well Elev)
Project:	DJ Wattenberg	MD Reference:	WELL @ 4974.0ft (Original Well Elev)
Site:	S34-T3N-R66W (Devore)	North Reference:	True
Well:	Devore 1G-34H	Survey Calculation Method:	Minimum Curvature
Wellbore:	Hz		
Design:	Plan #1		

Planned Survey									
Measured Depth (ft)	Inclination (°)	Azimuth (°)	Vertical Depth (ft)	+N/-S (ft)	+E/-W (ft)	Vertical Section (ft)	Dogleg Rate (°/100ft)	Build Rate (°/100ft)	Comments / Formations
4,802.0	8.58	75.60	4,723.0	199.4	776.5	-199.4	1.00	-1.00	Sussex Marker
4,900.0	7.60	75.60	4,820.0	202.8	789.9	-202.8	1.00	-1.00	
5,000.0	6.60	75.60	4,919.3	205.9	801.8	-205.9	1.00	-1.00	
5,100.0	5.60	75.60	5,018.7	208.5	812.1	-208.5	1.00	-1.00	
5,156.5	5.03	75.60	5,075.0	209.8	817.2	-209.8	1.00	-1.00	Shannon
5,200.0	4.60	75.60	5,118.3	210.7	820.8	-210.7	1.00	-1.00	
5,300.0	3.60	75.60	5,218.0	212.5	827.7	-212.5	1.00	-1.00	
5,400.0	2.60	75.60	5,317.9	213.9	832.9	-213.9	1.00	-1.00	
5,500.0	1.60	75.60	5,417.8	214.8	836.5	-214.8	1.00	-1.00	
5,600.0	0.60	75.60	5,517.8	215.2	838.3	-215.2	1.00	-1.00	
5,660.0	0.00	0.00	5,577.8	215.3	838.6	-215.3	1.00	-1.00	EOD; Inc=0°
5,700.0	0.00	0.00	5,617.8	215.3	838.6	-215.3	0.00	0.00	
5,800.0	0.00	0.00	5,717.8	215.3	838.6	-215.3	0.00	0.00	
5,900.0	0.00	0.00	5,817.8	215.3	838.6	-215.3	0.00	0.00	
6,000.0	0.00	0.00	5,917.8	215.3	838.6	-215.3	0.00	0.00	
6,100.0	0.00	0.00	6,017.8	215.3	838.6	-215.3	0.00	0.00	
6,125.2	0.00	0.00	6,043.0	215.3	838.6	-215.3	0.00	0.00	Teepee Buttes
6,200.0	0.00	0.00	6,117.8	215.3	838.6	-215.3	0.00	0.00	
6,300.0	0.00	0.00	6,217.8	215.3	838.6	-215.3	0.00	0.00	
6,400.0	0.00	0.00	6,317.8	215.3	838.6	-215.3	0.00	0.00	
6,500.0	0.00	0.00	6,417.8	215.3	838.6	-215.3	0.00	0.00	
6,600.0	0.00	0.00	6,517.8	215.3	838.6	-215.3	0.00	0.00	
6,700.0	0.00	0.00	6,617.8	215.3	838.6	-215.3	0.00	0.00	
6,769.0	0.00	0.00	6,686.8	215.3	838.6	-215.3	0.00	0.00	Start Build 8.00
6,800.0	2.48	179.00	6,717.8	214.7	838.6	-214.7	8.00	8.00	
6,900.0	10.48	179.00	6,817.1	203.4	838.8	-203.4	8.00	8.00	
7,000.0	18.48	179.00	6,913.8	178.4	839.3	-178.4	8.00	8.00	
7,100.0	26.48	179.00	7,006.2	140.2	839.9	-140.2	8.00	8.00	
7,159.2	31.22	179.00	7,058.0	111.6	840.4	-111.6	8.00	8.00	Sharon Springs
7,200.0	34.48	179.00	7,092.3	89.5	840.8	-89.5	8.00	8.00	
7,284.6	41.25	179.00	7,159.0	37.6	841.7	-37.6	8.00	8.00	B Chalk
7,299.3	42.43	179.00	7,170.0	27.8	841.9	-27.8	8.00	8.00	Niobrara
7,300.0	42.48	179.00	7,170.5	27.4	841.9	-27.4	8.00	8.00	
7,400.0	50.48	179.00	7,239.3	-45.1	843.2	45.1	8.00	8.00	
7,500.0	58.48	179.00	7,297.3	-126.4	844.6	126.4	8.00	8.00	
7,600.0	66.48	179.00	7,343.5	-215.0	846.1	215.0	8.00	8.00	
7,665.9	71.75	179.00	7,367.0	-276.6	847.2	276.6	8.00	8.00	Ft. Hayes
7,700.0	74.48	179.00	7,376.9	-309.2	847.8	309.2	8.00	8.00	
7,774.1	80.41	179.00	7,393.0	-381.5	849.0	381.5	8.00	8.00	Codell
7,800.0	82.48	179.00	7,396.8	-407.0	849.5	407.0	8.00	8.00	
7,894.0	90.00	179.00	7,403.0	-500.8	851.1	500.8	8.00	8.00	LP @ 7403' TVD; 90°
7,900.0	90.00	179.00	7,403.0	-506.8	851.2	506.8	0.00	0.00	
8,000.0	90.00	179.00	7,403.0	-606.7	853.0	606.7	0.00	0.00	
8,100.0	90.00	179.00	7,403.0	-706.7	854.7	706.7	0.00	0.00	
8,200.0	90.00	179.00	7,403.0	-806.7	856.5	806.7	0.00	0.00	
8,300.0	90.00	179.00	7,403.0	-906.7	858.2	906.7	0.00	0.00	
8,400.0	90.00	179.00	7,403.0	-1,006.7	860.0	1,006.7	0.00	0.00	
8,500.0	90.00	179.00	7,403.0	-1,106.7	861.7	1,106.7	0.00	0.00	
8,600.0	90.00	179.00	7,403.0	-1,206.7	863.4	1,206.7	0.00	0.00	
8,700.0	90.00	179.00	7,403.0	-1,306.6	865.2	1,306.6	0.00	0.00	
8,800.0	90.00	179.00	7,403.0	-1,406.6	866.9	1,406.6	0.00	0.00	
8,900.0	90.00	179.00	7,403.0	-1,506.6	868.7	1,506.6	0.00	0.00	

Planning Report

Database:	USA EDM 5000 Multi Users DB	Local Co-ordinate Reference:	Well Devore 1G-34H
Company:	EnCana Oil & Gas (USA) Inc	TVD Reference:	WELL @ 4974.0ft (Original Well Elev)
Project:	DJ Wattenberg	MD Reference:	WELL @ 4974.0ft (Original Well Elev)
Site:	S34-T3N-R66W (Devore)	North Reference:	True
Well:	Devore 1G-34H	Survey Calculation Method:	Minimum Curvature
Wellbore:	Hz		
Design:	Plan #1		

Planned Survey									
Measured Depth (ft)	Inclination (°)	Azimuth (°)	Vertical Depth (ft)	+N/-S (ft)	+E/-W (ft)	Vertical Section (ft)	Dogleg Rate (°/100ft)	Build Rate (°/100ft)	Comments / Formations
9,000.0	90.00	179.00	7,403.0	-1,606.6	870.4	1,606.6	0.00	0.00	
9,100.0	90.00	179.00	7,403.0	-1,706.6	872.2	1,706.6	0.00	0.00	
9,200.0	90.00	179.00	7,403.0	-1,806.6	873.9	1,806.6	0.00	0.00	
9,300.0	90.00	179.00	7,403.0	-1,906.6	875.7	1,906.6	0.00	0.00	
9,400.0	90.00	179.00	7,403.0	-2,006.5	877.4	2,006.5	0.00	0.00	
9,500.0	90.00	179.00	7,403.0	-2,106.5	879.2	2,106.5	0.00	0.00	
9,600.0	90.00	179.00	7,403.0	-2,206.5	880.9	2,206.5	0.00	0.00	
9,700.0	90.00	179.00	7,403.0	-2,306.5	882.6	2,306.5	0.00	0.00	
9,800.0	90.00	179.00	7,403.0	-2,406.5	884.4	2,406.5	0.00	0.00	
9,894.0	90.00	179.00	7,403.0	-2,500.5	886.0	2,500.5	0.00	0.00	Start turn @ 9894' MD
9,900.0	90.00	179.06	7,403.0	-2,506.5	886.1	2,506.5	1.00	0.00	
10,000.0	90.00	180.06	7,403.0	-2,606.5	886.9	2,606.5	1.00	0.00	
10,100.0	90.00	181.06	7,403.0	-2,706.4	885.9	2,706.4	1.00	0.00	
10,140.1	90.00	181.46	7,403.0	-2,746.6	885.0	2,746.6	1.00	0.00	End of turn @ 10140' MD
10,200.0	90.00	181.46	7,403.0	-2,806.4	883.5	2,806.4	0.00	0.00	
10,300.0	90.00	181.46	7,403.0	-2,906.4	881.0	2,906.4	0.00	0.00	
10,400.0	90.00	181.46	7,403.0	-3,006.4	878.4	3,006.4	0.00	0.00	
10,500.0	90.00	181.46	7,403.0	-3,106.3	875.9	3,106.3	0.00	0.00	
10,600.0	90.00	181.46	7,403.0	-3,206.3	873.3	3,206.3	0.00	0.00	
10,700.0	90.00	181.46	7,403.0	-3,306.3	870.8	3,306.3	0.00	0.00	
10,800.0	90.00	181.46	7,403.0	-3,406.2	868.2	3,406.2	0.00	0.00	
10,900.0	90.00	181.46	7,403.0	-3,506.2	865.7	3,506.2	0.00	0.00	
11,000.0	90.00	181.46	7,403.0	-3,606.2	863.1	3,606.2	0.00	0.00	
11,100.0	90.00	181.46	7,403.0	-3,706.1	860.6	3,706.1	0.00	0.00	
11,200.0	90.00	181.46	7,403.0	-3,806.1	858.0	3,806.1	0.00	0.00	
11,300.0	90.00	181.46	7,403.0	-3,906.1	855.5	3,906.1	0.00	0.00	
11,400.0	90.00	181.46	7,403.0	-4,006.0	852.9	4,006.0	0.00	0.00	
11,500.0	90.00	181.46	7,403.0	-4,106.0	850.4	4,106.0	0.00	0.00	
11,600.0	90.00	181.46	7,403.0	-4,206.0	847.8	4,206.0	0.00	0.00	
11,700.0	90.00	181.46	7,403.0	-4,305.9	845.3	4,305.9	0.00	0.00	
11,800.0	90.00	181.46	7,403.0	-4,405.9	842.7	4,405.9	0.00	0.00	
11,900.0	90.00	181.46	7,403.0	-4,505.9	840.2	4,505.9	0.00	0.00	
11,973.1	90.00	181.46	7,403.0	-4,579.0	838.3	4,579.0	0.00	0.00	TD at 11973.1

Targets									
Target Name	Dip Angle (°)	Dip Dir. (°)	TVD (ft)	+N/-S (ft)	+E/-W (ft)	Northing (ft)	Easting (ft)	Latitude	Longitude
- hit/miss target									
- Shape									
Devore 1G-34H PBHL	0.00	0.00	7,403.0	-4,579.0	838.3	1,307,730.09	3,208,054.90	40.175710	-104.755450
- plan hits target center									
- Point									

Planning Report

Database:	USA EDM 5000 Multi Users DB	Local Co-ordinate Reference:	Well Devore 1G-34H
Company:	EnCana Oil & Gas (USA) Inc	TVD Reference:	WELL @ 4974.0ft (Original Well Elev)
Project:	DJ Wattenberg	MD Reference:	WELL @ 4974.0ft (Original Well Elev)
Site:	S34-T3N-R66W (Devore)	North Reference:	True
Well:	Devore 1G-34H	Survey Calculation Method:	Minimum Curvature
Wellbore:	Hz		
Design:	Plan #1		

Formations						
Measured Depth (ft)	Vertical Depth (ft)	Name	Lithology	Dip (°)	Dip Direction (°)	
649.2	649.0	Base of Fox Hills				
4,502.3	4,428.0	Sussex				
4,802.0	4,723.0	Sussex Marker				
5,156.5	5,075.0	Shannon				
6,125.2	6,043.0	Teepee Buttes				
7,159.2	7,058.0	Sharon Springs				
7,284.6	7,159.0	B Chalk				
7,299.3	7,170.0	Niobrara				
7,665.9	7,367.0	Ft. Hayes				
7,774.1	7,393.0	Codell				

Plan Annotations					
Measured Depth (ft)	Vertical Depth (ft)	Local Coordinates			
		+N/-S (ft)	+E/-W (ft)	Comment	
300.0	300.0	0.0	0.0	KOP @ 300'	
1,500.0	1,491.2	31.1	121.3	EOB; Inc=12°	
4,460.0	4,386.6	184.2	717.4	Start Drop -1.00	
5,660.0	5,577.8	215.3	838.6	EOD; Inc=0°	
6,769.0	6,686.8	215.3	838.6	Start Build 8.00	
7,894.0	7,403.0	-500.8	851.1	LP @ 7403' TVD; 90°	
9,894.0	7,403.0	-2,500.5	886.0	Start turn @ 9894' MD	
10,140.1	7,403.0	-2,746.6	885.0	End of turn @ 10140' MD	
11,973.1	7,403.0	-4,579.0	838.3	TD at 11973.1	

EnCana Oil & Gas (USA) Inc

DJ Wattenberg

S34-T3N-R66W (Devore)

Devore 1G-34H

Hz

Plan #1

Anticollision Report

14 March, 2013

Anticollision Report

Company:	EnCana Oil & Gas (USA) Inc	Local Co-ordinate Reference:	Well Devore 1G-34H
Project:	DJ Wattenberg	TVD Reference:	WELL @ 4974.0ft (Original Well Elev)
Reference Site:	S34-T3N-R66W (Devore)	MD Reference:	WELL @ 4974.0ft (Original Well Elev)
Site Error:	0.0ft	North Reference:	True
Reference Well:	Devore 1G-34H	Survey Calculation Method:	Minimum Curvature
Well Error:	0.0ft	Output errors are at	2.00 sigma
Reference Wellbore	Hz	Database:	USA EDM 5000 Multi Users DB
Reference Design:	Plan #1	Offset TVD Reference:	Offset Datum

Reference	Plan #1		
Filter type:	NO GLOBAL FILTER: Using user defined selection & filtering criteria		
Interpolation Method:	MD Interval 100.0ft	Error Model:	Systematic Ellipse
Depth Range:	Unlimited	Scan Method:	Closest Approach 3D
Results Limited by:	Maximum center-center distance of 1,268.1ft	Error Surface:	Elliptical Conic
Warning Levels Evaluated at:	2.00 Sigma		

Survey Tool Program		Date	3/14/2013		
From (ft)	To (ft)	Survey (Wellbore)	Tool Name	Description	
0.0	11,973.1	Plan #1 (Hz)	MWD	Geolink MWD	

Anticollision Report

Company:	EnCana Oil & Gas (USA) Inc	Local Co-ordinate Reference:	Well Devore 1G-34H
Project:	DJ Wattenberg	TVD Reference:	WELL @ 4974.0ft (Original Well Elev)
Reference Site:	S34-T3N-R66W (Devore)	MD Reference:	WELL @ 4974.0ft (Original Well Elev)
Site Error:	0.0ft	North Reference:	True
Reference Well:	Devore 1G-34H	Survey Calculation Method:	Minimum Curvature
Well Error:	0.0ft	Output errors are at	2.00 sigma
Reference Wellbore	Hz	Database:	USA EDM 5000 Multi Users DB
Reference Design:	Plan #1	Offset TVD Reference:	Offset Datum

Summary

Site Name	Reference Measured Depth (ft)	Offset Measured Depth (ft)	Distance Between Centres (ft)	Distance Between Ellipses (ft)	Separation Factor	Warning
Offset Well - Wellbore - Design						
S34-T3N-R66W (Devore)						
DEVORE 1 (EXISTING) - EXISTING - GYRO	8,298.2	7,401.7	781.8	753.4	27.516	CC
DEVORE 1 (EXISTING) - EXISTING - GYRO	8,300.0	7,401.7	781.8	753.4	27.493	ES
DEVORE 1 (EXISTING) - EXISTING - GYRO	8,600.0	7,396.2	838.0	805.1	25.478	SF
Devore 1A-34H - Hz - Plan #1	200.0	200.0	58.7	58.0	89.881	CC, ES
Devore 1A-34H - Hz - Plan #1	600.0	594.7	79.9	77.9	39.185	SF
Devore 1B-34H - Hz - Plan #1	300.0	300.0	50.3	49.3	50.197	CC, ES
Devore 1B-34H - Hz - Plan #1	600.0	596.7	65.5	63.5	32.069	SF
Devore 1C-34H - Hz - Plan #1	300.0	300.0	39.1	38.1	39.042	CC, ES
Devore 1C-34H - Hz - Plan #1	600.0	598.3	50.0	47.9	24.427	SF
Devore 1D-34H - Hz - Plan #1	300.0	300.0	30.7	29.7	30.676	CC, ES
Devore 1D-34H - Hz - Plan #1	11,973.1	11,667.2	1,057.8	896.1	6.542	SF
Devore 1E-34H - Hz - Plan #1	300.0	300.0	19.6	18.6	19.521	CC, ES
Devore 1E-34H - Hz - Plan #1	11,973.1	11,884.9	682.0	516.5	4.122	SF
Devore 1F-34H - Hz - Plan #1	300.0	300.0	8.4	7.4	8.366	CC, ES
Devore 1F-34H - Hz - Plan #1	11,973.1	11,698.2	401.5	264.3	2.928	SF
Devore 1H-34H - Hz - Plan #1	200.0	200.0	11.2	10.5	17.120	CC, ES
Devore 1H-34H - Hz - Plan #1	11,973.1	11,806.5	434.2	292.5	3.064	SF
DEVORE 31-34 (EXISTING) - EXISTING - GYRO	0.0	0.0	896.3			
DEVORE 31-34 (EXISTING) - EXISTING - GYRO	2,500.0	2,452.8	1,251.5	1,245.0	192.286	SF
DEVORE 32-34 (EXISTING) - EXISTING - GYRO						Out of range
DEVORE 33-34 (EXISTING) - EXISTING - GYRO						Out of range
DEVORE 3-34 (EXISTING) - EXISTING - GYRO	11,341.0	7,437.5	545.3	467.0	6.971	CC, ES
DEVORE 3-34 (EXISTING) - EXISTING - GYRO	11,400.0	7,437.8	548.4	469.2	6.922	SF
DEVORE 34-34 (EXISTING) - EXISTING - GYRO						Out of range
DEVORE 41-34 (EXISTING) - EXISTING - GYRO	7,609.7	7,333.2	92.0	71.6	4.510	CC, ES, SF
DEVORE 42-34 (EXISTING) - EXISTING - GYRO	9,478.6	7,415.2	55.3	8.1	1.172	Level 2, CC, ES, SF
DEVORE 43-34 (EXISTING) - EXISTING - GYRO	10,318.5	7,421.3	438.8	378.2	7.239	CC, ES
DEVORE 43-34 (EXISTING) - EXISTING - GYRO	10,400.0	7,421.5	446.3	384.3	7.198	SF
DEVORE 44-34 (EXISTING) - EXISTING - GYRO	11,904.5	7,464.7	80.5	-7.5	0.915	Level 1, CC, ES, SF
DEVORE 6-0-34 (EXISTING) - EXISTING - SURVEYS	3,240.8	3,228.5	205.8	188.3	11.819	CC, ES
DEVORE 6-0-34 (EXISTING) - EXISTING - SURVEYS	3,300.0	3,282.6	207.0	189.3	11.697	SF
DEVORE 6-4-34 (EXISTING) - EXISTING - SURVEYS	9,827.2	7,500.0	1,032.6	971.1	16.800	CC, ES
DEVORE 6-4-34 (EXISTING) - EXISTING - SURVEYS	10,100.0	7,501.6	1,064.5	999.1	16.274	SF
DEVORE 6-8-34 (EXISTING) - EXISTING - Plan #1	11,973.1	7,525.3	939.0	841.3	9.609	CC, ES, SF
DEVORE 6-8-34 (EXISTING) - EXISTING - Plan #2	11,973.1	7,528.5	944.7	846.9	9.668	CC, ES, SF
DEVORE 6-8-34 (EXISTING) - EXISTING - SURVEYS	11,973.1	7,538.1	936.7	839.2	9.607	CC, ES, SF

Anticollision Report

Company:	EnCana Oil & Gas (USA) Inc	Local Co-ordinate Reference:	Well Devore 1G-34H
Project:	DJ Wattenberg	TVD Reference:	WELL @ 4974.0ft (Original Well Elev)
Reference Site:	S34-T3N-R66W (Devore)	MD Reference:	WELL @ 4974.0ft (Original Well Elev)
Site Error:	0.0ft	North Reference:	True
Reference Well:	Devore 1G-34H	Survey Calculation Method:	Minimum Curvature
Well Error:	0.0ft	Output errors are at	2.00 sigma
Reference Wellbore	Hz	Database:	USA EDM 5000 Multi Users DB
Reference Design:	Plan #1	Offset TVD Reference:	Offset Datum

Offset Design S34-T3N-R66W (Devore) - DEVORE 1 (EXISTING) - EXISTING - GYRO													Offset Site Error:	0.0 ft
Survey Program: 100-Gyro													Offset Well Error:	0.0 ft
Reference		Offset		Semi Major Axis			Distance				Total Uncertainty Axis	Separation Factor	Warning	
Measured Depth (ft)	Vertical Depth (ft)	Measured Depth (ft)	Vertical Depth (ft)	Reference (ft)	Offset (ft)	Highside Toolface (°)	Offset Wellbore Centre +N/-S (ft)	+E/-W (ft)	Between Centres (ft)	Between Ellipses (ft)				
0.0	0.0	0.0	0.0	0.0	0.0	174.52	-824.3	79.1	828.1					
100.0	100.0	103.4	103.4	0.2	0.1	174.55	-823.9	78.6	827.7	827.4	0.24	3,416.489		
200.0	200.0	202.5	202.5	0.3	0.2	174.59	-823.1	77.9	826.8	826.3	0.50	1,642.307		
300.0	300.0	300.0	300.0	0.5	0.3	174.62	-822.6	77.4	826.2	825.4	0.76	1,082.670		
400.0	400.0	399.9	399.9	0.7	0.4	99.10	-822.1	77.1	825.9	824.8	1.03	805.376		
436.0	436.0	435.1	435.1	0.7	0.4	99.16	-822.0	77.1	825.8	824.7	1.12	737.051		
500.0	500.0	497.7	497.7	0.9	0.4	99.29	-821.8	77.0	826.0	824.7	1.29	640.570		
600.0	599.9	599.0	599.0	1.0	0.5	99.60	-821.5	76.7	826.4	824.8	1.56	528.587		
700.0	699.7	696.8	696.7	1.2	0.6	100.02	-821.3	76.4	827.2	825.3	1.84	448.457		
800.0	799.4	798.7	798.7	1.4	0.7	100.57	-821.1	76.1	828.3	826.2	2.14	386.571		
900.0	898.9	899.8	899.8	1.7	0.8	101.25	-820.6	75.7	829.6	827.2	2.46	337.728		
1,000.0	998.3	998.8	998.8	1.9	0.9	102.00	-820.0	75.4	831.4	828.6	2.79	298.309		
1,100.0	1,097.4	1,097.2	1,097.2	2.2	1.0	102.86	-819.5	75.2	833.7	830.6	3.14	265.751		
1,200.0	1,196.3	1,197.4	1,197.4	2.5	1.0	103.82	-819.0	75.1	836.6	833.1	3.51	238.333		
1,300.0	1,294.9	1,295.5	1,295.5	2.8	1.1	104.88	-818.5	74.9	840.2	836.3	3.90	215.203		
1,400.0	1,393.3	1,388.3	1,388.3	3.2	1.2	105.97	-818.2	74.4	844.9	840.5	4.32	195.758		
1,500.0	1,491.2	1,490.9	1,490.9	3.5	1.3	107.28	-818.1	74.0	850.6	845.8	4.76	178.781		
1,600.0	1,589.1	1,584.9	1,584.8	3.9	1.4	108.57	-817.8	73.3	856.9	851.7	5.19	164.970		
1,700.0	1,686.9	1,683.5	1,683.4	4.3	1.5	109.92	-817.8	72.4	863.9	858.3	5.63	153.358		
1,800.0	1,784.7	1,778.9	1,778.9	4.7	1.6	111.20	-817.7	71.7	871.4	865.3	6.07	143.603		
1,900.0	1,882.5	1,879.4	1,879.4	5.1	1.6	112.49	-817.8	71.4	879.4	872.9	6.50	135.224		
2,000.0	1,980.3	1,983.9	1,983.8	5.5	1.7	113.78	-817.4	71.6	887.2	880.3	6.94	127.898		
2,100.0	2,078.1	2,082.3	2,082.3	5.9	1.8	114.98	-816.5	71.8	895.0	887.7	7.36	121.562		
2,200.0	2,175.9	2,185.4	2,185.3	6.3	1.9	116.16	-815.5	72.8	903.0	895.2	7.79	115.967		
2,300.0	2,273.8	2,275.1	2,275.0	6.7	2.0	117.11	-814.9	74.8	911.4	903.2	8.20	111.124		
2,400.0	2,371.6	2,363.5	2,363.4	7.1	2.1	117.97	-815.5	77.4	921.1	912.5	8.61	106.946		
2,500.0	2,469.4	2,452.1	2,451.9	7.5	2.1	118.77	-817.1	80.4	932.1	923.1	9.02	103.306		
2,600.0	2,567.2	2,539.4	2,539.1	7.9	2.2	119.50	-819.9	84.0	944.4	935.0	9.43	100.133		
2,700.0	2,665.0	2,625.3	2,624.8	8.3	2.3	120.16	-823.8	87.6	958.1	948.3	9.84	97.391		
2,800.0	2,762.8	2,711.4	2,710.7	8.7	2.4	120.83	-828.7	90.7	973.3	963.0	10.24	95.035		
2,900.0	2,860.7	2,802.8	2,801.9	9.1	2.5	121.57	-834.4	92.8	989.5	978.8	10.64	92.992		
3,000.0	2,958.5	2,901.2	2,900.1	9.5	2.5	122.41	-840.5	94.0	1,006.2	995.1	11.04	91.171		
3,100.0	3,056.3	3,007.7	3,006.4	9.9	2.6	123.33	-846.3	94.7	1,022.6	1,011.2	11.43	89.483		
3,200.0	3,154.1	3,112.8	3,111.4	10.3	2.7	124.21	-851.2	95.6	1,038.5	1,026.6	11.81	87.893		
3,300.0	3,251.9	3,214.7	3,213.3	10.7	2.8	125.02	-855.6	96.9	1,054.0	1,041.8	12.20	86.405		
3,400.0	3,349.7	3,317.0	3,315.4	11.1	2.9	125.81	-859.6	98.5	1,069.3	1,056.7	12.58	85.016		
3,500.0	3,447.5	3,417.0	3,415.4	11.5	3.0	126.59	-862.9	99.5	1,084.4	1,071.5	12.95	83.749		
3,600.0	3,545.4	3,516.2	3,514.6	11.9	3.1	127.34	-866.2	100.9	1,099.6	1,086.3	13.32	82.569		
3,700.0	3,643.2	3,612.1	3,610.4	12.3	3.2	128.05	-869.3	101.9	1,115.0	1,101.3	13.68	81.506		
3,800.0	3,741.0	3,700.0	3,698.2	12.7	3.3	128.71	-872.4	102.2	1,131.2	1,117.1	14.03	80.599		
3,900.0	3,838.8	3,793.7	3,791.9	13.2	3.3	129.42	-876.0	101.7	1,148.1	1,133.7	14.38	79.824		
4,000.0	3,936.6	3,888.2	3,886.3	13.6	3.4	130.15	-879.6	100.7	1,165.4	1,150.7	14.73	79.146		
4,100.0	4,034.4	3,991.8	3,989.8	14.0	3.5	130.95	-883.1	99.1	1,182.9	1,167.8	15.06	78.542		
4,200.0	4,132.2	4,088.4	4,086.4	14.4	3.6	131.69	-886.1	97.6	1,200.2	1,184.8	15.39	77.976		
4,300.0	4,230.1	4,192.1	4,190.0	14.8	3.7	132.40	-889.6	97.0	1,217.6	1,201.8	15.73	77.423		
4,400.0	4,327.9	4,287.1	4,284.9	15.2	3.8	133.04	-892.7	96.6	1,234.9	1,218.8	16.06	76.906		
4,500.0	4,425.7	4,386.2	4,384.0	15.6	3.9	133.73	-896.0	96.2	1,252.3	1,236.0	16.38	76.474		
7,200.0	7,092.3	7,100.0	7,097.3	19.5	6.3	43.67	-921.3	78.4	1,266.2	1,245.7	20.44	61.934		
7,300.0	7,170.5	7,167.8	7,165.1	19.6	6.3	48.50	-920.9	78.0	1,217.7	1,197.6	20.06	60.687		
7,400.0	7,239.3	7,236.4	7,233.7	19.8	6.4	54.85	-920.7	77.5	1,163.2	1,143.3	19.89	58.490		
7,500.0	7,297.3	7,298.7	7,296.0	20.0	6.4	62.56	-920.1	76.9	1,104.2	1,084.2	20.03	55.137		
7,600.0	7,343.5	7,349.1	7,346.4	20.4	6.5	70.98	-919.5	76.6	1,043.3	1,022.8	20.50	50.903		

CC - Min centre to center distance or convergent point, SF - min separation factor, ES - min ellipse separation

Anticollision Report

Company:	EnCana Oil & Gas (USA) Inc	Local Co-ordinate Reference:	Well Devore 1G-34H
Project:	DJ Wattenberg	TVD Reference:	WELL @ 4974.0ft (Original Well Elev)
Reference Site:	S34-T3N-R66W (Devore)	MD Reference:	WELL @ 4974.0ft (Original Well Elev)
Site Error:	0.0ft	North Reference:	True
Reference Well:	Devore 1G-34H	Survey Calculation Method:	Minimum Curvature
Well Error:	0.0ft	Output errors are at	2.00 sigma
Reference Wellbore	Hz	Database:	USA EDM 5000 Multi Users DB
Reference Design:	Plan #1	Offset TVD Reference:	Offset Datum

Offset Design S34-T3N-R66W (Devore) - DEVORE 1 (EXISTING) - EXISTING - GYRO													Offset Site Error:	0.0 ft
Survey Program: 100-Gyro													Offset Well Error:	0.0 ft
Reference		Offset		Semi Major Axis			Distance						Warning	
Measured Depth	Vertical Depth	Measured Depth	Vertical Depth	Reference	Offset	Highside Toolface	Offset Wellbore Centre		Between Centres	Between Ellipses	Total Uncertainty Axis	Separation Factor		
(ft)	(ft)	(ft)	(ft)	(ft)	(ft)	(°)	+N/-S (ft)	+E/-W (ft)	(ft)	(ft)				
7,700.0	7,376.9	7,384.7	7,381.9	20.9	6.5	79.08	-918.9	76.5	983.2	962.0	21.22	46.340		
7,800.0	7,396.8	7,404.1	7,401.4	21.6	6.5	85.85	-918.6	76.5	927.0	904.8	22.14	41.875		
7,900.0	7,403.0	7,408.3	7,405.6	22.4	6.5	90.48	-918.5	76.5	877.4	854.2	23.24	37.753		
8,000.0	7,403.0	7,406.7	7,404.0	23.3	6.5	90.37	-918.5	76.5	836.8	812.4	24.42	34.260		
8,100.0	7,403.0	7,405.1	7,402.3	24.3	6.5	90.24	-918.5	76.5	806.6	780.9	25.70	31.390		
8,200.0	7,403.0	7,403.4	7,400.7	25.3	6.5	90.12	-918.6	76.5	788.0	760.9	27.04	29.144		
8,298.2	7,403.0	7,401.7	7,399.0	26.4	6.5	90.00	-918.6	76.5	781.8	753.4	28.41	27.516 CC		
8,300.0	7,403.0	7,401.7	7,398.9	26.5	6.5	89.99	-918.6	76.5	781.8	753.4	28.44	27.493 ES		
8,400.0	7,403.0	7,399.9	7,397.2	27.7	6.5	89.87	-918.6	76.5	788.4	758.5	29.89	26.381		
8,500.0	7,403.0	7,398.0	7,395.3	28.9	6.5	89.73	-918.7	76.5	807.4	776.1	31.37	25.737		
8,600.0	7,403.0	7,396.2	7,393.4	30.3	6.5	89.59	-918.7	76.5	838.0	805.1	32.89	25.478 SF		
8,700.0	7,403.0	7,394.3	7,391.6	31.6	6.5	89.46	-918.7	76.5	879.0	844.6	34.44	25.523		
8,800.0	7,403.0	7,392.5	7,389.8	33.0	6.5	89.32	-918.8	76.5	929.0	892.9	36.01	25.798		
8,900.0	7,403.0	7,390.7	7,388.0	34.4	6.5	89.19	-918.8	76.5	986.5	948.9	37.60	26.240		
9,000.0	7,403.0	7,388.9	7,386.2	35.9	6.5	89.06	-918.8	76.5	1,050.5	1,011.3	39.20	26.797		
9,100.0	7,403.0	7,387.2	7,384.4	37.4	6.5	88.93	-918.9	76.5	1,119.8	1,078.9	40.82	27.431		
9,200.0	7,403.0	7,385.4	7,382.7	38.9	6.5	88.80	-918.9	76.5	1,193.4	1,150.9	42.45	28.111		

Anticollision Report

Company:	EnCana Oil & Gas (USA) Inc	Local Co-ordinate Reference:	Well Devore 1G-34H
Project:	DJ Wattenberg	TVD Reference:	WELL @ 4974.0ft (Original Well Elev)
Reference Site:	S34-T3N-R66W (Devore)	MD Reference:	WELL @ 4974.0ft (Original Well Elev)
Site Error:	0.0ft	North Reference:	True
Reference Well:	Devore 1G-34H	Survey Calculation Method:	Minimum Curvature
Well Error:	0.0ft	Output errors are at	2.00 sigma
Reference Wellbore	Hz	Database:	USA EDM 5000 Multi Users DB
Reference Design:	Plan #1	Offset TVD Reference:	Offset Datum

Offset Design S34-T3N-R66W (Devore) - Devore 1A-34H - Hz - Plan #1													Offset Site Error:	0.0 ft
Survey Program: 0-MWD													Offset Well Error:	0.0 ft
Reference		Offset		Semi Major Axis		Highside Toolface (°)	Distance		Total Uncertainty Axis	Separation Factor	Warning			
Measured Depth (ft)	Vertical Depth (ft)	Measured Depth (ft)	Vertical Depth (ft)	Reference (ft)	Offset (ft)		Offset Wellbore Centre +N/-S (ft)	+E/-W (ft)						
0.0	0.0	0.0	0.0	0.0	0.0	-89.95	0.1	-58.7	58.7					
100.0	100.0	100.0	100.0	0.2	0.2	-89.95	0.1	-58.7	58.7	58.4	0.30	193.192		
200.0	200.0	200.0	200.0	0.3	0.3	-89.95	0.1	-58.7	58.7	58.0	0.65	89.881 CC, ES		
300.0	300.0	299.0	299.0	0.5	0.5	-89.83	0.2	-59.5	59.5	58.5	1.00	59.469		
400.0	400.0	397.9	397.8	0.7	0.7	-165.30	0.5	-62.1	62.9	61.6	1.35	46.717		
500.0	500.0	496.5	496.4	0.9	0.9	-165.36	1.1	-66.3	69.7	68.0	1.69	41.174		
600.0	599.9	594.7	594.4	1.0	1.1	-165.53	1.9	-72.1	79.9	77.9	2.04	39.185 SF		
700.0	699.7	692.3	691.7	1.2	1.3	-165.78	3.0	-79.6	93.5	91.1	2.38	39.197		
800.0	799.4	789.2	788.2	1.4	1.5	-166.03	4.3	-88.6	110.3	107.6	2.73	40.445		
900.0	898.9	885.2	883.5	1.7	1.7	-166.27	5.7	-99.2	130.5	127.4	3.07	42.509		
1,000.0	998.3	980.0	977.6	1.9	2.0	-166.48	7.4	-111.2	154.0	150.5	3.41	45.135		
1,100.0	1,097.4	1,073.7	1,070.3	2.2	2.3	-166.66	9.3	-124.5	180.6	176.9	3.75	48.166		
1,200.0	1,196.3	1,166.1	1,161.5	2.5	2.6	-166.81	11.4	-139.1	210.4	206.4	4.09	51.495		
1,300.0	1,294.9	1,256.9	1,250.9	2.8	2.9	-166.92	13.6	-154.9	243.4	239.0	4.42	55.047		
1,400.0	1,393.3	1,346.2	1,338.6	3.2	3.2	-167.02	16.0	-171.8	279.4	274.6	4.75	58.770		
1,500.0	1,491.2	1,433.8	1,424.3	3.5	3.5	-167.09	18.5	-189.7	318.4	313.3	5.08	62.624		
1,600.0	1,589.1	1,519.9	1,508.3	3.9	3.9	-167.21	21.1	-208.6	359.5	354.1	5.42	66.287		
1,700.0	1,686.9	1,604.9	1,590.9	4.3	4.3	-167.26	23.9	-228.4	402.0	396.2	5.76	69.761		
1,800.0	1,784.7	1,688.7	1,672.0	4.7	4.7	-167.28	26.8	-249.1	445.7	439.6	6.10	73.073		
1,900.0	1,882.5	1,777.4	1,757.6	5.1	5.1	-167.28	30.0	-271.8	490.3	483.9	6.45	76.056		
2,000.0	1,980.3	1,866.9	1,844.1	5.5	5.5	-167.27	33.2	-294.8	534.9	528.1	6.80	78.712		
2,100.0	2,078.1	1,956.4	1,930.6	5.9	5.9	-167.27	36.5	-317.7	579.5	572.4	7.15	81.103		
2,200.0	2,175.9	2,045.9	2,017.0	6.3	6.4	-167.26	39.7	-340.6	624.1	616.6	7.50	83.266		
2,300.0	2,273.8	2,135.4	2,103.5	6.7	6.8	-167.26	42.9	-363.6	668.7	660.8	7.85	85.231		
2,400.0	2,371.6	2,224.9	2,189.9	7.1	7.2	-167.26	46.1	-386.5	713.3	705.1	8.20	87.025		
2,500.0	2,469.4	2,314.4	2,276.4	7.5	7.7	-167.26	49.4	-409.5	757.9	749.3	8.55	88.668		
2,600.0	2,567.2	2,403.9	2,362.8	7.9	8.1	-167.25	52.6	-432.4	802.5	793.6	8.90	90.179		
2,700.0	2,665.0	2,493.4	2,449.3	8.3	8.6	-167.25	55.8	-455.4	847.1	837.8	9.25	91.573		
2,800.0	2,762.8	2,582.9	2,535.8	8.7	9.0	-167.25	59.0	-478.3	891.7	882.1	9.60	92.862		
2,900.0	2,860.7	2,672.4	2,622.2	9.1	9.4	-167.25	62.3	-501.2	936.2	926.3	9.95	94.059		
3,000.0	2,958.5	2,761.9	2,708.7	9.5	9.9	-167.25	65.5	-524.2	980.8	970.5	10.31	95.172		
3,100.0	3,056.3	2,851.4	2,795.1	9.9	10.3	-167.25	68.7	-547.1	1,025.4	1,014.8	10.66	96.211		
3,200.0	3,154.1	2,940.9	2,881.6	10.3	10.8	-167.25	71.9	-570.1	1,070.0	1,059.0	11.01	97.182		
3,300.0	3,251.9	3,030.4	2,968.0	10.7	11.2	-167.25	75.1	-593.0	1,114.6	1,103.3	11.36	98.091		
3,400.0	3,349.7	3,120.0	3,054.5	11.1	11.6	-167.24	78.4	-615.9	1,159.2	1,147.5	11.72	98.945		
3,500.0	3,447.5	3,209.5	3,140.9	11.5	12.1	-167.24	81.6	-638.9	1,203.8	1,191.7	12.07	99.748		
3,600.0	3,545.4	3,299.0	3,227.4	11.9	12.5	-167.24	84.8	-661.8	1,248.4	1,236.0	12.42	100.505		

Anticollision Report

Company:	EnCana Oil & Gas (USA) Inc	Local Co-ordinate Reference:	Well Devore 1G-34H
Project:	DJ Wattenberg	TVD Reference:	WELL @ 4974.0ft (Original Well Elev)
Reference Site:	S34-T3N-R66W (Devore)	MD Reference:	WELL @ 4974.0ft (Original Well Elev)
Site Error:	0.0ft	North Reference:	True
Reference Well:	Devore 1G-34H	Survey Calculation Method:	Minimum Curvature
Well Error:	0.0ft	Output errors are at	2.00 sigma
Reference Wellbore	Hz	Database:	USA EDM 5000 Multi Users DB
Reference Design:	Plan #1	Offset TVD Reference:	Offset Datum

Offset Design S34-T3N-R66W (Devore) - Devore 1B-34H - Hz - Plan #1													Offset Site Error: 0.0 ft	
Survey Program: 0-MWD													Offset Well Error: 0.0 ft	
Reference		Offset		Semi Major Axis			Distance						Warning	
Measured Depth (ft)	Vertical Depth (ft)	Measured Depth (ft)	Vertical Depth (ft)	Reference (ft)	Offset (ft)	Highside Toolface (°)	Offset Wellbore Centre +N/-S (ft)	+E/-W (ft)	Between Centres (ft)	Between Ellipses (ft)	Total Uncertainty Axis	Separation Factor		
0.0	0.0	0.0	0.0	0.0	0.0	-89.95	0.0	-50.3	50.3					
100.0	100.0	100.0	100.0	0.2	0.2	-89.95	0.0	-50.3	50.3	50.0	0.30	165.593		
200.0	200.0	200.0	200.0	0.3	0.3	-89.95	0.0	-50.3	50.3	49.6	0.65	77.041		
300.0	300.0	300.0	300.0	0.5	0.5	-89.95	0.0	-50.3	50.3	49.3	1.00	50.197	CC, ES	
400.0	400.0	399.1	399.1	0.7	0.7	-165.60	0.2	-51.1	52.0	50.6	1.35	38.526		
500.0	500.0	498.1	498.0	0.9	0.9	-165.74	0.7	-53.6	57.1	55.4	1.70	33.637		
600.0	599.9	596.7	596.5	1.0	1.0	-165.93	1.5	-57.8	65.5	63.5	2.04	32.069	SF	
700.0	699.7	694.8	694.5	1.2	1.2	-166.12	2.6	-63.6	77.3	74.9	2.39	32.371		
800.0	799.4	792.2	791.6	1.4	1.4	-166.29	4.1	-71.0	92.5	89.7	2.73	33.826		
900.0	898.9	888.8	887.8	1.7	1.6	-166.42	5.8	-80.0	110.9	107.9	3.08	36.040		
1,000.0	998.3	984.4	982.8	1.9	1.9	-166.52	7.8	-90.4	132.7	129.2	3.42	38.777		
1,100.0	1,097.4	1,078.9	1,076.5	2.2	2.1	-166.60	10.1	-102.2	157.6	153.9	3.76	41.887		
1,200.0	1,196.3	1,172.2	1,168.8	2.5	2.4	-166.65	12.7	-115.3	185.8	181.7	4.10	45.269		
1,300.0	1,294.9	1,264.0	1,259.4	2.8	2.7	-166.67	15.5	-129.7	217.0	212.6	4.44	48.854		
1,400.0	1,393.3	1,354.3	1,348.4	3.2	3.0	-166.69	18.5	-145.2	251.4	246.6	4.78	52.590		
1,500.0	1,491.2	1,443.0	1,435.4	3.5	3.3	-166.68	21.7	-161.8	288.7	283.6	5.12	56.441		
1,600.0	1,589.1	1,530.3	1,520.8	3.9	3.7	-166.73	25.2	-179.4	328.2	322.8	5.46	60.107		
1,700.0	1,686.9	1,616.4	1,604.9	4.3	4.0	-166.72	28.8	-198.1	369.1	363.3	5.81	63.572		
1,800.0	1,784.7	1,701.5	1,687.6	4.7	4.4	-166.67	32.6	-217.7	411.3	405.1	6.15	66.865		
1,900.0	1,882.5	1,791.9	1,775.3	5.1	4.8	-166.60	36.8	-239.2	454.1	447.6	6.51	69.795		
2,000.0	1,980.3	1,882.3	1,863.0	5.5	5.2	-166.55	40.9	-260.6	496.9	490.1	6.86	72.414		
2,100.0	2,078.1	1,972.6	1,950.6	5.9	5.6	-166.50	45.1	-282.1	539.7	532.5	7.22	74.767		
2,200.0	2,175.9	2,063.0	2,038.3	6.3	6.0	-166.46	49.3	-303.6	582.6	575.0	7.58	76.893		
2,300.0	2,273.8	2,153.4	2,126.0	6.7	6.4	-166.43	53.4	-325.0	625.4	617.5	7.93	78.822		
2,400.0	2,371.6	2,243.7	2,213.7	7.1	6.8	-166.40	57.6	-346.5	668.2	659.9	8.29	80.581		
2,500.0	2,469.4	2,334.1	2,301.4	7.5	7.2	-166.38	61.8	-367.9	711.0	702.4	8.65	82.190		
2,600.0	2,567.2	2,424.5	2,389.1	7.9	7.6	-166.35	66.0	-389.4	753.9	744.9	9.01	83.668		
2,700.0	2,665.0	2,514.8	2,476.7	8.3	8.0	-166.33	70.1	-410.9	796.7	787.3	9.37	85.029		
2,800.0	2,762.8	2,605.2	2,564.4	8.7	8.5	-166.31	74.3	-432.3	839.5	829.8	9.73	86.288		
2,900.0	2,860.7	2,695.6	2,652.1	9.1	8.9	-166.30	78.5	-453.8	882.3	872.3	10.09	87.455		
3,000.0	2,958.5	2,785.9	2,739.8	9.5	9.3	-166.28	82.6	-475.2	925.2	914.7	10.45	88.540		
3,100.0	3,056.3	2,876.3	2,827.5	9.9	9.7	-166.27	86.8	-496.7	968.0	957.2	10.81	89.551		
3,200.0	3,154.1	2,966.7	2,915.1	10.3	10.1	-166.26	91.0	-518.2	1,010.8	999.7	11.17	90.495		
3,300.0	3,251.9	3,057.0	3,002.8	10.7	10.5	-166.25	95.2	-539.6	1,053.6	1,042.1	11.53	91.379		
3,400.0	3,349.7	3,147.4	3,090.5	11.1	11.0	-166.24	99.3	-561.1	1,096.5	1,084.6	11.89	92.209		
3,500.0	3,447.5	3,237.8	3,178.2	11.5	11.4	-166.23	103.5	-582.5	1,139.3	1,127.0	12.25	92.988		
3,600.0	3,545.4	3,328.1	3,265.9	11.9	11.8	-166.22	107.7	-604.0	1,182.1	1,169.5	12.61	93.722		
3,700.0	3,643.2	3,418.5	3,353.6	12.3	12.2	-166.21	111.8	-625.5	1,225.0	1,212.0	12.97	94.414		
3,800.0	3,741.0	3,508.9	3,441.2	12.7	12.6	-166.20	116.0	-646.9	1,267.8	1,254.4	13.34	95.068		

Anticollision Report

Company:	EnCana Oil & Gas (USA) Inc	Local Co-ordinate Reference:	Well Devore 1G-34H
Project:	DJ Wattenberg	TVD Reference:	WELL @ 4974.0ft (Original Well Elev)
Reference Site:	S34-T3N-R66W (Devore)	MD Reference:	WELL @ 4974.0ft (Original Well Elev)
Site Error:	0.0ft	North Reference:	True
Reference Well:	Devore 1G-34H	Survey Calculation Method:	Minimum Curvature
Well Error:	0.0ft	Output errors are at	2.00 sigma
Reference Wellbore	Hz	Database:	USA EDM 5000 Multi Users DB
Reference Design:	Plan #1	Offset TVD Reference:	Offset Datum

Offset Design S34-T3N-R66W (Devore) - Devore 1C-34H - Hz - Plan #1													Offset Site Error:	0.0 ft
Survey Program: 0-MWD													Offset Well Error:	0.0 ft
Reference		Offset		Semi Major Axis		Highside Toolface (°)	Distance		Total Uncertainty Axis	Separation Factor	Warning			
Measured Depth (ft)	Vertical Depth (ft)	Measured Depth (ft)	Vertical Depth (ft)	Reference (ft)	Offset (ft)		Offset Wellbore Centre +N/-S (ft)	+E/-W (ft)						
0.0	0.0	0.0	0.0	0.0	0.0	-89.95	0.0	-39.1	39.1					
100.0	100.0	100.0	100.0	0.2	0.2	-89.95	0.0	-39.1	39.1	38.8	0.30	128.795		
200.0	200.0	200.0	200.0	0.3	0.3	-89.95	0.0	-39.1	39.1	38.5	0.65	59.920		
300.0	300.0	300.0	300.0	0.5	0.5	-89.95	0.0	-39.1	39.1	38.1	1.00	39.042 CC, ES		
400.0	400.0	400.0	400.0	0.7	0.7	-165.86	0.0	-39.1	40.0	38.6	1.35	29.582		
500.0	500.0	499.3	499.3	0.9	0.8	-166.29	0.3	-39.9	43.3	41.6	1.70	25.500		
600.0	599.9	598.3	598.2	1.0	1.0	-166.41	1.2	-42.3	50.0	47.9	2.05	24.427 SF		
700.0	699.7	696.9	696.8	1.2	1.2	-166.29	2.7	-46.3	59.9	57.5	2.39	25.043		
800.0	799.4	795.0	794.6	1.4	1.4	-166.04	4.7	-51.9	73.2	70.4	2.74	26.698		
900.0	898.9	892.3	891.7	1.7	1.6	-165.75	7.3	-59.0	89.7	86.6	3.09	29.031		
1,000.0	998.3	988.8	987.7	1.9	1.8	-165.46	10.4	-67.5	109.4	106.0	3.44	31.827		
1,100.0	1,097.4	1,084.2	1,082.6	2.2	2.0	-165.18	14.0	-77.5	132.3	128.5	3.79	34.946		
1,200.0	1,196.3	1,178.5	1,176.1	2.5	2.3	-164.92	18.1	-88.7	158.4	154.2	4.14	38.293		
1,300.0	1,294.9	1,271.5	1,268.1	2.8	2.6	-164.68	22.7	-101.3	187.5	183.0	4.49	41.803		
1,400.0	1,393.3	1,363.1	1,358.6	3.2	2.8	-164.47	27.7	-115.0	219.7	214.9	4.84	45.428		
1,500.0	1,491.2	1,453.2	1,447.3	3.5	3.1	-164.27	33.1	-129.8	254.9	249.7	5.19	49.130		
1,600.0	1,589.1	1,541.9	1,534.4	3.9	3.4	-164.15	38.8	-145.7	292.3	286.7	5.55	52.642		
1,700.0	1,686.9	1,629.6	1,620.2	4.3	3.8	-163.97	45.0	-162.6	331.0	325.1	5.92	55.933		
1,800.0	1,784.7	1,717.2	1,705.7	4.7	4.1	-163.75	51.6	-180.7	371.0	364.7	6.29	59.019		
1,900.0	1,882.5	1,808.7	1,794.8	5.1	4.5	-163.55	58.6	-200.1	411.4	404.8	6.66	61.745		
2,000.0	1,980.3	1,900.1	1,883.9	5.5	4.9	-163.39	65.7	-219.4	451.9	444.8	7.04	64.166		
2,100.0	2,078.1	1,991.6	1,973.0	5.9	5.3	-163.25	72.7	-238.7	492.3	484.9	7.42	66.329		
2,200.0	2,175.9	2,083.0	2,062.1	6.3	5.6	-163.13	79.7	-258.1	532.8	525.0	7.80	68.273		
2,300.0	2,273.8	2,174.5	2,151.2	6.7	6.0	-163.03	86.8	-277.4	573.2	565.0	8.19	70.028		
2,400.0	2,371.6	2,265.9	2,240.3	7.1	6.4	-162.94	93.8	-296.7	613.7	605.1	8.57	71.620		
2,500.0	2,469.4	2,357.4	2,329.4	7.5	6.8	-162.86	100.8	-316.1	654.1	645.2	8.95	73.071		
2,600.0	2,567.2	2,448.8	2,418.5	7.9	7.2	-162.79	107.9	-335.4	694.6	685.2	9.34	74.399		
2,700.0	2,665.0	2,540.3	2,507.6	8.3	7.6	-162.73	114.9	-354.7	735.0	725.3	9.72	75.618		
2,800.0	2,762.8	2,631.7	2,596.7	8.7	8.0	-162.68	121.9	-374.1	775.5	765.4	10.11	76.740		
2,900.0	2,860.7	2,723.2	2,685.8	9.1	8.4	-162.63	129.0	-393.4	815.9	805.5	10.49	77.777		
3,000.0	2,958.5	2,814.6	2,774.9	9.5	8.8	-162.59	136.0	-412.7	856.4	845.5	10.88	78.738		
3,100.0	3,056.3	2,915.9	2,873.7	9.9	9.2	-162.55	143.7	-433.8	896.6	885.3	11.28	79.479		
3,200.0	3,154.1	3,024.7	2,980.2	10.3	9.6	-162.55	151.3	-454.7	935.2	923.5	11.69	79.968		
3,300.0	3,251.9	3,135.2	3,088.7	10.7	10.0	-162.59	158.3	-474.0	972.1	960.0	12.11	80.288		
3,400.0	3,349.7	3,247.2	3,199.2	11.1	10.4	-162.67	164.7	-491.5	1,007.3	994.8	12.52	80.457		
3,500.0	3,447.5	3,360.7	3,311.5	11.5	10.7	-162.79	170.4	-507.2	1,040.8	1,027.8	12.93	80.488		
3,600.0	3,545.4	3,475.8	3,425.6	11.9	11.0	-162.94	175.4	-521.0	1,072.4	1,059.1	13.34	80.395		
3,700.0	3,643.2	3,592.2	3,541.3	12.3	11.3	-163.11	179.7	-532.7	1,102.3	1,088.5	13.75	80.188		
3,800.0	3,741.0	3,709.9	3,658.6	12.7	11.5	-163.32	183.2	-542.3	1,130.3	1,116.1	14.15	79.880		
3,900.0	3,838.8	3,828.9	3,777.4	13.2	11.7	-163.56	185.9	-549.7	1,156.4	1,141.8	14.55	79.479		
4,000.0	3,936.6	3,949.1	3,897.4	13.6	11.9	-163.83	187.8	-554.9	1,180.6	1,165.6	14.95	78.994		
4,100.0	4,034.4	4,070.3	4,018.6	14.0	12.1	-164.12	188.8	-557.7	1,202.9	1,187.5	15.34	78.431		
4,200.0	4,132.2	4,184.0	4,132.2	14.4	12.2	-164.42	189.0	-558.2	1,223.3	1,207.6	15.71	77.860		
4,300.0	4,230.1	4,281.8	4,230.1	14.8	12.3	-164.68	189.0	-558.2	1,243.4	1,227.3	16.06	77.415		
4,400.0	4,327.9	4,379.6	4,327.9	15.2	12.4	-164.93	189.0	-558.2	1,263.5	1,247.1	16.41	76.994		

Anticollision Report

Company:	EnCana Oil & Gas (USA) Inc	Local Co-ordinate Reference:	Well Devore 1G-34H
Project:	DJ Wattenberg	TVD Reference:	WELL @ 4974.0ft (Original Well Elev)
Reference Site:	S34-T3N-R66W (Devore)	MD Reference:	WELL @ 4974.0ft (Original Well Elev)
Site Error:	0.0ft	North Reference:	True
Reference Well:	Devore 1G-34H	Survey Calculation Method:	Minimum Curvature
Well Error:	0.0ft	Output errors are at	2.00 sigma
Reference Wellbore	Hz	Database:	USA EDM 5000 Multi Users DB
Reference Design:	Plan #1	Offset TVD Reference:	Offset Datum

Offset Design S34-T3N-R66W (Devore) - Devore 1D-34H - Hz - Plan #1													Offset Site Error:	0.0 ft
Survey Program: 0-MWD													Offset Well Error:	0.0 ft
Reference		Offset		Semi Major Axis		Highside Toolface (°)	Distance		Total Uncertainty Axis	Separation Factor	Warning			
Measured Depth (ft)	Vertical Depth (ft)	Measured Depth (ft)	Vertical Depth (ft)	Reference (ft)	Offset (ft)		Offset Wellbore Centre +N/-S (ft)	+E/-W (ft)						
0.0	0.0	0.0	0.0	0.0	0.0	-89.95	0.0	-30.7	30.7					
100.0	100.0	100.0	100.0	0.2	0.2	-89.95	0.0	-30.7	30.7	30.4	0.30	101.196		
200.0	200.0	200.0	200.0	0.3	0.3	-89.95	0.0	-30.7	30.7	30.1	0.65	47.080		
300.0	300.0	300.0	300.0	0.5	0.5	-89.95	0.0	-30.7	30.7	29.7	1.00	30.676	CC, ES	
400.0	400.0	400.0	400.0	0.7	0.7	-165.95	0.0	-30.7	31.6	30.2	1.35	23.377		
500.0	500.0	500.0	500.0	0.9	0.8	-167.01	0.0	-30.7	34.1	32.4	1.70	20.077		
600.0	599.9	599.5	599.5	1.0	1.0	-167.43	0.7	-31.3	38.9	36.9	2.05	18.998		
700.0	699.7	698.7	698.7	1.2	1.2	-166.50	2.7	-32.9	46.4	44.0	2.40	19.371		
800.0	799.4	797.6	797.5	1.4	1.4	-164.89	6.0	-35.6	56.7	54.0	2.75	20.635		
900.0	898.9	896.0	895.7	1.7	1.6	-163.09	10.7	-39.3	69.9	66.8	3.11	22.479		
1,000.0	998.3	993.8	993.2	1.9	1.8	-161.37	16.6	-44.1	85.8	82.4	3.47	24.707		
1,100.0	1,097.4	1,090.9	1,089.8	2.2	2.0	-159.82	23.7	-49.9	104.6	100.8	3.85	27.185		
1,200.0	1,196.3	1,187.1	1,185.5	2.5	2.2	-158.47	32.0	-56.6	126.3	122.0	4.23	29.818		
1,300.0	1,294.9	1,282.4	1,280.0	2.8	2.5	-157.31	41.5	-64.3	150.7	146.0	4.63	32.534		
1,400.0	1,393.3	1,376.6	1,373.2	3.2	2.7	-156.30	52.0	-72.9	177.9	172.8	5.04	35.281		
1,500.0	1,491.2	1,469.7	1,465.0	3.5	3.0	-155.42	63.6	-82.2	207.8	202.3	5.46	38.022		
1,600.0	1,589.1	1,563.7	1,557.6	3.9	3.3	-154.74	76.3	-92.5	239.3	233.4	5.91	40.517		
1,700.0	1,686.9	1,658.5	1,651.0	4.3	3.6	-154.21	89.1	-102.8	271.0	264.7	6.36	42.628		
1,800.0	1,784.7	1,753.3	1,744.4	4.7	3.9	-153.79	101.9	-113.2	302.7	295.9	6.81	44.432		
1,900.0	1,882.5	1,848.1	1,837.8	5.1	4.2	-153.45	114.7	-123.6	334.4	327.1	7.27	45.990		
2,000.0	1,980.3	1,943.0	1,931.2	5.5	4.5	-153.16	127.5	-133.9	366.1	358.4	7.73	47.346		
2,100.0	2,078.1	2,041.1	2,027.9	5.9	4.8	-152.95	140.4	-144.4	397.6	389.4	8.20	48.490		
2,200.0	2,175.9	2,142.0	2,127.6	6.3	5.2	-152.91	152.6	-154.3	427.9	419.2	8.66	49.394		
2,300.0	2,273.8	2,243.8	2,228.4	6.7	5.4	-153.02	163.4	-163.0	456.8	447.7	9.12	50.111		
2,400.0	2,371.6	2,346.4	2,330.3	7.1	5.7	-153.26	172.9	-170.7	484.5	474.9	9.56	50.676		
2,500.0	2,469.4	2,449.8	2,433.1	7.5	5.9	-153.61	181.0	-177.3	510.8	500.8	9.99	51.116		
2,600.0	2,567.2	2,553.8	2,536.8	7.9	6.2	-154.06	187.8	-182.8	535.8	525.4	10.41	51.455		
2,700.0	2,665.0	2,658.5	2,641.2	8.3	6.4	-154.60	193.1	-187.1	559.5	548.7	10.82	51.713		
2,800.0	2,762.8	2,763.7	2,746.3	8.7	6.6	-155.22	196.9	-190.2	581.9	570.7	11.21	51.905		
2,900.0	2,860.7	2,869.4	2,852.0	9.1	6.7	-155.93	199.3	-192.1	603.0	591.4	11.59	52.045		
3,000.0	2,958.5	2,975.5	2,958.1	9.5	6.9	-156.70	200.1	-192.7	622.8	610.9	11.95	52.138		
3,100.0	3,056.3	3,073.7	3,056.3	9.9	7.0	-157.44	200.1	-192.7	642.0	629.8	12.29	52.246		
3,200.0	3,154.1	3,171.5	3,154.1	10.3	7.1	-158.13	200.1	-192.7	661.3	648.7	12.63	52.367		
3,300.0	3,251.9	3,269.3	3,251.9	10.7	7.3	-158.78	200.1	-192.7	680.7	667.8	12.97	52.496		
3,400.0	3,349.7	3,367.2	3,349.7	11.1	7.4	-159.39	200.1	-192.7	700.2	686.9	13.30	52.632		
3,500.0	3,447.5	3,465.0	3,447.5	11.5	7.5	-159.97	200.1	-192.7	719.8	706.1	13.64	52.772		
3,600.0	3,545.4	3,562.8	3,545.4	11.9	7.7	-160.52	200.1	-192.7	739.4	725.4	13.97	52.915		
3,700.0	3,643.2	3,660.6	3,643.2	12.3	7.8	-161.04	200.1	-192.7	759.1	744.8	14.31	53.059		
3,800.0	3,741.0	3,758.4	3,741.0	12.7	7.9	-161.54	200.1	-192.7	778.8	764.2	14.64	53.204		
3,900.0	3,838.8	3,856.2	3,838.8	13.2	8.1	-162.01	200.1	-192.7	798.6	783.6	14.97	53.349		
4,000.0	3,936.6	3,954.0	3,936.6	13.6	8.2	-162.46	200.1	-192.7	818.4	803.1	15.30	53.492		
4,100.0	4,034.4	4,051.9	4,034.4	14.0	8.4	-162.89	200.1	-192.7	838.3	822.7	15.63	53.635		
4,200.0	4,132.2	4,149.7	4,132.2	14.4	8.5	-163.29	200.1	-192.7	858.2	842.3	15.96	53.775		
4,300.0	4,230.1	4,247.5	4,230.1	14.8	8.7	-163.68	200.1	-192.7	878.2	861.9	16.29	53.913		
4,400.0	4,327.9	4,345.3	4,327.9	15.2	8.8	-164.06	200.1	-192.7	898.2	881.6	16.62	54.049		
4,500.0	4,425.7	4,443.1	4,425.7	15.6	9.0	-164.43	200.1	-192.7	918.1	901.2	16.96	54.146		
4,600.0	4,523.8	4,541.3	4,523.8	16.0	9.1	-164.80	200.1	-192.7	936.7	919.4	17.30	54.131		
4,700.0	4,622.3	4,639.7	4,622.3	16.3	9.3	-165.12	200.1	-192.7	953.7	936.0	17.65	54.033		
4,800.0	4,721.0	4,738.5	4,721.0	16.6	9.4	-165.40	200.1	-192.7	969.0	951.0	17.99	53.855		
4,900.0	4,820.0	4,837.5	4,820.0	16.9	9.6	-165.64	200.1	-192.7	982.6	964.3	18.33	53.602		
5,000.0	4,919.3	4,936.7	4,919.3	17.2	9.7	-165.84	200.1	-192.7	994.6	975.9	18.67	53.277		
5,100.0	5,018.7	5,036.1	5,018.7	17.4	9.9	-166.02	200.1	-192.7	1,004.9	985.9	19.00	52.883		

CC - Min centre to center distance or convergent point, SF - min separation factor, ES - min ellipse separation

Anticollision Report

Company:	EnCana Oil & Gas (USA) Inc	Local Co-ordinate Reference:	Well Devore 1G-34H
Project:	DJ Wattenberg	TVD Reference:	WELL @ 4974.0ft (Original Well Elev)
Reference Site:	S34-T3N-R66W (Devore)	MD Reference:	WELL @ 4974.0ft (Original Well Elev)
Site Error:	0.0ft	North Reference:	True
Reference Well:	Devore 1G-34H	Survey Calculation Method:	Minimum Curvature
Well Error:	0.0ft	Output errors are at	2.00 sigma
Reference Wellbore	Hz	Database:	USA EDM 5000 Multi Users DB
Reference Design:	Plan #1	Offset TVD Reference:	Offset Datum

Offset Design S34-T3N-R66W (Devore) - Devore 1D-34H - Hz - Plan #1													Offset Site Error:	0.0 ft
Survey Program: 0-MWD													Offset Well Error:	0.0 ft
Reference		Offset		Semi Major Axis			Distance				Total Uncertainty Axis	Separation Factor	Warning	
Measured Depth (ft)	Vertical Depth (ft)	Measured Depth (ft)	Vertical Depth (ft)	Reference (ft)	Offset (ft)	Highside Toolface (°)	Offset Wellbore Centre +N/-S (ft)	+E/-W (ft)	Between Centres (ft)	Between Ellipses (ft)				
5,200.0	5,118.3	5,135.7	5,118.3	17.6	10.0	-166.16	200.1	-192.7	1,013.6	994.2	19.33	52.423		
5,300.0	5,218.0	5,235.5	5,218.0	17.8	10.2	-166.27	200.1	-192.7	1,020.5	1,000.8	19.66	51.902		
5,400.0	5,317.9	5,335.3	5,317.9	18.0	10.3	-166.36	200.1	-192.7	1,025.8	1,005.8	19.99	51.321		
5,500.0	5,417.8	5,435.3	5,417.8	18.1	10.5	-166.41	200.1	-192.7	1,029.3	1,009.0	20.31	50.683		
5,600.0	5,517.8	5,535.2	5,517.8	18.2	10.6	-166.44	200.1	-192.7	1,031.2	1,010.6	20.63	49.991		
5,700.0	5,617.8	5,635.2	5,617.8	18.3	10.8	-90.85	200.1	-192.7	1,031.5	1,010.5	21.02	49.062		
5,800.0	5,717.8	5,735.2	5,717.8	18.4	11.0	-90.85	200.1	-192.7	1,031.5	1,010.1	21.35	48.309		
5,900.0	5,817.8	5,835.2	5,817.8	18.5	11.1	-90.85	200.1	-192.7	1,031.5	1,009.8	21.68	47.576		
6,000.0	5,917.8	5,935.2	5,917.8	18.6	11.3	-90.85	200.1	-192.7	1,031.5	1,009.5	22.01	46.864		
6,100.0	6,017.8	6,035.2	6,017.8	18.7	11.4	-90.85	200.1	-192.7	1,031.5	1,009.1	22.34	46.172		
6,200.0	6,117.8	6,135.2	6,117.8	18.8	11.6	-90.85	200.1	-192.7	1,031.5	1,008.8	22.67	45.499		
6,300.0	6,217.8	6,235.2	6,217.8	18.9	11.8	-90.85	200.1	-192.7	1,031.5	1,008.5	23.00	44.844		
6,400.0	6,317.8	6,335.2	6,317.8	19.0	11.9	-90.85	200.1	-192.7	1,031.5	1,008.2	23.33	44.207		
6,500.0	6,417.8	6,435.2	6,417.8	19.1	12.1	-90.85	200.1	-192.7	1,031.5	1,007.8	23.67	43.586		
6,508.8	6,426.6	6,444.0	6,426.6	19.1	12.1	-90.85	200.1	-192.7	1,031.5	1,007.8	23.69	43.533		
6,600.0	6,517.8	6,532.9	6,515.4	19.2	12.2	-91.01	197.2	-192.8	1,031.6	1,007.6	23.96	43.059		
6,700.0	6,617.8	6,627.1	6,608.4	19.3	12.3	-91.82	182.5	-192.9	1,032.1	1,007.9	24.14	42.750		
6,800.0	6,717.8	6,716.3	6,693.9	19.4	12.3	87.78	157.6	-193.1	1,033.6	1,009.4	24.19	42.723		
6,900.0	6,817.1	6,800.0	6,770.8	19.5	12.3	86.23	124.6	-193.4	1,036.3	1,012.0	24.24	42.742		
7,000.0	6,913.8	6,885.1	6,844.5	19.5	12.4	84.69	82.1	-193.8	1,039.8	1,015.5	24.31	42.782		
7,100.0	7,006.2	6,966.4	6,909.7	19.5	12.5	83.28	33.7	-194.2	1,044.1	1,019.6	24.43	42.730		
7,200.0	7,092.3	7,050.0	6,970.7	19.5	12.6	81.93	-23.5	-194.7	1,048.7	1,024.0	24.70	42.459		
7,300.0	7,170.5	7,124.3	7,018.9	19.6	12.9	80.80	-80.0	-195.2	1,053.6	1,028.5	25.12	41.939		
7,400.0	7,239.3	7,200.0	7,061.7	19.8	13.2	79.79	-142.3	-195.7	1,058.5	1,032.7	25.73	41.133		
7,500.0	7,297.3	7,277.9	7,098.7	20.0	13.6	78.92	-210.9	-196.3	1,063.1	1,036.5	26.58	39.990		
7,600.0	7,343.5	7,350.0	7,126.1	20.4	14.1	78.25	-277.5	-196.9	1,067.3	1,039.7	27.61	38.657		
7,700.0	7,376.9	7,429.1	7,148.2	20.9	14.8	77.74	-353.4	-197.6	1,071.0	1,042.1	28.92	37.037		
7,800.0	7,396.8	7,500.0	7,160.9	21.6	15.5	77.43	-423.1	-198.2	1,074.0	1,043.7	30.35	35.392		
7,900.0	7,403.0	7,579.3	7,166.8	22.4	16.4	77.32	-502.2	-198.9	1,076.3	1,044.3	32.06	33.572		
8,000.0	7,403.0	7,674.7	7,167.0	23.3	17.5	77.36	-597.6	-199.7	1,078.9	1,044.5	34.34	31.417		
8,100.0	7,403.0	7,774.7	7,167.0	24.3	18.7	77.39	-697.5	-200.6	1,081.4	1,044.6	36.83	29.358		
8,200.0	7,403.0	7,874.6	7,167.0	25.3	20.1	77.42	-797.5	-201.5	1,084.0	1,044.5	39.47	27.463		
8,300.0	7,403.0	7,974.6	7,167.0	26.5	21.5	77.45	-897.4	-202.3	1,086.5	1,044.3	42.22	25.735		
8,400.0	7,403.0	8,074.6	7,167.0	27.7	22.9	77.48	-997.4	-203.2	1,089.1	1,044.0	45.06	24.168		
8,500.0	7,403.0	8,174.5	7,167.0	28.9	24.4	77.51	-1,097.4	-204.1	1,091.6	1,043.7	47.98	22.750		
8,600.0	7,403.0	8,274.5	7,167.0	30.3	25.9	77.54	-1,197.3	-204.9	1,094.2	1,043.2	50.97	21.468		
8,700.0	7,403.0	8,374.4	7,167.0	31.6	27.5	77.57	-1,297.3	-205.8	1,096.7	1,042.7	54.01	20.308		
8,800.0	7,403.0	8,474.4	7,167.0	33.0	29.0	77.60	-1,397.3	-206.7	1,099.3	1,042.2	57.09	19.256		
8,900.0	7,403.0	8,574.4	7,167.0	34.4	30.6	77.63	-1,497.2	-207.6	1,101.9	1,041.7	60.21	18.300		
9,000.0	7,403.0	8,674.3	7,167.0	35.9	32.2	77.66	-1,597.2	-208.4	1,104.4	1,041.1	63.37	17.429		
9,100.0	7,403.0	8,774.3	7,167.0	37.4	33.9	77.68	-1,697.1	-209.3	1,107.0	1,040.4	66.55	16.634		
9,200.0	7,403.0	8,874.3	7,167.0	38.9	35.5	77.71	-1,797.1	-210.2	1,109.5	1,039.8	69.76	15.906		
9,300.0	7,403.0	8,974.2	7,167.0	40.4	37.1	77.74	-1,897.1	-211.0	1,112.1	1,039.1	72.99	15.237		
9,400.0	7,403.0	9,074.2	7,167.0	42.0	38.8	77.77	-1,997.0	-211.9	1,114.7	1,038.4	76.23	14.622		
9,500.0	7,403.0	9,174.2	7,167.0	43.5	40.5	77.80	-2,097.0	-212.8	1,117.2	1,037.7	79.50	14.054		
9,600.0	7,403.0	9,274.1	7,167.0	45.1	42.1	77.83	-2,197.0	-213.7	1,119.8	1,037.0	82.77	13.528		
9,700.0	7,403.0	9,374.1	7,167.0	46.7	43.8	77.86	-2,296.9	-214.5	1,122.3	1,036.3	86.07	13.040		
9,800.0	7,403.0	9,474.1	7,167.0	48.3	45.5	77.88	-2,396.9	-215.4	1,124.9	1,035.5	89.37	12.587		
9,900.0	7,403.0	9,574.0	7,167.0	49.9	47.2	77.91	-2,496.8	-216.3	1,127.4	1,034.8	92.67	12.166		
10,000.0	7,403.0	9,693.3	7,167.0	51.5	49.2	77.92	-2,616.1	-216.5	1,128.4	1,032.2	96.12	11.739		
10,100.0	7,403.0	9,796.9	7,167.0	53.1	50.9	77.90	-2,719.7	-215.2	1,126.3	1,027.0	99.27	11.345		
10,200.0	7,403.0	9,896.8	7,167.0	54.7	52.6	77.86	-2,819.6	-214.0	1,122.7	1,020.2	102.49	10.954		

CC - Min centre to center distance or convergent point, SF - min separation factor, ES - min ellipse separation

Anticollision Report

Company:	EnCana Oil & Gas (USA) Inc	Local Co-ordinate Reference:	Well Devore 1G-34H
Project:	DJ Wattenberg	TVD Reference:	WELL @ 4974.0ft (Original Well Elev)
Reference Site:	S34-T3N-R66W (Devore)	MD Reference:	WELL @ 4974.0ft (Original Well Elev)
Site Error:	0.0ft	North Reference:	True
Reference Well:	Devore 1G-34H	Survey Calculation Method:	Minimum Curvature
Well Error:	0.0ft	Output errors are at	2.00 sigma
Reference Wellbore	Hz	Database:	USA EDM 5000 Multi Users DB
Reference Design:	Plan #1	Offset TVD Reference:	Offset Datum

Offset Design S34-T3N-R66W (Devore) - Devore 1D-34H - Hz - Plan #1													Offset Site Error:	0.0 ft
Survey Program: 0-MWD													Offset Well Error:	0.0 ft
Reference		Offset		Semi Major Axis			Distance							Warning
Measured Depth (ft)	Vertical Depth (ft)	Measured Depth (ft)	Vertical Depth (ft)	Reference (ft)	Offset (ft)	Highside Toolface (°)	Offset Wellbore Centre +N/-S (ft)	+E/-W (ft)	Between Centres (ft)	Between Ellipses (ft)	Total Uncertainty Axis	Separation Factor		
10,300.0	7,403.0	9,996.7	7,167.0	56.4	54.3	77.82	-2,919.5	-212.8	1,119.1	1,013.3	105.81	10.576		
10,400.0	7,403.0	10,096.7	7,167.0	58.0	56.0	77.77	-3,019.4	-211.6	1,115.4	1,006.3	109.13	10.221		
10,500.0	7,403.0	10,196.6	7,167.0	59.6	57.8	77.73	-3,119.4	-210.4	1,111.7	999.3	112.46	9.886		
10,600.0	7,403.0	10,296.5	7,167.0	61.3	59.5	77.69	-3,219.3	-209.2	1,108.1	992.3	115.79	9.570		
10,700.0	7,403.0	10,396.5	7,167.0	62.9	61.2	77.65	-3,319.2	-208.0	1,104.4	985.3	119.12	9.271		
10,800.0	7,403.0	10,496.4	7,167.0	64.6	62.9	77.61	-3,419.1	-206.8	1,100.7	978.3	122.46	8.989		
10,900.0	7,403.0	10,596.3	7,167.0	66.2	64.6	77.57	-3,519.0	-205.7	1,097.1	971.3	125.80	8.721		
11,000.0	7,403.0	10,696.2	7,167.0	67.9	66.3	77.53	-3,619.0	-204.5	1,093.4	964.3	129.14	8.467		
11,100.0	7,403.0	10,796.2	7,167.0	69.6	68.1	77.48	-3,718.9	-203.3	1,089.8	957.3	132.48	8.226		
11,200.0	7,403.0	10,896.1	7,167.0	71.2	69.8	77.44	-3,818.8	-202.1	1,086.1	950.3	135.83	7.996		
11,300.0	7,403.0	10,996.0	7,167.0	72.9	71.5	77.40	-3,918.7	-200.9	1,082.4	943.3	139.18	7.778		
11,400.0	7,403.0	11,096.0	7,167.0	74.6	73.2	77.35	-4,018.7	-199.7	1,078.8	936.3	142.52	7.569		
11,500.0	7,403.0	11,195.9	7,167.0	76.3	74.9	77.31	-4,118.6	-198.5	1,075.1	929.3	145.87	7.370		
11,600.0	7,403.0	11,295.8	7,167.0	78.0	76.7	77.27	-4,218.5	-197.3	1,071.5	922.2	149.22	7.180		
11,700.0	7,403.0	11,395.7	7,167.0	79.7	78.4	77.22	-4,318.4	-196.1	1,067.8	915.2	152.57	6.999		
11,800.0	7,403.0	11,495.7	7,167.0	81.4	80.1	77.18	-4,418.3	-194.9	1,064.2	908.2	155.92	6.825		
11,900.0	7,403.0	11,595.6	7,167.0	83.1	81.9	77.13	-4,518.3	-193.7	1,060.5	901.2	159.28	6.658		
11,973.1	7,403.0	11,667.2	7,167.0	84.3	83.1	77.10	-4,589.9	-192.8	1,057.8	896.1	161.70	6.542 SF		

Anticollision Report

Company:	EnCana Oil & Gas (USA) Inc	Local Co-ordinate Reference:	Well Devore 1G-34H
Project:	DJ Wattenberg	TVD Reference:	WELL @ 4974.0ft (Original Well Elev)
Reference Site:	S34-T3N-R66W (Devore)	MD Reference:	WELL @ 4974.0ft (Original Well Elev)
Site Error:	0.0ft	North Reference:	True
Reference Well:	Devore 1G-34H	Survey Calculation Method:	Minimum Curvature
Well Error:	0.0ft	Output errors are at	2.00 sigma
Reference Wellbore	Hz	Database:	USA EDM 5000 Multi Users DB
Reference Design:	Plan #1	Offset TVD Reference:	Offset Datum

Offset Design S34-T3N-R66W (Devore) - Devore 1E-34H - Hz - Plan #1													Offset Site Error:	0.0 ft
Survey Program: 0-MWD													Offset Well Error:	0.0 ft
Reference		Offset		Semi Major Axis		Highside Toolface (°)	Distance		Total Uncertainty Axis	Separation Factor	Warning			
Measured Depth (ft)	Vertical Depth (ft)	Measured Depth (ft)	Vertical Depth (ft)	Reference (ft)	Offset (ft)		Offset Wellbore Centre +N/-S (ft)	+E/-W (ft)						
0.0	0.0	0.0	0.0	0.0	0.0	-89.95	0.0	-19.6	19.6					
100.0	100.0	100.0	100.0	0.2	0.2	-89.95	0.0	-19.6	19.6	19.3	0.30	64.397		
200.0	200.0	200.0	200.0	0.3	0.3	-89.95	0.0	-19.6	19.6	18.9	0.65	29.960		
300.0	300.0	300.0	300.0	0.5	0.5	-89.95	0.0	-19.6	19.6	18.6	1.00	19.521 CC, ES		
400.0	400.0	400.0	400.0	0.7	0.7	-166.16	0.0	-19.6	20.4	19.1	1.35	15.104		
500.0	500.0	500.0	500.0	0.9	0.8	-167.72	0.0	-19.6	23.0	21.3	1.70	13.505		
600.0	599.9	599.9	599.9	1.0	1.0	-169.66	0.0	-19.6	27.2	25.2	2.05	13.297		
700.0	699.7	700.1	700.1	1.2	1.2	-170.49	0.7	-19.0	32.6	30.2	2.40	13.615		
800.0	799.4	800.4	800.3	1.4	1.4	-169.66	2.7	-17.3	38.5	35.8	2.75	14.020		
900.0	898.9	900.6	900.5	1.7	1.6	-167.86	6.0	-14.4	44.9	41.8	3.10	14.479		
1,000.0	998.3	1,000.9	1,000.6	1.9	1.8	-165.49	10.7	-10.5	51.9	48.4	3.47	14.972		
1,100.0	1,097.4	1,101.2	1,100.6	2.2	2.0	-162.83	16.7	-5.4	59.5	55.7	3.84	15.480		
1,200.0	1,196.3	1,201.5	1,200.4	2.5	2.2	-160.06	24.0	0.9	67.9	63.6	4.25	15.983		
1,300.0	1,294.9	1,301.7	1,300.0	2.8	2.4	-157.27	32.7	8.3	77.0	72.3	4.68	16.460		
1,400.0	1,393.3	1,401.9	1,399.3	3.2	2.7	-154.56	42.7	16.8	87.0	81.8	5.15	16.893		
1,500.0	1,491.2	1,502.0	1,498.3	3.5	2.9	-151.95	54.0	26.4	97.9	92.2	5.67	17.269		
1,600.0	1,589.1	1,602.0	1,596.9	3.9	3.2	-149.31	66.6	37.1	108.9	102.7	6.24	17.448		
1,700.0	1,686.9	1,701.3	1,694.7	4.3	3.6	-146.81	79.7	48.3	119.8	113.0	6.85	17.498		
1,800.0	1,784.7	1,800.6	1,792.5	4.7	3.9	-144.72	92.8	59.4	130.9	123.4	7.47	17.519		
1,900.0	1,882.5	1,899.9	1,890.2	5.1	4.2	-142.97	106.0	70.6	142.2	134.0	8.11	17.524		
2,000.0	1,980.3	1,999.1	1,988.0	5.5	4.5	-141.47	119.1	81.8	153.5	144.7	8.76	17.519		
2,100.0	2,078.1	2,098.4	2,085.8	5.9	4.8	-140.18	132.2	93.0	165.0	155.5	9.42	17.508		
2,200.0	2,175.9	2,197.4	2,183.3	6.3	5.2	-139.09	145.2	104.0	176.5	166.4	10.08	17.508		
2,300.0	2,273.8	2,295.9	2,280.5	6.7	5.5	-138.56	157.1	114.2	188.4	177.7	10.70	17.615		
2,400.0	2,371.6	2,394.4	2,378.0	7.1	5.8	-138.56	167.7	123.2	200.8	189.5	11.27	17.820		
2,500.0	2,469.4	2,492.7	2,475.5	7.5	6.0	-139.00	177.1	131.1	213.5	201.7	11.79	18.115		
2,600.0	2,567.2	2,590.8	2,573.1	7.9	6.3	-139.81	185.1	138.0	226.7	214.5	12.26	18.495		
2,700.0	2,665.0	2,688.7	2,670.5	8.3	6.5	-140.91	191.9	143.7	240.4	227.8	12.68	18.962		
2,800.0	2,762.8	2,786.2	2,767.8	8.7	6.7	-142.26	197.4	148.4	254.7	241.7	13.05	19.517		
2,900.0	2,860.7	2,883.5	2,864.9	9.1	6.9	-143.79	201.6	152.0	269.7	256.3	13.38	20.163		
3,000.0	2,958.5	2,980.3	2,961.6	9.5	7.0	-145.47	204.5	154.5	285.4	271.8	13.65	20.904		
3,100.0	3,056.3	3,076.6	3,058.0	9.9	7.2	-147.26	206.2	155.9	302.0	288.1	13.89	21.743		
3,200.0	3,154.1	3,172.7	3,154.1	10.3	7.3	-149.13	206.6	156.3	319.6	305.5	14.09	22.673		
3,300.0	3,251.9	3,270.6	3,251.9	10.7	7.4	-150.93	206.6	156.3	337.7	323.4	14.29	23.625		
3,400.0	3,349.7	3,368.4	3,349.7	11.1	7.5	-152.55	206.6	156.3	356.1	341.6	14.50	24.556		
3,500.0	3,447.5	3,466.2	3,447.5	11.5	7.7	-154.01	206.6	156.3	374.7	360.0	14.72	25.461		
3,600.0	3,545.4	3,564.0	3,545.4	11.9	7.8	-155.33	206.6	156.3	393.6	378.7	14.94	26.340		
3,700.0	3,643.2	3,661.8	3,643.2	12.3	8.0	-156.53	206.6	156.3	412.7	397.5	15.18	27.189		
3,800.0	3,741.0	3,759.6	3,741.0	12.7	8.1	-157.63	206.6	156.3	431.9	416.4	15.42	28.010		
3,900.0	3,838.8	3,857.4	3,838.8	13.2	8.2	-158.63	206.6	156.3	451.2	435.6	15.67	28.801		
4,000.0	3,936.6	3,955.3	3,936.6	13.6	8.4	-159.55	206.6	156.3	470.7	454.8	15.92	29.562		
4,100.0	4,034.4	4,053.1	4,034.4	14.0	8.5	-160.40	206.6	156.3	490.3	474.1	16.18	30.295		
4,200.0	4,132.2	4,150.9	4,132.2	14.4	8.7	-161.18	206.6	156.3	510.0	493.5	16.45	31.001		
4,300.0	4,230.1	4,248.7	4,230.1	14.8	8.8	-161.90	206.6	156.3	529.7	513.0	16.72	31.679		
4,400.0	4,327.9	4,346.5	4,327.9	15.2	8.9	-162.58	206.6	156.3	549.6	532.6	17.00	32.331		
4,500.0	4,425.7	4,444.4	4,425.7	15.6	9.1	-163.22	206.6	156.3	569.3	552.1	17.28	32.942		
4,600.0	4,523.8	4,542.5	4,523.8	16.0	9.2	-163.81	206.6	156.3	587.8	570.3	17.58	33.439		
4,700.0	4,622.3	4,640.9	4,622.3	16.3	9.4	-164.32	206.6	156.3	604.7	586.8	17.88	33.822		
4,800.0	4,721.0	4,739.7	4,721.0	16.6	9.5	-164.76	206.6	156.3	620.0	601.8	18.18	34.096		
4,900.0	4,820.0	4,838.7	4,820.0	16.9	9.7	-165.13	206.6	156.3	633.6	615.1	18.49	34.268		
5,000.0	4,919.3	4,937.9	4,919.3	17.2	9.8	-165.44	206.6	156.3	645.5	626.8	18.80	34.342		
5,100.0	5,018.7	5,037.3	5,018.7	17.4	10.0	-165.70	206.6	156.3	655.8	636.7	19.11	34.325		

CC - Min centre to center distance or convergent point, SF - min separation factor, ES - min ellipse separation

Anticollision Report

Company:	EnCana Oil & Gas (USA) Inc	Local Co-ordinate Reference:	Well Devore 1G-34H
Project:	DJ Wattenberg	TVD Reference:	WELL @ 4974.0ft (Original Well Elev)
Reference Site:	S34-T3N-R66W (Devore)	MD Reference:	WELL @ 4974.0ft (Original Well Elev)
Site Error:	0.0ft	North Reference:	True
Reference Well:	Devore 1G-34H	Survey Calculation Method:	Minimum Curvature
Well Error:	0.0ft	Output errors are at	2.00 sigma
Reference Wellbore	Hz	Database:	USA EDM 5000 Multi Users DB
Reference Design:	Plan #1	Offset TVD Reference:	Offset Datum

Offset Design S34-T3N-R66W (Devore) - Devore 1E-34H - Hz - Plan #1													Offset Site Error:	0.0 ft
Survey Program: O-MWD													Offset Well Error:	0.0 ft
Reference		Offset		Semi Major Axis		Distance		Total		Separation		Warning		
Measured Depth (ft)	Vertical Depth (ft)	Measured Depth (ft)	Vertical Depth (ft)	Reference (ft)	Offset (ft)	Highside Toolface (°)	Offset Wellbore Centre +N/-S (ft)	+E/-W (ft)	Between Centres (ft)	Between Ellipses (ft)	Uncertainty Axis			
5,200.0	5,118.3	5,136.9	5,118.3	17.6	10.1	-165.91	206.6	156.3	664.5	645.0	19.42	34.221		
5,300.0	5,218.0	5,236.7	5,218.0	17.8	10.3	-166.07	206.6	156.3	671.4	651.7	19.73	34.034		
5,400.0	5,317.9	5,336.5	5,317.9	18.0	10.4	-166.20	206.6	156.3	676.7	656.6	20.04	33.769		
5,500.0	5,417.8	5,436.5	5,417.8	18.1	10.6	-166.28	206.6	156.3	680.2	659.9	20.35	33.430		
5,600.0	5,517.8	5,536.5	5,517.8	18.2	10.8	-166.32	206.6	156.3	682.1	661.4	20.66	33.020		
5,700.0	5,617.8	5,636.5	5,617.8	18.3	10.9	-90.73	206.6	156.3	682.4	661.3	21.08	32.364		
5,800.0	5,717.8	5,736.5	5,717.8	18.4	11.1	-90.73	206.6	156.3	682.4	661.0	21.41	31.869		
5,900.0	5,817.8	5,836.5	5,817.8	18.5	11.2	-90.73	206.6	156.3	682.4	660.6	21.74	31.389		
6,000.0	5,917.8	5,936.5	5,917.8	18.6	11.4	-90.73	206.6	156.3	682.4	660.3	22.07	30.921		
6,100.0	6,017.8	6,036.5	6,017.8	18.7	11.5	-90.73	206.6	156.3	682.4	660.0	22.40	30.467		
6,200.0	6,117.8	6,136.5	6,117.8	18.8	11.7	-90.73	206.6	156.3	682.4	659.7	22.73	30.025		
6,300.0	6,217.8	6,236.5	6,217.8	18.9	11.9	-90.73	206.6	156.3	682.4	659.3	23.06	29.595		
6,400.0	6,317.8	6,336.5	6,317.8	19.0	12.0	-90.73	206.6	156.3	682.4	659.0	23.39	29.176		
6,500.0	6,417.8	6,436.5	6,417.8	19.1	12.2	-90.73	206.6	156.3	682.4	658.7	23.72	28.769		
6,600.0	6,517.8	6,536.5	6,517.8	19.2	12.3	-90.73	206.6	156.3	682.4	658.3	24.05	28.372		
6,700.0	6,617.8	6,636.5	6,617.8	19.3	12.5	-90.73	206.6	156.3	682.4	658.0	24.38	27.985		
6,736.1	6,653.9	6,672.5	6,653.9	19.3	12.6	90.30	206.6	156.3	682.4	658.0	24.41	27.958		
6,800.0	6,717.8	6,735.9	6,717.2	19.4	12.6	90.20	205.2	156.3	682.4	657.8	24.59	27.749		
6,900.0	6,817.1	6,834.4	6,814.8	19.5	12.7	90.03	192.2	156.3	682.6	657.9	24.76	27.568		
7,000.0	6,913.8	6,932.7	6,909.5	19.5	12.8	89.85	166.1	156.3	683.1	658.3	24.84	27.496		
7,100.0	7,006.2	7,030.8	6,999.5	19.5	12.8	89.68	127.3	156.3	683.8	658.9	24.90	27.460		
7,200.0	7,092.3	7,128.8	7,083.3	19.5	12.8	89.51	76.7	156.3	684.7	659.7	25.02	27.368		
7,300.0	7,170.5	7,226.5	7,159.2	19.6	13.0	89.35	15.2	156.3	685.8	660.5	25.28	27.125		
7,400.0	7,239.3	7,324.2	7,226.0	19.8	13.2	89.21	-55.9	156.3	687.1	661.3	25.79	26.646		
7,500.0	7,297.3	7,421.9	7,282.5	20.0	13.6	89.08	-135.5	156.3	688.5	661.9	26.59	25.889		
7,600.0	7,343.5	7,519.5	7,327.7	20.4	14.1	88.97	-221.9	156.3	690.0	662.3	27.75	24.866		
7,700.0	7,376.9	7,617.2	7,360.7	20.9	14.8	88.87	-313.8	156.3	691.7	662.4	29.26	23.639		
7,800.0	7,396.8	7,714.9	7,381.0	21.6	15.7	88.80	-409.3	156.3	693.4	662.3	31.09	22.300		
7,900.0	7,403.0	7,812.7	7,388.0	22.4	16.8	88.76	-506.8	156.3	695.1	661.9	33.19	20.941		
8,000.0	7,403.0	7,912.7	7,388.0	23.3	17.9	88.77	-606.8	156.3	696.8	661.2	35.56	19.593		
8,100.0	7,403.0	8,012.7	7,388.0	24.3	19.2	88.77	-706.8	156.3	698.5	660.4	38.11	18.331		
8,200.0	7,403.0	8,112.6	7,388.0	25.3	20.5	88.77	-806.7	156.3	700.3	659.5	40.79	17.166		
8,300.0	7,403.0	8,212.6	7,388.0	26.5	21.9	88.77	-906.7	156.3	702.0	658.4	43.60	16.102		
8,400.0	7,403.0	8,312.6	7,388.0	27.7	23.3	88.78	-1,006.7	156.3	703.8	657.3	46.50	15.136		
8,500.0	7,403.0	8,412.6	7,388.0	28.9	24.8	88.78	-1,106.7	156.3	705.5	656.0	49.48	14.260		
8,600.0	7,403.0	8,512.6	7,388.0	30.3	26.3	88.78	-1,206.7	156.4	707.3	654.7	52.52	13.467		
8,700.0	7,403.0	8,612.6	7,388.0	31.6	27.8	88.79	-1,306.7	156.4	709.0	653.4	55.62	12.748		
8,800.0	7,403.0	8,712.6	7,388.0	33.0	29.4	88.79	-1,406.7	156.4	710.7	652.0	58.76	12.095		
8,900.0	7,403.0	8,812.5	7,388.0	34.4	31.0	88.79	-1,506.6	156.4	712.5	650.5	61.94	11.502		
9,000.0	7,403.0	8,912.5	7,388.0	35.9	32.6	88.80	-1,606.6	156.4	714.2	649.1	65.16	10.961		
9,100.0	7,403.0	9,012.5	7,388.0	37.4	34.2	88.80	-1,706.6	156.4	716.0	647.6	68.41	10.466		
9,200.0	7,403.0	9,112.5	7,388.0	38.9	35.8	88.80	-1,806.6	156.4	717.7	646.0	71.67	10.013		
9,300.0	7,403.0	9,212.5	7,388.0	40.4	37.5	88.80	-1,906.6	156.4	719.4	644.5	74.97	9.597		
9,400.0	7,403.0	9,312.5	7,388.0	42.0	39.1	88.81	-2,006.6	156.4	721.2	642.9	78.28	9.213		
9,500.0	7,403.0	9,412.4	7,388.0	43.5	40.8	88.81	-2,106.5	156.4	722.9	641.3	81.60	8.859		
9,600.0	7,403.0	9,512.4	7,388.0	45.1	42.4	88.81	-2,206.5	156.4	724.7	639.7	84.94	8.531		
9,700.0	7,403.0	9,612.4	7,388.0	46.7	44.1	88.82	-2,306.5	156.4	726.4	638.1	88.30	8.227		
9,800.0	7,403.0	9,712.4	7,388.0	48.3	45.8	88.82	-2,406.5	156.4	728.1	636.5	91.66	7.944		
9,900.0	7,403.0	9,812.4	7,388.0	49.9	47.5	88.82	-2,506.5	156.4	729.9	634.9	95.02	7.681		
10,000.0	7,403.0	9,912.4	7,388.0	51.5	49.2	88.82	-2,606.5	156.4	730.6	632.5	98.11	7.447		
10,100.0	7,403.0	10,012.4	7,388.0	53.1	50.8	88.82	-2,706.5	156.4	729.7	628.5	101.18	7.211		
10,200.0	7,403.0	10,112.3	7,388.0	54.7	52.5	88.82	-2,806.4	156.4	727.3	622.8	104.44	6.963		

CC - Min centre to center distance or convergent point, SF - min separation factor, ES - min ellipse separation

Anticollision Report

Company:	EnCana Oil & Gas (USA) Inc	Local Co-ordinate Reference:	Well Devore 1G-34H
Project:	DJ Wattenberg	TVD Reference:	WELL @ 4974.0ft (Original Well Elev)
Reference Site:	S34-T3N-R66W (Devore)	MD Reference:	WELL @ 4974.0ft (Original Well Elev)
Site Error:	0.0ft	North Reference:	True
Reference Well:	Devore 1G-34H	Survey Calculation Method:	Minimum Curvature
Well Error:	0.0ft	Output errors are at	2.00 sigma
Reference Wellbore	Hz	Database:	USA EDM 5000 Multi Users DB
Reference Design:	Plan #1	Offset TVD Reference:	Offset Datum

Offset Design S34-T3N-R66W (Devore) - Devore 1E-34H - Hz - Plan #1												Offset Site Error:	0.0 ft
Survey Program: 0-MWD												Offset Well Error:	0.0 ft
Reference		Offset		Semi Major Axis		Distance							
Measured Depth (ft)	Vertical Depth (ft)	Measured Depth (ft)	Vertical Depth (ft)	Reference (ft)	Offset (ft)	Highside Toolface (°)	Offset Wellbore Centre +N/-S (ft)	+E/-W (ft)	Between Centres (ft)	Between Ellipses (ft)	Total Uncertainty Axis	Separation Factor	Warning
10,300.0	7,403.0	10,212.3	7,388.0	56.4	54.2	88.81	-2,906.4	156.4	724.7	616.9	107.85	6.720	
10,400.0	7,403.0	10,312.3	7,388.0	58.0	55.9	88.81	-3,006.4	156.4	722.1	610.9	111.26	6.491	
10,500.0	7,403.0	10,412.2	7,388.0	59.6	57.7	88.80	-3,106.4	156.4	719.6	604.9	114.68	6.275	
10,600.0	7,403.0	10,512.2	7,388.0	61.3	59.4	88.80	-3,206.3	156.4	717.0	598.9	118.10	6.072	
10,700.0	7,403.0	10,612.2	7,388.0	62.9	61.1	88.80	-3,306.3	156.4	714.5	593.0	121.52	5.879	
10,800.0	7,403.0	10,712.2	7,388.0	64.6	62.8	88.79	-3,406.3	156.4	711.9	587.0	124.96	5.697	
10,900.0	7,403.0	10,812.1	7,388.0	66.2	64.5	88.79	-3,506.2	156.4	709.4	581.0	128.39	5.525	
11,000.0	7,403.0	10,912.1	7,388.0	67.9	66.2	88.78	-3,606.2	156.4	706.8	575.0	131.83	5.362	
11,100.0	7,403.0	11,012.1	7,388.0	69.6	67.9	88.78	-3,706.2	156.4	704.3	569.0	135.27	5.206	
11,200.0	7,403.0	11,112.0	7,388.0	71.2	69.7	88.77	-3,806.1	156.5	701.7	563.0	138.72	5.059	
11,300.0	7,403.0	11,212.0	7,388.0	72.9	71.4	88.77	-3,906.1	156.5	699.2	557.0	142.17	4.918	
11,400.0	7,403.0	11,312.0	7,388.0	74.6	73.1	88.77	-4,006.1	156.5	696.6	551.0	145.62	4.784	
11,500.0	7,403.0	11,411.9	7,388.0	76.3	74.8	88.76	-4,106.0	156.5	694.1	545.0	149.07	4.656	
11,600.0	7,403.0	11,511.9	7,388.0	78.0	76.6	88.76	-4,206.0	156.5	691.5	539.0	152.53	4.534	
11,700.0	7,403.0	11,611.9	7,388.0	79.7	78.3	88.75	-4,306.0	156.5	689.0	533.0	155.99	4.417	
11,800.0	7,403.0	11,711.8	7,388.0	81.4	80.0	88.75	-4,405.9	156.5	686.4	527.0	159.45	4.305	
11,900.0	7,403.0	11,811.8	7,388.0	83.1	81.8	88.74	-4,505.9	156.5	683.8	520.9	162.91	4.198	
11,973.1	7,403.0	11,884.9	7,388.0	84.3	83.0	88.74	-4,579.0	156.5	682.0	516.5	165.44	4.122 SF	

Anticollision Report

Company:	EnCana Oil & Gas (USA) Inc	Local Co-ordinate Reference:	Well Devore 1G-34H
Project:	DJ Wattenberg	TVD Reference:	WELL @ 4974.0ft (Original Well Elev)
Reference Site:	S34-T3N-R66W (Devore)	MD Reference:	WELL @ 4974.0ft (Original Well Elev)
Site Error:	0.0ft	North Reference:	True
Reference Well:	Devore 1G-34H	Survey Calculation Method:	Minimum Curvature
Well Error:	0.0ft	Output errors are at	2.00 sigma
Reference Wellbore	Hz	Database:	USA EDM 5000 Multi Users DB
Reference Design:	Plan #1	Offset TVD Reference:	Offset Datum

Offset Design S34-T3N-R66W (Devore) - Devore 1F-34H - Hz - Plan #1													Offset Site Error:	0.0 ft
Survey Program: 0-MWD													Offset Well Error:	0.0 ft
Reference		Offset		Semi Major Axis		Highside Toolface (°)	Distance		Total Uncertainty Axis	Separation Factor	Warning			
Measured Depth (ft)	Vertical Depth (ft)	Measured Depth (ft)	Vertical Depth (ft)	Reference (ft)	Offset (ft)		Offset Wellbore Centre +N/-S (ft)	+E/-W (ft)						
0.0	0.0	0.0	0.0	0.0	0.0	-89.94	0.0	-8.4	8.4					
100.0	100.0	100.0	100.0	0.2	0.2	-89.94	0.0	-8.4	8.4	8.1	0.30	27.599		
200.0	200.0	200.0	200.0	0.3	0.3	-89.94	0.0	-8.4	8.4	7.7	0.65	12.840		
300.0	300.0	300.0	300.0	0.5	0.5	-89.94	0.0	-8.4	8.4	7.4	1.00	8.366 CC, ES		
400.0	400.0	400.0	400.0	0.7	0.7	-166.89	0.0	-8.4	9.2	7.9	1.35	6.832		
500.0	500.0	500.1	500.1	0.9	0.9	-168.38	0.3	-7.6	11.0	9.3	1.70	6.450		
600.0	599.9	600.3	600.3	1.0	1.0	-168.45	1.3	-5.1	12.8	10.7	2.05	6.228		
700.0	699.7	700.5	700.4	1.2	1.2	-167.62	3.0	-1.1	14.6	12.2	2.40	6.091		
800.0	799.4	800.8	800.4	1.4	1.4	-166.20	5.3	4.6	16.5	13.8	2.75	6.008		
900.0	898.9	901.0	900.4	1.7	1.6	-164.40	8.2	11.9	18.5	15.4	3.11	5.959		
1,000.0	998.3	1,001.3	1,000.2	1.9	1.8	-162.34	11.8	20.8	20.6	17.2	3.48	5.930		
1,100.0	1,097.4	1,101.6	1,099.9	2.2	2.1	-160.12	16.1	31.4	22.9	19.0	3.86	5.912		
1,200.0	1,196.3	1,202.0	1,199.4	2.5	2.4	-157.82	21.0	43.6	25.2	20.9	4.27	5.897		
1,300.0	1,294.9	1,302.3	1,298.6	2.8	2.6	-155.47	26.6	57.4	27.6	22.9	4.70	5.876		
1,400.0	1,393.3	1,402.7	1,397.6	3.2	3.0	-153.13	32.8	72.8	30.3	25.1	5.18	5.845		
1,500.0	1,491.2	1,502.6	1,496.0	3.5	3.3	-151.76	39.3	88.9	33.8	28.1	5.66	5.967		
1,600.0	1,589.1	1,602.5	1,594.4	3.9	3.6	-151.31	45.8	104.9	38.1	31.9	6.14	6.199		
1,700.0	1,686.9	1,702.5	1,692.8	4.3	3.9	-150.95	52.3	121.0	42.4	35.7	6.63	6.390		
1,800.0	1,784.7	1,802.4	1,791.2	4.7	4.3	-150.65	58.8	137.1	46.7	39.5	7.12	6.551		
1,900.0	1,882.5	1,902.3	1,889.6	5.1	4.6	-150.41	65.3	153.2	51.0	43.3	7.62	6.687		
2,000.0	1,980.3	2,002.2	1,988.0	5.5	5.0	-150.20	71.8	169.3	55.3	47.1	8.12	6.803		
2,100.0	2,078.1	2,102.1	2,086.3	5.9	5.3	-150.02	78.3	185.4	59.6	50.9	8.63	6.904		
2,200.0	2,175.9	2,202.0	2,184.7	6.3	5.6	-149.87	84.8	201.4	63.9	54.7	9.13	6.992		
2,300.0	2,273.8	2,301.9	2,283.1	6.7	6.0	-149.73	91.3	217.5	68.2	58.5	9.64	7.069		
2,400.0	2,371.6	2,401.8	2,381.5	7.1	6.3	-149.62	97.8	233.6	72.5	62.3	10.15	7.137		
2,500.0	2,469.4	2,501.7	2,479.9	7.5	6.7	-149.51	104.3	249.7	76.8	66.1	10.66	7.197		
2,600.0	2,567.2	2,601.6	2,578.3	7.9	7.0	-149.42	110.8	265.8	81.1	69.9	11.18	7.251		
2,700.0	2,665.0	2,701.5	2,676.7	8.3	7.4	-149.33	117.3	281.9	85.4	73.7	11.69	7.300		
2,800.0	2,762.8	2,801.4	2,775.1	8.7	7.7	-149.26	123.8	298.0	89.7	77.5	12.21	7.344		
2,900.0	2,860.7	2,901.3	2,873.5	9.1	8.1	-149.19	130.3	314.0	94.0	81.2	12.72	7.384		
3,000.0	2,958.5	3,001.2	2,971.9	9.5	8.4	-149.12	136.8	330.1	98.3	85.0	13.24	7.421		
3,100.0	3,056.3	3,101.2	3,070.2	9.9	8.8	-149.07	143.3	346.2	102.6	88.8	13.76	7.454		
3,200.0	3,154.1	3,201.1	3,168.6	10.3	9.1	-149.01	149.8	362.3	106.9	92.6	14.28	7.484		
3,300.0	3,251.9	3,301.0	3,267.0	10.7	9.5	-148.96	156.3	378.4	111.2	96.4	14.80	7.513		
3,400.0	3,349.7	3,400.9	3,365.4	11.1	9.8	-148.92	162.8	394.5	115.5	100.2	15.32	7.539		
3,500.0	3,447.5	3,500.8	3,463.8	11.5	10.2	-148.88	169.3	410.6	119.8	103.9	15.84	7.563		
3,600.0	3,545.4	3,600.7	3,562.2	11.9	10.5	-148.84	175.8	426.6	124.1	107.7	16.36	7.585		
3,700.0	3,643.2	3,699.0	3,659.2	12.3	10.8	-148.99	181.9	441.8	128.9	112.1	16.83	7.660		
3,800.0	3,741.0	3,797.1	3,756.1	12.7	11.1	-149.58	187.4	455.5	135.1	117.9	17.21	7.852		
3,900.0	3,838.8	3,894.9	3,853.0	13.2	11.4	-150.52	192.3	467.5	142.7	125.2	17.50	8.154		
4,000.0	3,936.6	3,992.4	3,949.9	13.6	11.6	-151.74	196.5	478.0	151.7	134.0	17.72	8.561		
4,100.0	4,034.4	4,089.6	4,046.6	14.0	11.9	-153.15	200.1	487.0	162.1	144.2	17.87	9.069		
4,200.0	4,132.2	4,186.4	4,143.1	14.4	12.1	-154.69	203.1	494.3	174.0	156.1	17.99	9.676		
4,300.0	4,230.1	4,282.8	4,239.2	14.8	12.3	-156.29	205.5	500.2	187.5	169.4	18.07	10.377		
4,400.0	4,327.9	4,378.6	4,335.0	15.2	12.4	-157.90	207.2	504.5	202.6	184.4	18.14	11.167		
4,500.0	4,425.7	4,474.0	4,430.3	15.6	12.5	-159.49	208.4	507.4	219.1	200.9	18.21	12.034		
4,600.0	4,523.8	4,569.1	4,525.4	16.0	12.6	-160.96	208.9	508.7	235.9	217.6	18.29	12.896		
4,700.0	4,622.3	4,666.0	4,622.3	16.3	12.8	-162.28	209.0	508.9	252.4	234.0	18.41	13.715		
4,800.0	4,721.0	4,764.7	4,721.0	16.6	12.9	-163.35	209.0	508.9	267.6	249.0	18.56	14.412		
4,900.0	4,820.0	4,863.7	4,820.0	16.9	13.0	-164.21	209.0	508.9	281.1	262.3	18.76	14.983		
5,000.0	4,919.3	4,963.0	4,919.3	17.2	13.1	-164.90	209.0	508.9	293.0	274.0	18.98	15.435		
5,100.0	5,018.7	5,062.4	5,018.7	17.4	13.2	-165.45	209.0	508.9	303.3	284.1	19.23	15.774		

CC - Min centre to center distance or convergent point, SF - min separation factor, ES - min ellipse separation

Anticollision Report

Company:	EnCana Oil & Gas (USA) Inc	Local Co-ordinate Reference:	Well Devore 1G-34H
Project:	DJ Wattenberg	TVD Reference:	WELL @ 4974.0ft (Original Well Elev)
Reference Site:	S34-T3N-R66W (Devore)	MD Reference:	WELL @ 4974.0ft (Original Well Elev)
Site Error:	0.0ft	North Reference:	True
Reference Well:	Devore 1G-34H	Survey Calculation Method:	Minimum Curvature
Well Error:	0.0ft	Output errors are at	2.00 sigma
Reference Wellbore	Hz	Database:	USA EDM 5000 Multi Users DB
Reference Design:	Plan #1	Offset TVD Reference:	Offset Datum

Offset Design S34-T3N-R66W (Devore) - Devore 1F-34H - Hz - Plan #1												Offset Site Error:	0.0 ft
Survey Program: O-MWD												Offset Well Error:	0.0 ft
Reference		Offset		Semi Major Axis			Distance				Total Uncertainty Axis	Separation Factor	Warning
Measured Depth (ft)	Vertical Depth (ft)	Measured Depth (ft)	Vertical Depth (ft)	Reference (ft)	Offset (ft)	Highside Toolface (°)	Offset Wellbore Centre +N/-S (ft)	+E/-W (ft)	Between Centres (ft)	Between Ellipses (ft)			
5,200.0	5,118.3	5,162.0	5,118.3	17.6	13.3	-165.88	209.0	508.9	311.9	292.4	19.49	16.006	
5,300.0	5,218.0	5,261.8	5,218.0	17.8	13.4	-166.21	209.0	508.9	318.8	299.1	19.76	16.137	
5,400.0	5,317.9	5,361.6	5,317.9	18.0	13.6	-166.45	209.0	508.9	324.1	304.1	20.04	16.172	
5,500.0	5,417.8	5,461.5	5,417.8	18.1	13.7	-166.61	209.0	508.9	327.7	307.3	20.33	16.117	
5,600.0	5,517.8	5,561.5	5,517.8	18.2	13.8	-166.69	209.0	508.9	329.5	308.9	20.63	15.976	
5,700.0	5,617.8	5,661.5	5,617.8	18.3	13.9	-91.10	209.0	508.9	329.8	308.8	21.09	15.643	
5,800.0	5,717.8	5,761.5	5,717.8	18.4	14.1	-91.10	209.0	508.9	329.8	308.4	21.41	15.403	
5,900.0	5,817.8	5,861.5	5,817.8	18.5	14.2	-91.10	209.0	508.9	329.8	308.1	21.74	15.171	
6,000.0	5,917.8	5,961.5	5,917.8	18.6	14.3	-91.10	209.0	508.9	329.8	307.8	22.07	14.944	
6,100.0	6,017.8	6,061.5	6,017.8	18.7	14.4	-91.10	209.0	508.9	329.8	307.4	22.40	14.724	
6,200.0	6,117.8	6,161.5	6,117.8	18.8	14.6	-91.10	209.0	508.9	329.8	307.1	22.73	14.510	
6,300.0	6,217.8	6,261.5	6,217.8	18.9	14.7	-91.10	209.0	508.9	329.8	306.8	23.06	14.302	
6,400.0	6,317.8	6,361.5	6,317.8	19.0	14.8	-91.10	209.0	508.9	329.8	306.4	23.39	14.100	
6,500.0	6,417.8	6,461.5	6,417.8	19.1	14.9	-91.10	209.0	508.9	329.8	306.1	23.73	13.902	
6,531.0	6,448.8	6,492.6	6,448.8	19.1	15.0	-91.10	209.0	508.9	329.8	306.0	23.83	13.842	
6,600.0	6,517.8	6,560.9	6,517.1	19.2	15.1	-91.53	206.5	508.9	329.9	305.9	23.98	13.759	
6,700.0	6,617.8	6,657.6	6,612.6	19.3	15.1	-94.04	192.0	508.8	330.6	306.7	23.94	13.814	
6,800.0	6,717.8	6,750.0	6,701.3	19.4	15.1	82.55	166.3	508.8	333.7	310.0	23.73	14.064	
6,900.0	6,817.1	6,836.8	6,781.0	19.5	15.2	77.88	131.9	508.8	339.6	315.8	23.80	14.265	
7,000.0	6,913.8	6,921.9	6,854.4	19.5	15.2	73.55	89.1	508.8	347.4	323.2	24.14	14.389	
7,100.0	7,006.2	7,004.8	6,920.7	19.5	15.2	69.68	39.3	508.8	356.5	331.9	24.67	14.450	
7,200.0	7,092.3	7,085.9	6,979.5	19.5	15.4	66.31	-16.5	508.8	366.3	341.1	25.23	14.519	
7,300.0	7,170.5	7,165.6	7,030.7	19.6	15.5	63.44	-77.5	508.8	376.1	350.3	25.80	14.579	
7,400.0	7,239.3	7,244.0	7,074.3	19.8	15.8	61.08	-142.7	508.8	385.4	359.1	26.27	14.671	
7,500.0	7,297.3	7,321.5	7,110.0	20.0	16.2	59.20	-211.3	508.8	393.7	367.1	26.66	14.772	
7,600.0	7,343.5	7,400.0	7,138.5	20.4	16.7	57.77	-284.5	508.8	400.8	373.8	27.00	14.846	
7,700.0	7,376.9	7,474.5	7,157.9	20.9	17.2	56.84	-356.3	508.8	406.3	379.0	27.33	14.865	
7,800.0	7,396.8	7,550.0	7,169.9	21.6	17.8	56.32	-430.8	508.8	410.0	382.3	27.75	14.775	
7,900.0	7,403.0	7,626.5	7,174.0	22.4	18.6	56.22	-507.2	508.8	411.9	383.5	28.40	14.503	
8,000.0	7,403.0	7,726.0	7,174.0	23.3	19.6	56.36	-606.7	508.8	413.4	382.9	30.46	13.572	
8,100.0	7,403.0	7,826.0	7,174.0	24.3	20.8	56.49	-706.7	508.8	414.9	382.2	32.66	12.703	
8,200.0	7,403.0	7,926.0	7,174.0	25.3	22.0	56.62	-806.7	508.8	416.3	381.3	34.97	11.904	
8,300.0	7,403.0	8,026.0	7,174.0	26.5	23.3	56.76	-906.7	508.8	417.8	380.4	37.39	11.174	
8,400.0	7,403.0	8,126.0	7,174.0	27.7	24.6	56.89	-1,006.7	508.8	419.2	379.4	39.89	10.511	
8,500.0	7,403.0	8,226.0	7,174.0	28.9	26.0	57.02	-1,106.7	508.8	420.7	378.3	42.45	9.910	
8,600.0	7,403.0	8,325.9	7,174.0	30.3	27.5	57.15	-1,206.6	508.8	422.2	377.1	45.08	9.365	
8,700.0	7,403.0	8,425.9	7,174.0	31.6	28.9	57.28	-1,306.6	508.8	423.7	375.9	47.76	8.871	
8,800.0	7,403.0	8,525.9	7,174.0	33.0	30.4	57.40	-1,406.6	508.8	425.1	374.7	50.48	8.422	
8,900.0	7,403.0	8,625.9	7,174.0	34.4	32.0	57.53	-1,506.6	508.7	426.6	373.4	53.24	8.013	
9,000.0	7,403.0	8,725.9	7,174.0	35.9	33.5	57.66	-1,606.6	508.7	428.1	372.1	56.03	7.640	
9,100.0	7,403.0	8,825.9	7,174.0	37.4	35.1	57.78	-1,706.6	508.7	429.6	370.7	58.86	7.299	
9,200.0	7,403.0	8,925.8	7,174.0	38.9	36.7	57.90	-1,806.5	508.7	431.1	369.3	61.71	6.985	
9,300.0	7,403.0	9,025.8	7,174.0	40.4	38.3	58.03	-1,906.5	508.7	432.5	368.0	64.58	6.697	
9,400.0	7,403.0	9,125.8	7,174.0	42.0	39.9	58.15	-2,006.5	508.7	434.0	366.5	67.48	6.432	
9,500.0	7,403.0	9,225.8	7,174.0	43.5	41.5	58.27	-2,106.5	508.7	435.5	365.1	70.40	6.186	
9,600.0	7,403.0	9,325.8	7,174.0	45.1	43.2	58.39	-2,206.5	508.7	437.0	363.7	73.34	5.959	
9,700.0	7,403.0	9,425.8	7,174.0	46.7	44.8	58.51	-2,306.5	508.7	438.5	362.2	76.29	5.748	
9,800.0	7,403.0	9,525.8	7,174.0	48.3	46.5	58.63	-2,406.5	508.7	440.0	360.7	79.26	5.551	
9,900.0	7,403.0	9,625.7	7,174.0	49.9	48.1	58.75	-2,506.4	508.7	441.5	359.3	82.23	5.369	
10,000.0	7,403.0	9,725.7	7,174.0	51.5	49.8	58.81	-2,606.4	508.7	442.1	357.3	84.83	5.212	
10,100.0	7,403.0	9,825.7	7,174.0	53.1	51.5	58.74	-2,706.4	508.7	441.3	354.0	87.31	5.054	
10,200.0	7,403.0	9,925.7	7,174.0	54.7	53.1	58.57	-2,806.4	508.7	439.3	349.3	89.93	4.885	

CC - Min centre to center distance or convergent point, SF - min separation factor, ES - min ellipse separation

Anticollision Report

Company:	EnCana Oil & Gas (USA) Inc	Local Co-ordinate Reference:	Well Devore 1G-34H
Project:	DJ Wattenberg	TVD Reference:	WELL @ 4974.0ft (Original Well Elev)
Reference Site:	S34-T3N-R66W (Devore)	MD Reference:	WELL @ 4974.0ft (Original Well Elev)
Site Error:	0.0ft	North Reference:	True
Reference Well:	Devore 1G-34H	Survey Calculation Method:	Minimum Curvature
Well Error:	0.0ft	Output errors are at	2.00 sigma
Reference Wellbore	Hz	Database:	USA EDM 5000 Multi Users DB
Reference Design:	Plan #1	Offset TVD Reference:	Offset Datum

Offset Design S34-T3N-R66W (Devore) - Devore 1F-34H - Hz - Plan #1													Offset Site Error:	0.0 ft
Survey Program: 0-MWD													Offset Well Error:	0.0 ft
Reference		Offset		Semi Major Axis			Distance							Warning
Measured Depth (ft)	Vertical Depth (ft)	Measured Depth (ft)	Vertical Depth (ft)	Reference (ft)	Offset (ft)	Highside Toolface (°)	Offset Wellbore Centre +N/-S (ft)	+E/-W (ft)	Between Centres (ft)	Between Ellipses (ft)	Total Uncertainty Axis	Separation Factor		
10,300.0	7,403.0	10,025.7	7,174.0	56.4	54.8	58.40	-2,906.4	508.7	437.1	344.4	92.68	4.716		
10,400.0	7,403.0	10,125.6	7,174.0	58.0	56.5	58.22	-3,006.3	508.7	434.9	339.5	95.43	4.558		
10,500.0	7,403.0	10,225.6	7,174.0	59.6	58.2	58.04	-3,106.3	508.7	432.8	334.6	98.17	4.408		
10,600.0	7,403.0	10,325.6	7,174.0	61.3	59.9	57.86	-3,206.3	508.6	430.6	329.7	100.90	4.268		
10,700.0	7,403.0	10,425.5	7,174.0	62.9	61.6	57.68	-3,306.2	508.6	428.5	324.8	103.62	4.135		
10,800.0	7,403.0	10,525.5	7,174.0	64.6	63.3	57.50	-3,406.2	508.6	426.3	320.0	106.33	4.009		
10,900.0	7,403.0	10,625.5	7,174.0	66.2	65.0	57.32	-3,506.2	508.6	424.2	315.1	109.03	3.890		
11,000.0	7,403.0	10,725.4	7,174.0	67.9	66.7	57.13	-3,606.1	508.6	422.0	310.3	111.72	3.778		
11,100.0	7,403.0	10,825.4	7,174.0	69.6	68.4	56.94	-3,706.1	508.6	419.9	305.5	114.39	3.671		
11,200.0	7,403.0	10,925.4	7,174.0	71.2	70.1	56.75	-3,806.1	508.6	417.8	300.7	117.05	3.569		
11,300.0	7,403.0	11,025.3	7,174.0	72.9	71.8	56.56	-3,906.0	508.6	415.6	295.9	119.70	3.472		
11,400.0	7,403.0	11,125.3	7,174.0	74.6	73.5	56.36	-4,006.0	508.6	413.5	291.2	122.33	3.380		
11,500.0	7,403.0	11,225.3	7,174.0	76.3	75.2	56.17	-4,106.0	508.6	411.4	286.4	124.95	3.292		
11,600.0	7,403.0	11,325.2	7,174.0	78.0	77.0	55.97	-4,205.9	508.6	409.3	281.7	127.55	3.209		
11,700.0	7,403.0	11,425.2	7,174.0	79.7	78.7	55.77	-4,305.9	508.6	407.2	277.0	130.14	3.129		
11,800.0	7,403.0	11,525.2	7,174.0	81.4	80.4	55.57	-4,405.9	508.6	405.1	272.4	132.71	3.052		
11,900.0	7,403.0	11,625.2	7,174.0	83.1	82.1	55.36	-4,505.8	508.6	403.0	267.7	135.27	2.979		
11,973.1	7,403.0	11,698.2	7,174.0	84.3	83.4	55.21	-4,578.9	508.6	401.5	264.3	137.12	2.928 SF		

Anticollision Report

Company:	EnCana Oil & Gas (USA) Inc	Local Co-ordinate Reference:	Well Devore 1G-34H
Project:	DJ Wattenberg	TVD Reference:	WELL @ 4974.0ft (Original Well Elev)
Reference Site:	S34-T3N-R66W (Devore)	MD Reference:	WELL @ 4974.0ft (Original Well Elev)
Site Error:	0.0ft	North Reference:	True
Reference Well:	Devore 1G-34H	Survey Calculation Method:	Minimum Curvature
Well Error:	0.0ft	Output errors are at	2.00 sigma
Reference Wellbore	Hz	Database:	USA EDM 5000 Multi Users DB
Reference Design:	Plan #1	Offset TVD Reference:	Offset Datum

Offset Design S34-T3N-R66W (Devore) - Devore 1H-34H - Hz - Plan #1													Offset Site Error:	0.0 ft
Survey Program: 0-MWD													Offset Well Error:	0.0 ft
Reference		Offset		Semi Major Axis		Distance		Total		Separation		Warning		
Measured Depth (ft)	Vertical Depth (ft)	Measured Depth (ft)	Vertical Depth (ft)	Reference (ft)	Offset (ft)	Highside Toolface (°)	Offset Wellbore Centre +N/-S (ft)	+E/-W (ft)	Between Centres (ft)	Between Ellipses (ft)	Uncertainty Axis			
0.0	0.0	0.0	0.0	0.0	0.0	90.04	0.0	11.2	11.2					
100.0	100.0	100.0	100.0	0.2	0.2	90.04	0.0	11.2	11.2	10.9	0.30	36.798		
200.0	200.0	200.0	200.0	0.3	0.3	90.04	0.0	11.2	11.2	10.5	0.65	17.120 CC, ES		
300.0	300.0	299.8	299.8	0.5	0.5	89.29	0.2	12.0	12.0	11.0	1.00	12.006		
400.0	400.0	399.6	399.5	0.7	0.7	12.69	0.6	14.6	13.8	12.4	1.35	10.192		
500.0	500.0	499.3	499.2	0.9	0.9	12.36	1.4	18.9	15.5	13.8	1.70	9.128		
600.0	599.9	599.0	598.7	1.0	1.1	12.48	2.5	24.8	17.3	15.2	2.05	8.434		
700.0	699.7	698.7	698.0	1.2	1.3	12.93	3.9	32.5	19.1	16.7	2.40	7.945		
800.0	799.4	798.3	797.2	1.4	1.5	13.62	5.7	41.9	20.9	18.1	2.75	7.583		
900.0	898.9	897.9	896.2	1.7	1.8	14.49	7.7	52.9	22.7	19.6	3.11	7.303		
1,000.0	998.3	997.5	994.9	1.9	2.0	15.51	10.1	65.7	24.5	21.1	3.47	7.078		
1,100.0	1,097.4	1,097.0	1,093.4	2.2	2.3	16.63	12.8	80.1	26.4	22.6	3.83	6.889		
1,200.0	1,196.3	1,196.6	1,191.5	2.5	2.7	17.83	15.7	96.2	28.3	24.1	4.21	6.724		
1,300.0	1,294.9	1,296.1	1,289.4	2.8	3.0	19.09	19.0	113.9	30.3	25.7	4.60	6.574		
1,400.0	1,393.3	1,395.5	1,386.9	3.2	3.4	20.40	22.6	133.4	32.2	27.2	5.01	6.431		
1,500.0	1,491.2	1,494.9	1,483.9	3.5	3.8	21.75	26.5	154.4	34.3	28.8	5.45	6.289		
1,600.0	1,589.1	1,594.3	1,580.6	3.9	4.2	22.59	30.8	177.2	37.2	31.3	5.90	6.299		
1,700.0	1,686.9	1,693.6	1,676.7	4.3	4.7	22.53	35.3	201.5	41.7	35.4	6.33	6.587		
1,800.0	1,784.7	1,793.4	1,773.1	4.7	5.2	22.10	40.0	226.9	47.1	40.4	6.74	6.990		
1,900.0	1,882.5	1,893.2	1,869.6	5.1	5.6	21.75	44.7	252.3	52.6	45.4	7.16	7.345		
2,000.0	1,980.3	1,993.1	1,966.0	5.5	6.1	21.47	49.4	277.7	58.1	50.5	7.58	7.661		
2,100.0	2,078.1	2,092.9	2,062.4	5.9	6.6	21.24	54.1	303.1	63.5	55.5	8.00	7.943		
2,200.0	2,175.9	2,192.8	2,158.9	6.3	7.1	21.05	58.8	328.5	69.0	60.6	8.42	8.197		
2,300.0	2,273.8	2,292.6	2,255.3	6.7	7.6	20.88	63.5	353.9	74.4	65.6	8.84	8.426		
2,400.0	2,371.6	2,392.5	2,351.8	7.1	8.1	20.74	68.2	379.4	79.9	70.7	9.26	8.634		
2,500.0	2,469.4	2,492.3	2,448.2	7.5	8.6	20.61	72.9	404.8	85.4	75.7	9.68	8.823		
2,600.0	2,567.2	2,592.2	2,544.7	7.9	9.0	20.50	77.6	430.2	90.8	80.7	10.10	8.996		
2,700.0	2,665.0	2,692.0	2,641.1	8.3	9.5	20.41	82.4	455.6	96.3	85.8	10.52	9.156		
2,800.0	2,762.8	2,791.9	2,737.6	8.7	10.0	20.32	87.1	481.0	101.8	90.8	10.94	9.302		
2,900.0	2,860.7	2,891.7	2,834.0	9.1	10.5	20.24	91.8	506.4	107.2	95.9	11.36	9.438		
3,000.0	2,958.5	2,991.6	2,930.5	9.5	11.0	20.17	96.5	531.8	112.7	100.9	11.78	9.564		
3,100.0	3,056.3	3,091.4	3,026.9	9.9	11.5	20.11	101.2	557.2	118.2	106.0	12.21	9.681		
3,200.0	3,154.1	3,191.3	3,123.4	10.3	12.0	20.05	105.9	582.6	123.6	111.0	12.63	9.790		
3,300.0	3,251.9	3,291.1	3,219.8	10.7	12.5	20.00	110.6	608.1	129.1	116.0	13.05	9.892		
3,400.0	3,349.7	3,391.0	3,316.3	11.1	13.0	19.95	115.3	633.5	134.6	121.1	13.47	9.987		
3,500.0	3,447.5	3,490.8	3,412.7	11.5	13.5	19.90	120.0	658.9	140.0	126.1	13.90	10.076		
3,600.0	3,545.4	3,590.7	3,509.2	11.9	14.0	19.86	124.7	684.3	145.5	131.2	14.32	10.161		
3,700.0	3,643.2	3,690.5	3,605.6	12.3	14.5	19.82	129.5	709.7	150.9	136.2	14.74	10.240		
3,800.0	3,741.0	3,790.4	3,702.1	12.7	15.0	19.78	134.2	735.1	156.4	141.3	15.16	10.315		
3,900.0	3,838.8	3,890.2	3,798.5	13.2	15.5	19.75	138.9	760.5	161.9	146.3	15.59	10.385		
4,000.0	3,936.6	3,990.1	3,895.0	13.6	15.9	19.72	143.6	785.9	167.3	151.3	16.01	10.452		
4,100.0	4,034.4	4,089.9	3,991.4	14.0	16.4	19.69	148.3	811.3	172.8	156.4	16.43	10.515		
4,200.0	4,132.2	4,189.8	4,087.9	14.4	16.9	19.66	153.0	836.7	178.3	161.4	16.86	10.575		
4,300.0	4,230.1	4,289.6	4,184.3	14.8	17.4	19.64	157.7	862.2	183.7	166.5	17.28	10.633		
4,400.0	4,327.9	4,389.5	4,280.8	15.2	17.9	19.61	162.4	887.6	189.2	171.5	17.70	10.687		
4,500.0	4,425.7	4,489.3	4,377.2	15.6	18.4	19.58	167.1	913.0	194.8	176.7	18.13	10.747		
4,600.0	4,523.8	4,589.1	4,473.6	16.0	18.9	19.43	171.8	938.4	201.7	183.2	18.51	10.901		
4,700.0	4,622.3	4,688.7	4,569.8	16.3	19.4	19.15	176.5	963.7	210.3	191.5	18.84	11.162		
4,800.0	4,721.0	4,788.2	4,665.9	16.6	19.9	18.74	181.2	989.0	220.6	201.4	19.14	11.526		
4,900.0	4,820.0	4,887.4	4,761.7	16.9	20.4	18.24	185.9	1,014.3	232.5	213.1	19.39	11.987		
5,000.0	4,919.3	4,990.6	4,861.6	17.2	20.9	17.69	190.6	1,039.7	245.3	225.6	19.63	12.491		
5,100.0	5,018.7	5,094.2	4,962.3	17.4	21.3	17.18	195.0	1,063.5	258.0	238.1	19.87	12.983		

CC - Min centre to center distance or convergent point, SF - min separation factor, ES - min ellipse separation

Anticollision Report

Company:	EnCana Oil & Gas (USA) Inc	Local Co-ordinate Reference:	Well Devore 1G-34H
Project:	DJ Wattenberg	TVD Reference:	WELL @ 4974.0ft (Original Well Elev)
Reference Site:	S34-T3N-R66W (Devore)	MD Reference:	WELL @ 4974.0ft (Original Well Elev)
Site Error:	0.0ft	North Reference:	True
Reference Well:	Devore 1G-34H	Survey Calculation Method:	Minimum Curvature
Well Error:	0.0ft	Output errors are at	2.00 sigma
Reference Wellbore	Hz	Database:	USA EDM 5000 Multi Users DB
Reference Design:	Plan #1	Offset TVD Reference:	Offset Datum

Offset Design S34-T3N-R66W (Devore) - Devore 1H-34H - Hz - Plan #1													Offset Site Error:	0.0 ft
Survey Program: 0-MWD													Offset Well Error:	0.0 ft
Reference		Offset		Semi Major Axis		Distance		Total		Separation		Warning		
Measured Depth (ft)	Vertical Depth (ft)	Measured Depth (ft)	Vertical Depth (ft)	Reference (ft)	Offset (ft)	Highside Toolface (°)	Offset Wellbore Centre +N/-S (ft)	+E/-W (ft)	Between Centres (ft)	Between Ellipses (ft)	Uncertainty Axis			
5,200.0	5,118.3	5,198.0	5,063.7	17.6	21.8	16.69	199.1	1,085.5	270.6	250.5	20.10	13.462		
5,300.0	5,218.0	5,302.1	5,165.7	17.8	22.2	16.23	202.9	1,105.8	283.2	262.8	20.33	13.929		
5,400.0	5,317.9	5,406.4	5,268.4	18.0	22.5	15.78	206.3	1,124.3	295.6	275.1	20.55	14.384		
5,500.0	5,417.8	5,511.0	5,371.6	18.1	22.8	15.35	209.4	1,141.0	308.0	287.3	20.77	14.827		
5,600.0	5,517.8	5,615.9	5,475.3	18.2	23.1	14.94	212.1	1,155.8	320.3	299.3	20.99	15.258		
5,700.0	5,617.8	5,721.0	5,579.6	18.3	23.4	90.13	214.6	1,168.8	332.4	310.9	21.46	15.487		
5,800.0	5,717.8	5,826.6	5,684.6	18.4	23.7	89.78	216.6	1,180.0	343.0	321.3	21.72	15.789		
5,900.0	5,817.8	5,932.5	5,790.1	18.5	23.9	89.51	218.3	1,189.3	351.8	329.8	22.00	15.988		
6,000.0	5,917.8	6,038.7	5,896.0	18.6	24.1	89.30	219.7	1,196.7	358.8	336.5	22.30	16.088		
6,100.0	6,017.8	6,145.2	6,002.4	18.7	24.2	89.15	220.7	1,202.2	363.9	341.3	22.61	16.095		
6,200.0	6,117.8	6,251.9	6,109.0	18.8	24.3	89.05	221.4	1,205.7	367.3	344.3	22.93	16.014		
6,300.0	6,217.8	6,358.6	6,215.7	18.9	24.4	89.01	221.7	1,207.3	368.8	345.5	23.27	15.849		
6,400.0	6,317.8	6,460.7	6,317.8	19.0	24.5	89.01	221.7	1,207.4	368.8	345.2	23.60	15.629		
6,500.0	6,417.8	6,560.7	6,417.8	19.1	24.6	89.01	221.7	1,207.4	368.8	344.9	23.93	15.412		
6,600.0	6,517.8	6,661.1	6,518.1	19.2	24.7	89.40	219.2	1,207.4	368.8	344.5	24.32	15.166		
6,635.5	6,553.3	6,696.5	6,553.3	19.2	24.7	90.00	215.3	1,207.4	368.8	344.3	24.53	15.032		
6,700.0	6,617.8	6,759.5	6,615.3	19.3	24.7	91.73	204.2	1,207.4	369.0	343.9	25.05	14.731		
6,800.0	6,717.8	6,852.4	6,704.3	19.4	24.7	-83.23	177.9	1,207.4	370.8	344.9	25.90	14.318		
6,900.0	6,817.1	6,941.2	6,785.6	19.5	24.7	-78.89	142.3	1,207.4	374.9	348.0	26.96	13.906		
7,000.0	6,913.8	7,027.3	6,859.6	19.5	24.7	-74.87	98.4	1,207.4	380.6	352.9	27.68	13.752		
7,100.0	7,006.2	7,111.1	6,926.0	19.5	24.7	-71.21	47.4	1,207.4	387.4	359.4	27.93	13.872		
7,200.0	7,092.3	7,192.9	6,984.8	19.5	24.8	-67.96	-9.5	1,207.4	394.6	366.9	27.75	14.220		
7,300.0	7,170.5	7,273.1	7,035.7	19.6	24.9	-65.13	-71.4	1,207.4	401.9	374.7	27.14	14.808		
7,400.0	7,239.3	7,350.0	7,077.7	19.8	25.1	-62.79	-135.8	1,207.4	408.7	382.3	26.37	15.495		
7,500.0	7,297.3	7,429.8	7,113.7	20.0	25.3	-60.80	-206.9	1,207.4	414.5	388.8	25.76	16.092		
7,600.0	7,343.5	7,506.8	7,140.8	20.4	25.6	-59.29	-279.0	1,207.4	419.1	393.5	25.62	16.358		
7,700.0	7,376.9	7,583.2	7,159.9	20.9	25.9	-58.19	-352.9	1,207.4	422.3	396.0	26.30	16.054		
7,800.0	7,396.8	7,659.2	7,170.9	21.6	26.3	-57.52	-428.1	1,207.4	423.8	395.8	27.96	15.157		
7,900.0	7,403.0	7,738.0	7,174.0	22.4	26.8	-57.25	-506.8	1,207.4	423.4	392.9	30.50	13.882		
8,000.0	7,403.0	7,838.0	7,174.0	23.3	27.5	-57.13	-606.8	1,207.4	421.9	389.5	32.43	13.012		
8,100.0	7,403.0	7,938.0	7,174.0	24.3	28.3	-57.00	-706.8	1,207.4	420.5	386.0	34.49	12.193		
8,200.0	7,403.0	8,038.0	7,174.0	25.3	29.2	-56.87	-806.7	1,207.4	419.0	382.4	36.65	11.431		
8,300.0	7,403.0	8,137.9	7,174.0	26.5	30.2	-56.73	-906.7	1,207.4	417.5	378.6	38.91	10.730		
8,400.0	7,403.0	8,237.9	7,174.0	27.7	31.2	-56.60	-1,006.7	1,207.3	416.1	374.8	41.25	10.087		
8,500.0	7,403.0	8,337.9	7,174.0	28.9	32.3	-56.47	-1,106.7	1,207.3	414.6	371.0	43.64	9.501		
8,600.0	7,403.0	8,437.9	7,174.0	30.3	33.5	-56.33	-1,206.7	1,207.3	413.2	367.1	46.08	8.965		
8,700.0	7,403.0	8,537.9	7,174.0	31.6	34.7	-56.20	-1,306.7	1,207.3	411.7	363.1	48.57	8.477		
8,800.0	7,403.0	8,637.9	7,174.0	33.0	36.0	-56.06	-1,406.6	1,207.3	410.3	359.2	51.08	8.032		
8,900.0	7,403.0	8,737.9	7,174.0	34.4	37.3	-55.93	-1,506.6	1,207.3	408.8	355.2	53.62	7.624		
9,000.0	7,403.0	8,837.8	7,174.0	35.9	38.6	-55.79	-1,606.6	1,207.3	407.4	351.2	56.18	7.251		
9,100.0	7,403.0	8,937.8	7,174.0	37.4	40.0	-55.65	-1,706.6	1,207.3	405.9	347.1	58.76	6.908		
9,200.0	7,403.0	9,037.8	7,174.0	38.9	41.3	-55.51	-1,806.6	1,207.3	404.5	343.1	61.35	6.593		
9,300.0	7,403.0	9,137.8	7,174.0	40.4	42.8	-55.37	-1,906.6	1,207.3	403.0	339.1	63.95	6.302		
9,400.0	7,403.0	9,237.8	7,174.0	42.0	44.2	-55.23	-2,006.6	1,207.3	401.6	335.0	66.56	6.034		
9,500.0	7,403.0	9,337.8	7,174.0	43.5	45.7	-55.08	-2,106.5	1,207.3	400.1	331.0	69.17	5.785		
9,600.0	7,403.0	9,437.7	7,174.0	45.1	47.2	-54.94	-2,206.5	1,207.3	398.7	326.9	71.78	5.554		
9,700.0	7,403.0	9,537.7	7,174.0	46.7	48.7	-54.80	-2,306.5	1,207.3	397.3	322.9	74.40	5.340		
9,800.0	7,403.0	9,637.7	7,174.0	48.3	50.2	-54.65	-2,406.5	1,207.3	395.8	318.8	77.02	5.140		
9,900.0	7,403.0	9,737.7	7,174.0	49.9	51.7	-54.50	-2,506.5	1,207.3	394.4	314.8	79.61	4.955		
9,994.3	7,403.0	9,832.0	7,174.0	51.4	53.2	-54.44	-2,600.8	1,207.3	393.8	312.1	81.72	4.819		
10,000.0	7,403.0	9,837.7	7,174.0	51.5	53.3	-54.44	-2,606.5	1,207.3	393.8	311.9	81.85	4.811		
10,100.0	7,403.0	9,937.7	7,174.0	53.1	54.9	-54.52	-2,706.5	1,207.3	394.6	310.4	84.19	4.687		

CC - Min centre to center distance or convergent point, SF - min separation factor, ES - min ellipse separation

Anticollision Report

Company:	EnCana Oil & Gas (USA) Inc	Local Co-ordinate Reference:	Well Devore 1G-34H
Project:	DJ Wattenberg	TVD Reference:	WELL @ 4974.0ft (Original Well Elev)
Reference Site:	S34-T3N-R66W (Devore)	MD Reference:	WELL @ 4974.0ft (Original Well Elev)
Site Error:	0.0ft	North Reference:	True
Reference Well:	Devore 1G-34H	Survey Calculation Method:	Minimum Curvature
Well Error:	0.0ft	Output errors are at	2.00 sigma
Reference Wellbore	Hz	Database:	USA EDM 5000 Multi Users DB
Reference Design:	Plan #1	Offset TVD Reference:	Offset Datum

Offset Design S34-T3N-R66W (Devore) - Devore 1H-34H - Hz - Plan #1													Offset Site Error:	0.0 ft
Survey Program: 0-MWD													Offset Well Error:	0.0 ft
Reference		Offset		Semi Major Axis			Distance							Warning
Measured Depth (ft)	Vertical Depth (ft)	Measured Depth (ft)	Vertical Depth (ft)	Reference (ft)	Offset (ft)	Highside Toolface (°)	Offset Wellbore Centre +N/-S (ft)	+E/-W (ft)	Between Centres (ft)	Between Ellipses (ft)	Total Uncertainty Axis	Separation Factor		
10,200.0	7,403.0	10,037.7	7,174.0	54.7	56.4	-54.72	-2,806.4	1,207.2	396.5	309.6	86.94	4.561		
10,300.0	7,403.0	10,137.6	7,174.0	56.4	58.0	-54.93	-2,906.4	1,207.2	398.6	308.7	89.91	4.434		
10,400.0	7,403.0	10,237.6	7,174.0	58.0	59.6	-55.14	-3,006.4	1,207.2	400.7	307.8	92.90	4.313		
10,500.0	7,403.0	10,337.6	7,174.0	59.6	61.2	-55.34	-3,106.3	1,207.2	402.8	306.9	95.91	4.200		
10,600.0	7,403.0	10,437.5	7,174.0	61.3	62.8	-55.55	-3,206.3	1,207.2	404.9	306.0	98.93	4.093		
10,700.0	7,403.0	10,537.5	7,174.0	62.9	64.5	-55.75	-3,306.3	1,207.2	407.0	305.0	101.97	3.991		
10,800.0	7,403.0	10,637.5	7,174.0	64.6	66.1	-55.95	-3,406.2	1,207.2	409.1	304.1	105.03	3.895		
10,900.0	7,403.0	10,737.4	7,174.0	66.2	67.7	-56.15	-3,506.2	1,207.2	411.2	303.1	108.10	3.804		
11,000.0	7,403.0	10,837.4	7,174.0	67.9	69.4	-56.35	-3,606.2	1,207.2	413.3	302.2	111.18	3.718		
11,100.0	7,403.0	10,937.4	7,174.0	69.6	71.0	-56.54	-3,706.1	1,207.2	415.4	301.2	114.27	3.636		
11,200.0	7,403.0	11,037.3	7,174.0	71.2	72.6	-56.73	-3,806.1	1,207.2	417.6	300.2	117.38	3.557		
11,300.0	7,403.0	11,137.3	7,174.0	72.9	74.3	-56.92	-3,906.1	1,207.2	419.7	299.2	120.50	3.483		
11,400.0	7,403.0	11,237.3	7,174.0	74.6	76.0	-57.11	-4,006.0	1,207.2	421.8	298.2	123.63	3.412		
11,500.0	7,403.0	11,337.2	7,174.0	76.3	77.6	-57.30	-4,106.0	1,207.2	424.0	297.2	126.77	3.344		
11,600.0	7,403.0	11,437.2	7,174.0	78.0	79.3	-57.48	-4,206.0	1,207.2	426.1	296.2	129.93	3.280		
11,700.0	7,403.0	11,537.2	7,174.0	79.7	81.0	-57.67	-4,306.0	1,207.2	428.3	295.2	133.09	3.218		
11,800.0	7,403.0	11,637.1	7,174.0	81.4	82.6	-57.85	-4,405.9	1,207.2	430.4	294.2	136.26	3.159		
11,900.0	7,403.0	11,737.1	7,174.0	83.1	84.3	-58.03	-4,505.9	1,207.2	432.6	293.1	139.45	3.102		
11,973.1	7,403.0	11,806.5	7,174.0	84.3	85.5	-58.15	-4,575.3	1,207.1	434.2	292.5	141.72	3.064 SF		

Anticollision Report

Company:	EnCana Oil & Gas (USA) Inc	Local Co-ordinate Reference:	Well Devore 1G-34H
Project:	DJ Wattenberg	TVD Reference:	WELL @ 4974.0ft (Original Well Elev)
Reference Site:	S34-T3N-R66W (Devore)	MD Reference:	WELL @ 4974.0ft (Original Well Elev)
Site Error:	0.0ft	North Reference:	True
Reference Well:	Devore 1G-34H	Survey Calculation Method:	Minimum Curvature
Well Error:	0.0ft	Output errors are at	2.00 sigma
Reference Wellbore	Hz	Database:	USA EDM 5000 Multi Users DB
Reference Design:	Plan #1	Offset TVD Reference:	Offset Datum

Offset Design S34-T3N-R66W (Devore) - DEVORE 31-34 (EXISTING) - EXISTING - GYRO													Offset Site Error:	0.0 ft
Survey Program: 100-Gyro													Offset Well Error:	0.0 ft
Reference		Offset		Semi Major Axis		Highside Toolface (°)	Offset Wellbore Centre		Distance		Total Uncertainty Axis	Separation Factor	Warning	
Measured Depth (ft)	Vertical Depth (ft)	Measured Depth (ft)	Vertical Depth (ft)	Reference (ft)	Offset (ft)		+N/-S (ft)	+E/-W (ft)	Between Centres (ft)	Between Ellipses (ft)				
0.0	0.0	0.0	0.0	0.0	0.0	-104.49	-224.3	-867.8	896.3					
100.0	100.0	95.3	95.3	0.2	0.1	-104.49	-224.3	-868.1	896.6	896.4	0.24	3,811.102		
200.0	200.0	184.0	184.0	0.3	0.2	-104.45	-224.1	-869.3	897.9	897.4	0.49	1,837.244		
300.0	300.0	282.0	282.0	0.5	0.2	-104.39	-223.7	-871.5	900.0	899.2	0.75	1,198.900		
400.0	400.0	388.9	388.8	0.7	0.3	-179.91	-222.9	-873.7	902.6	901.6	1.02	887.915		
500.0	500.0	492.9	492.8	0.9	0.4	-179.78	-221.1	-875.3	906.3	905.1	1.28	706.318		
600.0	599.9	592.8	592.7	1.0	0.5	-179.67	-219.6	-876.6	911.6	910.0	1.55	589.745		
700.0	699.7	693.8	693.7	1.2	0.6	-179.58	-218.4	-877.8	918.5	916.7	1.81	507.698		
800.0	799.4	805.8	805.7	1.4	0.7	-179.50	-217.2	-878.2	926.4	924.4	2.08	445.084		
900.0	898.9	900.0	899.9	1.7	0.8	-179.43	-216.0	-878.3	935.9	933.5	2.34	400.104		
1,000.0	998.3	1,000.0	999.9	1.9	0.9	-179.38	-215.0	-878.5	947.1	944.5	2.60	364.255		
1,100.0	1,097.4	1,092.3	1,092.2	2.2	1.0	-179.35	-214.5	-878.7	960.3	957.4	2.86	336.288		
1,200.0	1,196.3	1,188.2	1,188.0	2.5	1.0	-179.30	-213.8	-879.7	975.9	972.8	3.11	313.420		
1,300.0	1,294.9	1,292.1	1,292.0	2.8	1.1	-179.26	-213.0	-880.7	993.1	989.7	3.38	293.892		
1,400.0	1,393.3	1,384.8	1,384.7	3.2	1.2	-179.21	-212.2	-881.5	1,012.0	1,008.3	3.63	278.401		
1,500.0	1,491.2	1,486.2	1,486.0	3.5	1.3	-179.18	-211.6	-882.5	1,032.7	1,028.8	3.90	264.970		
1,600.0	1,589.1	1,584.7	1,584.6	3.9	1.4	-179.16	-211.2	-883.1	1,054.0	1,049.9	4.16	253.336		
1,700.0	1,686.9	1,682.5	1,682.3	4.3	1.5	-179.13	-210.4	-883.8	1,075.3	1,070.9	4.42	243.128		
1,800.0	1,784.7	1,779.5	1,779.3	4.7	1.6	-179.10	-209.7	-884.6	1,096.7	1,092.0	4.68	234.094		
1,900.0	1,882.5	1,877.8	1,877.6	5.1	1.7	-179.05	-208.7	-885.4	1,118.0	1,113.1	4.95	225.966		
2,000.0	1,980.3	1,972.4	1,972.2	5.5	1.7	-179.02	-207.8	-886.2	1,139.4	1,134.2	5.21	218.809		
2,100.0	2,078.1	2,062.9	2,062.7	5.9	1.8	-178.98	-207.1	-887.4	1,161.2	1,155.8	5.46	212.552		
2,200.0	2,175.9	2,153.5	2,153.2	6.3	1.9	-178.95	-206.5	-889.1	1,183.7	1,178.0	5.72	206.962		
2,300.0	2,273.8	2,249.9	2,249.6	6.7	2.0	-178.92	-206.1	-891.4	1,206.6	1,200.6	5.98	201.770		
2,400.0	2,371.6	2,352.4	2,352.1	7.1	2.1	-178.96	-206.8	-893.2	1,229.2	1,223.0	6.25	196.832		
2,500.0	2,469.4	2,452.8	2,452.5	7.5	2.2	-179.00	-207.7	-894.5	1,251.5	1,245.0	6.51	192.286 SF		

Anticollision Report

Company:	EnCana Oil & Gas (USA) Inc	Local Co-ordinate Reference:	Well Devore 1G-34H
Project:	DJ Wattenberg	TVD Reference:	WELL @ 4974.0ft (Original Well Elev)
Reference Site:	S34-T3N-R66W (Devore)	MD Reference:	WELL @ 4974.0ft (Original Well Elev)
Site Error:	0.0ft	North Reference:	True
Reference Well:	Devore 1G-34H	Survey Calculation Method:	Minimum Curvature
Well Error:	0.0ft	Output errors are at	2.00 sigma
Reference Wellbore	Hz	Database:	USA EDM 5000 Multi Users DB
Reference Design:	Plan #1	Offset TVD Reference:	Offset Datum

Offset Design S34-T3N-R66W (Devore) - DEVORE 3-34 (EXISTING) - EXISTING - GYRO													Offset Site Error:	0.0 ft
Survey Program: 100-Gyro													Offset Well Error:	0.0 ft
Reference		Offset		Semi Major Axis			Distance				Total Uncertainty Axis	Separation Factor	Warning	
Measured Depth (ft)	Vertical Depth (ft)	Measured Depth (ft)	Vertical Depth (ft)	Reference (ft)	Offset (ft)	Highside Toolface (°)	Offset Wellbore Centre +N/-S (ft)	+E/-W (ft)	Between Centres (ft)	Between Ellipses (ft)				
10,200.0	7,403.0	7,431.5	7,428.8	54.7	6.5	89.24	-3,933.1	309.4	1,264.6	1,205.9	58.63	21.569		
10,300.0	7,403.0	7,432.0	7,429.3	56.4	6.5	89.30	-3,933.1	309.4	1,175.1	1,114.8	60.33	19.478		
10,400.0	7,403.0	7,432.6	7,429.8	58.0	6.5	89.35	-3,933.1	309.3	1,087.5	1,025.5	62.04	17.530		
10,500.0	7,403.0	7,433.1	7,430.4	59.6	6.5	89.41	-3,933.1	309.3	1,002.3	938.5	63.75	15.722		
10,600.0	7,403.0	7,433.6	7,430.9	61.3	6.5	89.47	-3,933.1	309.3	920.0	854.5	65.46	14.054		
10,700.0	7,403.0	7,434.2	7,431.5	62.9	6.5	89.52	-3,933.1	309.3	841.5	774.3	67.18	12.527		
10,800.0	7,403.0	7,434.7	7,432.0	64.6	6.5	89.58	-3,933.1	309.3	768.1	699.2	68.89	11.149		
10,900.0	7,403.0	7,435.2	7,432.5	66.2	6.5	89.63	-3,933.1	309.3	701.3	630.6	70.61	9.931		
11,000.0	7,403.0	7,435.8	7,433.0	67.9	6.5	89.69	-3,933.1	309.3	643.1	570.8	72.33	8.891		
11,100.0	7,403.0	7,436.3	7,433.6	69.6	6.5	89.74	-3,933.1	309.3	596.1	522.1	74.06	8.050		
11,200.0	7,403.0	7,436.8	7,434.1	71.2	6.5	89.80	-3,933.1	309.3	563.2	487.4	75.78	7.432		
11,300.0	7,403.0	7,437.3	7,434.6	72.9	6.5	89.85	-3,933.1	309.3	546.8	469.3	77.51	7.055		
11,341.0	7,403.0	7,437.5	7,434.8	73.6	6.5	89.87	-3,933.1	309.3	545.3	467.0	78.21	6.971 CC, ES		
11,400.0	7,403.0	7,437.8	7,435.1	74.6	6.5	89.91	-3,933.1	309.3	548.4	469.2	79.23	6.922 SF		
11,500.0	7,403.0	7,438.3	7,435.6	76.3	6.5	89.96	-3,933.1	309.3	568.0	487.0	80.96	7.015		
11,600.0	7,403.0	7,438.9	7,436.1	78.0	6.5	90.01	-3,933.1	309.3	603.7	521.0	82.69	7.300		
11,700.0	7,403.0	7,439.4	7,436.6	79.7	6.5	90.07	-3,933.1	309.3	652.8	568.4	84.42	7.733		
11,800.0	7,403.0	7,439.9	7,437.1	81.4	6.5	90.12	-3,933.1	309.3	712.7	626.6	86.15	8.273		
11,900.0	7,403.0	7,440.4	7,437.6	83.1	6.5	90.17	-3,933.1	309.3	780.9	693.0	87.89	8.885		
11,973.1	7,403.0	7,440.7	7,438.0	84.3	6.5	90.21	-3,933.1	309.3	834.8	745.6	89.15	9.363		

Anticollision Report

Company:	EnCana Oil & Gas (USA) Inc	Local Co-ordinate Reference:	Well Devore 1G-34H
Project:	DJ Wattenberg	TVD Reference:	WELL @ 4974.0ft (Original Well Elev)
Reference Site:	S34-T3N-R66W (Devore)	MD Reference:	WELL @ 4974.0ft (Original Well Elev)
Site Error:	0.0ft	North Reference:	True
Reference Well:	Devore 1G-34H	Survey Calculation Method:	Minimum Curvature
Well Error:	0.0ft	Output errors are at	2.00 sigma
Reference Wellbore	Hz	Database:	USA EDM 5000 Multi Users DB
Reference Design:	Plan #1	Offset TVD Reference:	Offset Datum

Offset Design S34-T3N-R66W (Devore) - DEVORE 41-34 (EXISTING) - EXISTING - GYRO													Offset Site Error:	0.0 ft
Survey Program: 100-Gyro													Offset Well Error:	0.0 ft
Reference		Offset		Semi Major Axis			Distance				Total Uncertainty Axis	Separation Factor	Warning	
Measured Depth (ft)	Vertical Depth (ft)	Measured Depth (ft)	Vertical Depth (ft)	Reference (ft)	Offset (ft)	Highside Toolface (°)	Offset Wellbore Centre +N/-S (ft)	+E/-W (ft)	Between Centres (ft)	Between Ellipses (ft)				
0.0	0.0	0.0	0.0	0.0	0.0	106.69	-218.1	727.8	759.9					
100.0	100.0	82.0	82.0	0.2	0.1	106.67	-217.9	728.0	759.9	759.7	0.22	3,400.044		
200.0	200.0	183.3	183.3	0.3	0.2	106.61	-217.4	728.6	760.3	759.8	0.49	1,563.272		
300.0	300.0	284.7	284.6	0.5	0.2	106.57	-216.9	728.9	760.4	759.7	0.75	1,014.819		
400.0	400.0	385.6	385.5	0.7	0.3	30.97	-216.4	729.0	759.7	758.7	1.01	750.192		
500.0	500.0	486.6	486.5	0.9	0.4	31.05	-215.9	729.0	757.3	756.0	1.28	593.299		
600.0	599.9	586.6	586.6	1.0	0.5	31.21	-215.5	728.9	753.3	751.8	1.54	488.769		
700.0	699.7	686.8	686.8	1.2	0.6	31.44	-214.9	728.8	747.9	746.0	1.81	413.313		
800.0	799.4	786.0	786.0	1.4	0.7	31.75	-214.3	728.7	740.9	738.8	2.08	356.046		
900.0	898.9	882.7	882.7	1.7	0.8	32.14	-213.8	728.8	732.7	730.4	2.36	311.009		
1,000.0	998.3	981.0	981.0	1.9	0.9	32.62	-213.4	729.2	723.4	720.8	2.64	274.052		
1,100.0	1,097.4	1,080.5	1,080.5	2.2	0.9	33.21	-213.1	729.6	712.7	709.8	2.93	242.943		
1,200.0	1,196.3	1,180.7	1,180.7	2.5	1.0	33.93	-212.9	729.9	700.5	697.3	3.24	216.229		
1,300.0	1,294.9	1,276.5	1,276.4	2.8	1.1	34.74	-212.9	730.1	687.1	683.5	3.56	193.206		
1,400.0	1,393.3	1,377.7	1,377.6	3.2	1.2	35.68	-212.5	730.7	672.5	668.6	3.89	172.672		
1,500.0	1,491.2	1,472.9	1,472.9	3.5	1.3	36.74	-212.4	730.9	656.5	652.3	4.25	154.526		
1,600.0	1,589.1	1,573.6	1,573.6	3.9	1.4	37.91	-212.9	731.2	640.3	635.7	4.62	138.527		
1,700.0	1,686.9	1,669.3	1,669.2	4.3	1.5	39.06	-213.1	731.2	624.0	619.0	5.00	124.725		
1,800.0	1,784.7	1,767.0	1,766.9	4.7	1.5	40.32	-213.6	731.6	608.4	603.0	5.40	112.681		
1,900.0	1,882.5	1,867.0	1,867.0	5.1	1.6	41.62	-213.6	731.9	592.8	587.0	5.81	102.017		
2,000.0	1,980.3	1,964.7	1,964.6	5.5	1.7	42.94	-213.4	732.1	577.3	571.1	6.23	92.629		
2,100.0	2,078.1	2,064.4	2,064.3	5.9	1.8	44.38	-213.2	732.2	562.2	555.5	6.67	84.265		
2,200.0	2,175.9	2,161.5	2,161.4	6.3	1.9	45.85	-212.9	732.1	547.1	539.9	7.12	76.826		
2,300.0	2,273.8	2,258.6	2,258.6	6.7	2.0	47.36	-212.4	732.4	532.7	525.1	7.58	70.244		
2,400.0	2,371.6	2,357.8	2,357.8	7.1	2.1	48.96	-211.6	732.8	518.5	510.5	8.06	64.319		
2,500.0	2,469.4	2,457.8	2,457.8	7.5	2.1	50.67	-210.7	733.0	504.5	496.0	8.56	58.956		
2,600.0	2,567.2	2,556.2	2,556.1	7.9	2.2	52.45	-209.7	732.7	490.6	481.5	9.07	54.116		
2,700.0	2,665.0	2,653.5	2,653.4	8.3	2.3	54.31	-208.7	732.6	477.3	467.7	9.59	49.784		
2,800.0	2,762.8	2,750.9	2,750.9	8.7	2.4	56.25	-207.7	732.6	464.6	454.4	10.12	45.897		
2,900.0	2,860.7	2,848.6	2,848.5	9.1	2.5	58.29	-206.5	732.8	452.5	441.8	10.67	42.409		
3,000.0	2,958.5	2,946.9	2,946.8	9.5	2.6	60.41	-205.2	733.1	441.1	429.8	11.23	39.272		
3,100.0	3,056.3	3,044.8	3,044.8	9.9	2.7	62.62	-203.8	733.4	430.1	418.3	11.80	36.448		
3,200.0	3,154.1	3,143.9	3,143.8	10.3	2.7	64.94	-202.3	733.9	419.9	407.5	12.38	33.912		
3,300.0	3,251.9	3,243.7	3,243.6	10.7	2.8	67.38	-200.2	734.1	409.9	396.9	12.97	31.595		
3,400.0	3,349.7	3,342.9	3,342.8	11.1	2.9	69.92	-198.1	734.2	400.4	386.8	13.56	29.517		
3,500.0	3,447.5	3,442.6	3,442.4	11.5	3.0	72.70	-195.8	733.3	391.2	377.0	14.16	27.619		
3,600.0	3,545.4	3,539.7	3,539.5	11.9	3.1	75.61	-193.8	731.9	382.8	368.1	14.76	25.942		
3,700.0	3,643.2	3,635.0	3,634.7	12.3	3.2	78.71	-192.6	729.9	376.0	360.6	15.34	24.504		
3,800.0	3,741.0	3,728.7	3,728.5	12.7	3.3	81.78	-191.8	728.7	371.1	355.1	15.91	23.325		
3,900.0	3,838.8	3,821.7	3,821.4	13.2	3.3	84.88	-192.2	728.0	368.7	352.2	16.45	22.409		
3,982.7	3,919.7	3,901.6	3,901.3	13.5	3.4	87.50	-192.9	727.9	368.2	351.3	16.89	21.802		
4,000.0	3,936.6	3,918.5	3,918.2	13.6	3.4	88.05	-193.0	727.9	368.2	351.2	16.98	21.689		
4,100.0	4,034.4	4,015.6	4,015.4	14.0	3.5	91.17	-193.9	728.3	369.1	351.6	17.47	21.123		
4,200.0	4,132.2	4,111.4	4,111.2	14.4	3.6	94.24	-195.2	728.7	371.5	353.5	17.94	20.711		
4,300.0	4,230.1	4,207.8	4,207.5	14.8	3.7	97.26	-196.9	729.2	375.5	357.1	18.37	20.440		
4,400.0	4,327.9	4,302.5	4,302.2	15.2	3.8	100.18	-199.1	729.6	381.1	362.4	18.77	20.307		
4,500.0	4,425.7	4,399.2	4,398.8	15.6	3.8	103.10	-202.0	729.9	388.4	369.3	19.13	20.299		
4,600.0	4,523.8	4,498.1	4,497.7	16.0	3.9	105.82	-204.9	730.3	396.3	376.8	19.44	20.382		
4,700.0	4,622.3	4,596.5	4,596.1	16.3	4.0	108.21	-207.6	730.6	404.3	384.6	19.71	20.508		
4,800.0	4,721.0	4,695.1	4,694.6	16.6	4.1	110.28	-210.4	730.9	412.4	392.4	19.96	20.660		
4,900.0	4,820.0	4,793.8	4,793.3	16.9	4.2	112.05	-213.2	731.2	420.3	400.1	20.18	20.823		
5,000.0	4,919.3	4,892.7	4,892.2	17.2	4.3	113.54	-216.1	731.6	428.0	407.6	20.40	20.981		

CC - Min centre to center distance or convergent point, SF - min separation factor, ES - min ellipse separation

Anticollision Report

Company:	EnCana Oil & Gas (USA) Inc	Local Co-ordinate Reference:	Well Devore 1G-34H
Project:	DJ Wattenberg	TVD Reference:	WELL @ 4974.0ft (Original Well Elev)
Reference Site:	S34-T3N-R66W (Devore)	MD Reference:	WELL @ 4974.0ft (Original Well Elev)
Site Error:	0.0ft	North Reference:	True
Reference Well:	Devore 1G-34H	Survey Calculation Method:	Minimum Curvature
Well Error:	0.0ft	Output errors are at	2.00 sigma
Reference Wellbore	Hz	Database:	USA EDM 5000 Multi Users DB
Reference Design:	Plan #1	Offset TVD Reference:	Offset Datum

Offset Design S34-T3N-R66W (Devore) - DEVORE 41-34 (EXISTING) - EXISTING - GYRO													Offset Site Error:	0.0 ft
Survey Program: 100-Gyro													Offset Well Error:	0.0 ft
Reference		Offset		Semi Major Axis			Distance				Total Uncertainty Axis	Separation Factor	Warning	
Measured Depth (ft)	Vertical Depth (ft)	Measured Depth (ft)	Vertical Depth (ft)	Reference (ft)	Offset (ft)	Highside Toolface (°)	Offset Wellbore Centre +N/-S (ft)	+E/-W (ft)	Between Centres (ft)	Between Ellipses (ft)				
5,100.0	5,018.7	4,992.4	4,991.8	17.4	4.4	114.75	-219.0	732.1	435.1	414.5	20.60	21.122		
5,200.0	5,118.3	5,092.5	5,091.8	17.6	4.4	115.69	-221.9	733.0	441.6	420.8	20.80	21.230		
5,300.0	5,218.0	5,190.1	5,189.4	17.8	4.5	116.33	-224.9	734.1	447.5	426.5	21.00	21.310		
5,400.0	5,317.9	5,295.8	5,295.0	18.0	4.6	116.79	-227.9	735.4	452.4	431.2	21.20	21.338		
5,500.0	5,417.8	5,398.7	5,397.9	18.1	4.7	117.03	-229.6	736.6	455.5	434.1	21.40	21.283		
5,600.0	5,517.8	5,500.9	5,500.1	18.2	4.8	117.04	-230.9	738.2	457.2	435.6	21.60	21.164		
5,700.0	5,617.8	5,604.1	5,603.3	18.3	4.9	-167.57	-231.5	740.1	457.6	435.9	21.71	21.072		
5,730.4	5,648.2	5,634.0	5,633.2	18.3	4.9	-167.63	-231.6	740.6	457.6	435.8	21.78	21.010		
5,800.0	5,717.8	5,702.7	5,701.9	18.4	5.0	-167.74	-231.9	741.4	457.6	435.7	21.92	20.876		
5,900.0	5,817.8	5,807.8	5,806.9	18.5	5.1	-167.86	-231.7	742.4	457.2	435.1	22.13	20.661		
6,000.0	5,917.8	5,906.0	5,905.2	18.6	5.2	-167.91	-231.1	743.0	456.5	434.2	22.33	20.448		
6,100.0	6,017.8	6,006.3	6,005.5	18.7	5.2	-167.92	-230.6	743.2	456.0	433.5	22.52	20.246		
6,200.0	6,117.8	6,106.2	6,105.3	18.8	5.3	-167.97	-230.1	743.7	455.4	432.7	22.72	20.043		
6,300.0	6,217.8	6,206.1	6,205.3	18.9	5.4	-168.06	-229.7	744.5	454.9	431.9	22.93	19.840		
6,400.0	6,317.8	6,304.9	6,304.0	19.0	5.5	-168.17	-229.5	745.5	454.4	431.3	23.13	19.644		
6,450.3	6,368.1	6,353.9	6,353.1	19.0	5.5	-168.23	-229.5	746.0	454.4	431.1	23.24	19.553		
6,500.0	6,417.8	6,402.4	6,401.6	19.1	5.6	-168.30	-229.7	746.5	454.4	431.1	23.34	19.468		
6,600.0	6,517.8	6,500.0	6,499.1	19.2	5.7	-168.52	-230.6	748.1	455.0	431.5	23.56	19.313		
6,700.0	6,617.8	6,598.3	6,597.4	19.3	5.8	-168.87	-232.1	750.6	456.0	432.3	23.79	19.168		
6,800.0	6,717.8	6,702.0	6,701.0	19.4	5.9	11.80	-233.5	753.2	456.2	432.1	24.09	18.934		
6,900.0	6,817.1	6,804.2	6,803.2	19.5	5.9	12.14	-233.8	754.4	445.2	421.2	24.05	18.515		
7,000.0	6,913.8	6,903.7	6,902.8	19.5	6.0	13.34	-233.2	754.5	420.2	396.5	23.70	17.731		
7,100.0	7,006.2	6,998.5	6,997.6	19.5	6.1	15.65	-231.9	754.3	381.8	358.8	23.08	16.545		
7,200.0	7,092.3	7,084.9	7,083.9	19.5	6.2	19.63	-230.2	754.2	331.3	309.1	22.22	14.912		
7,300.0	7,170.5	7,161.6	7,160.6	19.6	6.3	26.58	-228.6	754.2	270.6	249.4	21.20	12.764		
7,400.0	7,239.3	7,228.7	7,227.7	19.8	6.3	39.29	-227.4	754.4	202.8	182.5	20.27	10.005		
7,500.0	7,297.3	7,284.9	7,283.9	20.0	6.4	61.40	-226.4	754.4	134.7	114.7	19.99	6.738		
7,600.0	7,343.5	7,329.5	7,328.5	20.4	6.4	87.75	-225.6	754.3	92.5	72.1	20.36	4.541		
7,609.7	7,347.3	7,333.2	7,332.2	20.5	6.4	89.89	-225.6	754.3	92.0	71.6	20.41	4.510 CC, ES, SF		
7,700.0	7,376.9	7,361.6	7,360.6	20.9	6.4	103.22	-225.1	754.2	125.8	105.0	20.78	6.051		
7,800.0	7,396.8	7,380.3	7,379.3	21.6	6.4	103.14	-224.9	754.2	205.6	183.8	21.83	9.419		
7,900.0	7,403.0	7,385.1	7,384.1	22.4	6.4	87.57	-224.8	754.2	298.2	275.1	23.12	12.898		
8,000.0	7,403.0	7,383.7	7,382.7	23.3	6.4	86.70	-224.8	754.2	394.5	370.2	24.29	16.244		
8,100.0	7,403.0	7,382.3	7,381.3	24.3	6.4	85.82	-224.8	754.2	492.3	466.8	25.54	19.278		
8,200.0	7,403.0	7,380.9	7,379.8	25.3	6.4	84.94	-224.9	754.2	590.8	564.0	26.85	22.002		
8,300.0	7,403.0	7,379.4	7,378.4	26.5	6.4	84.05	-224.9	754.2	689.8	661.6	28.22	24.442		
8,400.0	7,403.0	7,378.0	7,376.9	27.7	6.4	83.15	-224.9	754.2	789.0	759.4	29.63	26.630		
8,500.0	7,403.0	7,376.5	7,375.5	28.9	6.4	82.25	-224.9	754.2	888.4	857.3	31.06	28.598		
8,600.0	7,403.0	7,375.0	7,374.0	30.3	6.4	81.35	-224.9	754.2	987.9	955.4	32.52	30.376		
8,700.0	7,403.0	7,373.5	7,372.5	31.6	6.4	80.44	-225.0	754.2	1,087.5	1,053.5	33.99	31.990		
8,800.0	7,403.0	7,372.0	7,371.0	33.0	6.4	79.53	-225.0	754.2	1,187.1	1,151.7	35.48	33.463		

Anticollision Report

Company:	EnCana Oil & Gas (USA) Inc	Local Co-ordinate Reference:	Well Devore 1G-34H
Project:	DJ Wattenberg	TVD Reference:	WELL @ 4974.0ft (Original Well Elev)
Reference Site:	S34-T3N-R66W (Devore)	MD Reference:	WELL @ 4974.0ft (Original Well Elev)
Site Error:	0.0ft	North Reference:	True
Reference Well:	Devore 1G-34H	Survey Calculation Method:	Minimum Curvature
Well Error:	0.0ft	Output errors are at	2.00 sigma
Reference Wellbore	Hz	Database:	USA EDM 5000 Multi Users DB
Reference Design:	Plan #1	Offset TVD Reference:	Offset Datum

Offset Design S34-T3N-R66W (Devore) - DEVORE 42-34 (EXISTING) - EXISTING - GYRO													Offset Site Error:	0.0 ft
Survey Program: 100-Gyro													Offset Well Error:	0.0 ft
Reference		Offset		Semi Major Axis		Distance		Total		Separation		Warning		
Measured Depth (ft)	Vertical Depth (ft)	Measured Depth (ft)	Vertical Depth (ft)	Reference (ft)	Offset (ft)	Highside Toolface (°)	Offset Wellbore Centre +N/-S (ft)	+E/-W (ft)	Between Centres (ft)	Between Ellipses (ft)	Uncertainty Axis			
8,300.0	7,403.0	7,444.2	7,438.1	26.5	6.6	117.84	-2,085.4	823.6	1,179.5	1,152.5	27.00	43.692		
8,400.0	7,403.0	7,441.8	7,435.8	27.7	6.6	115.91	-2,085.4	823.6	1,079.7	1,051.2	28.50	37.885		
8,500.0	7,403.0	7,439.5	7,433.5	28.9	6.6	113.90	-2,085.5	823.6	979.9	949.8	30.08	32.577		
8,600.0	7,403.0	7,437.1	7,431.1	30.3	6.6	111.80	-2,085.5	823.6	880.1	848.3	31.72	27.742		
8,700.0	7,403.0	7,434.7	7,428.7	31.6	6.6	109.62	-2,085.6	823.6	780.3	746.9	33.42	23.346		
8,800.0	7,403.0	7,432.3	7,426.3	33.0	6.6	107.36	-2,085.7	823.6	680.6	645.5	35.17	19.353		
8,900.0	7,403.0	7,429.8	7,423.8	34.4	6.6	105.03	-2,085.7	823.6	581.1	544.1	36.95	15.726		
9,000.0	7,403.0	7,427.4	7,421.4	35.9	6.6	102.61	-2,085.8	823.6	481.6	442.9	38.75	12.431		
9,100.0	7,403.0	7,424.9	7,418.9	37.4	6.6	100.13	-2,085.8	823.5	382.5	341.9	40.55	9.433		
9,200.0	7,403.0	7,422.4	7,416.4	38.9	6.6	97.59	-2,085.9	823.5	283.9	241.6	42.34	6.706		
9,300.0	7,403.0	7,419.8	7,413.8	40.4	6.6	94.99	-2,086.0	823.5	186.9	142.8	44.11	4.237		
9,400.0	7,403.0	7,417.3	7,411.3	42.0	6.6	92.35	-2,086.0	823.5	96.1	50.2	45.84	2.096		
9,478.6	7,403.0	7,415.2	7,409.2	43.2	6.6	90.24	-2,086.1	823.5	55.3	8.1	47.16	1.172 Level 2, CC, ES, SF		
9,500.0	7,403.0	7,414.7	7,408.7	43.5	6.6	89.67	-2,086.1	823.5	59.3	11.8	47.51	1.247 Level 2		
9,600.0	7,403.0	7,412.1	7,406.1	45.1	6.6	86.97	-2,086.2	823.5	133.3	84.2	49.12	2.715		
9,700.0	7,403.0	7,409.4	7,403.4	46.7	6.6	84.26	-2,086.2	823.5	228.1	177.5	50.64	4.505		
9,800.0	7,403.0	7,406.8	7,400.8	48.3	6.6	81.54	-2,086.3	823.5	326.0	273.9	52.06	6.262		
9,900.0	7,403.0	7,404.1	7,398.1	49.9	6.6	78.93	-2,086.4	823.5	424.9	371.5	53.38	7.959		
10,000.0	7,403.0	7,401.4	7,395.4	51.5	6.6	77.98	-2,086.5	823.5	524.0	469.4	54.64	9.590		
10,100.0	7,403.0	7,398.6	7,392.6	53.1	6.6	77.50	-2,086.5	823.4	623.3	567.3	55.96	11.138		
10,200.0	7,403.0	7,395.8	7,389.8	54.7	6.6	76.25	-2,086.6	823.4	722.6	665.3	57.27	12.616		
10,300.0	7,403.0	7,393.0	7,387.0	56.4	6.6	74.32	-2,086.7	823.4	822.0	763.5	58.50	14.050		
10,400.0	7,403.0	7,390.1	7,384.1	58.0	6.6	72.39	-2,086.8	823.4	921.6	861.9	59.66	15.447		
10,500.0	7,403.0	7,387.2	7,381.2	59.6	6.6	70.49	-2,086.8	823.4	1,021.2	960.5	60.74	16.813		
10,600.0	7,403.0	7,384.3	7,378.3	61.3	6.6	68.60	-2,086.9	823.4	1,120.9	1,059.2	61.73	18.157		
10,700.0	7,403.0	7,381.3	7,375.3	62.9	6.6	66.74	-2,087.0	823.4	1,220.6	1,158.0	62.65	19.485		

Anticollision Report

Company:	EnCana Oil & Gas (USA) Inc	Local Co-ordinate Reference:	Well Devore 1G-34H
Project:	DJ Wattenberg	TVD Reference:	WELL @ 4974.0ft (Original Well Elev)
Reference Site:	S34-T3N-R66W (Devore)	MD Reference:	WELL @ 4974.0ft (Original Well Elev)
Site Error:	0.0ft	North Reference:	True
Reference Well:	Devore 1G-34H	Survey Calculation Method:	Minimum Curvature
Well Error:	0.0ft	Output errors are at	2.00 sigma
Reference Wellbore	Hz	Database:	USA EDM 5000 Multi Users DB
Reference Design:	Plan #1	Offset TVD Reference:	Offset Datum

Offset Design S34-T3N-R66W (Devore) - DEVORE 43-34 (EXISTING) - EXISTING - GYRO												Offset Site Error:	0.0 ft
Survey Program: 100-Gyro												Offset Well Error:	0.0 ft
Reference		Offset		Semi Major Axis		Highside Toolface (°)	Offset Wellbore Centre		Distance		Total Uncertainty Axis	Separation Factor	Warning
Measured Depth (ft)	Vertical Depth (ft)	Measured Depth (ft)	Vertical Depth (ft)	Reference (ft)	Offset (ft)		+N/-S (ft)	+E/-W (ft)	Between Centres (ft)	Between Ellipses (ft)			
9,200.0	7,403.0	7,418.8	7,415.4	38.9	6.5	89.41	-2,913.7	441.9	1,188.5	1,146.0	42.45	27.994	
9,300.0	7,403.0	7,419.1	7,415.6	40.4	6.5	89.44	-2,913.7	441.9	1,096.6	1,052.5	44.10	24.866	
9,400.0	7,403.0	7,419.3	7,415.8	42.0	6.5	89.47	-2,913.7	441.9	1,006.3	960.6	45.76	21.993	
9,500.0	7,403.0	7,419.5	7,416.0	43.5	6.5	89.50	-2,913.7	441.9	918.0	870.6	47.42	19.360	
9,600.0	7,403.0	7,419.7	7,416.2	45.1	6.5	89.52	-2,913.7	441.9	832.4	783.3	49.09	16.956	
9,700.0	7,403.0	7,419.9	7,416.5	46.7	6.5	89.55	-2,913.7	441.9	750.4	699.6	50.77	14.780	
9,800.0	7,403.0	7,420.1	7,416.7	48.3	6.5	89.58	-2,913.7	441.9	673.2	620.7	52.45	12.833	
9,900.0	7,403.0	7,420.3	7,416.9	49.9	6.5	89.60	-2,913.7	441.9	602.7	548.6	54.13	11.135	
10,000.0	7,403.0	7,420.5	7,417.1	51.5	6.5	89.62	-2,913.7	441.9	540.8	485.2	55.57	9.732	
10,100.0	7,403.0	7,420.8	7,417.3	53.1	6.5	89.65	-2,913.7	441.9	490.1	433.1	57.01	8.597	
10,200.0	7,403.0	7,421.0	7,417.5	54.7	6.5	89.68	-2,913.7	441.9	454.5	395.9	58.60	7.757	
10,300.0	7,403.0	7,421.2	7,417.8	56.4	6.5	89.71	-2,913.7	441.9	439.2	378.9	60.30	7.283	
10,318.5	7,403.0	7,421.3	7,417.8	56.7	6.5	89.71	-2,913.7	441.9	438.8	378.2	60.62	7.239 CC, ES	
10,400.0	7,403.0	7,421.5	7,418.0	58.0	6.5	89.74	-2,913.7	441.9	446.3	384.3	62.01	7.198 SF	
10,500.0	7,403.0	7,421.7	7,418.2	59.6	6.5	89.77	-2,913.7	441.9	474.8	411.1	63.71	7.452	
10,600.0	7,403.0	7,421.9	7,418.5	61.3	6.5	89.80	-2,913.7	441.8	521.3	455.9	65.43	7.968	
10,700.0	7,403.0	7,422.2	7,418.7	62.9	6.5	89.83	-2,913.7	441.8	581.4	514.3	67.14	8.660	
10,800.0	7,403.0	7,422.4	7,418.9	64.6	6.5	89.86	-2,913.7	441.8	651.4	582.6	68.86	9.460	
10,900.0	7,403.0	7,422.6	7,419.2	66.2	6.5	89.89	-2,913.7	441.8	728.4	657.9	70.58	10.321	
11,000.0	7,403.0	7,422.8	7,419.4	67.9	6.5	89.92	-2,913.7	441.8	810.5	738.2	72.30	11.211	
11,100.0	7,403.0	7,423.1	7,419.6	69.6	6.5	89.95	-2,913.7	441.8	896.2	822.2	74.02	12.108	
11,200.0	7,403.0	7,423.3	7,419.8	71.2	6.5	89.98	-2,913.7	441.8	984.6	908.9	75.74	13.000	
11,300.0	7,403.0	7,423.5	7,420.1	72.9	6.5	90.01	-2,913.7	441.8	1,075.1	997.6	77.47	13.878	
11,400.0	7,403.0	7,423.7	7,420.3	74.6	6.5	90.04	-2,913.7	441.8	1,167.1	1,087.9	79.19	14.737	
11,500.0	7,403.0	7,424.0	7,420.5	76.3	6.5	90.07	-2,913.7	441.8	1,260.3	1,179.4	80.92	15.574	

Anticollision Report

Company:	EnCana Oil & Gas (USA) Inc	Local Co-ordinate Reference:	Well Devore 1G-34H
Project:	DJ Wattenberg	TVD Reference:	WELL @ 4974.0ft (Original Well Elev)
Reference Site:	S34-T3N-R66W (Devore)	MD Reference:	WELL @ 4974.0ft (Original Well Elev)
Site Error:	0.0ft	North Reference:	True
Reference Well:	Devore 1G-34H	Survey Calculation Method:	Minimum Curvature
Well Error:	0.0ft	Output errors are at	2.00 sigma
Reference Wellbore	Hz	Database:	USA EDM 5000 Multi Users DB
Reference Design:	Plan #1	Offset TVD Reference:	Offset Datum

Offset Design S34-T3N-R66W (Devore) - DEVORE 44-34 (EXISTING) - EXISTING - GYRO												Offset Site Error:	0.0 ft
Survey Program: 100-Gyro												Offset Well Error:	0.0 ft
Reference		Offset		Semi Major Axis		Distance							
Measured Depth (ft)	Vertical Depth (ft)	Measured Depth (ft)	Vertical Depth (ft)	Reference (ft)	Offset (ft)	Highside Toolface (°)	Offset Wellbore Centre +N/-S (ft)	+E/-W (ft)	Between Centres (ft)	Between Ellipses (ft)	Total Uncertainty Axis	Separation Factor	Warning
10,700.0	7,403.0	7,466.4	7,464.4	62.9	6.5	90.97	-4,508.3	759.6	1,207.2	1,140.0	67.19	17.968	
10,800.0	7,403.0	7,466.2	7,464.2	64.6	6.5	90.87	-4,508.3	759.6	1,107.5	1,038.6	68.90	16.073	
10,900.0	7,403.0	7,466.1	7,464.1	66.2	6.5	90.77	-4,508.3	759.6	1,007.8	937.1	70.62	14.270	
11,000.0	7,403.0	7,466.0	7,463.9	67.9	6.5	90.67	-4,508.3	759.6	908.1	835.8	72.34	12.553	
11,100.0	7,403.0	7,465.8	7,463.8	69.6	6.5	90.57	-4,508.3	759.6	808.6	734.5	74.06	10.917	
11,200.0	7,403.0	7,465.7	7,463.7	71.2	6.5	90.47	-4,508.3	759.6	709.1	633.3	75.79	9.357	
11,300.0	7,403.0	7,465.5	7,463.5	72.9	6.5	90.37	-4,508.3	759.6	609.9	532.4	77.51	7.868	
11,400.0	7,403.0	7,465.4	7,463.4	74.6	6.5	90.26	-4,508.3	759.6	510.9	431.7	79.24	6.448	
11,500.0	7,403.0	7,465.3	7,463.2	76.3	6.5	90.16	-4,508.3	759.6	412.5	331.5	80.97	5.094	
11,600.0	7,403.0	7,465.1	7,463.1	78.0	6.5	90.06	-4,508.3	759.6	315.0	232.3	82.70	3.809	
11,700.0	7,403.0	7,465.0	7,462.9	79.7	6.5	89.96	-4,508.3	759.6	219.8	135.4	84.43	2.604	
11,800.0	7,403.0	7,464.8	7,462.8	81.4	6.5	89.86	-4,508.3	759.6	131.9	45.8	86.16	1.531	
11,900.0	7,403.0	7,464.7	7,462.7	83.1	6.5	89.76	-4,508.3	759.6	80.6	-7.3	87.89	0.917 Level 1	
11,904.5	7,403.0	7,464.7	7,462.7	83.1	6.5	89.75	-4,508.3	759.6	80.5	-7.5	87.97	0.915 Level 1, CC, ES, SF	
11,973.1	7,403.0	7,464.6	7,462.6	84.3	6.5	89.68	-4,508.3	759.6	105.8	16.6	89.15	1.186 Level 2	

Anticollision Report

Company:	EnCana Oil & Gas (USA) Inc	Local Co-ordinate Reference:	Well Devore 1G-34H
Project:	DJ Wattenberg	TVD Reference:	WELL @ 4974.0ft (Original Well Elev)
Reference Site:	S34-T3N-R66W (Devore)	MD Reference:	WELL @ 4974.0ft (Original Well Elev)
Site Error:	0.0ft	North Reference:	True
Reference Well:	Devore 1G-34H	Survey Calculation Method:	Minimum Curvature
Well Error:	0.0ft	Output errors are at	2.00 sigma
Reference Wellbore	Hz	Database:	USA EDM 5000 Multi Users DB
Reference Design:	Plan #1	Offset TVD Reference:	Offset Datum

Offset Design S34-T3N-R66W (Devore) - DEVORE 6-0-34 (EXISTING) - EXISTING - SURVEYS													Offset Site Error:	0.0 ft
Survey Program: 1206-MWD													Offset Well Error:	0.0 ft
Reference		Offset		Semi Major Axis			Distance				Total Uncertainty Axis	Separation Factor	Warning	
Measured Depth (ft)	Vertical Depth (ft)	Measured Depth (ft)	Vertical Depth (ft)	Reference (ft)	Offset (ft)	Highside Toolface (°)	Offset Wellbore Centre +N/-S (ft)	+E/-W (ft)	Between Centres (ft)	Between Ellipses (ft)				
0.0	0.0	0.0	0.0	0.0	0.0	104.15	-183.2	726.7	749.4					
100.0	100.0	100.4	100.4	0.2	0.2	104.15	-183.2	726.7	749.4	749.1	0.33	2,296.407		
200.0	200.0	199.7	199.7	0.3	0.3	104.15	-183.2	726.8	749.6	748.9	0.67	1,112.670		
300.0	300.0	299.1	299.1	0.5	0.5	104.14	-183.2	727.1	749.8	748.8	1.02	734.376		
400.0	400.0	398.4	398.4	0.7	0.7	28.57	-183.3	727.4	749.3	748.0	1.37	548.887		
500.0	500.0	497.8	497.8	0.9	0.9	28.68	-183.3	727.7	747.4	745.7	1.71	436.515		
600.0	599.9	597.0	597.0	1.0	1.0	28.85	-183.3	728.2	744.1	742.0	2.06	361.100		
700.0	699.7	696.3	696.3	1.2	1.2	29.09	-183.4	728.8	739.3	736.9	2.41	306.630		
800.0	799.4	795.4	795.4	1.4	1.4	29.41	-183.5	729.4	733.1	730.3	2.76	265.171		
900.0	898.9	894.3	894.3	1.7	1.6	29.81	-183.6	730.1	725.4	722.3	3.12	232.345		
1,000.0	998.3	993.2	993.2	1.9	1.7	30.29	-183.7	730.9	716.4	712.9	3.49	205.536		
1,100.0	1,097.4	1,091.8	1,091.8	2.2	1.9	30.86	-183.8	731.8	706.1	702.2	3.86	183.088		
1,200.0	1,196.3	1,190.3	1,190.2	2.5	2.1	31.53	-183.9	732.8	694.4	690.1	4.24	163.903		
1,300.0	1,294.9	1,291.0	1,290.9	2.8	2.2	32.33	-184.0	733.7	681.2	676.6	4.63	147.003		
1,400.0	1,393.3	1,403.4	1,403.4	3.2	2.4	33.30	-183.2	733.7	665.5	660.5	5.07	131.314		
1,500.0	1,491.2	1,522.5	1,522.4	3.5	2.6	34.37	-179.8	731.5	646.4	640.8	5.53	116.825		
1,600.0	1,589.1	1,663.8	1,663.1	3.9	2.9	35.63	-172.5	721.2	620.6	614.5	6.06	102.445		
1,700.0	1,686.9	1,774.8	1,773.0	4.3	3.1	36.72	-164.7	708.2	590.4	583.9	6.54	90.340		
1,800.0	1,784.7	1,879.9	1,876.9	4.7	3.3	37.88	-156.7	694.1	558.7	551.7	7.02	79.641		
1,900.0	1,882.5	1,975.9	1,971.5	5.1	3.6	39.18	-149.7	679.4	525.8	518.3	7.49	70.175		
2,000.0	1,980.3	2,066.3	2,060.7	5.5	3.8	40.70	-144.3	665.9	493.9	485.9	7.98	61.900		
2,100.0	2,078.1	2,166.4	2,159.4	5.9	4.1	42.56	-137.8	650.4	461.7	453.2	8.51	54.263		
2,200.0	2,175.9	2,260.5	2,252.0	6.3	4.3	44.65	-131.8	635.0	429.2	420.2	9.05	47.401		
2,300.0	2,273.8	2,353.6	2,343.7	6.7	4.6	47.15	-126.4	619.3	397.3	387.7	9.64	41.219		
2,400.0	2,371.6	2,446.4	2,435.0	7.1	4.9	50.03	-121.1	603.9	366.4	356.2	10.27	35.697		
2,500.0	2,469.4	2,538.5	2,525.7	7.5	5.2	53.43	-116.2	588.7	336.8	325.9	10.95	30.767		
2,600.0	2,567.2	2,631.0	2,616.8	7.9	5.5	57.46	-111.3	573.3	308.6	296.9	11.70	26.383		
2,700.0	2,665.0	2,723.2	2,707.6	8.3	5.8	62.27	-107.2	558.1	282.8	270.3	12.53	22.571		
2,800.0	2,762.8	2,816.0	2,799.1	8.7	6.0	68.00	-103.2	542.7	259.5	246.0	13.44	19.303		
2,900.0	2,860.7	2,911.1	2,892.7	9.1	6.4	74.89	-98.9	526.6	239.2	224.7	14.44	16.562		
3,000.0	2,958.5	3,003.4	2,983.5	9.5	6.7	82.62	-94.8	510.8	222.8	207.4	15.44	14.431		
3,100.0	3,056.3	3,096.6	3,075.4	9.9	7.0	91.16	-90.6	495.4	211.7	195.3	16.37	12.928		
3,200.0	3,154.1	3,190.8	3,168.2	10.3	7.3	100.29	-86.2	480.3	206.3	189.2	17.16	12.027		
3,240.8	3,194.0	3,228.5	3,205.4	10.5	7.4	104.07	-84.3	474.1	205.8	188.3	17.41	11.819 CC, ES		
3,300.0	3,251.9	3,282.6	3,258.7	10.7	7.6	109.48	-81.9	465.1	207.0	189.3	17.70	11.697 SF		
3,400.0	3,349.7	3,374.3	3,349.2	11.1	7.8	118.06	-78.5	451.0	214.5	196.5	17.98	11.928		
3,500.0	3,447.5	3,465.5	3,439.4	11.5	8.1	125.62	-76.5	437.8	228.1	210.0	18.09	12.614		
3,600.0	3,545.4	3,559.8	3,532.6	11.9	8.4	132.61	-74.7	423.7	246.4	228.3	18.05	13.647		
3,700.0	3,643.2	3,657.0	3,628.6	12.3	8.7	139.05	-71.6	408.5	267.1	249.2	17.93	14.901		
3,800.0	3,741.0	3,751.0	3,721.3	12.7	9.0	144.58	-67.2	393.7	289.8	272.0	17.79	16.292		
3,900.0	3,838.8	3,845.7	3,814.7	13.2	9.3	149.41	-62.7	378.5	315.0	297.3	17.66	17.831		
4,000.0	3,936.6	3,943.0	3,910.7	13.6	9.6	153.60	-57.6	363.8	341.0	323.5	17.58	19.403		
4,100.0	4,034.4	4,035.1	4,001.6	14.0	10.0	157.12	-52.0	349.8	368.1	350.6	17.55	20.972		
4,200.0	4,132.2	4,121.8	4,086.7	14.4	10.3	160.26	-46.0	334.6	397.9	380.3	17.57	22.651		
4,300.0	4,230.1	4,215.8	4,178.9	14.8	10.6	163.23	-39.7	317.6	429.3	411.7	17.61	24.385		
4,400.0	4,327.9	4,311.2	4,272.7	15.2	11.0	165.73	-33.9	301.0	461.3	443.6	17.70	26.056		
4,500.0	4,425.7	4,406.8	4,367.0	15.6	11.3	167.84	-28.4	285.5	493.0	475.1	17.86	27.602		
4,600.0	4,523.8	4,501.3	4,460.0	16.0	11.6	169.62	-23.4	270.4	523.8	505.8	18.07	28.991		
4,700.0	4,622.3	4,592.7	4,550.3	16.3	11.9	171.00	-19.7	256.2	553.4	535.1	18.31	30.223		
4,800.0	4,721.0	4,695.3	4,651.6	16.6	12.2	172.34	-15.5	240.2	581.8	563.2	18.59	31.296		
4,900.0	4,820.0	4,792.0	4,747.0	16.9	12.5	173.62	-9.4	225.8	607.3	588.4	18.88	32.163		
5,000.0	4,919.3	4,891.0	4,844.5	17.2	12.9	174.92	-2.2	210.2	631.7	612.5	19.18	32.933		

CC - Min centre to center distance or convergent point, SF - min separation factor, ES - min ellipse separation

Anticollision Report

Company:	EnCana Oil & Gas (USA) Inc	Local Co-ordinate Reference:	Well Devore 1G-34H
Project:	DJ Wattenberg	TVD Reference:	WELL @ 4974.0ft (Original Well Elev)
Reference Site:	S34-T3N-R66W (Devore)	MD Reference:	WELL @ 4974.0ft (Original Well Elev)
Site Error:	0.0ft	North Reference:	True
Reference Well:	Devore 1G-34H	Survey Calculation Method:	Minimum Curvature
Well Error:	0.0ft	Output errors are at	2.00 sigma
Reference Wellbore	Hz	Database:	USA EDM 5000 Multi Users DB
Reference Design:	Plan #1	Offset TVD Reference:	Offset Datum

Offset Design S34-T3N-R66W (Devore) - DEVORE 6-0-34 (EXISTING) - EXISTING - SURVEYS													Offset Site Error:	0.0 ft
Survey Program: 1206-MWD													Offset Well Error:	0.0 ft
Reference		Offset		Semi Major Axis		Highside Toolface (°)	Distance		Total Uncertainty Axis	Separation Factor	Warning			
Measured Depth (ft)	Vertical Depth (ft)	Measured Depth (ft)	Vertical Depth (ft)	Reference (ft)	Offset (ft)		Offset Wellbore Centre +N/-S (ft)	+E/-W (ft)						
5,100.0	5,018.7	4,987.3	4,939.4	17.4	13.2	176.03	4.6	195.9	654.0	634.5	19.49	33.548		
5,200.0	5,118.3	5,075.2	5,026.0	17.6	13.5	176.92	10.1	181.9	676.1	656.3	19.80	34.145		
5,300.0	5,218.0	5,169.0	5,118.5	17.8	13.8	177.71	14.7	166.9	697.1	677.0	20.12	34.642		
5,400.0	5,317.9	5,267.5	5,215.6	18.0	14.2	178.46	19.1	150.8	716.9	696.4	20.46	35.045		
5,500.0	5,417.8	5,375.5	5,322.1	18.1	14.5	179.28	24.9	133.7	734.3	713.5	20.81	35.293		
5,600.0	5,517.8	5,468.5	5,413.8	18.2	14.8	179.95	30.1	119.6	749.6	728.4	21.14	35.465		
5,700.0	5,617.8	5,571.2	5,515.0	18.3	15.2	-103.65	36.7	103.2	763.9	742.5	21.40	35.694		
5,800.0	5,717.8	5,691.2	5,633.6	18.4	15.6	-102.83	43.9	86.3	776.3	754.5	21.79	35.635		
5,900.0	5,817.8	5,799.4	5,740.8	18.5	15.9	-102.13	50.9	73.5	786.5	764.3	22.16	35.499		
6,000.0	5,917.8	5,889.9	5,830.4	18.6	16.1	-101.56	56.6	62.8	796.9	774.4	22.49	35.437		
6,100.0	6,017.8	5,988.8	5,928.5	18.7	16.4	-101.02	61.7	50.2	808.3	785.4	22.84	35.382		
6,200.0	6,117.8	6,083.5	6,022.0	18.8	16.7	-100.31	69.7	37.7	819.8	796.5	23.21	35.318		
6,300.0	6,217.8	6,188.5	6,125.4	18.9	17.1	-99.37	80.8	23.5	831.5	807.9	23.60	35.237		
6,400.0	6,317.8	6,291.0	6,226.6	19.0	17.4	-98.52	91.3	10.6	842.3	818.4	23.98	35.132		
6,500.0	6,417.8	6,400.6	6,334.9	19.1	17.7	-97.70	101.6	-2.4	852.8	828.5	24.37	35.002		
6,600.0	6,517.8	6,514.0	6,447.4	19.2	18.0	-97.02	110.4	-13.8	861.9	837.1	24.75	34.828		
6,700.0	6,617.8	6,627.0	6,559.9	19.3	18.3	-96.62	115.4	-23.0	869.4	844.3	25.11	34.625		
6,800.0	6,717.8	6,753.1	6,685.7	19.4	18.5	84.58	118.2	-30.2	874.8	849.3	25.54	34.253		
6,900.0	6,817.1	6,876.5	6,809.0	19.5	18.7	85.46	119.2	-33.1	876.1	850.3	25.80	33.952		
7,000.0	6,913.8	6,973.3	6,905.8	19.5	18.8	87.12	119.8	-34.2	875.5	849.5	25.94	33.746		
7,050.9	6,961.5	7,019.5	6,952.1	19.5	18.9	88.21	120.1	-34.7	875.3	849.3	25.99	33.675		
7,100.0	7,006.2	7,062.1	6,994.7	19.5	18.9	89.37	120.4	-35.3	875.5	849.5	26.03	33.639		
7,200.0	7,092.3	7,143.9	7,076.5	19.5	19.1	91.90	121.1	-36.6	878.2	852.1	26.09	33.662		
7,300.0	7,170.5	7,217.6	7,150.1	19.6	19.2	94.33	121.8	-38.2	885.4	859.2	26.16	33.839		
7,400.0	7,239.3	7,282.3	7,214.8	19.8	19.3	96.27	122.3	-39.8	899.1	872.7	26.33	34.152		
7,500.0	7,297.3	7,336.8	7,269.3	20.0	19.4	97.34	122.7	-41.4	920.8	894.1	26.68	34.509		
7,600.0	7,343.5	7,384.2	7,316.7	20.4	19.4	97.46	123.1	-42.8	951.5	924.2	27.34	34.801		
7,700.0	7,376.9	7,423.7	7,356.2	20.9	19.5	96.39	123.6	-43.7	991.2	962.9	28.35	34.963		
7,800.0	7,396.8	7,446.1	7,378.5	21.6	19.5	93.39	124.0	-44.1	1,039.6	1,010.0	29.64	35.078		
7,900.0	7,403.0	7,451.4	7,383.9	22.4	19.5	88.69	124.0	-44.1	1,095.4	1,064.6	30.85	35.504		
8,000.0	7,403.0	7,449.4	7,381.8	23.3	19.5	88.56	124.0	-44.1	1,157.3	1,125.2	32.04	36.122		
8,100.0	7,403.0	7,447.4	7,379.9	24.3	19.5	88.44	124.0	-44.1	1,224.1	1,190.8	33.31	36.752		

Anticollision Report

Company:	EnCana Oil & Gas (USA) Inc	Local Co-ordinate Reference:	Well Devore 1G-34H
Project:	DJ Wattenberg	TVD Reference:	WELL @ 4974.0ft (Original Well Elev)
Reference Site:	S34-T3N-R66W (Devore)	MD Reference:	WELL @ 4974.0ft (Original Well Elev)
Site Error:	0.0ft	North Reference:	True
Reference Well:	Devore 1G-34H	Survey Calculation Method:	Minimum Curvature
Well Error:	0.0ft	Output errors are at	2.00 sigma
Reference Wellbore	Hz	Database:	USA EDM 5000 Multi Users DB
Reference Design:	Plan #1	Offset TVD Reference:	Offset Datum

Offset Design S34-T3N-R66W (Devore) - DEVORE 6-4-34 (EXISTING) - EXISTING - SURVEYS													Offset Site Error:	0.0 ft
Survey Program: 805-MWD													Offset Well Error:	0.0 ft
Reference		Offset		Semi Major Axis			Distance							
Measured Depth Depth (ft)	Vertical Depth (ft)	Measured Depth (ft)	Vertical Depth (ft)	Reference (ft)	Offset (ft)	Highside Toolface (°)	Offset Wellbore Centre +N/-S (ft)	+E/-W (ft)	Between Centres (ft)	Between Ellipses (ft)	Total Uncertainty Axis	Separation Factor	Warning	
9,100.0	7,403.0	7,495.6	7,429.0	37.4	17.3	90.33	-2,451.4	-147.6	1,262.8	1,213.4	49.38	25.575		
9,200.0	7,403.0	7,496.2	7,429.6	38.9	17.3	90.37	-2,451.4	-147.6	1,208.0	1,157.0	51.01	23.681		
9,300.0	7,403.0	7,496.8	7,430.2	40.4	17.3	90.40	-2,451.4	-147.6	1,159.2	1,106.6	52.66	22.015		
9,400.0	7,403.0	7,497.4	7,430.8	42.0	17.3	90.43	-2,451.4	-147.5	1,117.4	1,063.0	54.31	20.572		
9,500.0	7,403.0	7,498.0	7,431.4	43.5	17.3	90.47	-2,451.4	-147.5	1,083.1	1,027.1	55.98	19.349		
9,600.0	7,403.0	7,498.6	7,432.0	45.1	17.3	90.50	-2,451.4	-147.5	1,057.2	999.6	57.65	18.339		
9,700.0	7,403.0	7,499.2	7,432.6	46.7	17.3	90.53	-2,451.4	-147.5	1,040.4	981.0	59.33	17.536		
9,800.0	7,403.0	7,499.8	7,433.2	48.3	17.3	90.57	-2,451.4	-147.5	1,032.9	971.9	61.01	16.931		
9,827.2	7,403.0	7,500.0	7,433.4	48.7	17.3	90.58	-2,451.4	-147.5	1,032.6	971.1	61.46	16.800 CC, ES		
9,900.0	7,403.0	7,500.4	7,433.8	49.9	17.3	90.60	-2,451.4	-147.5	1,035.2	972.5	62.68	16.515		
10,000.0	7,403.0	7,501.0	7,434.4	51.5	17.3	90.63	-2,451.4	-147.5	1,046.0	982.0	64.05	16.332		
10,100.0	7,403.0	7,501.6	7,435.0	53.1	17.3	90.66	-2,451.4	-147.5	1,064.5	999.1	65.41	16.274 SF		
10,200.0	7,403.0	7,502.1	7,435.5	54.7	17.3	90.69	-2,451.4	-147.5	1,090.5	1,023.5	66.97	16.283		
10,300.0	7,403.0	7,502.7	7,436.1	56.4	17.3	90.72	-2,451.4	-147.5	1,124.7	1,056.0	68.67	16.377		
10,400.0	7,403.0	7,503.2	7,436.6	58.0	17.3	90.75	-2,451.4	-147.5	1,166.5	1,096.1	70.38	16.574		
10,500.0	7,403.0	7,503.8	7,437.2	59.6	17.3	90.78	-2,451.4	-147.5	1,215.1	1,143.0	72.09	16.855		

Anticollision Report

Company:	EnCana Oil & Gas (USA) Inc	Local Co-ordinate Reference:	Well Devore 1G-34H
Project:	DJ Wattenberg	TVD Reference:	WELL @ 4974.0ft (Original Well Elev)
Reference Site:	S34-T3N-R66W (Devore)	MD Reference:	WELL @ 4974.0ft (Original Well Elev)
Site Error:	0.0ft	North Reference:	True
Reference Well:	Devore 1G-34H	Survey Calculation Method:	Minimum Curvature
Well Error:	0.0ft	Output errors are at	2.00 sigma
Reference Wellbore	Hz	Database:	USA EDM 5000 Multi Users DB
Reference Design:	Plan #1	Offset TVD Reference:	Offset Datum

Offset Design S34-T3N-R66W (Devore) - DEVORE 6-8-34 (EXISTING) - EXISTING - Plan #1													Offset Site Error: 0.0 ft
Survey Program: 0-MWD													Offset Well Error: 0.0 ft
Reference		Offset		Semi Major Axis			Distance						Warning
Measured Depth (ft)	Vertical Depth (ft)	Measured Depth (ft)	Vertical Depth (ft)	Reference (ft)	Offset (ft)	Highside Toolface (°)	Offset Wellbore Centre +N/-S (ft)	+E/-W (ft)	Between Centres (ft)	Between Ellipses (ft)	Total Uncertainty Axis	Separation Factor	
11,500.0	7,403.0	7,525.3	7,463.0	76.3	20.0	90.00	-4,999.2	-1.4	1,234.2	1,144.7	89.52	13.786	
11,600.0	7,403.0	7,525.3	7,463.0	78.0	20.0	90.00	-4,999.2	-1.4	1,162.1	1,070.8	91.25	12.734	
11,700.0	7,403.0	7,525.3	7,463.0	79.7	20.0	90.00	-4,999.2	-1.4	1,094.3	1,001.3	92.98	11.768	
11,800.0	7,403.0	7,525.3	7,463.0	81.4	20.0	90.00	-4,999.2	-1.4	1,031.8	937.0	94.71	10.893	
11,900.0	7,403.0	7,525.3	7,463.0	83.1	20.0	90.00	-4,999.2	-1.4	975.5	879.1	96.45	10.114	
11,973.1	7,403.0	7,525.3	7,463.0	84.3	20.0	90.00	-4,999.2	-1.4	939.0	841.3	97.71	9.609 CC, ES, SF	

Anticollision Report

Company:	EnCana Oil & Gas (USA) Inc	Local Co-ordinate Reference:	Well Devore 1G-34H
Project:	DJ Wattenberg	TVD Reference:	WELL @ 4974.0ft (Original Well Elev)
Reference Site:	S34-T3N-R66W (Devore)	MD Reference:	WELL @ 4974.0ft (Original Well Elev)
Site Error:	0.0ft	North Reference:	True
Reference Well:	Devore 1G-34H	Survey Calculation Method:	Minimum Curvature
Well Error:	0.0ft	Output errors are at	2.00 sigma
Reference Wellbore	Hz	Database:	USA EDM 5000 Multi Users DB
Reference Design:	Plan #1	Offset TVD Reference:	Offset Datum

Offset Design S34-T3N-R66W (Devore) - DEVORE 6-8-34 (EXISTING) - EXISTING - Plan #2													Offset Site Error: 0.0 ft
Survey Program: 0-MWD													Offset Well Error: 0.0 ft
Reference		Offset		Semi Major Axis			Distance						Warning
Measured Depth (ft)	Vertical Depth (ft)	Measured Depth (ft)	Vertical Depth (ft)	Reference (ft)	Offset (ft)	Highside Toolface (°)	Offset Wellbore Centre +N/-S (ft)	+E/-W (ft)	Between Centres (ft)	Between Ellipses (ft)	Total Uncertainty Axis	Separation Factor	
11,500.0	7,403.0	7,528.5	7,463.0	76.3	20.1	90.00	-4,997.9	-8.4	1,238.1	1,148.6	89.52	13.830	
11,600.0	7,403.0	7,528.5	7,463.0	78.0	20.1	90.00	-4,997.9	-8.4	1,166.3	1,075.0	91.25	12.781	
11,700.0	7,403.0	7,528.5	7,463.0	79.7	20.1	90.00	-4,997.9	-8.4	1,098.9	1,005.9	92.98	11.818	
11,800.0	7,403.0	7,528.5	7,463.0	81.4	20.1	90.00	-4,997.9	-8.4	1,036.7	942.0	94.71	10.946	
11,900.0	7,403.0	7,528.5	7,463.0	83.1	20.1	90.00	-4,997.9	-8.4	980.9	884.4	96.44	10.171	
11,973.1	7,403.0	7,528.5	7,463.0	84.3	20.1	90.00	-4,997.9	-8.4	944.7	846.9	97.71	9.668 CC, ES, SF	

Anticollision Report

Company:	EnCana Oil & Gas (USA) Inc	Local Co-ordinate Reference:	Well Devore 1G-34H
Project:	DJ Wattenberg	TVD Reference:	WELL @ 4974.0ft (Original Well Elev)
Reference Site:	S34-T3N-R66W (Devore)	MD Reference:	WELL @ 4974.0ft (Original Well Elev)
Site Error:	0.0ft	North Reference:	True
Reference Well:	Devore 1G-34H	Survey Calculation Method:	Minimum Curvature
Well Error:	0.0ft	Output errors are at	2.00 sigma
Reference Wellbore	Hz	Database:	USA EDM 5000 Multi Users DB
Reference Design:	Plan #1	Offset TVD Reference:	Offset Datum

Offset Design S34-T3N-R66W (Devore) - DEVORE 6-8-34 (EXISTING) - EXISTING - SURVEYS													Offset Site Error: 0.0 ft
Survey Program: 805-MWD													Offset Well Error: 0.0 ft
Reference		Offset		Semi Major Axis		Distance							
Measured Depth (ft)	Vertical Depth (ft)	Measured Depth (ft)	Vertical Depth (ft)	Reference (ft)	Offset (ft)	Highside Toolface (°)	Offset Wellbore Centre +N/-S (ft)	+E/-W (ft)	Between Centres (ft)	Between Ellipses (ft)	Total Uncertainty Axis	Separation Factor	Warning
11,500.0	7,403.0	7,544.9	7,475.2	76.3	20.1	90.83	-4,959.2	-17.7	1,217.2	1,127.9	89.31	13.630	
11,600.0	7,403.0	7,543.4	7,473.8	78.0	20.1	90.73	-4,959.3	-17.7	1,147.4	1,056.4	91.04	12.604	
11,700.0	7,403.0	7,542.0	7,472.4	79.7	20.1	90.64	-4,959.3	-17.7	1,082.4	989.6	92.77	11.668	
11,800.0	7,403.0	7,540.6	7,470.9	81.4	20.1	90.54	-4,959.3	-17.7	1,023.0	928.5	94.50	10.826	
11,900.0	7,403.0	7,539.1	7,469.5	83.1	20.1	90.44	-4,959.3	-17.7	970.3	874.1	96.23	10.083	
11,973.1	7,403.0	7,538.1	7,468.5	84.3	20.1	90.37	-4,959.4	-17.7	936.7	839.2	97.50	9.607 CC, ES, SF	

Anticollision Report

Company:	EnCana Oil & Gas (USA) Inc	Local Co-ordinate Reference:	Well Devore 1G-34H
Project:	DJ Wattenberg	TVD Reference:	WELL @ 4974.0ft (Original Well Elev)
Reference Site:	S34-T3N-R66W (Devore)	MD Reference:	WELL @ 4974.0ft (Original Well Elev)
Site Error:	0.0ft	North Reference:	True
Reference Well:	Devore 1G-34H	Survey Calculation Method:	Minimum Curvature
Well Error:	0.0ft	Output errors are at	2.00 sigma
Reference Wellbore	Hz	Database:	USA EDM 5000 Multi Users DB
Reference Design:	Plan #1	Offset TVD Reference:	Offset Datum

Reference Depths are relative to WELL @ 4974.0ft (Original Well Elev)

Offset Depths are relative to Offset Datum

Central Meridian is -105.500000 °

Coordinates are relative to: Devore 1G-34H

Coordinate System is US State Plane 1983, Colorado Northern Zone

Grid Convergence at Surface is: 0.48°

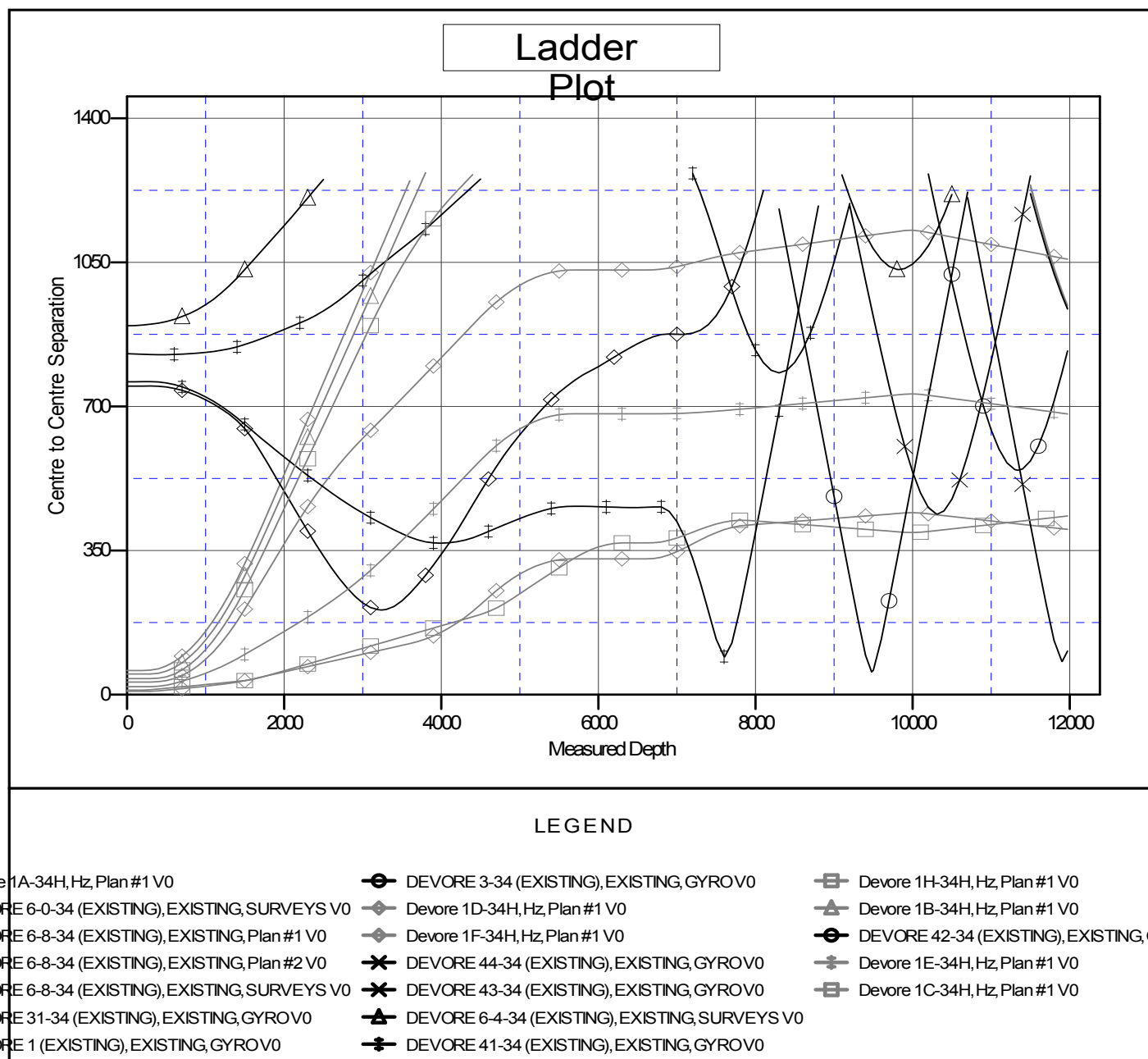

CC - Min centre to center distance or convergent point, SF - min separation factor, ES - min ellipse separation