

Lat40°, Inc. 1635 Foxtrail Drive, Suite 325 Loveland, CO 970-776-3321

# PRODUCTION FACILITY LOCATION DRAWING

SECTION: 27  
TOWNSHIP: 6N  
RANGE: 63W

WELLS RANCH AA27-ECONODE

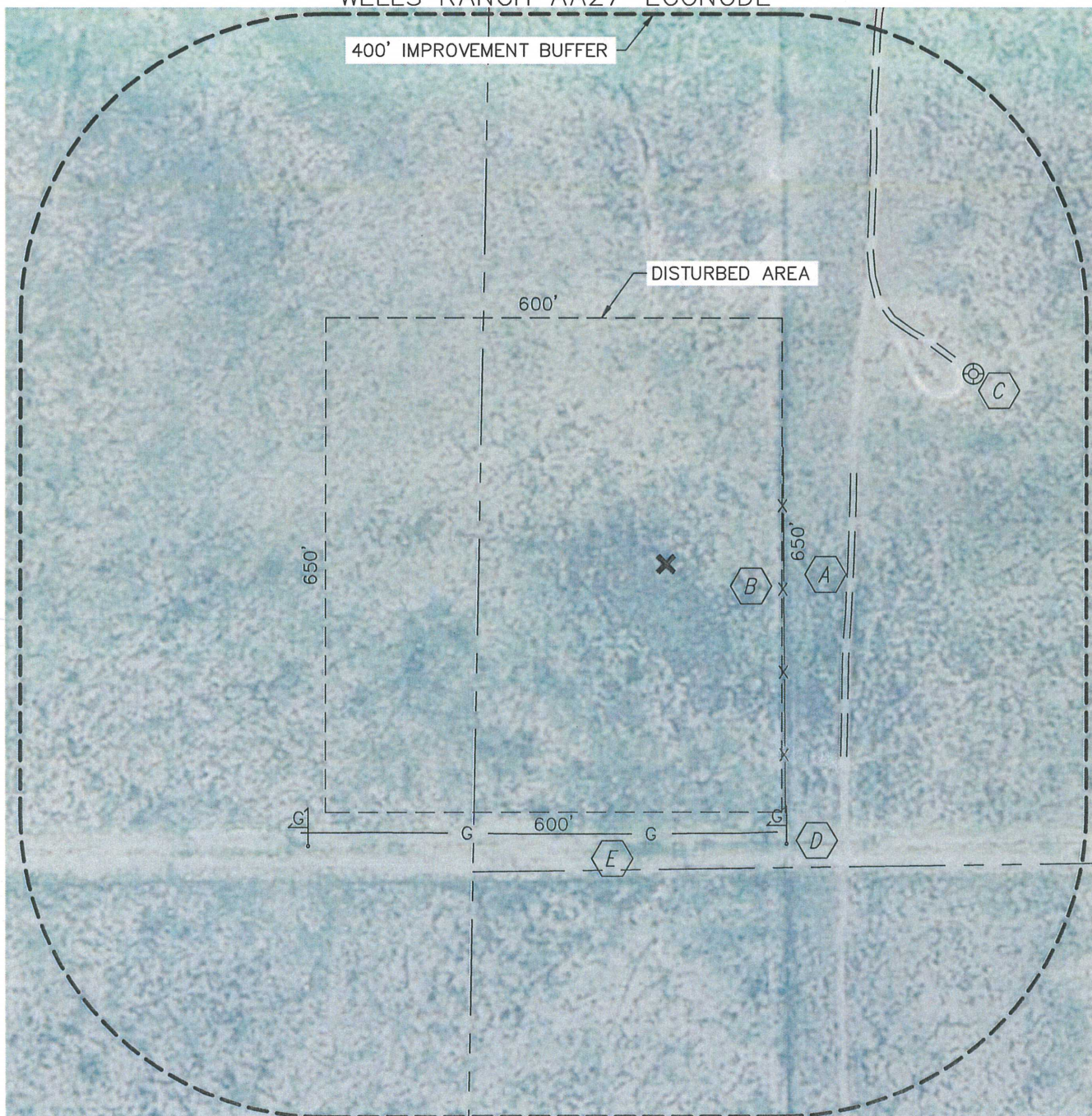

## REFERENCE POINT LOCATION:

LAT: 40.45863°N  
LONG: 104.43152°W  
ELEV: 4796'  
PDOP: 1.5  
DATE: 6/7/2012  
OPERATOR: ADAM KELLY  
1/41/4: SW1/4NW1/4  
FNL: 2274'  
FWL: 247'  
DISTANCE TO WELL: 793'  
ASSOCIATED NEW WELLS:  
WELLS RANCH USX AA27-62-1HN,  
63-1HN, 64-1HN, 65-1HN, 66-1HN,  
67-1HN, 68-1HN & 69-1HN  
ASSOCIATED EXISTING WELLS:  
NONE

## IMPROVEMENTS:

- (A) FIELD ROAD 235' E & 434' NE
- (B) FENCE 154' E
- (C) EX. O&G WELL 474' NE

- (D) GAS MARKER 401' SE & 599' SW
- (E) GAS PIPELINE SCAR 355' S

## LEGEND

X - REFERENCE POINT  
ALL DISTANCES ARE APPROXIMATE.

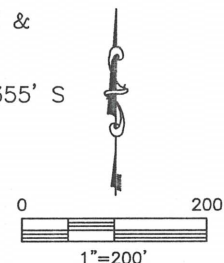

NEAREST: BUILDING 5280'+,  
PUBLIC ROAD 5280'+ (CR 68), ABOVE GROUND UTILITY 3100' S,  
RAILROAD 5280'+, PROPERTY LINE 247' W

DATE: Rev 6/28/2012  
PROJECT#: 2012075