

NOBLE ENERGY, INC.
FISCUS FEDERAL LD23-78HN
LOCATED IN WELD COUNTY, COLORADO
SECTION 23, T9N, R58W, 6th P.M.



PHOTO: VIEW OF LOCATION STAKE

CAMERA ANGLE: NORTHERLY



PHOTO: VIEW OF LOCATION STAKE

CAMERA ANGLE: EASTERLY



UELS Uintah Engineering & Land Surveying
85 South 200 East Vernal, Utah 84078
(435) 789-1017 * FAX (435) 789-1813

LOCATION PHOTOS

11 **01** **12**
MONTH DAY YEAR

TAKEN BY: D.S.

DRAWN BY: B.D.H.

REVISED: 11-13-12

PHOTO
P1

NOBLE ENERGY, INC.
FISCUS FEDERAL LD23-78HN
LOCATED IN WELD COUNTY, COLORADO
SECTION 23, T9N, R58W, 6th P.M.

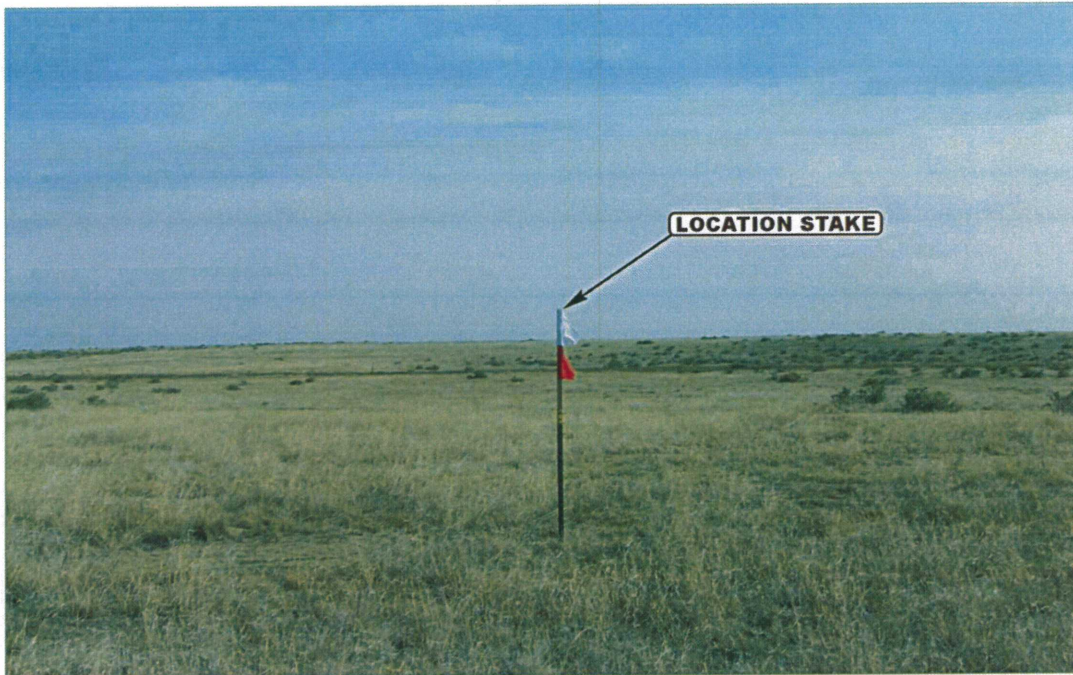

PHOTO: VIEW OF LOCATION STAKE

CAMERA ANGLE: SOUTHERLY



PHOTO: VIEW OF LOCATION STAKE

CAMERA ANGLE: WESTERLY



- Since 1964 -

UELS

Uintah Engineering & Land Surveying
85 South 200 East Vernal, Utah 84078
(435) 789-1017 * FAX (435) 789-1813

LOCATION PHOTOS

11 **01** **12**
MONTH DAY YEAR

TAKEN BY: D.S. | DRAWN BY: B.D.H. | REVISED: 11-13-12

PHOTO
P2