

ConocoPhillips Company

CONSTRUCTION LAYOUT FOR

TEBO #28-1H
SECTION 28, T4S, R64W, 6th. P.M.
660' FSL 60' FWL

FIGURE #1

SCALE: 1" = 60'
DATE: 09-19-12
DRAWN BY: H.K.W.
REV: 10-12-12 J.M.H.

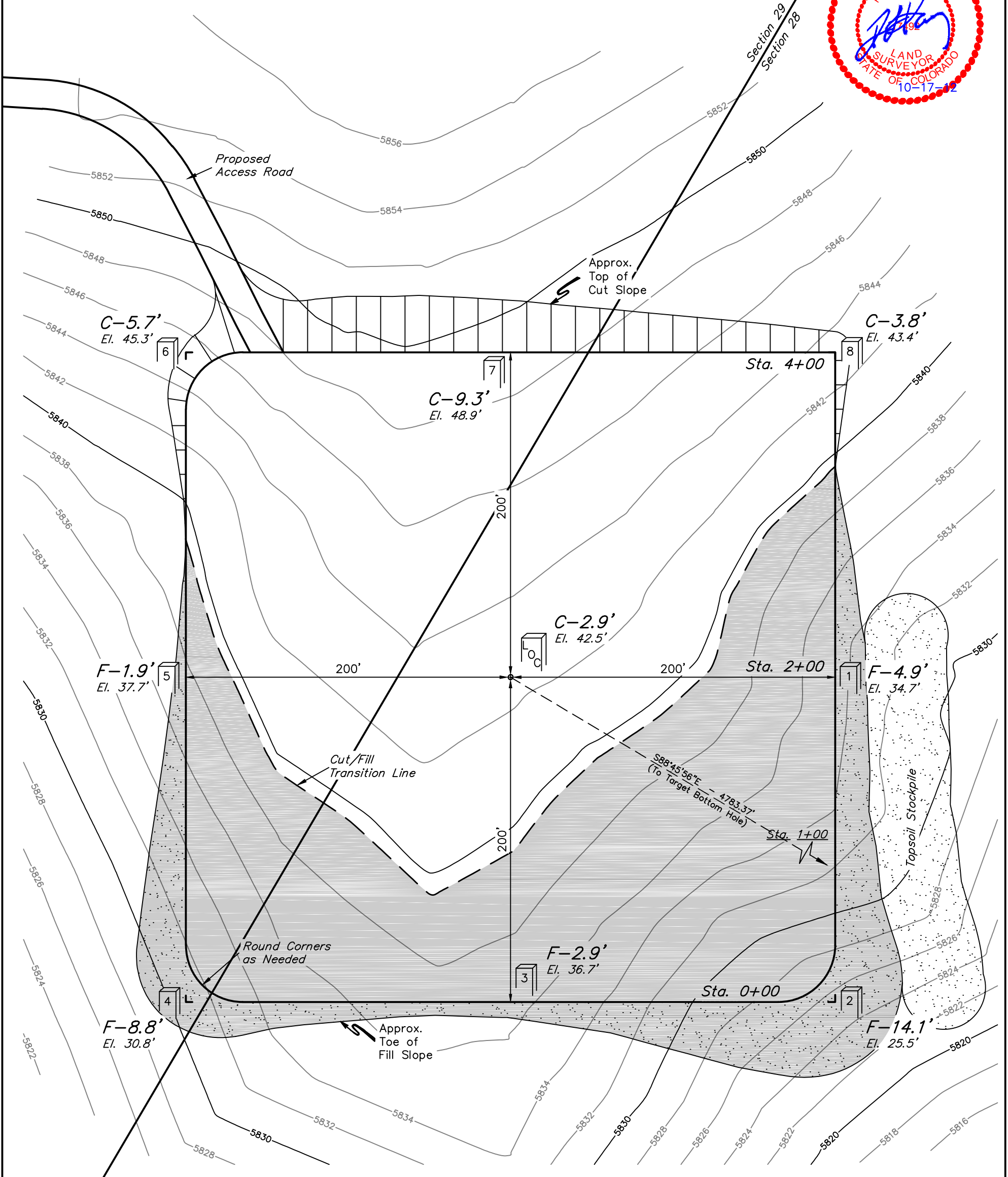
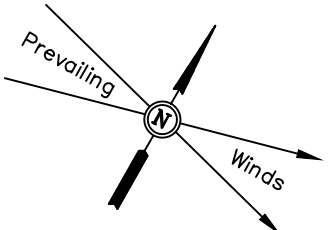

Elev. Ungraded Ground At Loc. Stake = 5842.5'
FINISHED GRADE ELEV. AT LOC. STAKE = 5839.6'

UINTAH ENGINEERING & LAND SURVEYING
85 So. 200 East * Vernal, Utah 84078 * (435) 789-1017

ConocoPhillips Company
CONSTRUCTION LAYOUT CROSS SECTIONS FOR
TEBO #28-1H
SECTION 28, T4S, R64W, 6th. P.M.
660' FSL 60' FWL

FIGURE #2

1" = 40'
 X-Section Scale
 1" = 100'

DATE: 09-19-12
 DRAWN BY: H.K.W.
 REV: 10-12-12 J.M.H.

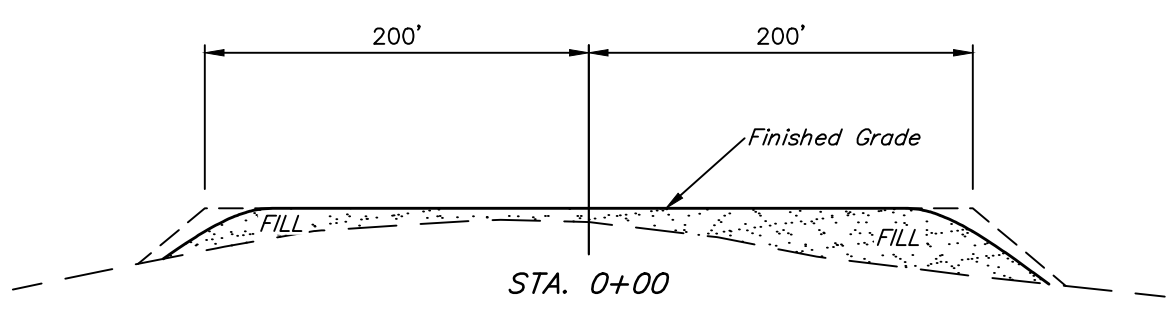
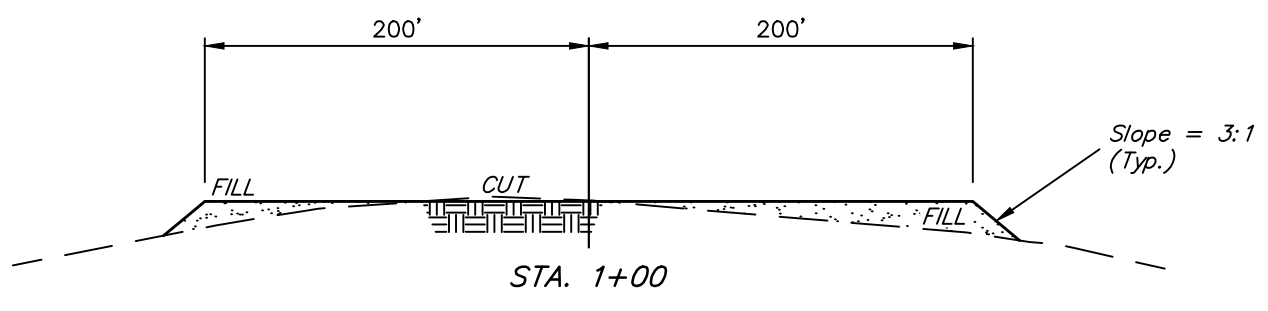
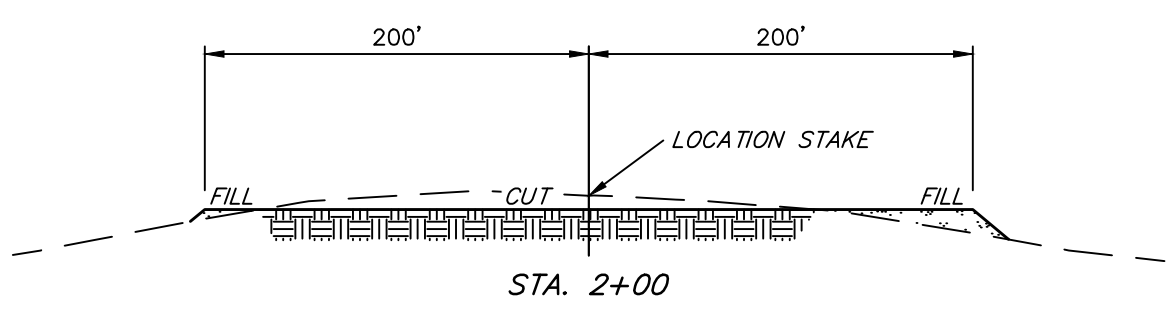
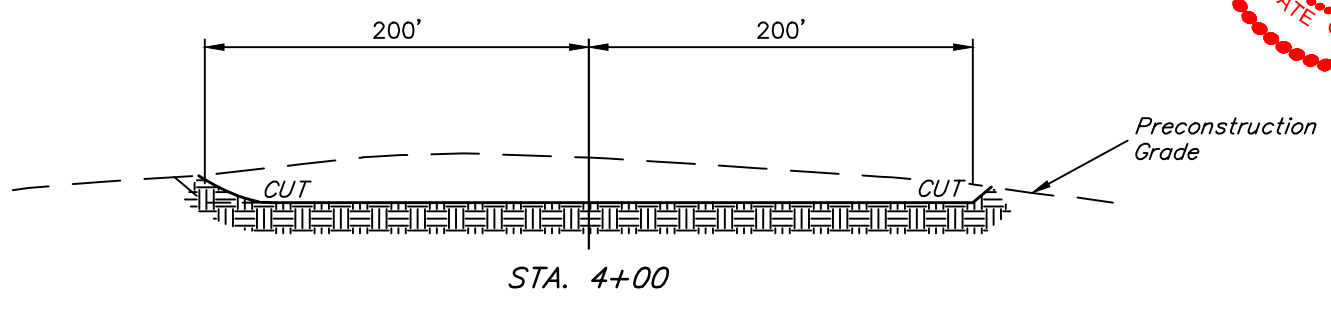

NOTE:
 Topsoil should not be Stripped Below Finished Grade on Substructure Area.

* NOTE:
 FILL QUANTITY INCLUDES 5% FOR COMPACTION

APPROXIMATE YARDAGES

(6") Topsoil Stripping	= 3,580 Cu. Yds.
Remaining Location	= 13,490 Cu. Yds.
TOTAL CUT	= 17,070 CU. YDS.
FILL	= 13,490 CU. YDS.

EXCESS MATERIAL	= 3,580 Cu. Yds.
Topsoil	= 3,580 Cu. Yds.
EXCESS UNBALANCE	= 0 Cu. Yds.
(After Interim Rehabilitation)	

APPROXIMATE ACREAGES

WELL SITE DISTURBANCE	= ± 4.727 ACRES
ACCESS ROAD DISTURBANCE	= ± 1.329 ACRES
TOTAL	= ± 6.056 ACRES

UINTAH ENGINEERING & LAND SURVEYING
 85 So. 200 East * Vernal, Utah 84078 * (435) 789-1017