

**NOBLE ENERGY, INC.**  
**TIMBRO FEDERAL LD07-78HN**  
LOCATED IN WELD COUNTY, COLORADO  
SECTION 7, T9N, R58W, 6th P.M.

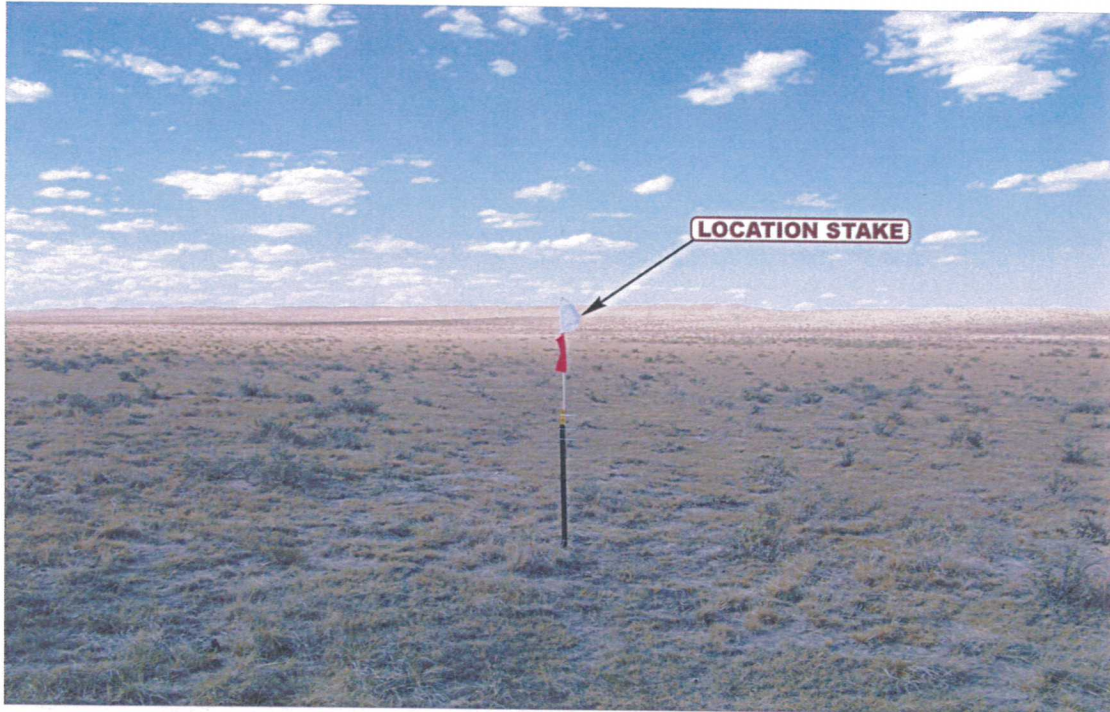

PHOTO: VIEW OF LOCATION STAKE

CAMERA ANGLE: NORTHERLY



PHOTO: VIEW OF LOCATION STAKE

CAMERA ANGLE: EASTERLY



**UELS** Uintah Engineering & Land Surveying  
85 South 200 East Vernal, Utah 84078  
(435) 789-1017 \* FAX (435) 789-1813

**LOCATION PHOTOS**

**10** **04** **12**  
MONTH DAY YEAR

TAKEN BY: J.H. DRAWN BY: B.D.H. REVISED: 00-00-00

**PHOTO**  
**P1**



**NOBLE ENERGY, INC.**  
**TIMBRO FEDERAL LD07-78HN**  
LOCATED IN WELD COUNTY, COLORADO  
SECTION 7, T9N, R58W, 6th P.M.

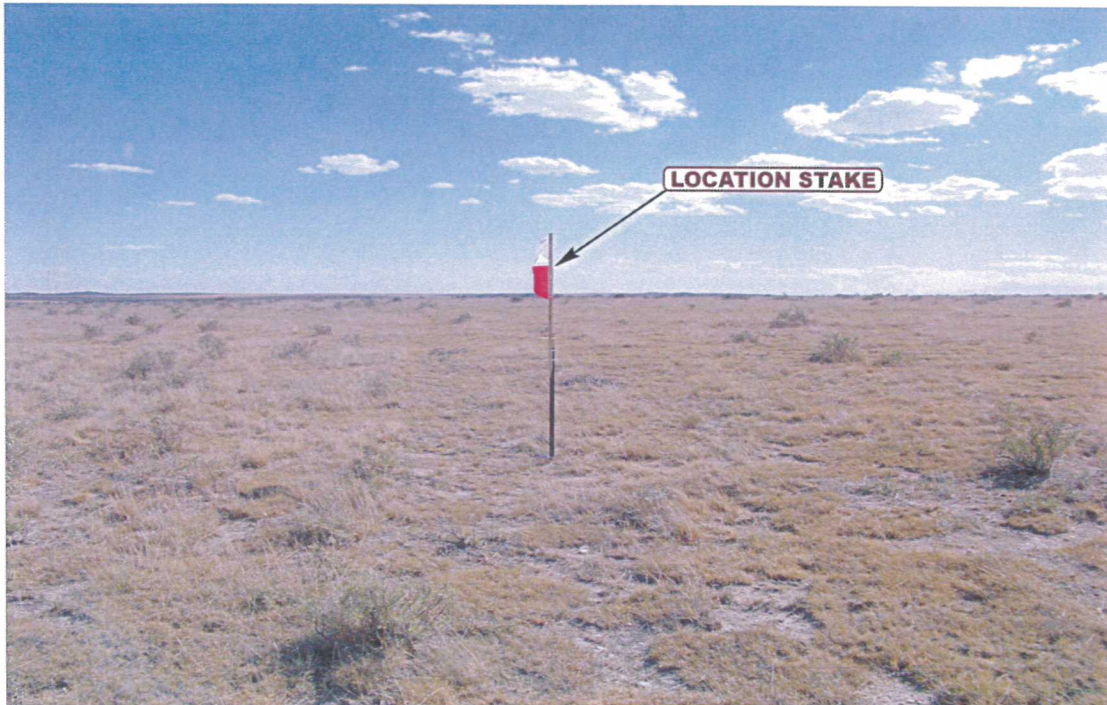

PHOTO: VIEW OF LOCATION STAKE

CAMERA ANGLE: SOUTHERLY

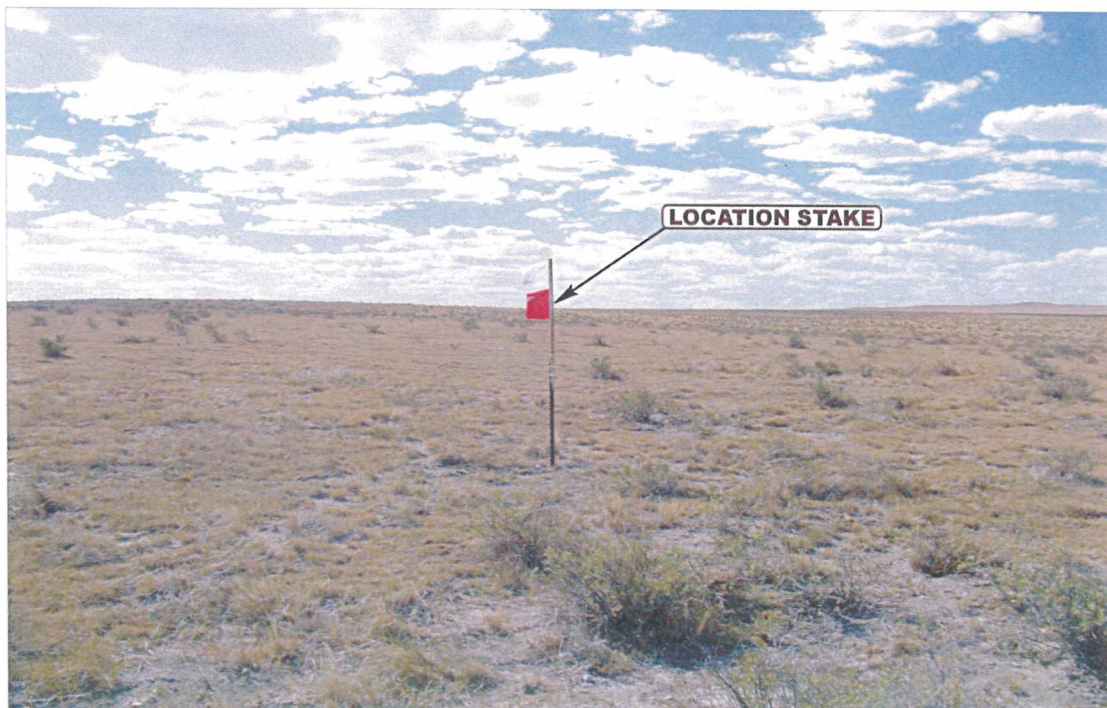

PHOTO: VIEW OF LOCATION STAKE

CAMERA ANGLE: WESTERLY



- Since 1964 -

**UELS**

Uintah Engineering & Land Surveying  
85 South 200 East Vernal, Utah 84078  
(435) 789-1017 \* FAX (435) 789-1813

**LOCATION PHOTOS**

**10** **04** **12**  
MONTH DAY YEAR

TAKEN BY: J.H. DRAWN BY: B.D.H. REVISED: 00-00-00

PHOTO  
**P2**