

WELL LOCATION CERTIFICATE: MORNING FRESH 15N-15HZ

SECTION 15, TOWNSHIP 3 NORTH, RANGE 66 WEST, 6TH P.M.

N 1/4 SEC. 15
3/4" BRASS CAP
PLS 25367

NE SEC. 15
3/4" BRASS CAP
PLS 25367

NW SEC. 15
3/4" ALUM. CAP
PLS 25367

N 89°46'38" E 2667.44' N 89°46'21" E 2667.86'

NOTES:
BH LOCATION PROVIDED BY CLIENT.
LAND SURFACE USE- DRY LAND CROP
SEE ATTACHED MAP FOR ADDITIONAL
IMPROVEMENTS WITHIN 400'.

PDOP= 1.3
GPS OPERATOR: OWEN MCKEE

MORNING FRESH
15N-15HZ

15

W 1/4 SEC. 15
3/4" ALUM. CAP
PLS 10855

N 89°50'29" E 2677.40' (C)

N 89°50'29" E 2677.60' (C)

E 1/4 SEC. 15
2 1/2" ALUM. CAP
PLS 23500

SURFACE LOCATION
GROUND ELEVATION= 4884'
NAD83
LATITUDE= 40.231526°
LONGITUDE= 104.760495°

LATITUDE= 40°13'53.494"
LONGITUDE= 104°45'37.782"

BOTTOM HOLE LOCATION
NAD83
LATITUDE= 40.219114°
LONGITUDE= 104.761310°

LATITUDE= 40°13'08.810"
LONGITUDE= 104°45'40.714"

SW SEC. 15
3/4" ALUM. CAP
PLS 13155

S 88°49'10" W 2687.75' S 89°58'52" W 2687.13'

S 1/4 SEC. 15
3/4" ALUM. CAP
PLS 34995

SE SEC. 15
3/4" ALUM. CAP
PLS 16154

WELL MORNING FRESH 15N-15HZ TO BE LOCATED 250' FNL AND 1860' FEL

LEGEND

⊕ = EXISTING MONUMENT ⊕ = BOTTOM HOLE BH = BOTTOM HOLE
● = PROPOSED WELL ◆ = EXISTING WELL

0 500 1000
SCALE: 1"=1000'

NOTES:

- THIS FIELD SURVEY CONFORMS TO THE MINIMUM STANDARDS SET BY THE C.O.G.C.C., RULE NO. 215
- HORIZONTAL POSITIONS AND ORTHOMETRIC ELEVATIONS SHOWN AT THE WELL HEAD, ARE BASED ON GPS-RTK POSITIONS DERIVED FROM MINIMUM 2-HOUR STATIC OBSERVATIONS CORRECTED BY THE NATIONAL GEODETIC SURVEY ONLINE POSITIONING USER SERVICE, O.P.U.S. DATUM: HORIZONTAL = NAD83/2007, VERTICAL = NAVD88
- THE BASIS OF BEARINGS ARE STATE PLANE COORDINATE SYSTEM GRID BEARINGS SHOWN HEREON BETWEEN THE DESCRIBED MONUMENTS SHOWN HEREON.
- GRID DISTANCES ARE SHOWN, AS MEASURED IN THE FIELD, WITH TIES TO WELLS MEASURED PERPENDICULAR TO SECTION LINES.

I, MARK A. HALL, A LICENSED PROFESSIONAL LAND SURVEYOR IN THE STATE OF COLORADO DO HEREBY CERTIFY TO **KERR-MCGEE OIL & GAS ONSHORE LP**, THAT THE SURVEY AND WELL LOCATION CERTIFICATE SHOWN HEREON WERE DONE BY ME OR UNDER MY DIRECT SUPERVISION AND THAT THE DRAWING SHOWN HEREON ACCURATELY DEPICTS THE PROPOSED LOCATION OF THE WELL. THIS CERTIFICATE DOES NOT REPRESENT A LAND SURVEY PLAT OR IMPROVEMENT SURVEY PLAT AS DEFINED BY C.R.S. 38-51-102 AND CANNOT BE RELIED UPON TO DETERMINE OWNERSHIP.

MARK A. HALL, PLS 36073
COLORADO LICENSED PROFESSIONAL LAND SURVEYOR
FOR AND ON BEHALF OF P.F.S., LLC

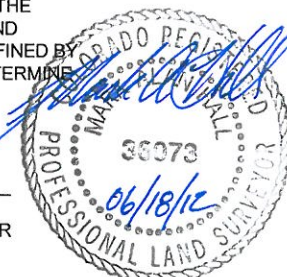

PREPARED BY:
PFS
Petroleum Field Services, LLC
1801 W. 13th Ave.
Denver, CO 80204

FIELD DATE:
05-10-12
DRAWING DATE:
05-17-12
BY:
KAG
CHECK:
SMF
SURFACE LOCATION:
NW 1/4 NE 1/4,
SEC. 15, T3N, R66W, 6TH P.M.
WELD COUNTY, COLORADO

NOTICE: ACCORDING TO COLORADO LAW YOU MUST COMMENCE ANY LEGAL ACTION BASED UPON ANY DEFECT IN THIS SURVEY WITHIN THREE YEARS AFTER YOU FIRST DISCOVER SUCH DEFECT. IN NO EVENT MAY ANY ACTION BASED UPON ANY DEFECT IN THIS SURVEY BE COMMENCED MORE THAN TEN YEARS FROM THIS SAID DATE OF THIS CERTIFICATION SHOWN HEREON.