

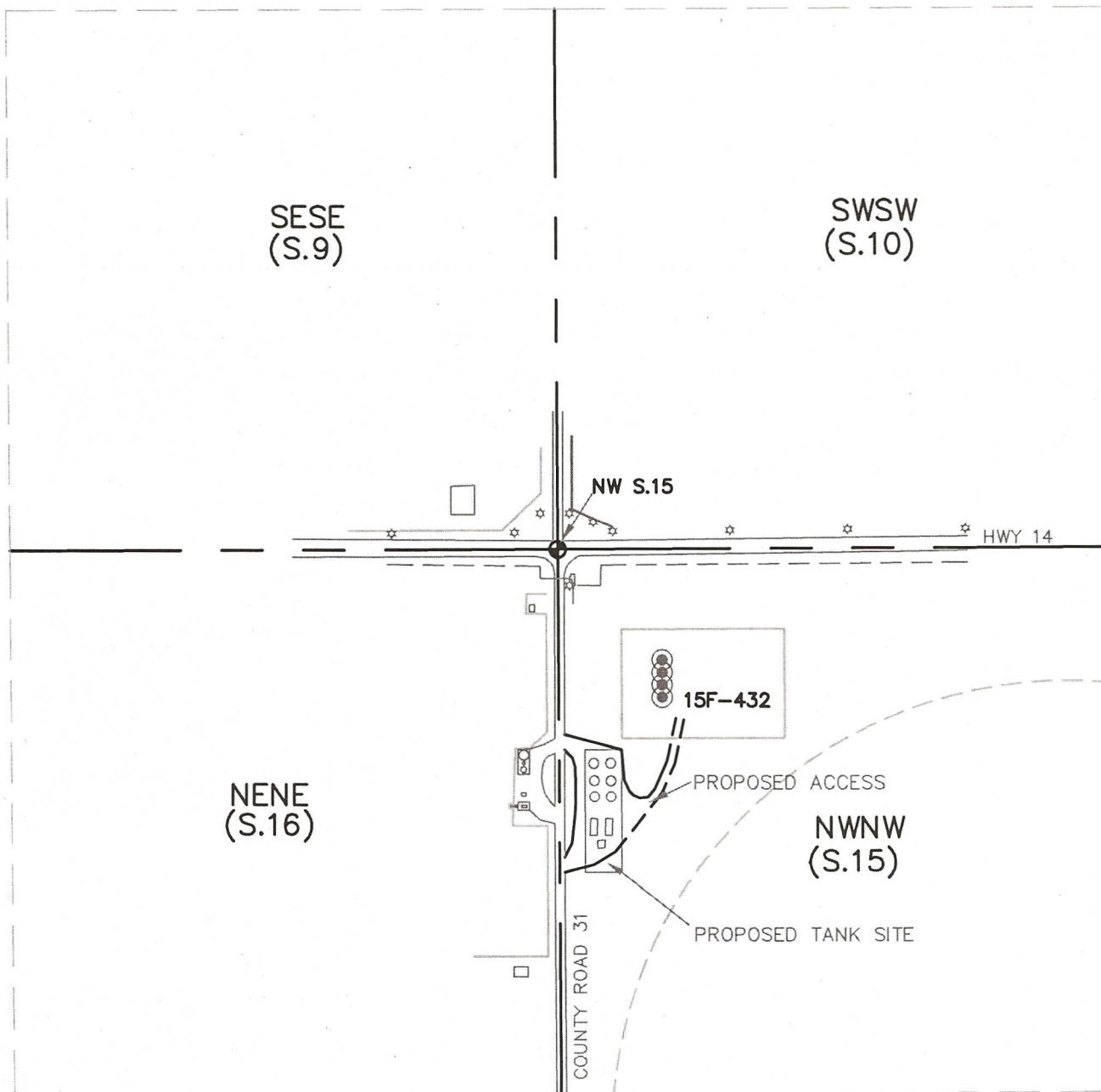



ACCESS ROAD DRAWING

PART OF THE NW1/4 SEC. 15, TOWNSHIP 7 NORTH, RANGE 66 WEST, 6TH P.M.



LEGEND

-  = FOUND MONUMENT
-  = PROPOSED WELL
-  = POWER POLE

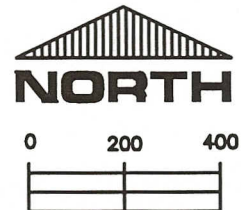

SCALE:

1" = 400'

THIS IS NOT A MONUMENTED BOUNDARY SURVEY, IT IS ONLY A
DRAWING INTENDED TO DEPICT THE PROPOSED ACCESS TO WELL SITE(S).

PREPARED BY:

HORSESHOE SURVEYING, LLC
PO BOX 150458
LAKEWOOD, CO 80215
(720)872-0196

WELL NAME:

THORNTON 15E-HZ Pad
15E-232, 15E-432, 15F-212, 15F-432

LOCATION:

WELD COUNTY, CO
NW1/4, SEC. 15, T7N, R66W, 6TH P.M.

DRAWING DATE:

2-13-13

FIELD DATE:

4-23-12