



Lat40°, Inc. 1635 Foxtrail Drive, Suite 325 Loveland, CO 970-776-3321

HYDROLOGY MAP

PRONGHORN P-22 PAD

SECTION: 22
TOWNSHIP: 5N
RANGE: 61W

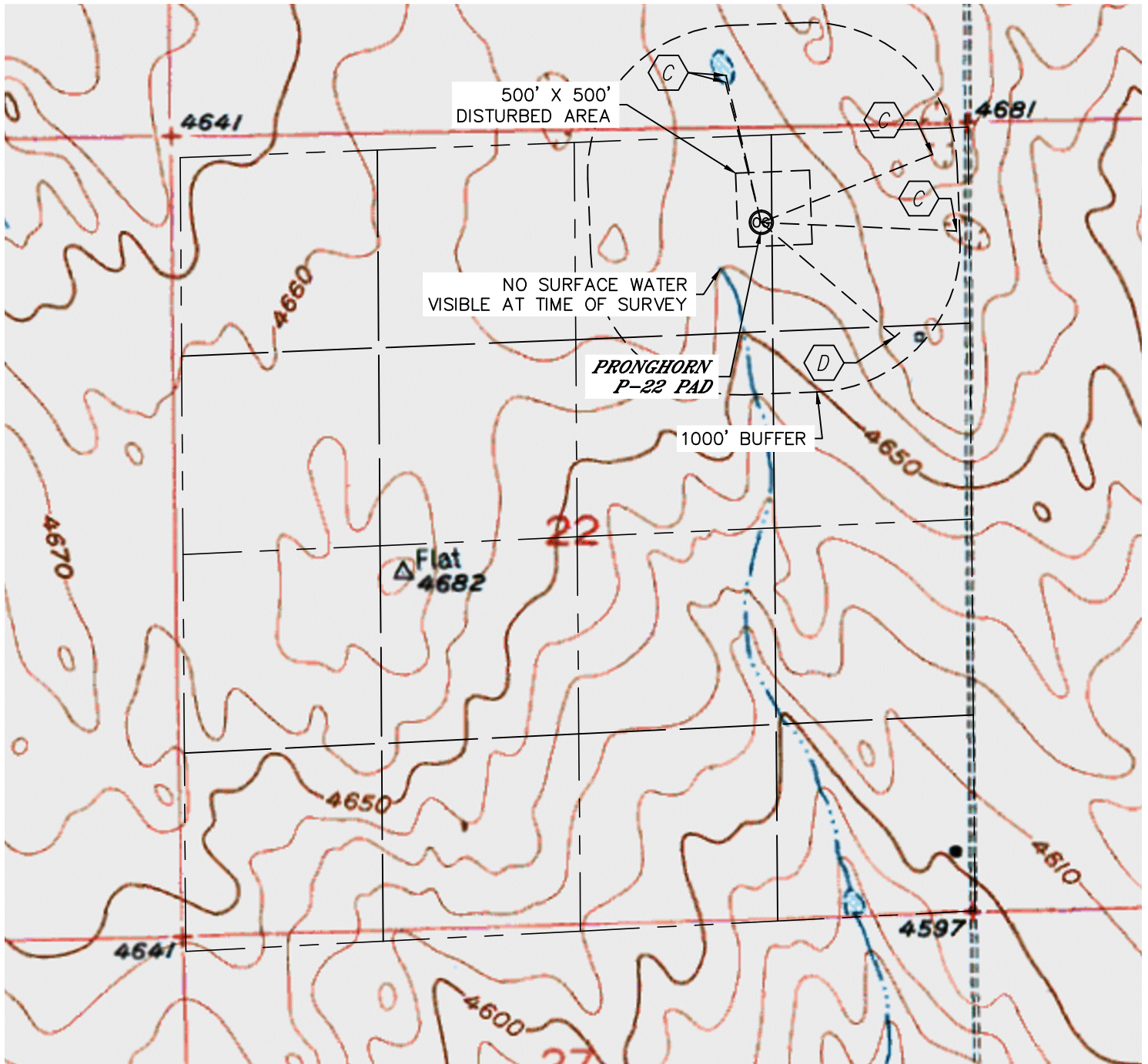

LOW AREA 1024' & 980' NW, 1249' NE, 1324' E



UNDERGROUND WATER TANK 1189' SE

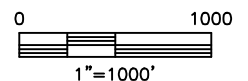

DATE: 12/4/2012
PROJECT#: 2012073