



Lat40°, Inc. 1635 Foxtrail Drive, Suite 325 Loveland, CO 970-776-3321

ACCESS ROAD MAP-A

CVR 5-63-32 PAD

SECTION: 32
TOWNSHIP: 5N
RANGE: 63W

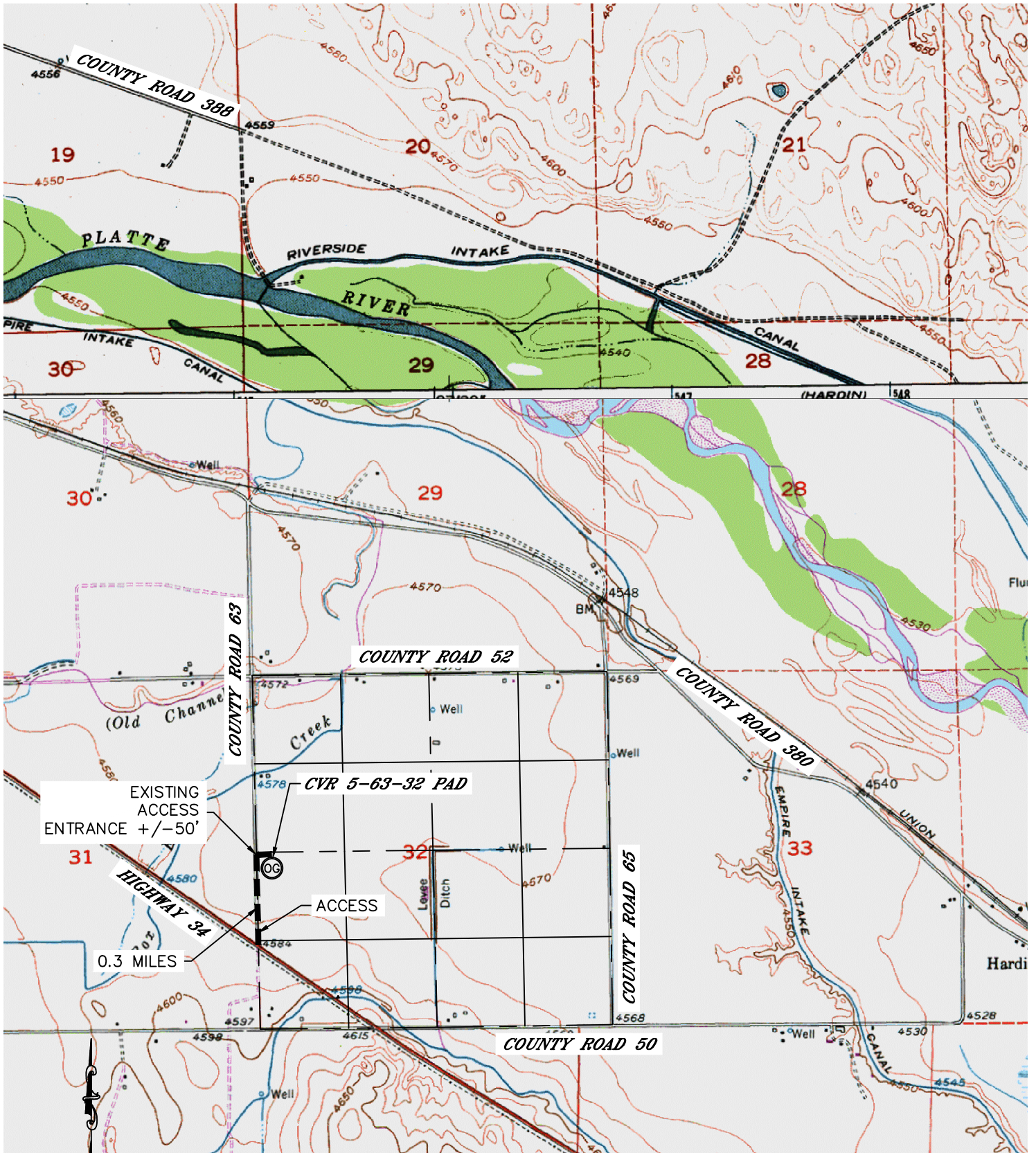

EXISTING ACCESS ENTRANCE +/-50'

CVR 5-63-32 PAD

ACCESS

0.3 MILES

DIRECTIONS:

FROM THE INTERSECTION OF COUNTY ROAD 63 AND HIGHWAY 34, GO NORTH 0.3 MILES TO AN EXISTING ACCESS ROAD TO THE EAST. TURN EAST FOR 230 FEET TO WELL PAD.

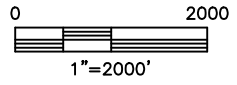

DATE: 12/21/2012
PROJECT#: 2012174