



Lat40°, Inc. 1635 Foxtrail Drive, Suite 325 Loveland, CO 970-776-3321

# HYDROLOGY MAP

NORTH PLATTE 41-34 PAD

SECTION: 34  
TOWNSHIP: 5N  
RANGE: 63W

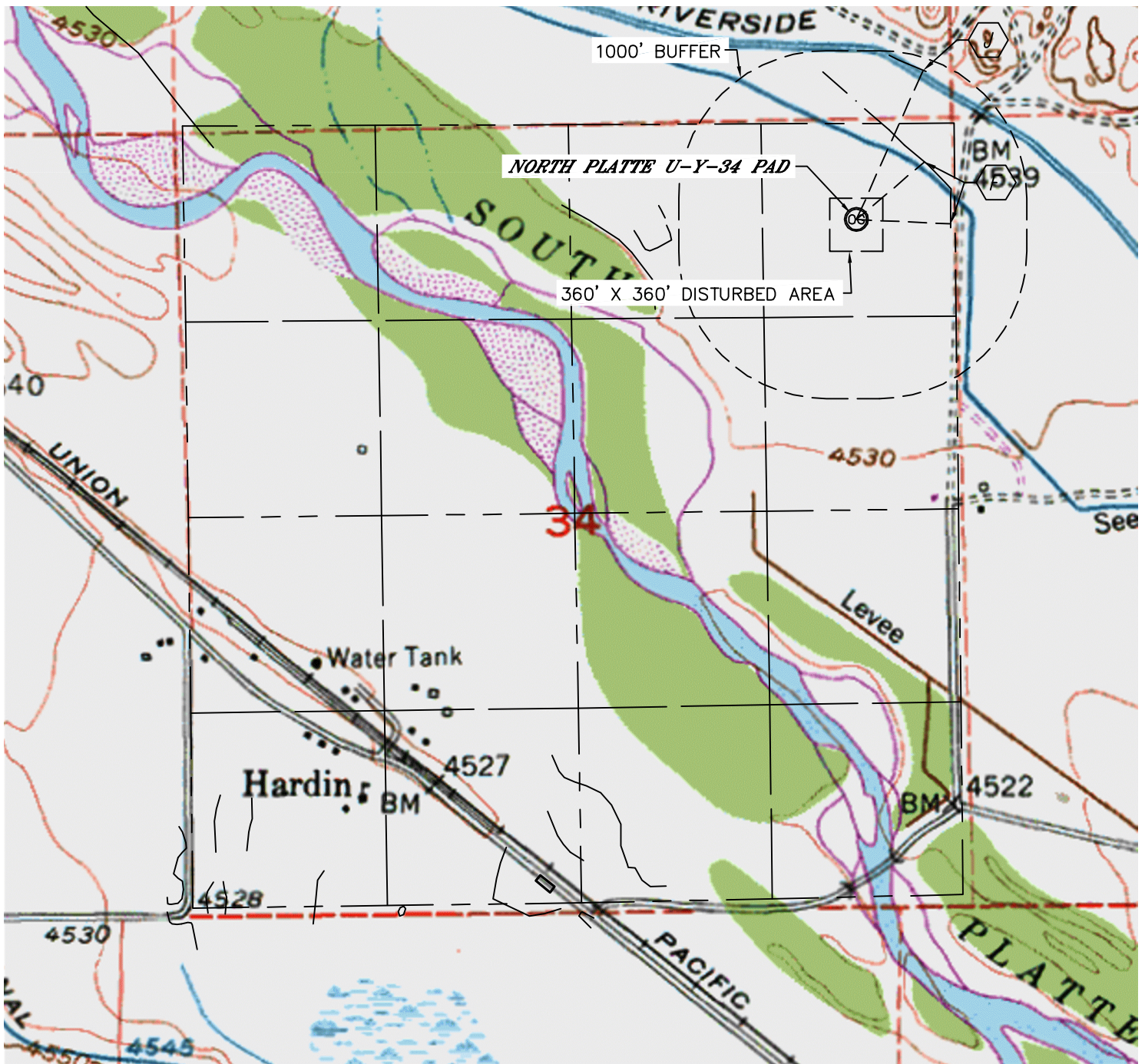

DITCH 595' NE, 639' NE

CANAL 1107' NE

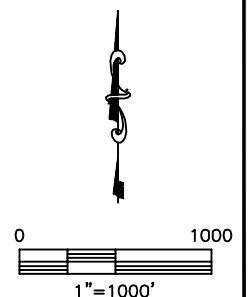

DATE: 11/12/2012  
PROJECT#: 2011092