

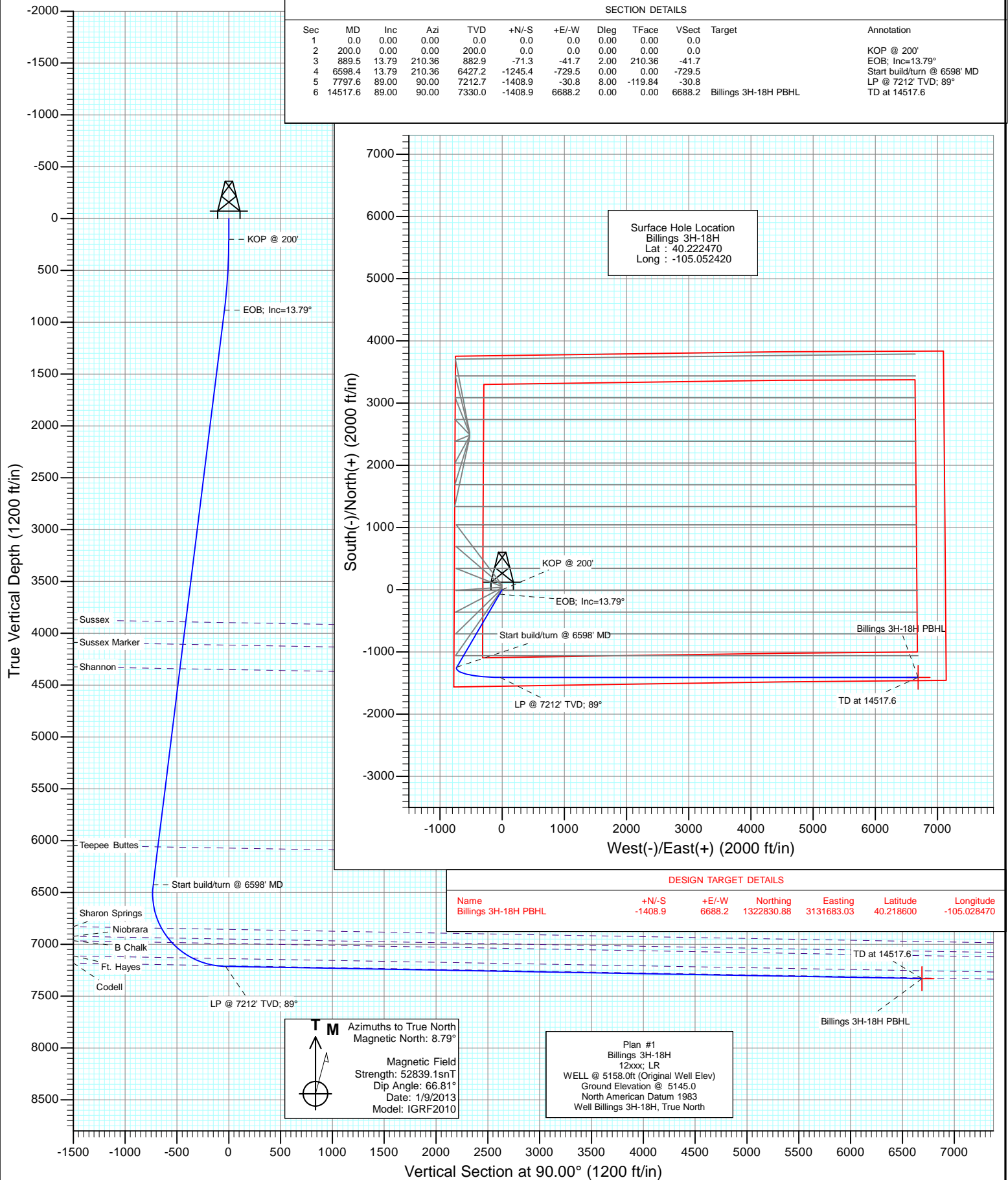

Project: DJ Wattenberg  
Site: S18-T3N-R68W (Billings)  
Well: Billings 3H-18H  
Wellbore: Hz  
Design: Plan #1



## Planning Report

<b>Database:</b>	USA EDM 5000 Multi Users DB	<b>Local Co-ordinate Reference:</b>	Well Billings 3H-18H
<b>Company:</b>	EnCana Oil & Gas (USA) Inc	<b>TVD Reference:</b>	WELL @ 5158.0ft (Original Well Elev)
<b>Project:</b>	DJ Wattenberg	<b>MD Reference:</b>	WELL @ 5158.0ft (Original Well Elev)
<b>Site:</b>	S18-T3N-R68W (Billings)	<b>North Reference:</b>	True
<b>Well:</b>	Billings 3H-18H	<b>Survey Calculation Method:</b>	Minimum Curvature
<b>Wellbore:</b>	Hz		
<b>Design:</b>	Plan #1		

<b>Project</b>	DJ Wattenberg		
<b>Map System:</b>	US State Plane 1983	<b>System Datum:</b>	Mean Sea Level
<b>Geo Datum:</b>	North American Datum 1983		
<b>Map Zone:</b>	Colorado Northern Zone		

Site		S18-T3N-R68W (Billings)			
Site Position:		Northing:	1,326,724.18 ft	Latitude:	40.229390
From:	Lat/Long	Easting:	3,124,452.97 ft	Longitude:	-105.054290
Position Uncertainty:	0.0 ft	Slot Radius:	13.200 in	Grid Convergence:	0.29 °

Well	Billings 3H-18H					
Well Position	+N/-S	0.0 ft	Northing:	1,324,205.98 ft	Latitude:	40.222470
	+E/-W	0.0 ft	Easting:	3,124,987.81 ft	Longitude:	-105.052420
Position Uncertainty		0.0 ft	Wellhead Elevation:	ft	Ground Level:	5,145.0 ft

<b>Wellbore</b>	Hz				
<b>Magnetics</b>	<b>Model Name</b>	<b>Sample Date</b>	<b>Declination (°)</b>	<b>Dip Angle (°)</b>	<b>Field Strength (nT)</b>
	IGRF2010	1/9/2013	8.79	66.81	52,839

<b>Design</b>	Plan #1				
<b>Audit Notes:</b>					
<b>Version:</b>	<b>Phase:</b>	PLAN		<b>Tie On Depth:</b>	0.0
<b>Vertical Section:</b>	<b>Depth From (TVD) (ft)</b>	<b>+N/-S (ft)</b>	<b>+E/-W (ft)</b>	<b>Direction (°)</b>	
	0.0	0.0	0.0	90.00	

<b>Plan Sections</b>										
Measured Depth (ft)	Inclination (°)	Azimuth (°)	Vertical Depth (ft)	+N/-S (ft)	+E/-W (ft)	Dogleg Rate (°/100ft)	Build Rate (°/100ft)	Turn Rate (°/100ft)	TFO (°)	Target
0.0	0.00	0.00	0.0	0.0	0.0	0.00	0.00	0.00	0.00	
200.0	0.00	0.00	200.0	0.0	0.0	0.00	0.00	0.00	0.00	
889.5	13.79	210.36	882.9	-71.3	-41.7	2.00	2.00	0.00	210.36	
6,598.4	13.79	210.36	6,427.2	-1,245.4	-729.5	0.00	0.00	0.00	0.00	
7,797.6	89.00	90.00	7,212.7	-1,408.9	-30.8	8.00	6.27	-10.04	-119.84	
14,517.6	89.00	90.00	7,330.0	-1,408.9	6,688.2	0.00	0.00	0.00	0.00	Billings 3H-18H PBHL

# Planning Report

<b>Database:</b>	USA EDM 5000 Multi Users DB	<b>Local Co-ordinate Reference:</b>	Well Billings 3H-18H
<b>Company:</b>	EnCana Oil & Gas (USA) Inc	<b>TVD Reference:</b>	WELL @ 5158.0ft (Original Well Elev)
<b>Project:</b>	DJ Wattenberg	<b>MD Reference:</b>	WELL @ 5158.0ft (Original Well Elev)
<b>Site:</b>	S18-T3N-R68W (Billings)	<b>North Reference:</b>	True
<b>Well:</b>	Billings 3H-18H	<b>Survey Calculation Method:</b>	Minimum Curvature
<b>Wellbore:</b>	Hz		
<b>Design:</b>	Plan #1		

Planned Survey									
Measured Depth (ft)	Inclination (°)	Azimuth (°)	Vertical Depth (ft)	+N/-S (ft)	+E/-W (ft)	Vertical Section (ft)	Dogleg Rate (°/100ft)	Build Rate (°/100ft)	Comments / Formations
0.0	0.00	0.00	0.0	0.0	0.0	0.0	0.00	0.00	
100.0	0.00	0.00	100.0	0.0	0.0	0.0	0.00	0.00	
200.0	0.00	0.00	200.0	0.0	0.0	0.0	0.00	0.00	KOP @ 200'
300.0	2.00	210.36	300.0	-1.5	-0.9	-0.9	2.00	2.00	
400.0	4.00	210.36	399.8	-6.0	-3.5	-3.5	2.00	2.00	
500.0	6.00	210.36	499.5	-13.5	-7.9	-7.9	2.00	2.00	
600.0	8.00	210.36	598.7	-24.1	-14.1	-14.1	2.00	2.00	
700.0	10.00	210.36	697.5	-37.6	-22.0	-22.0	2.00	2.00	
800.0	12.00	210.36	795.6	-54.0	-31.6	-31.6	2.00	2.00	
889.5	13.79	210.36	882.9	-71.3	-41.7	-41.7	2.00	2.00	EOB; Inc=13.79°
900.0	13.79	210.36	893.1	-73.4	-43.0	-43.0	0.00	0.00	
1,000.0	13.79	210.36	990.2	-94.0	-55.0	-55.0	0.00	0.00	
1,100.0	13.79	210.36	1,087.3	-114.5	-67.1	-67.1	0.00	0.00	
1,200.0	13.79	210.36	1,184.4	-135.1	-79.1	-79.1	0.00	0.00	
1,300.0	13.79	210.36	1,281.5	-155.7	-91.2	-91.2	0.00	0.00	
1,400.0	13.79	210.36	1,378.6	-176.2	-103.2	-103.2	0.00	0.00	
1,500.0	13.79	210.36	1,475.8	-196.8	-115.3	-115.3	0.00	0.00	
1,600.0	13.79	210.36	1,572.9	-217.4	-127.3	-127.3	0.00	0.00	
1,700.0	13.79	210.36	1,670.0	-238.0	-139.4	-139.4	0.00	0.00	
1,800.0	13.79	210.36	1,767.1	-258.5	-151.4	-151.4	0.00	0.00	
1,900.0	13.79	210.36	1,864.2	-279.1	-163.5	-163.5	0.00	0.00	
2,000.0	13.79	210.36	1,961.4	-299.7	-175.5	-175.5	0.00	0.00	
2,100.0	13.79	210.36	2,058.5	-320.2	-187.6	-187.6	0.00	0.00	
2,200.0	13.79	210.36	2,155.6	-340.8	-199.6	-199.6	0.00	0.00	
2,300.0	13.79	210.36	2,252.7	-361.4	-211.7	-211.7	0.00	0.00	
2,400.0	13.79	210.36	2,349.8	-381.9	-223.7	-223.7	0.00	0.00	
2,500.0	13.79	210.36	2,446.9	-402.5	-235.8	-235.8	0.00	0.00	
2,600.0	13.79	210.36	2,544.1	-423.1	-247.8	-247.8	0.00	0.00	
2,700.0	13.79	210.36	2,641.2	-443.6	-259.9	-259.9	0.00	0.00	
2,800.0	13.79	210.36	2,738.3	-464.2	-271.9	-271.9	0.00	0.00	
2,900.0	13.79	210.36	2,835.4	-484.8	-284.0	-284.0	0.00	0.00	
3,000.0	13.79	210.36	2,932.5	-505.3	-296.0	-296.0	0.00	0.00	
3,100.0	13.79	210.36	3,029.6	-525.9	-308.1	-308.1	0.00	0.00	
3,200.0	13.79	210.36	3,126.8	-546.5	-320.1	-320.1	0.00	0.00	
3,300.0	13.79	210.36	3,223.9	-567.0	-332.2	-332.2	0.00	0.00	
3,400.0	13.79	210.36	3,321.0	-587.6	-344.2	-344.2	0.00	0.00	
3,500.0	13.79	210.36	3,418.1	-608.2	-356.2	-356.2	0.00	0.00	
3,600.0	13.79	210.36	3,515.2	-628.7	-368.3	-368.3	0.00	0.00	
3,700.0	13.79	210.36	3,612.3	-649.3	-380.3	-380.3	0.00	0.00	
3,800.0	13.79	210.36	3,709.5	-669.9	-392.4	-392.4	0.00	0.00	
3,900.0	13.79	210.36	3,806.6	-690.4	-404.4	-404.4	0.00	0.00	
3,985.6	13.79	210.36	3,889.8	-708.1	-414.8	-414.8	0.00	0.00	Sussex
4,000.0	13.79	210.36	3,903.7	-711.0	-416.5	-416.5	0.00	0.00	
4,100.0	13.79	210.36	4,000.8	-731.6	-428.5	-428.5	0.00	0.00	
4,200.0	13.79	210.36	4,097.9	-752.1	-440.6	-440.6	0.00	0.00	
4,208.6	13.79	210.36	4,106.3	-753.9	-441.6	-441.6	0.00	0.00	Sussex Marker
4,300.0	13.79	210.36	4,195.1	-772.7	-452.6	-452.6	0.00	0.00	
4,400.0	13.79	210.36	4,292.2	-793.3	-464.7	-464.7	0.00	0.00	
4,451.1	13.79	210.36	4,341.8	-803.8	-470.8	-470.8	0.00	0.00	Shannon
4,500.0	13.79	210.36	4,389.3	-813.9	-476.7	-476.7	0.00	0.00	
4,600.0	13.79	210.36	4,486.4	-834.4	-488.8	-488.8	0.00	0.00	
4,700.0	13.79	210.36	4,583.5	-855.0	-500.8	-500.8	0.00	0.00	

# Planning Report

<b>Database:</b>	USA EDM 5000 Multi Users DB	<b>Local Co-ordinate Reference:</b>	Well Billings 3H-18H
<b>Company:</b>	EnCana Oil & Gas (USA) Inc	<b>TVD Reference:</b>	WELL @ 5158.0ft (Original Well Elev)
<b>Project:</b>	DJ Wattenberg	<b>MD Reference:</b>	WELL @ 5158.0ft (Original Well Elev)
<b>Site:</b>	S18-T3N-R68W (Billings)	<b>North Reference:</b>	True
<b>Well:</b>	Billings 3H-18H	<b>Survey Calculation Method:</b>	Minimum Curvature
<b>Wellbore:</b>	Hz		
<b>Design:</b>	Plan #1		

## Planned Survey

Measured Depth (ft)	Inclination (°)	Azimuth (°)	Vertical Depth (ft)	+N/-S (ft)	+E/-W (ft)	Vertical Section (ft)	Dogleg Rate (°/100ft)	Build Rate (°/100ft)	Comments / Formations
4,800.0	13.79	210.36	4,680.6	-875.6	-512.9	-512.9	0.00	0.00	
4,900.0	13.79	210.36	4,777.8	-896.1	-524.9	-524.9	0.00	0.00	
5,000.0	13.79	210.36	4,874.9	-916.7	-537.0	-537.0	0.00	0.00	
5,100.0	13.79	210.36	4,972.0	-937.3	-549.0	-549.0	0.00	0.00	
5,200.0	13.79	210.36	5,069.1	-957.8	-561.1	-561.1	0.00	0.00	
5,300.0	13.79	210.36	5,166.2	-978.4	-573.1	-573.1	0.00	0.00	
5,400.0	13.79	210.36	5,263.3	-999.0	-585.2	-585.2	0.00	0.00	
5,500.0	13.79	210.36	5,360.5	-1,019.5	-597.2	-597.2	0.00	0.00	
5,600.0	13.79	210.36	5,457.6	-1,040.1	-609.3	-609.3	0.00	0.00	
5,700.0	13.79	210.36	5,554.7	-1,060.7	-621.3	-621.3	0.00	0.00	
5,800.0	13.79	210.36	5,651.8	-1,081.2	-633.4	-633.4	0.00	0.00	
5,900.0	13.79	210.36	5,748.9	-1,101.8	-645.4	-645.4	0.00	0.00	
6,000.0	13.79	210.36	5,846.1	-1,122.4	-657.4	-657.4	0.00	0.00	
6,100.0	13.79	210.36	5,943.2	-1,142.9	-669.5	-669.5	0.00	0.00	
6,200.0	13.79	210.36	6,040.3	-1,163.5	-681.5	-681.5	0.00	0.00	
6,220.4	13.79	210.36	6,060.1	-1,167.7	-684.0	-684.0	0.00	0.00	Teepee Buttes
6,300.0	13.79	210.36	6,137.4	-1,184.1	-693.6	-693.6	0.00	0.00	
6,400.0	13.79	210.36	6,234.5	-1,204.6	-705.6	-705.6	0.00	0.00	
6,500.0	13.79	210.36	6,331.6	-1,225.2	-717.7	-717.7	0.00	0.00	
6,598.4	13.79	210.36	6,427.2	-1,245.4	-729.5	-729.5	0.00	0.00	Start build/turn @ 6598' MD
6,600.0	13.73	209.88	6,428.8	-1,245.8	-729.7	-729.7	8.00	-3.95	
6,700.0	11.99	174.16	6,526.4	-1,266.4	-734.6	-734.6	8.00	-1.74	
6,800.0	15.01	141.81	6,623.8	-1,287.0	-725.5	-725.5	8.00	3.02	
6,900.0	20.80	123.58	6,718.9	-1,307.0	-702.7	-702.7	8.00	5.80	
7,000.0	27.69	113.54	6,810.1	-1,326.1	-666.5	-666.5	8.00	6.88	
7,039.6	30.55	110.77	6,844.7	-1,333.4	-648.7	-648.7	8.00	7.24	Sharon Springs
7,100.0	35.02	107.34	6,895.5	-1,344.0	-617.8	-617.8	8.00	7.39	
7,154.3	39.09	104.86	6,938.8	-1,353.0	-586.4	-586.4	8.00	7.51	Niobrara
7,200.0	42.56	103.09	6,973.4	-1,360.2	-557.3	-557.3	8.00	7.59	
7,212.4	43.51	102.65	6,982.4	-1,362.1	-549.1	-549.1	8.00	7.62	B Chalk
7,300.0	50.23	99.92	7,042.3	-1,374.5	-486.4	-486.4	8.00	7.67	
7,400.0	57.96	97.39	7,100.9	-1,386.6	-406.4	-406.4	8.00	7.73	
7,462.7	62.83	96.01	7,131.9	-1,393.0	-352.3	-352.3	8.00	7.77	Ft. Hayes
7,500.0	65.74	95.25	7,148.0	-1,396.3	-318.8	-318.8	8.00	7.79	
7,600.0	73.54	93.37	7,182.8	-1,403.3	-225.4	-225.4	8.00	7.80	
7,700.0	81.36	91.63	7,204.5	-1,407.5	-128.0	-128.0	8.00	7.82	
7,701.8	81.50	91.60	7,204.8	-1,407.5	-126.2	-126.2	8.00	7.82	Codell
7,797.6	89.00	90.00	7,212.7	-1,408.9	-30.8	-30.8	8.00	7.83	LP @ 7212' TVD; 89°
7,800.0	89.00	90.00	7,212.8	-1,408.9	-28.4	-28.4	0.00	0.00	
7,900.0	89.00	90.00	7,214.5	-1,408.9	71.6	71.6	0.00	0.00	
8,000.0	89.00	90.00	7,216.3	-1,408.9	171.6	171.6	0.00	0.00	
8,100.0	89.00	90.00	7,218.0	-1,408.9	271.5	271.5	0.00	0.00	
8,200.0	89.00	90.00	7,219.7	-1,408.9	371.5	371.5	0.00	0.00	
8,300.0	89.00	90.00	7,221.5	-1,408.9	471.5	471.5	0.00	0.00	
8,400.0	89.00	90.00	7,223.2	-1,408.9	571.5	571.5	0.00	0.00	
8,500.0	89.00	90.00	7,225.0	-1,408.9	671.5	671.5	0.00	0.00	
8,600.0	89.00	90.00	7,226.7	-1,408.9	771.5	771.5	0.00	0.00	
8,700.0	89.00	90.00	7,228.5	-1,408.9	871.5	871.5	0.00	0.00	
8,800.0	89.00	90.00	7,230.2	-1,408.9	971.4	971.4	0.00	0.00	
8,900.0	89.00	90.00	7,232.0	-1,408.9	1,071.4	1,071.4	0.00	0.00	
9,000.0	89.00	90.00	7,233.7	-1,408.9	1,171.4	1,171.4	0.00	0.00	
9,100.0	89.00	90.00	7,235.4	-1,408.9	1,271.4	1,271.4	0.00	0.00	

# Planning Report

<b>Database:</b>	USA EDM 5000 Multi Users DB	<b>Local Co-ordinate Reference:</b>	Well Billings 3H-18H
<b>Company:</b>	EnCana Oil & Gas (USA) Inc	<b>TVD Reference:</b>	WELL @ 5158.0ft (Original Well Elev)
<b>Project:</b>	DJ Wattenberg	<b>MD Reference:</b>	WELL @ 5158.0ft (Original Well Elev)
<b>Site:</b>	S18-T3N-R68W (Billings)	<b>North Reference:</b>	True
<b>Well:</b>	Billings 3H-18H	<b>Survey Calculation Method:</b>	Minimum Curvature
<b>Wellbore:</b>	Hz		
<b>Design:</b>	Plan #1		

Planned Survey									
Measured Depth (ft)	Inclination (°)	Azimuth (°)	Vertical Depth (ft)	+N/-S (ft)	+E/-W (ft)	Vertical Section (ft)	Dogleg Rate (°/100ft)	Build Rate (°/100ft)	Comments / Formations
9,200.0	89.00	90.00	7,237.2	-1,408.9	1,371.4	1,371.4	0.00	0.00	
9,300.0	89.00	90.00	7,238.9	-1,408.9	1,471.4	1,471.4	0.00	0.00	
9,400.0	89.00	90.00	7,240.7	-1,408.9	1,571.3	1,571.3	0.00	0.00	
9,500.0	89.00	90.00	7,242.4	-1,408.9	1,671.3	1,671.3	0.00	0.00	
9,600.0	89.00	90.00	7,244.2	-1,408.9	1,771.3	1,771.3	0.00	0.00	
9,700.0	89.00	90.00	7,245.9	-1,408.9	1,871.3	1,871.3	0.00	0.00	
9,800.0	89.00	90.00	7,247.7	-1,408.9	1,971.3	1,971.3	0.00	0.00	
9,900.0	89.00	90.00	7,249.4	-1,408.9	2,071.3	2,071.3	0.00	0.00	
10,000.0	89.00	90.00	7,251.2	-1,408.9	2,171.3	2,171.3	0.00	0.00	
10,100.0	89.00	90.00	7,252.9	-1,408.9	2,271.2	2,271.2	0.00	0.00	
10,200.0	89.00	90.00	7,254.6	-1,408.9	2,371.2	2,371.2	0.00	0.00	
10,300.0	89.00	90.00	7,256.4	-1,408.9	2,471.2	2,471.2	0.00	0.00	
10,400.0	89.00	90.00	7,258.1	-1,408.9	2,571.2	2,571.2	0.00	0.00	
10,500.0	89.00	90.00	7,259.9	-1,408.9	2,671.2	2,671.2	0.00	0.00	
10,600.0	89.00	90.00	7,261.6	-1,408.9	2,771.2	2,771.2	0.00	0.00	
10,700.0	89.00	90.00	7,263.4	-1,408.9	2,871.1	2,871.1	0.00	0.00	
10,800.0	89.00	90.00	7,265.1	-1,408.9	2,971.1	2,971.1	0.00	0.00	
10,900.0	89.00	90.00	7,266.9	-1,408.9	3,071.1	3,071.1	0.00	0.00	
11,000.0	89.00	90.00	7,268.6	-1,408.9	3,171.1	3,171.1	0.00	0.00	
11,100.0	89.00	90.00	7,270.4	-1,408.9	3,271.1	3,271.1	0.00	0.00	
11,200.0	89.00	90.00	7,272.1	-1,408.9	3,371.1	3,371.1	0.00	0.00	
11,300.0	89.00	90.00	7,273.8	-1,408.9	3,471.1	3,471.1	0.00	0.00	
11,400.0	89.00	90.00	7,275.6	-1,408.9	3,571.0	3,571.0	0.00	0.00	
11,500.0	89.00	90.00	7,277.3	-1,408.9	3,671.0	3,671.0	0.00	0.00	
11,600.0	89.00	90.00	7,279.1	-1,408.9	3,771.0	3,771.0	0.00	0.00	
11,700.0	89.00	90.00	7,280.8	-1,408.9	3,871.0	3,871.0	0.00	0.00	
11,800.0	89.00	90.00	7,282.6	-1,408.9	3,971.0	3,971.0	0.00	0.00	
11,900.0	89.00	90.00	7,284.3	-1,408.9	4,071.0	4,071.0	0.00	0.00	
12,000.0	89.00	90.00	7,286.1	-1,408.9	4,170.9	4,170.9	0.00	0.00	
12,100.0	89.00	90.00	7,287.8	-1,408.9	4,270.9	4,270.9	0.00	0.00	
12,200.0	89.00	90.00	7,289.6	-1,408.9	4,370.9	4,370.9	0.00	0.00	
12,300.0	89.00	90.00	7,291.3	-1,408.9	4,470.9	4,470.9	0.00	0.00	
12,400.0	89.00	90.00	7,293.0	-1,408.9	4,570.9	4,570.9	0.00	0.00	
12,500.0	89.00	90.00	7,294.8	-1,408.9	4,670.9	4,670.9	0.00	0.00	
12,600.0	89.00	90.00	7,296.5	-1,408.9	4,770.9	4,770.9	0.00	0.00	
12,700.0	89.00	90.00	7,298.3	-1,408.9	4,870.8	4,870.8	0.00	0.00	
12,800.0	89.00	90.00	7,300.0	-1,408.9	4,970.8	4,970.8	0.00	0.00	
12,900.0	89.00	90.00	7,301.8	-1,408.9	5,070.8	5,070.8	0.00	0.00	
13,000.0	89.00	90.00	7,303.5	-1,408.9	5,170.8	5,170.8	0.00	0.00	
13,100.0	89.00	90.00	7,305.3	-1,408.9	5,270.8	5,270.8	0.00	0.00	
13,200.0	89.00	90.00	7,307.0	-1,408.9	5,370.8	5,370.8	0.00	0.00	
13,300.0	89.00	90.00	7,308.7	-1,408.9	5,470.8	5,470.8	0.00	0.00	
13,400.0	89.00	90.00	7,310.5	-1,408.9	5,570.7	5,570.7	0.00	0.00	
13,500.0	89.00	90.00	7,312.2	-1,408.9	5,670.7	5,670.7	0.00	0.00	
13,600.0	89.00	90.00	7,314.0	-1,408.9	5,770.7	5,770.7	0.00	0.00	
13,700.0	89.00	90.00	7,315.7	-1,408.9	5,870.7	5,870.7	0.00	0.00	
13,800.0	89.00	90.00	7,317.5	-1,408.9	5,970.7	5,970.7	0.00	0.00	
13,900.0	89.00	90.00	7,319.2	-1,408.9	6,070.7	6,070.7	0.00	0.00	
14,000.0	89.00	90.00	7,321.0	-1,408.9	6,170.6	6,170.6	0.00	0.00	
14,100.0	89.00	90.00	7,322.7	-1,408.9	6,270.6	6,270.6	0.00	0.00	
14,200.0	89.00	90.00	7,324.5	-1,408.9	6,370.6	6,370.6	0.00	0.00	
14,300.0	89.00	90.00	7,326.2	-1,408.9	6,470.6	6,470.6	0.00	0.00	

## Planning Report

<b>Database:</b>	USA EDM 5000 Multi Users DB	<b>Local Co-ordinate Reference:</b>	Well Billings 3H-18H
<b>Company:</b>	EnCana Oil & Gas (USA) Inc	<b>TVD Reference:</b>	WELL @ 5158.0ft (Original Well Elev)
<b>Project:</b>	DJ Wattenberg	<b>MD Reference:</b>	WELL @ 5158.0ft (Original Well Elev)
<b>Site:</b>	S18-T3N-R68W (Billings)	<b>North Reference:</b>	True
<b>Well:</b>	Billings 3H-18H	<b>Survey Calculation Method:</b>	Minimum Curvature
<b>Wellbore:</b>	Hz		
<b>Design:</b>	Plan #1		

### Planned Survey

Measured Depth (ft)	Inclination (°)	Azimuth (°)	Vertical Depth (ft)	+N/-S (ft)	+E/-W (ft)	Vertical Section (ft)	Dogleg Rate (°/100ft)	Build Rate (°/100ft)	Comments / Formations
14,400.0	89.00	90.00	7,327.9	-1,408.9	6,570.6	6,570.6	0.00	0.00	
14,500.0	89.00	90.00	7,329.7	-1,408.9	6,670.6	6,670.6	0.00	0.00	
14,517.6	89.00	90.00	7,330.0	-1,408.9	6,688.2	6,688.2	0.00	0.00	TD at 14517.6 - Billings 3H-18H PBHL

### Targets

Target Name - hit/miss target - Shape	Dip Angle (°)	Dip Dir. (°)	TVD (ft)	+N/-S (ft)	+E/-W (ft)	Northing (ft)	Easting (ft)	Latitude	Longitude
Billings 3H-18H PBHL - plan hits target center - Point	0.00	0.00	7,330.0	-1,408.9	6,688.2	1,322,830.88	3,131,683.03	40.218600	-105.028470

### Formations

Measured Depth (ft)	Vertical Depth (ft)	Name	Lithology	Dip (°)	Dip Direction (°)
3,985.6	3,897.0	Sussex		1.00	90.00
4,208.6	4,114.0	Sussex Marker		1.00	90.00
4,451.1	4,350.0	Shannon		1.00	90.00
6,220.4	6,072.0	Teepee Buttes		1.00	90.00
7,039.6	6,856.0	Sharon Springs		1.00	90.00
7,154.3	6,949.0	Niobrara		1.00	90.00
7,212.4	6,992.0	B Chalk		1.00	90.00
7,462.7	7,138.0	Ft. Hayes		1.00	90.00
7,701.8	7,207.0	Codell		1.00	90.00

### Plan Annotations

Measured Depth (ft)	Vertical Depth (ft)	Local Coordinates		Comment
		+N/-S (ft)	+E/-W (ft)	
200.0	200.0	0.0	0.0	KOP @ 200'
889.5	882.9	-71.3	-41.7	EOB; Inc=13.79°
6,598.4	6,427.2	-1,245.4	-729.5	Start build/turn @ 6598' MD
7,797.6	7,212.7	-1,408.9	-30.8	LP @ 7212' TVD; 89°
14,517.6	7,330.0	-1,408.9	6,688.2	TD at 14517.6

# **EnCana Oil & Gas (USA) Inc**

**DJ Wattenberg**

**S18-T3N-R68W (Billings)**

**Billings 3H-18H**

**Hz**

**Plan #1**

## **Anticollision Report**

**09 January, 2013**

## Anticollision Report

<b>Company:</b>	EnCana Oil & Gas (USA) Inc	<b>Local Co-ordinate Reference:</b>	Well Billings 3H-18H
<b>Project:</b>	DJ Wattenberg	<b>TVD Reference:</b>	WELL @ 5158.0ft (Original Well Elev)
<b>Reference Site:</b>	S18-T3N-R68W (Billings)	<b>MD Reference:</b>	WELL @ 5158.0ft (Original Well Elev)
<b>Site Error:</b>	0.0ft	<b>North Reference:</b>	True
<b>Reference Well:</b>	Billings 3H-18H	<b>Survey Calculation Method:</b>	Minimum Curvature
<b>Well Error:</b>	0.0ft	<b>Output errors are at</b>	2.00 sigma
<b>Reference Wellbore</b>	Hz	<b>Database:</b>	USA EDM 5000 Multi Users DB
<b>Reference Design:</b>	Plan #1	<b>Offset TVD Reference:</b>	Offset Datum

<b>Reference</b>	Plan #1		
<b>Filter type:</b>	NO GLOBAL FILTER: Using user defined selection & filtering criteria		
<b>Interpolation Method:</b>	MD Interval 100.0ft	<b>Error Model:</b>	Systematic Ellipse
<b>Depth Range:</b>	Unlimited	<b>Scan Method:</b>	Closest Approach 3D
<b>Results Limited by:</b>	Maximum center-center distance of 500.0ft	<b>Error Surface:</b>	Elliptical Conic
<b>Warning Levels Evaluated at:</b>	2.00 Sigma		

<b>Survey Tool Program</b>	<b>Date</b>	1/9/2013		
<b>From (ft)</b>	<b>To (ft)</b>	<b>Survey (Wellbore)</b>	<b>Tool Name</b>	<b>Description</b>
0.0	14,517.6	Plan #1 (Hz)	MWD	Geolink MWD

Summary						
Site Name	Reference Measured Depth (ft)	Offset Measured Depth (ft)	Distance Between Centres (ft)	Distance Between Ellipses (ft)	Separation Factor	Warning
Offset Well - Wellbore - Design						
S18-T3N-R68W (Billings)						
Billings 2A-18H - Hz - Plan #1						Out of range
Billings 2B-18H - HZ - Plan #1						Out of range
Billings 2C-18H - HZ - Plan #1						Out of range
Billings 2D-18H - Hz - Plan #1						Out of range
Billings 2E-18H - HZ - Plan #1						Out of range
Billings 2F-18H - HZ - Plan #1						Out of range
Billings 2G-18H - Hz - Plan #1						Out of range
Billings 2H-18H - Hz - Plan #1						Out of range
Billings 3A-18H - Hz - Plan #1	166.3	167.3	72.9	72.3	135.682	CC
Billings 3A-18H - Hz - Plan #1	200.0	201.0	72.9	72.2	111.320	ES
Billings 3A-18H - Hz - Plan #1	700.0	690.9	127.7	125.3	51.732	SF
Billings 3B-18H - Hz - Plan #1	200.0	200.0	61.9	61.3	94.873	CC, ES
Billings 3B-18H - Hz - Plan #1	600.0	596.1	91.4	89.3	43.985	SF
Billings 3C-18H - Hz - Plan #1	200.0	200.0	51.0	50.3	78.130	CC, ES
Billings 3C-18H - Hz - Plan #1	600.0	598.1	77.1	75.0	37.288	SF
Billings 3D-18H - Hz - Plan #1	200.0	200.0	40.1	39.4	61.382	CC, ES
Billings 3D-18H - Hz - Plan #1	500.0	499.5	54.2	52.5	31.765	SF
Billings 3E-18H - Hz - Plan #1	200.0	200.0	32.8	32.1	50.227	CC, ES
Billings 3E-18H - Hz - Plan #1	4,000.0	3,979.6	499.4	476.9	22.193	SF
Billings 3F-18H - Hz - Plan #1	200.0	200.0	21.9	21.2	33.484	CC, ES
Billings 3F-18H - Hz - Plan #1	5,100.0	5,098.1	312.0	274.0	8.205	SF
Billings 3G-18H - Hz - Plan #1	200.0	201.0	10.9	10.3	16.698	CC, ES
Billings 3G-18H - Hz - Plan #1	14,517.6	14,289.4	407.2	107.6	1.359	Level 3, SF



# Anticollision Report

<b>Company:</b>	EnCana Oil & Gas (USA) Inc	<b>Local Co-ordinate Reference:</b>	Well Billings 3H-18H
<b>Project:</b>	DJ Wattenberg	<b>TVD Reference:</b>	WELL @ 5158.0ft (Original Well Elev)
<b>Reference Site:</b>	S18-T3N-R68W (Billings)	<b>MD Reference:</b>	WELL @ 5158.0ft (Original Well Elev)
<b>Site Error:</b>	0.0ft	<b>North Reference:</b>	True
<b>Reference Well:</b>	Billings 3H-18H	<b>Survey Calculation Method:</b>	Minimum Curvature
<b>Well Error:</b>	0.0ft	<b>Output errors are at</b>	2.00 sigma
<b>Reference Wellbore</b>	Hz	<b>Database:</b>	USA EDM 5000 Multi Users DB
<b>Reference Design:</b>	Plan #1	<b>Offset TVD Reference:</b>	Offset Datum

<b>Offset Design</b> S18-T3N-R68W (Billings) - Billings 3A-18H - Hz - Plan #1													Offset Site Error:	0.0 ft
Survey Program: 0-MWD													Offset Well Error:	0.0 ft
Reference		Offset		Semi Major Axis			Distance							
Measured Depth (ft)	Vertical Depth (ft)	Measured Depth (ft)	Vertical Depth (ft)	Reference (ft)	Offset (ft)	Highside Toolface (°)	Offset Wellbore Centre +N/-S (ft)	+E/-W (ft)	Between Centres (ft)	Between Ellipses (ft)	Total Uncertainty Axis	Separation Factor	Warning	
0.0	0.0	1.0	1.0	0.0	0.0	0.00	72.9	0.0	72.9					
100.0	100.0	101.0	101.0	0.2	0.2	0.00	72.9	0.0	72.9	72.6	0.31	238.537		
166.3	166.3	167.3	167.3	0.3	0.3	0.00	72.9	0.0	72.9	72.3	0.54	135.682 CC		
200.0	200.0	201.0	201.0	0.3	0.3	0.00	72.9	0.0	72.9	72.2	0.65	111.320 ES		
300.0	300.0	300.0	300.0	0.5	0.5	149.88	73.6	-0.5	75.1	74.1	1.00	74.854		
400.0	399.8	398.7	398.6	0.7	0.7	150.54	75.6	-2.1	81.7	80.3	1.36	60.252		
500.0	499.5	496.9	496.7	0.9	0.9	151.42	79.0	-4.7	92.7	90.9	1.72	54.002		
600.0	598.7	594.3	594.0	1.2	1.1	152.34	83.7	-8.2	108.0	105.9	2.09	51.775		
700.0	697.5	690.9	690.3	1.5	1.3	153.17	89.6	-12.7	127.7	125.3	2.47	51.732 SF		
800.0	795.6	786.2	785.1	1.9	1.5	153.86	96.7	-18.1	151.8	148.9	2.87	52.952		
900.0	893.1	880.1	878.5	2.3	1.7	154.43	104.9	-24.4	180.0	176.7	3.28	54.913		
1,000.0	990.2	973.0	970.6	2.7	2.0	154.88	114.3	-31.5	210.6	206.9	3.71	56.776		
1,100.0	1,087.3	1,065.1	1,061.9	3.2	2.2	154.95	124.8	-39.5	242.3	238.2	4.15	58.326		
1,200.0	1,184.4	1,156.6	1,152.2	3.6	2.5	154.79	136.3	-48.2	275.2	270.5	4.61	59.631		
1,300.0	1,281.5	1,247.3	1,241.5	4.1	2.8	154.46	148.8	-57.8	309.1	304.0	5.09	60.746		
1,400.0	1,378.6	1,337.2	1,329.7	4.5	3.2	154.03	162.4	-68.1	344.1	338.5	5.58	61.717		
1,500.0	1,475.8	1,426.2	1,416.9	4.9	3.5	153.53	176.9	-79.1	380.2	374.1	6.08	62.579		
1,600.0	1,572.9	1,514.4	1,502.9	5.4	3.9	152.98	192.3	-90.9	417.4	410.8	6.59	63.360		
1,700.0	1,670.0	1,600.0	1,586.1	5.8	4.2	152.41	208.3	-103.0	455.7	448.6	7.11	64.131		
1,800.0	1,767.1	1,688.0	1,671.3	6.3	4.6	151.80	225.8	-116.3	495.1	487.5	7.65	64.748		

# Anticollision Report

<b>Company:</b>	EnCana Oil & Gas (USA) Inc	<b>Local Co-ordinate Reference:</b>	Well Billings 3H-18H
<b>Project:</b>	DJ Wattenberg	<b>TVD Reference:</b>	WELL @ 5158.0ft (Original Well Elev)
<b>Reference Site:</b>	S18-T3N-R68W (Billings)	<b>MD Reference:</b>	WELL @ 5158.0ft (Original Well Elev)
<b>Site Error:</b>	0.0ft	<b>North Reference:</b>	True
<b>Reference Well:</b>	Billings 3H-18H	<b>Survey Calculation Method:</b>	Minimum Curvature
<b>Well Error:</b>	0.0ft	<b>Output errors are at</b>	2.00 sigma
<b>Reference Wellbore</b>	Hz	<b>Database:</b>	USA EDM 5000 Multi Users DB
<b>Reference Design:</b>	Plan #1	<b>Offset TVD Reference:</b>	Offset Datum

Offset Design S18-T3N-R68W (Billings) - Billings 3B-18H - Hz - Plan #1													Offset Site Error:	0.0 ft
Survey Program: 0-MWD													Offset Well Error:	0.0 ft
Reference		Offset		Semi Major Axis			Distance				Total	Separation	Warning	
Measured Depth (ft)	Vertical Depth (ft)	Measured Depth (ft)	Vertical Depth (ft)	Reference (ft)	Offset (ft)	Highside Toolface (°)	Offset Wellbore Centre +N/-S (ft)	+E/-W (ft)	Between Centres (ft)	Between Ellipses (ft)	Uncertainty Axis	Factor		
0.0	0.0	0.0	0.0	0.0	0.0	0.00	61.9	0.0	61.9					
100.0	100.0	100.0	100.0	0.2	0.2	0.00	61.9	0.0	61.9	61.6	0.30	203.922		
200.0	200.0	200.0	200.0	0.3	0.3	0.00	61.9	0.0	61.9	61.3	0.65	94.873 CC, ES		
300.0	300.0	300.0	300.0	0.5	0.5	150.42	61.9	0.0	63.4	62.4	1.00	63.288		
400.0	399.8	399.1	399.1	0.7	0.7	151.97	62.5	-0.7	68.6	67.2	1.35	50.650		
500.0	499.5	497.9	497.8	0.9	0.9	153.39	64.1	-2.6	77.9	76.2	1.71	45.519		
600.0	598.7	596.1	596.0	1.2	1.0	154.52	66.9	-5.8	91.4	89.3	2.08	43.985 SF		
700.0	697.5	693.6	693.2	1.5	1.2	155.33	70.7	-10.3	109.0	106.5	2.46	44.381		
800.0	795.6	790.0	789.4	1.9	1.4	155.86	75.5	-15.9	130.6	127.8	2.85	45.866		
900.0	893.1	885.4	884.3	2.3	1.6	156.19	81.3	-22.7	156.3	153.0	3.26	47.959		
1,000.0	990.2	979.9	978.3	2.7	1.9	156.31	88.1	-30.6	184.1	180.4	3.69	49.825		
1,100.0	1,087.3	1,073.9	1,071.6	3.2	2.1	156.03	95.8	-39.7	212.7	208.6	4.15	51.256		
1,200.0	1,184.4	1,167.4	1,164.1	3.6	2.4	155.51	104.5	-49.8	242.2	237.6	4.63	52.353		
1,300.0	1,281.5	1,260.3	1,255.8	4.1	2.7	154.82	114.1	-61.0	272.6	267.5	5.13	53.196		
1,400.0	1,378.6	1,352.5	1,346.6	4.5	3.0	154.03	124.5	-73.3	304.0	298.3	5.64	53.851		
1,500.0	1,475.8	1,444.0	1,436.5	4.9	3.3	153.18	135.9	-86.6	336.2	330.0	6.18	54.368		
1,600.0	1,572.9	1,536.2	1,526.7	5.4	3.7	152.28	148.1	-100.9	369.4	362.6	6.74	54.785		
1,700.0	1,670.0	1,630.4	1,618.8	5.8	4.0	151.48	160.8	-115.8	402.8	395.5	7.31	55.088		
1,800.0	1,767.1	1,724.5	1,710.8	6.3	4.4	150.81	173.6	-130.7	436.2	428.3	7.88	55.334		
1,900.0	1,864.2	1,818.6	1,802.9	6.7	4.7	150.23	186.3	-145.6	469.7	461.3	8.46	55.539		

# Anticollision Report

<b>Company:</b>	EnCana Oil & Gas (USA) Inc	<b>Local Co-ordinate Reference:</b>	Well Billings 3H-18H
<b>Project:</b>	DJ Wattenberg	<b>TVD Reference:</b>	WELL @ 5158.0ft (Original Well Elev)
<b>Reference Site:</b>	S18-T3N-R68W (Billings)	<b>MD Reference:</b>	WELL @ 5158.0ft (Original Well Elev)
<b>Site Error:</b>	0.0ft	<b>North Reference:</b>	True
<b>Reference Well:</b>	Billings 3H-18H	<b>Survey Calculation Method:</b>	Minimum Curvature
<b>Well Error:</b>	0.0ft	<b>Output errors are at</b>	2.00 sigma
<b>Reference Wellbore</b>	Hz	<b>Database:</b>	USA EDM 5000 Multi Users DB
<b>Reference Design:</b>	Plan #1	<b>Offset TVD Reference:</b>	Offset Datum

Offset Design S18-T3N-R68W (Billings) - Billings 3C-18H - Hz - Plan #1													Offset Site Error:	0.0 ft
Survey Program: 0-MWD													Offset Well Error:	0.0 ft
Reference		Offset		Semi Major Axis			Distance				Total		Warning	
Measured Depth (ft)	Vertical Depth (ft)	Measured Depth (ft)	Vertical Depth (ft)	Reference (ft)	Offset (ft)	Highside Toolface (°)	Offset Wellbore Centre +N/-S (ft)	+E/-W (ft)	Between Centres (ft)	Between Ellipses (ft)	Uncertainty Axis	Separation Factor		
0.0	0.0	0.0	0.0	0.0	0.0	0.00	51.0	0.0	51.0					
100.0	100.0	100.0	100.0	0.2	0.2	0.00	51.0	0.0	51.0	50.7	0.30	167.935		
200.0	200.0	200.0	200.0	0.3	0.3	0.00	51.0	0.0	51.0	50.3	0.65	78.130 CC, ES		
300.0	300.0	300.0	300.0	0.5	0.5	150.59	51.0	0.0	52.5	51.5	1.00	52.387		
400.0	399.8	399.8	399.8	0.7	0.7	153.12	51.0	0.0	57.1	55.8	1.35	42.186		
500.0	499.5	499.2	499.2	0.9	0.8	155.79	51.3	-0.8	65.2	63.5	1.71	38.195		
600.0	598.7	598.1	598.1	1.2	1.0	157.55	52.3	-3.2	77.1	75.0	2.07	37.288 SF		
700.0	697.5	696.6	696.4	1.5	1.2	158.54	53.8	-7.1	92.6	90.1	2.44	38.005		
800.0	795.6	794.4	794.1	1.9	1.4	158.97	56.0	-12.6	111.6	108.8	2.82	39.612		
900.0	893.1	891.4	890.8	2.3	1.6	159.05	58.7	-19.6	134.2	131.0	3.22	41.682		
1,000.0	990.2	987.9	986.9	2.7	1.8	158.80	62.0	-28.0	158.4	154.7	3.65	43.376		
1,100.0	1,087.3	1,084.2	1,082.6	3.2	2.0	158.10	66.0	-38.0	182.9	178.8	4.11	44.497		
1,200.0	1,184.4	1,180.3	1,177.9	3.6	2.3	157.12	70.4	-49.4	207.8	203.2	4.60	45.176		
1,300.0	1,281.5	1,276.0	1,272.6	4.1	2.6	155.96	75.5	-62.2	233.2	228.0	5.12	45.523		
1,400.0	1,378.6	1,371.4	1,366.8	4.5	2.9	154.67	81.1	-76.4	259.0	253.3	5.68	45.626		
1,500.0	1,475.8	1,467.3	1,461.3	4.9	3.2	153.37	87.2	-91.9	285.3	279.1	6.26	45.616		
1,600.0	1,572.9	1,563.6	1,556.1	5.4	3.5	152.28	93.3	-107.4	311.8	304.9	6.84	45.566		
1,700.0	1,670.0	1,659.9	1,650.9	5.8	3.8	151.35	99.4	-123.0	338.3	330.9	7.44	45.502		
1,800.0	1,767.1	1,756.2	1,745.7	6.3	4.1	150.56	105.6	-138.5	364.9	356.9	8.03	45.432		
1,900.0	1,864.2	1,852.5	1,840.5	6.7	4.4	149.88	111.7	-154.1	391.6	383.0	8.63	45.363		
2,000.0	1,961.4	1,948.7	1,935.3	7.2	4.8	149.28	117.8	-169.6	418.3	409.1	9.24	45.295		
2,100.0	2,058.5	2,045.0	2,030.2	7.6	5.1	148.75	124.0	-185.2	445.1	435.2	9.84	45.230		
2,200.0	2,155.6	2,141.3	2,125.0	8.1	5.4	148.29	130.1	-200.8	471.9	461.4	10.45	45.169		
2,300.0	2,252.7	2,237.6	2,219.8	8.6	5.8	147.87	136.2	-216.3	498.7	487.6	11.05	45.112		

# Anticollision Report

<b>Company:</b>	EnCana Oil & Gas (USA) Inc	<b>Local Co-ordinate Reference:</b>	Well Billings 3H-18H
<b>Project:</b>	DJ Wattenberg	<b>TVD Reference:</b>	WELL @ 5158.0ft (Original Well Elev)
<b>Reference Site:</b>	S18-T3N-R68W (Billings)	<b>MD Reference:</b>	WELL @ 5158.0ft (Original Well Elev)
<b>Site Error:</b>	0.0ft	<b>North Reference:</b>	True
<b>Reference Well:</b>	Billings 3H-18H	<b>Survey Calculation Method:</b>	Minimum Curvature
<b>Well Error:</b>	0.0ft	<b>Output errors are at</b>	2.00 sigma
<b>Reference Wellbore</b>	Hz	<b>Database:</b>	USA EDM 5000 Multi Users DB
<b>Reference Design:</b>	Plan #1	<b>Offset TVD Reference:</b>	Offset Datum

Offset Design S18-T3N-R68W (Billings) - Billings 3D-18H - Hz - Plan #1													Offset Site Error:	0.0 ft
Survey Program: 0-MWD													Offset Well Error:	0.0 ft
Reference		Offset		Semi Major Axis		Highside Toolface (°)	Distance		Total Uncertainty Axis	Separation Factor	Warning			
Measured Depth (ft)	Vertical Depth (ft)	Measured Depth (ft)	Vertical Depth (ft)	Reference (ft)	Offset (ft)		Offset Wellbore Centre +N/-S (ft)	+E/-W (ft)						
0.0	0.0	0.0	0.0	0.0	0.0	0.00	40.1	0.0	40.1					
100.0	100.0	100.0	100.0	0.2	0.2	0.00	40.1	0.0	40.1	39.8	0.30	131.936		
200.0	200.0	200.0	200.0	0.3	0.3	0.00	40.1	0.0	40.1	39.4	0.65	61.382 CC, ES		
300.0	300.0	300.0	300.0	0.5	0.5	150.84	40.1	0.0	41.6	40.6	1.00	41.483		
400.0	399.8	399.8	399.8	0.7	0.7	153.96	40.1	0.0	46.2	44.9	1.35	34.140		
500.0	499.5	499.5	499.5	0.9	0.8	157.95	40.1	0.0	54.2	52.5	1.71	31.765 SF		
600.0	598.7	599.0	599.0	1.2	1.0	161.16	40.0	-0.9	65.4	63.4	2.06	31.788		
700.0	697.5	698.3	698.3	1.5	1.2	162.92	39.8	-3.4	79.6	77.2	2.41	32.987		
800.0	795.6	797.3	797.2	1.9	1.4	163.71	39.5	-7.7	96.6	93.8	2.77	34.809		
900.0	893.1	895.9	895.6	2.3	1.6	163.90	39.1	-13.6	116.3	113.2	3.15	36.937		
1,000.0	990.2	994.5	993.9	2.7	1.8	163.59	38.6	-21.3	136.9	133.3	3.55	38.532		
1,100.0	1,087.3	1,093.2	1,092.2	3.2	2.0	162.75	38.0	-30.6	156.9	152.9	3.98	39.411		
1,200.0	1,184.4	1,192.1	1,190.4	3.6	2.2	161.56	37.2	-41.6	176.5	172.0	4.44	39.724		
1,300.0	1,281.5	1,291.0	1,288.4	4.1	2.5	160.13	36.4	-54.4	195.7	190.7	4.94	39.592		
1,400.0	1,378.6	1,389.9	1,386.3	4.5	2.8	158.50	35.4	-68.8	214.5	209.1	5.48	39.118		
1,500.0	1,475.8	1,488.7	1,483.8	4.9	3.1	156.72	34.3	-84.9	233.2	227.2	6.07	38.391		
1,600.0	1,572.9	1,586.8	1,580.4	5.4	3.4	154.98	33.1	-101.9	251.9	245.2	6.69	37.646		
1,700.0	1,670.0	1,684.7	1,676.9	5.8	3.7	153.48	32.0	-118.8	270.8	263.5	7.32	36.983		
1,800.0	1,767.1	1,782.7	1,773.3	6.3	4.0	152.18	30.8	-135.8	289.8	281.9	7.96	36.397		
1,900.0	1,864.2	1,880.7	1,869.8	6.7	4.3	151.04	29.7	-152.8	309.0	300.4	8.61	35.880		
2,000.0	1,961.4	1,978.6	1,966.3	7.2	4.7	150.03	28.5	-169.8	328.2	319.0	9.27	35.423		
2,100.0	2,058.5	2,076.6	2,062.8	7.6	5.0	149.13	27.3	-186.7	347.6	337.7	9.93	35.018		
2,200.0	2,155.6	2,174.6	2,159.3	8.1	5.3	148.33	26.2	-203.7	367.0	356.4	10.59	34.658		
2,300.0	2,252.7	2,272.6	2,255.8	8.6	5.7	147.61	25.0	-220.7	386.5	375.2	11.26	34.337		
2,400.0	2,349.8	2,370.5	2,352.2	9.0	6.0	146.96	23.9	-237.7	406.0	394.1	11.93	34.049		
2,500.0	2,446.9	2,468.5	2,448.7	9.5	6.3	146.36	22.7	-254.6	425.6	413.0	12.60	33.790		
2,600.0	2,544.1	2,566.5	2,545.2	9.9	6.7	145.82	21.6	-271.6	445.3	432.0	13.27	33.556		
2,700.0	2,641.2	2,664.4	2,641.7	10.4	7.0	145.33	20.4	-288.6	464.9	451.0	13.94	33.344		
2,800.0	2,738.3	2,762.4	2,738.2	10.8	7.3	144.87	19.2	-305.6	484.6	470.0	14.62	33.151		

# Anticollision Report

<b>Company:</b>	EnCana Oil & Gas (USA) Inc	<b>Local Co-ordinate Reference:</b>	Well Billings 3H-18H
<b>Project:</b>	DJ Wattenberg	<b>TVD Reference:</b>	WELL @ 5158.0ft (Original Well Elev)
<b>Reference Site:</b>	S18-T3N-R68W (Billings)	<b>MD Reference:</b>	WELL @ 5158.0ft (Original Well Elev)
<b>Site Error:</b>	0.0ft	<b>North Reference:</b>	True
<b>Reference Well:</b>	Billings 3H-18H	<b>Survey Calculation Method:</b>	Minimum Curvature
<b>Well Error:</b>	0.0ft	<b>Output errors are at</b>	2.00 sigma
<b>Reference Wellbore</b>	Hz	<b>Database:</b>	USA EDM 5000 Multi Users DB
<b>Reference Design:</b>	Plan #1	<b>Offset TVD Reference:</b>	Offset Datum

Offset Design S18-T3N-R68W (Billings) - Billings 3E-18H - Hz - Plan #1													Offset Site Error:	0.0 ft
Survey Program: 0-MWD													Offset Well Error:	0.0 ft
Reference		Offset		Semi Major Axis			Distance				Total	Separation	Warning	
Measured Depth (ft)	Vertical Depth (ft)	Measured Depth (ft)	Vertical Depth (ft)	Reference (ft)	Offset (ft)	Highside Toolface (°)	Offset Wellbore Centre +N/-S (ft)	+E/-W (ft)	Between Centres (ft)	Between Ellipses (ft)	Uncertainty Axis	Factor		
0.0	0.0	0.0	0.0	0.0	0.0	0.00	32.8	0.0	32.8					
100.0	100.0	100.0	100.0	0.2	0.2	0.00	32.8	0.0	32.8	32.5	0.30	107.959		
200.0	200.0	200.0	200.0	0.3	0.3	0.00	32.8	0.0	32.8	32.1	0.65	50.227 CC, ES		
300.0	300.0	300.0	300.0	0.5	0.5	151.10	32.8	0.0	34.3	33.3	1.00	34.222		
400.0	399.8	399.8	399.8	0.7	0.7	154.78	32.8	0.0	39.0	37.6	1.35	28.787		
500.0	499.5	499.9	499.9	0.9	0.9	158.42	32.4	-0.8	46.5	44.8	1.71	27.232		
600.0	598.7	600.0	599.9	1.2	1.0	160.79	31.2	-3.1	56.3	54.3	2.06	27.304		
700.0	697.5	699.9	699.8	1.5	1.2	162.21	29.1	-6.9	68.4	66.0	2.42	28.225		
800.0	795.6	799.8	799.4	1.9	1.4	162.96	26.3	-12.3	82.7	79.9	2.79	29.609		
900.0	893.1	899.4	898.8	2.3	1.6	163.29	22.7	-19.3	99.1	96.0	3.17	31.228		
1,000.0	990.2	999.3	998.2	2.7	1.8	163.14	18.2	-27.7	115.8	112.2	3.58	32.313		
1,100.0	1,087.3	1,099.5	1,097.8	3.2	2.1	162.45	13.0	-37.8	131.3	127.2	4.02	32.685		
1,200.0	1,184.4	1,200.0	1,197.4	3.6	2.3	161.37	6.9	-49.4	145.6	141.2	4.48	32.504		
1,300.0	1,281.5	1,300.7	1,297.0	4.1	2.6	159.99	-0.1	-62.6	159.0	154.0	4.99	31.892		
1,400.0	1,378.6	1,401.6	1,396.5	4.5	3.0	158.35	-7.8	-77.3	171.4	165.8	5.54	30.949		
1,500.0	1,475.8	1,500.7	1,494.1	4.9	3.3	156.74	-15.8	-92.6	183.4	177.2	6.11	29.998		
1,600.0	1,572.9	1,599.9	1,591.8	5.4	3.6	155.33	-23.8	-107.8	195.5	188.8	6.70	29.154		
1,700.0	1,670.0	1,699.1	1,689.4	5.8	3.9	154.08	-31.8	-123.0	207.7	200.4	7.31	28.407		
1,800.0	1,767.1	1,798.2	1,787.1	6.3	4.3	152.97	-39.8	-138.3	220.0	212.1	7.93	27.745		
1,900.0	1,864.2	1,897.4	1,884.7	6.7	4.6	151.98	-47.8	-153.5	232.4	223.8	8.56	27.158		
2,000.0	1,961.4	1,996.5	1,982.4	7.2	4.9	151.09	-55.8	-168.8	244.8	235.6	9.19	26.636		
2,100.0	2,058.5	2,095.7	2,080.0	7.6	5.3	150.29	-63.8	-184.0	257.3	247.5	9.83	26.170		
2,200.0	2,155.6	2,194.8	2,177.7	8.1	5.6	149.56	-71.8	-199.3	269.9	259.4	10.48	25.752		
2,300.0	2,252.7	2,294.0	2,275.3	8.6	5.9	148.90	-79.8	-214.5	282.4	271.3	11.13	25.377		
2,400.0	2,349.8	2,393.1	2,373.0	9.0	6.3	148.29	-87.8	-229.8	295.1	283.3	11.78	25.038		
2,500.0	2,446.9	2,492.3	2,470.6	9.5	6.6	147.73	-95.8	-245.0	307.7	295.3	12.44	24.730		
2,600.0	2,544.1	2,591.5	2,568.3	9.9	7.0	147.22	-103.8	-260.3	320.4	307.3	13.10	24.450		
2,700.0	2,641.2	2,690.6	2,665.9	10.4	7.3	146.74	-111.9	-275.5	333.1	319.3	13.77	24.195		
2,800.0	2,738.3	2,789.8	2,763.6	10.8	7.7	146.30	-119.9	-290.7	345.8	331.4	14.43	23.962		
2,900.0	2,835.4	2,888.9	2,861.2	11.3	8.0	145.89	-127.9	-306.0	358.5	343.4	15.10	23.747		
3,000.0	2,932.5	2,988.1	2,958.9	11.7	8.4	145.51	-135.9	-321.2	371.3	355.5	15.77	23.549		
3,100.0	3,029.6	3,087.2	3,056.5	12.2	8.7	145.16	-143.9	-336.5	384.0	367.6	16.44	23.366		
3,200.0	3,126.8	3,186.4	3,154.2	12.6	9.0	144.82	-151.9	-351.7	396.8	379.7	17.11	23.197		
3,300.0	3,223.9	3,285.5	3,251.8	13.1	9.4	144.51	-159.9	-367.0	409.6	391.8	17.78	23.040		
3,400.0	3,321.0	3,384.7	3,349.5	13.5	9.7	144.22	-167.9	-382.2	422.4	404.0	18.45	22.894		
3,500.0	3,418.1	3,483.8	3,447.1	14.0	10.1	143.94	-175.9	-397.5	435.2	416.1	19.12	22.757		
3,600.0	3,515.2	3,583.0	3,544.8	14.4	10.4	143.68	-183.9	-412.7	448.0	428.2	19.80	22.630		
3,700.0	3,612.3	3,682.2	3,642.4	14.9	10.8	143.44	-191.9	-427.9	460.9	440.4	20.47	22.510		
3,800.0	3,709.5	3,781.3	3,740.1	15.3	11.1	143.21	-199.9	-443.2	473.7	452.6	21.15	22.398		
3,900.0	3,806.6	3,880.5	3,837.7	15.8	11.5	142.99	-207.9	-458.4	486.6	464.7	21.83	22.292		
4,000.0	3,903.7	3,979.6	3,935.4	16.3	11.8	142.78	-215.9	-473.7	499.4	476.9	22.50	22.193 SF		

# Anticollision Report

<b>Company:</b>	EnCana Oil & Gas (USA) Inc	<b>Local Co-ordinate Reference:</b>	Well Billings 3H-18H
<b>Project:</b>	DJ Wattenberg	<b>TVD Reference:</b>	WELL @ 5158.0ft (Original Well Elev)
<b>Reference Site:</b>	S18-T3N-R68W (Billings)	<b>MD Reference:</b>	WELL @ 5158.0ft (Original Well Elev)
<b>Site Error:</b>	0.0ft	<b>North Reference:</b>	True
<b>Reference Well:</b>	Billings 3H-18H	<b>Survey Calculation Method:</b>	Minimum Curvature
<b>Well Error:</b>	0.0ft	<b>Output errors are at</b>	2.00 sigma
<b>Reference Wellbore</b>	Hz	<b>Database:</b>	USA EDM 5000 Multi Users DB
<b>Reference Design:</b>	Plan #1	<b>Offset TVD Reference:</b>	Offset Datum

Offset Design S18-T3N-R68W (Billings) - Billings 3F-18H - Hz - Plan #1													Offset Site Error:	0.0 ft
Survey Program: 0-MWD													Offset Well Error:	0.0 ft
Reference		Offset		Semi Major Axis			Distance					Warning		
Measured Depth (ft)	Vertical Depth (ft)	Measured Depth (ft)	Vertical Depth (ft)	Reference (ft)	Offset (ft)	Highside Toolface (°)	Offset Wellbore Centre +N/-S (ft)	+E/-W (ft)	Between Centres (ft)	Between Ellipses (ft)	Total Uncertainty Axis		Separation Factor	
0.0	0.0	0.0	0.0	0.0	0.0	0.00	21.9	0.0	21.9					
100.0	100.0	100.0	100.0	0.2	0.2	0.00	21.9	0.0	21.9	21.6	0.30	71.972		
200.0	200.0	200.0	200.0	0.3	0.3	0.00	21.9	0.0	21.9	21.2	0.65	33.484	CC, ES	
300.0	300.0	300.0	300.0	0.5	0.5	151.79	21.9	0.0	23.4	22.4	1.00	23.325		
400.0	399.8	399.8	399.8	0.7	0.7	156.80	21.9	0.0	28.1	26.7	1.35	20.770		
500.0	499.5	500.5	500.5	0.9	0.9	160.65	20.6	-1.3	34.8	33.1	1.71	20.413		
600.0	598.7	601.3	601.2	1.2	1.0	162.06	16.9	-5.1	42.0	40.0	2.07	20.345		
700.0	697.5	702.4	701.8	1.5	1.3	162.05	10.7	-11.4	49.6	47.2	2.44	20.336		
800.0	795.6	803.7	802.3	1.9	1.5	161.17	2.0	-20.3	57.5	54.7	2.84	20.277		
900.0	893.1	905.1	902.5	2.3	1.8	159.74	-9.2	-31.7	65.9	62.6	3.28	20.090		
1,000.0	990.2	1,006.8	1,002.3	2.7	2.2	157.40	-22.9	-45.7	72.7	68.9	3.79	19.165		
1,100.0	1,087.3	1,107.5	1,100.5	3.2	2.6	154.09	-38.6	-61.7	77.3	72.9	4.39	17.606		
1,200.0	1,184.4	1,207.3	1,197.7	3.6	3.0	151.03	-54.3	-77.7	81.9	76.9	5.05	16.239		
1,300.0	1,281.5	1,307.1	1,294.9	4.1	3.4	148.30	-70.0	-93.8	86.8	81.0	5.75	15.104		
1,400.0	1,378.6	1,406.9	1,392.2	4.5	3.8	145.86	-85.7	-109.8	91.8	85.3	6.48	14.163		
1,500.0	1,475.8	1,506.7	1,489.4	4.9	4.2	143.68	-101.4	-125.9	97.0	89.7	7.25	13.383		
1,600.0	1,572.9	1,606.5	1,586.7	5.4	4.6	141.73	-117.1	-141.9	102.3	94.2	8.03	12.732		
1,700.0	1,670.0	1,706.3	1,683.9	5.8	5.0	139.97	-132.8	-157.9	107.7	98.8	8.84	12.186		
1,800.0	1,767.1	1,806.1	1,781.2	6.3	5.5	138.37	-148.5	-174.0	113.2	103.5	9.65	11.724		
1,900.0	1,864.2	1,905.9	1,878.4	6.7	5.9	136.93	-164.2	-190.0	118.7	108.3	10.48	11.330		
2,000.0	1,961.4	2,005.7	1,975.7	7.2	6.3	135.62	-179.9	-206.1	124.4	113.1	11.32	10.992		
2,100.0	2,058.5	2,105.5	2,072.9	7.6	6.7	134.42	-195.6	-222.1	130.1	117.9	12.16	10.699		
2,200.0	2,155.6	2,205.3	2,170.1	8.1	7.2	133.32	-211.4	-238.1	135.8	122.8	13.00	10.445		
2,300.0	2,252.7	2,305.1	2,267.4	8.6	7.6	132.31	-227.1	-254.2	141.6	127.8	13.86	10.222		
2,400.0	2,349.8	2,404.9	2,364.6	9.0	8.0	131.38	-242.8	-270.2	147.5	132.8	14.71	10.025		
2,500.0	2,446.9	2,504.7	2,461.9	9.5	8.5	130.52	-258.5	-286.3	153.3	137.8	15.57	9.851		
2,600.0	2,544.1	2,604.5	2,559.1	9.9	8.9	129.73	-274.2	-302.3	159.3	142.8	16.43	9.695		
2,700.0	2,641.2	2,704.3	2,656.4	10.4	9.3	128.99	-289.9	-318.3	165.2	147.9	17.29	9.556		
2,800.0	2,738.3	2,804.1	2,753.6	10.8	9.8	128.30	-305.6	-334.4	171.1	153.0	18.15	9.430		
2,900.0	2,835.4	2,903.9	2,850.9	11.3	10.2	127.66	-321.3	-350.4	177.1	158.1	19.01	9.317		
3,000.0	2,932.5	3,003.7	2,948.1	11.7	10.6	127.06	-337.0	-366.5	183.1	163.3	19.88	9.214		
3,100.0	3,029.6	3,103.5	3,045.3	12.2	11.1	126.50	-352.7	-382.5	189.2	168.4	20.74	9.120		
3,200.0	3,126.8	3,203.3	3,142.6	12.6	11.5	125.98	-368.4	-398.5	195.2	173.6	21.61	9.035		
3,300.0	3,223.9	3,303.1	3,239.8	13.1	11.9	125.48	-384.1	-414.6	201.3	178.8	22.47	8.956		
3,400.0	3,321.0	3,402.9	3,337.1	13.5	12.3	125.02	-399.8	-430.6	207.3	184.0	23.34	8.884		
3,500.0	3,418.1	3,502.7	3,434.3	14.0	12.8	124.58	-415.6	-446.7	213.4	189.2	24.20	8.817		
3,600.0	3,515.2	3,602.5	3,531.6	14.4	13.2	124.17	-431.3	-462.7	219.5	194.4	25.07	8.756		
3,700.0	3,612.3	3,702.3	3,628.8	14.9	13.6	123.77	-447.0	-478.7	225.6	199.7	25.94	8.699		
3,800.0	3,709.5	3,802.1	3,726.0	15.3	14.1	123.40	-462.7	-494.8	231.7	204.9	26.80	8.646		
3,900.0	3,806.6	3,901.9	3,823.3	15.8	14.5	123.05	-478.4	-510.8	237.8	210.2	27.67	8.596		
4,000.0	3,903.7	4,001.8	3,920.5	16.3	14.9	122.72	-494.1	-526.9	244.0	215.4	28.53	8.550		
4,100.0	4,000.8	4,101.6	4,017.8	16.7	15.4	122.40	-509.8	-542.9	250.1	220.7	29.40	8.507		
4,200.0	4,097.9	4,201.4	4,115.0	17.2	15.8	122.09	-525.5	-558.9	256.3	226.0	30.27	8.466		
4,300.0	4,195.1	4,301.2	4,212.3	17.6	16.2	121.81	-541.2	-575.0	262.4	231.3	31.13	8.429		
4,400.0	4,292.2	4,401.0	4,309.5	18.1	16.7	121.53	-556.9	-591.0	268.6	236.6	32.00	8.393		
4,500.0	4,389.3	4,500.8	4,406.8	18.5	17.1	121.27	-572.6	-607.1	274.7	241.9	32.87	8.359		
4,600.0	4,486.4	4,600.6	4,504.0	19.0	17.5	121.02	-588.3	-623.1	280.9	247.2	33.73	8.328		
4,700.0	4,583.5	4,700.4	4,601.2	19.4	18.0	120.77	-604.0	-639.2	287.1	252.5	34.60	8.298		
4,800.0	4,680.6	4,800.2	4,698.5	19.9	18.4	120.54	-619.8	-655.2	293.3	257.8	35.47	8.269		
4,900.0	4,777.8	4,900.0	4,795.7	20.3	18.8	120.32	-635.5	-671.2	299.5	263.1	36.33	8.242		
5,000.0	4,874.9	4,999.8	4,893.0	20.8	19.3	120.11	-651.2	-687.3	305.6	268.5	37.20	8.217		
5,100.0	4,972.0	5,098.1	4,988.9	21.2	19.7	120.00	-666.3	-702.7	312.0	274.0	38.02	8.205	SF	

CC - Min centre to center distance or convergent point, SF - min separation factor, ES - min ellipse separation

# Anticollision Report

<b>Company:</b>	EnCana Oil & Gas (USA) Inc	<b>Local Co-ordinate Reference:</b>	Well Billings 3H-18H
<b>Project:</b>	DJ Wattenberg	<b>TVD Reference:</b>	WELL @ 5158.0ft (Original Well Elev)
<b>Reference Site:</b>	S18-T3N-R68W (Billings)	<b>MD Reference:</b>	WELL @ 5158.0ft (Original Well Elev)
<b>Site Error:</b>	0.0ft	<b>North Reference:</b>	True
<b>Reference Well:</b>	Billings 3H-18H	<b>Survey Calculation Method:</b>	Minimum Curvature
<b>Well Error:</b>	0.0ft	<b>Output errors are at</b>	2.00 sigma
<b>Reference Wellbore</b>	Hz	<b>Database:</b>	USA EDM 5000 Multi Users DB
<b>Reference Design:</b>	Plan #1	<b>Offset TVD Reference:</b>	Offset Datum

<b>Offset Design</b> S18-T3N-R68W (Billings) - Billings 3F-18H - Hz - Plan #1													<b>Offset Site Error:</b> 0.0 ft
Survey Program: 0-MWD													<b>Offset Well Error:</b> 0.0 ft
Reference		Offset		Semi Major Axis			Distance						Warning
Measured Depth (ft)	Vertical Depth (ft)	Measured Depth (ft)	Vertical Depth (ft)	Reference (ft)	Offset (ft)	Highside Toolface (°)	Offset Wellbore Centre +N/-S (ft)	+E/-W (ft)	Between Centres (ft)	Between Ellipses (ft)	Total Uncertainty Axis	Separation Factor	
5,200.0	5,069.1	5,195.0	5,084.0	21.7	20.0	120.40	-679.2	-715.9	319.1	280.4	38.66	8.253	
5,300.0	5,166.2	5,291.5	5,179.3	22.1	20.3	121.34	-689.8	-726.7	327.2	288.1	39.12	8.363	
5,400.0	5,263.3	5,387.4	5,274.5	22.6	20.5	122.75	-698.1	-735.2	336.4	297.0	39.40	8.538	
5,500.0	5,360.5	5,482.5	5,369.2	23.1	20.7	124.58	-704.2	-741.4	346.9	307.4	39.48	8.786	
5,600.0	5,457.6	5,576.7	5,463.2	23.5	20.8	126.74	-708.0	-745.3	359.0	319.6	39.37	9.117	
5,700.0	5,554.7	5,669.6	5,556.1	24.0	20.9	129.17	-709.6	-746.9	372.9	333.8	39.09	9.540	
5,800.0	5,651.8	5,765.3	5,651.8	24.4	21.0	131.80	-709.7	-747.0	388.6	349.9	38.66	10.051	
5,900.0	5,748.9	5,862.5	5,748.9	24.9	21.1	134.28	-709.7	-747.0	405.1	366.9	38.22	10.598	
6,000.0	5,846.1	5,959.6	5,846.1	25.3	21.2	136.56	-709.7	-747.0	422.3	384.5	37.80	11.173	
6,100.0	5,943.2	6,056.7	5,943.2	25.8	21.3	138.67	-709.7	-747.0	440.2	402.8	37.40	11.769	
6,200.0	6,040.3	6,153.8	6,040.3	26.2	21.3	140.61	-709.7	-747.0	458.5	421.5	37.03	12.384	
6,300.0	6,137.4	6,250.9	6,137.4	26.7	21.4	142.41	-709.7	-747.0	477.4	440.7	36.68	13.014	
6,400.0	6,234.5	6,348.0	6,234.5	27.1	21.5	144.07	-709.7	-747.0	496.7	460.3	36.37	13.656	

# Anticollision Report

<b>Company:</b>	EnCana Oil & Gas (USA) Inc	<b>Local Co-ordinate Reference:</b>	Well Billings 3H-18H
<b>Project:</b>	DJ Wattenberg	<b>TVD Reference:</b>	WELL @ 5158.0ft (Original Well Elev)
<b>Reference Site:</b>	S18-T3N-R68W (Billings)	<b>MD Reference:</b>	WELL @ 5158.0ft (Original Well Elev)
<b>Site Error:</b>	0.0ft	<b>North Reference:</b>	True
<b>Reference Well:</b>	Billings 3H-18H	<b>Survey Calculation Method:</b>	Minimum Curvature
<b>Well Error:</b>	0.0ft	<b>Output errors are at</b>	2.00 sigma
<b>Reference Wellbore</b>	Hz	<b>Database:</b>	USA EDM 5000 Multi Users DB
<b>Reference Design:</b>	Plan #1	<b>Offset TVD Reference:</b>	Offset Datum

Offset Design S18-T3N-R68W (Billings) - Billings 3G-18H - Hz - Plan #1													Offset Site Error:	0.0 ft
Survey Program: 0-MWD													Offset Well Error:	0.0 ft
Reference		Offset		Semi Major Axis		Distance		Total		Separation		Warning		
Measured Depth (ft)	Vertical Depth (ft)	Measured Depth (ft)	Vertical Depth (ft)	Reference (ft)	Offset (ft)	Highside Toolface (°)	Offset Wellbore Centre +N/-S (ft)	+E/-W (ft)	Between Centres (ft)	Between Ellipses (ft)	Uncertainty Axis			
0.0	0.0	1.0	1.0	0.0	0.0	0.00	10.9	0.0	10.9					
100.0	100.0	101.0	101.0	0.2	0.2	0.00	10.9	0.0	10.9	10.6	0.31	35.781		
200.0	200.0	201.0	201.0	0.3	0.3	0.00	10.9	0.0	10.9	10.3	0.65	16.698 CC, ES		
300.0	300.0	301.0	301.0	0.5	0.5	153.68	10.9	0.0	12.5	11.5	1.00	12.416		
400.0	399.8	401.3	401.2	0.7	0.7	160.45	10.4	-0.4	16.7	15.3	1.35	12.321		
500.0	499.5	502.1	501.9	0.9	0.9	162.56	6.0	-3.5	20.1	18.4	1.71	11.742		
600.0	598.7	603.1	602.4	1.2	1.1	161.69	-2.8	-9.6	21.9	19.8	2.08	10.540		
700.0	697.5	704.2	702.1	1.5	1.4	158.40	-15.9	-18.8	22.2	19.7	2.48	8.938		
800.0	795.6	805.1	800.8	1.9	1.8	152.14	-33.3	-31.0	21.2	18.2	3.00	7.061		
868.2	862.2	873.4	867.1	2.2	2.1	146.80	-46.8	-40.4	20.5	17.0	3.45	5.943		
900.0	893.1	905.2	897.9	2.3	2.2	145.23	-53.1	-44.8	20.8	17.1	3.66	5.675		
1,000.0	990.2	1,005.2	995.0	2.7	2.6	140.55	-72.9	-58.7	21.7	17.3	4.39	4.944		
1,100.0	1,087.3	1,105.2	1,092.0	3.2	3.1	136.29	-92.7	-72.6	22.8	17.6	5.20	4.385		
1,200.0	1,184.4	1,205.2	1,189.0	3.6	3.5	132.43	-112.5	-86.4	24.0	17.9	6.06	3.958		
1,300.0	1,281.5	1,305.1	1,286.0	4.1	4.0	128.96	-132.3	-100.3	25.3	18.3	6.97	3.631		
1,400.0	1,378.6	1,405.1	1,383.0	4.5	4.4	125.83	-152.2	-114.2	26.7	18.8	7.90	3.379		
1,500.0	1,475.8	1,505.1	1,480.0	4.9	4.9	123.02	-172.0	-128.1	28.1	19.3	8.84	3.181		
1,600.0	1,572.9	1,605.1	1,577.0	5.4	5.3	120.49	-191.8	-141.9	29.6	19.8	9.80	3.025		
1,700.0	1,670.0	1,705.1	1,674.0	5.8	5.8	118.21	-211.6	-155.8	31.2	20.4	10.76	2.899		
1,800.0	1,767.1	1,805.0	1,771.0	6.3	6.2	116.15	-231.4	-169.7	32.8	21.1	11.73	2.798		
1,900.0	1,864.2	1,905.0	1,868.1	6.7	6.7	114.28	-251.2	-183.6	34.5	21.8	12.70	2.714		
2,000.0	1,961.4	2,005.0	1,965.1	7.2	7.2	112.59	-271.0	-197.4	36.1	22.5	13.66	2.645		
2,100.0	2,058.5	2,105.0	2,062.1	7.6	7.6	111.05	-290.8	-211.3	37.9	23.2	14.63	2.588		
2,200.0	2,155.6	2,205.0	2,159.1	8.1	8.1	109.64	-310.7	-225.2	39.6	24.0	15.59	2.539		
2,300.0	2,252.7	2,304.9	2,256.1	8.6	8.5	108.35	-330.5	-239.1	41.3	24.8	16.55	2.498		
2,400.0	2,349.8	2,404.9	2,353.1	9.0	9.0	107.17	-350.3	-252.9	43.1	25.6	17.51	2.463		
2,500.0	2,446.9	2,504.9	2,450.1	9.5	9.4	106.08	-370.1	-266.8	44.9	26.5	18.46	2.433		
2,600.0	2,544.1	2,604.9	2,547.1	9.9	9.9	105.07	-389.9	-280.7	46.7	27.3	19.41	2.407		
2,700.0	2,641.2	2,704.9	2,644.1	10.4	10.4	104.14	-409.7	-294.5	48.5	28.2	20.36	2.384		
2,800.0	2,738.3	2,804.8	2,741.2	10.8	10.8	103.28	-429.5	-308.4	50.4	29.1	21.30	2.364		
2,900.0	2,835.4	2,904.8	2,838.2	11.3	11.3	102.48	-449.4	-322.3	52.2	30.0	22.25	2.347		
3,000.0	2,932.5	3,004.8	2,935.2	11.7	11.7	101.73	-469.2	-336.2	54.1	30.9	23.19	2.332		
3,100.0	3,029.6	3,104.8	3,032.2	12.2	12.2	101.03	-489.0	-350.0	55.9	31.8	24.13	2.318		
3,200.0	3,126.8	3,204.8	3,129.2	12.6	12.7	100.38	-508.8	-363.9	57.8	32.7	25.06	2.306		
3,300.0	3,223.9	3,304.7	3,226.2	13.1	13.1	99.77	-528.6	-377.8	59.7	33.7	26.00	2.295		
3,400.0	3,321.0	3,404.7	3,323.2	13.5	13.6	99.19	-548.4	-391.7	61.6	34.6	26.93	2.286		
3,500.0	3,418.1	3,504.7	3,420.2	14.0	14.0	98.65	-568.2	-405.5	63.4	35.6	27.86	2.277		
3,600.0	3,515.2	3,604.7	3,517.2	14.4	14.5	98.14	-588.0	-419.4	65.3	36.5	28.79	2.269		
3,700.0	3,612.3	3,704.7	3,614.2	14.9	15.0	97.66	-607.9	-433.3	67.2	37.5	29.72	2.262		
3,800.0	3,709.5	3,804.6	3,711.3	15.3	15.4	97.21	-627.7	-447.2	69.1	38.5	30.65	2.256		
3,900.0	3,806.6	3,904.6	3,808.3	15.8	15.9	96.78	-647.5	-461.0	71.0	39.5	31.57	2.250		
4,000.0	3,903.7	4,004.6	3,905.3	16.3	16.3	96.37	-667.3	-474.9	73.0	40.5	32.50	2.245		
4,100.0	4,000.8	4,104.6	4,002.3	16.7	16.8	95.99	-687.1	-488.8	74.9	41.5	33.42	2.240		
4,200.0	4,097.9	4,204.6	4,099.3	17.2	17.3	95.62	-706.9	-502.6	76.8	42.4	34.34	2.236		
4,300.0	4,195.1	4,304.5	4,196.3	17.6	17.7	95.27	-726.7	-516.5	78.7	43.4	35.26	2.232		
4,400.0	4,292.2	4,404.5	4,293.3	18.1	18.2	94.94	-746.6	-530.4	80.6	44.5	36.18	2.228		
4,500.0	4,389.3	4,504.5	4,390.3	18.5	18.6	94.62	-766.4	-544.3	82.6	45.5	37.10	2.225		
4,600.0	4,486.4	4,604.5	4,487.3	19.0	19.1	94.32	-786.2	-558.1	84.5	46.5	38.02	2.222		
4,700.0	4,583.5	4,704.5	4,584.4	19.4	19.6	94.03	-806.0	-572.0	86.4	47.5	38.94	2.219		
4,800.0	4,680.6	4,804.4	4,681.4	19.9	20.0	93.76	-825.8	-585.9	88.4	48.5	39.86	2.217		
4,900.0	4,777.8	4,904.4	4,778.4	20.3	20.5	93.49	-845.6	-599.8	90.3	49.5	40.77	2.214		
5,000.0	4,874.9	5,004.4	4,875.4	20.8	20.9	93.24	-865.4	-613.6	92.2	50.5	41.69	2.212		

CC - Min centre to center distance or convergent point, SF - min separation factor, ES - min ellipse separation



# Anticollision Report

<b>Company:</b>	EnCana Oil & Gas (USA) Inc	<b>Local Co-ordinate Reference:</b>	Well Billings 3H-18H
<b>Project:</b>	DJ Wattenberg	<b>TVD Reference:</b>	WELL @ 5158.0ft (Original Well Elev)
<b>Reference Site:</b>	S18-T3N-R68W (Billings)	<b>MD Reference:</b>	WELL @ 5158.0ft (Original Well Elev)
<b>Site Error:</b>	0.0ft	<b>North Reference:</b>	True
<b>Reference Well:</b>	Billings 3H-18H	<b>Survey Calculation Method:</b>	Minimum Curvature
<b>Well Error:</b>	0.0ft	<b>Output errors are at</b>	2.00 sigma
<b>Reference Wellbore</b>	Hz	<b>Database:</b>	USA EDM 5000 Multi Users DB
<b>Reference Design:</b>	Plan #1	<b>Offset TVD Reference:</b>	Offset Datum

Offset Design S18-T3N-R68W (Billings) - Billings 3G-18H - Hz - Plan #1													Offset Site Error:	0.0 ft
Survey Program: 0-MWD													Offset Well Error:	0.0 ft
Reference		Offset		Semi Major Axis			Distance				Total Uncertainty Axis	Separation Factor	Warning	
Measured Depth (ft)	Vertical Depth (ft)	Measured Depth (ft)	Vertical Depth (ft)	Reference (ft)	Offset (ft)	Highside Toolface (°)	Offset Wellbore Centre +N/-S (ft)	+E/-W (ft)	Between Centres (ft)	Between Ellipses (ft)				
5,100.0	4,972.0	5,104.4	4,972.4	21.2	21.4	92.99	-885.2	-627.5	94.2	51.6	42.60	2.210		
5,200.0	5,069.1	5,204.4	5,069.4	21.7	21.9	92.76	-905.1	-641.4	96.1	52.6	43.52	2.208		
5,300.0	5,166.2	5,304.3	5,166.4	22.1	22.3	92.54	-924.9	-655.3	98.0	53.6	44.43	2.207		
5,400.0	5,263.3	5,404.3	5,263.4	22.6	22.8	92.32	-944.7	-669.1	100.0	54.6	45.35	2.205		
5,500.0	5,360.5	5,504.3	5,360.4	23.1	23.2	92.12	-964.5	-683.0	101.9	55.7	46.26	2.203		
5,600.0	5,457.6	5,604.3	5,457.4	23.5	23.7	91.92	-984.3	-696.9	103.9	56.7	47.17	2.202		
5,700.0	5,554.7	5,704.3	5,554.5	24.0	24.2	91.72	-1,004.1	-710.7	105.8	57.7	48.09	2.201		
5,800.0	5,651.8	5,804.4	5,651.8	24.4	24.6	92.00	-1,023.3	-724.2	107.7	58.8	48.97	2.200		
5,900.0	5,748.9	5,904.4	5,750.0	24.9	24.9	94.76	-1,038.6	-734.9	109.6	59.8	49.71	2.204		
6,000.0	5,846.1	6,003.5	5,848.2	25.3	25.2	100.04	-1,049.6	-742.6	112.0	61.9	50.07	2.237		
6,100.0	5,943.2	6,101.4	5,945.7	25.8	25.3	107.41	-1,056.3	-747.3	116.4	66.8	49.60	2.348		
6,200.0	6,040.3	6,197.4	6,041.7	26.2	25.4	116.13	-1,058.9	-749.1	124.5	76.5	47.98	2.595		
6,300.0	6,137.4	6,294.1	6,138.4	26.7	25.5	124.89	-1,059.0	-749.2	136.9	91.4	45.45	3.011		
6,400.0	6,234.5	6,391.2	6,235.5	27.1	25.6	132.17	-1,059.0	-749.2	152.0	109.2	42.83	3.550		
6,500.0	6,331.6	6,490.3	6,334.6	27.6	25.6	138.67	-1,059.0	-747.7	168.9	128.8	40.09	4.213		
6,600.0	6,428.8	6,587.5	6,430.8	28.0	25.5	147.81	-1,059.0	-735.0	186.9	151.1	35.78	5.223		
6,700.0	6,526.4	6,679.3	6,519.4	28.4	25.4	-167.32	-1,059.0	-711.1	208.9	178.4	30.53	6.843		
6,800.0	6,623.8	6,768.0	6,601.4	28.7	25.1	-127.73	-1,059.0	-677.4	234.2	207.3	26.89	8.709		
6,900.0	6,718.9	6,854.2	6,676.5	28.8	24.8	-103.88	-1,059.0	-635.2	260.7	235.7	24.95	10.446		
7,000.0	6,810.1	6,938.3	6,744.4	28.9	24.5	-89.55	-1,059.0	-585.6	287.0	262.7	24.24	11.841		
7,100.0	6,895.5	7,020.8	6,804.9	28.8	24.1	-80.14	-1,059.0	-529.6	312.0	287.9	24.15	12.922		
7,200.0	6,973.4	7,100.0	6,856.6	28.8	23.8	-73.58	-1,059.0	-469.7	335.1	310.9	24.26	13.813		
7,300.0	7,042.3	7,182.0	6,902.8	28.6	23.5	-68.76	-1,059.0	-401.9	355.6	331.1	24.45	14.542		
7,400.0	7,100.9	7,261.2	6,939.7	28.5	23.2	-65.24	-1,059.0	-331.9	373.1	348.4	24.65	15.133		
7,500.0	7,148.0	7,339.8	6,968.6	28.4	23.1	-62.67	-1,059.0	-258.8	387.2	362.2	24.96	15.513		
7,600.0	7,182.8	7,417.9	6,989.1	28.3	22.9	-60.88	-1,059.0	-183.5	397.7	372.2	25.49	15.603		
7,700.0	7,204.5	7,500.0	7,001.7	28.4	22.9	-59.72	-1,059.0	-102.5	404.5	378.2	26.34	15.357		
7,800.0	7,212.8	7,577.8	7,005.4	28.5	23.0	-59.22	-1,059.0	-24.8	407.2	379.7	27.53	14.791		
7,900.0	7,214.5	7,677.8	7,007.1	28.7	23.4	-59.22	-1,059.0	75.2	407.2	377.5	29.77	13.681		
8,000.0	7,216.3	7,777.8	7,008.9	29.2	24.0	-59.22	-1,059.0	175.2	407.2	374.8	32.39	12.571		
8,100.0	7,218.0	7,877.8	7,010.6	29.9	25.0	-59.22	-1,059.0	275.2	407.2	371.9	35.34	11.523		
8,200.0	7,219.7	7,977.8	7,012.4	30.7	26.3	-59.22	-1,059.0	375.2	407.2	368.7	38.53	10.569		
8,300.0	7,221.5	8,077.8	7,014.1	31.8	27.8	-59.22	-1,059.0	475.2	407.2	365.3	41.91	9.716		
8,400.0	7,223.2	8,177.8	7,015.8	33.2	29.5	-59.22	-1,059.0	575.1	407.2	361.8	45.44	8.961		
8,500.0	7,225.0	8,277.8	7,017.6	34.6	31.3	-59.22	-1,059.0	675.1	407.2	358.1	49.09	8.296		
8,600.0	7,226.7	8,377.8	7,019.3	36.3	33.3	-59.22	-1,059.0	775.1	407.2	354.4	52.82	7.709		
8,700.0	7,228.5	8,477.8	7,021.1	38.0	35.3	-59.22	-1,059.0	875.1	407.2	350.6	56.63	7.191		
8,800.0	7,230.2	8,577.8	7,022.8	39.9	37.4	-59.22	-1,059.0	975.1	407.2	346.7	60.50	6.731		
8,900.0	7,232.0	8,677.8	7,024.6	41.9	39.5	-59.22	-1,059.0	1,075.1	407.2	342.8	64.42	6.322		
9,000.0	7,233.7	8,777.8	7,026.3	43.9	41.7	-59.22	-1,059.0	1,175.1	407.2	338.8	68.37	5.956		
9,100.0	7,235.4	8,877.8	7,028.1	45.9	43.9	-59.21	-1,059.0	1,275.0	407.2	334.8	72.37	5.627		
9,200.0	7,237.2	8,977.8	7,029.8	48.0	46.1	-59.21	-1,059.0	1,375.0	407.2	330.8	76.39	5.331		
9,300.0	7,238.9	9,077.8	7,031.6	50.2	48.4	-59.21	-1,059.0	1,475.0	407.2	326.8	80.43	5.063		
9,400.0	7,240.7	9,177.8	7,033.3	52.4	50.6	-59.21	-1,059.0	1,575.0	407.2	322.7	84.50	4.819		
9,500.0	7,242.4	9,277.8	7,035.0	54.6	52.9	-59.21	-1,059.0	1,675.0	407.2	318.6	88.58	4.597		
9,600.0	7,244.2	9,377.8	7,036.8	56.8	55.2	-59.21	-1,059.1	1,775.0	407.2	314.5	92.68	4.394		
9,700.0	7,245.9	9,477.8	7,038.5	59.1	57.6	-59.21	-1,059.1	1,874.9	407.2	310.4	96.79	4.207		
9,800.0	7,247.7	9,577.8	7,040.3	61.3	59.9	-59.21	-1,059.1	1,974.9	407.2	306.3	100.91	4.035		
9,900.0	7,249.4	9,677.8	7,042.0	63.6	62.2	-59.21	-1,059.1	2,074.9	407.2	302.1	105.05	3.876		
10,000.0	7,251.2	9,777.8	7,043.8	65.9	64.6	-59.21	-1,059.1	2,174.9	407.2	298.0	109.19	3.729		
10,100.0	7,252.9	9,877.8	7,045.5	68.2	67.0	-59.21	-1,059.1	2,274.9	407.2	293.8	113.34	3.593		
10,200.0	7,254.6	9,977.8	7,047.3	70.5	69.3	-59.21	-1,059.1	2,374.9	407.2	289.7	117.50	3.465		

CC - Min centre to center distance or convergent point, SF - min separation factor, ES - min ellipse separation

# Anticollision Report

<b>Company:</b>	EnCana Oil & Gas (USA) Inc	<b>Local Co-ordinate Reference:</b>	Well Billings 3H-18H
<b>Project:</b>	DJ Wattenberg	<b>TVD Reference:</b>	WELL @ 5158.0ft (Original Well Elev)
<b>Reference Site:</b>	S18-T3N-R68W (Billings)	<b>MD Reference:</b>	WELL @ 5158.0ft (Original Well Elev)
<b>Site Error:</b>	0.0ft	<b>North Reference:</b>	True
<b>Reference Well:</b>	Billings 3H-18H	<b>Survey Calculation Method:</b>	Minimum Curvature
<b>Well Error:</b>	0.0ft	<b>Output errors are at</b>	2.00 sigma
<b>Reference Wellbore</b>	Hz	<b>Database:</b>	USA EDM 5000 Multi Users DB
<b>Reference Design:</b>	Plan #1	<b>Offset TVD Reference:</b>	Offset Datum

Offset Design S18-T3N-R68W (Billings) - Billings 3G-18H - Hz - Plan #1												Offset Site Error:	0.0 ft
Survey Program: 0-MWD												Offset Well Error:	0.0 ft
Reference		Offset		Semi Major Axis			Distance				Total Uncertainty Axis	Separation Factor	Warning
Measured Depth (ft)	Vertical Depth (ft)	Measured Depth (ft)	Vertical Depth (ft)	Reference (ft)	Offset (ft)	Highside Toolface (°)	Offset Wellbore Centre +N/-S (ft)	+E/-W (ft)	Between Centres (ft)	Between Ellipses (ft)			
10,300.0	7,256.4	10,077.8	7,049.0	72.9	71.7	-59.21	-1,059.1	2,474.9	407.2	285.5	121.67	3.347	
10,400.0	7,258.1	10,177.8	7,050.8	75.2	74.1	-59.21	-1,059.1	2,574.8	407.2	281.3	125.84	3.236	
10,500.0	7,259.9	10,277.8	7,052.5	77.6	76.5	-59.21	-1,059.1	2,674.8	407.2	277.2	130.02	3.132	
10,600.0	7,261.6	10,377.8	7,054.2	79.9	78.9	-59.21	-1,059.1	2,774.8	407.2	273.0	134.20	3.034	
10,700.0	7,263.4	10,477.8	7,056.0	82.3	81.3	-59.21	-1,059.1	2,874.8	407.2	268.8	138.38	2.942	
10,800.0	7,265.1	10,577.8	7,057.7	84.7	83.7	-59.21	-1,059.1	2,974.8	407.2	264.6	142.57	2.856	
10,900.0	7,266.9	10,677.8	7,059.5	87.0	86.1	-59.21	-1,059.1	3,074.8	407.2	260.4	146.77	2.774	
11,000.0	7,268.6	10,777.8	7,061.2	89.4	88.5	-59.21	-1,059.1	3,174.7	407.2	256.2	150.97	2.697	
11,100.0	7,270.4	10,877.8	7,063.0	91.8	90.9	-59.21	-1,059.1	3,274.7	407.2	252.0	155.17	2.624	
11,200.0	7,272.1	10,977.8	7,064.7	94.2	93.3	-59.21	-1,059.1	3,374.7	407.2	247.8	159.37	2.555	
11,300.0	7,273.8	11,077.8	7,066.5	96.6	95.7	-59.21	-1,059.1	3,474.7	407.2	243.6	163.58	2.489	
11,400.0	7,275.6	11,177.8	7,068.2	99.0	98.2	-59.21	-1,059.1	3,574.7	407.2	239.4	167.78	2.427	
11,500.0	7,277.3	11,277.8	7,069.9	101.4	100.6	-59.21	-1,059.1	3,674.7	407.2	235.2	172.00	2.367	
11,600.0	7,279.1	11,377.8	7,071.7	103.8	103.0	-59.21	-1,059.1	3,774.7	407.2	231.0	176.21	2.311	
11,700.0	7,280.8	11,477.8	7,073.4	106.2	105.4	-59.21	-1,059.1	3,874.6	407.2	226.7	180.42	2.257	
11,800.0	7,282.6	11,577.8	7,075.2	108.6	107.9	-59.21	-1,059.1	3,974.6	407.2	222.5	184.64	2.205	
11,900.0	7,284.3	11,677.8	7,076.9	111.0	110.3	-59.21	-1,059.1	4,074.6	407.2	218.3	188.86	2.156	
12,000.0	7,286.1	11,777.8	7,078.7	113.5	112.7	-59.21	-1,059.1	4,174.6	407.2	214.1	193.08	2.109	
12,100.0	7,287.8	11,877.8	7,080.4	115.9	115.2	-59.21	-1,059.1	4,274.6	407.2	209.9	197.30	2.064	
12,200.0	7,289.6	11,977.8	7,082.2	118.3	117.6	-59.21	-1,059.1	4,374.6	407.2	205.6	201.52	2.020	
12,300.0	7,291.3	12,077.8	7,083.9	120.7	120.1	-59.21	-1,059.1	4,474.5	407.1	201.4	205.75	1.979	
12,400.0	7,293.0	12,177.8	7,085.7	123.1	122.5	-59.21	-1,059.1	4,574.5	407.1	197.2	209.97	1.939	
12,500.0	7,294.8	12,277.8	7,087.4	125.6	124.9	-59.21	-1,059.1	4,674.5	407.1	192.9	214.20	1.901	
12,600.0	7,296.5	12,377.8	7,089.1	128.0	127.4	-59.21	-1,059.1	4,774.5	407.1	188.7	218.43	1.864	
12,700.0	7,298.3	12,477.8	7,090.9	130.4	129.8	-59.21	-1,059.1	4,874.5	407.1	184.5	222.66	1.829	
12,800.0	7,300.0	12,577.8	7,092.6	132.9	132.3	-59.21	-1,059.1	4,974.5	407.1	180.3	226.89	1.794	
12,900.0	7,301.8	12,677.8	7,094.4	135.3	134.7	-59.21	-1,059.1	5,074.5	407.1	176.0	231.12	1.762	
13,000.0	7,303.5	12,777.8	7,096.1	137.7	137.2	-59.21	-1,059.1	5,174.4	407.1	171.8	235.35	1.730	
13,100.0	7,305.3	12,877.8	7,097.9	140.2	139.6	-59.21	-1,059.1	5,274.4	407.1	167.6	239.58	1.699	
13,200.0	7,307.0	12,977.8	7,099.6	142.6	142.1	-59.21	-1,059.1	5,374.4	407.1	163.3	243.81	1.670	
13,300.0	7,308.7	13,077.8	7,101.4	145.0	144.5	-59.21	-1,059.1	5,474.4	407.1	159.1	248.05	1.641	
13,400.0	7,310.5	13,177.8	7,103.1	147.5	147.0	-59.21	-1,059.1	5,574.4	407.1	154.8	252.28	1.614	
13,500.0	7,312.2	13,277.8	7,104.9	149.9	149.4	-59.21	-1,059.1	5,674.4	407.1	150.6	256.52	1.587	
13,600.0	7,314.0	13,377.8	7,106.6	152.4	151.9	-59.21	-1,059.1	5,774.4	407.1	146.4	260.75	1.561	
13,700.0	7,315.7	13,477.8	7,108.3	154.8	154.3	-59.21	-1,059.1	5,874.3	407.1	142.1	264.99	1.536	
13,800.0	7,317.5	13,577.8	7,110.1	157.3	156.8	-59.21	-1,059.1	5,974.3	407.1	137.9	269.22	1.512	
13,900.0	7,319.2	13,677.8	7,111.8	159.7	159.2	-59.21	-1,059.1	6,074.3	407.1	133.7	273.46	1.489 Level 3	
14,000.0	7,321.0	13,777.8	7,113.6	162.2	161.7	-59.21	-1,059.1	6,174.3	407.1	129.4	277.70	1.466 Level 3	
14,100.0	7,322.7	13,877.8	7,115.3	164.6	164.1	-59.21	-1,059.1	6,274.3	407.1	125.2	281.94	1.444 Level 3	
14,200.0	7,324.5	13,977.8	7,117.1	167.0	166.6	-59.21	-1,059.2	6,374.3	407.1	120.9	286.18	1.423 Level 3	
14,300.0	7,326.2	14,077.8	7,118.8	169.5	169.0	-59.21	-1,059.2	6,474.2	407.1	116.7	290.42	1.402 Level 3	
14,400.0	7,327.9	14,177.8	7,120.6	171.9	171.5	-59.21	-1,059.2	6,574.2	407.1	112.5	294.65	1.382 Level 3	
14,500.0	7,329.7	14,277.8	7,122.3	174.4	174.0	-59.21	-1,059.2	6,674.2	407.1	108.2	298.89	1.362 Level 3	
14,511.1	7,329.9	14,288.9	7,122.5	174.7	174.2	-59.21	-1,059.2	6,685.3	407.1	107.7	299.37	1.360 Level 3	
14,517.6	7,330.0	14,289.4	7,122.5	174.8	174.2	-59.21	-1,059.2	6,685.8	407.2	107.6	299.51	1.359 Level 3, SF	

## Anticollision Report

<b>Company:</b>	EnCana Oil & Gas (USA) Inc	<b>Local Co-ordinate Reference:</b>	Well Billings 3H-18H
<b>Project:</b>	DJ Wattenberg	<b>TVD Reference:</b>	WELL @ 5158.0ft (Original Well Elev)
<b>Reference Site:</b>	S18-T3N-R68W (Billings)	<b>MD Reference:</b>	WELL @ 5158.0ft (Original Well Elev)
<b>Site Error:</b>	0.0ft	<b>North Reference:</b>	True
<b>Reference Well:</b>	Billings 3H-18H	<b>Survey Calculation Method:</b>	Minimum Curvature
<b>Well Error:</b>	0.0ft	<b>Output errors are at</b>	2.00 sigma
<b>Reference Wellbore</b>	Hz	<b>Database:</b>	USA EDM 5000 Multi Users DB
<b>Reference Design:</b>	Plan #1	<b>Offset TVD Reference:</b>	Offset Datum

Reference Depths are relative to WELL @ 5158.0ft (Original Well Elev)

Offset Depths are relative to Offset Datum

Central Meridian is -105.500000 °

Coordinates are relative to: Billings 3H-18H

Coordinate System is US State Plane 1983, Colorado Northern Zone

Grid Convergence at Surface is: 0.29°

