

LEGEND:

- STABILIZED CONSTRUCTION ENTRANCE
- SLASH
- VEGETATED BUFFER
- WATTLE

ELEV. AT PAD EXPANSION CORNERS VARIES = 8104.1' AVERAGE

UNTAIN ENGINEERING & LAND SURVEYING
85 So. 200 East • Vernal, Utah 84078 • (435) 789-1017

NOTE:
2' CONTOUR INTERVAL.

UINTAH ENGINEERING & LAND SURVEYING
85 So. 200 East * Vernal, Utah 84078 * (435) 789-1017

1" = 40'
X-Section
Scale
1" = 100'

DATE: 08-10-10
DRAWN BY: D.R.B.
Revised: 05-31-11 D.R.B.
Revised: 07-12-11 D.R.B.
Revised: 07-19-11 D.R.B.
Revised: 08-10-11 D.R.B.
Revised: 07-20-12 T.B.
Revised: 08-16-12 M.D.
Revised: 08-28-12 M.D.
Revised: 09-11-12 P.M.B.
Revised: 09-29-12 M.D.

Encana OIL & GAS (USA) INC.
CONSTRUCTION LAYOUT CROSS SECTION FOR
WELL PAD SG L27 496
SECTION 27, T4S, R96W, 6th P.M.
NW 1/4 SW 1/4

Sheet 4 of 10

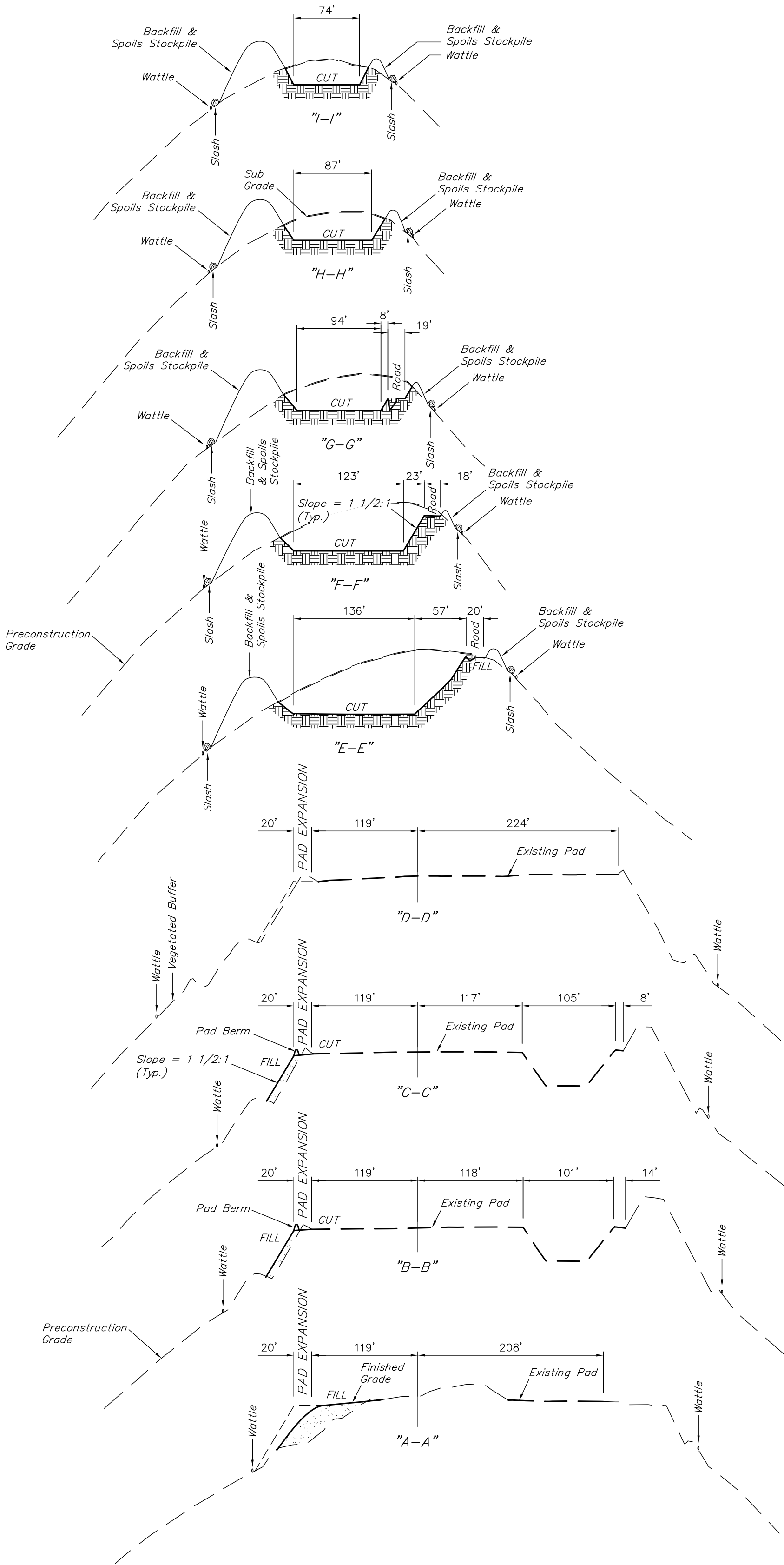

NOTE:
Topsoil should not be
Stripped Below Finished
Grade on Substructure Area.

* NOTE:
FILL QUANTITY INCLUDES
5% FOR COMPACTION

PAD EXPANSION
APPROXIMATE YARDAGES

(6") Topsoil Stripping	=	110 Cu. Yds.
Remaining Location	=	270 Cu. Yds.
TOTAL CUT	=	380 CU.YDS.
FILL	=	5,140 CU.YDS.

DEFICIT MATERIAL	=	<4,760> Cu. Yds.
Topsoil	=	110 Cu. Yds.
DEFICIT UNBALANCE (After Interim Rehabilitation)	=	<4,870> Cu. Yds.

CUTTINGS AREA
APPROXIMATE YARDAGES

(12") Topsoil Stripping	=	2,850 Cu. Yds.
Remaining Location	=	36,890 Cu. Yds.
TOTAL CUT	=	39,740 CU.YDS.
FILL	=	0 CU.YDS.

EXCESS MATERIAL	=	39,740 Cu. Yds.
Topsoil	=	2,850 Cu. Yds.
EXCESS UNBALANCE (After Interim Rehabilitation)	=	36,890 Cu. Yds.

Encana OIL & GAS (USA) INC.

PRODUCTION SCHEMATIC FOR
WELL PAD SGL27496;

SECTION 27, T4S, R96W, 6th P.M.
NW 1/4 SW 1/4

100' 50' 0' 100'
SCALE
Sheet 5 of 10

DATE: 09-29-12
DRAWN BY: M.D.



SUMP LEGEND:
FCD - FLOW CONTROL DITCH
RV - REVEGATION
ST - SEDIMENT TRAP

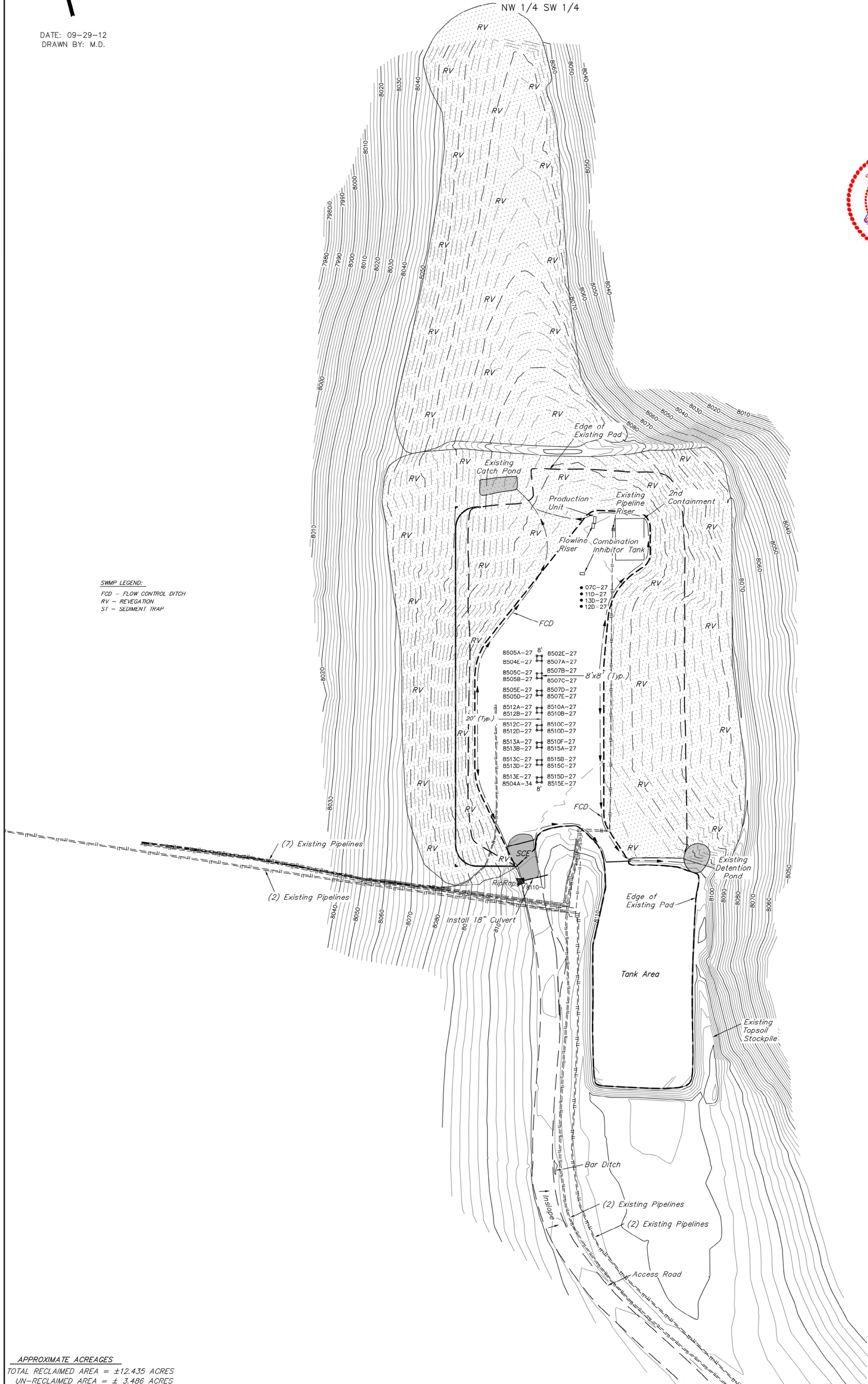

APPROXIMATE ACREAGES

TOTAL RECLAIMED AREA = ±12.435 ACRES
UN-RECLAIMED AREA = ± 3.486 ACRES

UINTAH ENGINEERING & LAND SURVEYING
85 So. 200 East • Vernal, Utah 84078 • (435) 789-1017