

SHABLE FEDERAL LB29-62HN

NOBLE ENERGY, INC.

LOCATION DRAWING

DATE: 09-10-12
DRAWN BY: J.M.H.

SHABLE FEDERAL LB29-62HN,
LB33-78HN & SHABLE LB32-68HN
SECTION 33, T9N, R60W, 6th P.M.

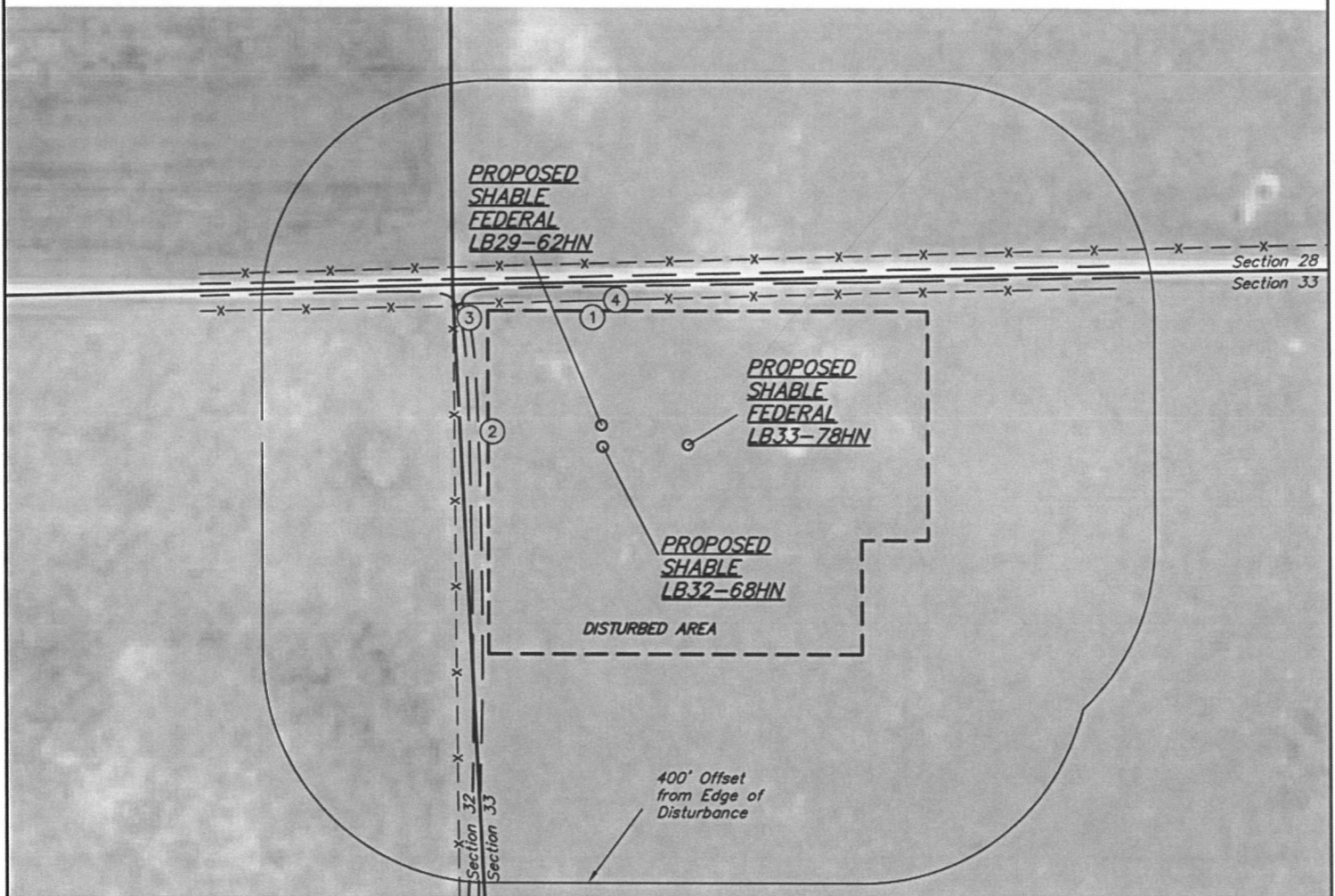
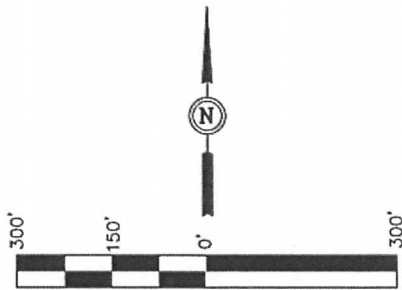

NOTE:

DIRECTION AND DISTANCE TO IMPROVEMENTS AND NEAREST FEATURES ARE FROM PROPOSED SHABLE FEDERAL LB29-62HN.

IMPROVEMENTS:

- ① FENCE 219' N, 260' W, 285' N
- ② 2-TRACK 225' W
- ③ GATE 328' NW
- ④ ROAD 243' N

PAD DETAILS:

WELL HEAD SPACING = 37.5' & 150'

NEAREST FEATURE: BUILDING 5280' +, PUBLIC ROAD
243' N (CR 100), ABOVE GROUND UTILITY 5280' +,
RAILROAD 5280' +, PROPERTY LINE 250' N

UINTAH ENGINEERING & LAND SURVEYING
85 So. 200 East * Vernal, Utah 84078 * (435) 789-1017