



LEGEND:

 PROPOSED LOCATION



Hunter Ridge Energy Services LLC.

FRAC PAD SG K24 496
SECTION 24, T4S, R96W, 6th P.M.
NE 1/4 SW 1/4

SHEET 6 OF 9



Uintah Engineering & Land Surveying
85 South 200 East Vernal, Utah 84078
(435) 789-1017 * FAX (435) 789-1813

**ACCESS ROAD
MAP**

10 20 12
MONTH DAY YEAR

SCALE: 1:100,000 DRAWN BY: J.L.G. REVISED: 12-19-12



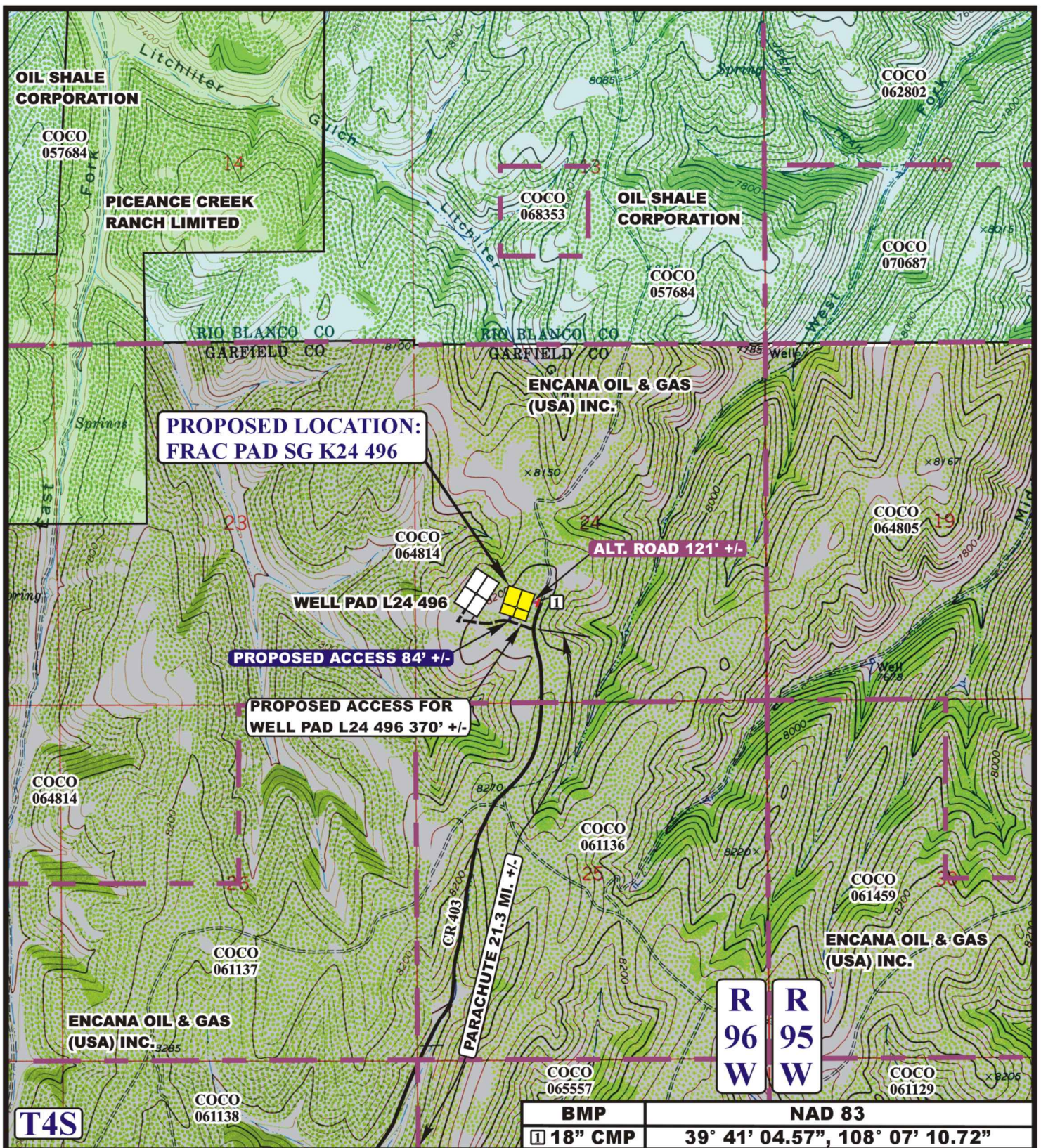

T4S

LEGEND:

- PROPOSED ACCESS ROAD
- ===== EXISTING ROAD
- ===== ALTERNATE ACCESS ROAD



Uintah Engineering & Land Surveying
85 South 200 East Vernal, Utah 84078
(435) 789-1017 * FAX (435) 789-1813



Hunter Ridge Energy Services LLC.

FRAC PAD SG K24 496
SECTION 24, T4S, R96W, 6th P.M.
NE 1/4 SW 1/4

SHEET 7 OF 9

ACCESS ROAD			10	20	10
MAP			MONTH	DAY	YEAR
SCALE: 1" = 2000'			DRAWN BY: J.L.G. REVISED: 12-19-12		



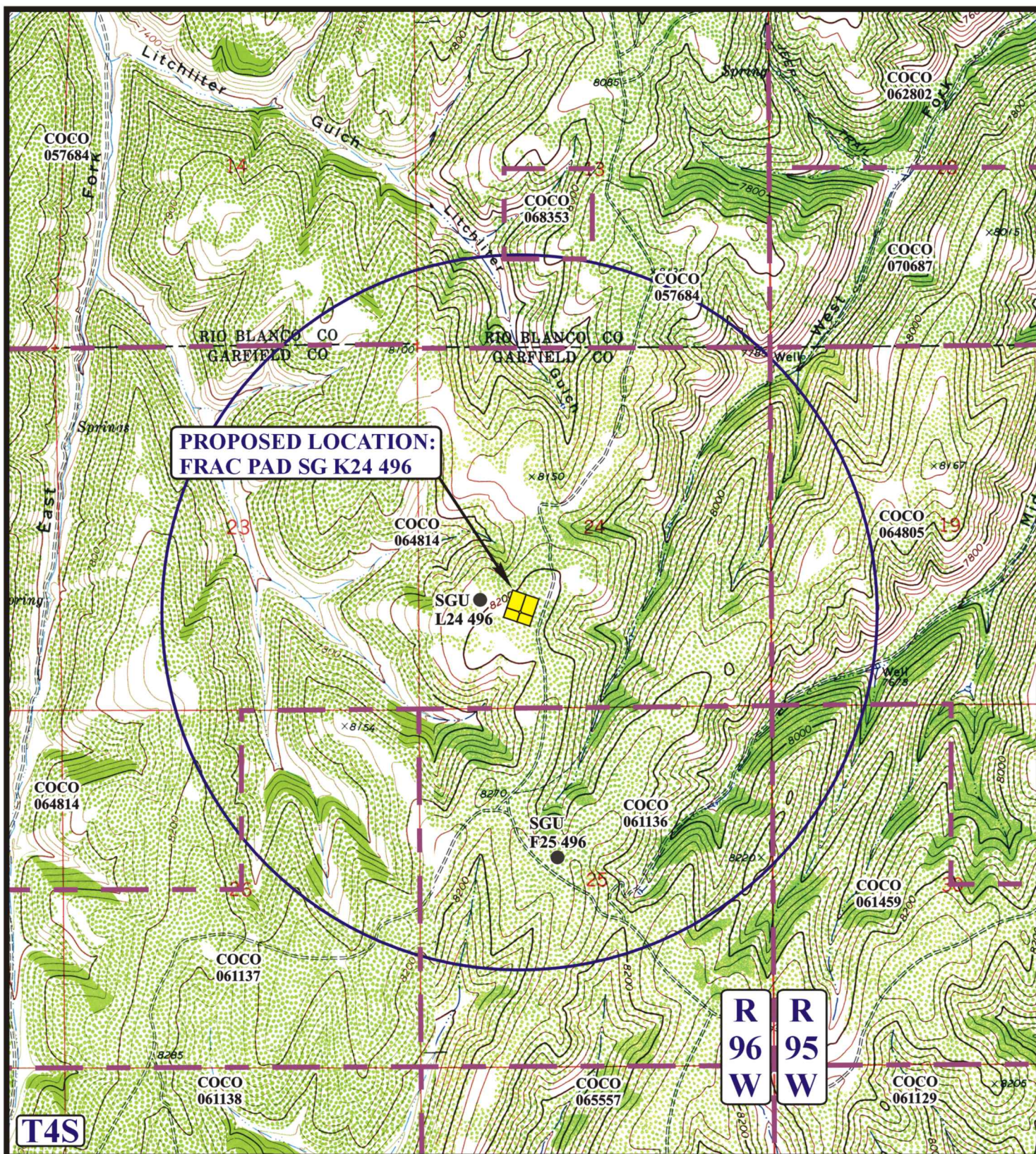

LEGEND:

- DISPOSAL WELLS
- PRODUCING WELLS
- SHUT IN WELLS
- WATER WELLS
- ABANDONED WELLS
- TEMPORARILY ABANDONED

Hunter Ridge Energy Services LLC.

FRAC PAD SG K24 496
SECTION 24, T4S, R96W, 6th P.M.
NE 1/4 SW 1/4

SHEET 8 OF 9



Uintah Engineering & Land Surveying
85 South 200 East Vernal, Utah 84078
(435) 789-1017 * FAX (435) 789-1813

TOPOGRAPHIC
MAP

10 MONTH
20 DAY
10 YEAR

SCALE: 1" = 2000' DRAWN BY: J.L.G. REVISED: 12-19-12



Hunter Ridge Energy Services LLC.
FRAC PAD SG K24 496
SECTION 24, T4S, R96W, 6th P.M.

PROCEED IN A NORTHWESTERLY DIRECTION FROM PARACHUTE, COLORADO ALONG COUNTY ROAD 215 APPROXIMATELY 10.8 MILES TO THE JUNCTION OF THIS ROAD AND AN EXISTING ROAD TO THE NORTHWEST; TURN LEFT AND PROCEED IN A NORTHWESTERLY, THEN NORTHERLY DIRECTION APPROXIMATELY 10.5 MILES TO THE BEGINNING OF THE ACCESS ROAD FOR THE L24 496 TO THE NORTHWEST; TURN LEFT AND PROCEED IN A NORTHWESTERLY DIRECTION APPROXIMATELY 370' TO THE BEGINNING OF THE PROPOSED ACCESS TO THE NORTHEAST: FOLLOW ROAD FLAGS IN A NORTHEASTERLY DIRECTION APPROXIMATELY 84' TO THE PROPOSED FRAC PAD.

TOTAL DISTANCE FROM PARACHUTE, COLORADO TO THE EXISTING WELL LOCATION IS APPROXIMATELY 21.4 MILES.