

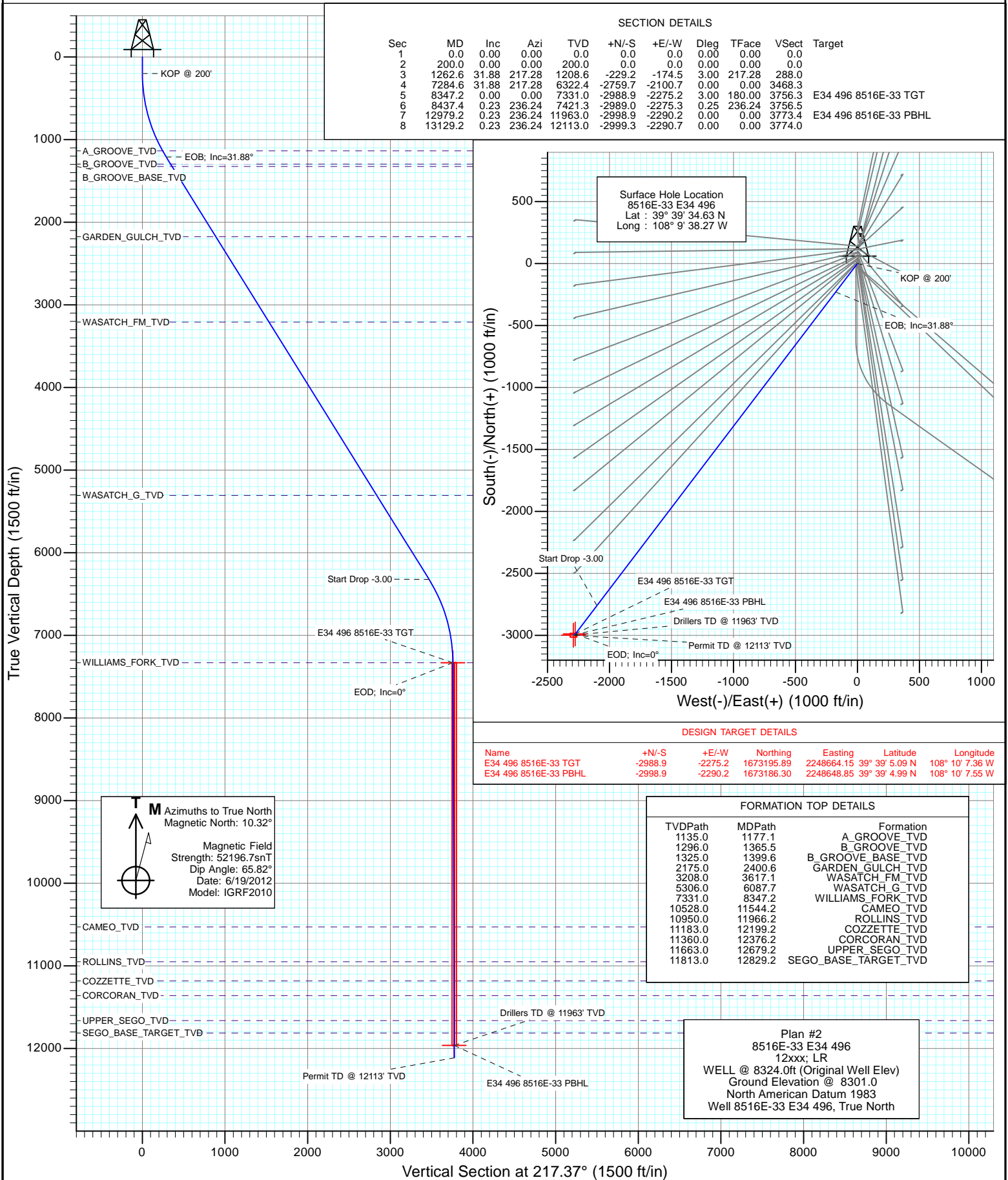

Project: Story Gulch  
Site: S33-T4S-R96W (E34 496)  
Well: 8516E-33 E34 496  
Wellbore: DD  
Design: Plan #2



## Planning Report

<b>Database:</b>	USA EDM 5000 Multi Users DB	<b>Local Co-ordinate Reference:</b>	Well 8516E-33 E34 496
<b>Company:</b>	EnCana Oil & Gas (USA) Inc	<b>TVD Reference:</b>	WELL @ 8324.0ft (Original Well Elev)
<b>Project:</b>	Story Gulch	<b>MD Reference:</b>	WELL @ 8324.0ft (Original Well Elev)
<b>Site:</b>	S33-T4S-R96W (E34 496)	<b>North Reference:</b>	True
<b>Well:</b>	8516E-33 E34 496	<b>Survey Calculation Method:</b>	Minimum Curvature
<b>Wellbore:</b>	DD		
<b>Design:</b>	Plan #2		

<b>Project</b>	Story Gulch		
<b>Map System:</b>	US State Plane 1983	<b>System Datum:</b>	Mean Sea Level
<b>Geo Datum:</b>	North American Datum 1983		
<b>Map Zone:</b>	Colorado Central Zone		

<b>Site</b>	S33-T4S-R96W (E34 496)			
<b>Site Position:</b>		<b>Northing:</b>	1,676,257.20 ft	<b>Latitude:</b> 39° 39' 36.02 N
<b>From:</b>	Lat/Long	<b>Easting:</b>	2,251,040.13 ft	<b>Longitude:</b> 108° 9' 38.14 W
<b>Position Uncertainty:</b>	0.0 ft	<b>Slot Radius:</b>	13.200 in	<b>Grid Convergence:</b> -1.68 °

<b>Well</b>	8516E-33 E34 496			
<b>Well Position</b>	<b>+N/-S</b>	0.0 ft	<b>Northing:</b>	1,676,116.90 ft
	<b>+E/-W</b>	0.0 ft	<b>Easting:</b>	2,251,025.85 ft
<b>Position Uncertainty</b>	0.0 ft		<b>Wellhead Elevation:</b>	ft
			<b>Ground Level:</b>	8,301.0 ft

<b>Wellbore</b>	DD				
<b>Magnetics</b>	<b>Model Name</b>	<b>Sample Date</b>	<b>Declination (°)</b>	<b>Dip Angle (°)</b>	<b>Field Strength (nT)</b>
	IGRF2010	6/19/2012	10.32	65.82	52,197

<b>Design</b>	Plan #2			
<b>Audit Notes:</b>				
<b>Version:</b>	<b>Phase:</b>	PLAN	<b>Tie On Depth:</b>	0.0
<b>Vertical Section:</b>	<b>Depth From (TVD) (ft)</b>	<b>+N/-S (ft)</b>	<b>+E/-W (ft)</b>	<b>Direction (°)</b>
	0.0	0.0	0.0	217.37

<b>Plan Sections</b>										
Measured Depth (ft)	Inclination (°)	Azimuth (°)	Vertical Depth (ft)	+N/-S (ft)	+E/-W (ft)	Dogleg Rate (°/100ft)	Build Rate (°/100ft)	Turn Rate (°/100ft)	TFO (°)	Target
0.0	0.00	0.00	0.0	0.0	0.0	0.00	0.00	0.00	0.00	
200.0	0.00	0.00	200.0	0.0	0.0	0.00	0.00	0.00	0.00	
1,262.6	31.88	217.28	1,208.6	-229.2	-174.5	3.00	3.00	0.00	217.28	
7,284.6	31.88	217.28	6,322.4	-2,759.7	-2,100.7	0.00	0.00	0.00	0.00	
8,347.2	0.00	0.00	7,331.0	-2,988.9	-2,275.2	3.00	-3.00	0.00	180.00	E34 496 8516E-33 TC
8,437.4	0.23	236.24	7,421.3	-2,989.0	-2,275.3	0.25	0.25	-137.13	236.24	
12,979.2	0.23	236.24	11,963.0	-2,998.9	-2,290.2	0.00	0.00	0.00	0.00	E34 496 8516E-33 PE
13,129.2	0.23	236.24	12,113.0	-2,999.3	-2,290.7	0.00	0.00	0.00	0.00	

# Planning Report

<b>Database:</b>	USA EDM 5000 Multi Users DB	<b>Local Co-ordinate Reference:</b>	Well 8516E-33 E34 496
<b>Company:</b>	EnCana Oil & Gas (USA) Inc	<b>TVD Reference:</b>	WELL @ 8324.0ft (Original Well Elev)
<b>Project:</b>	Story Gulch	<b>MD Reference:</b>	WELL @ 8324.0ft (Original Well Elev)
<b>Site:</b>	S33-T4S-R96W (E34 496)	<b>North Reference:</b>	True
<b>Well:</b>	8516E-33 E34 496	<b>Survey Calculation Method:</b>	Minimum Curvature
<b>Wellbore:</b>	DD		
<b>Design:</b>	Plan #2		

Planned Survey									
Measured Depth (ft)	Inclination (°)	Azimuth (°)	Vertical Depth (ft)	+N/-S (ft)	+E/-W (ft)	Vertical Section (ft)	Dogleg Rate (°/100ft)	Build Rate (°/100ft)	Comments / Formations
0.0	0.00	0.00	0.0	0.0	0.0	0.0	0.00	0.00	
100.0	0.00	0.00	100.0	0.0	0.0	0.0	0.00	0.00	
200.0	0.00	0.00	200.0	0.0	0.0	0.0	0.00	0.00	KOP @ 200'
300.0	3.00	217.28	300.0	-2.1	-1.6	2.6	3.00	3.00	
400.0	6.00	217.28	399.6	-8.3	-6.3	10.5	3.00	3.00	
500.0	9.00	217.28	498.8	-18.7	-14.2	23.5	3.00	3.00	
600.0	12.00	217.28	597.1	-33.2	-25.3	41.7	3.00	3.00	
700.0	15.00	217.28	694.3	-51.8	-39.4	65.1	3.00	3.00	
800.0	18.00	217.28	790.2	-74.4	-56.6	93.5	3.00	3.00	
900.0	21.00	217.28	884.4	-100.9	-76.8	126.9	3.00	3.00	
1,000.0	24.00	217.28	976.8	-131.4	-100.0	165.1	3.00	3.00	
1,100.0	27.00	217.28	1,067.1	-165.6	-126.1	208.2	3.00	3.00	
1,177.1	29.31	217.28	1,135.0	-194.6	-148.1	244.5	3.00	3.00	A_GROOVE_TVD
1,200.0	30.00	217.28	1,154.9	-203.6	-155.0	255.9	3.00	3.00	
1,262.6	31.88	217.28	1,208.6	-229.2	-174.5	288.0	3.00	3.00	EOB; Inc=31.88°
1,300.0	31.88	217.28	1,240.4	-244.9	-186.4	307.8	0.00	0.00	
1,365.5	31.88	217.28	1,296.0	-272.4	-207.4	342.4	0.00	0.00	B_GROOVE_TVD
1,399.6	31.88	217.28	1,325.0	-286.8	-218.3	360.4	0.00	0.00	B_GROOVE_BASE_TVD
1,400.0	31.88	217.28	1,325.3	-286.9	-218.4	360.6	0.00	0.00	
1,500.0	31.88	217.28	1,410.2	-329.0	-250.4	413.4	0.00	0.00	
1,600.0	31.88	217.28	1,495.1	-371.0	-282.4	466.2	0.00	0.00	
1,700.0	31.88	217.28	1,580.1	-413.0	-314.4	519.0	0.00	0.00	
1,800.0	31.88	217.28	1,665.0	-455.0	-346.4	571.9	0.00	0.00	
1,900.0	31.88	217.28	1,749.9	-497.0	-378.4	624.7	0.00	0.00	
2,000.0	31.88	217.28	1,834.8	-539.1	-410.3	677.5	0.00	0.00	
2,100.0	31.88	217.28	1,919.7	-581.1	-442.3	730.3	0.00	0.00	
2,200.0	31.88	217.28	2,004.6	-623.1	-474.3	783.1	0.00	0.00	
2,300.0	31.88	217.28	2,089.6	-665.1	-506.3	835.9	0.00	0.00	
2,400.0	31.88	217.28	2,174.5	-707.2	-538.3	888.7	0.00	0.00	
2,400.6	31.88	217.28	2,175.0	-707.4	-538.5	889.0	0.00	0.00	GARDEN_GULCH_TVD
2,500.0	31.88	217.28	2,259.4	-749.2	-570.3	941.5	0.00	0.00	
2,600.0	31.88	217.28	2,344.3	-791.2	-602.3	994.3	0.00	0.00	
2,700.0	31.88	217.28	2,429.2	-833.2	-634.2	1,047.1	0.00	0.00	
2,800.0	31.88	217.28	2,514.2	-875.2	-666.2	1,100.0	0.00	0.00	
2,900.0	31.88	217.28	2,599.1	-917.3	-698.2	1,152.8	0.00	0.00	
3,000.0	31.88	217.28	2,684.0	-959.3	-730.2	1,205.6	0.00	0.00	
3,100.0	31.88	217.28	2,768.9	-1,001.3	-762.2	1,258.4	0.00	0.00	
3,200.0	31.88	217.28	2,853.8	-1,043.3	-794.2	1,311.2	0.00	0.00	
3,300.0	31.88	217.28	2,938.7	-1,085.3	-826.2	1,364.0	0.00	0.00	
3,400.0	31.88	217.28	3,023.7	-1,127.4	-858.1	1,416.8	0.00	0.00	
3,500.0	31.88	217.28	3,108.6	-1,169.4	-890.1	1,469.6	0.00	0.00	
3,600.0	31.88	217.28	3,193.5	-1,211.4	-922.1	1,522.4	0.00	0.00	
3,617.1	31.88	217.28	3,208.0	-1,218.6	-927.6	1,531.4	0.00	0.00	WASATCH_FM_TVD
3,700.0	31.88	217.28	3,278.4	-1,253.4	-954.1	1,575.2	0.00	0.00	
3,800.0	31.88	217.28	3,363.3	-1,295.4	-986.1	1,628.1	0.00	0.00	
3,900.0	31.88	217.28	3,448.3	-1,337.5	-1,018.1	1,680.9	0.00	0.00	
4,000.0	31.88	217.28	3,533.2	-1,379.5	-1,050.1	1,733.7	0.00	0.00	
4,100.0	31.88	217.28	3,618.1	-1,421.5	-1,082.1	1,786.5	0.00	0.00	
4,200.0	31.88	217.28	3,703.0	-1,463.5	-1,114.0	1,839.3	0.00	0.00	
4,300.0	31.88	217.28	3,787.9	-1,505.6	-1,146.0	1,892.1	0.00	0.00	
4,400.0	31.88	217.28	3,872.8	-1,547.6	-1,178.0	1,944.9	0.00	0.00	
4,500.0	31.88	217.28	3,957.8	-1,589.6	-1,210.0	1,997.7	0.00	0.00	

# Planning Report

<b>Database:</b>	USA EDM 5000 Multi Users DB	<b>Local Co-ordinate Reference:</b>	Well 8516E-33 E34 496
<b>Company:</b>	EnCana Oil & Gas (USA) Inc	<b>TVD Reference:</b>	WELL @ 8324.0ft (Original Well Elev)
<b>Project:</b>	Story Gulch	<b>MD Reference:</b>	WELL @ 8324.0ft (Original Well Elev)
<b>Site:</b>	S33-T4S-R96W (E34 496)	<b>North Reference:</b>	True
<b>Well:</b>	8516E-33 E34 496	<b>Survey Calculation Method:</b>	Minimum Curvature
<b>Wellbore:</b>	DD		
<b>Design:</b>	Plan #2		

Planned Survey									
Measured Depth (ft)	Inclination (°)	Azimuth (°)	Vertical Depth (ft)	+N/-S (ft)	+E/-W (ft)	Vertical Section (ft)	Dogleg Rate (°/100ft)	Build Rate (°/100ft)	Comments / Formations
4,600.0	31.88	217.28	4,042.7	-1,631.6	-1,242.0	2,050.5	0.00	0.00	
4,700.0	31.88	217.28	4,127.6	-1,673.6	-1,274.0	2,103.3	0.00	0.00	
4,800.0	31.88	217.28	4,212.5	-1,715.7	-1,306.0	2,156.2	0.00	0.00	
4,900.0	31.88	217.28	4,297.4	-1,757.7	-1,337.9	2,209.0	0.00	0.00	
5,000.0	31.88	217.28	4,382.4	-1,799.7	-1,369.9	2,261.8	0.00	0.00	
5,100.0	31.88	217.28	4,467.3	-1,841.7	-1,401.9	2,314.6	0.00	0.00	
5,200.0	31.88	217.28	4,552.2	-1,883.7	-1,433.9	2,367.4	0.00	0.00	
5,300.0	31.88	217.28	4,637.1	-1,925.8	-1,465.9	2,420.2	0.00	0.00	
5,400.0	31.88	217.28	4,722.0	-1,967.8	-1,497.9	2,473.0	0.00	0.00	
5,500.0	31.88	217.28	4,806.9	-2,009.8	-1,529.9	2,525.8	0.00	0.00	
5,600.0	31.88	217.28	4,891.9	-2,051.8	-1,561.8	2,578.6	0.00	0.00	
5,700.0	31.88	217.28	4,976.8	-2,093.8	-1,593.8	2,631.4	0.00	0.00	
5,800.0	31.88	217.28	5,061.7	-2,135.9	-1,625.8	2,684.2	0.00	0.00	
5,900.0	31.88	217.28	5,146.6	-2,177.9	-1,657.8	2,737.1	0.00	0.00	
6,000.0	31.88	217.28	5,231.5	-2,219.9	-1,689.8	2,789.9	0.00	0.00	
6,087.7	31.88	217.28	5,306.0	-2,256.8	-1,717.8	2,836.2	0.00	0.00	WASATCH_G_TVD
6,100.0	31.88	217.28	5,316.5	-2,261.9	-1,721.8	2,842.7	0.00	0.00	
6,200.0	31.88	217.28	5,401.4	-2,304.0	-1,753.8	2,895.5	0.00	0.00	
6,300.0	31.88	217.28	5,486.3	-2,346.0	-1,785.7	2,948.3	0.00	0.00	
6,400.0	31.88	217.28	5,571.2	-2,388.0	-1,817.7	3,001.1	0.00	0.00	
6,500.0	31.88	217.28	5,656.1	-2,430.0	-1,849.7	3,053.9	0.00	0.00	
6,600.0	31.88	217.28	5,741.0	-2,472.0	-1,881.7	3,106.7	0.00	0.00	
6,700.0	31.88	217.28	5,826.0	-2,514.1	-1,913.7	3,159.5	0.00	0.00	
6,800.0	31.88	217.28	5,910.9	-2,556.1	-1,945.7	3,212.3	0.00	0.00	
6,900.0	31.88	217.28	5,995.8	-2,598.1	-1,977.7	3,265.2	0.00	0.00	
7,000.0	31.88	217.28	6,080.7	-2,640.1	-2,009.7	3,318.0	0.00	0.00	
7,100.0	31.88	217.28	6,165.6	-2,682.1	-2,041.6	3,370.8	0.00	0.00	
7,200.0	31.88	217.28	6,250.6	-2,724.2	-2,073.6	3,423.6	0.00	0.00	
7,284.6	31.88	217.28	6,322.4	-2,759.7	-2,100.7	3,468.3	0.00	0.00	Start Drop -3.00
7,300.0	31.42	217.28	6,335.5	-2,766.1	-2,105.6	3,476.3	3.00	-3.00	
7,400.0	28.42	217.28	6,422.2	-2,805.8	-2,135.8	3,526.2	3.00	-3.00	
7,500.0	25.42	217.28	6,511.3	-2,841.8	-2,163.2	3,571.5	3.00	-3.00	
7,600.0	22.42	217.28	6,602.7	-2,874.1	-2,187.7	3,612.0	3.00	-3.00	
7,700.0	19.42	217.28	6,696.1	-2,902.5	-2,209.4	3,647.7	3.00	-3.00	
7,800.0	16.42	217.28	6,791.3	-2,927.0	-2,228.0	3,678.5	3.00	-3.00	
7,900.0	13.42	217.28	6,887.9	-2,947.4	-2,243.6	3,704.2	3.00	-3.00	
8,000.0	10.42	217.28	6,985.7	-2,963.9	-2,256.1	3,724.8	3.00	-3.00	
8,100.0	7.42	217.28	7,084.5	-2,976.2	-2,265.5	3,740.3	3.00	-3.00	
8,200.0	4.42	217.28	7,184.0	-2,984.4	-2,271.7	3,750.6	3.00	-3.00	
8,300.0	1.42	217.28	7,283.8	-2,988.4	-2,274.8	3,755.7	3.00	-3.00	
8,347.2	0.00	0.00	7,331.0	-2,988.9	-2,275.2	3,756.3	3.00	-3.00	EOD; Inc=0° - WILLIAMS_FORK_TVD - E34 496
8,400.0	0.13	236.24	7,383.8	-2,988.9	-2,275.2	3,756.4	0.25	0.25	
8,437.4	0.23	236.24	7,421.3	-2,989.0	-2,275.3	3,756.5	0.25	0.25	
8,500.0	0.23	236.24	7,483.8	-2,989.1	-2,275.5	3,756.7	0.00	0.00	
8,600.0	0.23	236.24	7,583.8	-2,989.4	-2,275.8	3,757.1	0.00	0.00	
8,700.0	0.23	236.24	7,683.8	-2,989.6	-2,276.2	3,757.5	0.00	0.00	
8,800.0	0.23	236.24	7,783.8	-2,989.8	-2,276.5	3,757.8	0.00	0.00	
8,900.0	0.23	236.24	7,883.8	-2,990.0	-2,276.8	3,758.2	0.00	0.00	
9,000.0	0.23	236.24	7,983.8	-2,990.2	-2,277.1	3,758.6	0.00	0.00	
9,100.0	0.23	236.24	8,083.8	-2,990.5	-2,277.5	3,758.9	0.00	0.00	
9,200.0	0.23	236.24	8,183.8	-2,990.7	-2,277.8	3,759.3	0.00	0.00	
9,300.0	0.23	236.24	8,283.8	-2,990.9	-2,278.1	3,759.7	0.00	0.00	

# Planning Report

<b>Database:</b>	USA EDM 5000 Multi Users DB	<b>Local Co-ordinate Reference:</b>	Well 8516E-33 E34 496
<b>Company:</b>	EnCana Oil & Gas (USA) Inc	<b>TVD Reference:</b>	WELL @ 8324.0ft (Original Well Elev)
<b>Project:</b>	Story Gulch	<b>MD Reference:</b>	WELL @ 8324.0ft (Original Well Elev)
<b>Site:</b>	S33-T4S-R96W (E34 496)	<b>North Reference:</b>	True
<b>Well:</b>	8516E-33 E34 496	<b>Survey Calculation Method:</b>	Minimum Curvature
<b>Wellbore:</b>	DD		
<b>Design:</b>	Plan #2		

Planned Survey									
Measured Depth (ft)	Inclination (°)	Azimuth (°)	Vertical Depth (ft)	+N/-S (ft)	+E/-W (ft)	Vertical Section (ft)	Dogleg Rate (°/100ft)	Build Rate (°/100ft)	Comments / Formations
9,400.0	0.23	236.24	8,383.8	-2,991.1	-2,278.4	3,760.1	0.00	0.00	
9,500.0	0.23	236.24	8,483.8	-2,991.3	-2,278.8	3,760.4	0.00	0.00	
9,600.0	0.23	236.24	8,583.8	-2,991.6	-2,279.1	3,760.8	0.00	0.00	
9,700.0	0.23	236.24	8,683.8	-2,991.8	-2,279.4	3,761.2	0.00	0.00	
9,800.0	0.23	236.24	8,783.8	-2,992.0	-2,279.8	3,761.6	0.00	0.00	
9,900.0	0.23	236.24	8,883.8	-2,992.2	-2,280.1	3,761.9	0.00	0.00	
10,000.0	0.23	236.24	8,983.8	-2,992.4	-2,280.4	3,762.3	0.00	0.00	
10,100.0	0.23	236.24	9,083.8	-2,992.6	-2,280.7	3,762.7	0.00	0.00	
10,200.0	0.23	236.24	9,183.8	-2,992.9	-2,281.1	3,763.0	0.00	0.00	
10,300.0	0.23	236.24	9,283.8	-2,993.1	-2,281.4	3,763.4	0.00	0.00	
10,400.0	0.23	236.24	9,383.8	-2,993.3	-2,281.7	3,763.8	0.00	0.00	
10,500.0	0.23	236.24	9,483.8	-2,993.5	-2,282.1	3,764.2	0.00	0.00	
10,600.0	0.23	236.24	9,583.8	-2,993.7	-2,282.4	3,764.5	0.00	0.00	
10,700.0	0.23	236.24	9,683.8	-2,994.0	-2,282.7	3,764.9	0.00	0.00	
10,800.0	0.23	236.24	9,783.8	-2,994.2	-2,283.0	3,765.3	0.00	0.00	
10,900.0	0.23	236.24	9,883.8	-2,994.4	-2,283.4	3,765.7	0.00	0.00	
11,000.0	0.23	236.24	9,983.8	-2,994.6	-2,283.7	3,766.0	0.00	0.00	
11,100.0	0.23	236.24	10,083.8	-2,994.8	-2,284.0	3,766.4	0.00	0.00	
11,200.0	0.23	236.24	10,183.8	-2,995.1	-2,284.3	3,766.8	0.00	0.00	
11,300.0	0.23	236.24	10,283.8	-2,995.3	-2,284.7	3,767.1	0.00	0.00	
11,400.0	0.23	236.24	10,383.8	-2,995.5	-2,285.0	3,767.5	0.00	0.00	
11,500.0	0.23	236.24	10,483.8	-2,995.7	-2,285.3	3,767.9	0.00	0.00	
11,544.2	0.23	236.24	10,528.0	-2,995.8	-2,285.5	3,768.1	0.00	0.00	CAMEO_TVD
11,600.0	0.23	236.24	10,583.8	-2,995.9	-2,285.7	3,768.3	0.00	0.00	
11,700.0	0.23	236.24	10,683.8	-2,996.1	-2,286.0	3,768.6	0.00	0.00	
11,800.0	0.23	236.24	10,783.8	-2,996.4	-2,286.3	3,769.0	0.00	0.00	
11,900.0	0.23	236.24	10,883.8	-2,996.6	-2,286.6	3,769.4	0.00	0.00	
11,966.2	0.23	236.24	10,950.0	-2,996.7	-2,286.9	3,769.6	0.00	0.00	ROLLINS_TVD
12,000.0	0.23	236.24	10,983.8	-2,996.8	-2,287.0	3,769.7	0.00	0.00	
12,100.0	0.23	236.24	11,083.8	-2,997.0	-2,287.3	3,770.1	0.00	0.00	
12,199.2	0.23	236.24	11,183.0	-2,997.2	-2,287.6	3,770.5	0.00	0.00	COZZETTE_TVD
12,200.0	0.23	236.24	11,183.8	-2,997.2	-2,287.6	3,770.5	0.00	0.00	
12,300.0	0.23	236.24	11,283.8	-2,997.5	-2,287.9	3,770.9	0.00	0.00	
12,376.2	0.23	236.24	11,360.0	-2,997.6	-2,288.2	3,771.2	0.00	0.00	CORCORAN_TVD
12,400.0	0.23	236.24	11,383.8	-2,997.7	-2,288.3	3,771.2	0.00	0.00	
12,500.0	0.23	236.24	11,483.8	-2,997.9	-2,288.6	3,771.6	0.00	0.00	
12,600.0	0.23	236.24	11,583.8	-2,998.1	-2,288.9	3,772.0	0.00	0.00	
12,679.2	0.23	236.24	11,663.0	-2,998.3	-2,289.2	3,772.3	0.00	0.00	UPPER_SEGO_TVD
12,700.0	0.23	236.24	11,683.8	-2,998.3	-2,289.3	3,772.4	0.00	0.00	
12,800.0	0.23	236.24	11,783.8	-2,998.6	-2,289.6	3,772.7	0.00	0.00	
12,829.2	0.23	236.24	11,813.0	-2,998.6	-2,289.7	3,772.8	0.00	0.00	SEGO_BASE_TARGET_TVD
12,900.0	0.23	236.24	11,883.8	-2,998.8	-2,289.9	3,773.1	0.00	0.00	
12,979.2	0.23	236.24	11,963.0	-2,998.9	-2,290.2	3,773.4	0.00	0.00	Drillers TD @ 11963' TVD - E34 496 8516E-33
13,000.0	0.23	236.24	11,983.8	-2,999.0	-2,290.2	3,773.5	0.00	0.00	
13,100.0	0.23	236.24	12,083.8	-2,999.2	-2,290.6	3,773.8	0.00	0.00	
13,129.2	0.23	236.24	12,113.0	-2,999.3	-2,290.7	3,774.0	0.00	0.00	Permit TD @ 12113' TVD

## Planning Report

<b>Database:</b>	USA EDM 5000 Multi Users DB	<b>Local Co-ordinate Reference:</b>	Well 8516E-33 E34 496
<b>Company:</b>	EnCana Oil & Gas (USA) Inc	<b>TVD Reference:</b>	WELL @ 8324.0ft (Original Well Elev)
<b>Project:</b>	Story Gulch	<b>MD Reference:</b>	WELL @ 8324.0ft (Original Well Elev)
<b>Site:</b>	S33-T4S-R96W (E34 496)	<b>North Reference:</b>	True
<b>Well:</b>	8516E-33 E34 496	<b>Survey Calculation Method:</b>	Minimum Curvature
<b>Wellbore:</b>	DD		
<b>Design:</b>	Plan #2		

Targets									
Target Name	Dip Angle (°)	Dip Dir. (°)	TVD (ft)	+N/-S (ft)	+E/-W (ft)	Northing (ft)	Easting (ft)	Latitude	Longitude
- hit/miss target									
- Shape									
E34 496 8516E-33 PBH	0.00	0.00	11,963.0	-2,998.9	-2,290.2	1,673,186.30	2,248,648.85	39° 39' 4.99 N	108° 10' 7.55 W
- plan hits target center									
- Rectangle (sides W30.0 H50.0 D0.0)									
E34 496 8516E-33 TGT	0.00	0.00	7,331.0	-2,988.9	-2,275.2	1,673,195.89	2,248,664.15	39° 39' 5.09 N	108° 10' 7.36 W
- plan hits target center									
- Point									

Formations						
Measured Depth (ft)	Vertical Depth (ft)	Name	Lithology	Dip (°)	Dip Direction (°)	
1,177.1	1,135.0	A_GROOVE_TVD				
1,365.5	1,296.0	B_GROOVE_TVD				
1,399.6	1,325.0	B_GROOVE_BASE_TVD				
2,400.6	2,175.0	GARDEN_GULCH_TVD				
3,617.1	3,208.0	WASATCH_FM_TVD				
6,087.7	5,306.0	WASATCH_G_TVD				
8,347.2	7,331.0	WILLIAMS_FORK_TVD				
11,544.2	10,528.0	CAMEO_TVD				
11,966.2	10,950.0	ROLLINS_TVD				
12,199.2	11,183.0	COZZETTE_TVD				
12,376.2	11,360.0	CORCORAN_TVD				
12,679.2	11,663.0	UPPER_SEGO_TVD				
12,829.2	11,813.0	SEGO_BASE_TARGET_TVD				

Plan Annotations				
Measured Depth (ft)	Vertical Depth (ft)	Local Coordinates		Comment
		+N/-S (ft)	+E/-W (ft)	
200.0	200.0	0.0	0.0	KOP @ 200'
1,262.6	1,208.6	-229.2	-174.5	EOB; Inc=31.88°
7,284.6	6,322.4	-2,759.7	-2,100.7	Start Drop -3.00
8,347.2	7,331.0	-2,988.9	-2,275.2	EOD; Inc=0°
12,979.2	11,963.0	-2,989.0	-2,275.3	Drillers TD @ 11963' TVD
13,129.2	12,113.0	-2,998.9	-2,290.2	Permit TD @ 12113' TVD