

Hydrology Map

WALLACH 1-8H

SW¼NW¼ SECTION 8, TOWNSHIP 7 NORTH, RANGE 61 WEST OF THE 6TH PRINCIPAL MERIDIAN

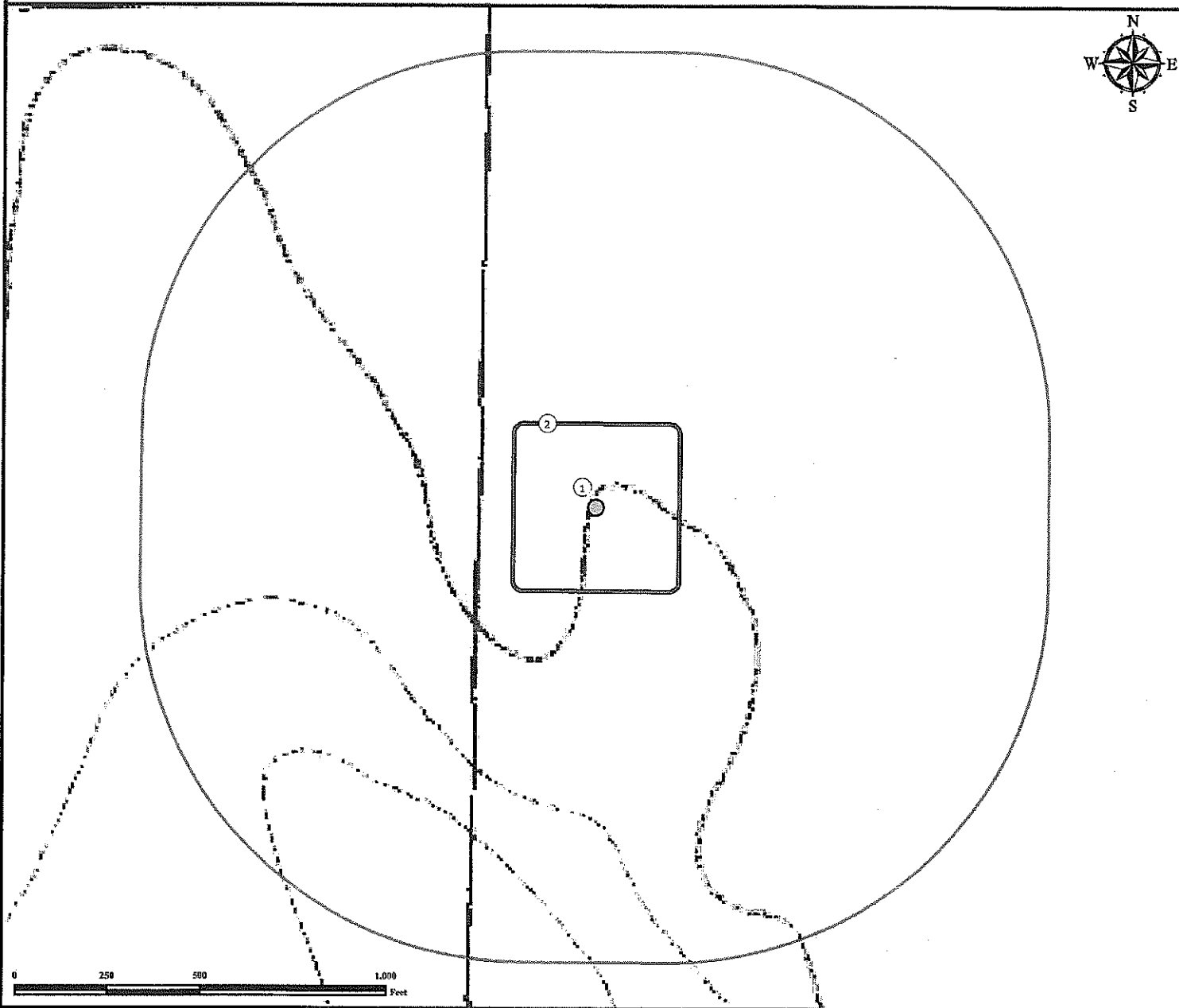

1. Proposed Well WALLACH 1-8H.

2. Operational Disturbance Area.

There are No Visible Surface Waters Within a 1000' Radius of the Disturbance Area of the Proposed Oil and Gas Location.

Legend



Proposed Well



Disturbance Area



1000' Radius

Reference Location

** All Measurements are Made from Reference Well WALLACH 1-8H**

Lat: 40.592257° Long:-104.239787° (NAD83)
Elevation: 4947 Feet



Use our resources to find yours!
www.petro-fs.com
(303) 928-7128

Field Date: 10/02/2012
Drafting Date: 10/08/2012
Drafter: GWB
Revision:

Data Sources:
TOPO courtesy USGS

Prepared for:

