

# MELBON 12C-8HZ TOPO HYDROLOGY MAP

**5,200' Radius**

**• Surface Location**

**Un-named pond is 3,688' S**

**Well elevation: 4,949'**

**pond elevation: 4,939'**

2N 66W

2N 65W

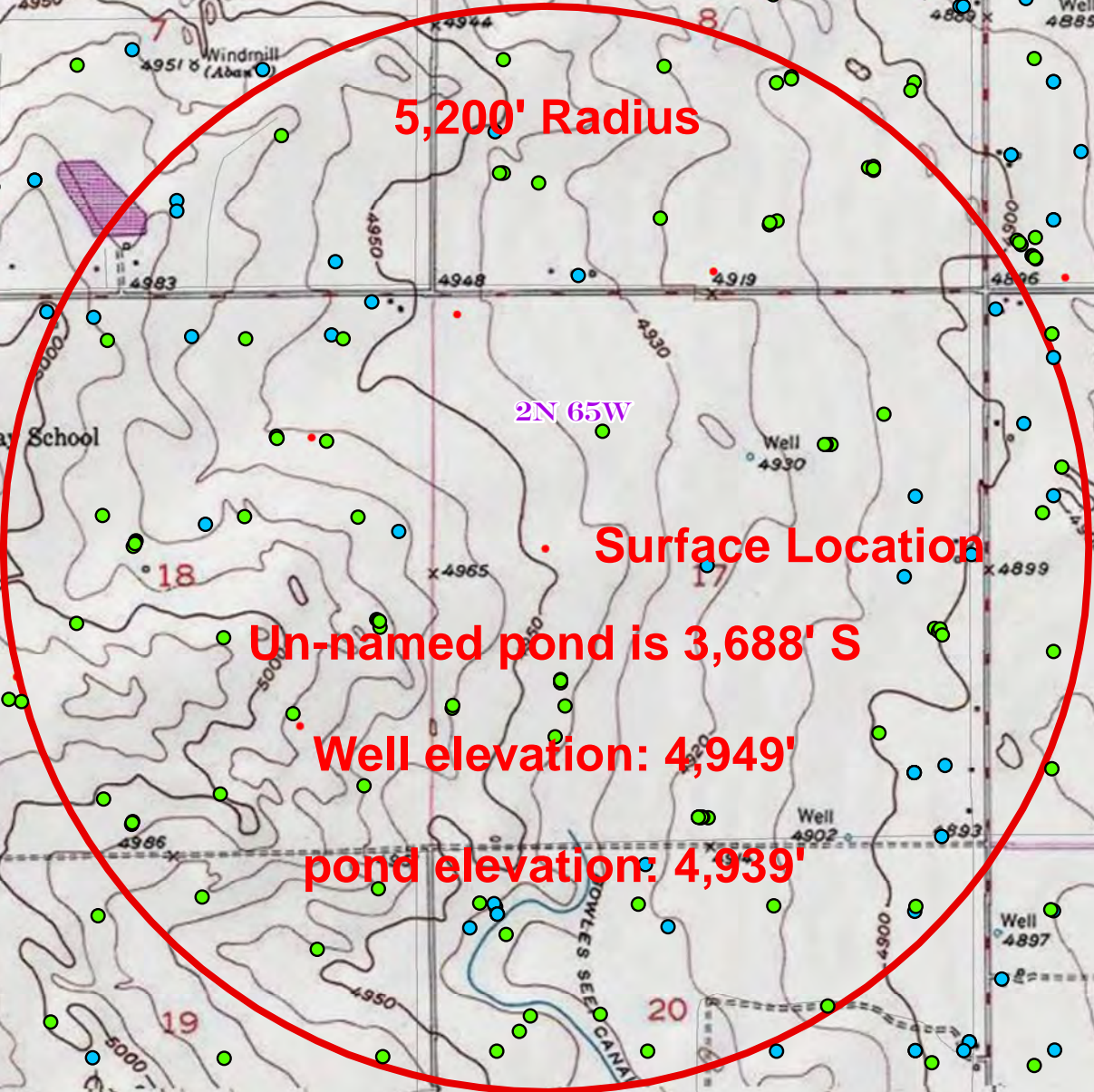

## LEGEND

- Wells
- Water Wells
- Melbon 19C-8HZ Buffer
- Rivers
- Lakes
- Water
- Road - Local
- Road - Secondary
- Road - Primary
- Road - Interstates
- Road - Trails

