

January 8, 2013

Colorado Oil and Gas Conservation Commission
The Chancery Building
1120 Lincoln Street, Suite 801
Denver, CO 80203
Attn: Mr. Matt Lepore, Director

RE: SHABLE USX PC AB11-62-1HNL
Niobrara New Drill
Township 7 North, Range 64 West, 6th P.M.
Section 11: SW/4SW/4: 660' FSL & 250' FWL (Surface Location)
Section 11: SW/4SW/4: 329' FSL & 907' FWL (Beginning of Lateral)
Section 12: SE/4SE/4: 330' FSL & 535' FEL (Bottom Hole Location)
Weld County, Colorado

Mr. Lepore:

Noble Energy, Inc. ("NEI") is planning to drill the captioned boundary well in accordance with the provisions of COGCC Rule 318A.e.

NEI's proposed wellbore spacing unit consists of the S/2S/2 of Section 11, the S/2S/2 of Section 12, the N/2N/2 of Section 13 and the N/2N/2 of Section 14, T7N, R64W, creating a 640-acre wellbore spacing unit for the Niobrara formation. NEI is not the only owner within the proposed wellbore spacing unit and as such provided notice to the remaining owner(s) within said proposed spacing unit as required under COGCC Rule 318A(l).e(6). Copies of the required notice letter(s) is/are on file at the NEI offices. The required thirty (30) day notice period has elapsed absent the receipt by NEI of an objection to said proposal by the owner(s) within the proposed spacing unit for this well.

Enclosed are copies of the following documents to assist you in your review and approval of NEI's proposed APD for the captioned well:

- Map & plat illustrating proposed wellbore spacing unit.

Thank you for your attention to the enclosed. NEI respectfully requests that the COGCC review the enclosed information and approve the Application for Permit to Drill the captioned well.

Sincerely,



Mari Clark
Regulatory Analyst II
Noble Energy Inc.

SHABLE USX PC AB11-62-1HNL

Proposed Spacing Unit – Noble Energy, Inc

S/2S/2 Section 11, Township 7 North, Range 64 West

S/2S/2 Section 12, Township 7 North, Range 64 West

N/2N/2 Section 13, Township 7 North, Range 64 West

N/2N/2 Section 14, Township 7 North, Range 64 West

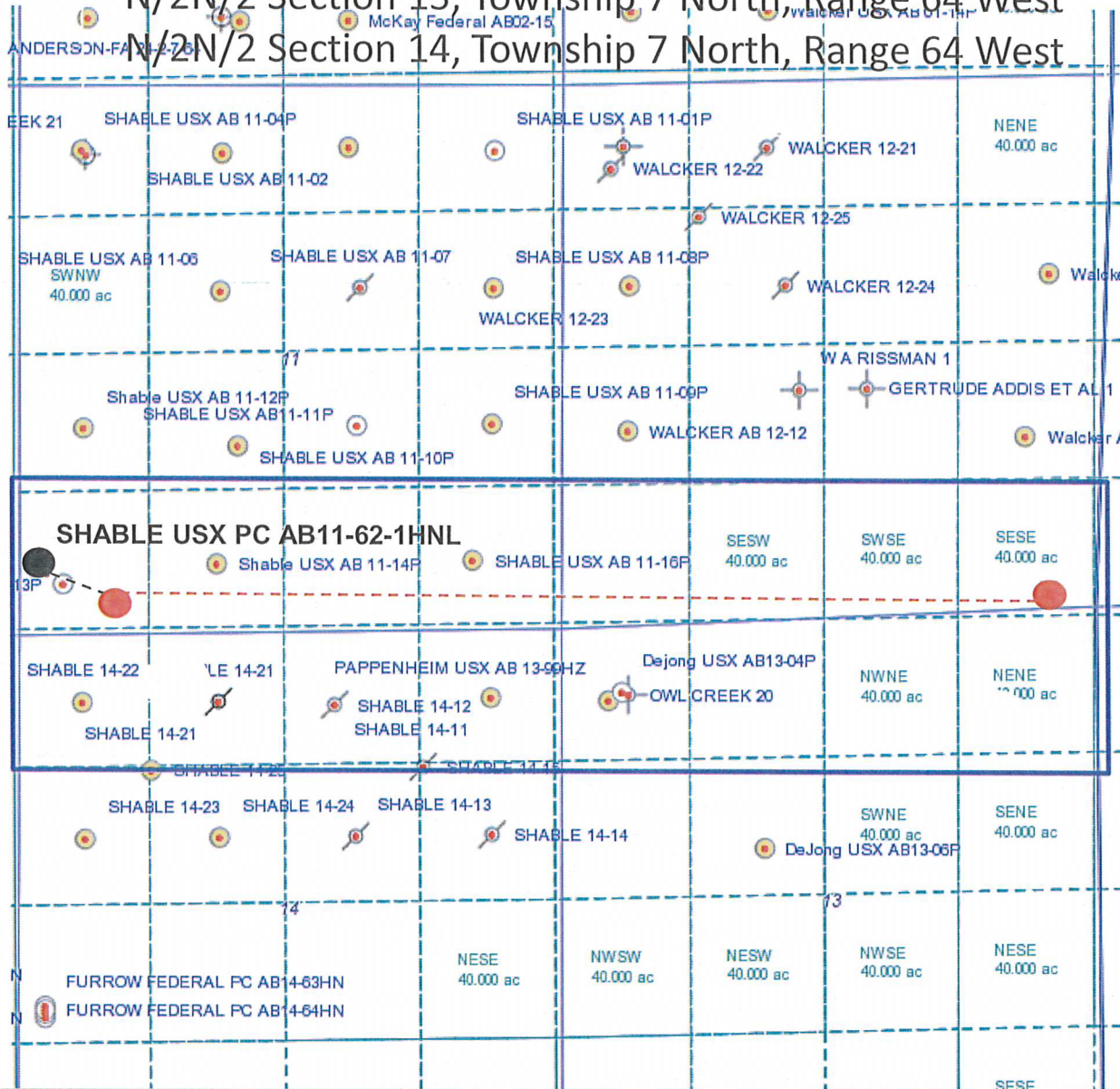

Legend



Proposed 640.01 acre spacing unit



Bottom Hole Location

