

# ConocoPhillips Company

CONSTRUCTION LAYOUT FOR  
CONVERSE FAMILY #6-1H  
SECTION 6, T4S, R63W, 6th P.M.  
1980' FSL 260' FEL

FIGURE #1

SCALE: 1" = 60'  
DATE: 10-08-12  
DRAWN BY: S.R.L.  
REV: 12-14-12 B.D.H.

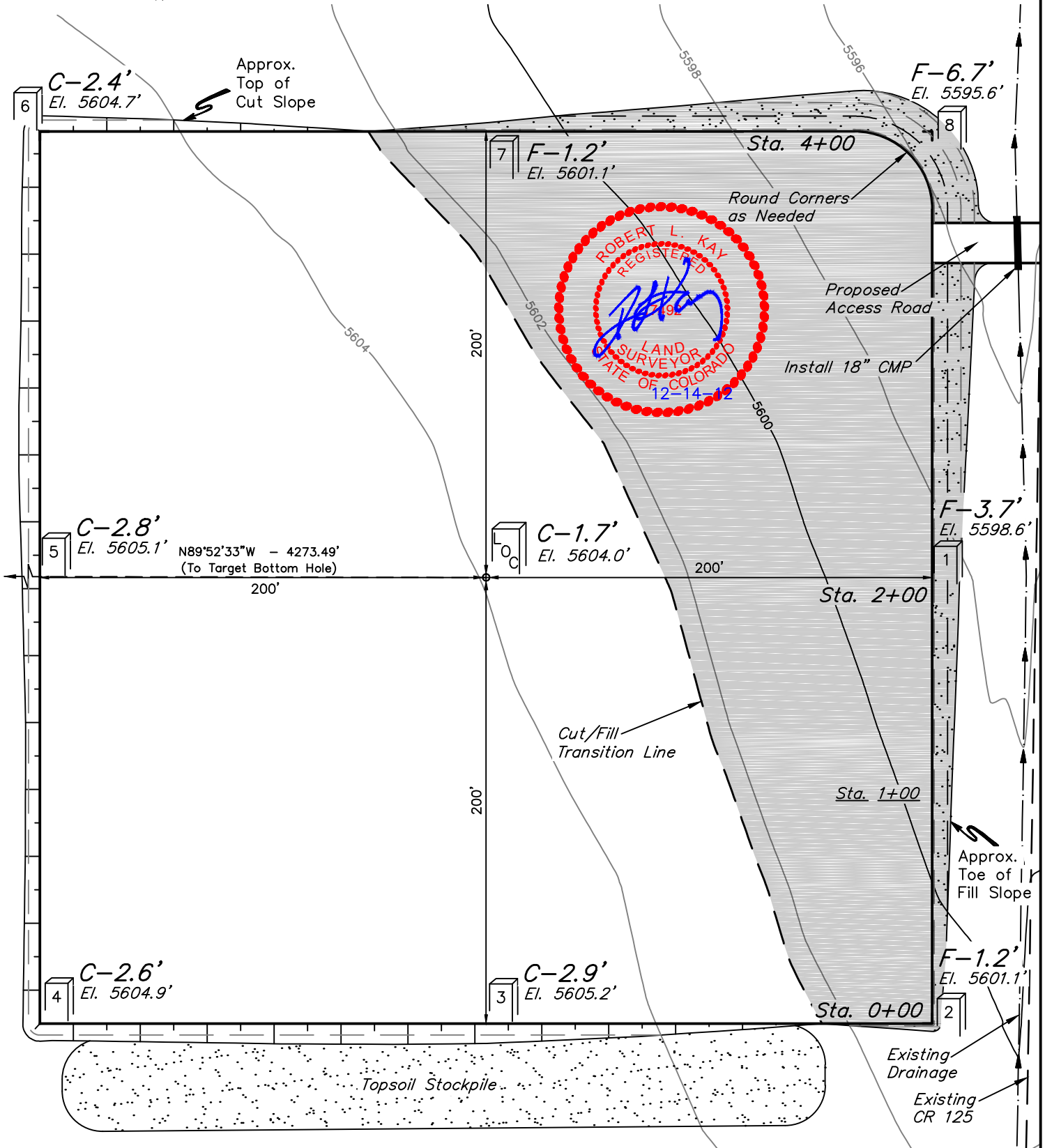
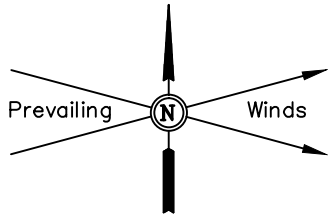

Elev. Ungraded Ground At Loc. Stake = 5604.0'  
FINISHED GRADE ELEV. AT LOC. STAKE = 5602.3'

UINTAH ENGINEERING & LAND SURVEYING  
85 So. 200 East \* Vernal, Utah 84078 \* (435) 789-1017

1" = 40'  
X-Section  
Scale  
1" = 100'

DATE: 10-08-12  
DRAWN BY: S.R.L.

ConocoPhillips Company  
CONSTRUCTION LAYOUT CROSS SECTIONS FOR  
CONVERSE FAMILY #6-1H  
SECTION 6, T4S, R63W, 6th P.M.  
1980' FSL 260' FEL

FIGURE #2

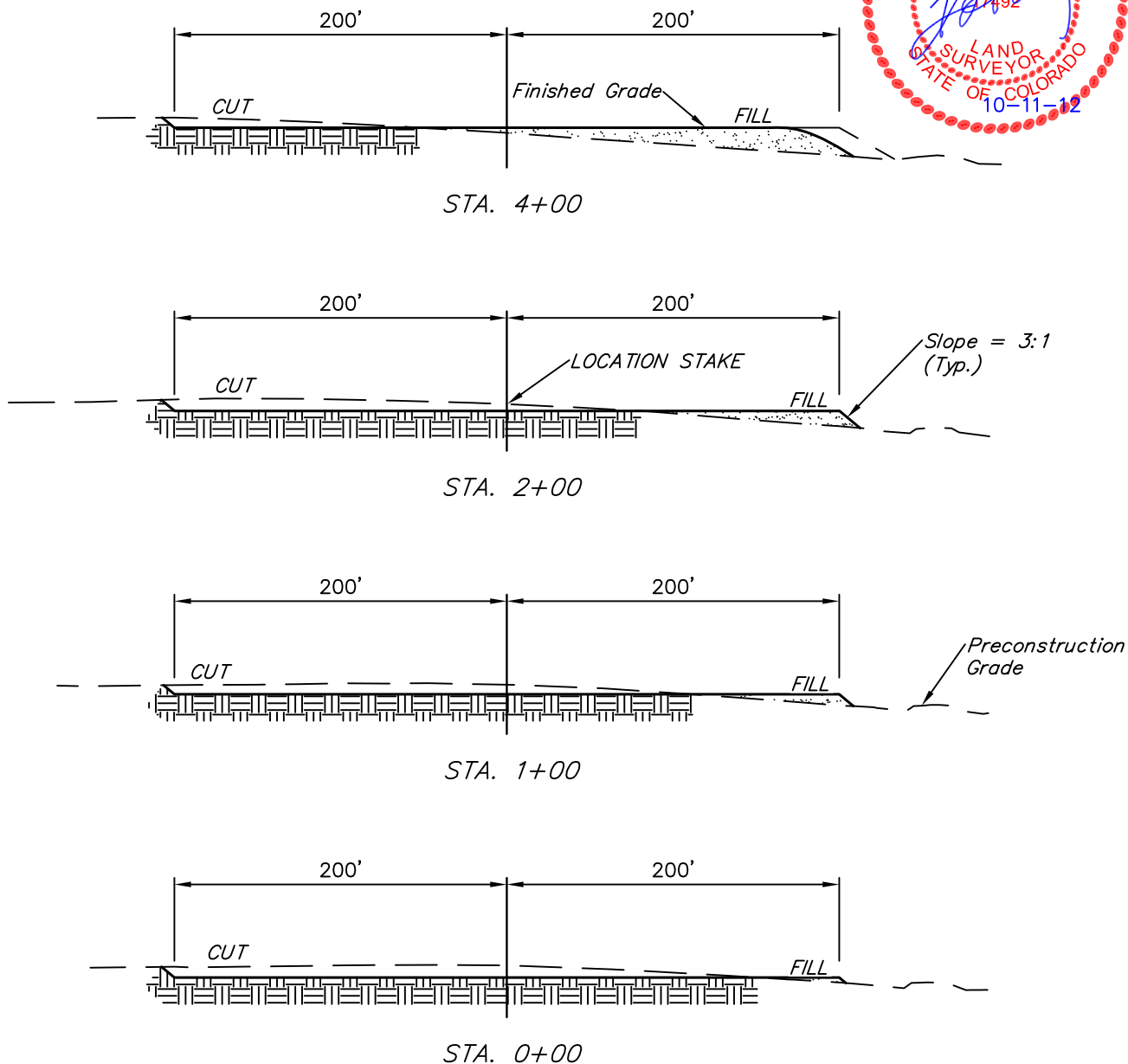

NOTE:

Topsoil should not be Stripped Below Finished Grade on Substructure Area.

APPROXIMATE ACREAGES  
WELL SITE DISTURBANCE =  $\pm 3.997$  ACRES  
ACCESS ROAD DISTURBANCE =  $\pm 0.033$  ACRES  
TOTAL =  $\pm 4.030$  ACRES

\* NOTE:  
FILL QUANTITY INCLUDES 5% FOR COMPACTION

APPROXIMATE YARDAGES

(6") Topsoil Stripping = 3,220 Cu. Yds.  
Remaining Location = 6,470 Cu. Yds.  
TOTAL CUT = 9,690 CU. YDS.  
FILL = 6,470 CU. YDS.

EXCESS MATERIAL = 3,220 Cu. Yds.  
Topsoil & Pit Backfill = 3,220 Cu. Yds.  
(1/2 Pit Vol.)  
EXCESS UNBALANCE = 0 Cu. Yds.  
(After Interim Rehabilitation)

UINTAH ENGINEERING & LAND SURVEYING  
85 So. 200 East \* Vernal, Utah 84078 \* (435) 789-1017